

# PT2305035 Design Description

## Building info:

The design is about a new type of welded container house with size 4056x2438mm and height 2591mm, and the interior net height is 2320mm. 50mm TPS sandwich wall panels, 70mm rock wool insulation roof panel, 18mm waterproof structural board + 1.8mm PVC floor for the floor.

## Load parameters:

Wind load: 120km/h                      Snow load: 0.00kN/m<sub>2</sub>                      Floor live load: 2.00kN/m<sub>2</sub>

## Material specs:

1. Frame: All profile adopts SGH440 high strength galvanized, powder sprayed and painted., color RAL7021. There are 6 secondary beams without forklift beam.
2. Roof panel: 70mm rock wool sandwich roof panel, with both sides 0.40mm color steel sheets(surface treatment:AZM100g/m<sup>2</sup>+PE coating 20/5um) ,color RAL9003(milky white).
3. Wall panel: 50mm TPS sandwich wall panel, with both sides 0.40mm color steel sheets(surface treatment:AZM100g/m<sup>2</sup>+PE coating 20/5um) ,color RAL9003(milky white).Wall panel height 2292mm, both sides flat.
4. Decoration cladding: Add WPC cladding to wall panels at south elevation.  
0.5mm corrugated color steel sheet on other 3 sides(customer's responsibility).
5. Roof system:0.5mm corrugated color steel single-slope roof panel+C-shaped purlins+square tube roof truss+flashings(7021)
6. Floor: 1.8mm PVC floor+18mm waterproof structural board. PVC floor color is wood grain.
7. Door: D1:1800x2175mm alum. alloy double glass sliding door(right panel fixed)+sliding steel fly screen(color of door frame RAL7021, drainage structure added to bottom frame, equipped with Australian standard door lock) (1 set)
8. Window: W1:930x1100mm alum. alloy double glass sliding with insect-proof screen (color for window frame RAL7021) (1 set)
9. Electrical system: Australian standard switches and sockets(double pole),outside plug(15amp 240v),Australian standard wire, Australian standard switch leakage protection and circuit breaker for distribution box,etc.

Note: 1.This construction drawing is only for the reference of the customer, and the final review and confirmation of the local professional authority shall prevail.  
2.Please try to avoid collision and paint loss during transportation. Upgrade protective measures for packing, and add more foam pads both inside and outside.



Australian standard door lock



01118 002555  
PROPERTY INFORMATION FOR SALE  
HOMES WA PTY LTD OR OUR AGENTS HAVE OBTAINED BEFORE ANY  
USE OR REPRODUCTION OF THE DRAWING.



HOMES WA

CG HOMES WA PTY LTD



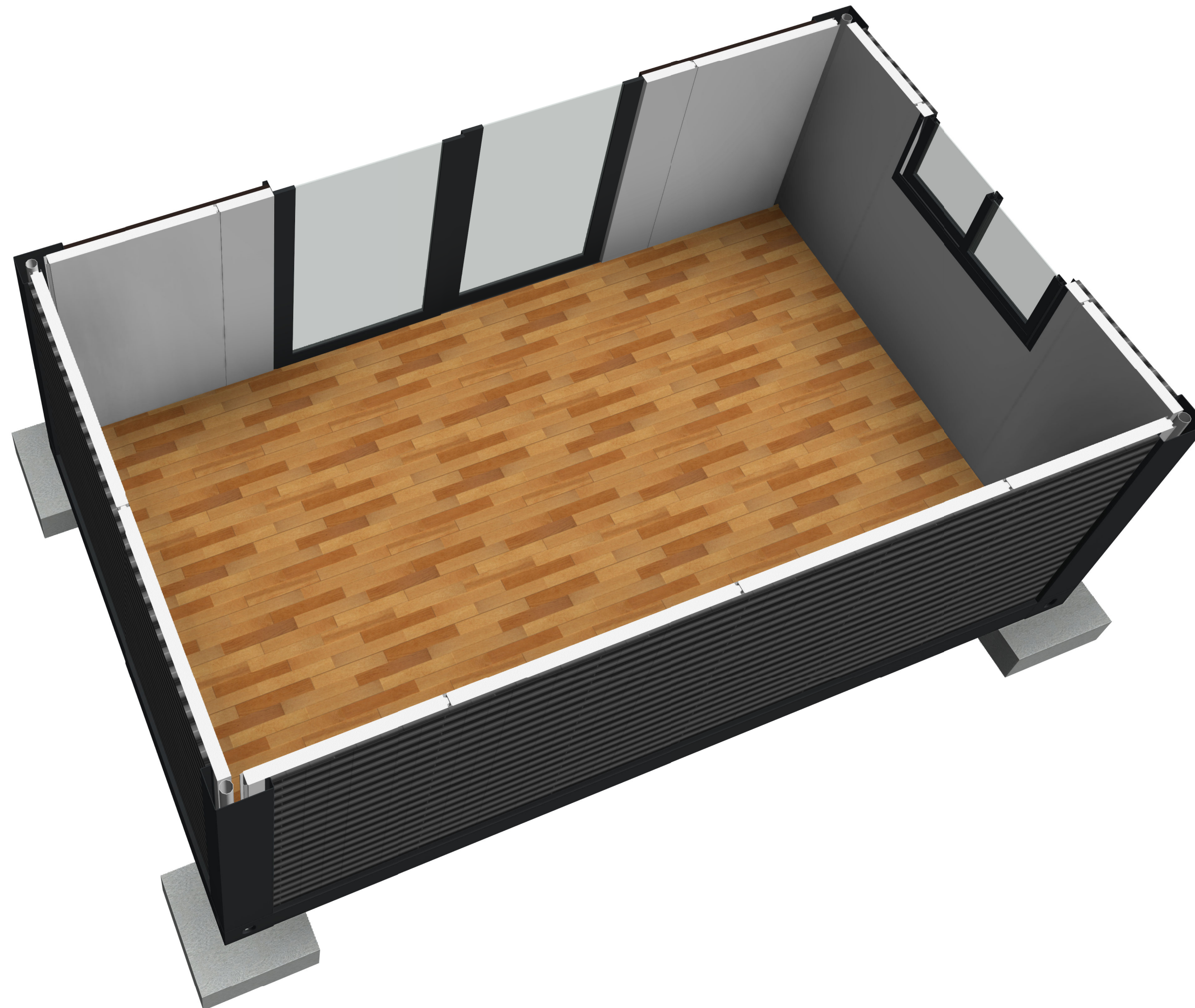

01118 002555  
PROPERTY INFORMATION FOR SALE ONLY  
HOMES WA PTY LTD OR OUR AGENTS HAVE OBTAINED BEFORE ANY  
USE OR REPRODUCTION OF THE DRAWING.



HOMES WA

CG HOMES WA PTY LTD

This drawing is valid only after being stamped and  
released by the RAO

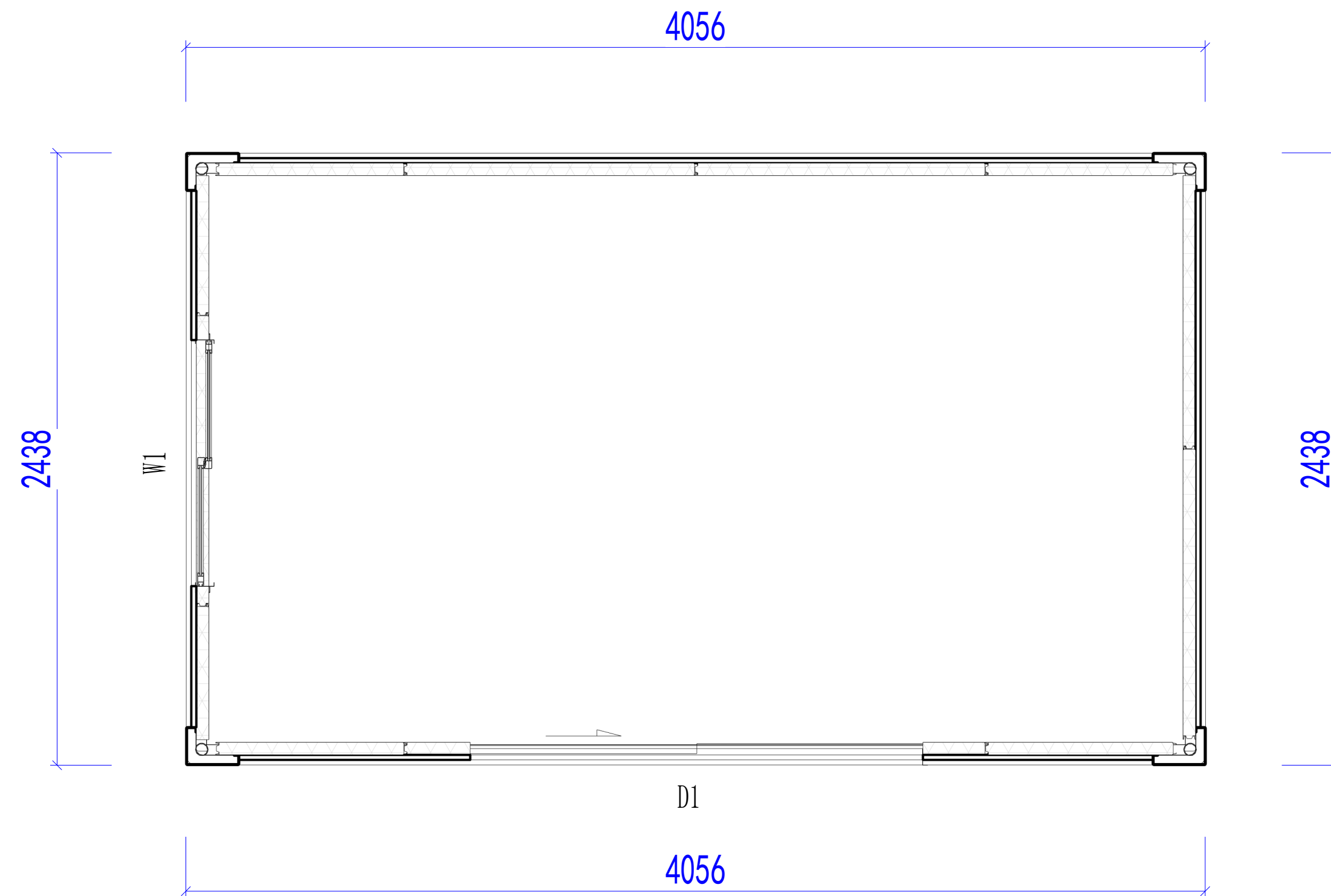

## Layout Plan







Australian standard air switch

Australian standard wire

Australian standard  
outside plug

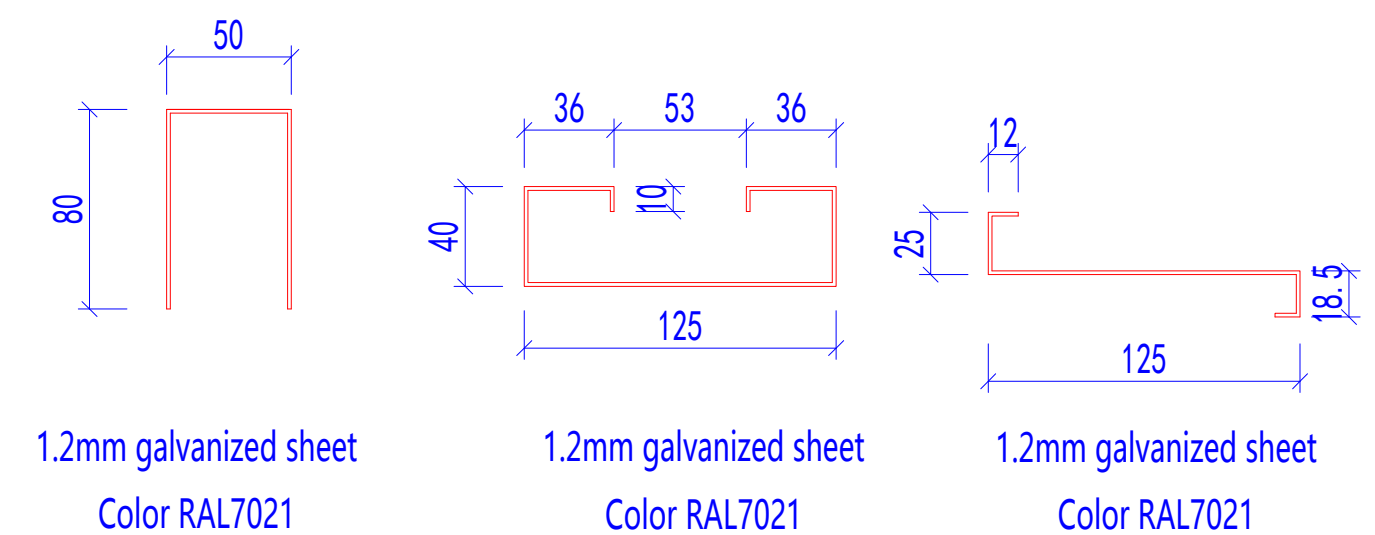
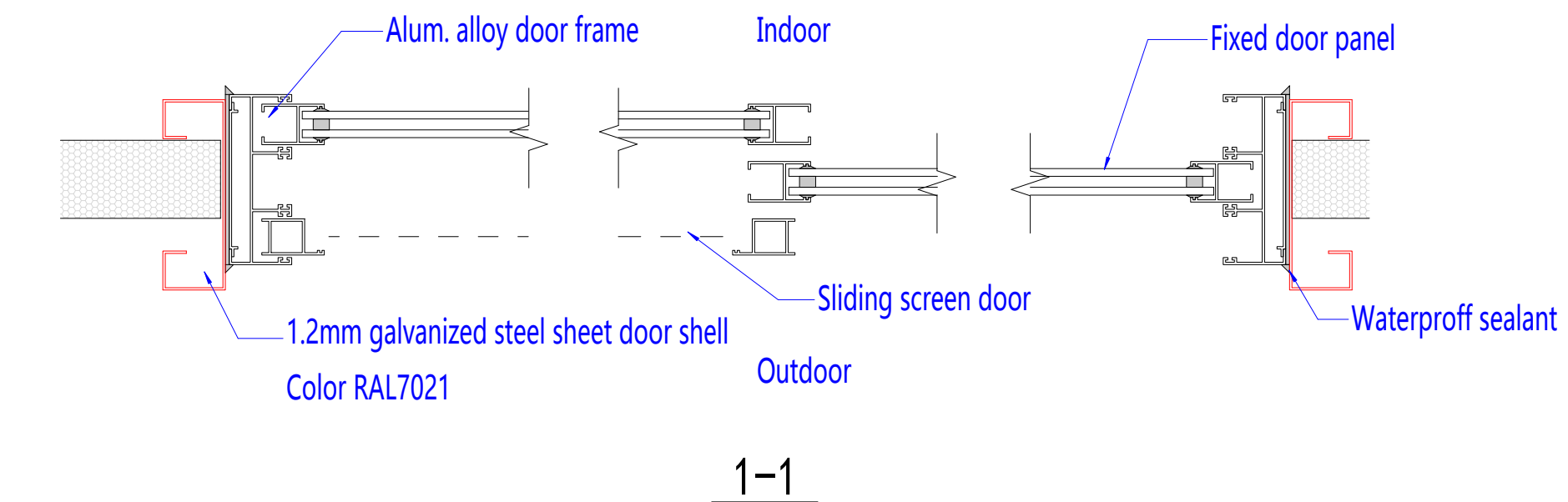

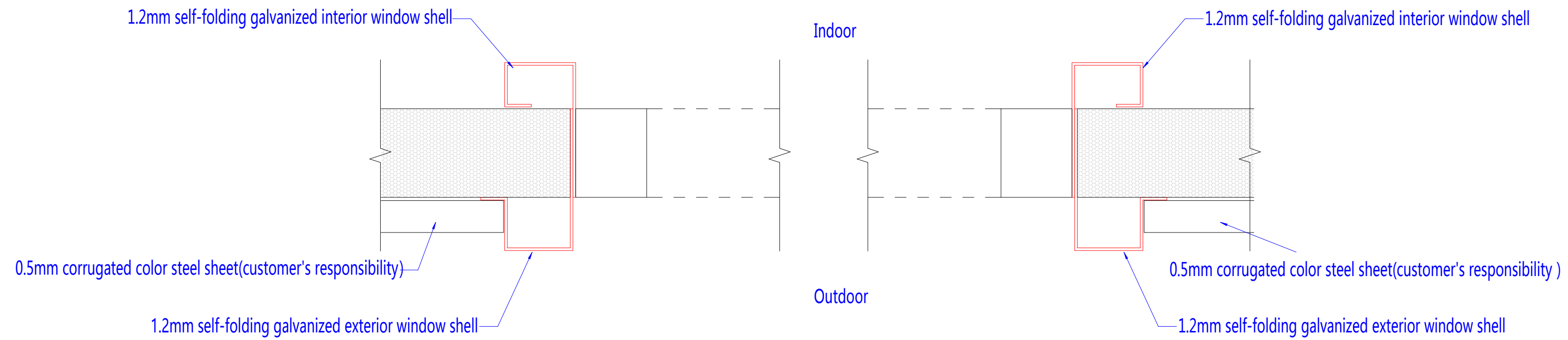

## Flashing for Window