

10 cubic-yard dumpster
Fill restrictions to follow 18-ton limit.

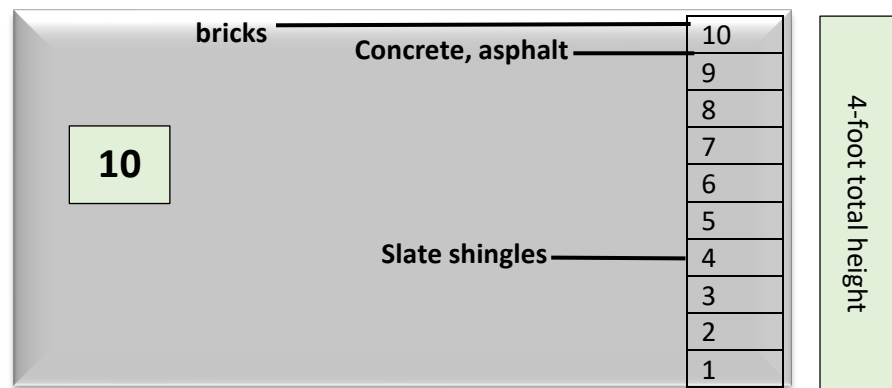

12-foot total length (and 6 feet wide total)



**Key Trucking and
Roll-off Services
2023**

20 cubic-yard dumpster
Fill restrictions to follow 18-ton limit.

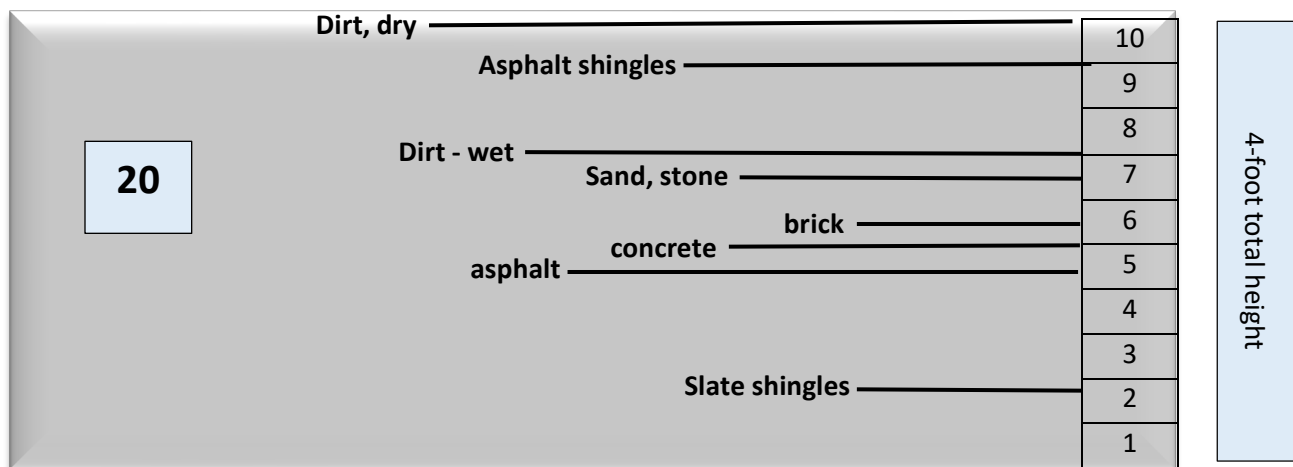

22-foot total length (and 8 feet wide total)

Debris / material	Tons per cubic yard	Equals total cu yds for 18 ton	Fill line limit – 10 yd	Fill line limit – 20 yd
Slate Shingles	5	3.6	3-4	.18
Asphalt	2	9	9	.45
Concrete	2	9	9	.5
Bricks	1.8	10	full	.56
Sand – wet	1.6	11.3	The rest of the debris will fill the dumpster without going over 18 tons.	.64
Sand-dry	1.4	12.9		.64
Stone	1.4	12.9		.64
Dirt - wet	1.4	12.9		.7
Asphalt Shingles	1.3	13.8		.9
Dirt – dry	1	18		full
Tree Stumps	.7	25.7		Rest will fill without going over 18 ton.
Drywall	.4	45		
Mulch	.4	45		
Const. Lumber	.5	35		
Yard Waste (no dirt)	.4	45		
Household trash	.3	51.4		

**The numbers on side of dumpster drawing represent tenths in debris volume, not necessarily the actual line that debris will fill to reach 18- ton limit. This is meant to assist.*

**Key Trucking reserves the right to put limits as it seems fit to avoid illegal weights, vehicle strain, and any unsafe practices which may cause risk of injury to employees or otherwise.*

**Any fines resulting in a container exceeding legal weight will be passed onto the customer.
Customer is not permitted to move the dumpster once it is delivered in place including moving by hand, by vehicle, by machinery, or by any other means.