

# HALO



## Installation instructions for HALO handtowel dispenser

### Box Contents:

- 1 Dispenser
- 1 Opening Key
- 4 Fitting Screws and Plugs

### Tools Required:

- Drill
- Screwdriver

1



Open the unit with the key provided.

2



Mark out the holes for fixings.  
Please see the pre-installed  
spirit level to aid installation.



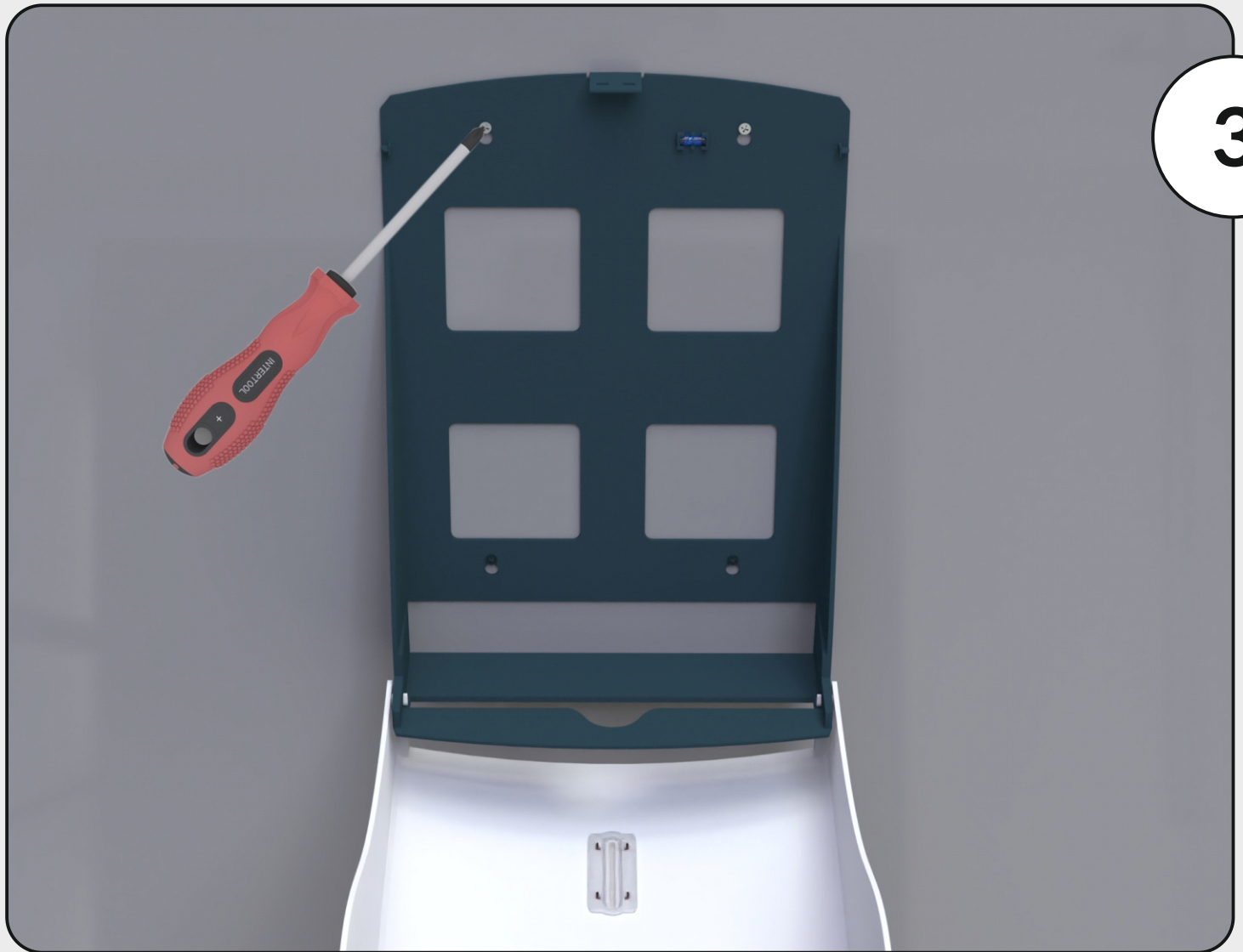

Drill the marked out holes to the size of the fixings provided then use a screwdriver to fix the unit to the wall. The unit should be hand tight to the wall.

4



Add handtowel paper and close the unit.  
The unit is now operational.