

All area below the Flood Line (481.9 m.) as determined by the Water Security Agency, is classified as Potential flood hazard/flood prone area

Datum: NAD1983 CSRS UTM Zone13N.  
Disclaimer: This map is for illustrative purposes only.

0 250 500 Meters

### ZONING DISTRICT MAP

This is the Zoning District Map  
Referred to in Bylaw No. \_\_\_\_\_  
Adopted by the Resort Village of Pasqua Lake

\_\_\_\_\_  
Mayor



\_\_\_\_\_  
Administrator

Approved on the \_\_\_\_ Day of \_\_\_\_\_, 2025

# RESORT VILLAGE OF PASQUA LAKE

SASKATCHEWAN

#### Zoning Districts

-  R1 - Residential
-  CS - Community Service
-  AG - Agricultural

 Flood Line - (481.9 m.)

 Highways

 Watercourse

 Waterbody

 Village Boundary

 Sewage Lagoon

 Lagoon 457 m. Buffer

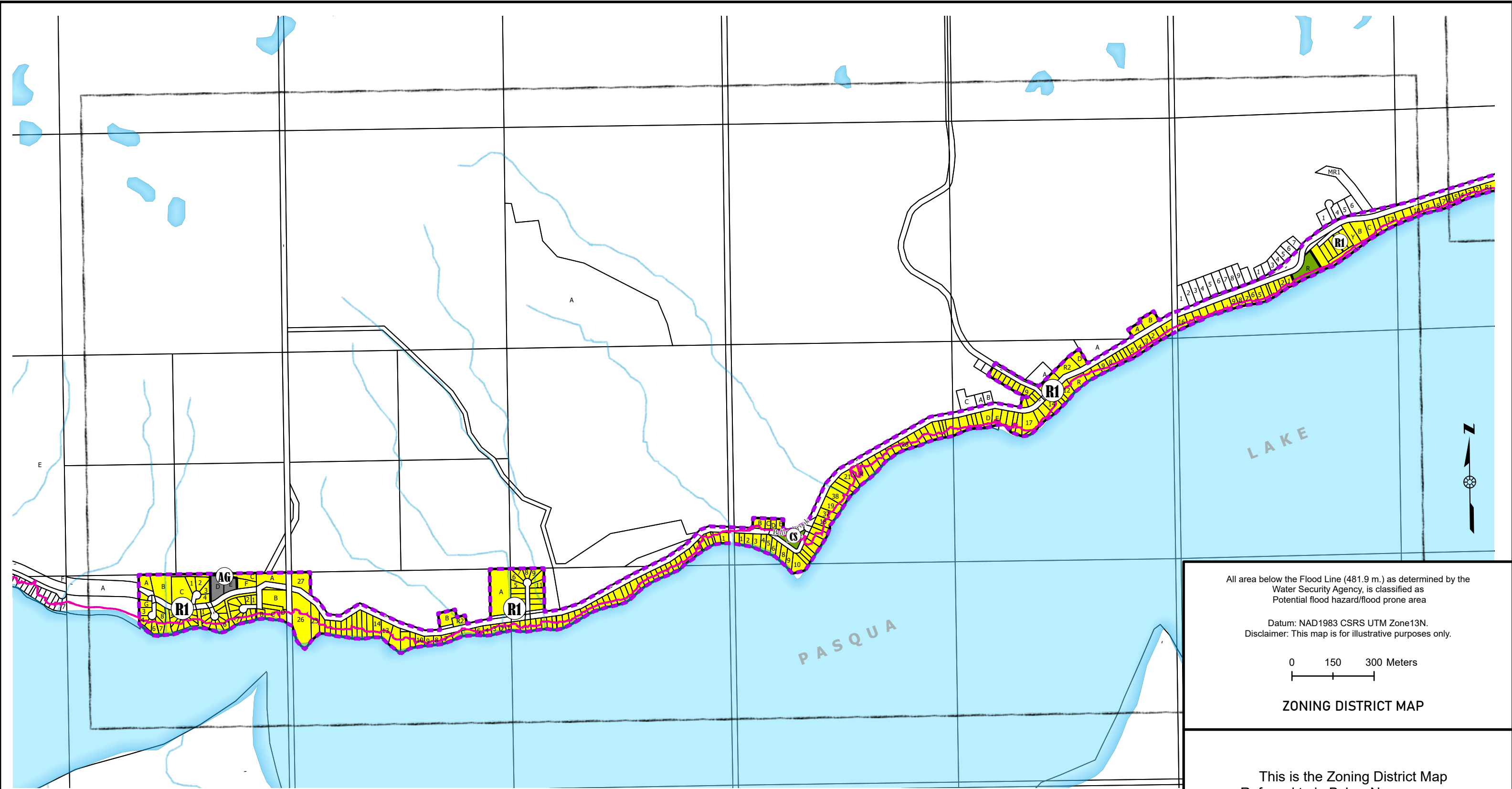

RESORT VILLAGE  
OF PASQUA LAKE

SASKATCHEWAN

- Zoning Districts
- R1 - Residential
  - CS - Community Service
  - AG - Agricultural

- Flood Line - (481.9 m.)
- Highways
- Watercourse
- Waterbody
- Village Boundary
- Sewage Lagoon
- Lagoon 457 m. Buffer

All area below the Flood Line (481.9 m.) as determined by the Water Security Agency, is classified as Potential flood hazard/flood prone area

Datum: NAD1983 CSRS UTM Zone13N.  
Disclaimer: This map is for illustrative purposes only.

0 150 300 Meters

ZONING DISTRICT MAP

This is the Zoning District Map  
Referred to in Bylaw No. \_\_\_\_\_  
Adopted by the Resort Village of Pasqua Lake

Mayor

Administrator

Approved on the \_\_\_\_ Day of \_\_\_\_\_, 2025

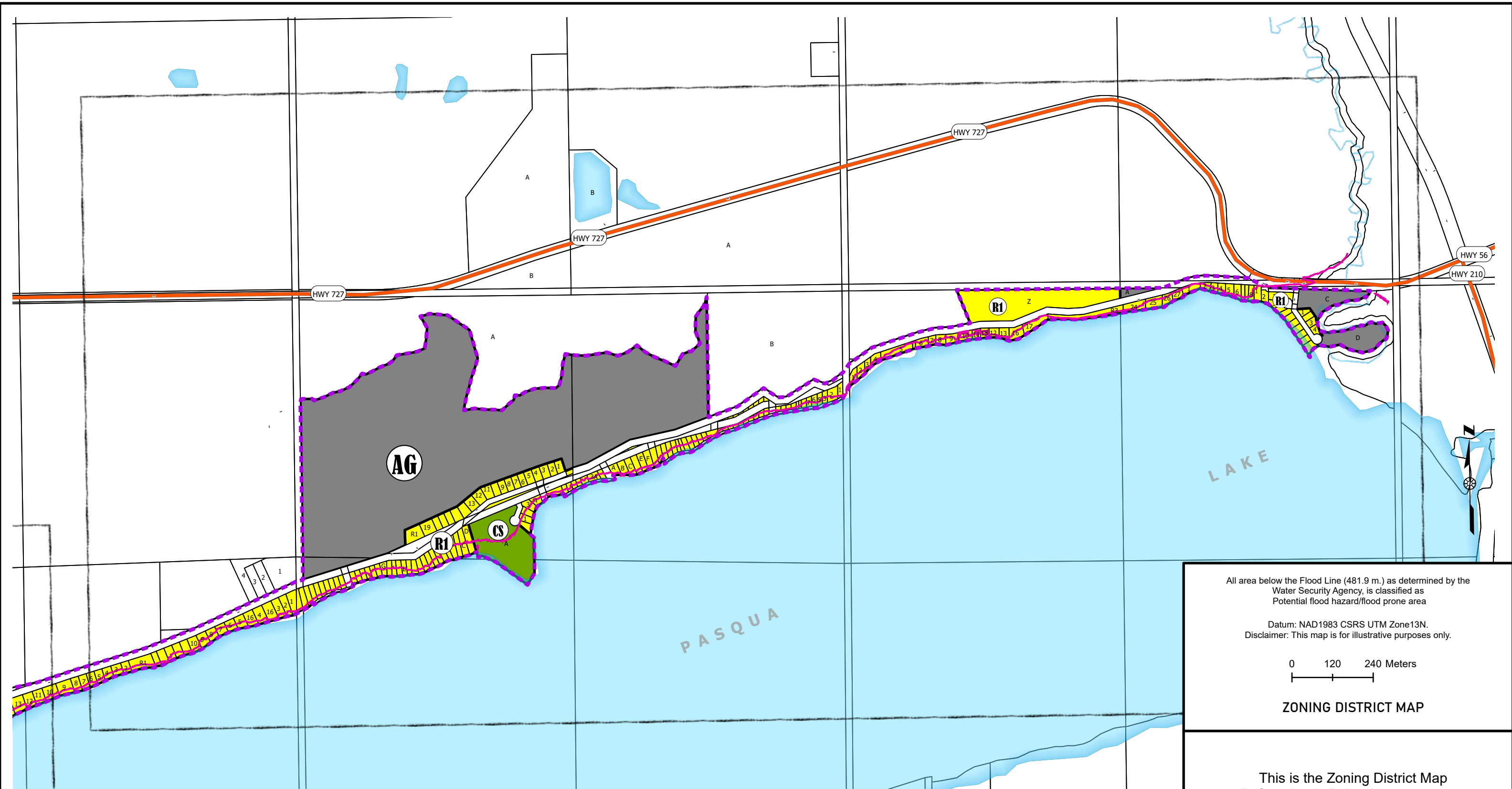

All area below the Flood Line (481.9 m.) as determined by the Water Security Agency, is classified as Potential flood hazard/flood prone area

Datum: NAD1983 CSRS UTM Zone13N.  
Disclaimer: This map is for illustrative purposes only.

0 120 240 Meters

### ZONING DISTRICT MAP

This is the Zoning District Map  
Referred to in Bylaw No. \_\_\_\_\_  
Adopted by the Resort Village of Pasqua Lake

\_\_\_\_\_  
Mayor

\_\_\_\_\_  
Administrator

Approved on the \_\_\_\_ Day of \_\_\_\_\_, 2025

# RESORT VILLAGE OF PASQUA LAKE

SASKATCHEWAN

### Zoning Districts

- R1 - Residential
- CS - Community Service
- AG - Agricultural

- Flood Line - (481.9 m.)
- Highways
- Watercourse
- Waterbody
- Village Boundary
- Sewage Lagoon
- Lagoon 457 m. Buffer



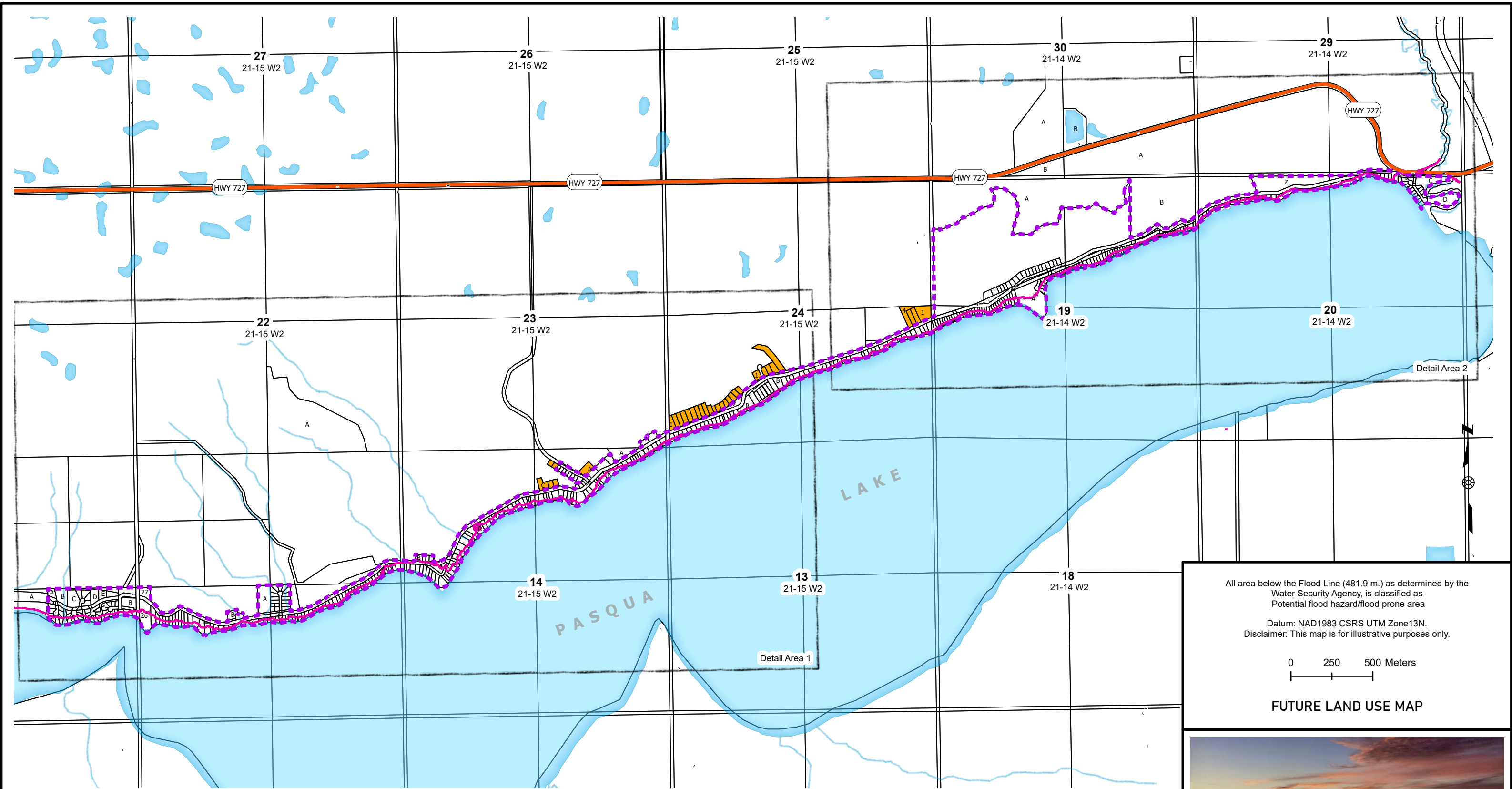

All area below the Flood Line (481.9 m.) as determined by the Water Security Agency, is classified as Potential flood hazard/flood prone area

Datum: NAD1983 CSRS UTM Zone13N.  
Disclaimer: This map is for illustrative purposes only.

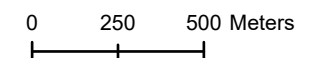







FUTURE LAND USE MAP

# RESORT VILLAGE OF PASQUA LAKE

SASKATCHEWAN

Future Land Use  
 Future Residential

-  Flood Line - (481.9 m.)
-  Highways
-  Watercourse
-  Waterbody
-  Village Boundary
-  Sewage Lagoon
-  Lagoon 457 m. Buffer

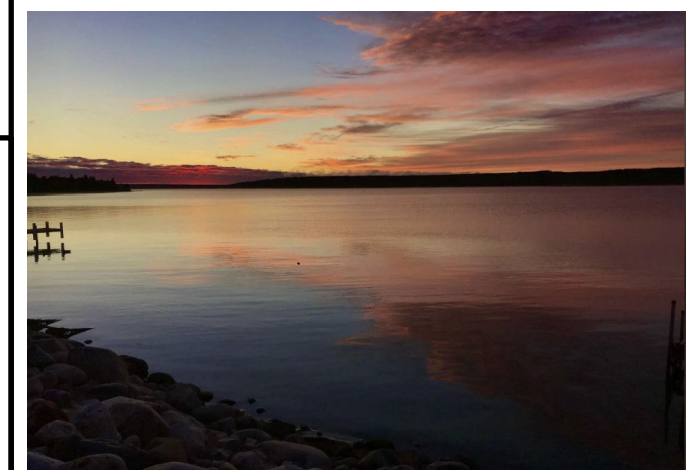

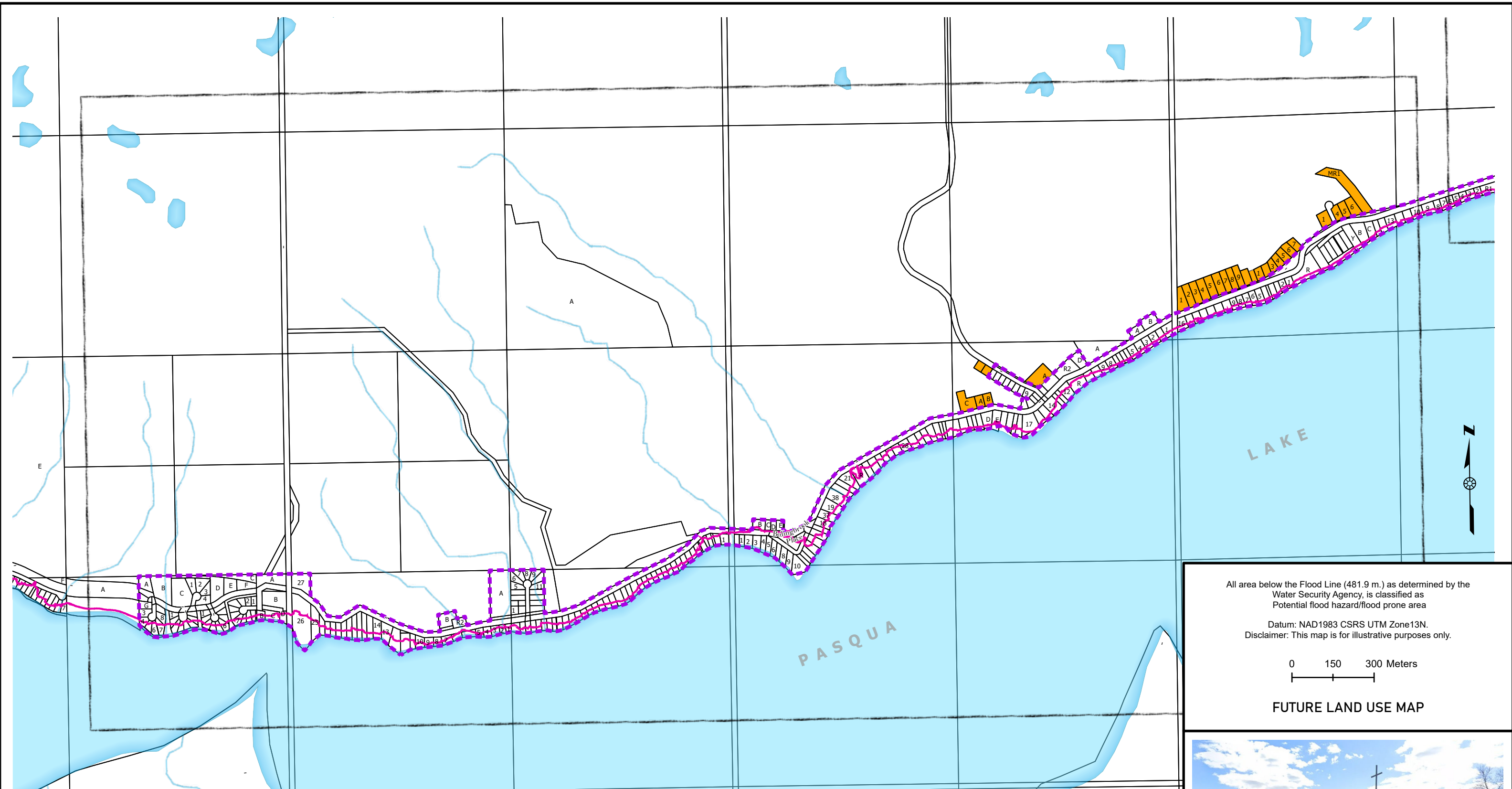

All area below the Flood Line (481.9 m.) as determined by the Water Security Agency, is classified as Potential flood hazard/flood prone area

Datum: NAD1983 CSRS UTM Zone13N.  
Disclaimer: This map is for illustrative purposes only.

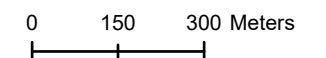

FUTURE LAND USE MAP

# RESORT VILLAGE OF PASQUA LAKE

SASKATCHEWAN

Future Land Use  
Future Residential

- Flood Line - (481.9 m.)
- Highways
- Watercourse
- Waterbody
- Village Boundary
- Sewage Lagoon
- Lagoon 457 m. Buffer





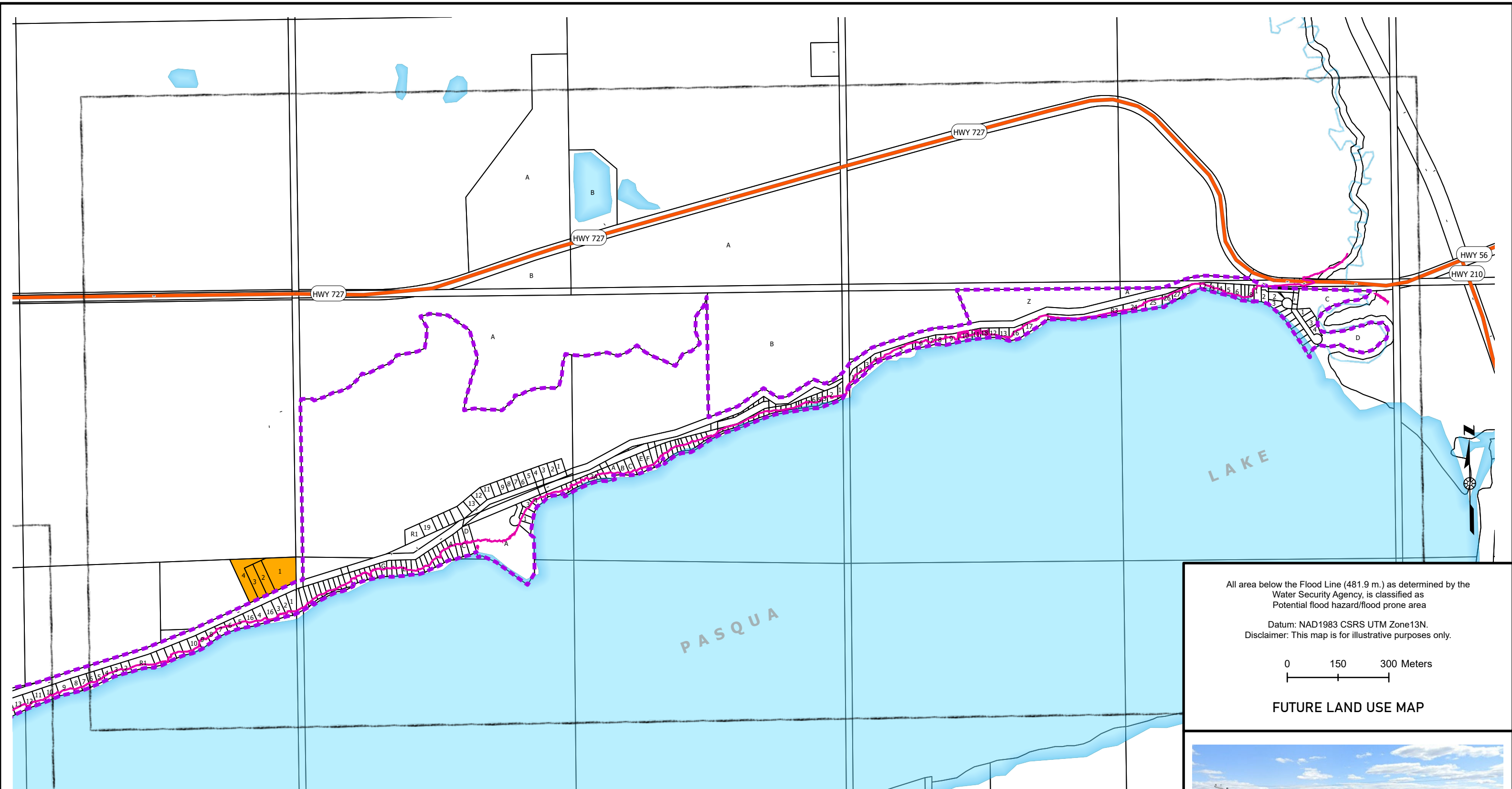

All area below the Flood Line (481.9 m.) as determined by the Water Security Agency, is classified as Potential flood hazard/flood prone area

Datum: NAD1983 CSRS UTM Zone13N.  
Disclaimer: This map is for illustrative purposes only.

0 150 300 Meters

FUTURE LAND USE MAP

# RESORT VILLAGE OF PASQUA LAKE

SASKATCHEWAN

Future Land Use  
Future Residential

Flood Line - (481.9 m.)  
Highways  
Watercourse  
Waterbody  
Village Boundary  
Sewage Lagoon  
Lagoon 457 m. Buffer

