

BOUNDARY SURVEY: This survey is a boundary survey of the property described in the plat and is not a subdivision survey. The plat is not to be used for the purpose of subdividing the property into lots or blocks.

COMMON PROPERTY: The common property is the area shown on the plat and is to be used for the purpose of subdividing the property into lots or blocks.

NOTES: The plat is a subdivision of the property described in the plat and is not a boundary survey. The plat is not to be used for the purpose of subdividing the property into lots or blocks.

LEGEND: The legend is used to identify the different types of areas shown on the plat.

CONSTRUCTION NOTES: The construction notes are used to describe the construction of the property shown on the plat.

PERMITS: The permits are used to describe the permits required for the construction of the property shown on the plat.

APPROVED: The approved signature and seal of the surveyor are shown here.

DATE: The date of the survey is shown here.

Lot No.	Area (Ac.)	Area (Sq. Ft.)
1	0.05	3,468
2	0.05	3,468
3	0.05	3,468
4	0.05	3,468
5	0.05	3,468
6	0.05	3,468
7	0.05	3,468
8	0.05	3,468
9	0.05	3,468
10	0.05	3,468
11	0.05	3,468
12	0.05	3,468
13	0.05	3,468
14	0.05	3,468
15	0.05	3,468
16	0.05	3,468
17	0.05	3,468
18	0.05	3,468
19	0.05	3,468
20	0.05	3,468
21	0.05	3,468
22	0.05	3,468
23	0.05	3,468
24	0.05	3,468
25	0.05	3,468
26	0.05	3,468
27	0.05	3,468
28	0.05	3,468
29	0.05	3,468
30	0.05	3,468
31	0.05	3,468
32	0.05	3,468
33	0.05	3,468
34	0.05	3,468
35	0.05	3,468

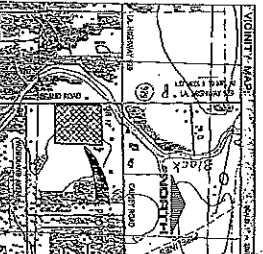
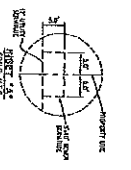

1040707

GENERAL NOTES: The general notes are used to describe the general conditions of the property shown on the plat.

BOUNDARY SURVEY: This survey is a boundary survey of the property described in the plat and is not a subdivision survey.

BOUNDARY SURVEY: This survey is a boundary survey of the property described in the plat and is not a subdivision survey.

BOUNDARY SURVEY: This survey is a boundary survey of the property described in the plat and is not a subdivision survey.

BOUNDARY SURVEY: This survey is a boundary survey of the property described in the plat and is not a subdivision survey.

BOUNDARY SURVEY: This survey is a boundary survey of the property described in the plat and is not a subdivision survey.

BOUNDARY SURVEY: This survey is a boundary survey of the property described in the plat and is not a subdivision survey.

BOUNDARY SURVEY: This survey is a boundary survey of the property described in the plat and is not a subdivision survey.

BOUNDARY SURVEY: This survey is a boundary survey of the property described in the plat and is not a subdivision survey.

BOUNDARY SURVEY: This survey is a boundary survey of the property described in the plat and is not a subdivision survey.

BOUNDARY SURVEY: This survey is a boundary survey of the property described in the plat and is not a subdivision survey.

BOUNDARY SURVEY: This survey is a boundary survey of the property described in the plat and is not a subdivision survey.

BOUNDARY SURVEY: This survey is a boundary survey of the property described in the plat and is not a subdivision survey.

BOUNDARY SURVEY: This survey is a boundary survey of the property described in the plat and is not a subdivision survey.