

Having the best is just
the beginning...

VB Motorsports



Installation of 2WD Kit for Porsche 993 / 993TT - 10/10/05

This kit is designed using factory Porsche parts to convert the shifter assembly from a Porsche 993 AWD system to a rear wheel drive. Additional instructions are included to enable the ABS function on the front wheels.

- 1) Install the forward shift fork coupling ball and bracket (964 424 055 00) located where the front differential mount was bolted previously. Here is a view from the tunnel area towards the front of the car

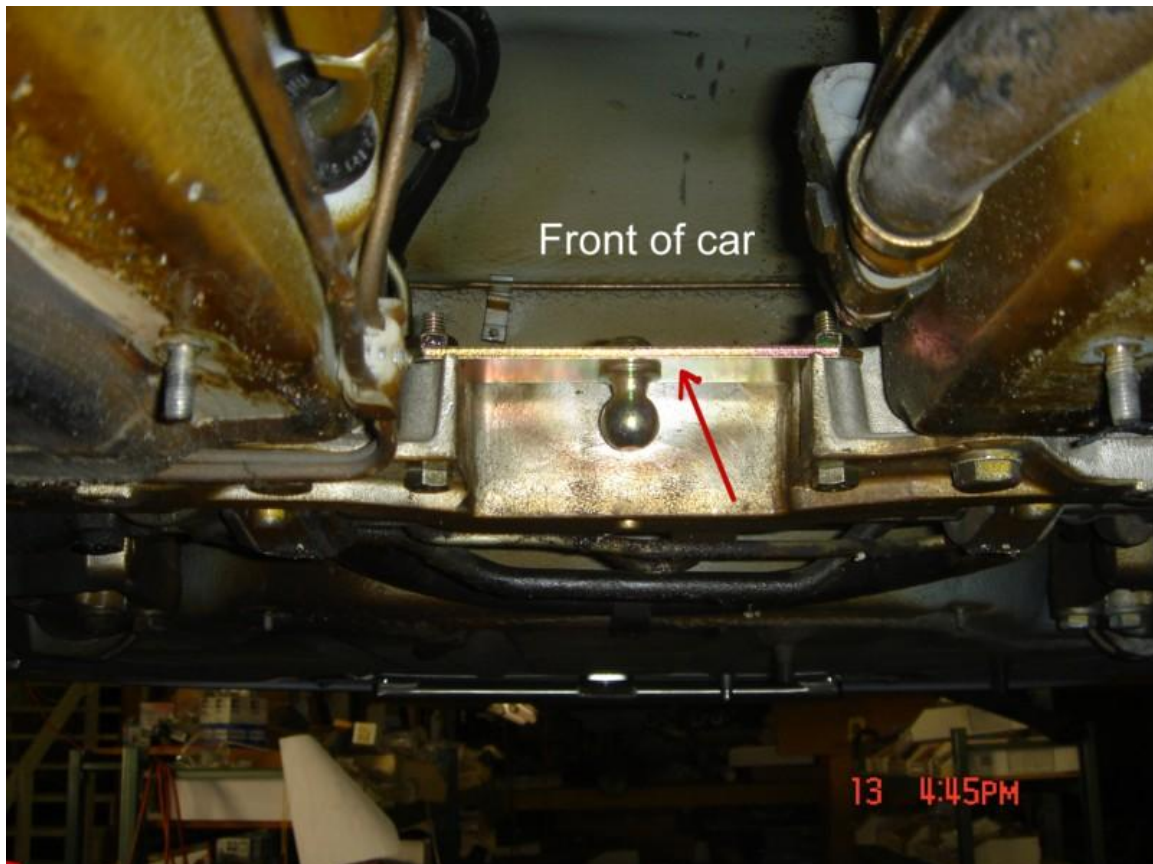

- 2) Next is the modification and the installation of the shifter box. This is the most important part of the entire modification. Here is a picture of the shifter box as taken from the top view.



You will need to cut through just the top part of the box. The part between the red lines on the top will be discarded. Now locate where this will go inside the tunnel. This will be where the shifter comes through the car.



You will notice a nice lip at the front and rear of this piece. This is where the shifter box fits and will be welded in place. Here are two pictures looking from the rear towards the front of the car, and one looking up from the bottom.



Please note the orientation of the box. There is an offset to the opening in it. This **MUST** be installed in this orientation. Once in place, weld the box to the tunnel. This will

require removing the paint from the box and the paint from the inner tunnel area to insure proper welds. Once welded in place, use some paint on any exposed bare metal surfaces.

- 3) Once the box is in place, install the white plastic tabs (964 424 028 00) on each side.



Notice the orientation of the plastic piece. The opening for the shift tube should be towards the TOP of the box.

- 4) Next install the shift tube (964 424 131 02). Grease it up first and slide it in. You should install one of the retaining clips (999 178 007 02) on one first before sliding it in place. Once in place, install the retaining ring on the other side to lock the tube into place.

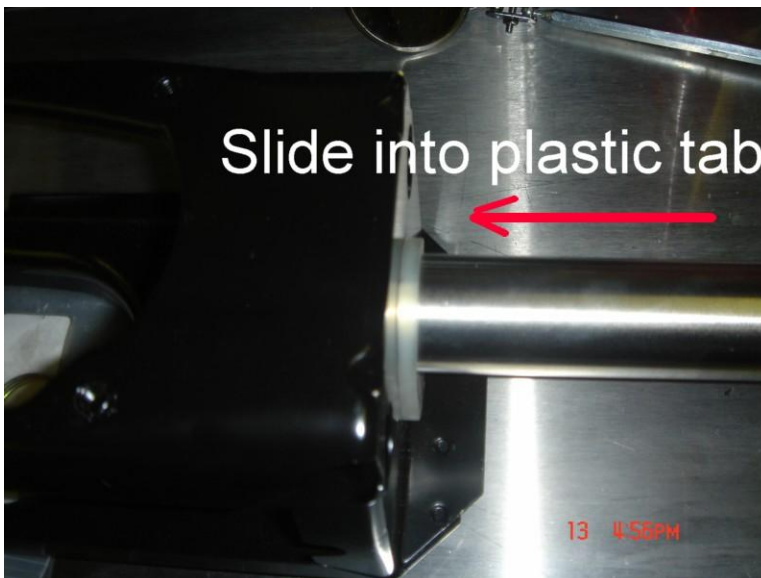



- 5) Install the front tube (964 424 011 31) to the front ball installed in step one. A c-clamp can be used to make this easier. Be sure to use some grease before assembly.



- 6) Install shift rod original shift rod (or optional 964 424 020 35 shown) onto the transaxle. Make sure to use the shoulder bolt.

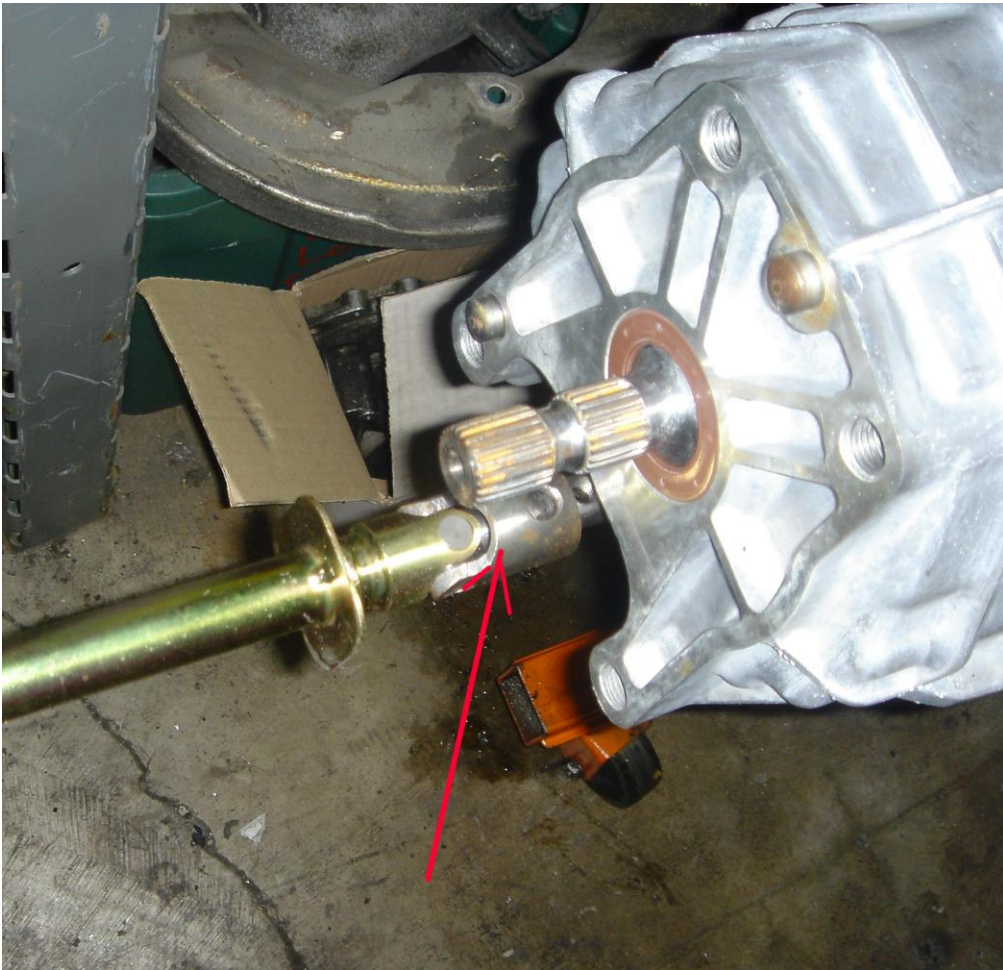

- 7) Install the shifter (964 424 015 08) into the shifter box and onto the shifter tube using the original assembly removed from the torque tube. An optional step is to remove 1" from the top of the shifter. This will allow the shifter be a little shorter in the passenger compartment. It is a recommended step.
- 8) Attach the rods to the shifter in the same fashion as was removed from the original assembly. Overall, it will look like this (picture is just shown off car for clarity)

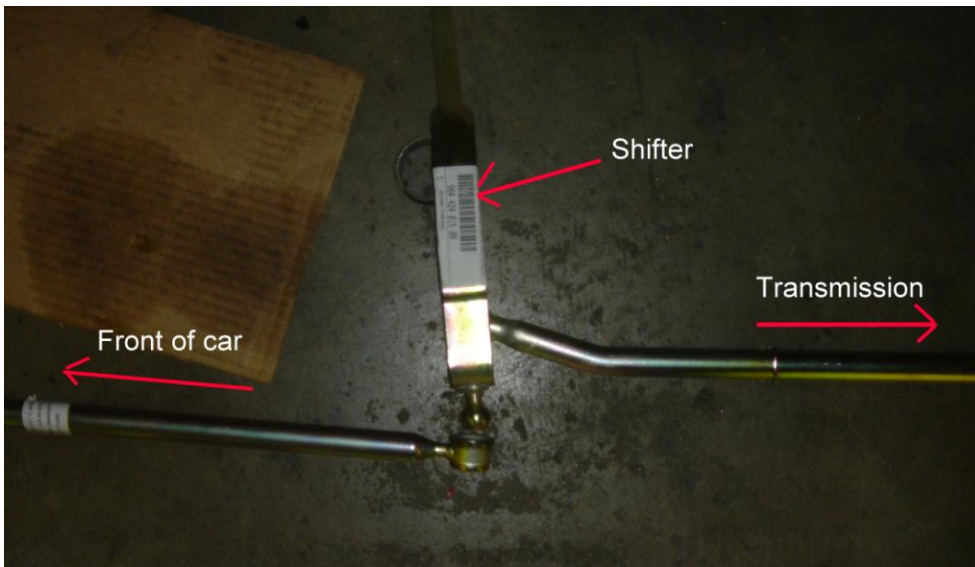

- 9) An optional step is to remove the viscous coupler and front drive shaft from the transaxle. This step is not necessary, but will save a little weight and take some friction out of the transmission. If this is done, some welding on the nose cone of the transaxle will be required to block any fluid from leaking out of the transaxle.
- 10) Installation of the ABS speed sensors into the front hubs. When the front drive axles are removed the speed sensor wheels (993 341 115 01) must be installed. These are just held in with the long bolt (900 082 123 09) and a nut (999 084 634 09). Here is a diagram that shows the parts and how they fit into the uprights.

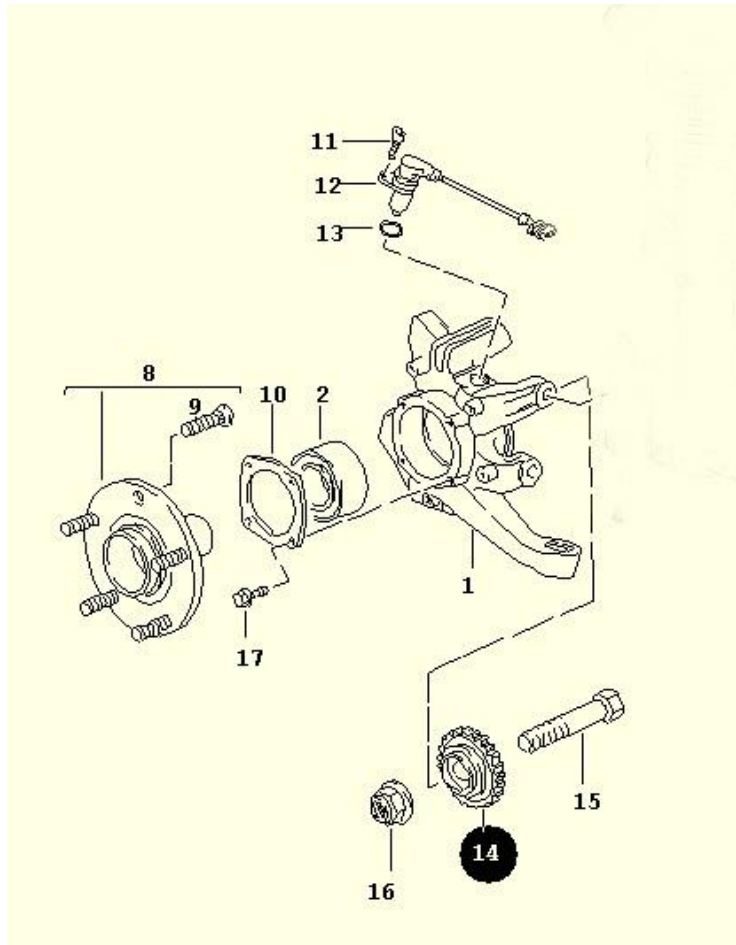

Appendix A

Attached is an exploded diagram of the shifter assembly.

