

# Soils Map

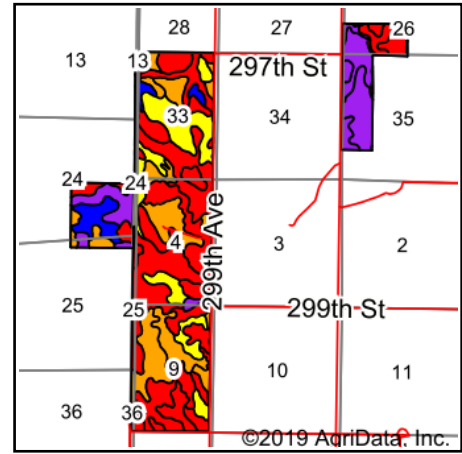

State: **South Dakota**  
 County: **Tripp**  
 Location: **3-95N-79W**  
 Township: **Beaver Creek**  
 Acres: **1548**  
 Date: **8/12/2019**

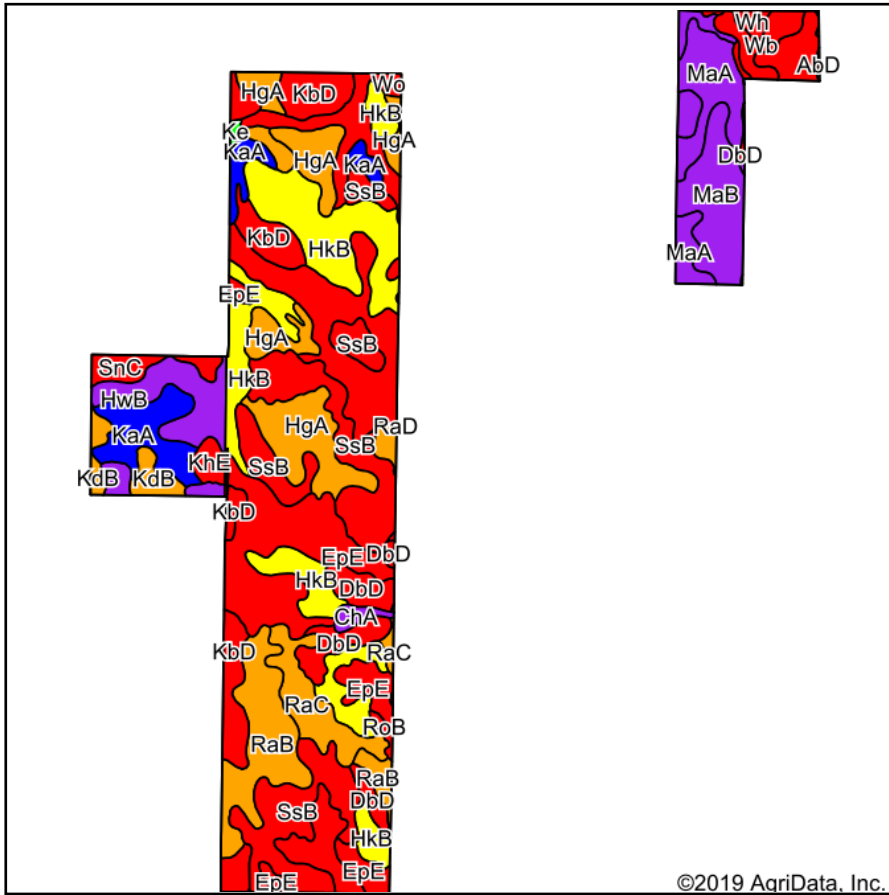

Soils data provided by USDA and NRCS.

Area Symbol: SD121, Soil Area Version: 19  
 Area Symbol: SD123, Soil Area Version: 19

Code	Soil Description	Acres	Percent of field	PI Legend	Non-Irr Class *c	Irr Class *c	Productivity Index	Alfalfa hay	Alfalfa hay Irrigated	Barley	Barley Irrigated	Bromegrass alfalfa	Cool season grasses	Corn	Corn Irrigated	Corn silage Irrigated	Grain sorghum
EpE	Epping soils, 12 to 25 percent slopes	290.73	18.8%		VIIe		14										
HkB	Huggins-Kadoka silt loams, 3 to 9 percent slopes	205.36	13.3%		IVe		63	0.9									
SsB	Shena silt loam, 0 to 9 percent slopes	199.27	12.9%		VIIs		17										
HgA	Huggins silt loam, 0 to 3 percent slopes	121.81	7.9%		IIIIs		71	1.1						31			
RaB	Ree loam, 3 to 6 percent slopes	96.13	6.2%		IIe	IIe	79										
KbD	Kadoka-Epping silt loams, 6 to 12 percent slopes	87.53	5.7%		IVe		44	1					1.7				
MaB	Manter fine sandy loam, 3 to 9 percent slopes	81.22	5.2%		IIIe	IIIe	52		4.5	30	60				120	15	

MaA	Manter fine sandy loam, 0 to 3 percent slopes	63.50	4.1%		Ille	Ille	59		5.5	35	75				130	18
RaC	Ree loam, 6 to 9 percent slopes	56.16	3.6%		Ille	Ile	72									
DbD	Dix soils, 9 to 18 percent slopes	54.51	3.5%		Vis		11									
HwB	Huggins-Kadoka silt loams, 2 to 9 percent slopes	48.74	3.1%		IVe		60	0.9								
KaA	Kadoka silt loam, 0 to 2 percent slopes	48.60	3.1%		Ils	Is	83									
MfE	Manter-Anselmo fine sandy loams, 15 to 30 percent slopes	30.15	1.9%		Vle	Vle	19									
Wb	Wann fine sandy loam	22.62	1.5%		Illw		50	3.5				5.6		60		
KdB	Kadoka-Huggins silt loams, 2 to 5 percent slopes	21.87	1.4%		Ile		80	1.3					2.2	33		
DgB	Doger loamy fine sand, 0 to 6 percent slopes	21.63	1.4%		IVe		32	1.5						25		
KaA	Kadoka silt loam, 0 to 3 percent slopes	21.62	1.4%		Ilc		87	1.4					2.3	35		
SnC	Shena silt loam, 0 to 9 percent slopes	19.30	1.2%		Vis		34									
KbC	Kadoka-Epping silt loams, 3 to 9 percent slopes	11.61	0.8%		Ille		58									
KhE	Keota-Epping silt loams, 9 to 21 percent slopes	10.60	0.7%		Vle		18									
AhC	Anselmo-Holt fine sandy loams, 3 to 9 percent slopes	9.79	0.6%		Ille	Ille	50	2.3	4.5					41	125	
ChA	Chappell fine sandy loam, 0 to 3 percent slopes	7.67	0.5%		Ille	Ille	57		4						85	
Wh	Whitelake fine sandy loam	6.77	0.4%		IVe		44	1.4				2.3				
Wo	Wortman silt loam	4.62	0.3%		IVs		39	0.9								



RoB	Ronson-Longpine fine sandy loams, 0 to 6 percent slopes	3.72	0.2%		Ille	Ille	36	0.7	4			1.2		13	125		
Ke	Keya silt loam	1.90	0.1%		Ilc	I	93	2.2	5.5					50	150		
AbD	Anselmo fine sandy loam, 9 to 15 percent slopes	0.57	0.0%		Vle	Vle	40										
<b>Weighted Average</b>							<b>44.8</b>	<b>0.4</b>	<b>0.5</b>	<b>3</b>	<b>6.2</b>	<b>0.1</b>	<b>0.2</b>	<b>5</b>	<b>13.3</b>	<b>1.5</b>	

\*c: Using Capabilities Class Dominant Condition Aggregation Method  
 Soils data provided by USDA and NRCS.