

ATTENTION

This notice is to inform you of a change coming to the Mandatory Magnus Driver app. Drivers can expect to see this change in the app **EFFECTIVE MONDAY, OCTOBER 14, 2024**. This change is part of our ongoing efforts to mitigate damage and avoid claim exposure.

The key changes are as follows:

1. At **PICKUP**, the Magnus Driver app will now require a series of photos to be taken **PRIOR** to "loading" and submitting the load within the app.

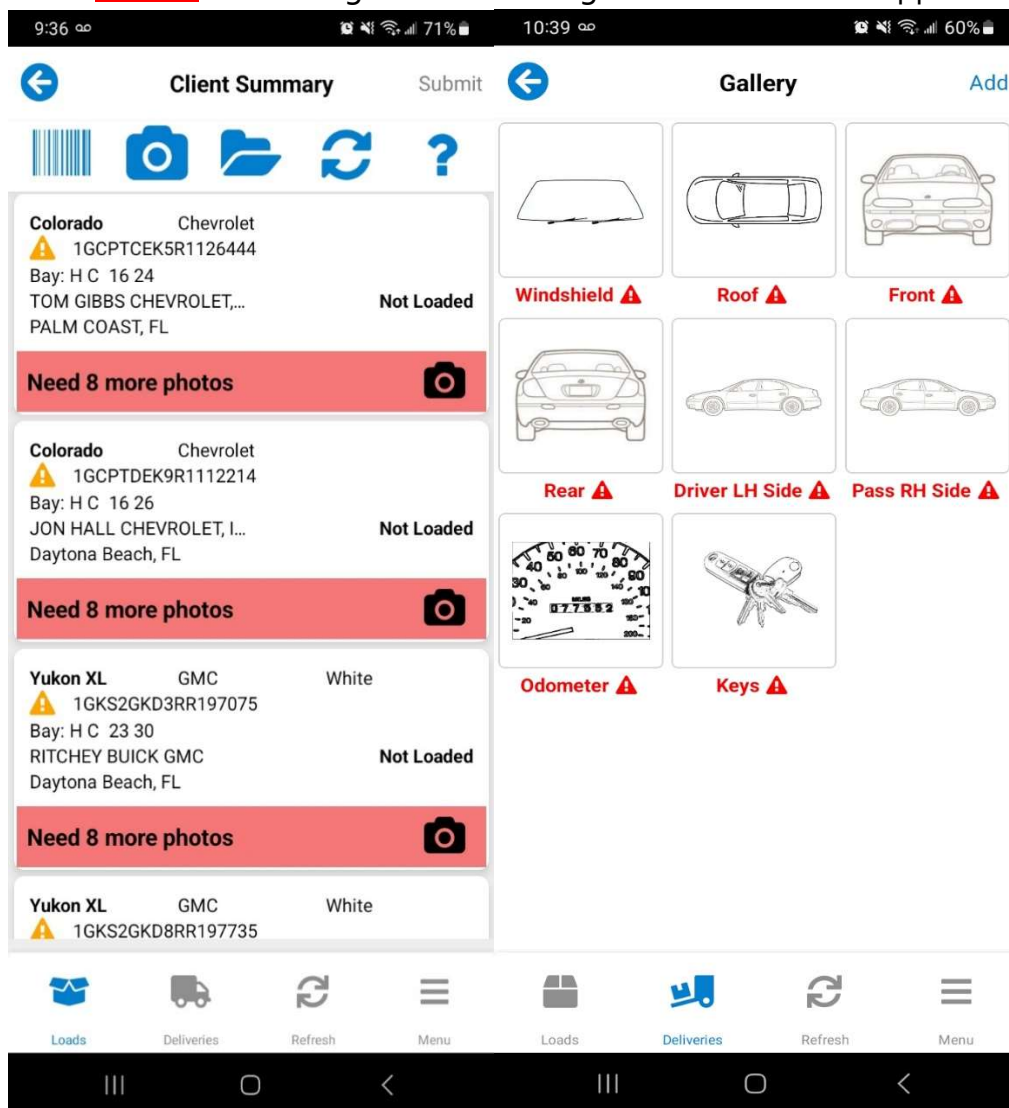

2. This step **cannot be bypassed**.
3. At **DELIVERY**, the Magnus Driver app will now require a series of photos to be taken **PRIOR** to delivering and submitting the load within the app.
4. This step **cannot be bypassed**.

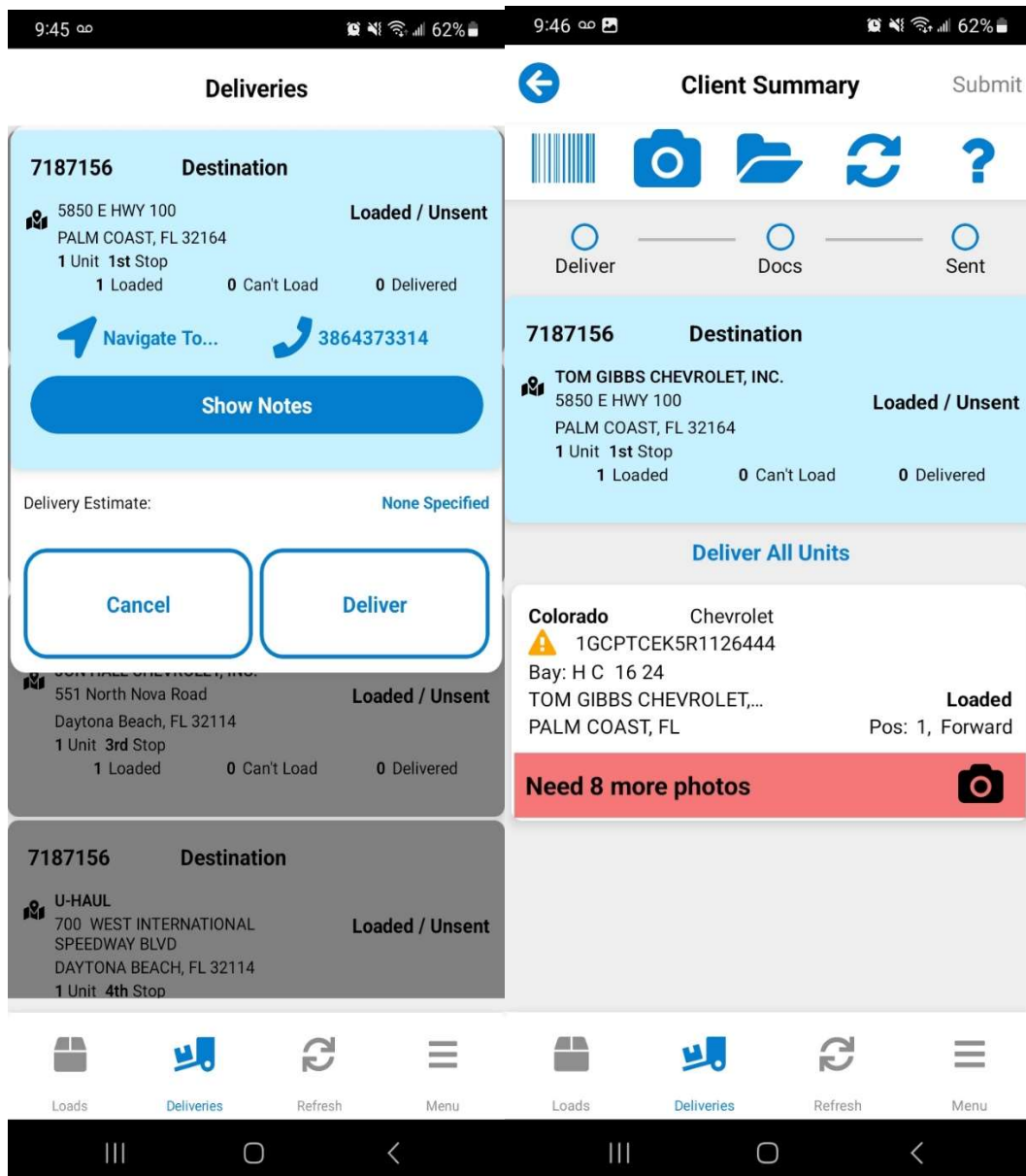

All drivers will continue to enter damage codes and take pictures of the damage at **BOTH PICKUP AND DELIVERY** in the Mandatory Magnus Driver app. This procedure will not change.

**** All drivers must take a picture of their load sheet and attach it in the Mandatory Magnus Driver app. ****

To assist with this update, our team will be available to field any questions and conduct onsite visits as necessary to streamline the process. Our goal is to capture additional data for all OEM vehicles handled and the conditions in which vehicles are received and delivered.

ACTION REQUIRED:

This update will be monitored for compliance. Those who fail to comply will be reported to supervision for non-compliance.

As stated in your signed legal Brokerage Agreement, if a load is determined to be **NON-COMPLIANT** according to **ALL RULES and REGULATIONS** set forth by Proficient Auto Transport, you will be subject to an administrative fee and disciplinary action up to and including Permanent Revocation with Proficient Auto Transport

If there are any questions or concerns regarding this update, please do not hesitate to contact the Brokerage Claims Department. We appreciate your understanding and cooperation as we implement this update.

Proficient Brokerage Claims Department

brokerageclaims@proautotran.com

Phone: 904.772.1175

