

TOTAL Sketch by a la mode, inc.

Area Calculations Summary

Living Area		Calculation Details
First Floor	1517.64 Sq ft	$22.1 \times 17.7 = 391.17$ $0.5 \times 4 \times 4 = 8$ $0.5 \times 4 \times 4 = 8$ $5.75 \times 4 = 23$ $38.7 \times 28.1 = 1087.47$
Total Living Area (Rounded):		1518 Sq ft
Non-living Area		Calculation Details
Screened Porch	253.2 Sq ft	$21.1 \times 12 = 253.2$
Patio	226.7 Sq ft	$12 \times 17.7 = 212.4$ $1.3 \times 11 = 14.3$
Front Porch	26.8 Sq ft	$6.7 \times 4 = 26.8$

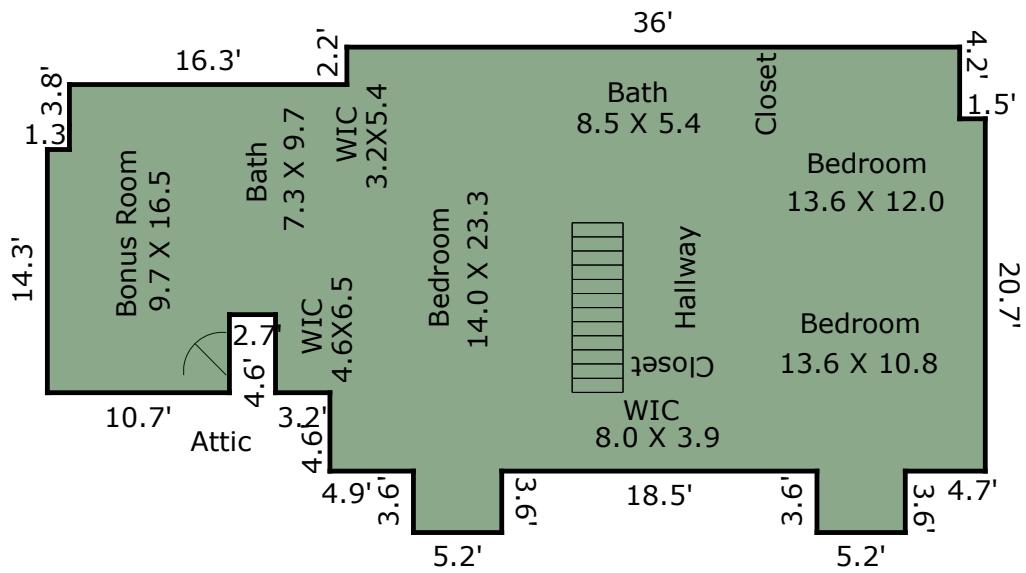

TOTAL Sketch by a la mode, inc.

Area Calculations Summary

Living Area		Calculation Details
Second Floor	1270.69 Sq ft	$5.2 \times 3.6 = 18.72$ $5.2 \times 3.6 = 18.72$ $38.5 \times 4.6 = 177.1$ $41.7 \times 4.6 = 191.82$ $10.7 \times 4.6 = 49.22$ $55.1 \times 9.7 = 534.47$ $1.8 \times 1.5 = 2.7$ $3.8 \times 16.3 = 61.94$ $6 \times 36 = 216$
Total Living Area (Rounded):	1271 Sq ft	

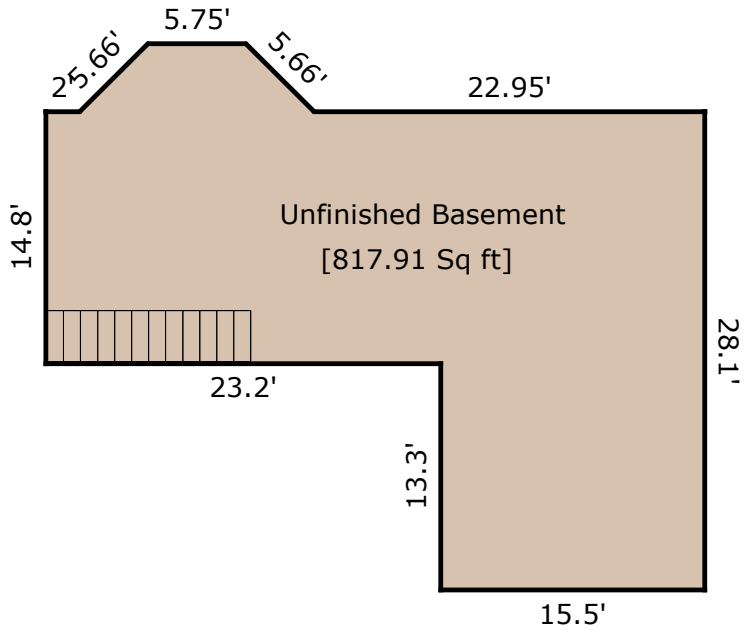

TOTAL Sketch by a la mode, inc.

Area Calculations Summary

Non-living Area

Basement	817.91 Sq ft	$0.5 \times 4 \times 4 = 8$ $0.5 \times 4 \times 4 = 8$ $5.75 \times 4 = 23$ $15.5 \times 13.3 = 206.15$ $38.7 \times 14.8 = 572.76$
----------	--------------	--