

Legend
Silt Fence
Curb, Gut
Wattle, Black Fabric
Wattle, Straw
Diversion Ditch
Dumpster
Tracking Control, Mud Mat
Tracking Control, Rock
Tracking Control, FODS
Inlet Protection, Sump
Inlet Protection, On-Grade
Inlet Protection, Area
Curb Check
Check Dam/Rock Sock
Check Dam, Straw Wattle
Conner Storage
Generator
Portable Toilet
Construction Office
Fueling Station
Concrete Washout, Eocopin
Concrete Washout, In-Ground
Outfall Protection, Temporary
Outfall Protection, Rip-Rap
Grade Differential
Road Barricade
Other
Other
11/10/19 Site fully disturbed (west of Robb Road)

Map closed 2/25/20

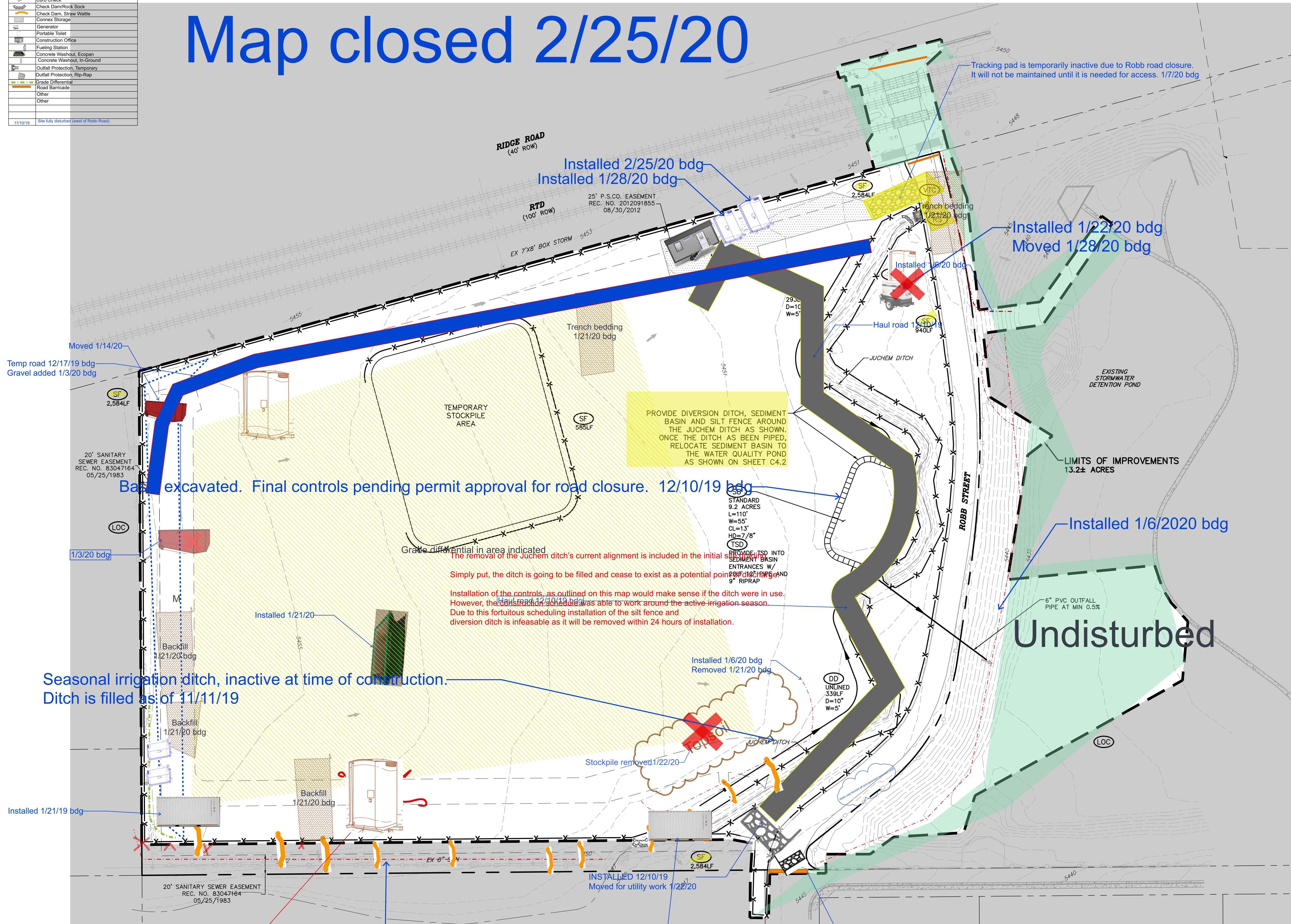

SHT. NO.		
SW-2		(RS) ROCK SOCK
SW-3		(SF) SILT FENCE
SW-4		(SCL) SEDIMENT CONTROL LOG
SW-5		(VTC) VEHICLE TRACKING CONTROL
SW-6		(CWA) CONCRETE WASHOUT AREA
SW-7		(SSA) STABILIZED STAGING AREA
SW-8, 8a		(ECB) EROSION CONTROL BLANKET
SW-9, 9a, 9b		(IP) INLET PROTECTION
SW-10		(SP) ON STREET STOCKPILE PROTECTION
		(LOC) LIMITS OF CONSTRUCTION
SW-11		(SL) SINGLE LOT
SW-12		(TSA) TEMPORARY STAGING AREA
		(SB) SEDIMENT BASIN
		AREA OUTSIDE LIMITS OF DISTURBANCE

- NOTES:**
- (SM) 1. SEED/MULCH DISTURBED AREAS WITHIN 30 DAYS ALL AREAS TO BE LEFT DORMANT FOR 60 DAYS PER THE TOWN OF ELIZABETH REQUIREMENTS.
 - (SR) 2. SURFACE ROUGHENING SHALL BE APPLIED TO ALL AREAS PRIOR TO SEEDING/MULCHING (SM) ACTIVITIES.
 - 3. CONTRACTOR SHALL PROVIDE SECURITY FENCING AROUND PROPOSED CONSTRUCTION.
 - 4. ALL SITE GRADING SHALL CONFORM TO THE RECOMMENDATIONS OF THE LATEST SOILS INVESTIGATION FOR THIS PROPERTY. NOTIFY ENGINEER IMMEDIATELY OF ANY DISCREPANCIES WITH THESE PLANS.
 - 5. TEMPORARY CUT/FILL SLOPES SHALL NOT EXCEED A STEEPNESS OF 2:1 (H:V). PERMANENT SLOPES SHALL NOT EXCEED 3:1 (H:V).
 - 6. TRASH DUMPSTER(S) SHALL BE LOCATED IN THE STAGING AREA.
 - 7. LOCATE PORT-A-POTTIES ADJACENT TO CONSTRUCTION TRAILER IN THE PROPOSED STAGING AREA. STAKE DOWN FACILITIES TO PREVENT TIPPING.

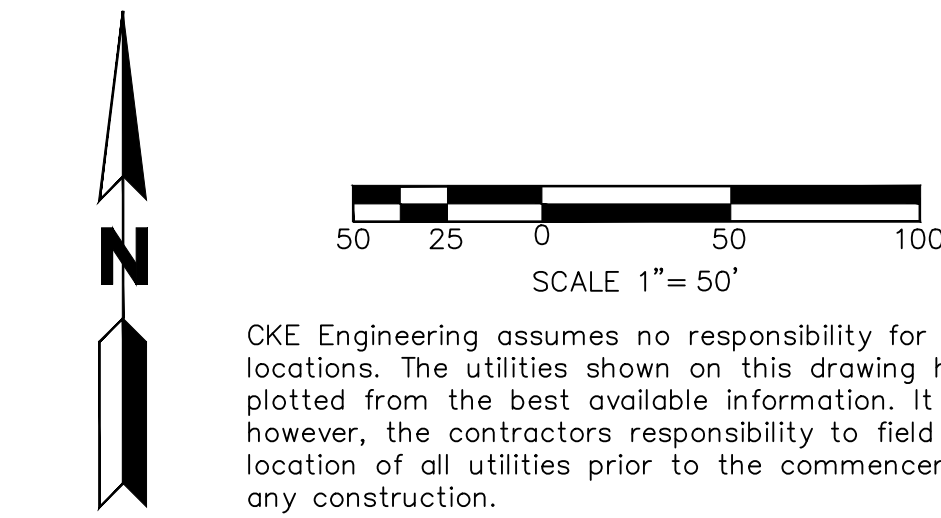

APPROVAL BLOCK:

CITY ENGINEER	DATE	2019-0059 JOB NUMBER
---------------	------	-------------------------

REVIEW IS FOR GENERAL COMPLIANCE WITH THE CITY OF ARVADA "ENGINEERING CODE OF STANDARDS AND SPECIFICATIONS FOR THE DESIGN AND CONSTRUCTION OF PUBLIC IMPROVEMENTS", LATEST EDITION. SOLE RESPONSIBILITY FOR THE COMPLETENESS AND/OR ACCURACY OF THESE DOCUMENTS SHALL REMAIN WITH THE REGISTERED PROFESSIONAL ENGINEER SEALING THESE PLANS. THE CITY DOES NOT ACCEPT LIABILITY FOR FACILITIES DESIGNED BY OTHERS.

MOUNTAIN GATEWAY
RIDGE ROAD & ROBB STREET
ARVADA, CO
INITIAL EROSION CONTROL PLAN

DATES/ REVISIONS	
05.20.19	1st Submittal
07.11.19	2nd Submittal

CKE ENGINEERING INC.
14257 W. EVANS CIRCLE
LAKEWOOD, CO. 80228
(303) 917-1757

C4.0