

K:\COS_Civil\196413000_Westerly Filing No. 1\CADD\PlanSheets\Block 12\B12_CV_EARTH.dwg Schmelbach, Ryan 6/29/2023 3:13 PM

WESTERLY FILING NO. 1A
BLOCK 12: LOTS 1 - 24
GRADING, EROSION AND SEDIMENT CONTROL (GESC) PLANS
A PORTION OF THE NORTHWEST ONE-QUARTER OF SECTION 21, TOWNSHIP 1 NORTH,
RANGE 68 WEST OF THE 6TH P.M., TOWN OF ERIE, COUNTY OF WELD, STATE OF COLORADO

TOWN OF ERIE – GRADING NOTES

- ALL CONSTRUCTION ACTIVITIES THAT DISTURBS ONE OR MORE ACRES OF LAND, AS WELL AS ACTIVITIES THAT DISTURB LESS THAN ONE ACRE OF LAND, BUT IS PART OF A LARGER COMMON PLAN OF DEVELOPMENT, MUST COMPLY WITH BOTH LOCAL AND STATE REGULATIONS REGARDING STORMWATER DRAINAGE ON CONSTRUCTION SITES. OWNERS OR CONTRACTORS MUST OBTAIN A COLORADO STORMWATER DISCHARGE PERMIT FOR CONSTRUCTION ACTIVITIES FROM THE COLORADO DEPARTMENT OF PUBLIC HEALTH AND ENVIRONMENT (CDPHE) AND A GRADING AND STORMWATER QUALITY PERMIT FROM THE TOWN OF ERIE. CONTRACTOR SHALL:
 - 1.1. MAINTAIN A COPY OF THE STORMWATER MANAGEMENT PLAN (SWMP) ONSITE AT ALL TIMES OR PROVIDE AN UPDATED DIGITAL COPY WITHIN TWO BUSINESS DAYS UPON REQUEST. THE SWMP MUST BE MAINTAINED AND MADE AVAILABLE TO TOWN OF ERIE INSPECTORS UPON REQUEST.
 - 1.2. INSTALL AND MAINTAIN EROSION, SEDIMENT, AND MATERIALS MANAGEMENT CONTROL MEASURE AS SPECIFIED IN THE SWMP.
 - 1.3. INSPECT ALL CONTROL MEASURES AT LEAST EVERY SEVEN (7) DAYS OR EVER FOURTEEN (14) DAYS AND WITHIN TWENTY FOUR (24) HOURS AFTER ANY PRECIPITATION OR SNOWMELT EVENT THAT CAUSES SURFACE RUNOFF.
 - 1.4. MAINTAIN INSPECTION AND MAINTENANCE RECORDS OF CONTROL MEASURES WITH THE SWMP. COPIES OF THESE REPORTS SHALL BE PROVIDED TO THE TOWN OF ERIE ENGINEERING STAFF.
 - 1.5. BASED ON INSPECTION PERFORMED BY THE PERMIT HOLDER OR BY TOWN PERSONNEL, MODIFICATIONS TO THE SWMP WILL BE NECESSARY IF AT ANY TIME THE SPECIFIED CONTROL MEASURES DO NOT MEET THE OBJECTIVES OF THE PERMIT. ALL MODIFICATIONS SHALL BE COMPLETED AS SOON AS PRACTICABLE AFTER THE REFERENCED INSPECTION, AND SHALL BE RECORDED ON THE OWNER'S COPY OF THE SWMP.
 - 1.6. THE OPERATOR SHALL AMEND THE SWMP WHENEVER THERE IS A SIGNIFICANT CHANGE IN DESIGN, CONSTRUCTION, OPERATION, OR MAINTENANCE, WHICH HAS A SIGNIFICANT EFFECT ON THE POTENTIAL FOR DISCHARGE OF POLLUTANTS TO THE RECEIVING WATERS, OR IF THE SWMP PROVES TO BE INEFFECTIVE IN ACHIEVING THE GENERAL OBJECTIVES OF CONTROLLING POLLUTANTS IN STORM WATER DISCHARGES ASSOCIATED WITH CONSTRUCTION ACTIVITIES.
 - 1.7. INSTALLATION AND MAINTENANCE OF CONTROL MEASURES SHALL BE SUPERVISED BY PERSONNEL CERTIFIED IN EROSION AND SEDIMENT CONTROL.
 - 1.8. ALL APPROPRIATE CONTROL MEASURES SHALL BE INSTALLED PRIOR TO THE START OF EACH CONSTRUCTION PHASE.
 - 1.9. APPROPRIATE STABILIZED CONSTRUCTION ENTRANCES WITH VEHICLE TRACKING CONTROLS INSTALLED SHALL BE UTILIZED AT ALL TIMES TO REDUCE THE TRACKOUT OF SEDIMENT. IF NON-STRUCTURAL VEHICLE TRACKING CONTROLS ARE UTILIZED, CLEANUP OF TRACKOUT MUST OCCUR AT THE END OF EVERY BUSINESS DAY WITH CONSTRUCTION ACTIVITY OCCURRING.
- ALL SITE GRADING (EXCAVATION, EMBANKMENT, AND COMPACTION) SHALL CONFORM TO THE RECOMMENDATIONS OF THE LATEST SOILS INVESTIGATION FOR THIS PROPERTY AND SHALL FURTHER BE IN CONFORMANCE WITH THE TOWN OF ERIE "STANDARDS AND SPECIFICATIONS FOR THE DESIGN AND CONSTRUCTION OF PUBLIC IMPROVEMENTS", LATEST EDITION.
- ALL GRADING AND FILLING OPERATIONS SHALL BE OBSERVED, INSPECTED AND TESTED BY A LICENSED SOILS ENGINEER. ALL TEST RESULTS SHALL BE SUBMITTED TO THE TOWN OF ERIE ENGINEERING STAFF.
- NATURE VEGETATION SHALL BE RETAINED AND PROTECTED WHEREVER POSSIBLE. EXPOSURE OF SOIL TO EROSION BY REMOVAL OR REQUIRED FOR IMMEDIATE CONSTRUCTION OPERATION AND FOR THE SHORTEST PRACTICAL PERIOD OF TIME. IT SHALL BE THE RESPONSIBILITY OF THE CONTRACTOR TO AVOID ANY DAMAGE TO EXISTING FOLIAGE THAT LIES IN THE PROJECT AREA UNLESS DESIGNATED FOR REMOVAL AND SHALL BE LIABLE FOR SUCH DAMAGE AT HIS/HER EXPENSE.
- TOPSOIL SHALL BE STOCKPILED TO THE EXTENT PRACTICABLE ON THE SITE FOR USE ON AREAS TO BE RE-VEGETATED. ANY AND ALL STOCKPILES SHALL BE LOCATED AND PROTECTED FROM EROSION ELEMENTS. IF MATERIALS ARE STORED OFFSITE, A WRITTEN USE AGREEMENT BETWEEN THE PERMITTEE AND THE OWNER/OPERATOR OF ANY CONTROL MEASURES BEING UTILIZED OUTSIDE OF THE PERMITTED AREA MUST BE MADE AVAILABLE TO TOWN PERSONNEL UPON REQUEST.
- TEMPORARY VEGETATION/STABILIZATION SHALL BE INSTALLED ON ALL DISTURBED AREAS WHERE PERMANENT SURFACE IMPROVEMENTS ARE NOT SCHEDULED FOR IMMEDIATE INSTALLATION BUT NO LATER THAN FOURTEEN (14) DAYS. SEEDING WILL BE DONE ACROSS THE SLOPE FOLLOWING THE CONTOURS. VEGETATION SHALL CONFORM TO THE TOWN OF ERIE STANDARDS AND SPECIFICATIONS. PROJECT SCHEDULING SHOULD TAKE ADVANTAGE OF SPRING OR FALL PLANTING SEASONS FOR NATURAL GERMINATION. SEEDED AREAS SHALL BE IRRIGATED IN ACCORDANCE WITH THE TOWN OF ERIE'S STANDARDS AND SPECIFICATIONS.
- AT ALL TIMES, A WATER TRUCK SHALL BE ON-SITE AND THE PROPERTY SHALL BE MAINTAINED AND/OR WATERED TO PREVENT WIND-CAUSED EROSION. EARTHWORK OPERATIONS SHALL BE DISCONTINUED WHEN FUGITIVE DUST SIGNIFICANTLY IMPACTS ADJACENT PROPERTY. IF EARTHWORK IS COMPLETE OR DISCONTINUED AND DUST FROM THE SITE CONTINUES TO CREATE PROBLEMS, THE OWNER/DEVELOPER SHALL IMMEDIATELY INSTITUTE MITIGATIVE MEASURES AND SHALL CORRECT DAMAGE TO ADJACENT PROPERTY.
- FILL SLOPES SHALL BE COMPACTED BY MEANS OF SHEEPSFOOT COMPACTOR OR OTHER SUITABLE EQUIPMENT. COMPACTING SHALL CONTINUED UNTIL SLOPES ARE STABLE AND THERE IS NOT AN APPRECIABLE AMOUNT OF LOOSE SOIL ON THE SLOPES.
- TEMPORARY CUT/FILL SLOPES SHALL ABIDE BY THE SOILS REPORT. PERMANENT SLOPES SHALL BE AS SHOWN ON PLANS.
- DEPTH OF MOISTURE-DENSITY CONTROL SHALL BE FULL DEPTH ON ALL EMBANKMENT AND SIX (6) INCHES ON THE BASE OF CUTS AND FILLS.
- OUTLET SIDES OF ALL STORM PIPES SHALL BE GRADED TOD RAIN AND SHALL SUFFICIENT EROSION PROTECTION.
- THE PERMITTEE OR HIS AGENT SHALL NOTIFY THE SITE GEOTECHNICAL ENGINEER WHEN THE GRADING OPERATION IS READY FOR EACH OF THE FOLLOWING INSPECTIONS:
 - 12.1. INITIAL INSPECTION WHEN THE PERMITTEE IS READY TO BEGIN WORK, BUT NOT LESS THAN TWO (2) DAYS BEFORE ANY GRADING OR GRUBBING IS STARTED.
 - 12.2. AFTER THE NATURAL GROUND OR BEDROCK IS EXPOSED AND PREPARED TO RECEIVE FILL, BUT BEFORE FILL IS PLACED.
 - 12.3. EXCAVATION INSPECTION AFTER THE EXCAVATION IS STARTED BUT BEFORE THE VERTICAL DEPTH OF EXCAVATION EXCEEDS TEN (10) FEET.
 - 12.4. FILL INSPECTION AFTER THE FILL PLACEMENT IS STARTED, BUT BEFORE THE FILL EXCEEDS TEN (10) FEET.

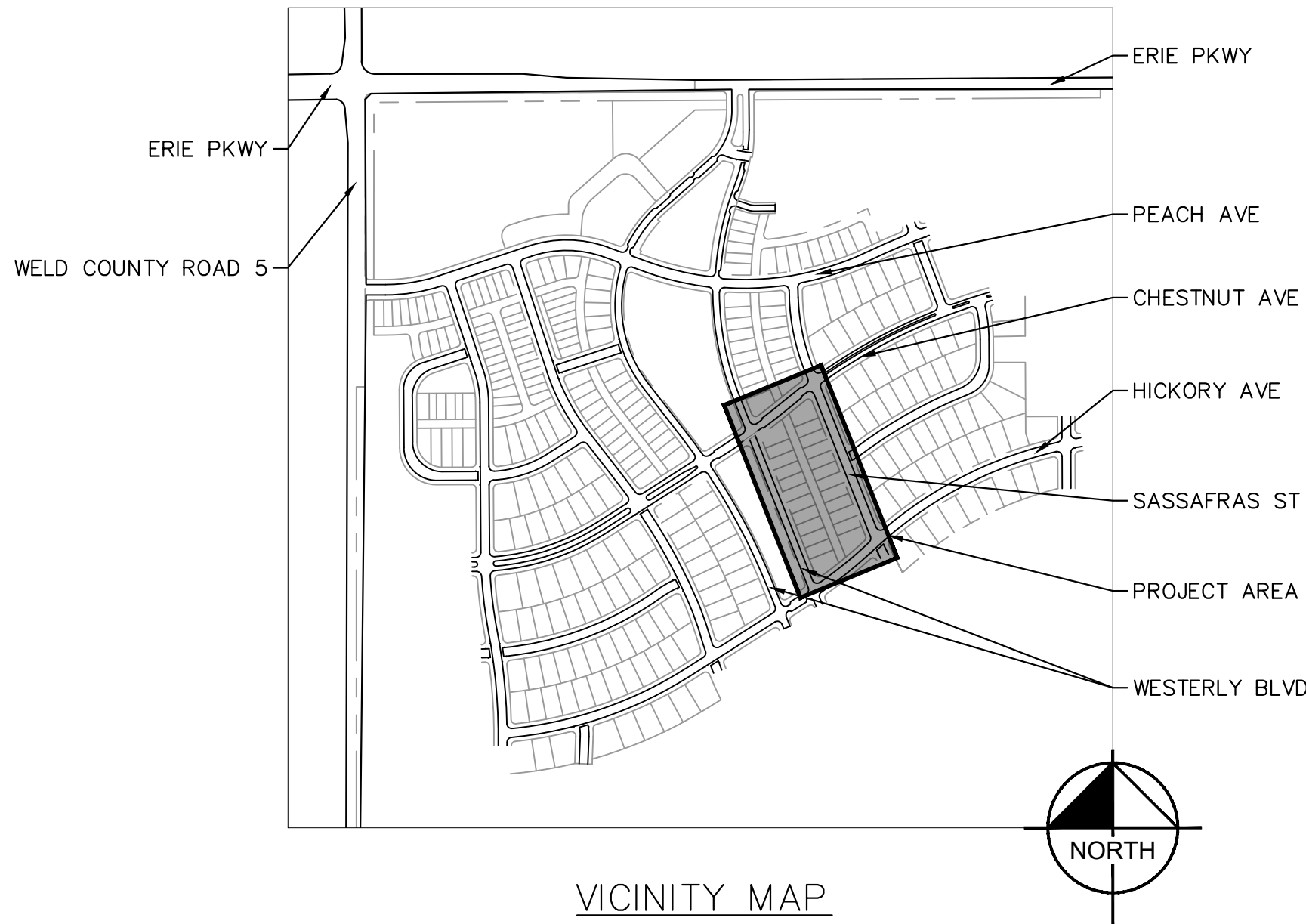

SHEET INDEX	
B12.1	COVER SHEET
B12.2	INITIAL PLAN
B12.3	INTERIM/FINAL PLAN
B12.4 – B12.8	DETAILS

GESC PLAN SIGNATURES

OWNER'S STATEMENT	
I, THE OWNER/DEVELOPER HAVE READ AND WILL COMPLY WITH THE REQUIREMENTS OF THE GRADING AND EROSION CONTROL PLAN.	
OWNER SIGNATURE	DATE
ENGINEER'S STATEMENT	
THIS GRADING AND EROSION CONTROL PLAN WAS PREPARED UNDER MY DIRECTION AND SUPERVISION AND IS CORRECT TO THE BEST OF MY KNOWLEDGE AND BELIEF. SAID PLAN HAS BEEN PREPARED ACCORDING TO THE CRITERIA ESTABLISHED BY THE COUNTY FOR GRADING AND EROSION CONTROL PLANS. I ACCEPT RESPONSIBILITY FOR ANY LIABILITY CAUSED BY ANY NEGLIGENT ACTS, ERRORS OR OMISSIONS ON MY PART IN PREPARING THIS PLAN.	
KEVIN KOFFORD, PE – KIMLEY-HORN AND ASSOCIATES, INC.	DATE



Kimley»Horn
2023 KIMLEY-HORN AND ASSOCIATES, INC.
2 North Nevada Avenue, Suite 900
Colorado Springs, Colorado 80903 (719) 453-0180

DESIGNED BY: KRK
DRAWN BY: RES
CHECKED BY: KRK
DATE: 6/29/23

WESTERLY SUBDIVISION FILING NO. 1
BLOCK 12
GESC PLANS
COVER SHEET

PRELIMINARY
FOR REVIEW ONLY
NOT FOR
CONSTRUCTION
Kimley»Horn
Kimley-Horn and Associates, Inc.

PROJECT NO.
196413000
SHEET
B12.1

K:\COS_Civil\196413000_Westerly Filing No. 1\CADD\PlanSheets\Block 12\B12_GESC_INITIAL.dwg Schnelboch, Ryan 6/29/2023 3:13 PM

NOTES

1. THE INTENT OF THIS PLAN IS TO IDENTIFY THE EROSION CONTROL PRACTICES RECOMMENDED. THE CONTRACTOR SHALL REFERENCE ADDITIONAL CONSTRUCTION PLANS OF EXISTING AND PROPOSED IMPROVEMENTS.
2. ADJACENT STREETS SHALL BE KEPT CLEAN AND FREE OF SEDIMENT AND/OR DEBRIS AS NEEDED.
3. TEMPORARY STABILIZATION (TS) SHALL BE IMPLEMENTED WITHIN THE DISTURBED PORTIONS OF THE PROJECT SITE NO LATER THAN 14 DAYS FOLLOWING THE CEASE OF CONSTRUCTION ACTIVITIES WITHIN THE DISTURBED AREAS.
4. PERMANENT STABILIZATION (PS) MAY BE USED WITHIN AREAS OF TEMPORARY STABILIZATION (TS) AT THE CONTRACTOR'S DISCRETION. STABILIZATION SHALL BE APPLIED IN ACCORDANCE WITH APPLICABLE TEMPORARY STABILIZATION SEQUENCING REQUIREMENTS.
5. CONTRACTOR SHALL UTILIZE ROLLED EROSION CONTROL PRODUCTS (STRAW-SINGLE NET EROSION CONTROL BLANKETS AND OPEN WEAVE TEXTILES) ON ALL SLOPES 3H:1V OR GREATER TO ACHIEVE REQUIRED STABILIZATION.
6. CONTRACTOR SHALL MAINTAIN ACCEPTABLE EROSION CONTROL PRACTICES WITHIN THE ANTICIPATED LIMITS OF CONSTRUCTION IDENTIFIED HEREIN. BEST MANAGEMENT PRACTICES AND STABILIZATION SHALL BE COMPLETED AS IDENTIFIED HEREIN IN ACCORDANCE WITHIN OWNER REQUIREMENTS.
7. SILT FENCE TO BE INSTALLED PRIOR TO COMMENCEMENT OF ONSITE GRADING AND CONSTRUCTION ACTIVITIES. SILT FENCE MAY BE SUBSTITUTED WITH BLACK FABRIC WATTLE.
8. SILT FENCE TO BE REPLACED WITH BLACK FABRIC WATTLE AS LOT SPECIFIC FOUNDATION BACKFILL AND COMPACTION IS COMPLETED.
9. DEMOLITION, REMOVAL, OVEREXCAVATION AND SOIL TREATMENT SHALL BE IN ACCORDANCE WITH THE GEOTECHNICAL ENGINEER RECOMMENDATIONS AS NOTED IN THE APPROVED PROJECT GEOTECHNICAL REPORT.
10. NO ASPHALT OR CONCRETE BATCH PLANTS SHALL BE USED FOR THIS PROJECT.
11. CHECK DAMS TO BE PLACED IN TEMPORARY AND PERMANENT DRAINAGE SWALES AND ROADSIDE DITCHES AND TO BE SPACED AS DEEMED NECESSARY. RIRPRAP IN CHECK DAMS TO BE SUBSTITUTED WITH SCL.
12. *SURFACE ROUGHENING - SURFACE ROUGHENING TO BE IMPLEMENTED AS NEEDED AND DETERMINED BY INSPECTOR.

LIMITS OF DISTURBANCE

ONSITE DISTURBANCE = ±2.56 ACRES
OFFSITE DISTURBANCE = ±1.08 ACRES
TOTAL = ±3.64 ACRES

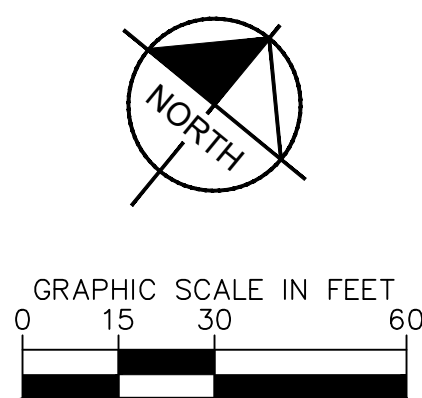

LEGEND

- | | |
|--|----------------------------|
| | PROPERTY LINE |
| | UTILITY EASEMENT |
| | MAJOR ELEVATION CONTOUR |
| | MINOR ELEVATION CONTOUR |
| | WATER PIPE |
| | SANITARY SEWER PIPE |
| | STORM WATER UTILITY PIPE |
| | MANHOLE |
| | FIRE HYDRANT |
| | LIMITS OF DISTURBANCE |
| | SILT FENCE |
| | WIRED BACK SILT FENCE |
| | FINAL STABILIZATION |
| | STABILIZED STAGING AREA |
| | SOIL STOCK PILING |
| | VEHICLE TRACKING (MUD MAT) |
| | PORTABLE TOILET |
| | CONCRETE WASHOUT (ECOPAN) |
| | INLET PROTECTION W/ SUMP |
| | CHECK DAM (WRE/ROCK) |
| | FLOW ARROW |
| | STREET SWEEPING |
| | ROCK SOCKS |
| | *SURFACE ROUGHENING |



Kimley»Horn

2023 KIMLEY-HORN AND ASSOCIATES, INC.
2 North Nevada Avenue, Suite 900
Colorado Springs, Colorado 80903 (719) 453-0180

WESTERLY SUBDIVISION FILING NO. 1

BLOCK 12
GESC PLANS
INITIAL PLAN

PRELIMINARY
FOR REVIEW ONLY
NOT FOR
CONSTRUCTION
Kimley»Horn
Kimley-Horn and Associates, Inc.

PROJECT NO.
196413000
SHEET
B12.2

SHEET
B12.3