

BROADWAY STREET

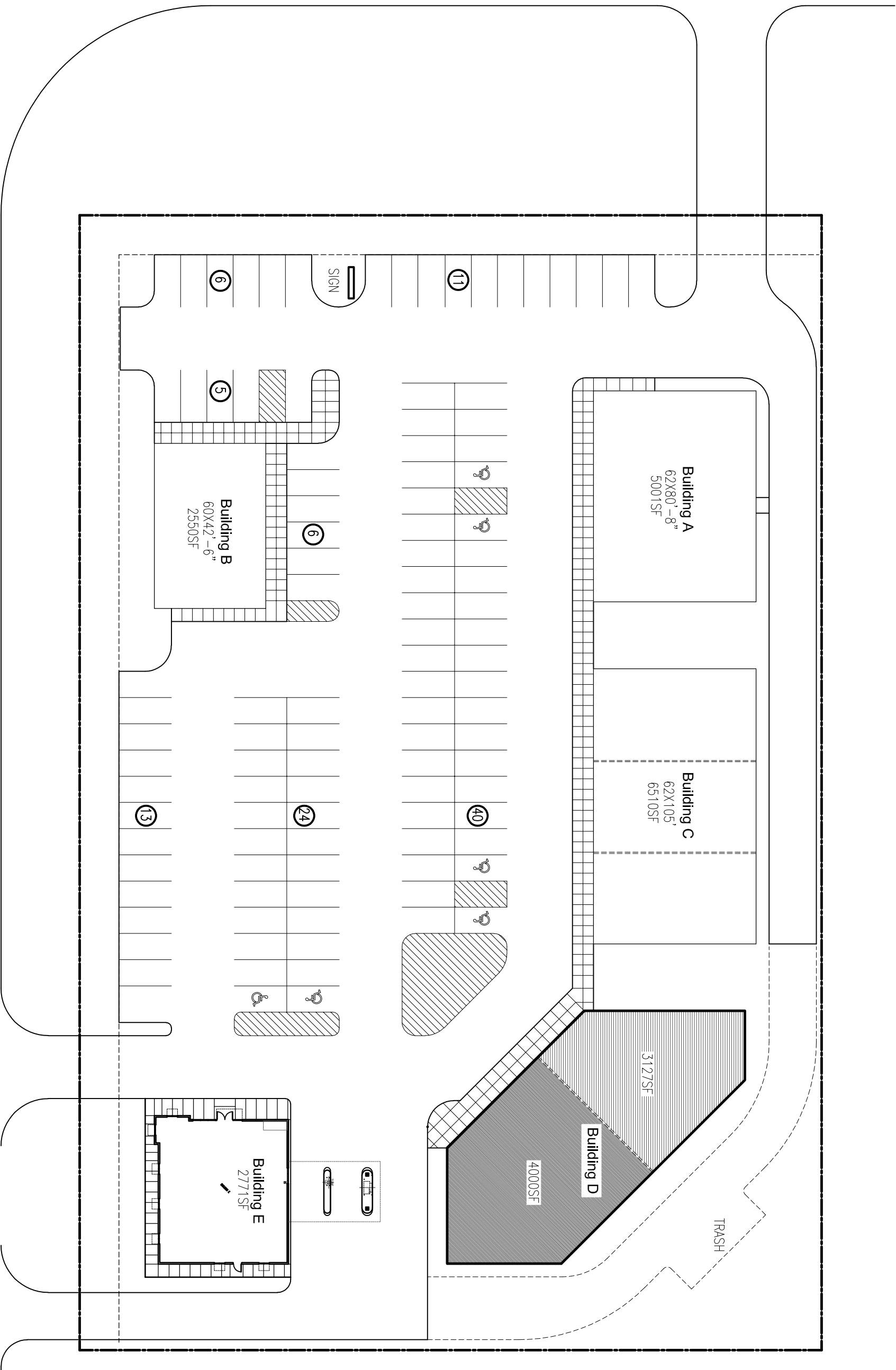

EAST 31st STREET

Building A
62X80'-8"
5001SF

Building C
62X105'
6510SF

Building B
60X42'-6"
2550SF

3127SF

4000SF

Building E
2771SF

SIGN

11

6

5

6

13

24

40

REQUIRED PARKING

- 1. 1 STALL PER 250SF OF GROSS FLOOR AREA
23959SF / 250 = 96 STALLS REQUIRED.
- 2. 105 STALLS PROVIDED.

⑦ - DENOTES PARKING STALLS PER ROW

north

SCHEMATIC SITE PLAN

1"=20'-0"