

ROBIEL®

Common Rail Injectors
Inyectores Common Rail

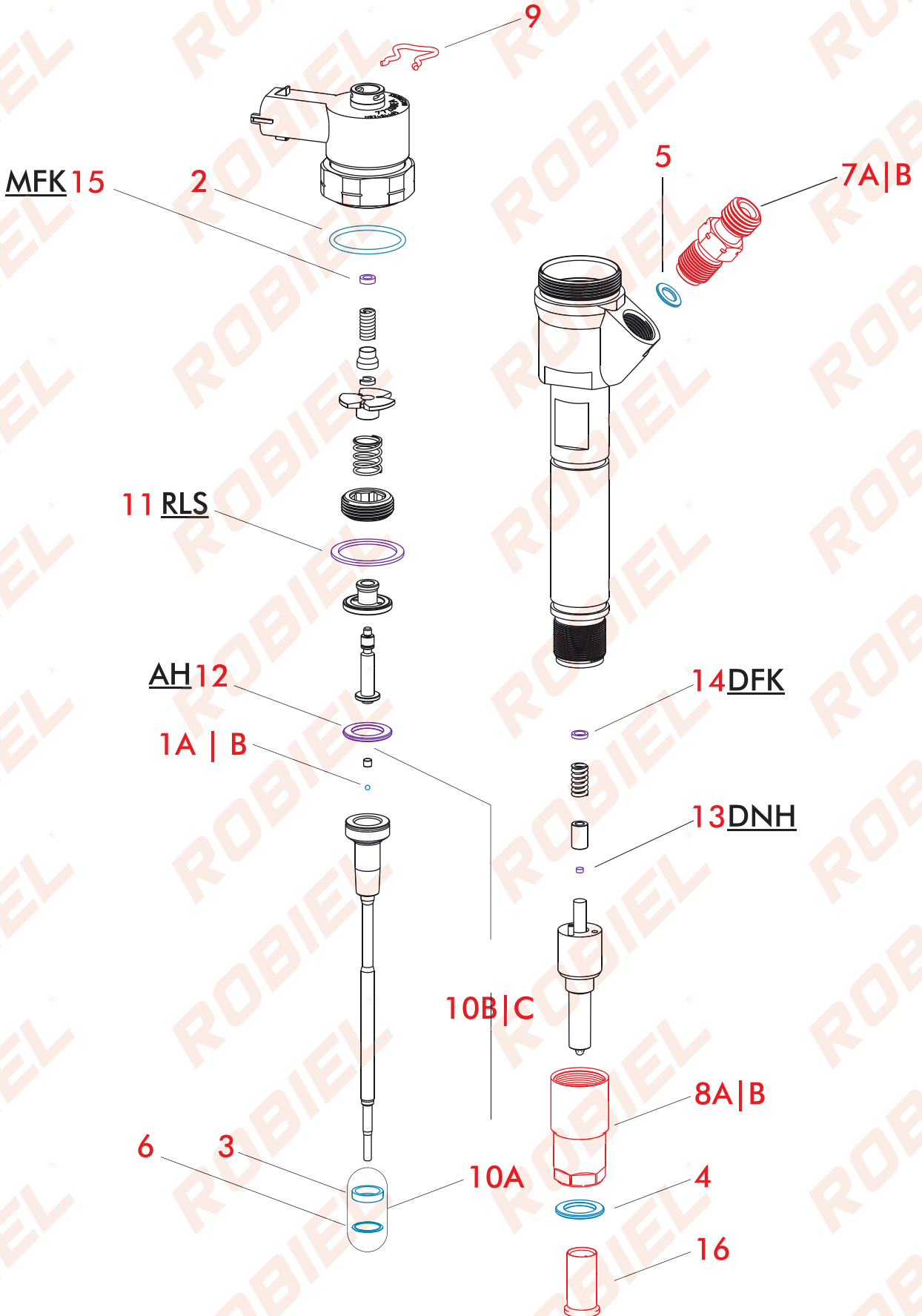

CRI|CRI1.0|CRI2.0|CRI2.2 INJECTORS
INYECTORES CRI|CRI1.0|CRI2.0|CRI2.2



410.00.26

REPAIR PARTS - SPRINTER CR INJECTOR COMPLETE

REPARACION INY COMMON RAIL SPRINTER COMPLETA

REFERENCE				
Nº	ROBIEL CODE	REFERENCE	DESCRIPTION	PACK
1A	190.50.11	F 00V C05 001	Ball - <i>Bolilla</i>	01un.
2	421.02.115	F 00V C38 002	O-ring - <i>Anillo</i>	01un.
3	424.08.10	F 00V C99 002	Teflon Ring - <i>Anillo Teflon</i>	01un.
4	600.02.02	1 987 972 076 A611 01 70 060	Washer - <i>Arandela</i>	01un.
5	805.09.05	F 00V C17 003	Washer - <i>Arandela</i>	01un.
6	808.10.010	F 00V C99 002	Shim-Nozzle - <i>Calzo-Tobera</i>	01un.





SPARE PARTS

Repuestos

Nº	ROBIEL CODE	REFERENCE	DESCRIPTION	PACK
1A	190.50.11	F 00V C05 001	Ball Diameter 1.34mm <i>Bolilla de Valvula Diametro 1.34mm</i>	12un.
1B	190.50.14	F 00V C05 009 006	Ball Diameter 1.50mm <i>Bolilla de Valvula Diametro 1.50mm</i>	12un.
4	600.02.02	1 987 972 076 A611 01 70 060	Washer - Sprinter 313 CDI CR Nozzle <i>Arandela de la Tobera Sprinter 313 CDI Common Rail</i>	24un.
5	805.09.05	F 00V C17 003	Shim - 0.60mm <i>Calzo - 0.60mm</i>	12un.
7A	165.02.06	F 00V C16 017	Connection - Pressure - Common Rail <i>Conexion de Pressão del Inyector Common Rail</i>	01un.
7B	165.02.061	-	Connection w/ Filter - Pressure - Common Rail <i>Conexion c/ Filtro de Pressão del Inyector Common Rail</i>	M12X 1.50mm M12 X 1.00mm 01un.
8A	315.06.25	F 00V C14 012	Nut - Nozzle-Retaining Sprinter 313 CDI CR <i>Tapa de la Tobera Sprinter 313 CDI CR</i>	M17 X 0.75mm 04un.
8B	315.06.58	F 00V C14 015	Nut - Nozzle-Retaining Bosch Ducato <i>Tapa de la Tobera Bosch Ducato</i>	M17 X 0.75mm 01un.
9	335.05.06	F 00V C22 003	Lock - Sprinter 313 CDI Return <i>Bloqueo Del Retorno Sprinter 313 CDICR</i>	12un.
10A	424.08.10C	F 00V C99 002	Repair Parts - Common Rail Injector Rod <i>Reparacion Inyector Baston Common Rail</i>	04kit.
10B	424.08.10D	F 00V C22 003 + Esfera	Repair Parts - Common Rail Injector Rod - Ball Ø1.34mm <i>Reparacion Inyector Baston Common Rail - Bolilla Ø1.34mm</i>	01kit.
10C	424.08.10E	F 00V C99 002 + Esfera	Repair Parts - Common Rail Injector Rod - Ball Ø1.50mm <i>Reparacion Inyector Baston Common Rail - Bolilla Ø1.50mm</i>	01kit.
16	220.03.08	-	Protective Cap - Injectors / Units Nozzle - 7.00mm <i>Tapa Protectora p/ Tobera Inyectores / Unidades - 7.00mm</i>	01kit.
R1	001.08.000	6013.001.121.000	Hose - Return - Volare Sprinter Motor <i>Manguera Retorno Volare Motor Sprinter</i>	01un.
R2	001.08.432	A 611 070 8432	Hose - Return - Sprinter 313 CDI <i>Manguera Retorno Sprinter 313 CDI</i>	01un.
R3	421.00.412	-	O-ring 3.70 x 1.20mm <i>Anillo 3.70 x 1.20mm</i>	24un.
R4	165.06.10	-	Connection - Sprinter 313 CDI Nozzle Return - "T" Type <i>Conexion T Retorno Toberas Sprinter 313 CDI</i>	04un.
R5	165.06.11	-	Connection - Sprinter 313 CDI Nozzle Return - "L" Type <i>Conexion L Retorno Toberas Sprinter 313 CDI</i>	04un.
R6	002.70.0533	-	Tube for Sprinter CDI Rail Pressure Pump <i>Tubo de la BBA de Presion Al Rail Sprinter CDI</i>	01un.
R7	002.70.0233	611 070 0233	Tube - CDI Sprinter / Acello Nozzle <i>Tubo de la Tobera CDI Sprinter / Acello</i>	01un.

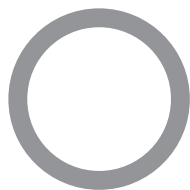
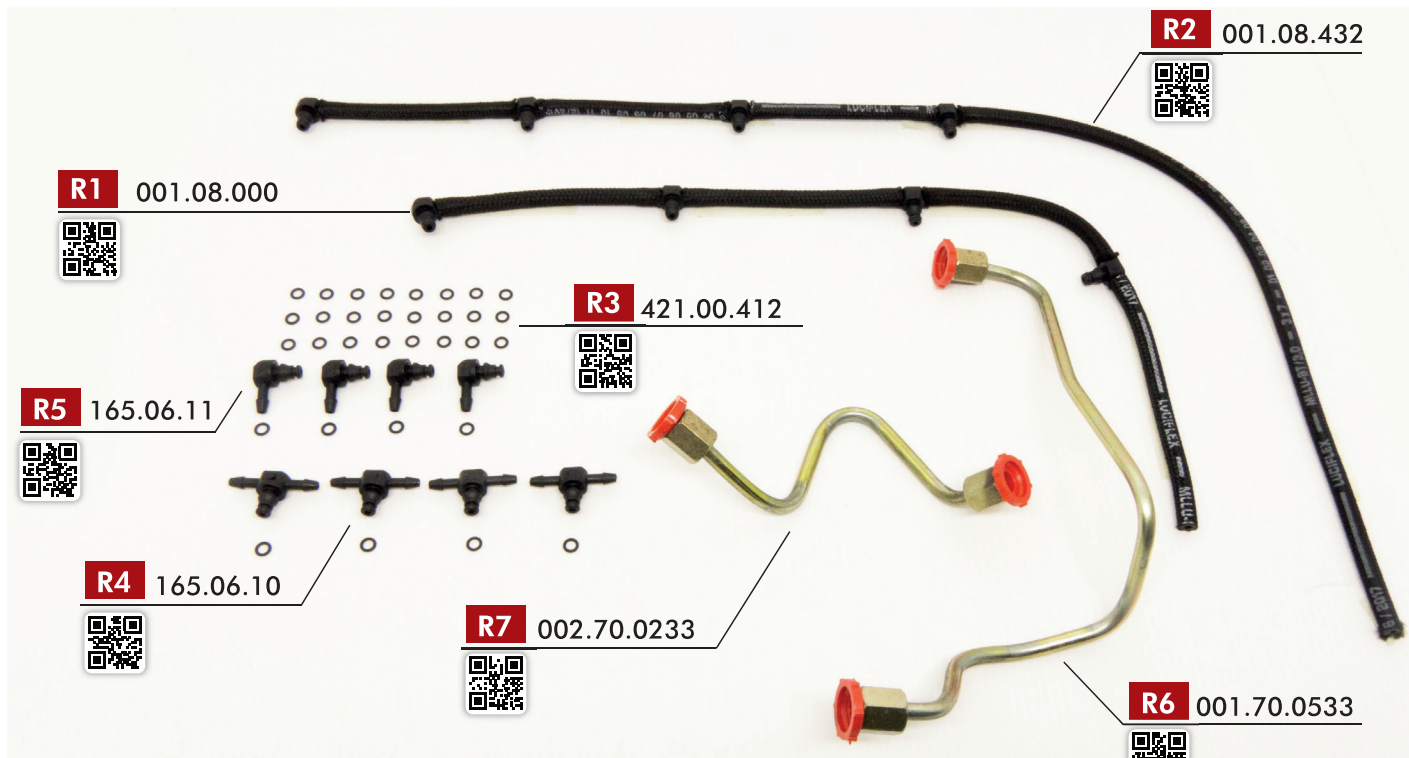





11	SHIM - ADJUSTMENT - C.R. DEBIT (RLS) CALZO AJUSTE DEBITO COMMON RAIL		
	Ø Int.: 19.00 Ø Ext.: 23.80		
ROBIEL CODE	REFERENCE	THICKNESS(mm)	
819.25.094	F 00V C60 215	0.94	
819.25.095	F 00V C60 221	0.95	
819.25.096	F 00V C60 225	0.96	
819.25.097	-	0.97	
819.25.098	F 00V C60 235	0.98	
819.25.099	-	0.99	
819.25.100	F 00V C60 245	1.00	
819.25.101	-	1.01	
819.25.102	F 00V C60 255	1.02	
819.25.103	-	1.03	
819.25.104	F 00V C60 265	1.04	
819.25.105	F 00V C60 270	1.05	
819.25.106	F 00V C60 275	1.06	
819.25.107	F 00V C60 280	1.07	
819.25.108	F 00V C60 285	1.08	
819.25.110	F 00V C60 295	1.10	
04 UNITS			

12	SHIM - CR SPRINTER PRESSURE (AH) CALZO PRESION COMMON RAIL SPRINTER		
	Ø Int.: 10.40 Ø Ext.: 15.80		
ROBIEL CODE	REFERENCE	THICKNESS(mm)	
810.16.117	-	1.17	
810.16.120	F 00V C10 406	1.20	
810.16.121	F 00V C10 410	1.21	
810.16.122	F 00V C10 416	1.22	
810.16.123	F 00V C10 420	1.23	
810.16.124	F 00V C10 426	1.24	
810.16.125	F 00V C10 430	1.25	
810.16.126	F 00V C10 436	1.26	
810.16.127	F 00V C10 440	1.27	
04 UNITS			

13	SHIM - HOLD - CR NOZZLE (DNH) CALZO RESTRICTOR TOBERA CR		
	Ø Ext.: 2.30 		
●	ROBIEL CODE	REFERENCE	THICKNESS(mm)
	800.02.100	F 00V C12 500	1.00
	800.02.101	F 00V C12 502	1.01
	800.02.102	F 00V C12 504	1.02
	800.02.103	F 00V C12 506	1.03
	800.02.104	F 00V C12 508	1.04
	800.02.105	F 00V C12 510	1.05
	800.02.106	F 00V C12 512	1.06
	800.02.107	F 00V C12 514	1.07
	800.02.108	F 00V C12 516	1.08
	800.02.109	F 00V C12 518	1.09
	800.02.110	F 00V C12 520	1.10
	800.02.111	F 00V C12 522	1.11
	800.02.112	F 00V C12 524	1.12
	800.02.113	F 00V C12 526	1.13
	800.02.114	F 00V C12 528	1.14
	800.02.115	F 00V C12 530	1.15
	800.02.116	F 00V C12 532	1.16
	800.02.117	F 00V C12 534	1.17
	800.02.118	F 00V C12 536	1.18
	800.02.119	F 00V C12 538	1.19
	800.02.120	F 00V C12 540	1.20
	800.02.121	F 00V C12 542	1.21
	800.02.122	F 00V C12 544	1.22
	800.02.123	F 00V C12 546	1.23
	800.02.124	F 00V C12 548	1.24
	800.02.125	F 00V C12 550	1.25
06 UNITS			

14	SHIM - PIEZO CR INJECTOR NOZZLE (DFK) CALZO TOBERA INYECTOR CR		
	Ø Int.: 3.50 Ø Ext.: 5.30 		
○	ROBIEL CODE	REFERENCE	THICKNESS(mm)
	803.05.09	-	0.90
	803.05.095	-	0.95
	803.05.10	F 00V C10 460	1.00
	803.05.105	F 00V C10 464	1.05
	803.05.11	F 00V C10 470	1.10
	803.05.115	F 00V C10 474	1.15
	803.05.12	F 00V C10 480	1.20
	803.05.125	F 00V C10 484	1.25
	803.05.13	F 00V C10 490	1.30
	803.05.135	F 00V C10 494	1.35
	803.05.14	F 00V C10 500	1.40
	803.05.145	F 00V C10 504	1.45
	803.05.15	F 00V C10 510	1.50
06 UNITS			

15	SHIM - CR PIEZO INJECTOR NOZZLE (MFK) CALZO TOBERA INYECTOR CR PIEZO		
	Ø Int.: 3.50 Ø Ext.: 5.30 		
○	ROBIEL CODE	REFERENCE	THICKNESS(mm)
	803.05.155	F 00V C10 514	1.55
	803.05.16	F 00V C10 520	1.60
	803.05.165	F 00V C10 524	1.65
	803.05.17	F 00V C10 530	1.70
	803.05.175	F 00V C10 534	1.75
	803.05.18	F 00V C10 540	1.80
	803.05.19	F 00V C10 550	1.90
	803.05.20	F 00V C10 560	2.00
06 UNITS			

15	SHIM - CR INJECTOR COIL (MFK) CALZO BOBINA INYECTOR CR		
	Ø Interno: 2.80 Ø Externo: 5.00 		
○	ROBIEL CODE	REFERENCE	THICKNESS(mm)
	803.06.140	F 00V C60 590	1.40
	803.06.144	F 00V C60 594	1.44
	803.06.148	F 00V C60 598	1.48
	803.06.152	F 00V C60 602	1.52
	803.06.156	F 00V C60 606	1.56
	803.06.160	F 00V C60 610	1.60
	803.06.200	-	2.00
12 UNITS			

415.00.011

PARTS SET - CRI/CRIN REPAIRING - R2
 JUEGO PIEZAS REPARACION CRI / CRIN - R2

Nº	ROBIEL CODE	DESCRIPTION	THICKNESS(mm)	UNITS BY MEASURE
-	305.20.830 - 305.20.849	Pin-MWM Injector - Top del Injector MWM	8.30 to 8.49	12 units
-	305.30.834 - 305.30.855	Pin-Cummins/Ducato Injector - Top del Injector Cummins/Ducato	8.34 to 8.55	12 units
DNH	800.02.100 - 800.02.125	Shim - Hold - Calzo Restrictor	1.00 to 1.25	12 units
-	802.04.10 - 802.04.125	Shim - Pre Injection - Calzo de pre Inyeccion	1.00 to 1.25	12 units
DFK	803.05.12 - 803.05.19	Shim-Piezo-Nozzle - Calzo Tobera Inyector Piezo	1.20 to 1.90	12 units
MFK	803.06.140 - 803.06.160	Shim - Coil - Calzo Bobina	1.40 to 1.60	12 units
AH	810.16.117 - 810.16.127	Shim - Pressure Sprinter - Calzo Presion Sprinter	1.17 to 1.27	12 units
-	818.24.092 - 818.24.103	Shim-CR CP3 Regulator - Calzo Regulacion CP3	0.92 to 1.03	12 units
-	819.24.125 - 819.24.135	Shim-CR CP3 Regulator - Calzo Regulacion CP3	1.25 to 1.35	12 units
RLS	819.25.094 - 819.25.110	Shim - Adjustment - Debit - Calzo Ajuste Debito	0.94 to 1.10	12 units

1740 UNITS

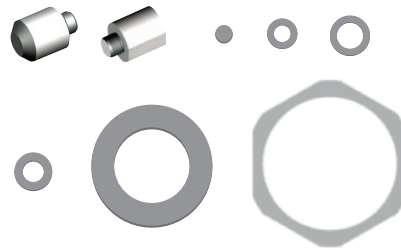

323.01.3241

Rotating Vise W / Indexer Pin
 Morsa Giratoria con Pin index



324.15.01

Injectors Repair Bracket
 Soporte para reparacion de Inyectores



324.10.10

Retaining Bushing Wrench
 248/273 CR Valve
 Llave Del Casquillo de Fijacion Valvula CR 248/273

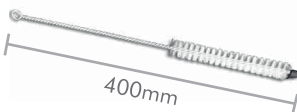

323.02.121

Cleaning Brush
 Cepillo de Limpeza
 Ø 12.00mm

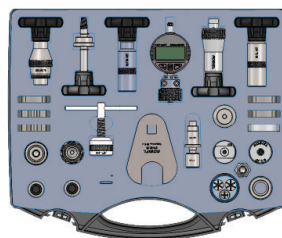

323.50.072

Bosch CRI 1.0 / 2.0 / 2.1 / 2.2 / CRIN 1 / 1.6 Injectors
 Tool Kit
 Kit de herramientas Inyectores Bosch
 CRI 1.0 / 2.0 / 2.1 / 2.2 / CRIN 1 / 1.6



323.02.29

Tightness test Tool - CRI/CRIN Valve
 Herramienta Prueba Estandeidad Valvula CRI/CRIN



CRI 2.5 INJECTORS
INYECTORES CRI 2.5

Amarok

INJECTOR

0 445 110 369

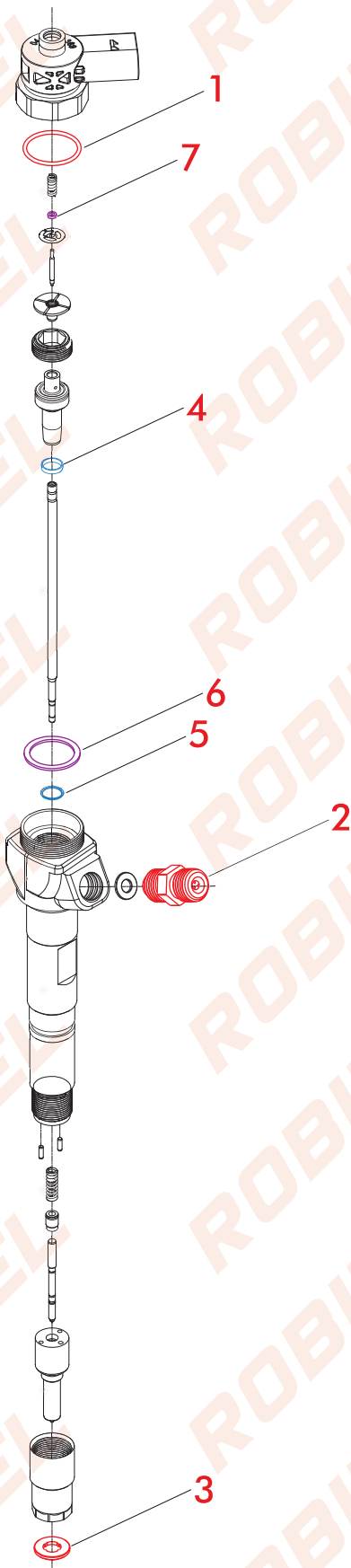

424.08.10C		REPAIR PARTS - COMMON RAIL INJECTOR		
		REPARACION INYECTOR BASTON COMMON RAIL		
REFERENCE		F 00V C99 002		
Nº	ROBIEL CODE	REFERENCE	DESCRIPTION	PACK
4	424.08.10	F 00V C99 002	Teflon Ring - Anillo Teflon	04un.
5	808.10.010	F 00V C99 002	Shim-Nozzle - Calzo-Tobera	04un.





SPARE PARTS				
Repuestos				
Nº	ROBIEL CODE	REFERENCE	DESCRIPTION	PACK
1	421.02.115	F 00V C38 002	O-Ring 21.00x1.50mm <i>Anillo oring 21.00x1.50mm</i>	06un.
2	165.02.17	F 00V C16 501	Connection w/ Filter - Amarok Injector <i>Conexion c/ Filtro Inyector Amarok</i>	01un.
3	607.13.15	F 00V P01 004	Washer - Amarok Nozzle <i>Arandela Tobera Amarok</i>	06un.

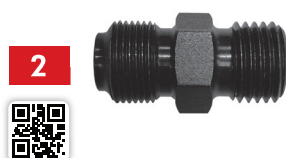
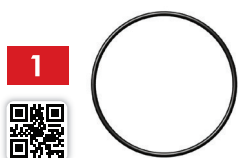

6 SHIM - ADJUSTMENT - C.R. DEBIT (RLS)
CALZO AJUSTE DEBITO COMMON RAIL 

Ø Int.: 19.00 Ø Ext.: 23.80

ROBIEL CODE	REFERENCE	THICKNESS(mm)
819.25.094	F 00V C60 215	0.94
819.25.095	F 00V C60 221	0.95
819.25.096	F 00V C60 225	0.96
819.25.097	-	0.97
819.25.098	F 00V C60 235	0.98
819.25.099	-	0.99
819.25.100	F 00V C60 245	1.00
819.25.101	-	1.01
819.25.102	F 00V C60 255	1.02
819.25.103	-	1.03
819.25.104	F 00V C60 265	1.04
819.25.105	F 00V C60 270	1.05
819.25.106	F 00V C60 275	1.06
819.25.107	F 00V C60 280	1.07
819.25.108	F 00V C60 285	1.08
819.25.110	F 00V C60 295	1.10

04 UNITS

7 SHIM - PRE-INJECTION (MFK)
CALZO DE PRE INYECCION 

Ø Int.: 2.25 Ø Ext.: 4.00

ROBIEL CODE	REFERENCE	THICKNESS(mm)
802.04.10	F 00R J00 778	1.00
802.04.105	F 00R J00 784	1.05
802.04.11	F 00R J00 787	1.10
802.04.115	F 00R J00 793	1.15
802.04.12	F 00R J00 799	1.20
802.04.125	F 00R J00 802	1.25
802.04.13	F 00R J00 808	1.30
802.04.135	F 00R J00 814	1.35
802.04.14	F 00R J00 817	1.40
802.04.145	F 00R J00 823	1.45
802.04.15	F 00R J00 837	1.50
802.04.155	F 00R J00 840	1.55
802.04.16	F 00R J00 846	1.60
802.04.165	-	1.65
802.04.17	-	1.70

06 UNITS

CRIN INJECTORS
INYECTORES CRIN

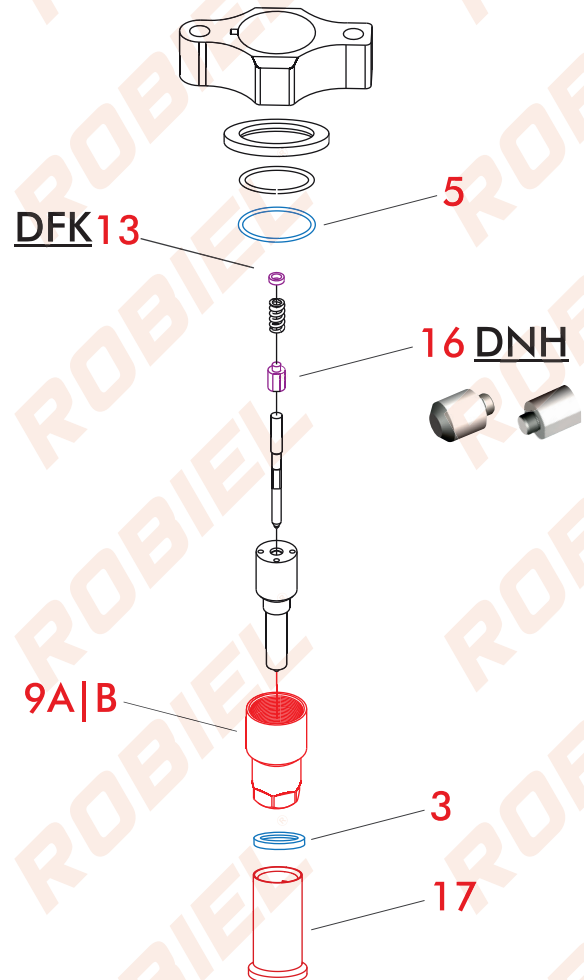
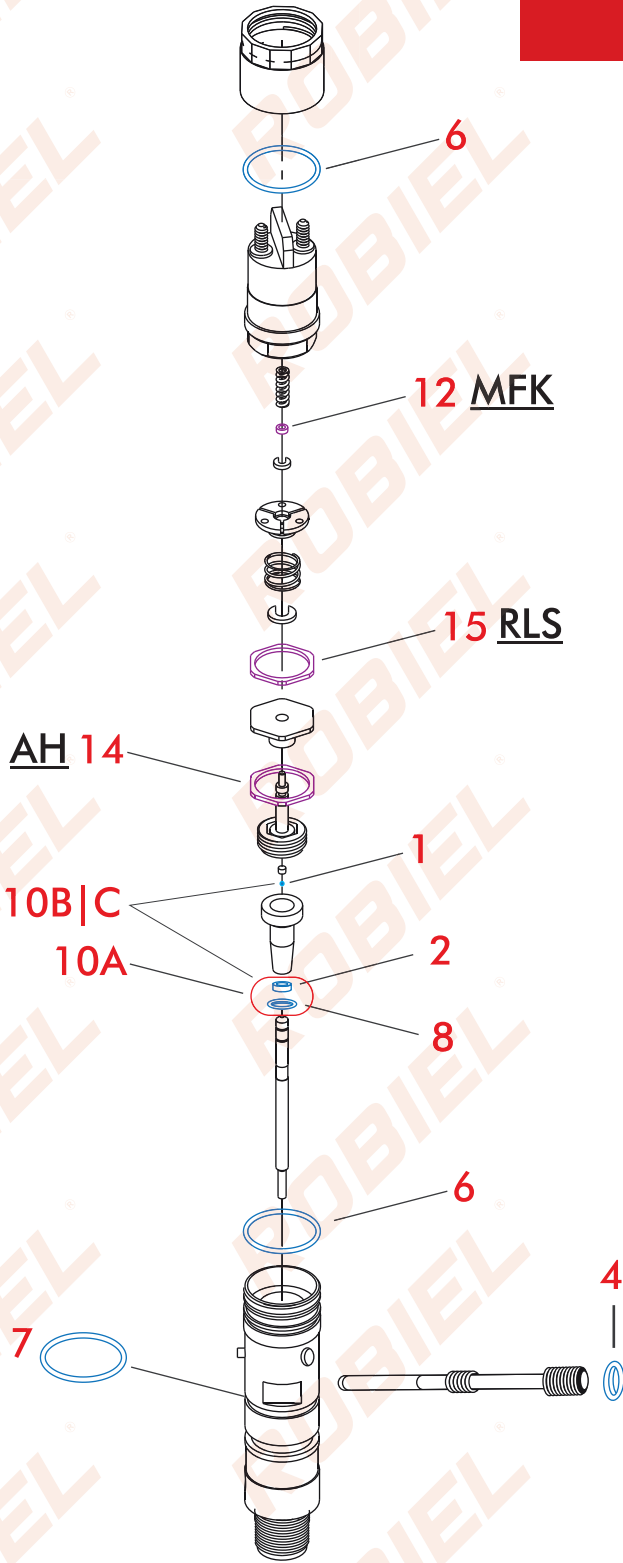

410.00.281		REPAIR PARTS - CRIN/MWM NOZZLE HOLDER		
		REPARACION PORTA INYECTOR CRIN MWM		
REFERENCE				
Nº	ROBIEL CODE	REFERENCE	DESCRIPTION	PACK
1	190.50.11	F 00V C05 001	Ball - Bolilla	01un.
2	424.08.10	F 00V C99 002	Teflon Ring - Anillo Teflon	01un.
3	600.02.08	F 00V C17 505 F 00R J01 086	Washer - Arandela 7.00x15.00x2.00	01un.
6	421.02.415	F 00R J00 220	O-ring - Anillo	02un.
7	421.01.720	-	O-ring - Anillo	01un.
8	808.10.010	-	Shim - Calzo	01un.



410.00.29		REPAIR PARTS - CRIN/CUMMINS NOZZLE HOLDER		
		REPARACION PORTA INYECTOR CRIN CUMMINS		
REFERENCE				
Nº	ROBIEL CODE	REFERENCE	DESCRIPTION	PACK
1	190.50.11	F 00V C05 001	Ball - Bolilla	01un.
2	424.08.10	F 00V C99 002	Teflon Ring - Anillo Teflon	01un.
3	600.02.07	F 00V C17 503 F 00R J01 453	Washer - Arandela 7.00x15.00x1.50	01un.
4	421.01.130	A5419970545	O-ring - Anillo	01un.
5	421.02.130	A5419970645	O-ring - Anillo	01un.
6	421.02.415	F 00R J00 220	O-ring - Anillo	02un.
8	808.10.010	-	Shim - Calzo	01un.



SPARE PARTS				
Repuestos				
Nº	ROBIEL CODE	REFERENCE	DESCRIPTION	PACK
1	190.50.11	F 00V C05 001	Ball Diameter 1.34mm Bolilla de Valvula Diametro 1.34mm	12un.
3A	600.02.07	F 00V C17 503 F 00R J01 453	Washer - Cummins Nozzle Arandela de la Tobera Cummins	1.50mm 24un.
3B	600.02.08	F 00V C17 505 F 00R J01 086	Washer - MWM Nozzle Arandela de la Tobera MWM	2.00mm 24un.
4	421.01.130	2 430 210 082 A5419970545	O-Ring 11.00 x 3.00mm Anillo 11.00 x 3.00mm	10un.
5	421.02.130	2 430 210 081 A5419970645	O-Ring 21.00 x 3.00mm Anillo 21.00 x 3.00mm	10un.
9A	315.06.32	F 00R J00 841	Nut - Nozzle-Retaining Cummins CP3 Injector Tapa de la Tobera Del Inyector Cummins CP3	01un.
9B	315.06.56	F 00R J00 713 F 00R J02 219	Nut - Nozzle-Retaining MWM 412 TCE Tapa de la Tobera Del Inyector MWM 412 TCE	04un.
10A	424.08.10C	F 00V C38 002 F 00R J02 176 F 00V C99 002	Repair Parts - Common Rail Injector Rod Reparacion Inyector Baston Common Rail	04kit.
10B	424.08.10D	F 00V C99 002 + Esfera	Repair Parts - Common Rail Injector Rod - Ball Ø1.34mm Reparacion Inyector Baston Common Rail - Bolilla Ø1.34mm	01kit.
10C	424.08.10E	F 00V C99 002 + Esfera	Repair Parts - Common Rail Injector Rod - Ball Ø1.50mm Reparacion Inyector Baston Common Rail - Bolilla Ø1.50mm	01kit.
11A	165.02.15	Inyectores c/ Caneta	Connection W/Filter - Delphi/Bosch M14 CR Injector Conexion C/ Filtro p/ Inyector CR Delphi/Bosch	01un.
11B	165.02.16	Inyectores s/ Caneta	Connection W/Filter - MWM M14 CR Injector Conexion C/ Filtro p/ Inyector CR MWM	01un.
17	220.03.08	-	Protective Cap - Injectors / Units Nozzle - 7.00mm Tapa Protectora p/ Tobera Inyectores / Unidades - 7.00mm	01kit.





12	SHIM - MWM/CUMMINS PRE-INJECTION (MFK) CALZO DE PRE INYECCION MWM/CUMMINS		
	Ø Int.: 2.25 Ø Ext.: 4.00		
	ROBIEL CODE	REFERENCE	THICKNESS(mm)
○	802.04.10	F 00R J00 778	1.00
	802.04.105	F 00R J00 784	1.05
	802.04.11	F 00R J00 787	1.10
	802.04.115	F 00R J00 793	1.15
	802.04.12	F 00R J00 799	1.20
	802.04.125	F 00R J00 802	1.25
	802.04.13	F 00R J00 808	1.30
	802.04.135	F 00R J00 814	1.35
	802.04.14	F 00R J00 817	1.40
	802.04.145	F 00R J00 823	1.45
	802.04.15	F 00R J00 837	1.50
	802.04.155	F 00R J00 840	1.55
	802.04.16	F 00R J00 846	1.60
	802.04.165	-	1.65
	802.04.17	-	1.70
06 UNITS			

13	SHIM - CR INJECTOR NOZZLE (DFK) CALZO TOBERA INYECTOR CR		
	Ø Int.: 3.50 Ø Ext.: 5.30		
	ROBIEL CODE	REFERENCE	THICKNESS(mm)
○	803.05.09	-	0.90
	803.05.095	-	0.95
	803.05.10	F 00V C10 460	1.00
	803.05.105	F 00V C10 464	1.05
	803.05.11	F 00V C10 470	1.10
	803.05.115	F 00V C10 474	1.15
	803.05.12	F 00V C10 480	1.20
	803.05.125	F 00V C10 484	1.25
	803.05.13	F 00V C10 490	1.30
	803.05.135	F 00V C10 494	1.35
	803.05.14	F 00V C10 500	1.40
	803.05.145	F 00V C10 504	1.45
	803.05.15	F 00V C10 510	1.50
	803.05.155	F 00V C10 514	1.55
	803.05.16	F 00V C10 520	1.60
	803.05.165	F 00V C10 524	1.65
	803.05.17	F 00V C10 530	1.70
	803.05.175	F 00V C10 534	1.75
	803.05.18	F 00V C10 540	1.80
	803.05.19	F 00V C10 550	1.90
	803.05.20	F 00V C10 560	2.00
06 UNITS			

INJECTORS INYECTORES

RESTRICTOR	RESTRICTOR	RESTRICTOR	RESTRICTOR	RESTRICTOR	RESTRICTOR	RESTRICTOR	INTERMEDIATE PIN	INTERMEDIATE PIN	INTERMEDIATE PIN
CRIN 1 1.6	CRIN 1 1.6	CRIN 1 1.6	CRIN 1 1.6	CRIN 1 1.6	CRIN 1 1.6	CRIN 1 1.6	CRIN 1 1.6	CRIN 1 1.6	CRIN 1 1.6
0 445 120 025	0 445 120 040	0 445 120 108	0 445 120 133	0 445 120 208	0 445 120 250	0 445 120 330	0 445 120 009	0 445 120 119	0 445 120 079
0 445 120 029	0 445 120 041	0 445 120 112	0 445 120 140	0 445 120 209	0 445 120 251	INTERMEDIATE PIN	0 445 120 010	0 445 120 020	0 445 120 084
0 445 120 031	0 445 120 051	0 445 120 115	0 445 120 144	0 445 120 210	0 445 120 252	CRIN 1 1.6	0 445 120 011	0 445 120 021	0 445 120 085
0 445 120 033	0 445 120 052	0 445 120 119	0 445 120 151	0 445 120 211	0 445 120 253	0 445 120 002	0 445 120 012	0 445 120 022	0 445 120 089
0 445 120 034	0 445 120 059	0 445 120 120	0 445 120 152	0 445 120 212	0 445 120 254	0 445 120 003	0 445 120 013	0 445 120 028	0 445 120 103
0 445 120 035	0 445 120 060	0 445 120 121	0 445 120 159	0 445 120 231	0 445 120 255	0 445 120 004	0 445 120 014	0 445 120 032	0 445 120 113
0 445 120 036	0 445 120 70	0 445 120 122	0 445 120 173	0 445 120 238	0 445 120 256	0 445 120 005	0 445 120 015	0 445 120 043	0 445 120 114
0 445 120 037	0 445 120 094	0 445 120 123	0 445 120 174	0 445 120 239	0 445 120 272	0 445 120 006	0 445 120 016	0 445 120 046	-
0 445 120 038	0 445 120 096	0 445 120 125	0 445 120 175	0 445 120 240	0 445 120 273	0 445 120 007	0 445 120 017	0 445 120 069	-
0 445 120 039	0 445 120 097	0 445 120 132	0 445 120 176	0 445 120 241	0 445 120 300	0 445 120 008	0 445 120 018	0 445 120 077	-

15	SHIM - CR REGULATOR (RLS) CALZO REGULACION COMMON RAIL		
	Ø Int.: 19.00 Ø Ext.: 24.00		
ROBIEL CODE	REFERENCE	THICKNESS(mm)	
819.24.100	-	1.00	
819.24.102	-	1.02	
819.24.104	-	1.04	
819.24.106	-	1.06	
819.24.108	-	1.08	
819.24.110	-	1.10	
819.24.112	-	1.12	
819.24.114	-	1.14	
819.24.116	-	1.16	
819.24.125	F 00R J00 128	1.25	
819.24.126	F 00R J00 130	1.26	
819.24.127	F 00R J00 132	1.27	
819.24.128	F 00R J00 134	1.28	
819.24.129	F 00R J00 136	1.29	
819.24.130	F 00R J00 138	1.30	
819.24.131	F 00R J00 140	1.31	
819.24.132	F 00R J00 142	1.32	
819.24.133	F 00R J00 144	1.33	
819.24.134	F 00R J00 146	1.34	
819.24.135	F 00R J00 148	1.35	
04 UNITS			



14	SHIM - CR REGULATOR (AH) CALZO REGULACION COMMON RAIL		
	Ø Int.: 18.00 Ø Ext.: 24.00		
ROBIEL CODE	REFERENCE	THICKNESS(mm)	
818.24.085	-	0.85	
818.24.088	-	0.88	
818.24.092	-	0.92	
818.24.093	-	0.93	
818.24.094	-	0.94	
818.24.095	F 00R J00 024	0.95	
818.24.096	-	0.96	
818.24.097	F 00R J00 034	0.97	
818.24.098	-	0.98	
818.24.099	F 00R J00 044	0.99	
818.24.100	-	1.00	
818.24.101	F 00R J00 054	1.01	
818.24.102	-	1.02	
818.24.103	F 00R J00 064	1.03	
818.24.105	F 00R J00 074	1.05	
818.24.107	F 00R J00 084	1.07	
818.24.109	F 00R J00 094	1.09	
04 UNITS			



16
PIN - MWM INJECTOR (DNH)
 TOP DEL INYECTOR MWM

ROBIEL CODE	REFERENCE	THICKNESS(mm)
305.20.830	F 00V C12 408	8.30
305.20.831	F 00V C12 412	8.31
305.20.832	F 00V C12 416	8.32
305.20.833	F 00V C12 420	8.33
305.20.834	-	8.34
305.20.835	F 00V C12 424	8.35
305.20.836	F 00V C12 428	8.36
305.20.837	F 00V C12 432	8.37
305.20.838	F 00V C12 436	8.38
305.20.839	-	8.39
305.20.840	F 00V C12 440	8.40
305.20.841	F 00V C12 444	8.41
305.20.842	F 00V C12 448	8.42
305.20.843	F 00V C12 452	8.43
305.20.844	F 00V C12 456	8.44
305.20.845	F 00V C12 460	8.45
305.20.846	-	8.46
305.20.847	F 00V C12 464	8.47
305.20.848	F 00V C12 468	8.48
305.20.849	F 00V C12 472	8.49

04 UNITS
16
PIN - CUMMINS / DUCATO INJECTOR (DNH)
 TOP DEL INYECTOR CUMMINS/DUCATO

ROBIEL CODE	REFERENCE	THICKNESS(mm)
305.30.834	F 00V C12 322	8.34
305.30.835	F 00V C12 324	8.35
305.30.836	F 00V C12 328	8.36
305.30.837	F 00V C12 332	8.37
305.30.838	F 00V C12 334	8.38
305.30.839	F 00V C12 338	8.39
305.30.840	F 00V C12 340	8.40
305.30.841	F 00V C12 344	8.41
305.30.842	F 00V C12 348	8.42
305.30.843	F 00V C12 352	8.43
305.30.844	F 00V C12 354	8.44
305.30.845	F 00V C12 358	8.45
305.30.846	F 00V C12 362	8.46
305.30.847	F 00V C12 364	8.47
305.30.848	F 00V C12 368	8.48
305.30.849	F 00V C12 372	8.49
305.30.850	F 00V C12 374	8.50
305.30.851	F 00V C12 378	8.51
305.30.852	F 00V C12 382	8.52
305.30.853	F 00V C12 384	8.53
305.30.854	F 00V C12 388	8.54
305.30.855	F 00V C12 392	8.55

04 UNITS

415.00.011

PARTS SET - CRI/CRIN REPAIRING - R2
JUEGO PIEZAS REPARACION CRI / CRIN - R2

Nº	ROBIEL CODE	DESCRIPTION	THICKNESS(mm)	UNITS BY MEASURE
DNH	305.20.830 - 305.20.849	Pin-MWM Injector - <i>Top del Injector MWM</i>	8.30 to 8.49	12 units
DNH	305.30.834 - 305.30.855	Pin-Cummins/Ducato Injector - <i>Top del Injector Cummins/Ducato</i>	8.34 to 8.55	12 units
-	800.02.100 - 800.02.125	Shim - Hold - <i>Calzo Restrictor</i>	1.00 to 1.25	12 units
MFK	802.04.10 - 802.04.125	Shim - Pre Injection - <i>Calzo de pre Inyeccion</i>	1.00 to 1.25	12 units
DFK	803.05.12 - 803.05.19	Shim-Piezo-Nozzle - <i>Calzo Tobera Inyector Piezo</i>	1.20 to 1.90	12 units
-	803.06.140 - 803.06.160	Shim - Coil - <i>Calzo Bobina</i>	1.40 to 1.60	12 units
-	810.16.117 - 810.16.127	Shim - Pressure Sprinter - <i>Calzo Presion Sprinter</i>	1.17 to 1.27	12 units
AH	818.24.092 - 818.24.103	Shim-CR CP3 Regulator - <i>Calzo Regulacion CP3</i>	0.92 to 1.03	12 units
RLS	819.24.125 - 819.24.135	Shim-CR CP3 Regulator - <i>Calzo Regulacion CP3</i>	1.25 to 1.35	12 units
-	819.25.094 - 819.25.110	Shim - Adjustment - Debit - <i>Calzo Ajuste Debito</i>	0.94 to 1.10	12 units

1740 UNITS

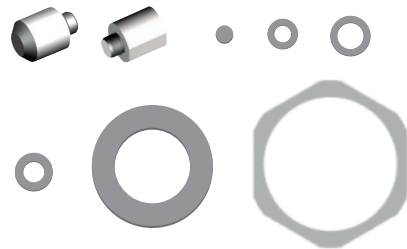

323.01.3241

Rotating Vise W /
Indexer Pin
Morsa Giratoria con Pin index



324.15.01

Injectors Repair Bracket
Soporte para reparacion de Inyectores



323.02.121

Cleaning Brush
Cepillo de Limpeza
Ø 12.00mm

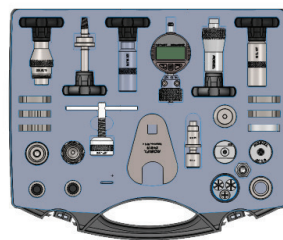

323.50.072

Bosch CRI 1.0 / 2.0 / 2.1 /
2.2 / CRIN 1 / 1.6 Injectors
Tool Kit
Kit de herramientas Inyectores Bosch
CRI 1.0 / 2.0 / 2.1 / 2.2 / CRIN 1 / 1.6



323.02.29

Tightness test Tool -
CRI/CRIN Valve
Herramienta Prueba Estanqueidad
Valvula CRI/CRIN



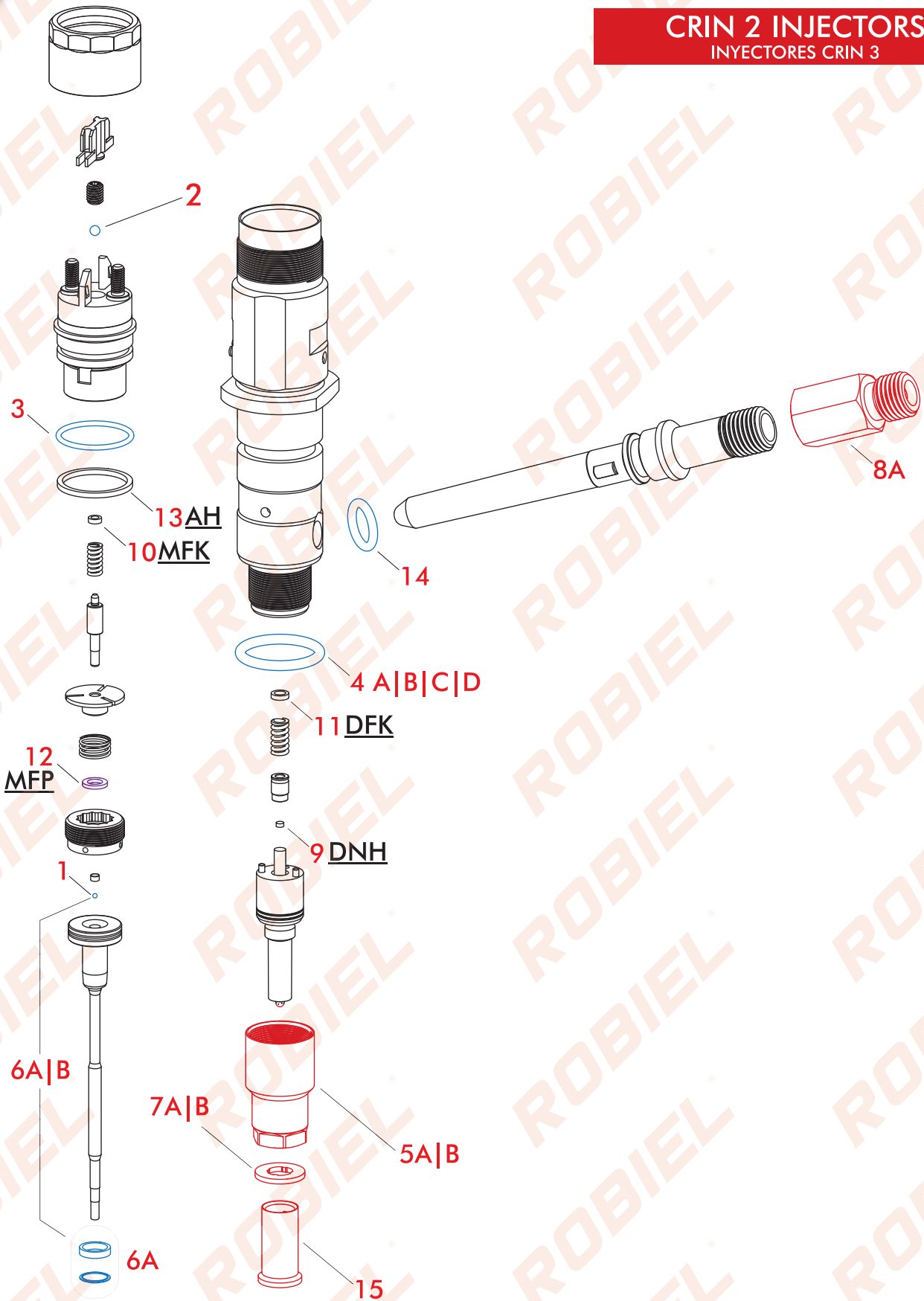

CRIN 2 INJECTORS
INYECTORES CRIN 3

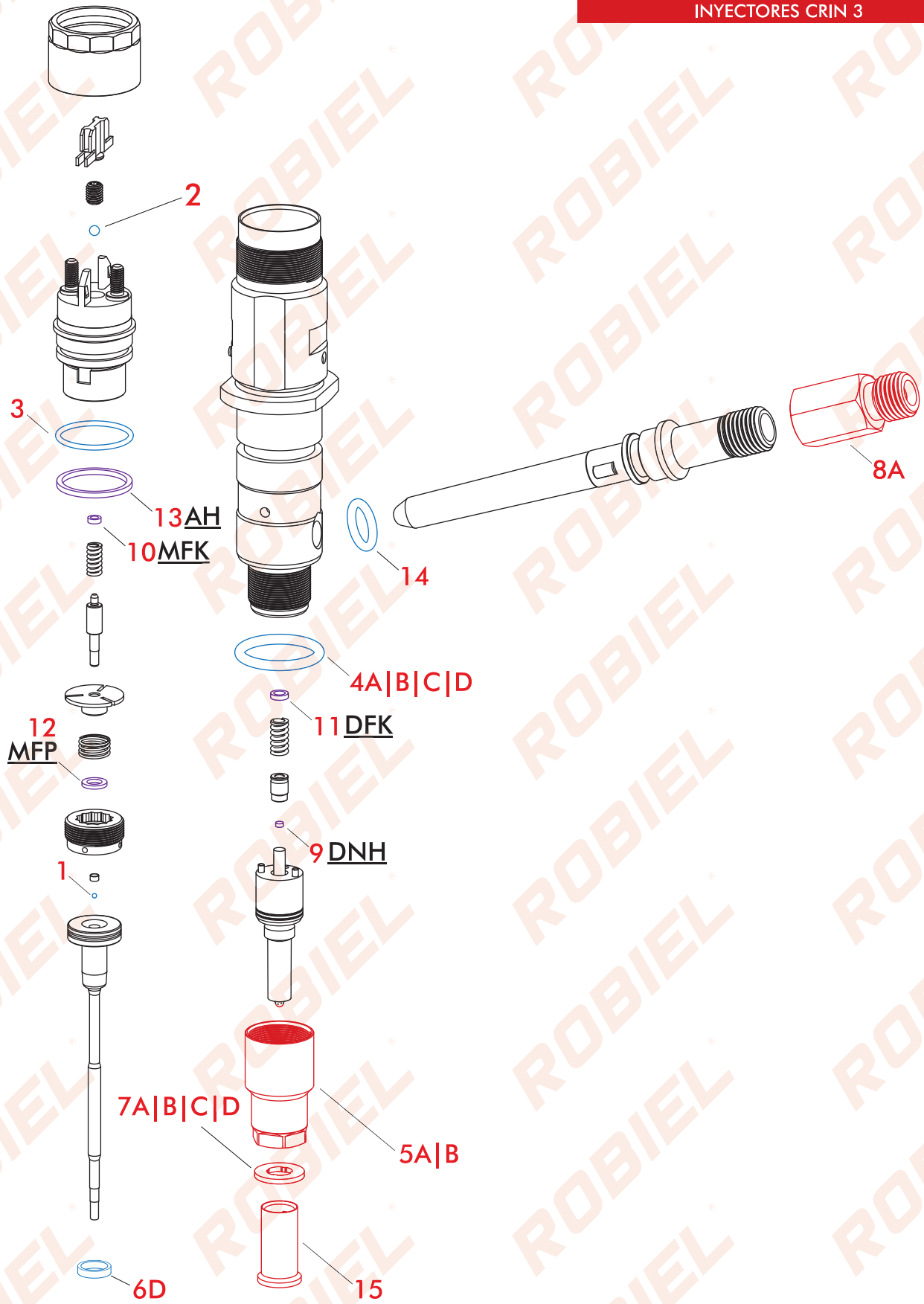

CRIN 3 INJECTORS
INYECTORES CRIN 3



410.00.37		REPAIR PARTS - CUMMINS CRIN 2/ EURO V INJECTOR		
APPLICATION		CUMMINS		
Nº	ROBIEL CODE	REFERENCE	DESCRIPTION	PACK
1	190.50.11	F 00V C05 001	Ball - Bolilla Ø1.35mm	01un.
2	190.50.16	F 00R C00 556	Ball - Bolilla Ø3.00mm	01un.
3	421.02.015	F 00R J00 222	O-ring - Anillo	01un.
4B	421.02.130	2 430 210 081	O-ring - Anillo	01un.
14	421.01.130	2 430 210 082	O-ring - Anillo	01un.
6A	424.08.10C	F 00V C99 002 F 00R J02 176	Repair Parts - Common Rail Injector Rod Reparacion Inyector Baston Common Rail	01kit.
7A	600.02.07	F 00V C17 503 F 00R 501 453	Washer - Arandela 7.00x15.00x1.50	01un.

410.00.38		REPAIR PARTS - CUMMINS CRIN 3/ EURO V INJECTOR		
APPLICATION		CUMMINS		
Nº	ROBIEL CODE	REFERENCE	DESCRIPTION	PACK
1	190.50.11	F 00V C05 001	Ball - Bolilla Ø1.35mm	01un.
2	190.50.16	F 00R C00 556	Ball - Bolilla Ø3.00mm	01un.
6B	424.07.917	F 00R J02 177	Teflon Ring - Anillo Teflon	01un.
4B	421.02.130	2 430 210 081	O-ring - Anillo	01un.
14	421.01.130	2 430 210 082	O-ring - Anillo	01un.
3	421.02.015	F 00R J00 222	O-ring - Anillo	01un.
7A	600.02.07	F 00V C17 503 F 00R 501 453	Washer - Arandela 7.00x15.00x1.50	01un.



410.00.39		REPAIR PARTS - MWM CRIN 3/ EURO V INJECTOR		
APPLICATION		MWM		
Nº	ROBIEL CODE	REFERENCE	DESCRIPTION	PACK
1	190.50.11	F 00V C05 001	Ball - Bolilla Ø1.35mm	01un.
2	190.50.16	F 00R C00 556	Ball - Bolilla Ø3.00mm	01un.
3	421.02.015	F 00R J00 222	O-ring - Anillo	01un.
6B	424.07.917	F 00R J02 177	Teflon Ring - Anillo Teflon	01un.
4C	421.01.720	-	O-ring - Anillo	01un.
7B	600.02.08	F 00V C17 505 F 00R J01 086	Washer - Arandela 7.00x15.00x2.00	01un.



410.00.40		REPAIR PARTS - MAN CRIN 3		
INJECTORS		0 445 120 162 0 445 120 186		
Nº	ROBIEL CODE	REFERENCE	DESCRIPTION	PACK
1	190.50.11	F 00V C05 001	Ball - Bolilla Ø1.35mm	01un.
2	190.50.16	F 00R C00 556	Ball - Bolilla Ø3.00mm	01un.
3	421.02.015	F 00R J00 222	O-ring - Anillo	01un.
4D	421.02.430	F 00R J00 534	O-ring - Anillo	01un.
6D	424.07.917	F 00R J02 177	Teflon Ring - Anillo Teflon	01un.
7D	600.02.10	F 00R J02 175	Washer - Arandela	01un.









410.00.41		REPAIR SET - MAN INJECTOR CRIN2					
		REPARACION INYECTOR MAN CRIN2					
INJECTORS		0 445 120 044 0 445 120 045 0 445 120 055					
Nº	ROBIEL CODE	REFERENCE	DESCRIPTION	PACK			
1	190.50.11	F 00V C05 001	Ball - Bolilla Ø1.35mm	01un.			
2	190.50.16	F 00R C00 556	Ball - Bolilla Ø3.00mm	01un.			
3	421.02.015	F 00R J00 222	O-ring - Anillo	01un.			
4D	421.02.430	F 00R J00 534	O-ring - Anillo	01un.			
6A	424.08.10C	F 00V C99 002 F 00R J02 176	Repair Parts - Common Rail Injector Rod Reparacion Inyector Baston Common Rail	01un.			
7D	600.02.10	F 00R J02 175	Washer - Arandela	01un.			

410.20.092		REPAIR SET - INJECTOR CRIN 2 3					
		REPARACION INYECTOR CRIN 2 3					
APPLICATION		IVECO CASE NH					
Nº	ROBIEL CODE	REFERENCE	DESCRIPTION	PACK			
1	190.50.11	F 00V C05 001	Ball - Bolilla Ø1.35mm	01un.			
2	190.50.16	F 00R C00 556	Ball - Bolilla Ø3.00mm	01un.			
3	421.02.015	F 00R J00 222	O-ring - Anillo	01un.			
4A	421.02.835	-	O-ring - Anillo	01un.			

SPARE PARTS
Repuestos

Nº	ROBIEL CODE	REFERENCE	DESCRIPTION	PACK
1	190.50.11	F 00V C05 001	Ball Diameter 1.34mm Bolilla de Valvula Diametro 1.34mm	12un.
5A	315.06.56	F 00R J00 713 F 00R J02 219	Nut - Nozzle-Retaining MWM 412 TCE Tapa de la Tobera Del Inyector MWM 412 TCE	04un.
5B	315.06.57	F 00R J00 842	Nut - Nozzle-Retaining Iveco / Case / NH Tapa de la Tobera Del Inyector Iveco / Case / NH	01un.
6A	424.08.10C	F 00V C99 002 F 00R J02 176	Repair Parts - Common Rail Injector Rod Reparacion Inyector Baston Common Rail	04kit.
6B	424.08.10D	F 00V C99 002 + Esfera	Repair Parts - Common Rail Injector Rod - Ball Ø1.34mm Reparacion Inyector Baston Common Rail - Bolilla Ø1.34mm	01kit.
6C	424.08.10E	F 00V C99 002 + Esfera	Repair Parts - Common Rail Injector Rod - Ball Ø1.50mm Reparacion Inyector Baston Common Rail - Bolilla Ø1.50mm	01kit.
6D	424.07.917	F00R J02 177	Teflon O-rin - CRIN 3 Anillo Teflon - CRIN 3	06un.
7A	600.02.07	F 00V C17 503 F 00R J01 453	Washer - Cummins Nozzle Arandela de la Tobera Cummins	1.50mm 24un.
7B	600.02.08	F 00V C17 505 F 00R J01 086	Washer - MWM Nozzle Arandela de la Tobera MWM	2.00mm 24un.
7C	600.07.17	CASE 504 262 598	Washer - Case Magnum MX325Injector Arandela de lo Inyector Case Magnum MX235	12un.
7D	600.02.10	F 00R J02 175	Washer - MAN Nozzle Arandela de la Tobera MAN	06un.
8A	165.02.15	INJECTORS c/ Caneta	Connection W/Filter - Delphi/Bosch M14 CR Injector Conexion C/ Filtro p/ Inyector CR Delphi/Bosch	01un.
8B	165.02.16	INJECTORS s/ Caneta	Connection W/Filter - MWM M14 CR Injector Conexion C/ Filtro p/ Inyector CR MWM	01un.
15	220.03.08	-	Protective Cap - Injectors / Units Nozzle - 7.00mm Tapa Protectora p/ Tobera Inyectores / Unidades - 7.00mm	01kit.
R1	421.02.430	F 00R J00 534	O-ring - External - MAN Injector Anillo Externo Inyector MAN	06un.

<p>1  Ø 1.34 mm</p> <p>5A </p> <p>5B </p>	<p>6A </p> <p>6B </p> <p>6C </p> <p>6D </p>	<p>7A  Ø INT: 7.50mm Ø EXT: 17.00mm Thickness: 1.50mm</p> <p>7B  Ø INT: 7.50mm Ø EXT: 17.00mm Thickness: 2.00mm</p> <p>7C  Ø INT: 7.50mm Ø EXT: 17.00mm</p> <p>7D </p>	<p>8A  M14 X 1.50</p> <p>8B  M14 X 1.50</p> <p>17 </p> <p>R1 </p>
---	---	--	---

9	SHIM - HOLD - COMMON RAIL NOZZLE (DNH) CALZO RESTRICTOR TOBERA COMMON RAIL		
	Ø Ext.: 2.30 		
ROBIEL CODE	REFERENCE	THICKNESS(mm)	
800.02.110	F 00V C12 520	1.10	
800.02.113	F 00V C12 526	1.13	
800.02.115	F 00V C12 530	1.15	
800.02.118	F 00V C12 536	1.18	
800.02.120	F 00V C12 540	1.20	
800.02.123	F 00V C12 546	1.23	
800.02.125	F 00V C12 550	1.25	
06 UNITS			

11	SHIM - CR INJECTOR NOZZLE (DFK) CALZO TOBERA INYECTOR CR		
	Ø Int.: 3.50 Ø Ex.: 5.30 		
ROBIEL CODE	REFERENCE	THICKNESS(mm)	
803.05.07	-	0.70	
803.05.075	-	0.75	
803.05.08	-	0.80	
803.05.085	-	0.85	
803.05.09	-	0.90	
803.05.095	-	0.95	
803.05.10	F 00V C10 460	1.00	
803.05.105	F 00V C10 464	1.05	
803.05.11	F 00V C10 470	1.10	
803.05.115	F 00V C10 474	1.15	
803.05.12	F 00V C10 480	1.20	
803.05.125	F 00V C10 484	1.25	
803.05.13	F 00V C10 490	1.30	
803.05.135	F 00V C10 494	1.35	
803.05.14	F 00V C10 500	1.40	
803.05.145	F 00V C10 504	1.45	
803.05.15	F 00V C10 510	1.50	
803.05.155	F 00V C10 514	1.55	
803.05.16	F 00V C10 520	1.60	
803.05.165	F 00V C10 524	1.65	
803.05.17	F 00V C10 530	1.70	
803.05.175	F 00V C10 534	1.75	
803.05.18	F 00V C10 540	1.80	
803.05.19	F 00V C10 550	1.90	
803.05.20	F 00V C10 560	2.00	
06 UNITS			

10	SHIM - MWM/CUMMINS PRE-INJECTION (MFK) CALZO DE PRE INYECCION MWM/CUMMINS		
	Ø Int.: 2.25 Ø Ext.: 4.00 		
ROBIEL CODE	REFERENCE	THICKNESS(mm)	
802.04.10	F 00R J00 778	1.00	
802.04.105	F 00R J00 784	1.05	
802.04.11	F 00R J00 787	1.10	
802.04.115	F 00R J00 793	1.15	
802.04.12	F 00R J00 799	1.20	
802.04.125	F 00R J00 802	1.25	
802.04.13	F 00R J00 808	1.30	
802.04.135	F 00R J00 814	1.35	
802.04.14	F 00R J00 817	1.40	
802.04.145	F 00R J00 823	1.45	
802.04.15	F 00R J00 837	1.50	
802.04.155	F 00R J00 840	1.55	
802.04.16	F 00R J00 846	1.60	
802.04.165	-	1.65	
802.04.17	-	1.70	
06 UNITS			

12	SHIM - INJECTOR SOLENOID BALL COURSE (MFP) CALZO CARRERA DE APERTURA BOLILLA SOLEN INYECTOR		
	Ø Int.: 4.50 Ø Ext.: 7.70 		
ROBIEL CODE	REFERENCE	THICKNESS(mm)	
805.07.100	F 00R J01 009	1.00	
805.07.101	-	1.01	
805.07.102	-	1.02	
805.07.103	-	1.03	
805.07.104	F 00R J01 010	1.04	
805.07.105	-	1.05	
805.07.106	-	1.06	
805.07.107	-	1.07	
805.07.108	F 00R J01 018	1.08	
805.07.109	-	1.09	
805.07.110	F 00R J01 020	1.10	
805.07.111	-	1.11	
805.07.112	F 00R J01 022	1.12	
06 UNITS			

* APPLICATION: 0 445 120 092 / 0 445 120 157
Iveco | Case New Holland

13

SHIM - INJECTORS COIL (AH)

CALZO BOBINA INYECCION

Ø Int.: 19.60 Ø Ext.: 22.80

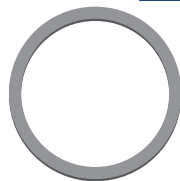

ROBIEL CODE	REFERENCE	THICKNESS(mm)
819.22.150	-	1.50
819.22.151	-	1.51
819.22.152	-	1.52
819.22.153	-	1.53
819.22.154	F 00R J00 883	1.54
819.22.155	-	1.55
819.22.156	F 00R J00 893	1.56
819.22.157	-	1.57
819.22.158	F 00R J00 903	1.58
819.22.159	-	1.59
819.22.160	F 00R J00 913	1.60

06 UNITS

* APPLICATION: 0 445 120 092 / 0 445 120 157
Iveco | Case New Holland

INJECTORS INYECTORES

CRIN 2	CRIN 2	CRIN 2	CRIN 2	CRIN 2	CRIN 2	CRIN 3	CRIN 3	CRIN 3	CRIN 3.3
0 445 120 024	0 445 120 078	0 445 120 130	0 445 120 164	0 445 120 222	0 445 120 264	0 445 120 050	0 445 120 184	0 445 120 257	0 445 120 058
0 445 120 026	0 445 120 080	0 445 120 131	0 445 120 165	0 445 120 223	0 445 120 265	0 445 120 071	0 445 120 185	0 445 120 258	0 445 120 095
0 445 120 030	0 445 120 081	0 445 120 134	0 445 120 166	0 445 120 224	0 445 120 266	0 445 120 092	0 445 120 186	0 445 120 259	0 445 120 109
0 445 120 044	0 445 120 083	0 445 120 136	0 445 120 169	0 445 120 225	0 445 120 268	0 445 120 118	0 445 120 187	0 445 120 267	0 445 120 243
0 445 120 045	0 445 120 086	0 445 120 137	0 445 120 170	0 445 120 226	0 445 120 274	0 445 120 135	0 445 120 188	0 445 120 269	W/ CONNECTOR
0 445 120 053	0 445 120 087	0 445 120 138	0 445 120 182	0 445 120 227	0 445 120 275	0 445 120 143	0 445 120 193	0 445 120 276	0 445 120 047
0 445 120 054	0 445 120 088	0 445 120 139	0 445 120 183	0 445 120 228	0 445 120 277	0 445 120 157	0 445 120 197	0 445 120 279	0 445 120 048
0 445 120 055	0 445 120 098	0 445 120 141	0 445 120 190	0 445 120 232	0 445 120 278	0 445 120 161	0 445 120 199	0 445 120 281	0 445 120 049
0 445 120 056	0 445 120 099	0 445 120 142	0 445 120 191	0 445 120 234	0 445 120 289	0 445 120 162	0 445 120 201	0 445 120 282	0 445 120 072
0 445 120 057	0 445 120 100	0 445 120 145	0 445 120 192	0 445 120 236	0 445 120 290	0 445 120 167	0 445 120 202	0 445 120 327	0 445 120 073
0 445 120 061	0 445 120 101	0 445 120 146	0 445 120 196	0 445 120 237	0 445 120 291	0 445 120 177	0 445 120 204	W/ CONNECTOR	0 445 120 076
0 445 120 062	0 445 120 102	0 445 120 147	0 445 120 200	0 445 120 242	0 445 120 292	0 445 120 178	0 445 120 216	0 445 120 042	0 445 120 090
0 445 120 063	0 445 120 105	0 445 120 148	0 445 120 203	0 445 120 244	0 445 120 293	0 445 120 179	0 445 120 229	0 445 120 082	0 445 120 091
0 445 120 064	0 445 120 106	0 445 120 149	0 445 120 213	0 445 120 245	0 445 120 294	0 445 120 180	0 445 120 233	-	0 445 120 093
0 445 120 065	0 445 120 107	0 445 120 150	0 445 120 215	0 445 120 246	0 445 120 295	0 445 120 181	0 445 120 235	-	0 445 120 126
0 445 120 066	0 445 120 110	0 445 120 153	0 445 120 217	0 445 120 247	W/ CONNECTOR	-	-	-	-
0 445 120 067	0 445 120 111	0 445 120 154	0 445 120 218	0 445 120 260	0 445 120 027	-	-	-	-
0 445 120 068	0 445 120 117	0 445 120 155	0 445 120 219	0 445 120 261	-	-	-	-	-
0 445 120 074	0 445 120 124	0 445 120 156	0 445 120 220	0 445 120 262	-	-	-	-	-
0 445 120 075	0 445 120 127	0 445 120 158	0 445 120 221	0 445 120 263	-	-	-	-	-

415.00.021

PARTS SET - CRIN2 / CRIN 3 REPAIRING - R2
 JUEGO PIEZAS REPARACION CRIN 2 / CRIN 3- R2

Nº	ROBIEL CODE	DESCRIPTION	THICKNESS(mm)	UNITS BY MEASURE
AH	819.22.150 - 819.22.160	Shim - Coil - <i>Calzo Bobina Iveco Case NH</i>	1.50 to 1.60	12 units
MFK	802.04.13 - 802.04.165	Shim - Pre Injection - <i>Calzo de pre Inyeccion MWM Cummins</i>	1.30 to 1.70	12 units
MFP	805.07.100 - 805.07.112	Shim - Injector Solenoid Ball Course <i>Calzo Carrera de Apertura Bolilla Solen Inyector</i>	1.00 to 1.12	12 units
DFK	803.05.12 - 803.05.16	Shim-Piezo-Nozzle - <i>Calzo Tobera Inyector Piezo</i>	1.20 to 1.60	12 units
DNH	800.02.110 - 800.02.125	Shim - Hold - <i>Calzo Restrictor</i>	1.10 to 1.25	12 units

576 UNITS



323.01.3241

Rotating Vise W /
Indexer Pin
Morsa Giratoria con Pin index

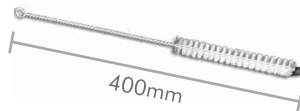

323.02.121

Cleaning Brush
Cepillo de Limpieza
Ø 12.00mm



323.01.841

Nut Wrench - Iveco/Case/NH
Injector Nozzle

Llave Wrench de la Tobera Inyector
Iveco/Case?NH
0 445 120 002|092|157|276



324.15.01

Injectors Repair Bracket
Soporte para reparación
de Inyectores



323.02.291

Tightness test Tool - CRIN 3
Valve
Herramienta Prueba Estanqueidad
Valvula CRIN 3



323.50.063

Bosch Crin 2 / Crin3 Injectors
Tool Kit
Kit de herramientas Inyectores Bosch
Crin 2 / Crin 3



G2 DENSO INJECTORS
 INYECTORES DENSO G2

JOHN DEERE INJECTORS
095000-5190
095000-6480
095000-6481
095000-6482
OTHERS
Sinotruck

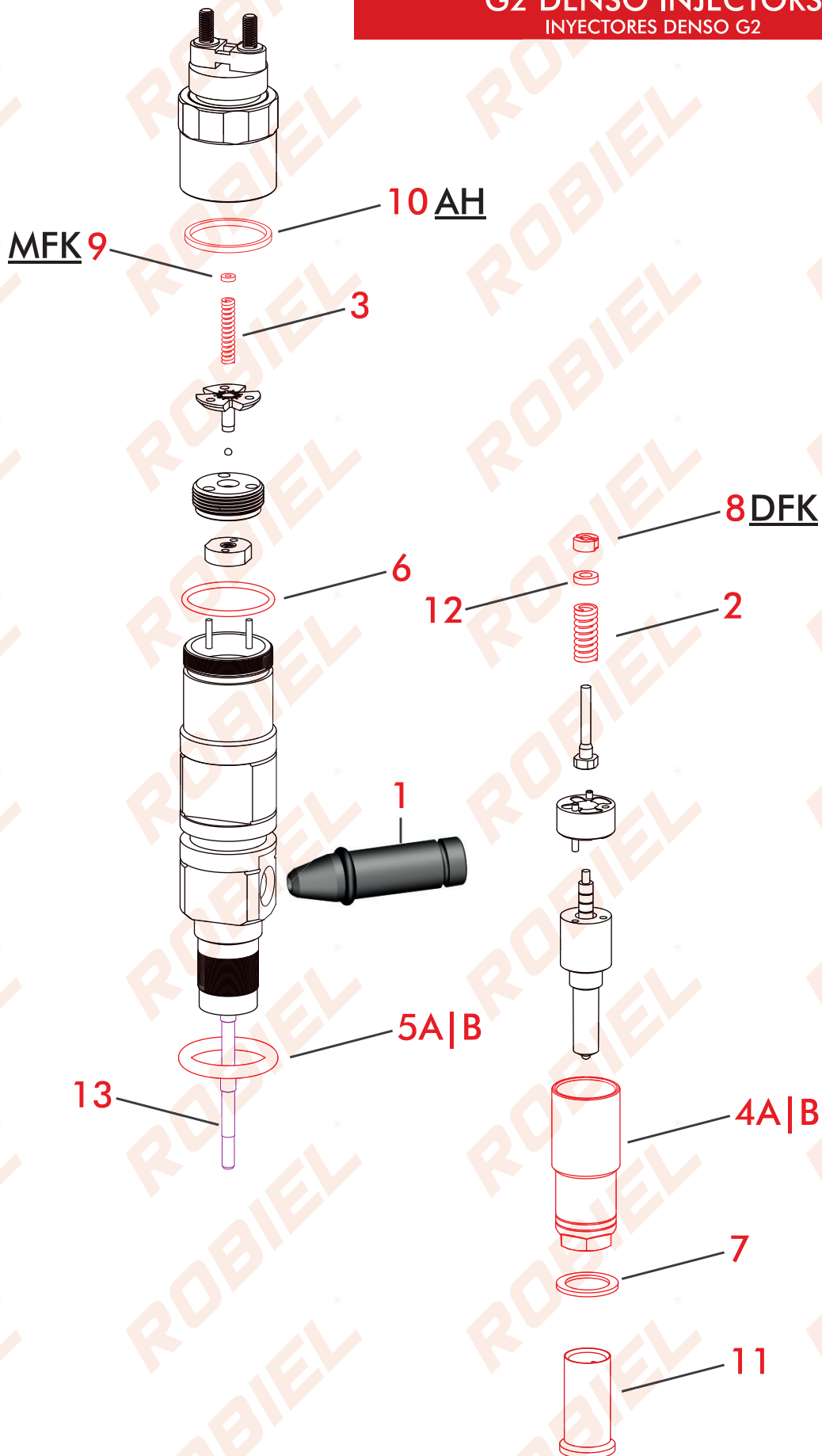

SPARE PARTS
Repuestos

Nº	ROBIEL CODE	REFERENCE	DESCRIPTION	PACK
1	165.03.06	-	Connection - Denso 5190 John Deere Injector Input <i>Conexion Entrada Inyector Denso 5190 John Deere</i>	01un.
2	225.01.38	-	Spring - Denso John Deere Injector Nozzle <i>Resorte de la Tobera Inyector Denso John Deere</i>	06un.
3	225.01.39	-	Spring - Denso John Deere / Hilux Solenoide <i>Resorte del Solenoide Denso John Deere / Hilux</i>	06un.
4A	315.06.54	-	Nut - Nozzle-Retaining Denso John Deere <i>Tapa de la Tobera Del Inyector Denso John Deere</i>	04un.
4B	315.06.34	-	Nut - Nozzle-Retaining Denso John Deere 6480/81/82 <i>Tapa de la Tobera Del Inyector Denso John Deere 6480/81/82</i>	06un.
5A	421.02.020	-	O-ring - Denso Injector 095000-5190 <i>Anillo Inyector Denso 095000-5190</i>	12un.
5B	421.02.035	-	O-ring - Denso Injector 095000-6480 / 81 / 82 <i>Anillo Inyector Denso 095000-6480 / 81 / 82</i>	06un.
6	421.02.318	-	O-ring - Denso Injector - Solenoide <i>Anillo Solenoide Inyector Denso</i>	12un.
7	807.13.20	-	Washer - Denso Nozzle <i>Arandela de la Tobera Denso</i>	48un.
11	220.03.08	-	Protective Cap - Injectors / Units Nozzle - 7.00mm <i>Tapa Protectora p/ Tobera Inyectores / Unidades - 7.00mm</i>	01kit.



8 SHIM - DENSO JOHN DEERE INJECTORS (DFK)
CALZO DEL INYECTOR DENSO JOHN DEERE

ROBIEL CODE	REFERENCE	THICKNESS(mm)
800.00.290	-	2.90
800.00.295	-	2.95
800.00.300	-	3.00
800.00.305	-	3.05
800.00.310	-	3.10

12 UNITS

9 SHIM - PRE-INJECTION - DENSO INJECTOR (MFK)
CALZO PRE INYECCION INYECTOR DENSO

Ø Int.: 1.80 Ø Ext.: 4.00

ROBIEL CODE	REFERENCE	THICKNESS(mm)
801.04.12	-	1.20
801.04.125	-	1.25
801.04.13	-	1.30
801.04.135	-	1.35
801.04.14	-	1.40
801.04.145	-	1.45
801.04.15	-	1.50

EMBALAGEM COM 06 PEÇAS

10 SHIM - DENSO 5190 INJECTOR SOLENOID (AH)
CALZO SOLENOIDE INYECTOR DENSO 5190

Ø Int.: 21.40 Ø Ext.: 24.30

ROBIEL CODE	THICKNESS(mm)	ROBIEL CODE	THICKNESS(mm)
821.24.150	1.50	821.24.161	1.61
821.24.151	1.51	821.24.162	1.62
821.24.152	1.52	821.24.163	1.63
821.24.153	1.53	821.24.164	1.64
821.24.154	1.54	821.24.165	1.65
821.24.155	1.55	821.24.166	1.66
821.24.156	1.56	821.24.167	1.67
821.24.157	1.57	821.24.168	1.68
821.24.158	1.58	821.24.169	1.69
821.24.159	1.59	821.24.170	1.70
821.24.160	1.60		

10 UNITS

12 SHIM - INJECTOR SPRING
CALZO DEL RESORTE

Ø Int.: 3.50 Ø Ext.: 6.75

ROBIEL CODE	THICKNESS(mm)
804.06.130	1.30
804.06.135	1.35
804.06.140	1.40
804.06.145	1.45
804.06.150	1.50
804.06.155	1.55
804.06.160	1.60
804.06.165	1.65
804.06.170	1.70

06 UNITS

13 **ROD - DENSO INJECTOR - 5160**
 VASTAGO INYECTOR DENSO 5160 
 Length 79.20mm

ROBIEL CODE	REFERENCE	THICKNESS(mm)
BID.01.4300	-	4.300
BID.01.4305	-	4.305

01 UNIT



13 **ROD - DENSO INJECTOR - 6490**
 VASTAGO INYECTOR DENSO 6490 
 Length 66.70mm

ROBIEL CODE	REFERENCE	THICKNESS(mm)
BID.02.4300	-	4.300
BID.02.4305	-	4.305

01 UNIT



13 **ROD - DENSO INJECTOR - 23670-0L020 (HILUX 3.0)**
 VASTAGO INYECTOR DENSO 23670-0L020 (HILUX 3.0) 
 Length 117.70mm

ROBIEL CODE	REFERENCE	THICKNESS(mm)
BID.03.4300	-	4.300
BID.03.4305	-	4.305

01 UNIT



13 **ROD - DENSO INJECTOR - 16600-EB70A**
 VASTAGO INYECTOR DENSO 16600-EB70A
 (FRONTIER/TRANSIT) 
 Length 125.85mm

ROBIEL CODE	REFERENCE	THICKNESS(mm)
BID.04.4300	-	4.300
BID.04.4305	-	4.305

01 UNIT



13 **ROD - DENSO INJECTOR - 1465A054**
 VASTAGO INYECTOR DENSO 1465A054
 (TRITON) 
 Length 125.90mm

ROBIEL CODE	REFERENCE	THICKNESS(mm)
BID.05.4305	-	4.305

01 UNIT



13 **ROD - DENSO INJECTOR - 6700**
 VASTAGO INYECTOR DENSO 6700
 (SINOTRUCK) 
 Length 77.50mm

ROBIEL CODE	REFERENCE	THICKNESS(mm)
BID.06.4300	-	4.300
BID.06.4305	-	4.305

01 UNIT



324.44.001
 Grinding Tool to Denso Rod
 Housing
 Herramienta Rectificar Alojamiento
 Baston Denso
 Ø 4.300mm 

G2 | G3 DENSO INJECTORS
INYECTORES DENSO G2 | G3

Mitsubishi L200 Triton
Nissan Frontier
Toyota Hilux

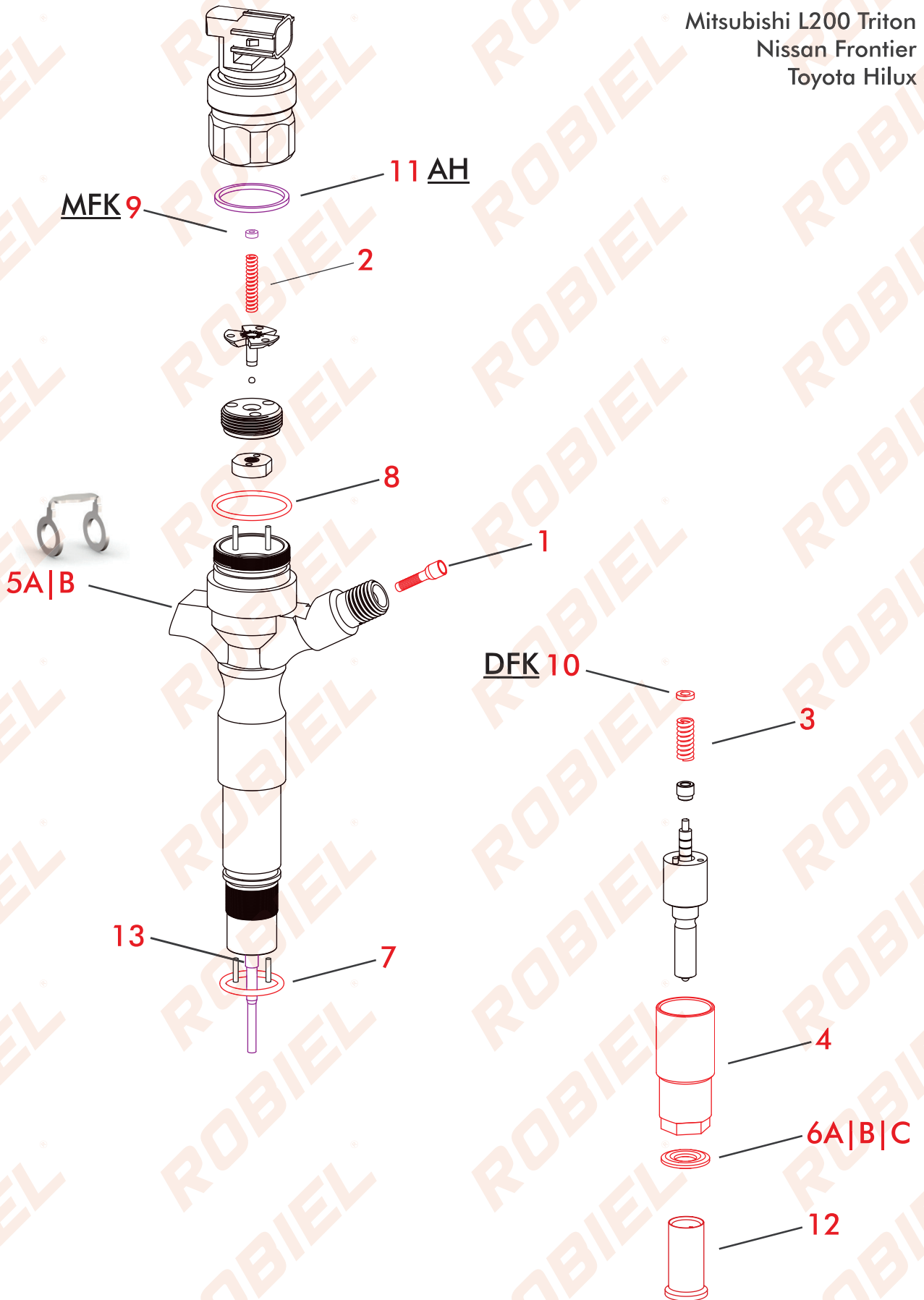

410.00.35		REPAIR SET - DENSO/HILUX INJECTOR			
		REPARACION INYECTOR DENSO HILUX			
REFERENCE					
Nº	ROBIEL CODE	REFERENCE	DESCRIPTION	PACK	
5A	602.08.13	-	Washer Double - Arandela Doble	05un.	
6B	608.16.19	-	Washer - Arandela	04un.	
7	421.01.720	-	O-ring - Anillo	04un.	
8	421.02.318	-	O-ring - Anillo	04un.	



410.00.36		REPAIR SET - DENSO/NISSAN FRONTIER INJECTOR			
		REPARACION INYECTOR DENSO NISSAN FRONTIER			
REFERENCE					
Nº	ROBIEL CODE	REFERENCE	DESCRIPTION	PACK	
5B	602.08.14	-	Washer Double - Arandela Doble	05un.	
6A	607.14.20	-	Washer - Arandela	04un.	
7	421.01.720	-	O-ring - Anillo	04un.	
8	421.02.318	-	O-ring - Anillo	04un.	



SPARE PARTS				
Repuestos				
Nº	ROBIEL CODE	REFERENCE	DESCRIPTION	PACK
1	200.02.01	093152-0320	Filter - Denso Injector <i>Filtro del Inyector Denso</i>	04un.
2	225.01.39	-	Spring - Denso John Deere / Hilux Solenoide <i>Resorte del Solenoide Denso John Deere / Hilux</i>	06un.
3	225.01.40	-	Spring - Denso Hilux Injector Nozzle Shim <i>Resorte del Calzo de la Tobera inyector Denso Hilux</i>	06un.
4	315.06.54	0 950 810 760	Nut - Nozzle-Retaining Denso John Deere <i>Tapa de la Tobera Del Inyector Denso John Deere</i>	04un.
5A	602.08.13	-	Washer - Double - Hilux <i>Arandela Doble Hilux</i>	08un.
5B	602.08.14	16635-84800	Washer - Double - Nissan Frontier <i>Arandela Doble Nissan Frontier</i>	04un.
6A	607.14.20	MN155904	Washer - L200 Triton Nozzle <i>Arandela de la Tobera L200 Triton</i>	2.00mm 48un.
6B	608.16.19	-	Washer - Hilux 3.0 Nozzle <i>Arandela de la Tobera Hilux 3.0</i>	2.00mm 48un.
6C	608.16.30	-	Washer - Hilux 3.0 Nozzle <i>Arandela de la Tobera Hilux 3.0</i>	3.00mm 12un.
7	421.01.720	F 00R OPO 397	O-ring - Hilux 3.0 Injector <i>Anillo Inyector Hilux 3.0</i>	12un.
8	421.02.318	-	O-ring - Injector - Solenoide <i>Anillo Solenoide Inyector Denso</i>	12un.
12	220.03.08	-	Protective Cap - Injectors / Units Nozzle - 7.00mm <i>Tapa Protectora p/ Tobera Inyectores / Unidades - 7.00mm</i>	01kit.



9	SHIM - PRE-INJECTION - DENSO INJECTOR (MFK) CALZO PRE INYECCION INYECTOR DENSO		
	Ø Int.: 1.80 Ø Ext.: 4.00		
	ROBIEL CODE	REFERENCE	THICKNESS(mm)
	801.04.12	-	1.20
	801.04.125	-	1.25
	801.04.13	-	1.30
	801.04.135	-	1.35
	801.04.14	-	1.40
	801.04.145	-	1.45
	801.04.15	-	1.50
06 UNITS			

10	SHIM - ADJUSTMENT - FORD RANGER NOZZLE (DFK) CALZO DE AJUSTE TOBERA FORD RANGER		
	Ø Int.: 3.00 Ø Ext.: 5.70		
	ROBIEL CODE	REFERENCE	THICKNESS(mm)
	803.02.130	-	1.30
	803.02.135	-	1.35
	803.02.140	-	1.40
	803.02.145	-	1.45
	803.02.150	-	1.50
	803.02.155	-	1.55
	803.02.160	-	1.60
	803.02.165	-	1.65
	803.02.170	-	1.70
	803.02.175	-	1.75
	803.02.180	-	1.80
	803.02.190	-	1.90
	803.02.200	-	2.00
06 UNITS			

11	SHIM - DENSO 5190 INJECTOR SOLENOID (AH) CALZO SOLENOIDE INYECTOR DENSO 5190		
	Ø Int.: 21.40 Ø Ext.: 24.30		
	ROBIEL CODE	REFERENCE	THICKNESS(mm)
	821.24.150	-	1.50
	821.24.151	-	1.51
	821.24.152	-	1.52
	821.24.153	-	1.53
	821.24.154	-	1.54
	821.24.155	-	1.55
	821.24.156	-	1.56
	821.24.157	-	1.57
	821.24.158	-	1.58
	821.24.159	-	1.59
	821.24.160	-	1.60
	821.24.161	-	1.61
	821.24.162	-	1.62
	821.24.163	-	1.63
	821.24.164	-	1.64
	821.24.165	-	1.65
	821.24.166	-	1.66
	821.24.167	-	1.67
	821.24.168	-	1.68
	821.24.169	-	1.69
	821.24.170	-	1.70
10 UNITS			

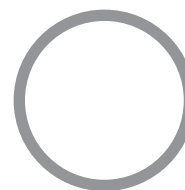

13 **ROD - DENSO INJECTOR - 5160**
 VASTAGO INYECTOR DENSO 5160 
 Length 79.20mm

ROBIEL CODE	REFERENCE	THICKNESS(mm)
BID.01.4300	-	4.300
BID.01.4305	-	4.305

01 UNIT



13 **ROD - DENSO INJECTOR - 6490**
 VASTAGO INYECTOR DENSO 6490 
 Length 66.70mm

ROBIEL CODE	REFERENCE	THICKNESS(mm)
BID.02.4300	-	4.300
BID.02.4305	-	4.305

01 UNIT



13 **ROD - DENSO INJECTOR - 23670-0L020 (HILUX 3.0)**
 VASTAGO INYECTOR DENSO 23670-0L020 (HILUX 3.0) 
 Length 117.70mm

ROBIEL CODE	REFERENCE	THICKNESS(mm)
BID.03.4300	-	4.300
BID.03.4305	-	4.305

01 UNIT



13 **ROD - DENSO INJECTOR - 16600-EB70A**
 VASTAGO INYECTOR DENSO 16600-EB70A
 (FRONTIER/TRANSIT) 
 Length 125.85mm

ROBIEL CODE	REFERENCE	THICKNESS(mm)
BID.04.4300	-	4.300
BID.04.4305	-	4.305

01 UNIT



13 **ROD - DENSO INJECTOR - 1465A054**
 VASTAGO INYECTOR DENSO 1465A054
 (TRITON) 
 Length 125.90mm

ROBIEL CODE	REFERENCE	THICKNESS(mm)
BID.05.4305	-	4.305

01 UNIT



13 **ROD - DENSO INJECTOR - 6700**
 VASTAGO INYECTOR DENSO 6700
 (SINOTRUCK) 
 Length 77.50mm

ROBIEL CODE	REFERENCE	THICKNESS(mm)
BID.06.4300	-	4.300
BID.06.4305	-	4.305

01 UNIT



324.44.001
 Grinding Tool to Denso Rod
 Housing
 Herramienta Rectificar Alojamento
 Baston Denso
 Ø 4.300mm 

415.00.031

SHIM SET - DENSO/SIEMENS REPAIRING

JUEGO CALZOS REPARACION DENSO / SIEMENS

Nº	ROBIEL CODE	DESCRIPTION	THICKNESS(mm)	UNITS BY MEASURE
AH	821.24.150 - 821.24.170	Shim - Solenoid - Calzo Solenoide	1.50 to 1.70	12 units
MFK	801.04.12 - 801.04.15	Shim - Pre Injection - Calzo Pre Inyeccion	1.20 to 1.50	12 units
DFK	800.00.290 - 800.00.310	Shim - Denso G2 - Calzo Denso G2	2.90 to 3.10	12 units
DFK	803.02.130 - 803.02.160	Shim - Adjustment - Nozzle - Calzo Del Ajuste Tobera	1.30 to 1.60	12 units
-	814.18.090 - 814.18.100	Shim - Adjustment Siemens - Calzo Del Ajuste Siemens	0.90 to 1.00	12 units

612 UNITS

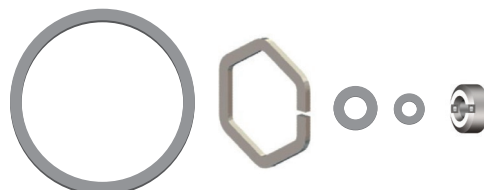

323.01.3241

Rotating Vise W / Indexer Pin
Morsa Giratoria con Pin index



324.15.01

Injectors Repair Bracket
Soporte para reparacion de Inyectores



324.15.04

Clamp Set For Denso Injector
Clip Del Inyector Denso



324.13.321

Tool To Release Denso Injector Valve
Herramienta Soltar Valvula Inyector Denso

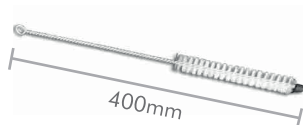

323.02.121

Cleaning Brush
Cepillo de Limpeza
Ø 12.00mm



323.50.20

Tool Set - Denso Injector Filter
Juego Herramienta Filtro Inyector Denso



323.50.081

Common Rail Denso G1 / G2 / G3 - Siemens/Continenta Injectors Tool Kit
Kit de Herramientas Inyectores Denso G1 / G2 / G3 - Siemens/Continental



SPARE PARTS
Repuestos

Nº	ROBIEL CODE	REFERENCE	DESCRIPTION	PACK
1A	165.02.06	F 00V C16 017	Connection - Pressure - Common Rail <i>Conexion de Pressão del Inyector Common Rail</i>	01un.
1B	165.02.061	-	Connection w/ Filter - Pressure - Common Rail M12X 1.50mm M12 X 1.00mm <i>Conexion c/ Filtrode Pressão del Inyector Common Rail</i>	01un.
2	225.01.41	-	Spring - Siemens Injector Nozzle Shim <i>Resorte del Calzo de la Tobera inyector Siemens</i>	06un.
3	315.06.55	-	Nut - Nozzle-Retaining Siemens <i>Tapa de la Tobera Del Inyector Siemens</i>	04un.
4	335.03.00	-	Lock - Siemens Injectors Return <i>Bloqueo Del Retorno Inyector Siemens</i>	04un.
5	421.01.851	-	O-ring - Siemens Injector - Solenoide <i>Anillo Solenoide Inyector Siemens</i>	12un.
6	607.15.20	-	Washer - Ford Ranger Siemens Nozzle <i>Arandela de la Tobera Siemens Ford Ranger</i>	01kit.
7	805.09.05	F 00V C17 003 F 00R 0P0 004	Shim - 0.60mm <i>Calzo - 0.60mm</i>	12un.
10	220.03.08	-	Protective Cap - Injectors / Units Nozzle - 7.00mm <i>Tapa Protectora p/ Tobera Inyectores / Unidades - 7.00mm</i>	01kit.



8	SHIM - ADJUSTMENT - FORD RANGER NOZZLE (DFK) CALZO DE AJUSTE TOBERA FORD RANGER		
	Ø Int.: 3.00 Ø Ext.: 5.70		
ROBIEL CODE	REFERENCE	THICKNESS(mm)	
803.02.130	-	1.30	
803.02.135	-	1.35	
803.02.140	-	1.40	
803.02.145	-	1.45	
803.02.150	-	1.50	
803.02.155	-	1.55	
803.02.160	-	1.60	
06 UNITS			

9	SHIM - ADJUSTMENT - PIEZO SIEMENS CALZO DE AJUSTE PIEZO SIEMENS		
	Ø Int.: 16.00 Ø Ext.: 18.00		
ROBIEL CODE	REFERENCE	THICKNESS(mm)	
814.18.090	-	0.90	
814.18.091	-	0.91	
814.18.092	-	0.92	
814.18.093	-	0.93	
814.18.094	-	0.94	
814.18.095	-	0.95	
814.18.096	-	0.96	
814.18.097	-	0.97	
814.18.098	-	0.98	
814.18.099	-	0.99	
814.18.100	-	1.00	
06 UNITS			

415.00.031

SHIM SET - DENSO/SIEMENS REPAIRING
JUEGO CALZOS REPARACION DENSO / SIEMENS

Nº	ROBIEL CODE	DESCRIPTION	THICKNESS(mm)	UNITS BY MEASURE
AH	821.24.150 - 821.24.170	Shim - Solenoid - Calzo Solenoide	1.50 to 1.70	12 units
MFK	801.04.12 - 801.04.15	Shim - Pre Injection - Calzo Pre Inyeccion	1.20 to 1.50	12 units
DFK	800.00.290 - 800.00.310	Shim - Denso G2 - Calzo Denso G2	2.90 to 3.10	12 units
DFK	803.02.130 - 803.02.160	Shim - Adjustment - Nozzle - Calzo Del Ajuste Tobera	1.30 to 1.60	12 units
-	814.18.090 - 814.18.100	Shim - Adjustment Siemens - Calzo Del Ajuste Siemens	0.90 to 1.00	12 units

612 UNITS

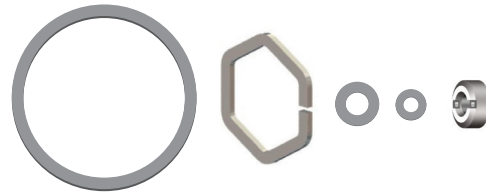

323.01.3241

Rotating Vise W /
Indexer Pin
Morsa Giratoria con Pin index



324.15.01

Injectors Repair Bracket
*Soporte para reparacion
de Inyectores*

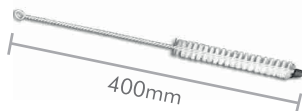

323.02.121

Cleaning Brush
Cepillo de Limpeza
Ø 12.00mm



323.50.081

Common Rail Denso G1 / G2
/ G3 - Siemens/Continenta
Injectors Tool Kit
*Kit de Herramientas Inyectores Denso
G1 / G2 / G3 - Siemens/Continental*



CATERPILLAR | PERKINS | MITSUBISHI INJECTOR
INYECTOR CATERPILLAR | PERKINS | MITSUBISHI

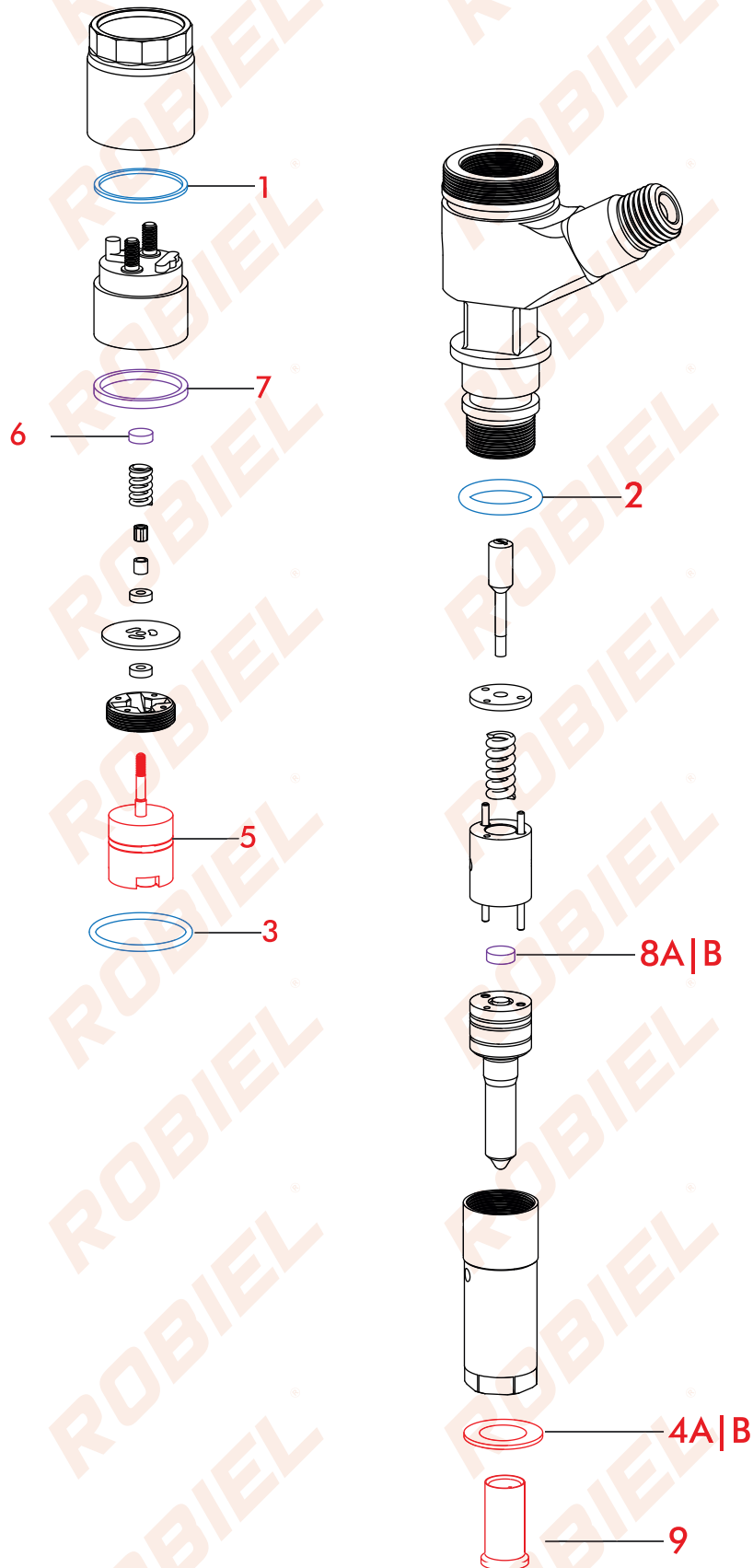

410.00.062		REPAIR PARTS - CATERPILLAR/ PERKINS NOZZLE HOLDER		
		REPARACION PORTA INYECTOR CATERPILLAR/PERKINS		
REFERENCE				
Nº	ROBIEL CODE	REFERENCE	DESCRIPTION	PACK
1	623.26.10	-	Washer - Arandela	01un.
2	421.01.426	-	O-ring - Anillo	01un.
3	421.02.417	-	O-ring - Anillo	01un.



SPARE PARTS				
Repuestos				
Nº	ROBIEL CODE	REFERENCE	DESCRIPTION	PACK
4A	607.14.20	MN155904	Washer - Copper 7.00 X 13.70 X 2.00mm <i>Arandela de Cobre</i>	48un.
4B	607.14.10	-	Washer - Copper 7.00 X 13.70 X 1.00mm <i>Arandela de Cobre</i>	48un.
5	VC6.10.0062	32F61-00062	Control Valve - Common Rail Caterpillar Injector <i>Valvula de Control Inyector Common Rail Caterpillar</i>	01un.
9	220.03.08	-	Protective Cap - Injectors / Units Nozzle - 7.00mm <i>Tapa Protectora p/ Tobera Inyectores / Unidades - 7.00mm</i>	01kit.

4A



Thickness: 2.00 mm



4B



Thickness: 1.00 mm



5





9

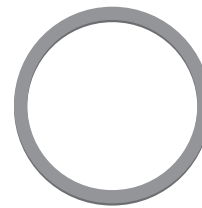

6	SHIM - NOZZLE/COIL CAT INJECTOR		
CALZO TOBERA/BOBINA INYECTOR CAT			
Ø Ext. Diameter: 6.60mm			
	ROBIEL CODE	REFERENCE	THICKNESS(mm)
	800.07.218	-	2.18
	800.07.220	-	2.20
	800.07.222	-	2.22
	800.07.224	-	2.24
	800.07.226	-	2.26
	800.07.228	-	2.28
	800.07.230	-	2.30
08 UNITS			

7	SHIM - CAT INJECTOR INDUCTION ADJUSTMENT		
CALZO DE AJUSTE INDUCTANCIA INYECTOR CAT			
22.5 x 26.0mm			
	ROBIEL CODE	REFERENCE	THICKNESS(mm)
	822.26.228	-	2.28
	822.26.230	-	2.30
	822.26.232	-	2.32
	822.26.234	-	2.34
	822.26.236	-	2.36
	822.26.238	-	2.38
08 UNITS			



8A	SHIM - NOZZLE/COIL - CAT INJECTOR CALZO TOBERA/BOBINA INYECTOR CAT		
	INOX - Ø Ext. Diameter: 6.60mm		
ROBIEL CODE	REFERENCE	THICKNESS(mm)	
800.07.140	-	1.40	
800.07.142	-	1.42	
800.07.144	-	1.44	
800.07.146	-	1.46	
800.07.148	-	1.48	
800.07.150	-	1.50	
800.07.152	-	1.52	
800.07.154	-	1.54	
800.07.156	-	1.56	
800.07.158	-	1.58	
800.07.160	-	1.60	
08 UNITS			

8B	SHIM - NOZZLE/COIL - CAT INJECTOR LOW NEEDLE CALZO TOBERA/BOBINA INYECTOR CAT - AGUJA BAJA		
	INOX - Ø Ext. Diameter: 6.60mm		
ROBIEL CODE	REFERENCE	THICKNESS(mm)	
800.07.206	-	2.06	
800.07.208	-	2.08	
800.07.210	-	2.10	
800.07.212	-	2.12	
800.07.214	-	2.14	
800.07.216	-	2.16	
08 UNITS			

415.01.01 SHIM SET - CAT C4/C6 INJECTOR AND PUMP JUEGO CALZOS REPARACION INYECTOR E BOMBA CAT C4/C6			
ROBIEL CODE	DESCRIPTION	THICKNESS(mm)	UNITS BY MEASURE
800.07.140 - 800.07.230	Shim - Nozzle/Coil - Calzo Tobera/Bobina	1.40 to 2.30	12 units
822.26.228 - 822.26.238	Shim - Induction Adjustment - Calzo Inductancia	2.28 to 2.38	12 units
803.07.125 - 803.07.15	Pump Coil Shim - Calzo de la Bobina de la Bomba	1.25 to 1.50	12 units
803.09.165 - 803.09.20	Pump Coil Shim - Calzo de la Bobina de la Bomba	1.65 to 2.00	12 units
528 UNITS			





DELPHI INJECTORS
INYECTORES DELPHI

HR
H100
Sprinter
Kia Bongo

INJECTOR CODE
28229873

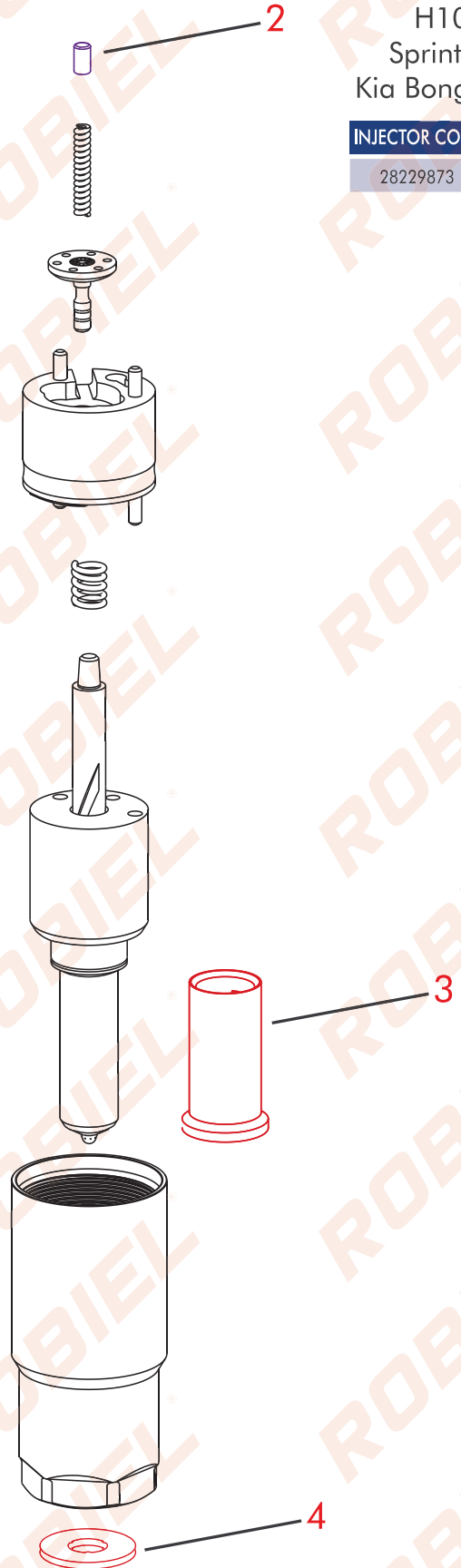
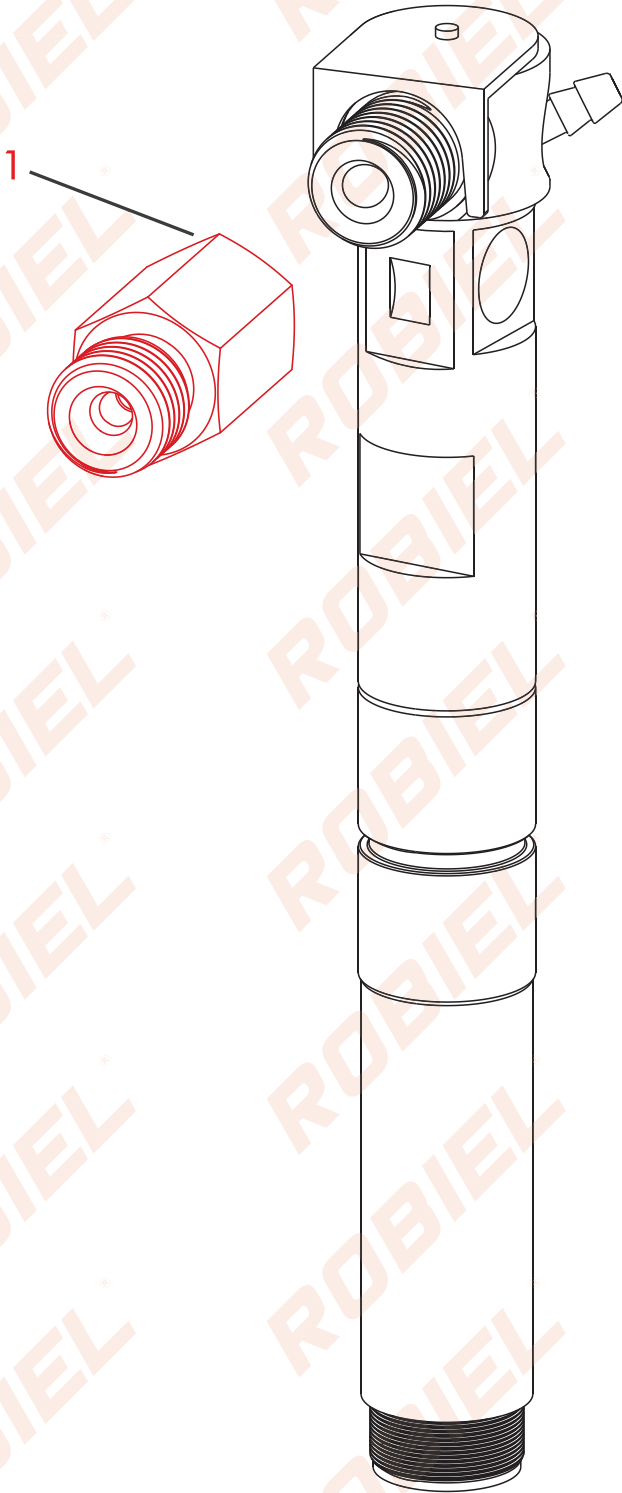

SPARE PARTS
Repuestos

Nº	ROBIEL CODE	REFERENCE	DESCRIPTION	PACK
1	165.02.15	Injektors w/ Stick Inyectores con Bastón	Connection W/Filter - Delphi/Bosch M14 CR Injector Conexion C/ Filtro p/ Inyector CR Delphi/Bosch	01un.
3	220.03.08	-	Protective Cap - Injektors / Units Nozzle - 7.00mm Tapa Protectora p/ Tobera Inyectores / Unidades - 7.00mm	01kit.
4	600.02.08	F 00V C17 505 F 00R J01 086	Washer - MWM Nozzle Arandela de la Tobera MWM	2.00mm 24un.



1 Thread: M14 X 1.50mm
Used in Injektors w/ Stick
Utilizado en inyectores con
Caneta/baston



3



4 Ø EXT: 15.00mm
Thickness: 2.00mm

2	SHIM - DELPHI INJECTORS DEBT ADJUSTING CALZO REGULACION DEB. INYECTORS DELPHI		
	Ø Ext.: 2.00		
	ROBIEL CODE	APLICACION	THICKNESS(mm)
	800.20.5260	HR SPRINTER	2.60
	800.20.5265	HR SPRINTER	2.65
	800.20.5270	HR SPRINTER	2.70
	800.20.5275	HR SPRINTER	2.75
	800.20.5280	HR SPRINTER	2.80
	800.20.5285	HR SPRINTER	2.85
	800.20.5290	HR SPRINTER	2.90
	800.20.5295	HR SPRINTER	2.95
	800.20.5300	HR SPRINTER	3.00
06 UNITS			

SPARE PARTS
Repuestos

Nº	ROBIEL CODE	REFERENCE	DESCRIPTION	PACK
1	165.02.15	Injetores c/ Caneta	Connection W/Filter - Delphi/Bosch M14 CR Injector <i>Conexion C/ Filtro p/ Inyector CR Delphi/Bosch</i>	01un.
3	220.03.08	-	Protective Cap - Injectors / Units Nozzle - 7.00mm <i>Tapa Protectora p/ Tobera Inyectores / Unidades - 7.00mm</i>	01kit.
4A	600.02.07	F 00V C17 503 F 00R J01 453	Washer - Cummins Nozzle <i>Arandela de la Tobera Cummins</i>	1.50mm 24un.
4B	600.02.08	F 00V C17 505 F 00R J01 086	Washer - MWM Nozzle <i>Arandela de la Tobera MWM</i>	2.00mm 24un.

1



Thread: M14 X 1.50mm
Used in Injectors w/ Stick
Utilizado en inyector con Caneta/baston



3



4A



Ø EXT: 15.00mm
Thickness: 1.50mm



4B



Ø EXT: 15.00mm
Thickness: 2.00mm



2	SHIM - DELPHI INJECTORS DEBT ADJUSTING CALZO REGULACION DEB. INYECTORS DELPHI		
	ROBIEL CODE	REFERENCE	THICKNESS(mm)
	800.20.5360	-	3.60
	800.20.5365	-	3.65
	800.20.5370	-	3.70
	800.20.5375	-	3.75
	800.20.5380	-	3.80
	800.20.5385	-	3.85
	800.20.5390	-	3.90
	800.20.5395	-	3.95
	800.20.5400	-	4.00
06 UNITS			