

ELECTRONIC LINE

Common Rail Injectors

Bosch CRI CRI 1.0 CRI 2.0 CRI 2.2	02
Bosch CRI 2.5	08
Bosch CRIN 1	12
Bosch CRIN 2 CRIN 3	18
Bosch CRIN 4.2	26
Caterpillar C4 C6	32
Cummins ISX 15 XPI - Scania	35
Cummins ISL - Scania	38
Daf MX13	40
Delphi HR	42
Delphi JCB	44
Denso G2	46
Denso G2 G3	50
Siemens VDO Continental	56

01
01

Common Rail Pumps

Bosch CP1	60
Bosch CP1H	64
Bosch CP3 0 445 020 046	68
Bosch CP3 0 445 010 033	72
Bosch CP3 0 445 020 033	76
Bosch CP3 0 445 020 129	82
Bosch CP3 0 445 020 005	86
Bosch CP4	90
Caterpillar C7 C9	92
Caterpillar C4 C6	94
Cummins CP2	98
Delphi - HR Sprinter	102
Denso HP3	104
Denso HP4	106
Siemens	108
Stanadyne	110

59

Units

EUP Units

PLD MBB Menores	114
PLD MBB Maiores	120
Volvo	126

EUI Units

Bosch E1 - Euro 5- Iveco	130
Bosch EUI PDE- Scania Iveco	132
Caterpillar C10 C12	140
Caterpillar C13 C15	144
Caterpillar C15 C32	146
Caterpillar 3500	150
Cummins M11 - N14	154
Delphi A1 A2 - Volvo D12 A C	156
Delphi E1 - Volvo D12D	162
Delphi E3 - Volvo D13	166
Delphi E3 - Freightliner	170
Detroit Série 60 N2	172
Detroit Série 60 N3	174
Daf MX13	178
Cummins ISX QSX	180

HEUI Units

Caterpillar C7 C9	182
Caterpillar 3126	188
Navistar DT466E	192
Caterpillar 3116	194
Navistar G2.8	197
Navistar G2.9	199

113

114

114

120

126

130

130

132

140

144

146

150

154

156

162

166

170

172

174

178

180

182

188

192

194

197

199

Summary

Gears Pumps

MBB 712	203
MBB 1933	205
MBB 1938	207
MBB Série 900	209
Scania	211
Volvo D12C	213
Volvo D13	215

193

Repair Tools

Tool kits	218
Interchangeable Tips	242
General Applications	258
High Pressure Pumps	261
Common Rail Injectors	262
EUP EUI HEUI Units	263
Gear Pumps	264

216

MECHANICAL LINE

Gear Pumps	266
Delphi CAV Pumps	272
"A" Pump	281
"P" Pump	291
"VE" Pump	302
Yanmar Pump	312
Limiter Smoke (LDA)	313
Nozzle Holder	315
RS RSV Regulator	327
RE RQ RQV RQVK Regulator	333
Solenoid Shut-Off	337
Diesel Injection Pipes	338

265

WASTEGATES AND TURBOCHARGERS

PARTS CATALOG

Wastegate

Wastegate with hose connection in 0° position and diameter(Ø) of 6mm	359
Wastegate with hose connection in 0° position and diameter(Ø) of 8mm	360
Wastegate with hose connection in 90° position and diameter(Ø) of 6mm	361
Wastegate with hose connection in 90° position and diameter(Ø) of 8mm	362
Wastegate with hose connection in 45° position and diameter(Ø) of 8mm	362
Wastegate for BorgWarner turbochargers	363
Wastegate for HR Hyundai KIA Bongo turbochargers	364
Wastegate for Man Bi-Turbo	364
Wastegate for Caterpillar	365

357

358

Turbochargers Parts

Hose clamp	366
Turbocharger sensor adapter	366
Turbocharger oil outlet adaptor	366
Nuts	367
Gaskets	368
O-ring	378

366

TECHNICAL PARTS

Technical Parts

Champ	382
Eyelets	363

381

381

Developed by

ROBIEL INDÚSTRIA E COMÉRCIO DE AUTO PEÇAS LTDA.

Indaiatuba - SP - Brasil

ROBIEL®

COMMON RAIL INJECTORS **INYECTORES COMMON RAIL**

Bosch CRI | CRI 1.0 | CRI 2.0 | CRI 2.2

Bosch CRI 2.5

Bosch CRIN 1

Bosch CRIN 2 | CRIN 3

Bosch CRIN 4.2

Caterpillar C4 | C6

Cummins ISX 15 | XPI - Scania

Cummins ISL - Scania

Daf MX13

Delphi HR

Delphi JCB

Denso G2

Denso G2 | G3

Siemens VDO | Continental

CRI | CRI 1.0 | CRI 2.0 | CRI 2.2 INJECTORS
INYECTORES CRI | CRI 1.0 | CRI 2.0 | CRI 2.2

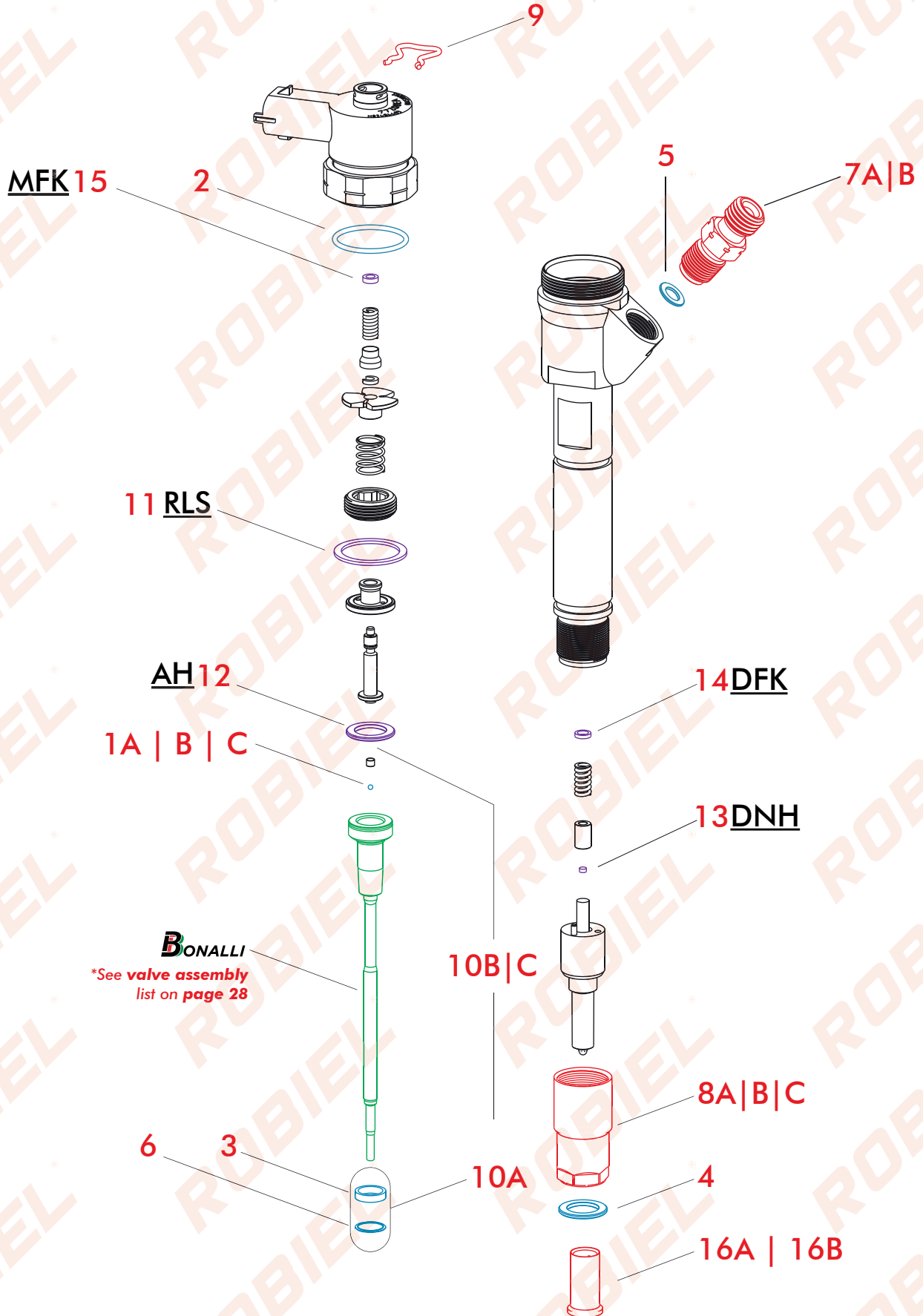

410.00.26

REPAIR PARTS - SPRINTER CR INJECTOR COMPLETE

REPARACION INY COMMON RAIL SPRINTER COMPLETA

REFERENCE				
Nº	ROBIEL CODE	REFERENCE	DESCRIPTION	PACK
1A	190.50.11	F 00V C05 001	Ball - Bolilla	01un.
2	421.02.115	F 00V C38 002	O-ring - Anillo	01un.
3	424.08.10	F 00V C99 002	Teflon Ring - Anillo Teflon	01un.
4	600.02.02	1 987 972 076 A611 01 70 060	Washer - Arandela	01un.
5	805.09.05	F 00V C17 003	Washer - Arandela	01un.
6	808.10.010	F 00V C99 002	Shim-Nozzle - Calzo-Tobera	01un.



SPARE PARTS Repuestos

Nº	ROBIEL CODE	REFERENCE	DESCRIPTION	PACK
1A	190.50.11	F 00V C05 001	Ball Diameter 1.34mm Bolilla de Valvula Diametro 1.34mm	12un.
1B	190.50.14	F 00V C05 009 006	Ball Diameter 1.50mm Bolilla de Valvula Diametro 1.50mm	12un.
1C	190.52.02	-	Ceramic Ball 1.50mm Bolilla Ceramica Diametro 1.50mm	12un.
4	600.02.02	1 987 972 076 A611 01 70 060	Washer - Sprinter 313 CDI CR Nozzle Arandela de la Tobera Sprinter 313 CDI Common Rail	24un.
5	805.09.05	F 00V C17 003	Shim - 0.60mm Calzo - 0.60mm	12un.
7A	165.02.06	F 00V C16 017	Connection - Pressure - Common Rail Conexion de Pressão del Inyector Common Rail	M12X 1.50mm M12 X 1.00mm 01un.
7B	165.02.061	-	Connection w/ Filter - Pressure - Common Rail Conexion c/ Filtrode Pressão del Inyector Common Rail	01un.
8A	315.06.25	F 00V C14 012	Nut - Nozzle-Retaining Sprinter 313 CDI CR Tapa de la Tobera Sprinter 313 CDI CR	M17 X 0.75mm 04un.
8B	315.06.58	F 00V C14 015	Nut - Nozzle-Retaining Bosch Ducato Tapa de la Tobera Bosch Ducato	M17 X 0.75mm 01un.
8C	315.06.64	-	Nut - Nozzle-Hyundai Kia 2.0 / 2.2 Tapa de la Tobera Hyundai Kia 2.0 / 2.2	06un.
9	335.05.06	F 00V C22 003	Lock - Sprinter 313 CDI Return Bloqueo Del Retorno Sprinter 313 CDICR	12un.
10A	424.08.10C	F 00V C99 002	Repair Parts - Common Rail Injector Rod Reparacion Inyector Baston Common Rail	04kit
10B	424.08.10D	F 00V C22 003 + Esfera	Repair Parts - Common Rail Injector Rod - Ball Ø1.34mm Reparacion Inyector Baston Common Rail - Bolilla Ø1.34mm	01kit
10C	424.08.10E	F 00V C99 002 + Esfera	Repair Parts - Common Rail Injector Rod - Ball Ø1.50mm Reparacion Inyector Baston Common Rail - Bolilla Ø1.50mm	01kit
16A	220.03.08	F 00R J02 537 F 00R J03 561 6.000.900.262	Protective Cap - Injectors / Units Nozzle - 7.00mm Tapa Protectora p/ Tobera Inyectores / Unidades - 7.00mm	01kit
16B	220.03.09	F 00H 410 849 F 002 C88 080 6.000.900.076	Protective Cap - Injectors / Units Nozzle - 9.00mm Tapa Protectora p/ Tobera Inyectores / Unidades - 9.00mm	01kit
R1	001.08.000	6013.001.121.000	Hose - Return - Volare Sprinter Motor Manguera Retorno Volare Motor Sprinter	01un.
R2	001.08.432	A 611 070 8432	Hose - Return - Sprinter 313 CDI Manguera Retorno Sprinter 313 CDI	01un.
R3	421.00.412	-	O-ring 3.70 x 1.20mm Anillo 3.70 x 1.20mm	24un.
R4	165.06.10	-	Connection - Sprinter 313 CDI Nozzle Return - "T" Type Conexion T Retorno Toberas Sprinter 313 CDI	04un.
R5	165.06.11	-	Connection - Sprinter 313 CDI Nozzle Return - "L" Type Conexion L Retorno Toberas Sprinter 313 CDI	04pc.
R6	002.70.0533	-	Tube for Sprinter CDI Rail Pressure Pump Tubo de la BBA de Presion Al Rail Sprinter CDI	01un.
R7	002.70.0233	611 070 0233	Tube - CDI Sprinter / Acello Nozzle Tubo de la Tobera CDI Sprinter / Acello	01un.



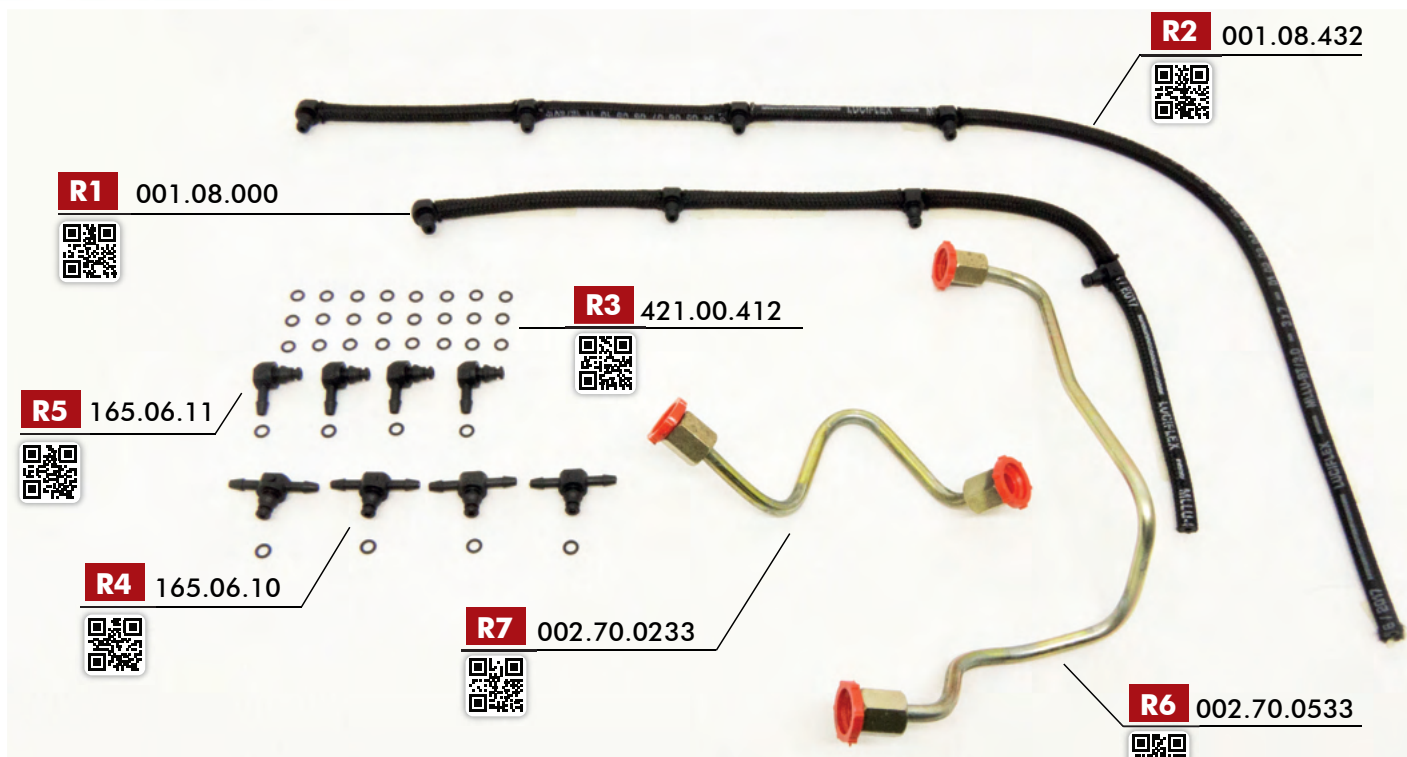

11 SHIM - ADJUSTMENT - C.R. DEBIT (RLS)
 CALZO AJUSTE DEBITO COMMON RAIL

Ø Int: 19.00 Ø Ext: 23.80

ROBIEL CODE	REFERENCE	THICKNESS(mm)
819.25.094	F 00V C60 215	0.94
819.25.095	F 00V C60 221	0.95
819.25.096	F 00V C60 225	0.96
819.25.097	-	0.97
819.25.098	F 00V C60 235	0.98
819.25.099	-	0.99
819.25.100	F 00V C60 245	1.00
819.25.101	-	1.01
819.25.102	F 00V C60 255	1.02
819.25.103	-	1.03
819.25.104	F 00V C60 265	1.04
819.25.105	F 00V C60 270	1.05
819.25.106	F 00V C60 275	1.06
819.25.107	F 00V C60 280	1.07
819.25.108	F 00V C60 285	1.08
819.25.110	F 00V C60 295	1.10
819.25.112	-	1.12
819.25.114	-	1.14
819.25.116	-	1.16
819.25.118	-	1.18
819.25.120	-	1.20
819.25.122	-	1.22
819.25.124	-	1.24
819.25.202	-	2.02
819.25.205	-	2.05

04 UNITS

12 SHIM - CR SPRINTER PRESSURE (AH)
 CALZO PRESION COMMON RAIL SPRINTER

Ø Int.: 10.40 Ø Ext.: 15.80

ROBIEL CODE	REFERENCE	THICKNESS(mm)
810.16.117	-	1.17
810.16.120	F 00V C10 406	1.20
810.16.121	F 00V C10 410	1.21
810.16.122	F 00V C10 416	1.22
810.16.123	F 00V C10 420	1.23
810.16.124	F 00V C10 426	1.24
810.16.125	F 00V C10 430	1.25
810.16.126	F 00V C10 436	1.26
810.16.127	F 00V C10 440	1.27

04 UNITS

13
SHIM - HOLD - CR NOZZLE (DNH)
CALZO RESTRICTOR TOBERA CR

Ø Ext: 2.30



ROBIEL CODE	REFERENCE	THICKNESS(mm)
800.02.100	F 00V C12 500	1.00
800.02.101	F 00V C12 502	1.01
800.02.102	F 00V C12 504	1.02
800.02.103	F 00V C12 506	1.03
800.02.104	F 00V C12 508	1.04
800.02.105	F 00V C12 510	1.05
800.02.106	F 00V C12 512	1.06
800.02.107	F 00V C12 514	1.07
800.02.108	F 00V C12 516	1.08
800.02.109	F 00V C12 518	1.09
800.02.110	F 00V C12 520	1.10
800.02.111	F 00V C12 522	1.11
800.02.112	F 00V C12 524	1.12
800.02.113	F 00V C12 526	1.13
800.02.114	F 00V C12 528	1.14
800.02.115	F 00V C12 530	1.15
800.02.116	F 00V C12 532	1.16
800.02.117	F 00V C12 534	1.17
800.02.118	F 00V C12 536	1.18
800.02.119	F 00V C12 538	1.19
800.02.120	F 00V C12 540	1.20
800.02.121	F 00V C12 542	1.21
800.02.122	F 00V C12 544	1.22
800.02.123	F 00V C12 546	1.23
800.02.124	F 00V C12 548	1.24
800.02.125	F 00V C12 550	1.25
800.02.126	-	1.26
800.02.127	-	1.27
800.02.133	-	1.33
800.02.134	-	1.34

06 UNITS

14
SHIM - PIEZO CR INJECTOR NOZZLE (DFK)
CALZO TOBERA INYECTOR CR

Ø Int.: 3.50 Ø Ext.: 5.30



ROBIEL CODE	REFERENCE	THICKNESS(mm)
803.05.09	-	0.90
803.05.095	-	0.95
803.05.10	F 00V C10 460	1.00
803.05.105	F 00V C10 464	1.05
803.05.11	F 00V C10 470	1.10
803.05.115	F 00V C10 474	1.15
803.05.12	F 00V C10 480	1.20
803.05.125	F 00V C10 484	1.25
803.05.13	F 00V C10 490	1.30
803.05.135	F 00V C10 494	1.35
803.05.14	F 00V C10 500	1.40
803.05.145	F 00V C10 504	1.45
803.05.15	F 00V C10 510	1.50

06 UNITS

15
SHIM - CR PIEZO INJECTOR NOZZLE (MFK)
CALZO TOBERA INYECTOR CR PIEZO

Ø Int.: 3.50 Ø Ext.: 5.30



ROBIEL CODE	REFERENCE	THICKNESS(mm)
803.05.155	F 00V C10 514	1.55
803.05.16	F 00V C10 520	1.60
803.05.165	F 00V C10 524	1.65
803.05.17	F 00V C10 530	1.70
803.05.175	F 00V C10 534	1.75
803.05.18	F 00V C10 540	1.80
803.05.19	F 00V C10 550	1.90
803.05.20	F 00V C10 560	2.00

06 UNITS

15
SHIM - CR INJECTOR COIL (MFK)
CALZO BOBINA INYECTOR CR

Ø Interno: 2.80 Ø Externo: 5.00



ROBIEL CODE	REFERENCE	THICKNESS(mm)
803.06.140	F 00V C60 590	1.40
803.06.144	F 00V C60 594	1.44
803.06.148	F 00V C60 598	1.48
803.06.152	F 00V C60 602	1.52
803.06.156	F 00V C60 606	1.56
803.06.160	F 00V C60 610	1.60
803.06.200	-	2.00

12 UNITS

415.00.011

PARTS SET - CRI/CRIN REPAIRING - R2

JUEGO PIEZAS REPARACION CRI / CRIN - R2

Nº	ROBIEL CODE	DESCRIPTION	THICKNESS(mm)	UNITS BY MEASURE
-	305.20.830 - 305.20.849	Pin-MWM Injector - Top del Injector MWM	8.30 to 8.49	12 units
-	305.30.834 - 305.30.855	Pin-Cummins/Ducato Injector - Top del Injector Cummins/Ducato	8.34 to 8.55	12 units
DNH	800.02.100 - 800.02.125	Shim - Hold - Calzo Restrictor	1.00 to 1.25	12 units
-	802.04.10 - 802.04.125	Shim - Pre Injection - Calzo de pre Inyeccion	1.00 to 1.25	12 units
DFK	803.05.12 - 803.05.19	Shim-Piezo-Nozzle - Calzo Tobera Inyector Piezo	1.20 to 1.90	12 units
MFK	803.06.140 - 803.06.160	Shim - Coil - Calzo Bobina	1.40 to 1.60	12 units
AH	810.16.117 - 810.16.127	Shim - Pressure Sprinter - Calzo Presion Sprinter	1.17 to 1.27	12 units
-	818.24.092 - 818.24.103	Shim-CR CP3 Regulator - Calzo Regulacion CP3	0.92 to 1.03	12 units
-	819.24.125 - 819.24.135	Shim-CR CP3 Regulator - Calzo Regulacion CP3	1.25 to 1.35	12 units
RLS	819.25.094 - 819.25.110	Shim - Adjustment - Debit - Calzo Ajuste Debito	0.94 to 1.10	12 units

1740 UNITS

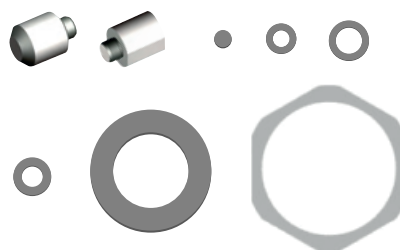

323.01.3241

Rotating Vise W /
Indexer Pin
Morsa Giratoria con Pin index



324.15.01

Injectors Repair Bracket
Soporte para reparacion
de Inyectores



324.10.10

Retaining Bushing Wrench
248/273 CR Valve
Llave Del Casquillo de Fijacion Valvula CR
248/273

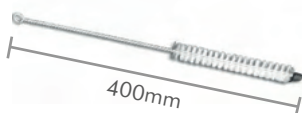

323.02.121

Cleaning Brush
Cepillo de Limpeza
Ø 12.00mm



323.50.072

Bosch CRI 1.0 / 2.0 / 2.1 / 2.2
/ CRIN 1 / 1.6 Injectors Tool Kit
Kit de herramientas Inyectores Bosch CRI
1.0 / 2.0 / 2.1 / 2.2 / CRIN 1 / 1.6



323.02.29

Tightness test Tool -
CRI/CRIN Valve
Herramienta Prueba Estanqueidad
Valvula CRI/CRIN



CRI 2.5 INJECTORS
INYECTORES CRI 2.5

Amarok

INJECTORS

0 445 110 369

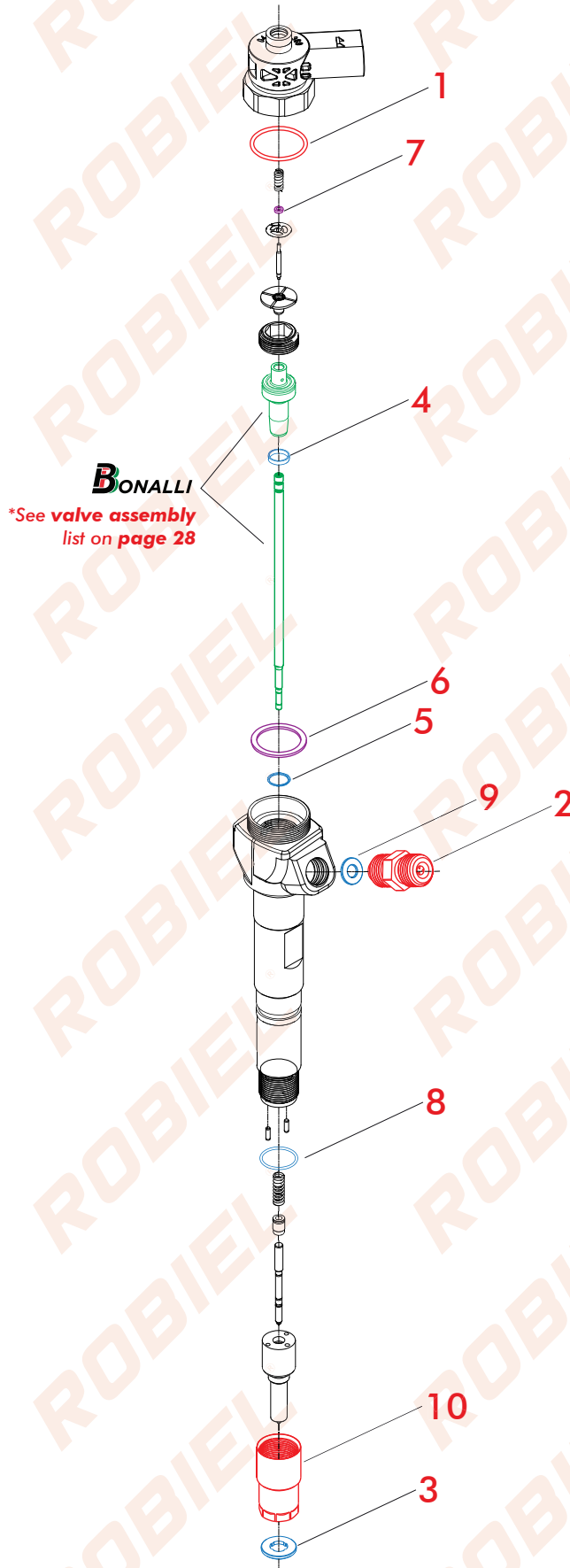

410.08.369

COMPLETE REPAIR PARTS - AMAROK INJECTOR

REPARACION COMPLETA INYECTOR AMAROK

REFERENCE				
Nº	ROBIEL CODE	REFERENCE	DESCRIPTION	PACK
1	421.02.115	F 00V C38 002	O-ring - Anillo	01un.
3	607.13.15	F 00V P01 004	Washer - Arandela	01un.
4	424.08.10	F 00V C99 002	Teflon Ring - Anillo Teflon	01un.
5	808.10.010	F 00V C99 002	Shim-Nozzle - Calzo-Tobera	01un.
8	421.16.15	-	O-ring - Anillo	01un.



410.08.001

EXTERNAL REPAIR PARTS - AMAROK INJECTOR

REPARACION EXTERNA INYECTOR AMAROK

REFERENCE				
Nº	ROBIEL CODE	REFERENCE	DESCRIPTION	PACK
3	607.13.15	F 00V P01 004	Washer - Arandela	04un.
8	421.16.15	-	O-ring - Anillo	04un.



424.08.10C

REPAIR PARTS - COMMON RAIL INJECTOR

REPARACION INYECTOR BASTON COMMON RAIL

REFERENCE		F 00V C99 002		
Nº	ROBIEL CODE	REFERENCE	DESCRIPTION	PACK
4	424.08.10	F 00V C99 002	Teflon Ring - Anillo Teflon	04un.
5	808.10.010	F 00V C99 002	Shim-Nozzle - Calzo-Tobera	04un.



SPARE PARTS

Repuestos

Nº	ROBIEL CODE	REFERENCE	DESCRIPTION	PACK
1	421.02.115	F 00V C38 002	O-RING 21.00X1.50MM ANILLO ORING 21.00X1.50MM	06un.
2	165.02.17	F 00V C16 501	CONNECTION W/ FILTER - AMAROK INJECTOR CONEXION C/ FILTRO INYECTOR AMAROK	01un.
3	607.13.15	F 00V P01 004	WASHER - AMAROK NOZZLE ARANDELA TOBERA AMAROK	06un.
9	806.12.100	-	CONNECTION WASHER - BOSCH AMAROK INJECTOR ARANDELA DE CONEXIÓN INYECTOR BOSCH AMAROK	12un.
10	315.06.62	-	NOZZLE-RETAINING NUT - AMAROK TAPA DE LA TOBERA AMAROK	04un.
R1	001.08.003	03L130235AD	AMAROK - FUEL INJECTOR RETURN LINE HOSE LÍNEA DE RETORNO DE COMBUSTIBLE PARA AMAROK	01un.

1



2



3



9



10



R1



6

SHIM - ADJUSTMENT - C.R. DEBIT (RLS)
CALZO AJUSTE DEBITO COMMON RAIL

Ø Int.: 19.00 Ø Ext.: 23.80



ROBIEL CODE	REFERENCE	THICKNESS(mm)
819.25.094	F 00V C60 215	0.94
819.25.095	F 00V C60 221	0.95
819.25.096	F 00V C60 225	0.96
819.25.097	-	0.97
819.25.098	F 00V C60 235	0.98
819.25.099	-	0.99
819.25.100	F 00V C60 245	1.00
819.25.101	-	1.01
819.25.102	F 00V C60 255	1.02
819.25.103	-	1.03
819.25.104	F 00V C60 265	1.04
819.25.105	F 00V C60 270	1.05
819.25.106	F 00V C60 275	1.06
819.25.107	F 00V C60 280	1.07
819.25.108	F 00V C60 285	1.08
819.25.110	F 00V C60 295	1.10
819.25.112	-	1.12
819.25.114	-	1.14
819.25.116	-	1.16
819.25.118	-	1.18
819.25.120	-	1.20
819.25.122	-	1.22
819.25.124	-	1.24
819.25.202	-	2.02
819.25.205	-	2.05

04 UNITS

7

SHIM - PRE-INJECTION (MFK)
CALZO DE PRE INYECCION

Ø Int.: 2.25 Ø Ext.: 4.00



ROBIEL CODE	REFERENCE	THICKNESS(mm)
802.04.10	F 00R J00 778	1.00
802.04.105	F 00R J00 784	1.05
802.04.11	F 00R J00 787	1.10
802.04.115	F 00R J00 793	1.15
802.04.12	F 00R J00 799	1.20
802.04.125	F 00R J00 802	1.25
802.04.13	F 00R J00 808	1.30
802.04.135	F 00R J00 814	1.35
802.04.14	F 00R J00 817	1.40
802.04.145	F 00R J00 823	1.45
802.04.15	F 00R J00 837	1.50
802.04.155	F 00R J00 840	1.55
802.04.16	F 00R J00 846	1.60
802.04.165	-	1.65
802.04.17	-	1.70

06 UNITS

CRIN INJECTORS
 INYECTORES CRIN

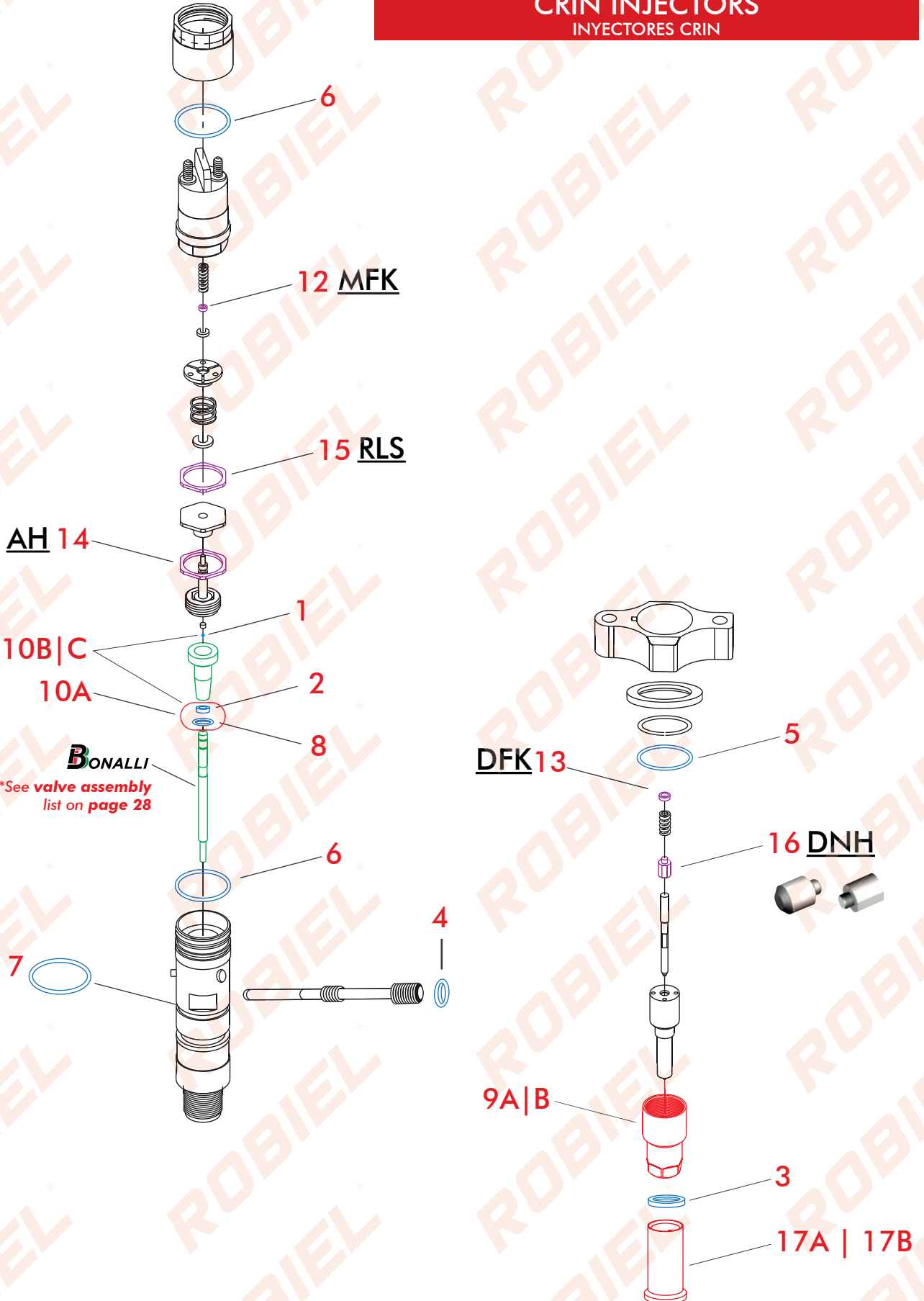

410.00.281

REPAIR PARTS - CRIN/MWM NOZZLE HOLDER

REPARACION PORTA INYECTOR CRIN MWM

REFERENCE				
Nº	ROBIEL CODE	REFERENCE	DESCRIPTION	PACK
1	190.50.11	F 00V C05 001	Ball - Bolilla	01un.
2	424.08.10	F 00V C99 002	Teflon Ring - Anillo Teflon	01un.
3	600.02.08	F 00V C17 505 F 00R J01 086	Washer - Arandela 7.00x15.00x2.00	01un.
6	421.02.415	F 00R J00 220	O-ring - Anillo	02un.
7	421.01.720	-	O-ring - Anillo	01un.
8	808.10.010	-	Shim - Calzo	01un.



410.00.29

REPAIR PARTS - CRIN/CUMMINS NOZZLE HOLDER

REPARACION PORTA INYECTOR CRIN CUMMINS

REFERENCE				
Nº	ROBIEL CODE	REFERENCE	DESCRIPTION	PACK
1	190.50.11	F 00V C05 001	Ball - Bolilla	01un.
2	424.08.10	F 00V C99 002	Teflon Ring - Anillo Teflon	01un.
3	600.02.07	F 00V C17 503 F 00R J01 453	Washer - Arandela 7.00x15.00x1.50	01un.
4	421.01.130	A5419970545	O-ring - Anillo	01un.
5	421.02.130	A5419970645	O-ring - Anillo	01un.
6	421.02.415	F 00R J00 220	O-ring - Anillo	02un.
8	808.10.010	-	Shim - Calzo	01un.



SPARE PARTS

Repuestos

Nº	ROBIEL CODE	REFERENCE	DESCRIPTION	PACK
1	190.50.11	F 00V C05 001	Ball Diameter 1.34mm Bolilla de Valvula Diametro 1.34mm	12un.
3A	600.02.07	F 00V C17 503 F 00R J01 453	Washer - Cummins Nozzle Arandela de la Tobera Cummins	24un.
3B	600.02.08	F 00V C17 505 F 00R J01 086	Washer - MWM Nozzle Arandela de la Tobera MWM	24un.
4	421.01.130	2 430 210 082 A5419970545	O-Ring 11.00 x 3.00mm Anillo 11.00 x 3.00mm	10un.
5	421.02.130	2 430 210 081 A5419970645	O-Ring 21.00 x 3.00mm Anillo 21.00 x 3.00mm	10un.
9A	315.06.32	F 00R J00 841	Nut - Nozzle-Retaining Cummins CP3 Injector Tapa de la Tobera Del Inyector Cummins CP3	01un.
9B	315.06.56	F 00R J00 713 F 00R J02 219	Nut - Nozzle-Retaining MWM 412 TCE Tapa de la Tobera Del Inyector MWM 412 TCE	04un.
10A	424.08.10C	F 00V C38 002 F 00R J02 176 F 00V C99 002	Repair Parts - Common Rail Injector Rod Reparacion Inyector Baston Common Rail	04kit
10B	424.08.10D	F 00V C99 002 + Esfera	Repair Parts - Common Rail Injector Rod - Ball Ø1.34mm Reparacion Inyector Baston Common Rail - Bolilla Ø1.34mm	01kit
10C	424.08.10E	F 00V C99 002 + Esfera	Repair Parts - Common Rail Injector Rod - Ball Ø1.50mm Reparacion Inyector Baston Common Rail - Bolilla Ø1.50mm	01kit
11A	165.02.15	Inyectores c/ Caneta	Connection W/Filter - Delphi/Bosch M14 CR Injector Conexion C/ Filtro p/ Inyector CR Delphi/Bosch	01un.
11B	165.02.16	Inyectores s/ Caneta	Connection W/Filter - MWM M14 CR Injector Conexion C/ Filtro p/ Inyector CR MWM	01un.
17A	220.03.08	F 00R J02 537 F 00R J03 561 6.000.900.262	Protective Cap - Injectors / Units Nozzle - 7.00mm Tapa Protectora p/ Tobera Inyectores / Unidades - 7.00mm	01kit
17B	220.03.09	F 00H 410 849 F 002 C88 080 6.000.900.076	Protective Cap - Injectors / Units Nozzle - 9.00mm Tapa Protectora p/ Tobera Inyectores / Unidades - 9.00mm	01kit





12	SHIM - MWM/CUMMINS PRE-INJECTION (MFK) CALZO DE PRE INYECCION MWM/CUMMINS		
	Ø Int.: 2.25 Ø Ext.: 4.00		
○	ROBIEL CODE	REFERENCE	THICKNESS(mm)
	802.04.10	F 00R J00 778	1.00
	802.04.105	F 00R J00 784	1.05
	802.04.11	F 00R J00 787	1.10
	802.04.115	F 00R J00 793	1.15
	802.04.12	F 00R J00 799	1.20
	802.04.125	F 00R J00 802	1.25
	802.04.13	F 00R J00 808	1.30
	802.04.135	F 00R J00 814	1.35
	802.04.14	F 00R J00 817	1.40
	802.04.145	F 00R J00 823	1.45
	802.04.15	F 00R J00 837	1.50
	802.04.155	F 00R J00 840	1.55
	802.04.16	F 00R J00 846	1.60
	802.04.165	-	1.65
	802.04.17	-	1.70
06 UNITS			

13	SHIM - CR INJECTOR NOZZLE (DFK) CALZO TOBERA INYECTOR CR		
	Ø Int.: 3.50 Ø Ext.: 5.30		
○	ROBIEL CODE	REFERENCE	THICKNESS(mm)
	803.05.09	-	0.90
	803.05.095	-	0.95
	803.05.10	F 00V C10 460	1.00
	803.05.105	F 00V C10 464	1.05
	803.05.11	F 00V C10 470	1.10
	803.05.115	F 00V C10 474	1.15
	803.05.12	F 00V C10 480	1.20
	803.05.125	F 00V C10 484	1.25
	803.05.13	F 00V C10 490	1.30
	803.05.135	F 00V C10 494	1.35
	803.05.14	F 00V C10 500	1.40
	803.05.145	F 00V C10 504	1.45
	803.05.15	F 00V C10 510	1.50
	803.05.155	F 00V C10 514	1.55
	803.05.16	F 00V C10 520	1.60
	803.05.165	F 00V C10 524	1.65
	803.05.17	F 00V C10 530	1.70
	803.05.175	F 00V C10 534	1.75
	803.05.18	F 00V C10 540	1.80
	803.05.19	F 00V C10 550	1.90
	803.05.20	F 00V C10 560	2.00
06 UNITS			

INJECTORS INYECTORES

RESTRICTOR	RESTRICTOR	RESTRICTOR	RESTRICTOR	RESTRICTOR	RESTRICTOR	RESTRICTOR	INTERMEDIATE PIN	INTERMEDIATE PIN	INTERMEDIATE PIN
CRIN 1 1.6	CRIN 1 1.6	CRIN 1 1.6	CRIN 1 1.6	CRIN 1 1.6	CRIN 1 1.6	CRIN 1 1.6	CRIN 1 1.6	CRIN 1 1.6	CRIN 1 1.6
0 445 120 025	0 445 120 040	0 445 120 108	0 445 120 133	0 445 120 208	0 445 120 250	0 445 120 330	0 445 120 009	0 445 120 119	0 445 120 079
0 445 120 029	0 445 120 041	0 445 120 112	0 445 120 140	0 445 120 209	0 445 120 251	INTERMEDIATE PIN	0 445 120 010	0 445 120 020	0 445 120 084
0 445 120 031	0 445 120 051	0 445 120 115	0 445 120 144	0 445 120 210	0 445 120 252	CRIN 1 1.6	0 445 120 011	0 445 120 021	0 445 120 085
0 445 120 033	0 445 120 052	0 445 120 119	0 445 120 151	0 445 120 211	0 445 120 253	0 445 120 002	0 445 120 012	0 445 120 022	0 445 120 089
0 445 120 034	0 445 120 059	0 445 120 120	0 445 120 152	0 445 120 212	0 445 120 254	0 445 120 003	0 445 120 013	0 445 120 028	0 445 120 103
0 445 120 035	0 445 120 060	0 445 120 121	0 445 120 159	0 445 120 231	0 445 120 255	0 445 120 004	0 445 120 014	0 445 120 032	0 445 120 113
0 445 120 036	0 445 120 70	0 445 120 122	0 445 120 173	0 445 120 238	0 445 120 256	0 445 120 005	0 445 120 015	0 445 120 043	0 445 120 114
0 445 120 037	0 445 120 094	0 445 120 123	0 445 120 174	0 445 120 239	0 445 120 272	0 445 120 006	0 445 120 016	0 445 120 046	-
0 445 120 038	0 445 120 096	0 445 120 125	0 445 120 175	0 445 120 240	0 445 120 273	0 445 120 007	0 445 120 017	0 445 120 069	-
0 445 120 039	0 445 120 097	0 445 120 132	0 445 120 176	0 445 120 241	0 445 120 300	0 445 120 008	0 445 120 018	0 445 120 077	-

15

SHIM - CR REGULATOR (RLS) CALZO REGULACION COMMON RAIL

Ø Int.: 19.00 Ø Ext.: 24.00



ROBIEL CODE	REFERENCE	THICKNESS(mm)
819.24.100	-	1.00
819.24.102	-	1.02
819.24.104	-	1.04
819.24.106	-	1.06
819.24.108	-	1.08
819.24.110	-	1.10
819.24.112	-	1.12
819.24.114	-	1.14
819.24.116	-	1.16
819.24.125	F 00R J00 128	1.25
819.24.126	F 00R J00 130	1.26
819.24.127	F 00R J00 132	1.27
819.24.128	F 00R J00 134	1.28
819.24.129	F 00R J00 136	1.29
819.24.130	F 00R J00 138	1.30
819.24.131	F 00R J00 140	1.31
819.24.132	F 00R J00 142	1.32
819.24.133	F 00R J00 144	1.33
819.24.134	F 00R J00 146	1.34
819.24.135	F 00R J00 148	1.35

04 UNITS



14

SHIM - CR REGULATOR (AH) CALZO REGULACION COMMON RAIL

Ø Int.: 18.00 Ø Ext.: 24.00



ROBIEL CODE	REFERENCE	THICKNESS(mm)
818.24.085	-	0.85
818.24.088	-	0.88
818.24.092	-	0.92
818.24.093	-	0.93
818.24.094	-	0.94
818.24.095	F 00R J00 024	0.95
818.24.096	-	0.96
818.24.097	F 00R J00 034	0.97
818.24.098	-	0.98
818.24.099	F 00R J00 044	0.99
818.24.100	-	1.00
818.24.101	F 00R J00 054	1.01
818.24.102	-	1.02
818.24.103	F 00R J00 064	1.03
818.24.105	F 00R J00 074	1.05
818.24.107	F 00R J00 084	1.07
818.24.109	F 00R J00 094	1.09

04 UNITS



16

PIN - MWM INJECTOR (DNH)
TOP DEL INYECTOR MWM



ROBIEL CODE	REFERENCE	THICKNESS(mm)
305.20.830	F 00V C12 408	8.30
305.20.831	F 00V C12 412	8.31
305.20.832	F 00V C12 416	8.32
305.20.833	F 00V C12 420	8.33
305.20.834	-	8.34
305.20.835	F 00V C12 424	8.35
305.20.836	F 00V C12 428	8.36
305.20.837	F 00V C12 432	8.37
305.20.838	F 00V C12 436	8.38
305.20.839	-	8.39
305.20.840	F 00V C12 440	8.40
305.20.841	F 00V C12 444	8.41
305.20.842	F 00V C12 448	8.42
305.20.843	F 00V C12 452	8.43
305.20.844	F 00V C12 456	8.44
305.20.845	F 00V C12 460	8.45
305.20.846	-	8.46
305.20.847	F 00V C12 464	8.47
305.20.848	F 00V C12 468	8.48
305.20.849	F 00V C12 472	8.49

04 UNITS

16

PIN - CUMMINS / DUCATO INJECTOR (DNH)
TOP DEL INYECTOR CUMMINS/DUCATO



ROBIEL CODE	REFERENCE	THICKNESS(mm)
305.30.834	F 00V C12 322	8.34
305.30.835	F 00V C12 324	8.35
305.30.836	F 00V C12 328	8.36
305.30.837	F 00V C12 332	8.37
305.30.838	F 00V C12 334	8.38
305.30.839	F 00V C12 338	8.39
305.30.840	F 00V C12 340	8.40
305.30.841	F 00V C12 344	8.41
305.30.842	F 00V C12 348	8.42
305.30.843	F 00V C12 352	8.43
305.30.844	F 00V C12 354	8.44
305.30.845	F 00V C12 358	8.45
305.30.846	F 00V C12 362	8.46
305.30.847	F 00V C12 364	8.47
305.30.848	F 00V C12 368	8.48
305.30.849	F 00V C12 372	8.49
305.30.850	F 00V C12 374	8.50
305.30.851	F 00V C12 378	8.51
305.30.852	F 00V C12 382	8.52
305.30.853	F 00V C12 384	8.53
305.30.854	F 00V C12 388	8.54
305.30.855	F 00V C12 392	8.55

04 UNITS

415.00.011

PARTS SET - CRI/CRIN REPAIRING - R2

JUEGO PIEZAS REPARACION CRI / CRIN - R2

Nº	ROBIEL CODE	DESCRIPTION	THICKNESS(mm)	UNITS BY MEASURE
DNH	305.20.830 - 305.20.849	Pin-MWM Injector - <i>Top del Injector MWM</i>	8.30 to 8.49	12 units
DNH	305.30.834 - 305.30.855	Pin-Cummins/Ducato Injector - <i>Top del Injector Cummins/Ducato</i>	8.34 to 8.55	12 units
-	800.02.100 - 800.02.125	Shim - Hold - <i>Calzo Restrictor</i>	1.00 to 1.25	12 units
MFK	802.04.10 - 802.04.125	Shim - Pre Injection - <i>Calzo de pre Inyeccion</i>	1.00 to 1.25	12 units
DFK	803.05.12 - 803.05.19	Shim-Piezo-Nozzle - <i>Calzo Tobera Injector Piezo</i>	1.20 to 1.90	12 units
-	803.06.140 - 803.06.160	Shim - Coil - <i>Calzo Bobina</i>	1.40 to 1.60	12 units
-	810.16.117 - 810.16.127	Shim - Pressure Sprinter - <i>Calzo Presion Sprinter</i>	1.17 to 1.27	12 units
AH	818.24.092 - 818.24.103	Shim-CR CP3 Regulator - <i>Calzo Regulacion CP3</i>	0.92 to 1.03	12 units
RLS	819.24.125 - 819.24.135	Shim-CR CP3 Regulator - <i>Calzo Regulacion CP3</i>	1.25 to 1.35	12 units
-	819.25.094 - 819.25.110	Shim - Adjustment - Debit - <i>Calzo Ajuste Debito</i>	0.94 to 1.10	12 units

1740 UNITS

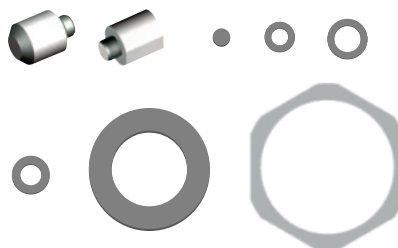

323.01.3241

Rotating Vise W /
Indexer Pin
Morsa Giratoria con Pin index



324.15.01

Injectors Repair Bracket
*SopORTE para reparacion
de Inyectores*

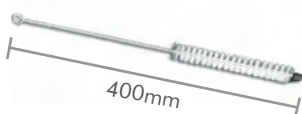

323.02.121

Cleaning Brush
Cepillo de Limpeza
Ø 12.00mm



323.50.072

Bosch CRI 1.0 / 2.0 / 2.1 / 2.2 /
CRIN 1 / 1.6 Injectors Tool Kit
*Kit de herramientas Inyectores Bosch CRI
1.0 / 2.0 / 2.1 / 2.2 / CRIN 1 / 1.6*



323.02.29

Tightness test Tool -
CRI/CRIN Valve
*Herramienta Prueba Estanqueidad
Valvula CRI/CRIN*



CRIN 2 INJECTORS
 INYECTORES CRIN 2

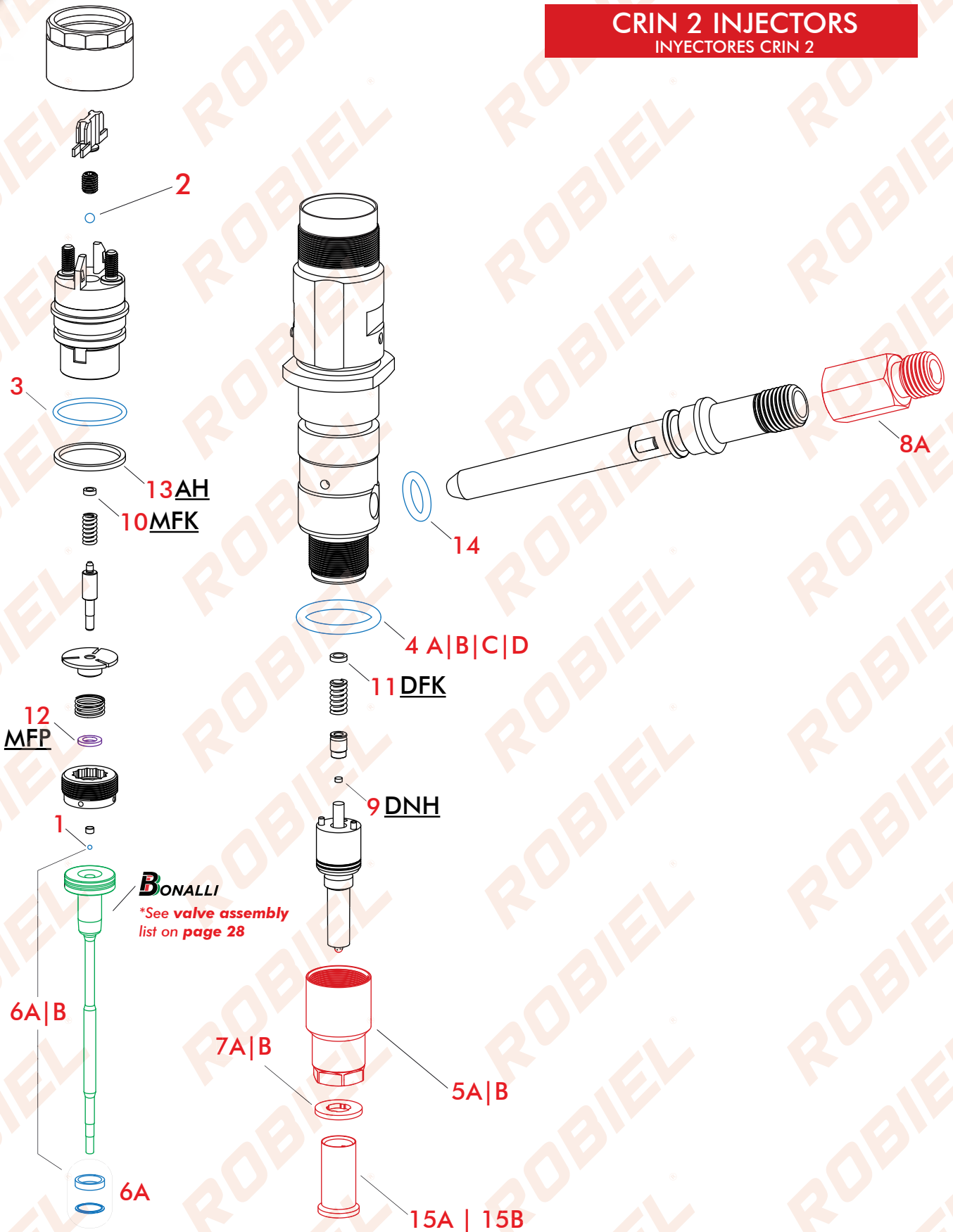

CRIN 3 INJECTORS
 INYECTORES CRIN 3

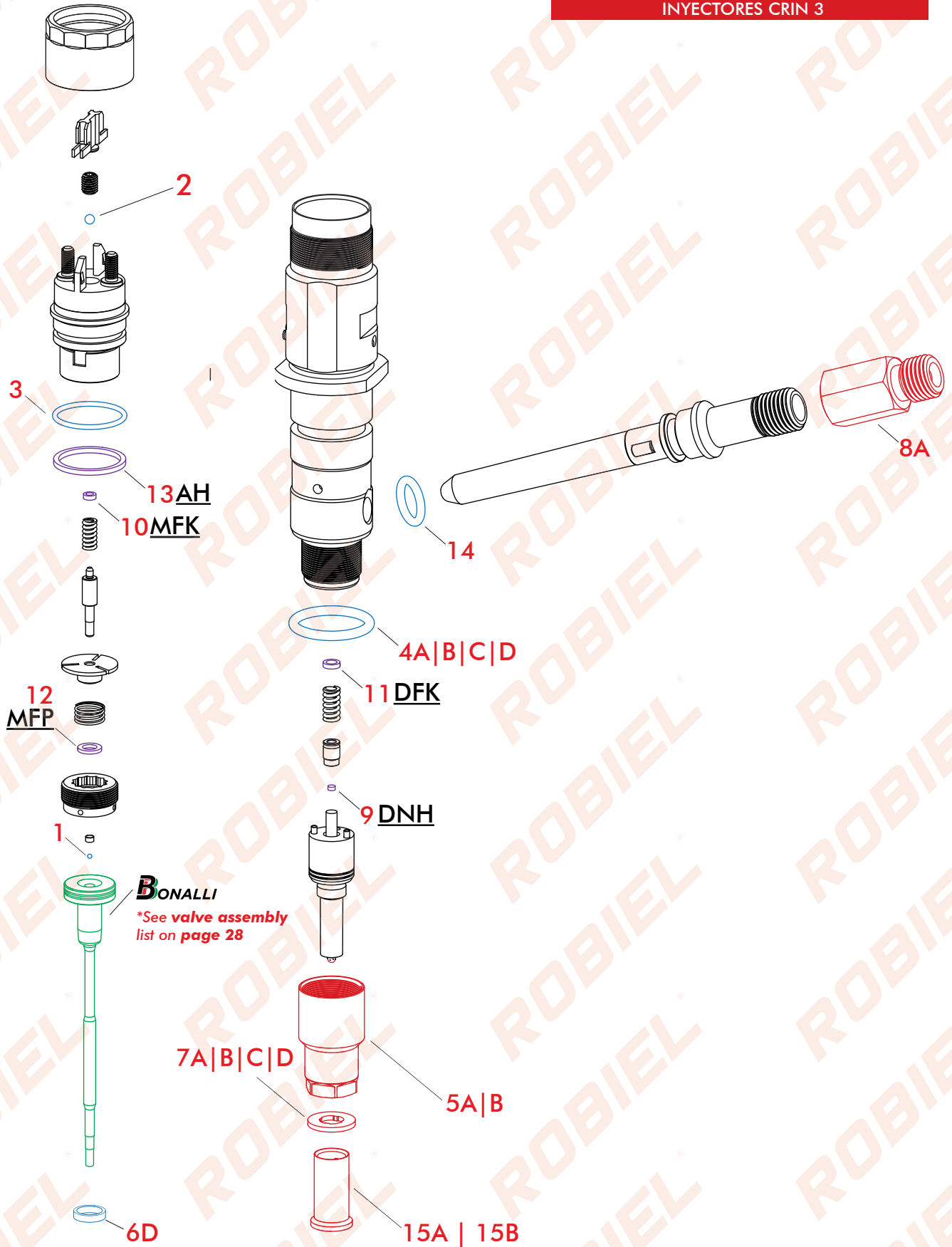

410.00.37
REPAIR PARTS - CUMMINS CRIN 2/ EURO V INJECTOR

REPARACION INYECTOR CUMMINS CRIN 2 EURO V

APPLICATION		CUMMINS		
Nº	ROBIEL CODE	REFERENCE	DESCRIPTION	PACK
1	190.50.11	F 00V C05 001	Ball - Bolilla Ø1.35mm	01 un.
2	190.50.16	F 00R C00 556	Ball - Bolilla Ø3.00mm	01 un.
3	421.02.015	F 00R J00 222	O-ring - Anillo	01 un.
4B	421.02.130	2 430 210 081	O-ring - Anillo	01 un.
14	421.01.130	2 430 210 082	O-ring - Anillo	01 un.
6A	424.08.10C	F 00V C99 002 F 00R J02 176	Repair Parts - Common Rail Injector Rod Reparacion Inyector Baston Common Rail	01 kit.
7A	600.02.07	F 00V C17 503 F 00R 501 453	Washer - Arandela 7.00x15.00x1.50	01 un.

410.00.38
REPAIR PARTS - CUMMINS CRIN 3/ EURO V INJECTOR

REPARACION INYECTOR CUMMINS CRIN 3 EURO V

APPLICATION		CUMMINS		
Nº	ROBIEL CODE	REFERENCE	DESCRIPTION	PACK
1	190.50.11	F 00V C05 001	Ball - Bolilla Ø1.35mm	01 un.
2	190.50.16	F 00R C00 556	Ball - Bolilla Ø3.00mm	01 un.
6B	424.07.917	F 00R J02 177	Teflon Ring - Anillo Teflon	01 un.
4B	421.02.130	2 430 210 081	O-ring - Anillo	01 un.
14	421.01.130	2 430 210 082	O-ring - Anillo	01 un.
3	421.02.015	F 00R J00 222	O-ring - Anillo	01 un.
7A	600.02.07	F 00V C17 503 F 00R 501 453	Washer - Arandela 7.00x15.00x1.50	01 un.

410.00.39
REPAIR PARTS - MWM CRIN 3/ EURO V INJECTOR

REPARACION INYECTOR MWM CRIN 3 EURO V

APPLICATION		MWM		
Nº	ROBIEL CODE	REFERENCE	DESCRIPTION	PACK
1	190.50.11	F 00V C05 001	Ball - Bolilla Ø1.35mm	01 un.
2	190.50.16	F 00R C00 556	Ball - Bolilla Ø3.00mm	01 un.
3	421.02.015	F 00R J00 222	O-ring - Anillo	01 un.
6B	424.07.917	F 00R J02 177	Teflon Ring - Anillo Teflon	01 un.
4C	421.01.720	-	O-ring - Anillo	01 un.
7B	600.02.08	F 00V C17 505 F 00R J01 086	Washer - Arandela 7.00x15.00x2.00	01 un.

410.00.40
REPAIR PARTS - MAN CRIN 3

REPARACION INYECTOR MAN CRIN3

INJECTORS		0 445 120 162 0 445 120 186		
Nº	ROBIEL CODE	REFERENCE	DESCRIPTION	PACK
1	190.50.11	F 00V C05 001	Ball - Bolilla Ø1.35mm	01 un.
2	190.50.16	F 00R C00 556	Ball - Bolilla Ø3.00mm	01 un.
3	421.02.015	F 00R J00 222	O-ring - Anillo	01 un.
4D	421.02.430	F 00R J00 534	O-ring - Anillo	01 un.
6D	424.07.917	F 00R J02 177	Teflon Ring - Anillo Teflon	01 un.
7D	600.02.10	F 00R J02 175	Washer - Arandela	01 un.



410.00.41

REPAIR SET - MAN INJECTOR CRIN2

REPARACION INYECTOR MAN CRIN2

INJECTORS

0 445 120 044 | 0 445 120 045 | 0 445 120 055

Nº	ROBIEL CODE	REFERENCE	DESCRIPTION	PACK
1	190.50.11	F 00V C05 001	Ball - Bolilla Ø1.35mm	01un.
2	190.50.16	F 00R C00 556	Ball - Bolilla Ø3.00mm	01un.
3	421.02.015	F 00R J00 222	O-ring - Anillo	01un.
4D	421.02.430	F 00R J00 534	O-ring - Anillo	01un.
6A	424.08.10C	F 00V C99 002 F 00R J02 176	Repair Parts - Common Rail Injector Rod Reparacion Inyector Baston Common Rail	01un.
7D	600.02.10	F 00R J02 175	Washer - Arandela	01un.



410.20.092

REPAIR SET - INJECTOR CRIN 2 | 3

REPARACION INYECTOR CRIN 2 | 3

APPLICATION

IVECO | CASE NH

Nº	ROBIEL CODE	REFERENCE	DESCRIPTION	PACK
1	190.50.11	F 00V C05 001	Ball - Bolilla Ø1.35mm	01un.
2	190.50.16	F 00R C00 556	Ball - Bolilla Ø3.00mm	01un.
3	421.02.015	F 00R J00 222	O-ring - Anillo	01un.
4A	421.02.835	-	O-ring - Anillo	01un.





SPARE PARTS

Repuestos

Nº	ROBIEL CODE	REFERENCE	DESCRIPTION	PACK
1	190.50.11	F 00V C05 001	Ball Diameter 1.34mm Bolilla de Valvula Diametro 1.34mm	12un.
5A	315.06.56	F 00R J00 713 F 00R J02 219	Nut - Nozzle-Retaining MWM 412 TCE Tapa de la Tobera Del Inyector MWM 412 TCE	04un.
5B	315.06.57	F 00R J00 842	Nut - Nozzle-Retaining Iveco / Case / NH Tapa de la Tobera Del Inyector Iveco / Case / NH	01un.
6A	424.08.10C	F 00V C99 002 F 00R J02 176	Repair Parts - Common Rail Injector Rod Reparacion Inyector Baston Common Rail	04kit
6B	424.08.10D	F 00V C99 002 + Esfera	Repair Parts - Common Rail Injector Rod - Ball Ø1.34mm Reparacion Inyector Baston Common Rail - Bolilla Ø1.34mm	01kit
6C	424.08.10E	F 00V C99 002 + Esfera	Repair Parts - Common Rail Injector Rod - Ball Ø1.50mm Reparacion Inyector Baston Common Rail - Bolilla Ø1.50mm	01kit
6D	424.07.917	F00R J02 177	Teflon O-ring - CRIN 3 Anillo Teflon - CRIN 3	06un.
7A	600.02.07	F 00V C17 503 F 00R J01 453	Washer - Cummins Nozzle Arandela de la Tobera Cummins	24un.
7B	600.02.08	F 00V C17 505 F 00R J01 086	Washer - MWM Nozzle Arandela de la Tobera MWM	24un.
7C	600.07.17	CASE 504 262 598	Washer - Case Magnum MX325Injector Arandela de lo Inyector Case Magnum MX235	12un.
7D	600.02.10	F 00R J02 175	Washer - MAN Nozzle Arandela de la Tobera MAN	06un.
8A	165.02.15	Inyectores c/ Caneta	Connection W/Filter - Delphi/Bosch M14 CR Injector Conexion C/ Filtro p/ Inyector CR Delphi/Bosch	01un.
8B	165.02.16	Inyectores s/ Caneta	Connection W/Filter - MWM M14 CR Injector Conexion C/ Filtro p/ Inyector CR MWM	01un.
15A	220.03.08	F 00R J02 537 F 00R J03 561 6.000.900.262	Protective Cap - Injectors / Units Nozzle - 7.00mm Tapa Protectora p/ Tobera Inyectores / Unidades - 7.00mm	01kit
15A	220.03.09	F 00H 410 849 F 002 C88 080 6.000.900.076	Protective Cap - Injectors / Units Nozzle - 9.00mm Tapa Protectora p/ Tobera Inyectores / Unidades - 9.00mm	01kit
R1	421.02.430	F 00R J00 534	O-ring - External - MAN Injector Anillo Externo Inyector MAN	06un.



9 SHIM - HOLD - COMMON RAIL NOZZLE (DNH) CALZO RESTRICTOR TOBERA COMMON RAIL 		
Ø Ext.: 2.30		
ROBIEL CODE	REFERENCE	THICKNESS(mm)
800.02.110	F 00V C12 520	1.10
800.02.113	F 00V C12 526	1.13
800.02.115	F 00V C12 530	1.15
800.02.118	F 00V C12 536	1.18
800.02.120	F 00V C12 540	1.20
800.02.123	F 00V C12 546	1.23
800.02.125	F 00V C12 550	1.25
06 UNITS		

11 SHIM - CR INJECTOR NOZZLE (DFK) CALZO TOBERA INYECTOR CR 		
Ø Int.: 3.50 Ø Ex.: 5.30		
ROBIEL CODE	REFERENCE	THICKNESS(mm)
803.05.07	-	0.70
803.05.075	-	0.75
803.05.08	-	0.80
803.05.085	-	0.85
803.05.09	-	0.90
803.05.095	-	0.95
803.05.10	F 00V C10 460	1.00
803.05.105	F 00V C10 464	1.05
803.05.11	F 00V C10 470	1.10
803.05.115	F 00V C10 474	1.15
803.05.12	F 00V C10 480	1.20
803.05.125	F 00V C10 484	1.25
803.05.13	F 00V C10 490	1.30
803.05.135	F 00V C10 494	1.35
803.05.14	F 00V C10 500	1.40
803.05.145	F 00V C10 504	1.45
803.05.15	F 00V C10 510	1.50
803.05.155	F 00V C10 514	1.55
803.05.16	F 00V C10 520	1.60
803.05.165	F 00V C10 524	1.65
803.05.17	F 00V C10 530	1.70
803.05.175	F 00V C10 534	1.75
803.05.18	F 00V C10 540	1.80
803.05.19	F 00V C10 550	1.90
803.05.20	F 00V C10 560	2.00
06 UNITS		

10 SHIM - MWM/CUMMINS PRE-INJECTION (MFK) CALZO DE PRE INYECCION MWM/CUMMINS 		
Ø Int.: 2.25 Ø Ext.: 4.00		
ROBIEL CODE	REFERENCE	THICKNESS(mm)
802.04.10	F 00R J00 778	1.00
802.04.105	F 00R J00 784	1.05
802.04.11	F 00R J00 787	1.10
802.04.115	F 00R J00 793	1.15
802.04.12	F 00R J00 799	1.20
802.04.125	F 00R J00 802	1.25
802.04.13	F 00R J00 808	1.30
802.04.135	F 00R J00 814	1.35
802.04.14	F 00R J00 817	1.40
802.04.145	F 00R J00 823	1.45
802.04.15	F 00R J00 837	1.50
802.04.155	F 00R J00 840	1.55
802.04.16	F 00R J00 846	1.60
802.04.165	-	1.65
802.04.17	-	1.70
06 UNITS		

12 SHIM - INJECTOR SOLENOID BALL COURSE (MFP) CALZO CARRERA DE APERTURA BOLILLA SOLEN INYECTOR 		
Ø Int.: 4.50 Ø Ext.: 7.70		
ROBIEL CODE	REFERENCE	THICKNESS(mm)
805.07.100	F 00R J01 009	1.00
805.07.101	-	1.01
805.07.102	-	1.02
805.07.103	-	1.03
805.07.104	F 00R J01 010	1.04
805.07.105	-	1.05
805.07.106	-	1.06
805.07.107	-	1.07
805.07.108	F 00R J01 018	1.08
805.07.109	-	1.09
805.07.110	F 00R J01 020	1.10
805.07.111	-	1.11
805.07.112	F 00R J01 022	1.12
06 UNITS		

* APPLICATION: 0 445 120 092 / 0 445 120 157
Iveco | Case New Holland

13

SHIM - INJECTORS COIL (AH) CALZO BOBINA INYECCION

Ø Int.: 19.60 Ø Ext.: 22.80

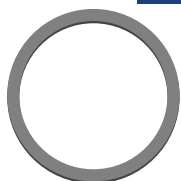

ROBIEL CODE	REFERENCE	THICKNESS(mm)
819.22.150	-	1.50
819.22.151	-	1.51
819.22.152	-	1.52
819.22.153	-	1.53
819.22.154	F OOR J00 883	1.54
819.22.155	-	1.55
819.22.156	F OOR J00 893	1.56
819.22.157	-	1.57
819.22.158	F OOR J00 903	1.58
819.22.159	-	1.59
819.22.160	F OOR J00 913	1.60

06 UNITS

* APPLICATION: 0 445 120 092 / 0 445 120 157
Iveco | Case New Holland

INJECTORS INYECTORES

CRIN 2	CRIN 2	CRIN 2	CRIN 2	CRIN 2	CRIN 2	CRIN 3	CRIN 3	CRIN 3	CRIN 3.3
0 445 120 024	0 445 120 078	0 445 120 130	0 445 120 164	0 445 120 222	0 445 120 264	0 445 120 050	0 445 120 184	0 445 120 257	0 445 120 058
0 445 120 026	0 445 120 080	0 445 120 131	0 445 120 165	0 445 120 223	0 445 120 265	0 445 120 071	0 445 120 185	0 445 120 258	0 445 120 095
0 445 120 030	0 445 120 081	0 445 120 134	0 445 120 166	0 445 120 224	0 445 120 266	0 445 120 092	0 445 120 186	0 445 120 259	0 445 120 109
0 445 120 044	0 445 120 083	0 445 120 136	0 445 120 169	0 445 120 225	0 445 120 268	0 445 120 118	0 445 120 187	0 445 120 267	0 445 120 243
0 445 120 045	0 445 120 086	0 445 120 137	0 445 120 170	0 445 120 226	0 445 120 274	0 445 120 135	0 445 120 188	0 445 120 269	W/ CONNECTOR
0 445 120 053	0 445 120 087	0 445 120 138	0 445 120 182	0 445 120 227	0 445 120 275	0 445 120 143	0 445 120 193	0 445 120 276	0 445 120 047
0 445 120 054	0 445 120 088	0 445 120 139	0 445 120 183	0 445 120 228	0 445 120 277	0 445 120 157	0 445 120 197	0 445 120 279	0 445 120 048
0 445 120 055	0 445 120 098	0 445 120 141	0 445 120 190	0 445 120 232	0 445 120 278	0 445 120 161	0 445 120 199	0 445 120 281	0 445 120 049
0 445 120 056	0 445 120 099	0 445 120 142	0 445 120 191	0 445 120 234	0 445 120 289	0 445 120 162	0 445 120 201	0 445 120 282	0 445 120 072
0 445 120 057	0 445 120 100	0 445 120 145	0 445 120 192	0 445 120 236	0 445 120 290	0 445 120 167	0 445 120 202	0 445 120 327	0 445 120 073
0 445 120 061	0 445 120 101	0 445 120 146	0 445 120 196	0 445 120 237	0 445 120 291	0 445 120 177	0 445 120 204	W/ CONNECTOR	0 445 120 076
0 445 120 062	0 445 120 102	0 445 120 147	0 445 120 200	0 445 120 242	0 445 120 292	0 445 120 178	0 445 120 216	0 445 120 042	0 445 120 090
0 445 120 063	0 445 120 105	0 445 120 148	0 445 120 203	0 445 120 244	0 445 120 293	0 445 120 179	0 445 120 229	0 445 120 082	0 445 120 091
0 445 120 064	0 445 120 106	0 445 120 149	0 445 120 213	0 445 120 245	0 445 120 294	0 445 120 180	0 445 120 233	-	0 445 120 093
0 445 120 065	0 445 120 107	0 445 120 150	0 445 120 215	0 445 120 246	0 445 120 295	0 445 120 181	0 445 120 235	-	0 445 120 126
0 445 120 066	0 445 120 110	0 445 120 153	0 445 120 217	0 445 120 247	W/ CONNECTOR	-	-	-	-
0 445 120 067	0 445 120 111	0 445 120 154	0 445 120 218	0 445 120 260	0 445 120 027	-	-	-	-
0 445 120 068	0 445 120 117	0 445 120 155	0 445 120 219	0 445 120 261	-	-	-	-	-
0 445 120 074	0 445 120 124	0 445 120 156	0 445 120 220	0 445 120 262	-	-	-	-	-
0 445 120 075	0 445 120 127	0 445 120 158	0 445 120 221	0 445 120 263	-	-	-	-	-

415.00.021

PARTS SET - CRIN2 / CRIN 3 REPAIRING - R2

JUEGO PIEZAS REPARACION CRIN 2 / CRIN 3- R2

Nº	ROBIEL CODE	DESCRIPTION	THICKNESS(mm)	UNITS BY MEASURE
AH	819.22.150 - 819.22.160	Shim - Coil - <i>Calzo Bobina Iveco Case NH</i>	1.50 to 1.60	12 units
MFK	802.04.13 - 802.04.165	Shim - Pre Injection - <i>Calzo de pre Inyeccion MWM Cummins</i>	1.30 to 1.70	12 units
MFP	805.07.100 - 805.07.112	Shim - Injector Solenoid Ball Course <i>Calzo Carrera de Apertura Bolilla Solen Inyector</i>	1.00 to 1.12	12 units
DFK	803.05.12 - 803.05.16	Shim-Piezo-Nozzle - <i>Calzo Tobera Inyector Piezo</i>	1.20 to 1.60	12 units
DNH	800.02.110 - 800.02.125	Shim - Hold - <i>Calzo Restrictor</i>	1.10 to 1.25	12 units

576 UNITS



323.01.3241

Rotating Vise W /
Indexer Pin
Morsa Giratoria con Pin index

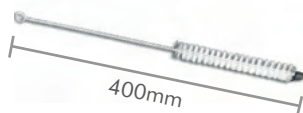

323.02.121

Cleaning Brush
Cepillo de Limpeza
Ø 12.00mm



323.01.841

Nut Wrench - Iveco/Case/NH
Injector Nozzle
Llave Wrench de la Tobera Inyector
Iveco/Case?NH
0 445 120 002|092|157|276



324.15.01

Injectors Repair Bracket
Soporte para reparación
de Inyectores



323.02.291

Tightness test Tool - CRIN 3
Valve
Herramienta Prueba Estanqueidad
Valvula CRIN 3



323.50.063

Bosch Crin 2 / Crin3 Injectors
Tool Kit
Kit de herramientas Inyectores Bosch
Crin 2 / Crin 3



CRIN 4.2 INJECTORS

INYECTORES CRIN 4.2

FREIGHTLINER | DETROIT DDE 16 15.6L
 DETROIT DDE 15 14.8L | DETROIT DDE13 12.8L

INJECTORS

- 0 445 120 104
- 0 445 120 194
- 0 445 120 195
- 0 445 120 207
- 0 445 120 270
- 0 445 120 271
- 0 445 120 283
- 0 445 120 284
- 0 445 120 285
- 0 445 120 286
- 0 445 120 287
- 0 445 120 288
- 0 445 120 298
- 0 445 120 299
- 0 445 120 300
- 0 445 120 301
- 0 445 120 302
- 0 445 120 303
- 0 445 120 374
- 0 445 120 375
- 0 445 120 385
- 0 445 120 386

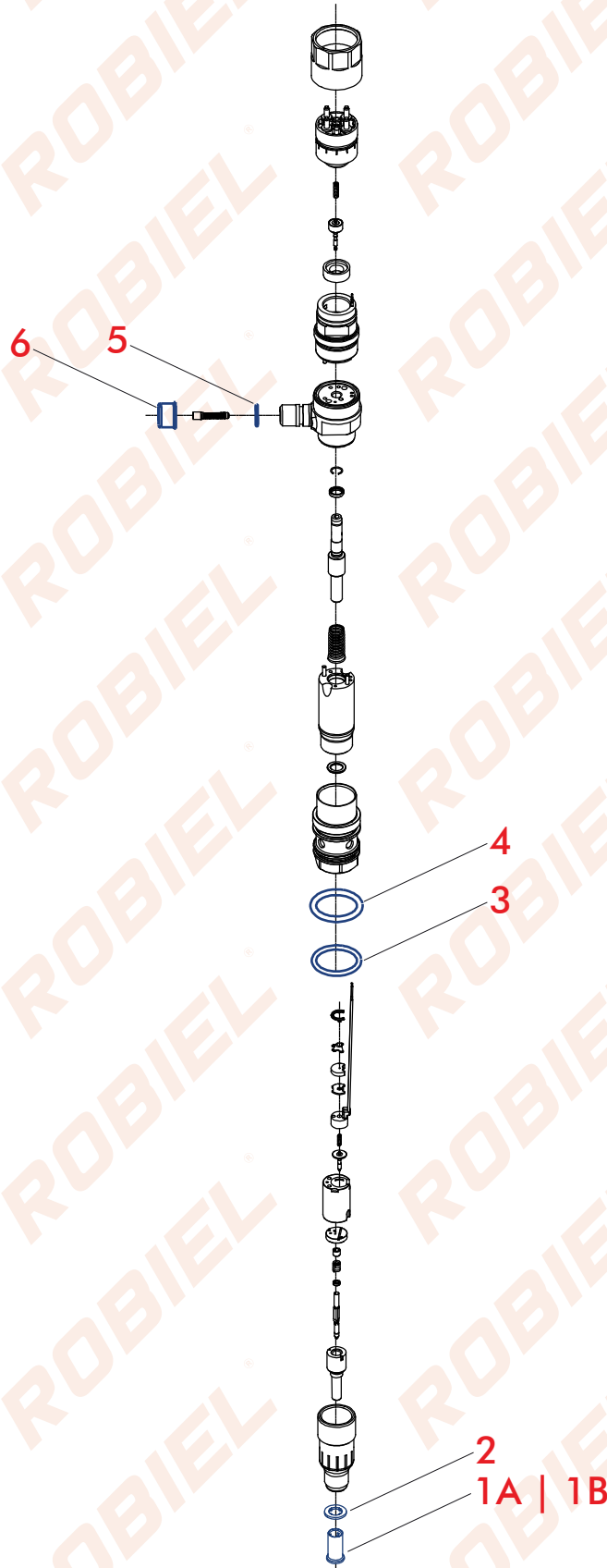

410.33.337

EXTERNAL REPAIR PARTS - CRIN 4.2 INJECTOR

REPARACION EXTERNO INYECTOR CRIN 4.2

REFERENCE		F 00E 200 337		
Nº	ROBIEL CODE	REFERENCE	DESCRIPTION	PACK
1	220.03.08	6 000 900 262	Protective Cap - Tapa Protectora	01un.
2	600.02.01	2 430 105 049	Washer - Arandela	01un.
3	421.30.265	-	O-ring - Anillo	01un.
4	421.29.735	-	O-ring - Anillo	01un.
5	421.01.320	-	O-ring - Anillo	01un.
6	220.03.03	-	Protective Cap - Tapa Protectora	01un.



SPARE PARTS Repuestos

Nº	ROBIEL CODE	REFERENCE	DESCRIPTION	PACK
1A	220.03.08	F 00R J02 537 F 00R J03 561 6.000.900.262	PROTECTIVE CAP - INJECTOR NOZZLE 7.00 MM TAPA PROTECTORA P/ TOBERA INY 7.00 MM	01kit
1A	220.03.09	F 00H 410 849 F 002 C88 080 6.000.900.076	PROTECTIVE CAP - INJECTOR NOZZLE 9.00 MM TAPA PROTECTORA P/ TOBERA INY 9.00 MM	01kit
2	220.03.03	-	PROTECTIVE CAP "C" - THREAD 16.0MM TAPA DE PROTECCION C - ROSCA 16.0MM	01kit
3	600.02.01	2 430 105 049	PROFILE WASHER - COPPER - 7.00X15.50X1.50MM ARANDELA PERFIL COBRE 7.00X15.50X1.50MM	01kit





SOLUTIONS FOR COMMON RAIL SYSTEMS

We offer the diesel segment several products for Common Rail systems aimed at workshops and repairers who are looking for better alternatives, compared to brands already on the market, either in price or in the quality of their products.

Distributed in Brazil by Robiel Injeção Diesel, a company that has operated for over 33 years in the sector, our products provide an excellent cost-benefit ratio, making the repair process simpler and more agile, in addition to offering its customers greater profitability and process optimization.

Having as main objectives the practice of affordable prices and a quality similar to the originals, we aim to become a reference both for repair shops that the culture of repair and remanufacture of diesel injection components is not possible, as for repairers who face difficulties in finding products with strength, durability and quality on the market.

VALVE SET

The control valve assembly is responsible for micro movements of opening and closing fuel flow in milliseconds and its response has to be very precise and support high mileage.



DENSO VALVES

Orifice plates are also part of a very precise fuel control system, they work in conjunction with the control valves and can be replaced separately from the rods.



These components of the common rail system are fundamental for the perfect functioning of modern diesel systems and guarantee the best fuel efficiency, engine power and compliance with emission laws.

Original Code: F 00R J00 005

B01.04.0005

Injector Number O 986 435 501 **Engine** 2.8 JTD
 O 445 120 002

Application Ducato / Jumper / Boxer 2005 - 2009



Original Code: F 00R J00 339

B01.04.0339

Injector Number O 445 120 007 **Engine** ISBe4 ISB6 - F4A

Application Agrale MA e MT12 01/2005 - 12/2009
 Iveco 170E25 e 240E25 e 170E22 12/2008 - 04/2012
 Eurocargo 170E22 01/2005
 Eurocargo 230E22 03/2006 - 12/2009
 Eurocargo 230E24 03/2006 - 12/2011
 New Holland T7060 10/2007 - 12/2014



Original Code: F 00V C01 022

B01.04.1022

Injector Number O 445 110 141 **Engine** G9U - 2.5 16V

Application Renault Master - Euro 3 2005 - 2011



Original Code: F 00V C01 023

B01.04.1023

Injector Number O 445 110 231 **Engine** MWM 4.07 TCE - SPRINT EURO 3

Application VW-Delivery 5.140/8.150 10/2005 - 12/2011
 Chevrolet S10 08/2005 - 01/2012
 Chevrolet Blazer 08/2005 - 05/2009



Original Code: F 00V C01 051

B01.04.1051

Injector Number O 445 110 190 **Engine** OM612 LA CDI 2.2 16V - 4 CIL.
 OM612 LA CDI 2.7 20V - 5 CIL.

Application MBB - Sprinter 311/313/413 - Euro 3 2002 - 2011
 MBB - Accelo 715 - Euro 3 2002 - 2011
 Gran Cherokee - 2.7 20V 2002 - 2004



Original Code: F 00R J01 278

B01.04.1278

Injector Number O 445 120 054 **Engine** NEF 4 / NEF 6

Application Iveco Tector 170E22/170E28/240E22/240E28/260E28 05/2012
 Vertis 90V16 / 130V18 10/2010 - 09/2012
 130V19 / 90V18 10/2012
 Case 2855491 / IH 2855491



B01.04.1379

Original Code: F 00V C01 379



Injector Number	O 445 110 424	Engine	2.8 CTDI
Application	Chevrolet - S10 / Trail Blazer		2012 - 2013

B01.04.1383

Original Code: F 00V C01 383



Injector Number	O 445 110 376	Engine	ISF 2.8 - Euro 5 - 150CV
Application	Cummins F350/F4000		12/2014

B01.04.1338

Original Code: F 00V C01 338



Injector Number	O 445 110 248 O 445 110 273	Engine	F1CE0481 - 3.0 - Euro 3 F1AE0481T - 2.3 - Euro 3
Application	Iveco Daily 3.0 - City Class / Daily 35S14 / 40S16 / 45S14 / 45S16 / 55S16 Scudato 70C16 Ducato / Jumper / Boxer		08/2007 - 03/2012 10/2009 - 02/2012

B01.04.1895

Original Code: F 00R J01 895



Injector Number	O 445 120 016 O 445 120 017	Engine	MWM 4.12 6.12 TCE
Application	VW 15.190 VW 17.230		2004 - 2012

B01.04.1941

Original Code: F 00R J01 941



Injector Number	O 445 120 120 O 445 120 140	Engine	ISC 8.3
Application	VW 18.320EOT Constellation 19.320 Titan Constellation 25.320 Constellation 31.320 Ford Cargo 28/40/43 e 5332		02/2006 - 12/2011 10/2005 - 12/2011 03/2008 - 08/2011 01/2007 - 12/2011

B01.04.2103

Original Code: F 00R J02 103



Injector Number	O 445 120 186 O 445 120 162 O 445 120 134	Engine	ISF 3.8
Application	VW 5.150 / 8.160 / 9.160 Foton		2012 ->

Original Code: F 00R J02 130

B01.04.2130

Injector Number	O 445 120 212	Engine	ISB4 / ISB6 / F4A
Application	VW 8150 / 24250 / 23250		2004 - 2011
	Ford 1317e / 1717e / 2422e / 2428e		2004 - 2011
	Agrale MT 12.0e		2004 - 2011
	Iveco Tector 170E22		2004 - 2011
	Eurocargo 170E22 / 230E22 / 230E24		2004 - 2011
	New Holland T7060		2004 - 2011



Original Code: F 00R J02 449

B01.04.2449

Injector Number	O 445 120 186 O 445 120 162 O 445 120 134	Engine	D0834
Application	VW Constellation 13/15.190		2012 ->



Original Code: F 00R J02 506

B01.04.2506

Injector Number	O 445 120 106 O 445 120 199 O 445 120 257 O 445 120 310	Engine	ISC 8.3 l e ISL
Application	Cargo 1832		01/2010 - 12/2011
	Cargo 1932		04/2011
	2632/2932/3132/4432/4532/ Max ton 5032/ 6332		02/2006 - 12/2011
	VW 18.320 EOT		02/2007 - 12/2011
	Constellation 17.320/19.320/24.320/25.320.31.320		02/2007 - 12/2011



Original Code: F 00V CO1 1353

B01.04.1353

Injector Number	O 445 110 265	Engine	2.5 - G9U
Application	Renault Master		2012 - 2013



CATERPILLAR | PERKINS | MITSUBISHI INJECTOR
INYECTOR CATERPILLAR | PERKINS | MITSUBISHI

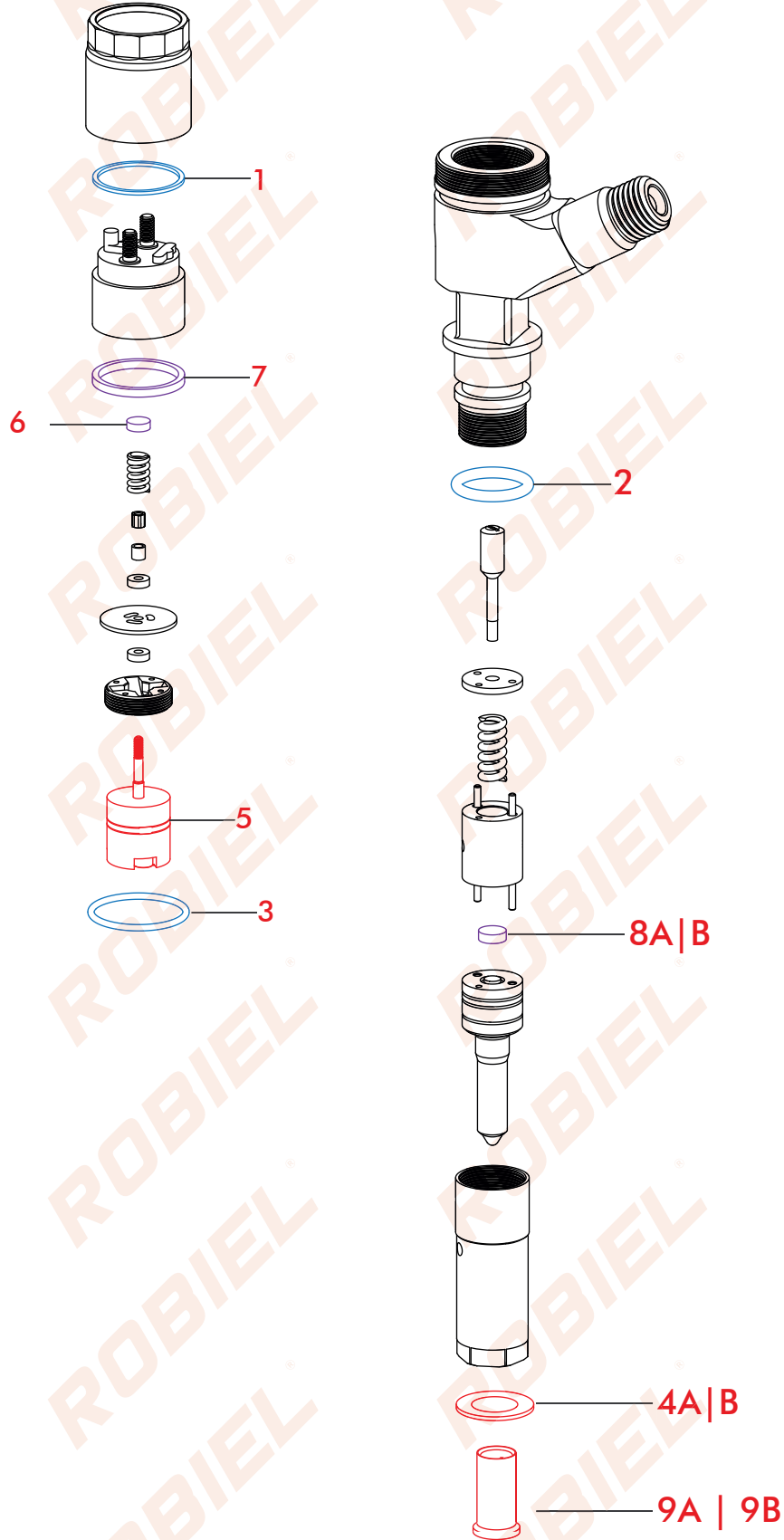

410.00.062

REPAIR PARTS - CATERPILLAR/ PERKINS NOZZLE HOLDER

REPARACION PORTA INYECTOR CATERPILLAR/PERKINS

REFERENCE				
Nº	ROBIEL CODE	REFERENCE	DESCRIPTION	PACK
1	623.26.10	-	Washer - Arandela	01un.
2	421.01.426	-	O-ring - Anillo	01un.
3	421.02.417	-	O-ring - Anillo	01un.



SPARE PARTS Repuestos

Nº	ROBIEL CODE	REFERENCE	DESCRIPTION	PACK
4A	607.14.20	MN155904	Washer - Copper 7.00 X 13.70 X 2.00mm Arandela de Cobre	48un
4B	607.14.10	-	Washer - Copper 7.00 X 13.70 X 1.00mm Arandela de Cobre	48un
5	VC6.10.0062	32F61-00062	Control Valve - Common Rail Caterpillar Injector Valvula de Control Inyector Common Rail Caterpillar	01un
9A	220.03.08	F 00R J02 537 F 00R J03 561 6.000.900.262	Protective Cap - Injectors / Units Nozzle - 7.00mm Tapa Protectora p/ Tobera Inyectores / Unidades - 7.00mm	01kit
9B	220.03.09	F 00H 410 849 F 002 C88 080 6.000.900.076	Protective Cap - Injectors / Units Nozzle - 9.00mm Tapa Protectora p/ Tobera Inyectores / Unidades - 9.00mm	01kit

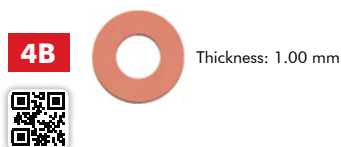

6 SHIM - NOZZLE/COIL CAT INJECTOR
CALZO TOBERA/BOBINA INYECTOR CAT

Ø Ext. Diameter: 6.60mm



ROBIEL CODE	REFERENCE	THICKNESS(mm)
800.07.218	-	2.18
800.07.220	-	2.20
800.07.222	-	2.22
800.07.224	-	2.24
800.07.226	-	2.26
800.07.228	-	2.28
800.07.230	-	2.30
800.07.232	-	2.32

08 UNITS

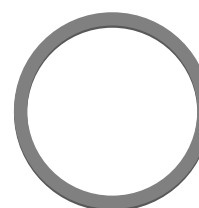

7 SHIM - CAT INJECTOR INDUCTION ADJUSTMENT
CALZO DE AJUSTE INDUCTANCIA INYECTOR CAT

22.5 x 26.0mm



ROBIEL CODE	REFERENCE	THICKNESS(mm)
822.26.228	-	2.28
822.26.230	-	2.30
822.26.232	-	2.32
822.26.234	-	2.34
822.26.236	-	2.36
822.26.238	-	2.38

08 UNITS

8A	SHIM - NOZZLE/COIL - CAT INJECTOR CALZO TOBERA/BOBINA INYECTOR CAT		
	INOX - Ø Ext. Diameter: 6.60mm		
ROBIEL CODE	REFERENCE	THICKNESS(mm)	
800.07.140	-	1.40	
800.07.142	-	1.42	
800.07.144	-	1.44	
800.07.146	-	1.46	
800.07.148	-	1.48	
800.07.150	-	1.50	
800.07.152	-	1.52	
800.07.154	-	1.54	
800.07.156	-	1.56	
800.07.158	-	1.58	
800.07.160	-	1.60	
08 UNITS			

8B	SHIM - NOZZLE/COIL - CAT INJECTOR LOW NEEDLE CALZO TOBERA/BOBINA INYECTOR CAT - AGUJA BAJA		
	INOX - Ø Ext. Diameter: 6.60mm		
ROBIEL CODE	REFERENCE	THICKNESS(mm)	
800.07.206	-	2.06	
800.07.208	-	2.08	
800.07.210	-	2.10	
800.07.212	-	2.12	
800.07.214	-	2.14	
800.07.216	-	2.16	
08 UNITS			

415.01.01	SHIM SET - CAT C4/C6 INJECTOR AND PUMP JUEGO CALZOS REPARACION INYECTOR E BOMBA CAT C4/C6		
ROBIEL CODE	DESCRIPTION	THICKNESS(mm)	UNITS BY MEASURE
800.07.140 - 800.07.230	Shim - Nozzle/Coil - Calzo Tobera/Bobina	1.40 to 2.30	12 units
822.26.228 - 822.26.238	Shim - Induction Adjustment - Calzo Inductancia	2.28 to 2.38	12 units
803.07.125 - 803.07.15	Pump Coil Shim - Calzo de la Bobina de la Bomba	1.25 to 1.50	12 units
803.09.165 - 803.09.20	Pump Coil Shim - Calzo de la Bobina de la Bomba	1.65 to 2.00	12 units
528 UNITS			



CUMMINS XPI INJECTORS
 INYECTORES CUMMINS XPI

SCANIA D9 XPI | D13 XPI | D16 XPI
 DC13 XPI CUMMINS ISX 15

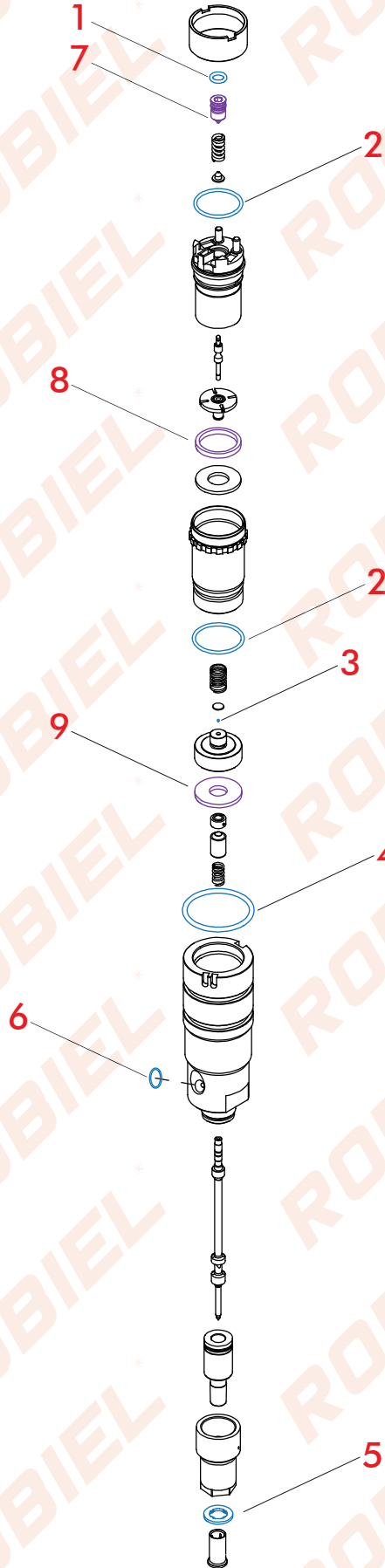

INJECTORS
1881564
2031836
2086663
2872405

410.32.211
COMPLETE REPAIR PARTS - ISX15 XPI

REPARACION COMPLETA ISX15 XPI

REFERENCE		1932820 1933246		
Nº	ROBIEL CODE	REFERENCE	DESCRIPTION	PACK
1	421.06.178	-	O-ring - Anillo	01un.
2	421.23.518	-	O-ring - Anillo	01un.
3	190.52.01	-	Ceramic Ball - Bolilla Ceramica	01un.
4	421.35.626	-	O-ring - Anillo	01un.
5	609.16.15	-	Arruela de Cobre	01un.
6	421.12.262	-	O-ring - Anillo	01un.
10	220.03.09	F 00H 410 849 F 002 C88 080 6.000.900.076	Protective Cap - Tapa Protectora p/ Tobera	01un.

410.32.212
COMPLETE REPAIR PARTS - ISX15 XPI

REPARACION COMPLETA ISX15 XPI

REFERENCE		-		
Nº	ROBIEL CODE	REFERENCE	DESCRIPTION	PACK
1	421.06.178	-	O-ring - Anillo	01un.
2	421.23.518	-	O-ring - Anillo	01un.
3	190.52.01	-	Ceramic Ball - Bolilla Ceramica	01un.
4	421.35.626	-	O-ring - Anillo	01un.
5B	600.03.05	-	Nozzle Holder - Manguito de Sellado de la Tobera	01un.
6	421.12.262	-	O-ring - Anillo	01un.

410.32.820
EXTERNAL REPAIR PARTS - ISX15 XPI

REPARACION EXTERNA ISX15 XPI

REFERENCE		1932820		
Nº	ROBIEL CODE	REFERENCE	DESCRIPTION	PACK
4	421.35.626	-	O-ring - Anillo	01un.
5	609.16.15	-	Washer - Arandela	01un.
6	421.12.262	-	O-ring - Anillo	01un.



7

SCANIA XPI BALL STROKE PLUG CUMMINS ISX15 / ISL / FOTON

BUJE DEL CURSO DE ESFERA SCANIA XPI / CUMMINS ISX15 / ISL / FOTON



ROBIEL CODE	REFERENCE	THICKNESS(mm)
165.07.620	-	6.20
165.07.630	-	6.30
165.07.640	-	6.40
165.07.650	-	6.50
165.07.660	-	6.60

01 UNIT

8

SOLENOID SHIM INJECTOR ISX / ISL / FOTON

ARANDELA DEL SOLENOIDE INYECTORES ISX / ISL / FOTON



ROBIEL CODE	REFERENCE	THICKNESS(mm)
821.82.290	-	2.90
821.82.292	-	2.92
821.82.294	-	2.94
821.82.296	-	2.96
821.82.298	-	2.98
821.82.300	-	3.00
821.82.302	-	3.02
821.82.304	-	3.04
821.82.306	-	3.06
821.82.308	-	3.08
821.82.310	-	3.10
821.82.312	-	3.12
821.82.314	-	3.14
821.82.316	-	3.16
821.82.318	-	3.18
821.82.320	-	3.20

06 UNITS

9

NOZZLE SHIM CUMMINS INJECTOR ISX15

ARANDELA DE LA TOBERA INYECTOR CUMMINS ISX15



ROBIEL CODE	REFERENCE	THICKNESS(mm)
810.26.210	-	2.10
810.26.212	-	2.12
810.26.214	-	2.14
810.26.216	-	2.16
810.26.218	-	2.18
810.26.220	-	2.20
810.26.222	-	2.22
810.26.224	-	2.24
810.26.226	-	2.26
810.26.228	-	2.28
810.26.230	-	2.30
810.26.232	-	2.32
810.26.234	-	2.34
810.26.236	-	2.36
810.26.238	-	2.38
810.26.240	-	2.40

06 UNITS



323.50.38

TOOL SET - SCANIA AND CUMMINS
XPI / ISX 15 / ISL / FOTON
KIT DE REPARACIÓN INYECTORES
SCANIA/CUMMINS XPI / ISX 15/ ISL / FOTON



323.01.3241

ROTATING VISE W/ INDEXER PIN
MORSA GIRATORIA CON PIN INDEX



324.15.01

INJECTORS REPAIR BRACKET
SOPORTE PARA REPARACION DE
INYECTORES



CUMMINS ISL INJECTORS
 INYECTORES CUMMINS ISL

SCANIA

INJECTORS

2872127
4954927
4984332
4954679

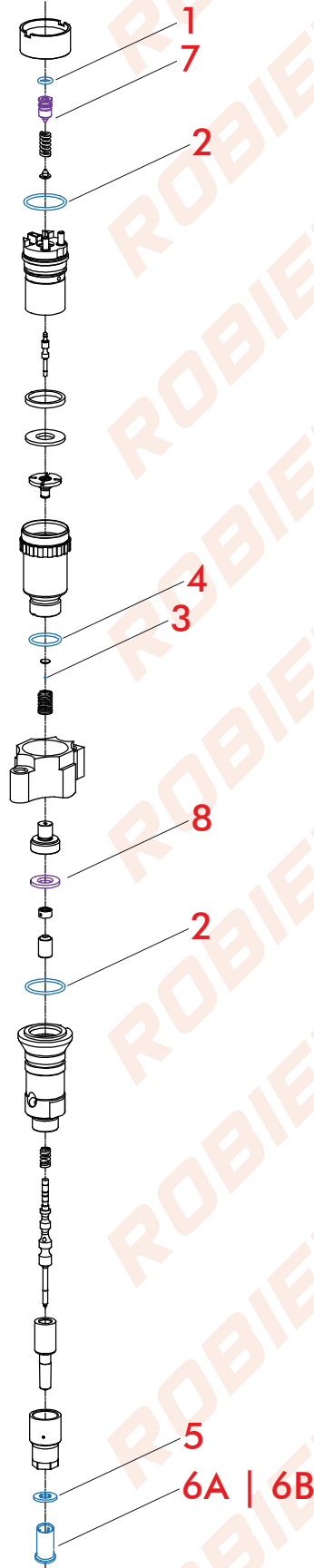

410.32.127

COMPLETE REPAIR PARTS CUMMINS ISC/ISL/QSL/QSC

REPARACION COMPLETA CUMMINS ISC/ISL/QSL/QSC

REFERENCE				
Nº	ROBIEL CODE	REFERENCE	DESCRIPTION	PACK
1	421.06.178	-	O-ring - Anillo	01un.
2	421.23.518	-	O-ring - Anillo	01un.
3	190.52.01	-	Ceramic Ball - Bolilla Ceramica	01un.
4	421.01.717	-	O-ring - Anillo	01un.
5	600.02.07	F 00V C17 503	Washer - Arandela	01un.
6A	220.03.08	F 00R J02 537 F 00R J03 561 6.000.900.262	Protective Cap - Tapa Protectora	01un.



SPARE PARTS

Repuestos

Nº	ROBIEL CODE	REFERENCE	DESCRIPTION	PACK
5	600.02.07	F 00V C17 503	PROFILE WASHER - COPPER - 7.00X15.00X1.50MM ARANDELA PERFIL COBRE 7.00X15.00X1.50MM	24un.
6A	220.03.08	F 00R J02 537 F 00R J03 561 6.000.900.262	PROTECTIVE CAP - INJECTOR NOZZLE 7.00 MM TAPA PROTECTORA P/ TOBERA INY 7.00 MM	01kit.
6B	220.03.09	F 00H 410 849 F 002 C88 080 6.000.900.076	PROTECTIVE CAP - INJECTOR NOZZLE 9.00 MM TAPA PROTECTORA P/ TOBERA INY 9.00 MM	01kit.

5



6A



6B



7

SCANIA XPI BALL STROKE PLUG

CUMMINS ISX15 / ISL / FOTON

BUJE DEL CURSO DE ESFERA SCANIA XPI / CUMMINS ISX15 / ISL / FOTON



ROBIEL CODE	REFERENCE	THICKNESS(mm)
165.07.620	-	6.20
165.07.630	-	6.30
165.07.640	-	6.40
165.07.650	-	6.50
165.07.660	-	6.60

01 UNIT

8

SOLENOID SHIM INJECTOR

ISX / ISL / FOTON

ARANDELA DEL SOLENOIDE INYECTORES ISX / ISL / FOTON

ROBIEL CODE	REFERENCE	THICKNESS(mm)
821.82.290	-	2.90
821.82.292	-	2.92
821.82.294	-	2.94
821.82.296	-	2.96
821.82.298	-	2.98
821.82.300	-	3.00
821.82.302	-	3.02
821.82.304	-	3.04
821.82.306	-	3.06
821.82.308	-	3.08
821.82.310	-	3.10
821.82.312	-	3.12
821.82.314	-	3.14
821.82.316	-	3.16
821.82.318	-	3.18
821.82.320	-	3.20

06 UNITS

9

NOZZLE SHIM CUMMINS INJECTOR

ARANDELA DE LA TOBERA CUMMINS ISL

ROBIEL CODE	REFERENCE	THICKNESS(mm)
818.91.0190	-	1.90
818.91.0192	-	1.92
818.91.0194	-	1.94
818.91.0196	-	1.96
818.91.0198	-	1.98
818.91.0200	-	2.00
818.91.0202	-	2.02
818.91.0204	-	2.04
818.91.0206	-	2.06
818.91.0208	-	2.08
818.91.0210	-	2.10
818.91.0212	-	2.12
818.91.0214	-	2.14
818.91.0216	-	2.16
818.91.0218	-	2.18
818.91.0220	-	2.20

06 UNITS

DAF MX13 INJECTORS
INYECTORES DAF MX13

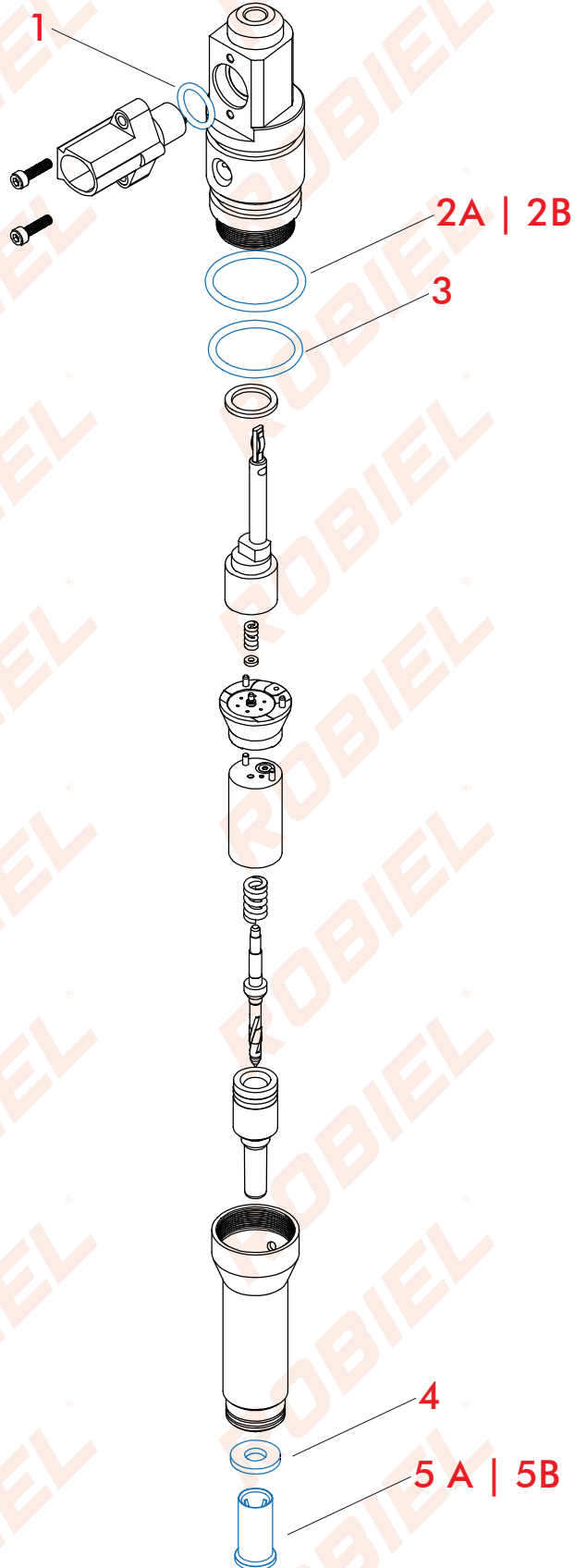

410.12.900

REPAIR PARTS - DAF MX13 INJECTOR

REPARACION INYECTOR DAF MX13

REFERENCE		182-5900 213-5457		
Nº	ROBIEL CODE	REFERENCE	DESCRIPTION	PACK
1	421.01.220	-	O-ring - Anillo	01 un.
2A	421.27.200	182-5900	O-ring - Anillo	01 un.
2B	421.27.250	213-5457	O-ring - Anillo	01 un.
3	421.24.250	-	O-ring - Anillo	01 un.
4	807.16.20	-	Washer - Arandela	01 un.
5A	220.03.08	-	Protective Cap - Tapa Protectora	01 un.



SPARE PARTS

Repuestos

Nº	ROBIEL CODE	REFERENCE	DESCRIPTION	PACK
5A	220.03.08	F 00R J02 537 F 00R J03 561 6.000.900.262	PROTECTIVE CAP - INJECTOR NOZZLE 7.00 MM TAPA PROTECTORA P/ TOBERA INY 7.00 MM	01 kit.
5B	220.03.09	F 00H 410 849 F 002 C88 080 6.000.900.076	PROTECTIVE CAP - INJECTOR NOZZLE 9.00 MM TAPA PROTECTORA P/ TOBERA INY 9.00 MM	01 kit.

5A



5B



323.50.41

TOOL SET - DAF INJECTORS / UNIT PUMP
JUEGO DE REPARACIÓN INYECTOR Y UNIDAD DAF



323.01.3241

ROTATING VISE W/ INDEXER PIN
MORSA GIRATORIA CON PIN INDEX



324.15.01

INJECTORS REPAIR BRACKET
SOPORTE PARA REPARACION DE INYECTORES



DELPHI INJECTORS
INYECTORES DELPHI

HR
H100
Sprinter
Kia Bongo

INJECTOR CODE
28229873

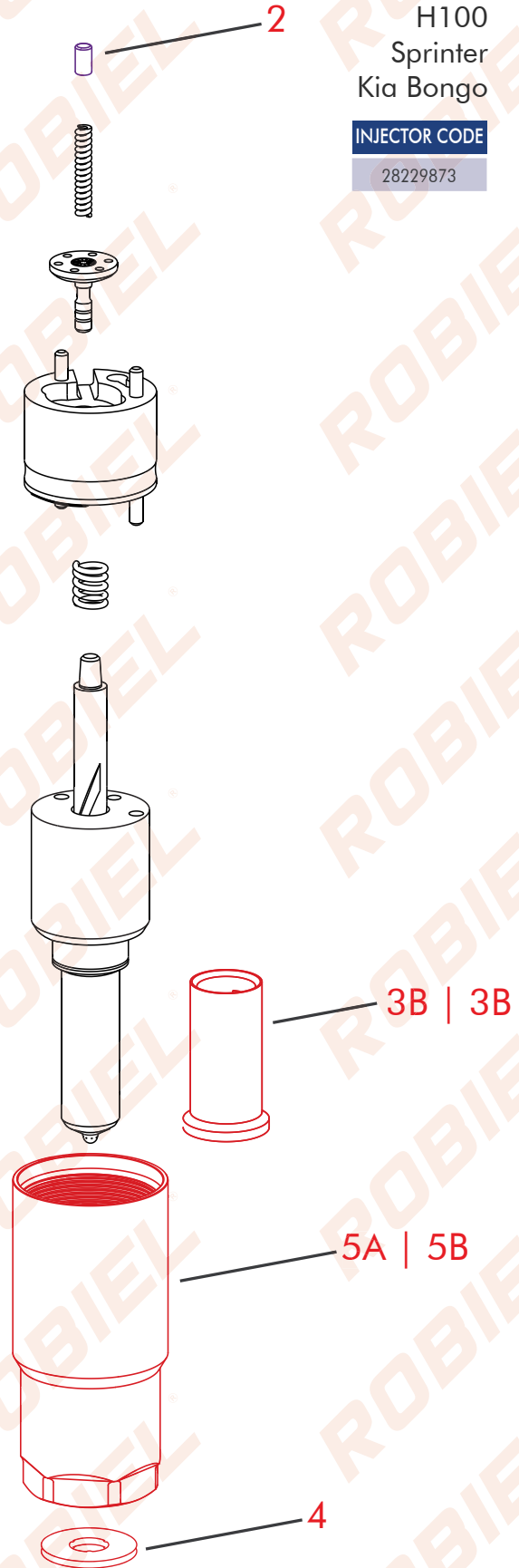
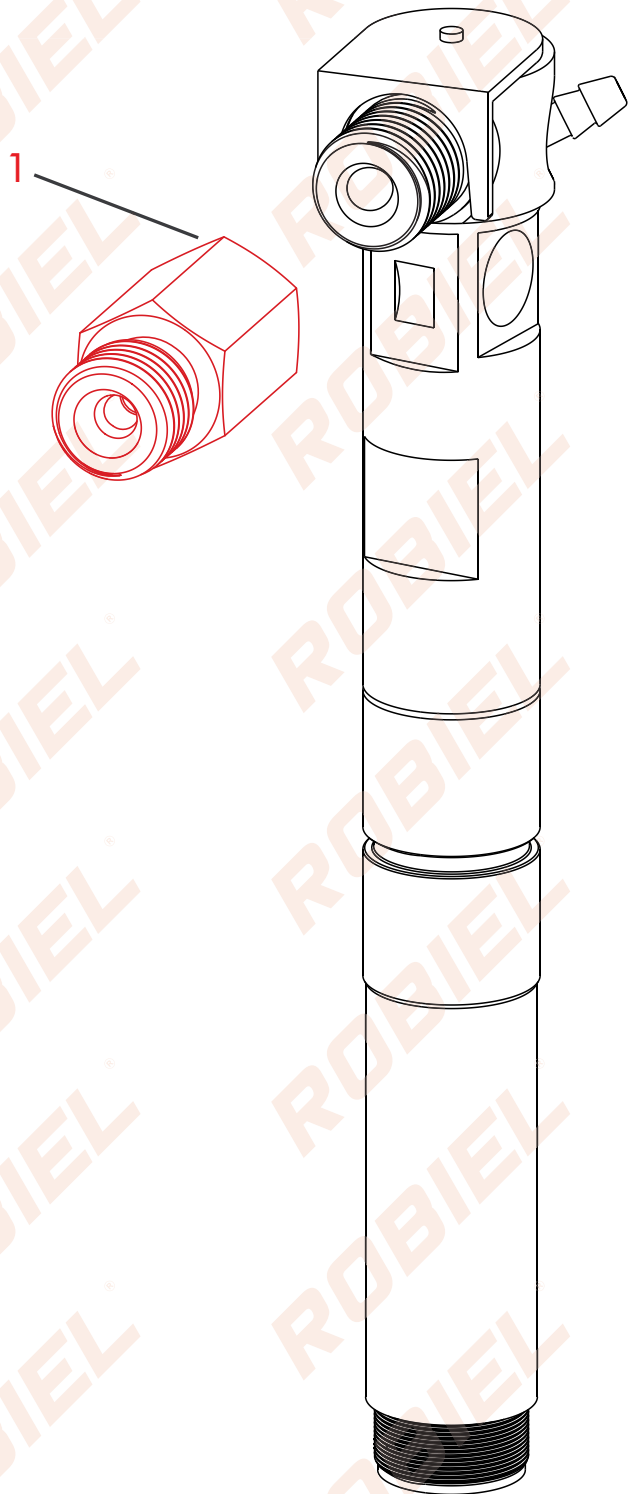

SPARE PARTS Repuestos

Nº	ROBIEL CODE	REFERENCE	DESCRIPTION	PACK
1	165.02.15	Injetores c/ Caneta	Connection W/Filter - Delphi/Bosch M14 CR Injector <i>Conexion C/ Filtro p/ Inyector CR Delphi/Bosch</i>	01un
3A	220.03.08	F 00R J02 537 F 00R J03 561 6.000.900.262	Protective Cap - Injectors / Units Nozzle - 7.00mm <i>Tapa Protectora p/ Tobera Inyectores / Unidades - 7.00mm</i>	01kit
3B	220.03.09	F 00H 410 849 F 002 C88 080 6.000.900.076	Protective Cap - Injectors / Units Nozzle - 9.00mm <i>Tapa Protectora p/ Tobera Inyectores / Unidades - 9.00mm</i>	01kit
4	607.14.20	MN155904	Washer - Copper 7.00 X 14.00 X 2.00mm <i>Arandela de Cobre</i>	48un
5A	315.06.59	28229873	Nut - Nozzle-Retaining - Delphi Kia Bongo <i>Tapa de la Tobera Delphi Kia Bongo</i>	01un
5B	315.06.63	-	Nut - Nozzle-Retaining - MBB Sprinter <i>Tapa de la Tobera MBB Sprinter</i>	01un



2	SHIM - DELPHI INJECTORS DEBT ADJUSTING CALZO REGULACION DEB. INYECTORS DELPHI		
	ROBIEL CODE	APLICAÇÃO	THICKNESS(mm)
	800.20.5260	HR SPRINTER	2.60
	800.20.5265	HR SPRINTER	2.65
	800.20.5270	HR SPRINTER	2.70
	800.20.5275	HR SPRINTER	2.75
	800.20.5280	HR SPRINTER	2.80
	800.20.5285	HR SPRINTER	2.85
	800.20.5290	HR SPRINTER	2.90
	800.20.5295	HR SPRINTER	2.95
	800.20.5300	HR SPRINTER	3.00
06 UNITS			

DELPHI INJECTORS
INYECTORES DELPHI

JCB
Ssangyong Action

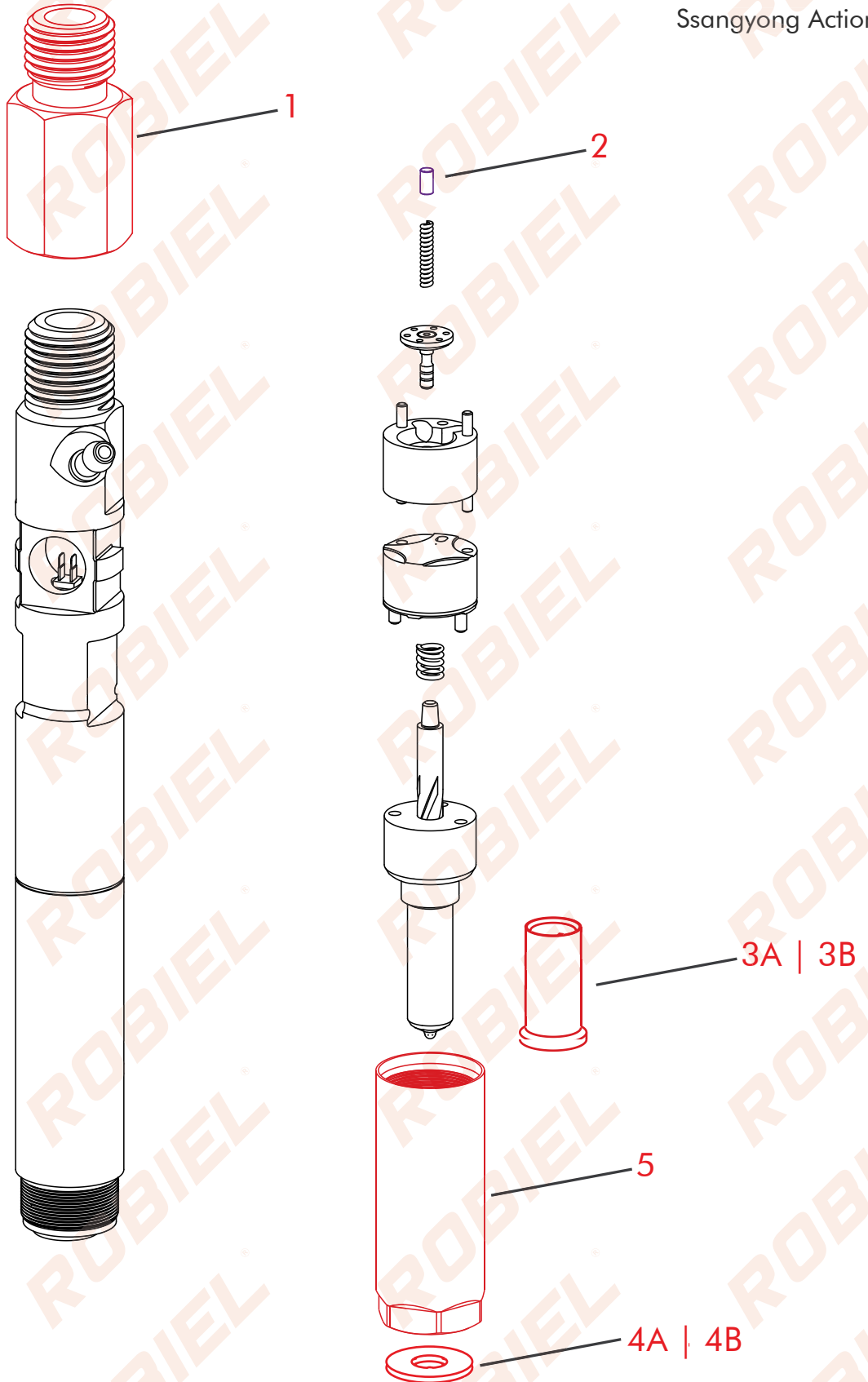

SPARE PARTS Repuestos

Nº	ROBIEL CODE	REFERENCE	DESCRIPTION	PACK
1	165.02.15	Inyectores c/ Caneta	Connection W/Filter - Delphi/Bosch M14 CR Injector <i>Conexion C/ Filtro p/ Inyector CR Delphi/Bosch</i>	01un
3A	220.03.08	F 00R J02 537 F 00R J03 561 6.000.900.262	Protective Cap - Injectors / Units Nozzle - 7.00mm <i>Tapa Protectora p/ Tobera Inyectores / Unidades - 7.00mm</i>	01kit
3B	220.03.09	F 00H 410 849 F 002 C88 080 6.000.900.076	Protective Cap - Injectors / Units Nozzle - 9.00mm <i>Tapa Protectora p/ Tobera Inyectores / Unidades - 9.00mm</i>	01kit
4A	600.02.07	F 00V C17 503 F 00R J01 453	Washer - Cummins Nozzle <i>Arandela de la Tobera Cummins</i>	24un
4B	600.02.08	F 00V C17 505 F 00R J01 086	Washer - MWM Nozzle <i>Arandela de la Tobera MWM</i>	24un
5	315.06.60	-	Nut - Nozzle-Retaining - JCB / Ssangyong <i>Tapa de la Tobera JCB / Ssangyong</i>	01un



Thread: M14 X 1.50mm
Used in Injectors w/ Stick
Utilizado en inyectores con Caneta/baston



Thickness:: 1.50mm
Ø EXT: 15.00mm



Thickness:: 2.00mm
Ø EXT: 15.00mm



2	SHIM - DELPHI INJECTORS DEBT ADJUSTING CALZO REGULACION DEB. INYECTORS DELPHI		
		Ø Ext.: 2.00	
ROBIEL CODE	REFERENCE	THICKNESS(mm)	
800.20.5360	-	3.60	
800.20.5365	-	3.65	
800.20.5370	-	3.70	
800.20.5375	-	3.75	
800.20.5380	-	3.80	
800.20.5385	-	3.85	
800.20.5390	-	3.90	
800.20.5395	-	3.95	
800.20.5400	-	4.00	
06 UNITS			

G2 DENSO INJECTORS
 INYECTORES DENSO G2

JOHN DEERE INJECTORS
095000-5190
095000-6480
095000-6481
095000-6482
OTHERS
Sinotruck

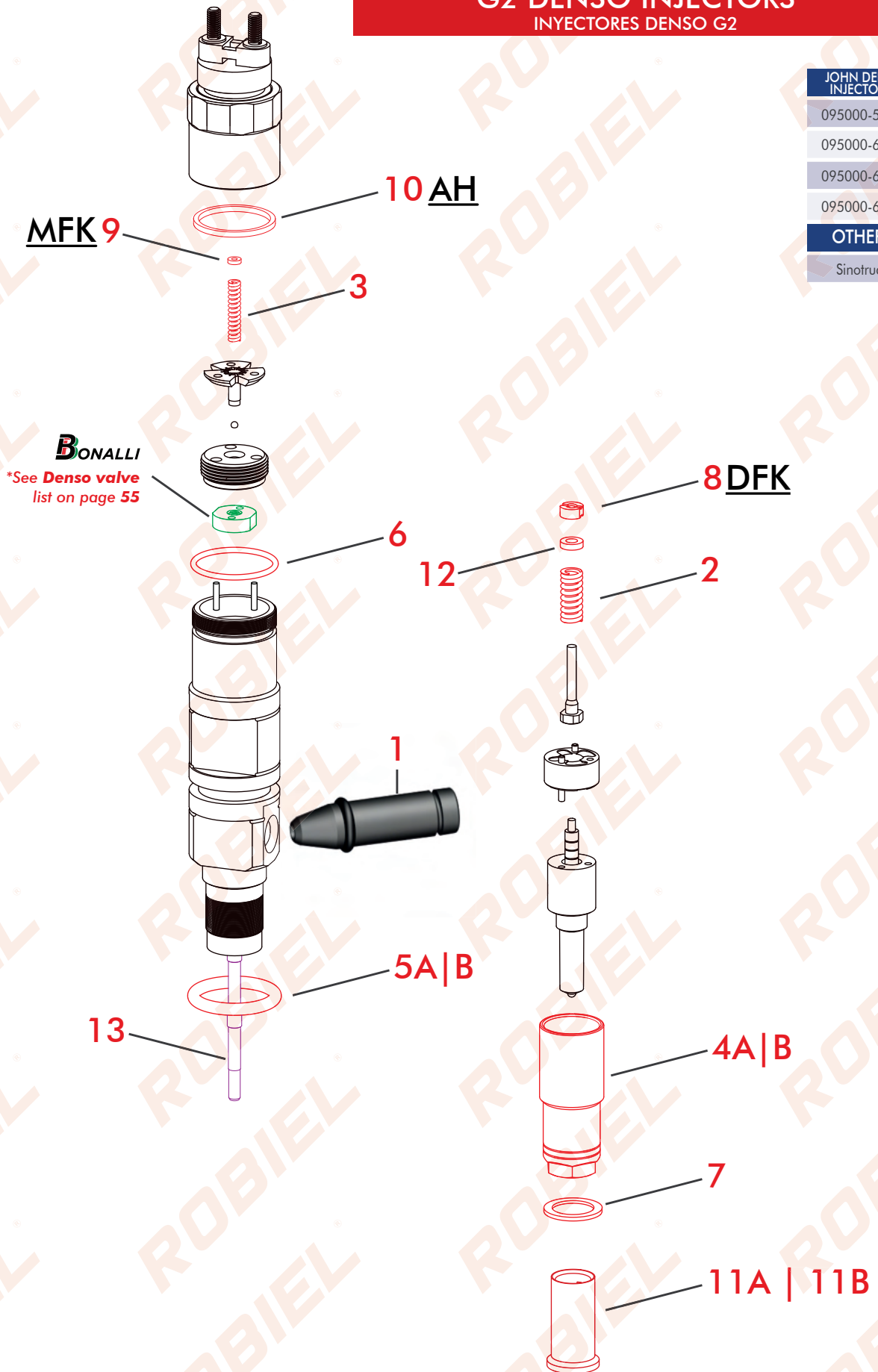

410.70.461

REPAIR PARTS - JOHN DEERE 9.0L

REPARACION INYECTOR JOHN DEERE 9.0L

ROBIEL CODE	REFERENCE	DESCRIPTION	PACK
421.00.926	-	O-ring - Anillo	01un
421.02.035	-	O-ring - Anillo	01un
421.02.318	-	O-ring - Anillo	01un
607.16.22	-	Washer - Arandela	01un
220.03.08	-	Protective Cap - Tapa Protectora	01un



410.70.151

REPAIR PARTS - JOHN DEERE 8.1L - HPCR

REPARACION INYECTOR JOHN DEERE 8.1L - HPCR

ROBIEL CODE	REFERENCE	DESCRIPTION	PACK
421.00.926	-	O-ring - Anillo	01un
421.02.020	-	O-ring - Anillo	01un
421.02.318	-	O-ring - Anillo	01un
607.16.22	-	Washer - Arandela	01un
220.03.08	-	Protective Cap - Tapa Protectora	01un



SPARE PARTS

Repuestos

Nº	ROBIEL CODE	REFERENCE	DESCRIPTION	PACK
1	165.03.06	-	Connection - Denso 5190 John Deere Injector Input <i>Conexion Entrada Inyector Denso 5190 John Deere</i>	01un
2	225.01.38	-	Spring - Denso John Deere Injector Nozzle <i>Resorte de la Tobera Inyector Denso John Deere</i>	06un
3	225.01.39	-	Spring - Denso John Deere / Hilux Solenoide <i>Resorte del Solenoide Denso John Deere / Hilux</i>	06un
4A	315.06.54	-	Nut - Nozzle-Retaining Denso John Deere <i>Tapa de la Tobera Del Inyector Denso John Deere</i>	04un
4B	315.06.34	-	Nut - Nozzle-Retaining Denso John Deere 6480/81/82 <i>Tapa de la Tobera Del Inyector Denso John Deere 6480/81/82</i>	06un
5A	421.02.020	-	O-ring - Denso Injector 095000-5190 <i>Anillo Inyector Denso 095000-5190</i>	12un
5B	421.02.035	-	O-ring - Denso Injector 095000-6480 / 81 / 82 <i>Anillo Inyector Denso 095000-6480 / 81 / 82</i>	06un
6	421.02.318	-	O-ring - Denso Injector - Solenoide <i>Anillo Solenoide Inyector Denso</i>	12un
7	807.13.20	-	Washer - Denso Nozzle <i>Arandela de la Tobera Denso</i>	48un
11A	220.03.08	F 00R J02 537 F 00R J03 561 6.000.900.262	Protective Cap - Injectors / Units Nozzle - 7.00mm <i>Tapa Protectora p/ Tobera Inyectores / Unidades - 7.00mm</i>	01kit
11B	220.03.09	F 00H 410 849 F 002 C88 080 6.000.900.076	Protective Cap - Injectors / Units Nozzle - 9.00mm <i>Tapa Protectora p/ Tobera Inyectores / Unidades - 9.00mm</i>	01kit



Ø INT: 7.00mm
Ø EXT: 13.00mm
Thickness: 2.00mm



8 SHIM - DENSO JOHN DEERE INJECTORS (DFK)
CALZO DEL INYECTOR DENSO JOHN DEERE 



ROBIEL CODE	REFERENCE	THICKNESS(mm)
800.00.290	-	2.90
800.00.295	-	2.95
800.00.300	-	3.00
800.00.305	-	3.05
800.00.310	-	3.10

12 UNITS

9 SHIM - PRE-INJECTION - DENSO INJECTOR (MFK)
CALZO PRE INYECCION INYECTOR DENSO 
Ø Int.: 1.80 Ø Ext.: 4.00



ROBIEL CODE	REFERENCE	THICKNESS(mm)
801.04.12	-	1.20
801.04.125	-	1.25
801.04.13	-	1.30
801.04.135	-	1.35
801.04.14	-	1.40
801.04.145	-	1.45
801.04.15	-	1.50

06 UNITS

10 SHIM - DENSO 5190 INJECTOR SOLENOID (AH)
CALZO SOLENOIDE INYECTOR DENSO 5190 
Ø Int.: 21.40 Ø Ext.: 24.30



ROBIEL CODE	THICKNESS(mm)	ROBIEL CODE	THICKNESS(mm)
821.24.150	1.50	821.24.161	1.61
821.24.151	1.51	821.24.162	1.62
821.24.152	1.52	821.24.163	1.63
821.24.153	1.53	821.24.164	1.64
821.24.154	1.54	821.24.165	1.65
821.24.155	1.55	821.24.166	1.66
821.24.156	1.56	821.24.167	1.67
821.24.157	1.57	821.24.168	1.68
821.24.158	1.58	821.24.169	1.69
821.24.159	1.59	821.24.170	1.70
821.24.160	1.60		

10 UNITS

12 SHIM - INJECTOR SPRING
CALZO DEL RESORTE 
Ø Int.: 3.50 Ø Ext.: 6.75



ROBIEL CODE	THICKNESS(mm)
804.06.130	1.30
804.06.135	1.35
804.06.140	1.40
804.06.145	1.45
804.06.150	1.50
804.06.155	1.55
804.06.160	1.60
804.06.165	1.65
804.06.170	1.70

06 UNITS

13 **ROD - DENSO INJECTOR - 5160**
VASTAGO INYECTOR DENSO 5160 
Length 79.20mm

ROBIEL CODE	REFERENCE	THICKNESS(mm)
BID.01.4300	-	4.300
BID.01.4305	-	4.305

01 UNIT



13 **ROD - DENSO INJECTOR - 6490**
VASTAGO INYECTOR DENSO 6490 
Length 66.70mm

ROBIEL CODE	REFERENCE	THICKNESS(mm)
BID.02.4300	-	4.300
BID.02.4302	-	4.302
BID.02.4305	-	4.305

01 UNIT



13 **ROD - DENSO INJECTOR - 23670-0L020 (HILUX 3.0)**
VASTAGO INYECTOR DENSO 23670-0L020 (HILUX 3.0) 
Length 117.70mm

ROBIEL CODE	REFERENCE	THICKNESS(mm)
BID.03.4300	-	4.300
BID.03.4305	-	4.305

01 UNIT



13 **ROD - DENSO INJECTOR - 16600-EB70A**
VASTAGO INYECTOR DENSO 16600-EB70A
(FRONTIER/TRANSIT) 
Length 125.85mm

ROBIEL CODE	REFERENCE	THICKNESS(mm)
BID.04.4300	-	4.300
BID.04.4305	-	4.305

01 UNIT



13 **ROD - DENSO INJECTOR - 1465A054**
VASTAGO INYECTOR DENSO 1465A054
(TRITON) 
Length 125.90mm

ROBIEL CODE	REFERENCE	THICKNESS(mm)
BID.05.4300	-	4.300
BID.05.4305	-	4.305

01 UNIT



13 **ROD - DENSO INJECTOR - 6700**
VASTAGO INYECTOR DENSO 6700
(SINOTRUCK) 
Length 77.50mm

ROBIEL CODE	REFERENCE	THICKNESS(mm)
BID.06.4300	-	4.300
BID.06.4305	-	4.305

01 UNIT



13 **ROD - DENSO INJECTOR - 09500-631**
VASTAGO INYECTOR DENSO 09500 - 631 
Length 4.300mm

ROBIEL CODE	REFERENCE	THICKNESS(mm)
BID.08.4300	-	4.300
BID.08.4302	-	4.302
BID.08.4305	-	4.305

01 UNIT





324.44.001
Grinding Tool to Denso Rod
Housing
Herramienta Rectificar Alojamiento
Baston Denso
Ø 4.300mm 



324.44.002
Grinding Tool to Denso Rod
Housing
Herramienta Rectificar Alojamiento
Baston Denso
Ø 4.305mm 

G2 | G3 DENSO INJECTORS
 INYECTORES DENSO G2 | G3

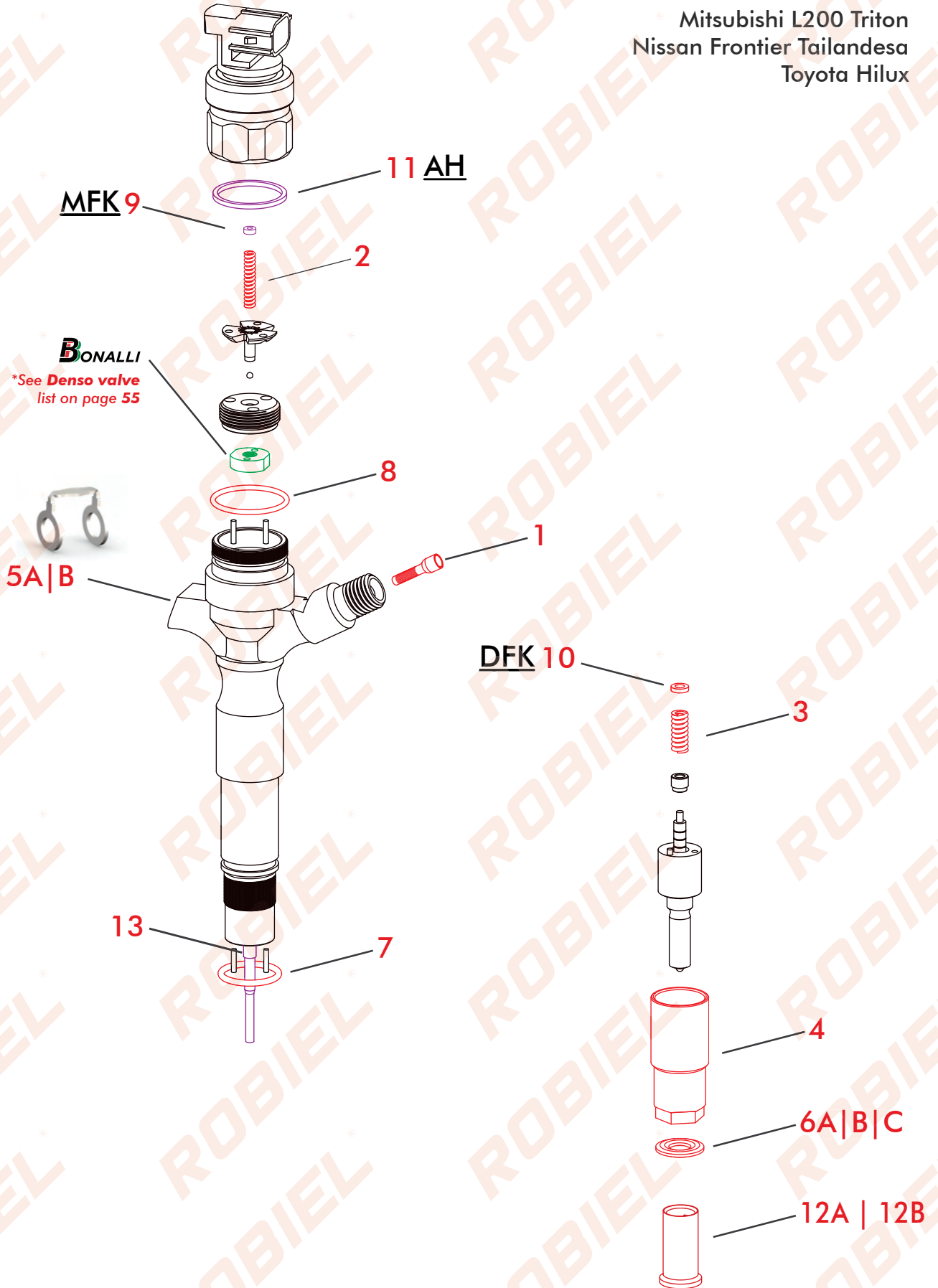
Mitsubishi L200 Triton
 Nissan Frontier Tailandesa
 Toyota Hilux



410.00.35

REPAIR SET - DENSO/HILUX INJECTOR

REPARACION INYECTOR DENSO HILUX

REFERENCE				
Nº	ROBIEL CODE	REFERENCE	DESCRIPTION	PACK
5A	602.08.13	-	Washer Double - Arandela Doble	05un.
6B	608.16.19	-	Washer - Arandela	04un.
7	421.01.720	-	O-ring - Anillo	04un.
8	421.02.318	-	O-ring - Anillo	04un.



410.00.36

REPAIR SET - DENSO/NISSAN FRONTIER INJECTOR

REPARACION INYECTOR DENSO NISSAN FRONTIER

REFERENCE				
Nº	ROBIEL CODE	REFERENCE	DESCRIPTION	PACK
5B	602.08.14	-	Washer Double - Arandela Doble	05un.
6A	607.14.20	-	Washer - Arandela	04un.
7	421.01.720	-	O-ring - Anillo	04un.
8	421.02.318	-	O-ring - Anillo	04un.



SPARE PARTS

Repuestos

Nº	ROBIEL CODE	REFERENCE	DESCRIPTION	PACK
1	200.02.01	093152-0320	Filter - Denso Injector <i>Filtro del Inyector Denso</i>	04un.
2	225.01.39	-	Spring - Denso John Deere / Hilux Solenoide <i>Resorte del Solenoide Denso John Deere / Hilux</i>	06un.
3	225.01.40	-	Spring - Denso Hilux Injector Nozzle Shim <i>Resorte del Calzo de la Tobera inyector Denso Hilux</i>	06un.
4	315.06.54	0 950 810 760	Nut - Nozzle-Retaining Denso John Deere <i>Tapa de la Tobera Del Inyector Denso John Deere</i>	04un.
5A	602.08.13	-	Washer - Double - Hilux <i>Arandela Doble Hilux</i>	08un.
5B	602.08.14	16635-84800	Washer - Double - Nissan Frontier <i>Arandela Doble Nissan Frontier</i>	04un.
6A	607.14.20	MN155904	Washer - L200 Triton Nozzle <i>Arandela de la Tobera L200 Triton</i>	48un.
6B	608.16.19	-	Washer - Hilux 3.0 Nozzle <i>Arandela de la Tobera Hilux 3.0</i>	48un.
6C	608.16.30	-	Washer - Hilux 3.0 Nozzle <i>Arandela de la Tobera Hilux 3.0</i>	12un.
7	421.01.720	F 00R 0P0 397	O-ring - Hilux 3.0 Injector <i>Anillo Inyector Hilux 3.0</i>	12un.
8	421.02.318	-	O-ring - Injector - Solenoide <i>Anillo Solenoide Inyector Denso</i>	12un.
12A	220.03.08	-	Protective Cap - Injectors / Units Nozzle - 7.00mm <i>Tapa Protectora p/ Tobera Inyectores / Unidades - 7.00mm</i>	01kit.
12B	220.03.09	-	Protective Cap - Injectors / Units Nozzle - 9.00mm <i>Tapa Protectora p/ Tobera Inyectores / Unidades - 9.00mm</i>	01kit.



9 SHIM - PRE-INJECTION - DENSO INJECTOR (MFK)
CALZO PRE INYECCION INYECTOR DENSO 

Ø Int.: 1.80 Ø Ext.: 4.00

ROBIEL CODE	REFERENCE	THICKNESS(mm)
801.04.12	-	1.20
801.04.125	-	1.25
801.04.13	-	1.30
801.04.135	-	1.35
801.04.14	-	1.40
801.04.145	-	1.45
801.04.15	-	1.50
06 UNITS		

10 SHIM - ADJUSTMENT - FORD RANGER NOZZLE (DFK)
CALZO DE AJUSTE TOBERA FORD RANGER 

Ø Int.: 3.00 Ø Ext.: 5.70

ROBIEL CODE	REFERENCE	THICKNESS(mm)
803.02.130	-	1.30
803.02.135	-	1.35
803.02.140	-	1.40
803.02.145	-	1.45
803.02.150	-	1.50
803.02.155	-	1.55
803.02.160	-	1.60
803.02.165	-	1.65
803.02.170	-	1.70
803.02.175	-	1.75
803.02.180	-	1.80
803.02.190	-	1.90
803.02.200	-	2.00
06 UNITS		

11 SHIM - DENSO 5190 INJECTOR SOLENOID (AH)
CALZO SOLENOIDE INYECTOR DENSO 5190 

Ø Int.: 21.40 Ø Ext.: 24.30

ROBIEL CODE	REFERENCE	THICKNESS(mm)
821.24.150	-	1.50
821.24.151	-	1.51
821.24.152	-	1.52
821.24.153	-	1.53
821.24.154	-	1.54
821.24.155	-	1.55
821.24.156	-	1.56
821.24.157	-	1.57
821.24.158	-	1.58
821.24.159	-	1.59
821.24.160	-	1.60
821.24.161	-	1.61
821.24.162	-	1.62
821.24.163	-	1.63
821.24.164	-	1.64
821.24.165	-	1.65
821.24.166	-	1.66
821.24.167	-	1.67
821.24.168	-	1.68
821.24.169	-	1.69
821.24.170	-	1.70
10 UNITS		

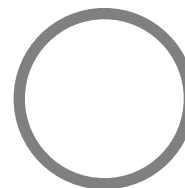



13 ROD - DENSO INJECTOR - 5160
VASTAGO INYECTOR DENSO 5160 

Length 79.20mm

ROBIEL CODE	REFERENCE	THICKNESS(mm)
BID.01.4300	-	4.300
BID.01.4305	-	4.305

01 UNIT





13 ROD - DENSO INJECTOR - 6490
VASTAGO INYECTOR DENSO 6490 

Length 66.70mm

ROBIEL CODE	REFERENCE	THICKNESS(mm)
BID.02.4300	-	4.300
BID.02.4302	-	4.302
BID.02.4305	-	4.305

01 UNIT





13 ROD - DENSO INJECTOR - 23670-0L020 (HILUX 3.0)
VASTAGO INYECTOR DENSO 23670-0L020 (HILUX 3.0) 

Length 117.70mm

ROBIEL CODE	REFERENCE	THICKNESS(mm)
BID.03.4300	-	4.300
BID.03.4305	-	4.305

01 UNIT





13 ROD - DENSO INJECTOR - 16600-EB70A
VASTAGO INYECTOR DENSO 16600-EB70A (FRONTIER/TRANSIT) 

Length 125.85mm

ROBIEL CODE	REFERENCE	THICKNESS(mm)
BID.04.4300	-	4.300
BID.04.4305	-	4.305

01 UNIT





13 ROD - DENSO INJECTOR - 1465A054
VASTAGO INYECTOR DENSO 1465A054 (TRITON) 

Length 125.90mm

ROBIEL CODE	REFERENCE	THICKNESS(mm)
BID.05.4300	-	4.300
BID.05.4305	-	4.305

01 UNIT





13 ROD - DENSO INJECTOR - 6700
VASTAGO INYECTOR DENSO 6700 (SINOTRUCK) 

Length 77.50mm

ROBIEL CODE	REFERENCE	THICKNESS(mm)
BID.06.4300	-	4.300
BID.06.4305	-	4.305

01 UNIT



13 ROD - DENSO INJECTOR - 09500-631
VASTAGO INYECTOR DENSO 09500 - 631 

Length 4.300mm

ROBIEL CODE	REFERENCE	THICKNESS(mm)
BID.08.4300	-	4.300
BID.08.4302	-	4.302
BID.08.4305	-	4.305

01 UNIT



324.44.001
Grinding Tool to Denso Rod
Housing
Herramienta Rectificar Alojamento
Baston Denso
Ø 4.300mm 



324.44.002
Grinding Tool to Denso Rod
Housing
Herramienta Rectificar Alojamento
Baston Denso
Ø 4.305mm 

415.00.031

SHIM SET - DENSO/SIEMENS REPAIRING

JUEGO CALZOS REPARACION DENSO / SIEMENS

Nº	ROBIEL CODE	DESCRIPTION	THICKNESS(mm)	UNITS BY MEASURE
AH	821.24.150 - 821.24.170		1.50 to 1.70	12 units
MFK	801.04.12 - 801.04.15	Shim - Pre Injection - Calzo Pre Inyeccion	1.20 to 1.50	12 units
DFK	800.00.290 - 800.00.310	Shim - Denso G2 - Calzo Denso G2	2.90 to 3.10	12 units
DFK	803.02.130 - 803.02.160	Shim - Adjustment - Nozzle - Calzo Del Ajuste Tobera	1.30 to 1.60	12 units
-	814.18.090 - 814.18.100	Shim - Adjustment Siemens - Calzo Del Ajuste Siemens	0.90 to 1.00	12 units

612 UNITS

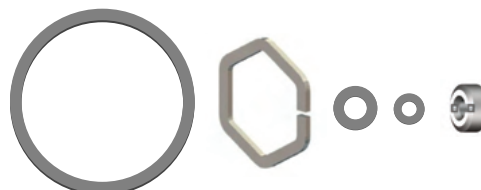

323.01.3241

Rotating Vise W /
Indexer Pin
Morsa Giratoria con Pin index



324.15.01

Injectors Repair Bracket
Soporte para reparacion
de Inyectores



324.15.04

Clamp Set For Denso Injector
Clip Del Inyector Denso



324.13.322

Tool To Release Denso
Injector Valve
Herramienta Soltar Valvula Inyector
Denso

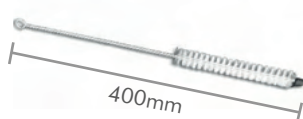

323.02.121

Cleaning Brush
Cepillo de Limpeza
Ø 12.00mm



323.50.20

Tool Set - Denso Injector Filter
Juego Herramienta Filtro Inyector Denso



323.50.083

Common Rail Denso G1 / G2
/ G3 - Siemens/Continenta
Injectors Tool Kit
Kit de Herramientas Inyectores Denso
G1 / G2 / G3 - Siemens/Continental



B03.03.P140

Injector Number	A2C59517051	Engine	Puma 2.2 e 3.2 16V - Euro 5
Application	Ford Ranger / Transit 2.2/3.2 - Euro 5		2012 - 2017

B05.03.L020

Injector Number	095000-544	Engine	1 KD-FTV
	095000-592		
	095000-822		
	095000-829		
	095000-778		
	095000-754		
Application	Hilux Land Cruiser 3.0		2005 - 2010

B05.03.L090

Injector Number	295050-018	Engine	1KD - 3.0 / 2KD - 2.5
	295050-052		
	295050-020		
	295050-046		
Application	Hilux 3.0 / Land Cruiser / Vigo 3.0 VNT - Euro 4		2010 - 2012

B05.03.0576

Injector Number	095000-576	Engine	4M41 - 3.2
	095000-811		
Application	Pajero Sport / Dakar / Full / Montero		2012-2016

B05.03.0560

Injector Number	095000-560	Engine	4D56 - 2.5
Application	L200 Triton		2008 - 2018

B05.03.0580

Injector Number	095000-580	Engine	Puma 2.4 16V
Application	Ford transit / Land Rover Defender - Euro 3		2007 - 2011
	Citroën Jumper		2007 - 2011

B05.03.0625

Injector Number	095000-625	Engine	YD 2.5 DDTI - 16V DOHC
Application	Nissan Frontier / Navara / Pathfinder YD 25		2005 - 2013

B05.03.0648

Injector Number	095000-648	Engine	JD 6090
Application	John Deere 8530 S450 2005_11 / Tractor		2006 - 2009



SIEMENS VDO | CONTINENTAL INJECTORS
 INYECTORES SIEMENS VDO | CONTINENTAL

Ford Ranger

INJECTOR
SW 5006
77550

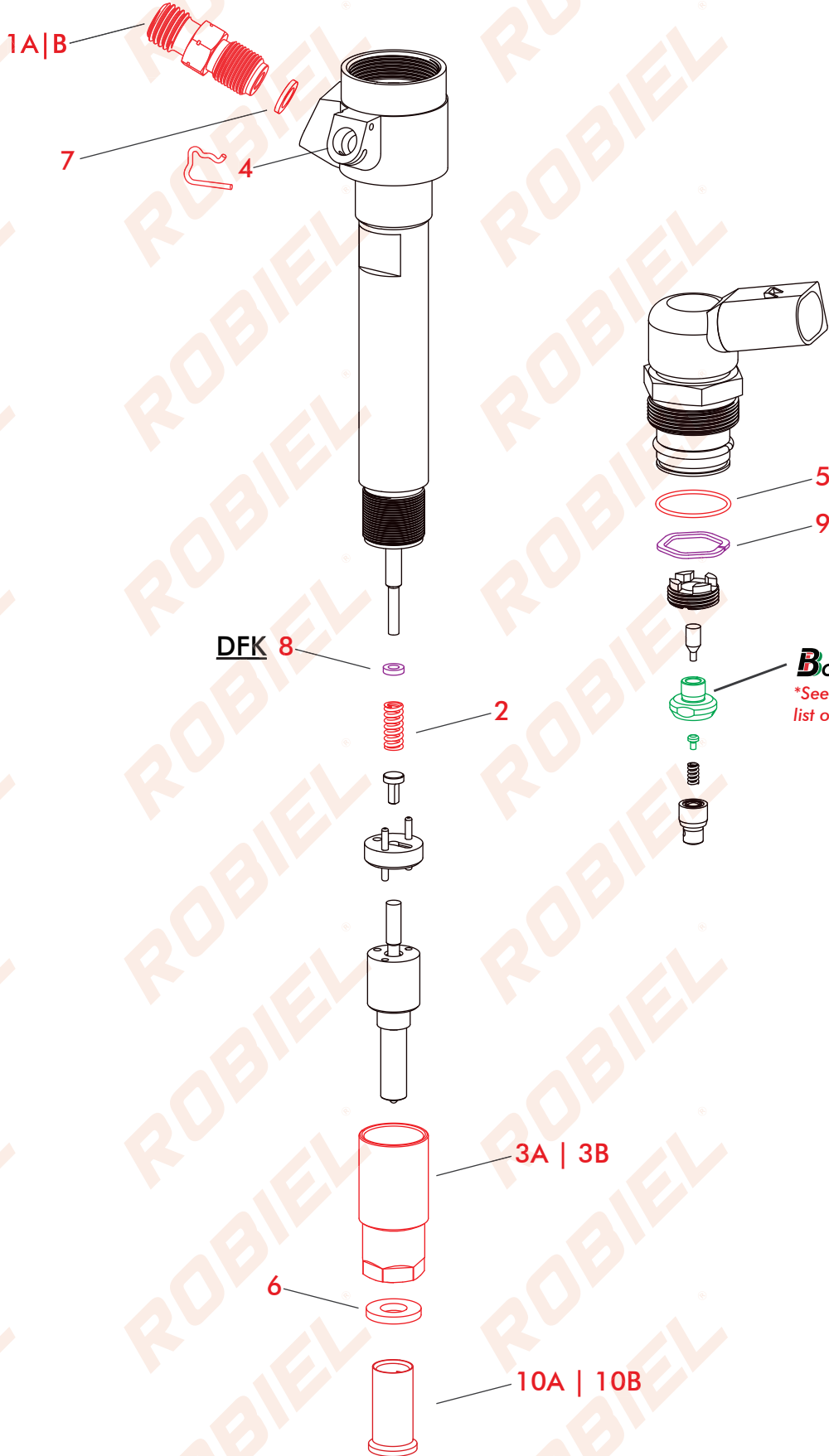

SPARE PARTS Repuestos

Nº	ROBIEL CODE	REFERENCE	DESCRIPTION	PACK
1A	165.02.06	F 00V C16 017	Connection - Pressure - Common Rail <i>Conexion de Pressão del Inyector Common Rail</i>	01un
1B	165.02.061	-	Connection w/ Filter - Pressure - Common Rail <i>Conexion c/ Filtro de Pressão del Inyector Common Rail</i> M12X 1.50mm M12 X 1.00mm	01un
2	225.01.41	-	Spring - Siemens Injector Nozzle Shim <i>Resorte del Calzo de la Tobera inyector Siemens</i>	06un
3A	315.06.55	-	Nut - Nozzle-Retaining Siemens <i>Tapa de la Tobera Del Inyector Siemens</i>	04un
3B	315.06.61	BK2Q9K546AG A2C59517051 5WS40745	Nut - Nozzle-Retaining Ford Ranger / Transit / Troller - 2.2 3.2 <i>Tapa de la Tobera Ford Ranger / Transit / Troller - 2.2 3.2</i>	04un
4	335.03.00	-	Lock - Siemens Injectors Return <i>Bloqueo Del Retorno Inyector Siemens</i>	04un
5	421.01.851	-	O-ring - Siemens Injector - Solenoide <i>Anillo Solenoide Inyector Siemens</i>	12un
6	607.15.20	-	Washer - Ford Ranger Siemens Nozzle <i>Arandela de la Tobera Siemens Ford Ranger</i>	01kit
7	805.09.05	F 00V C17 003 F 00R 0P0 004	Shim - 0.60mm <i>Calzo - 0.60mm</i>	12un
10A	220.03.08	F 00R J02 537 F 00R J03 561 6.000.900.262	Protective Cap - Injectors / Units Nozzle - 7.00mm <i>Tapa Protectora p/ Tobera Inyectores / Unidades - 7.00mm</i>	01kit
10B	220.03.09	F 00H 410 849 F 002 C88 080 6.000.900.076	Protective Cap - Injectors / Units Nozzle - 9.00mm <i>Tapa Protectora p/ Tobera Inyectores / Unidades - 9.00mm</i>	01kit



8	SHIM - ADJUSTMENT - FORD RANGER NOZZLE (DFK) CALZO DE AJUSTE TOBERA FORD RANGER		
	Ø Int.: 3.00 Ø Ext.: 5.70		

ROBIEL CODE	REFERENCE	THICKNESS(mm)
803.02.130	-	1.30
803.02.135	-	1.35
803.02.140	-	1.40
803.02.145	-	1.45
803.02.150	-	1.50
803.02.155	-	1.55
803.02.160	-	1.60

06 UNITS

9	SHIM - ADJUSTMENT - PIEZO SIEMENS CALZO DE AJUSTE PIEZO SIEMENS		
	Ø Int.: 16.00 Ø Ext.: 18.00		

ROBIEL CODE	REFERENCE	THICKNESS(mm)
814.18.090	-	0.90
814.18.091	-	0.91
814.18.092	-	0.92
814.18.093	-	0.93
814.18.094	-	0.94
814.18.095	-	0.95
814.18.096	-	0.96
814.18.097	-	0.97
814.18.098	-	0.98
814.18.099	-	0.99
814.18.100	-	1.00

06 UNITS

415.00.031

SHIM SET - DENSO/SIEMENS REPAIRING
JUEGO CALZOS REPARACION DENSO / SIEMENS

Nº	ROBIEL CODE	DESCRIPTION	THICKNESS(mm)	UNITS BY MEASURE
AH	821.24.150 - 821.24.170		1.50 to 1.70	12 units
MFK	801.04.12 - 801.04.15	Shim - Pre Injection - <i>Calzo Pre Inyeccion</i>	1.20 to 1.50	12 units
DFK	800.00.290 - 800.00.310	Shim - Denso G2 - <i>Calzo Denso G2</i>	2.90 to 3.10	12 units
DFK	803.02.130 - 803.02.160	Shim - Adjustment - Nozzle - <i>Calzo Del Ajuste Tobera</i>	1.30 to 1.60	12 units
-	814.18.090 - 814.18.100	Shim - Adjustment Siemens - <i>Calzo Del Ajuste Siemens</i>	0.90 to 1.00	12 units

612 UNITS

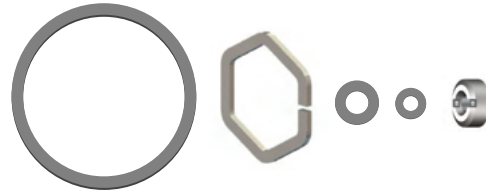

323.01.324

Rotating Vise W /
Indexer Pin
Morsa Giratoria con Pin index



324.15.01

Injectors Repair Bracket
*Soporte para reparacion
de Inyectores*

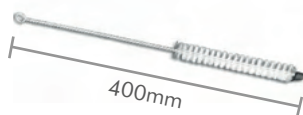

323.02.121

Cleaning Brush
Cepillo de Limpieza
Ø 12.00mm



323.50.083

Common Rail Denso G1 / G2
/ G3 - Siemens/Continenta
Injectors Tool Kit
*Kit de Herramientas Inyectores Denso
G1 / G2 / G3 - Siemens/Continental*

