

PEMBROOKE COMPOSITE CHART

PHASE	LOTS	ACREAGE
I	150	+/-67.20
II	67	+/-25.26
III	59	+/-35.39
IV	48	+/-35.06
V	18	+/-17.00
TOTAL	342	+/- 179.91

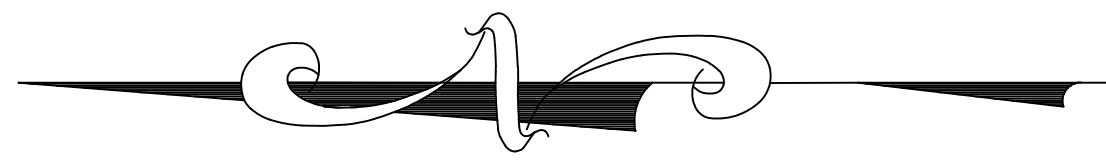

08-XXXXXX

= SDAT PROPERTY ACCOUNT NUMBER

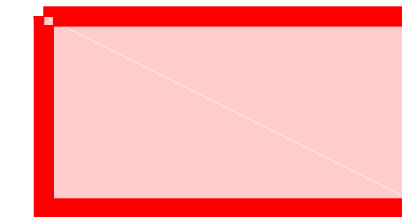

= PARCEL OWNED BY PEMBROOKE HOA

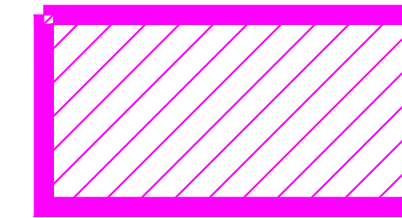

= PARCEL OWNED BY PEMBROOKE, LLC

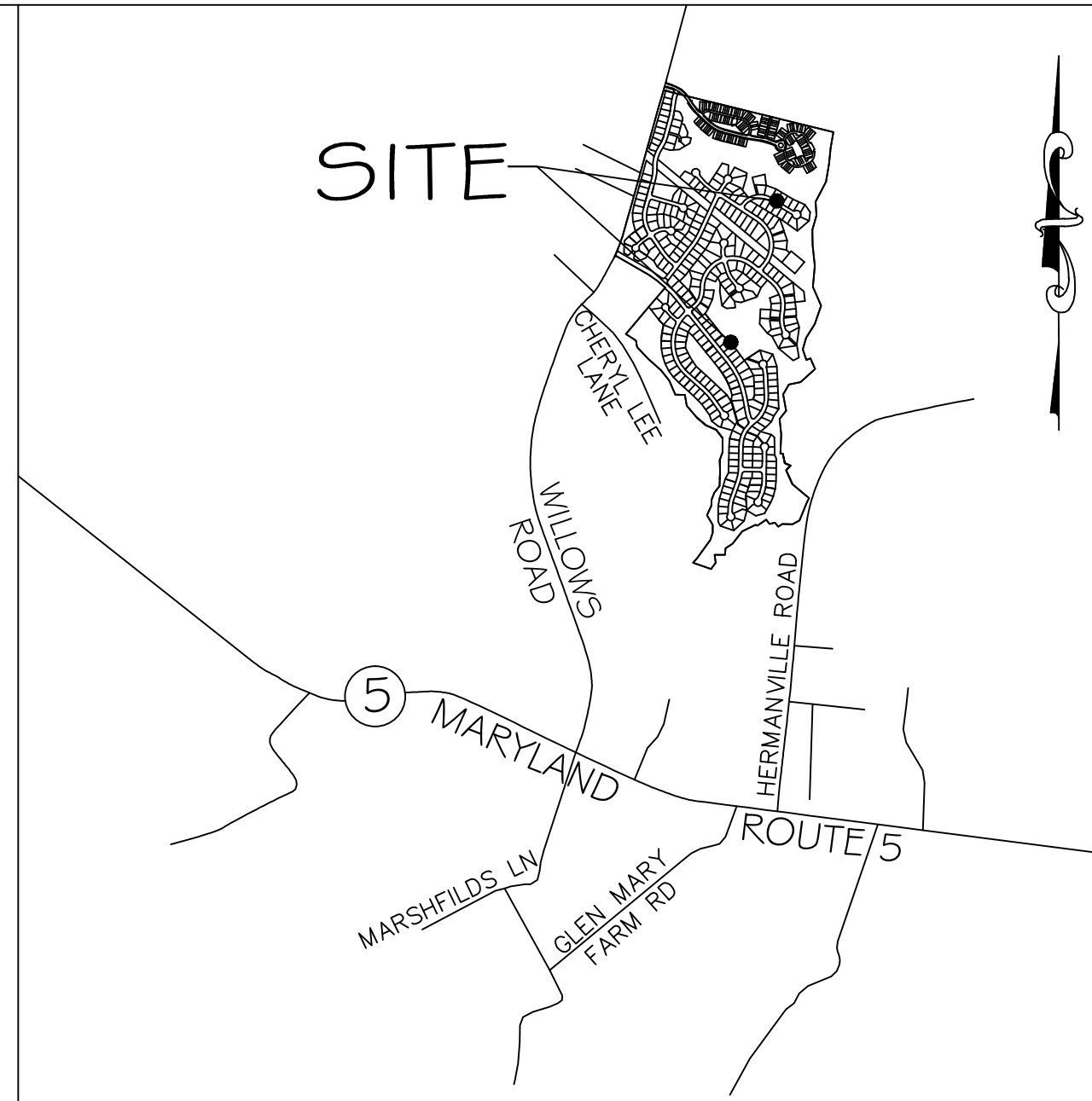

VICINITY MAP

SCALE: 1"=2000'

Tax Map 51, Gnds 11, 16 & 17, Parcels 618, 387 & 390

FUTURE
PHASE VI
28.01 AC.

PHASE IV

PHASE I

PHASE II

PHASE III

SCALE 1"=200'

- Parcel K along Willows Rd
- Area marked in front of Parcel F on Colby Dr
- Outlot D along Colby Dr
- Open space Parcel D 08-170932 off Pembroke St
- Area in front of Lots 4 and 5 (Tot Lot and mailboxes) and 08-171238 between lots 22 and 23 on Pembroke St
- Area along Middlegate in Outlot C 08-17118 and 08-171513 and 08-171726 surrounding the mailboxes and in front of the stormwater ponds
- All areas marked "stormwater management easements" and Open Space Parcel A 08-178613 off Jillian Grace are included in the Stormwater maintenance portion.

OWNER/DEVELOPER
PEMBROOKE, LLC
29971 BUSINESS CENTER DRIVE
CHARLOTTE HALL, MD 20622
(301) 884-9454
C/O JOHN PARLETT

PEMBROOKE	
8TH ELECTION DISTRICT - ST. MARY'S COUNTY, MARYLAND	
HOA OWNED PARCELS	SCALE AS SHOWN
DRAWN CHECKED	CONTRACT REFERENCE
6/22/2017	
1 OF 1	