

Seismic Sway Brace Pipe Attachment

- Material : Carbon Steel - Zinc Plated
- Application : Designed for bracing pipe against sway and seismic disturbance. The pipe attachment component of a sway brace system used in conjunction with structural attachment fitting, and joined together with a bracing pipe element forms a complete sway brace assembly.
- Installation: Place over the pipe to be braced, adjust brace angle, and insert bracing pipe through opening leaving a minimum of 1" extending from attachment. Brace pipe can be installed on top or bottom of pipe to be braced but must be a minimum of 6" away from a pipe joint. Tighten nuts down evenly until hexheads break off.

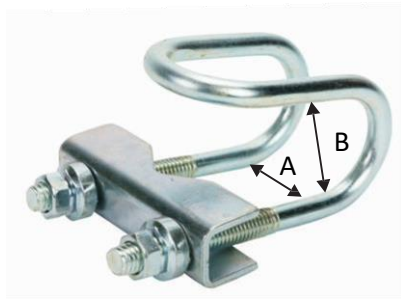

Cat.No.	Pipe Size (B)		Brace Pipe Size (A)	
	inch	DN	inch	mm
SBPA-1250	2-1/2"	65	1"	25
SBPA-1400	4"	100	1"	25
SBPA-1600	6"	150	1"	25

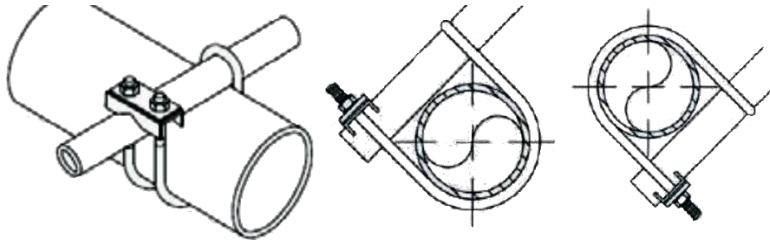

Longitudinal In Line Clamping Pipe Attachment

- Material : Carbon Steel - Zinc Plated
- Application : Designed for bracing pipe against sway and seismic disturbance. Versatile design allows for attachment at any angle and the ability to be used in a lateral or longitudinal bracing configuration
- Installation: Place attachment around pipe to be braced, positioning brace attachment as needed, then tighten clamping bolts and nuts finger tight. Insert brace component into fitting against back of jaw. Tighten set screw finger tight, adjust brace angle as needed, then tighten set screw until hex head breaks off. Then evenly torque clamping bolts until hex portion of clamping nuts break off.

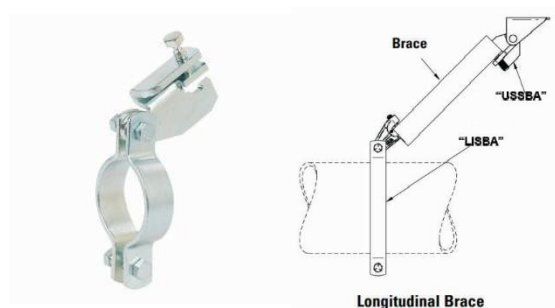

Cat.No.	Pipe Size (B)		Structural Size (max)	
	inch	DN	inch	mm
LISBA-250	2-1/2"	65	3/4	19
LISBA-400	4"	100	3/4	19
LISBA-600	6"	150	3/4	19



Universal Swivel Sway Brace Attachment

- Material : Carbon Steel - Zinc Plated
- Application : Designed for bracing pipe against sway and seismic disturbances. Universal swivel design allows for attachment at any surface angle combined with concentric loading
- Installation: Mount device to structure then insert brace element into fitting against back of jaw. Tighten set screw finger tight, then tighten until hex head breaks off. Adjust attachment to proper brace angle

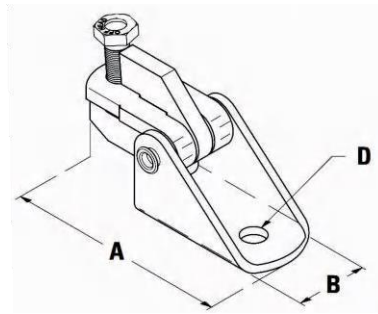

Cat.No.	A		B		D	
	inch	mm	inch	mm	inch	mm
USSBA-050	5-1/4	133	1-7/8	47.6	1/2	14

