

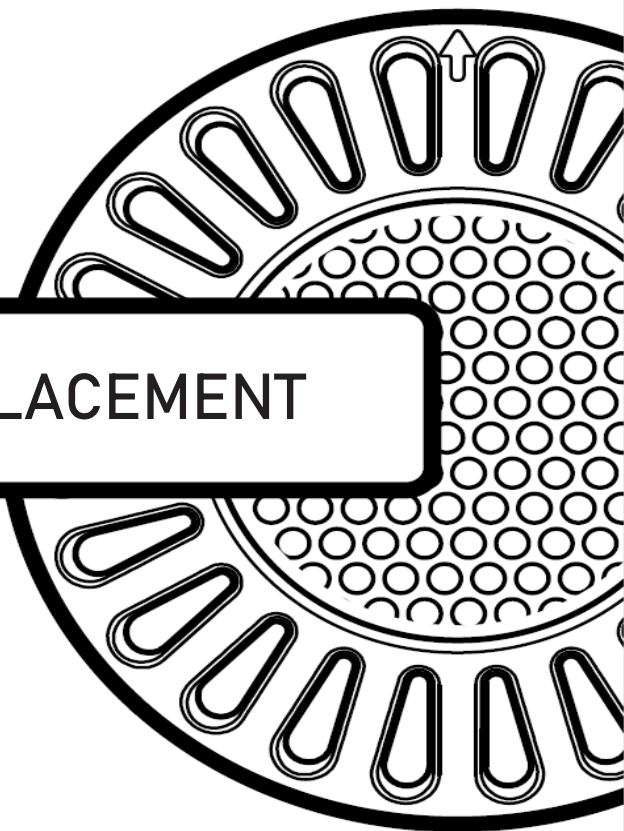

atom

BULB REPLACEMENT



1. Push and hold red button with flat head screwdriver.

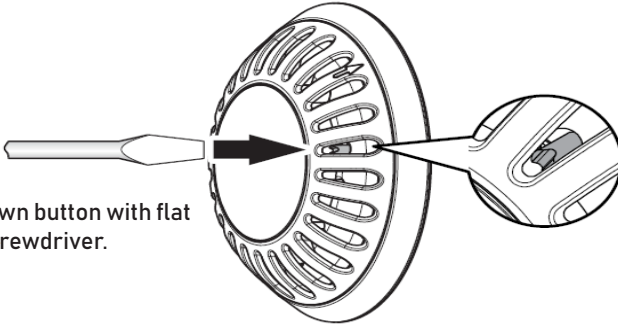

Hold down button with flat head screwdriver.

2. While continuing to hold button, rotate counter-clockwise & remove bulb from locking ring.

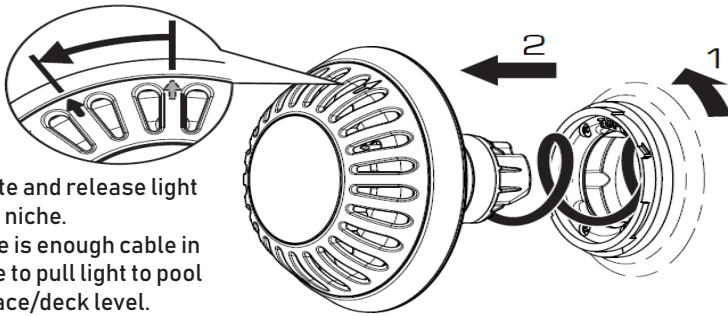

Rotate and release light from niche.
There is enough cable in niche to pull light to pool surface/deck level.

3. Remove plug from light.

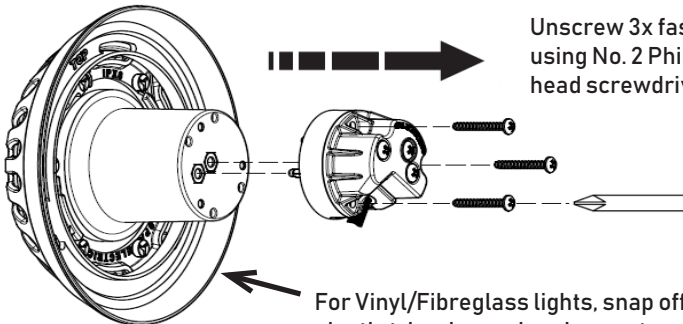

Unscrew 3x fasteners using No. 2 Phillips head screwdriver.

For Vinyl/Fibreglass lights, snap off clear plastic trim ring and replace onto new bulb.

4. Attach new bulb.

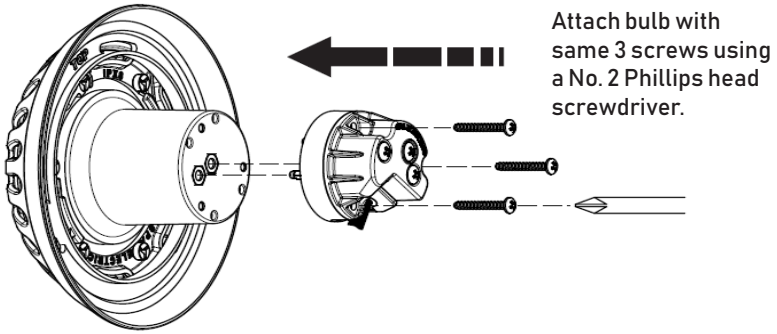

5. Insert bulb back into locking ring and rotate clockwise until bulb clicks/locks into place.

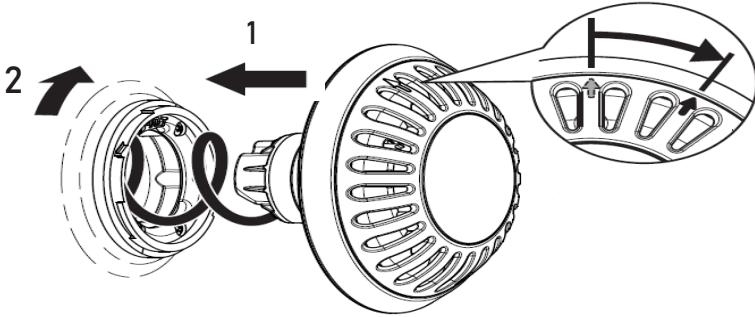

WINTERIZING: Follow steps 1 - 3 and install enclosed red winterizing cap to replace bulb. Store bulb indoors to optimize product longevity.

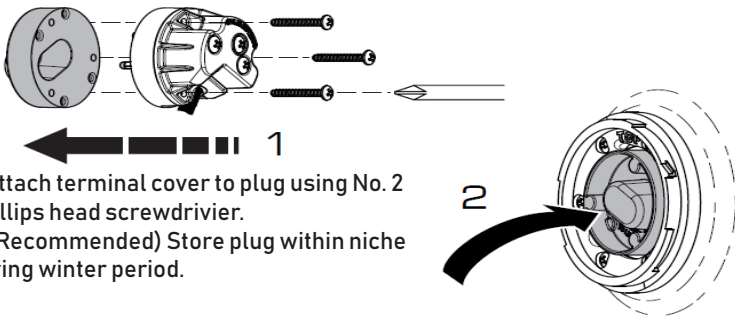

1. Attach terminal cover to plug using No. 2 Phillips head screwdriver.
2. (Recommended) Store plug within niche during winter period.

For syncing light with automation please see our Multi Plus Set Up guide enclosed or visit saelectrics.ca for tutorials.



Proudly manufactured by

Spa Electrics



www.spaelectrics.ca