

C&O Motorcar Shed, Bld 29 Hinton Yard, West Virginia



The motorcar shed was inspired by a conversation with a C&O modeler about his need to round out the support structures of his Hinton yard layout. Once our research was moving along, we discovered just how interesting this area of the C&O railroad was. The generic nature of this building allows it to be used in many rail yard applications. Use your imagination to see what you can come up with for your railroad!

Tools & Supplies needed

- Hobby knife, with an #11 Xacto Blade
- Fine Files
- Square
- 1-2-3 blocks (optional)
- PVA glue or wood glue
- Cyanoacrylate glue (CA)
- Paints
- Tweezers
- Patience
- Fun

Pre-assembly

1. Inspect all sheets of laser cut materials against the diagrams provided in the instructions checking for any missing pieces or damaged parts.
2. Before starting your model, read through the instructions completely to become familiar with the parts and assembly.
3. One of the most important steps in the kit build is to properly brace the wall sections. This needs to be done before any painting or weathering of the model. Use the 1/8x1/8" strip wood for the bracing material. Reference the picture right for proper locations. It is critical that you space the strip wood 1/16" from the bottom edge of all of the walls. This space will allow the foundation piece to fit inside, as seen in step 21. Cut wood to fit and glue with your choice of adhesive (We prefer to use a good quality wood glue such as, Tite-Bond II). Place weights on top of assemblies. Let glue dry thoroughly before moving on, preferably overnight.
4. At this time the walls can be painted and weathered using your choice of paint and stains. Apply spray primer on both sides of the walls. Follow that up with the main color of your choice for your walls. Also, paint your corner trim a different color in order to provide contrast. While you have the paint and brushes out, paint the windows and doors with the same trim color if desired.

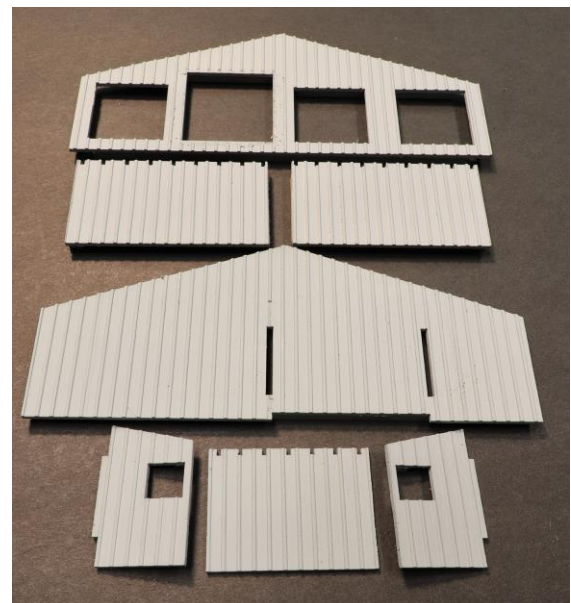
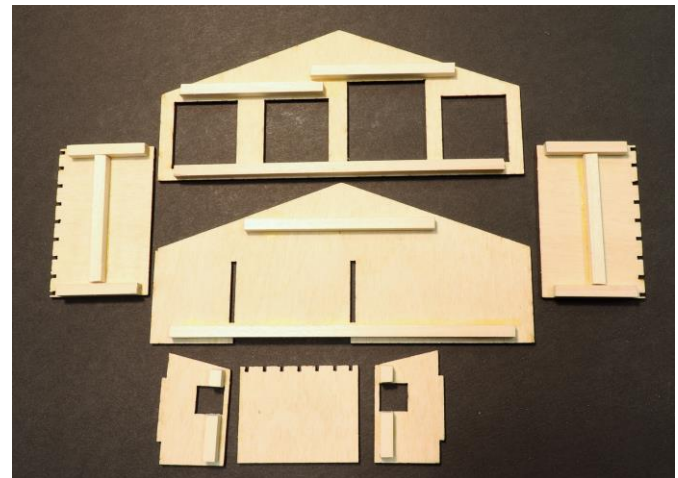

Since this is a representation of a C&O motorcar shed, we chose to paint it the colors used by the C&O for their Maintenance Of Way (MOW) support structures.

Main walls – light gray

Trim and window frames – white

Doors and window mullions – dark gray

Mine Mount Models

5. After the paint dries on the windows and doors (This is where we like to use an old hair dryer to speed up the process), cut out the window glazing using the provided clear material in the kit. Then glue the glazing onto the back of the window panes. (We prefer to use a gel CA glue, or Aleene's Tacky Glue.)

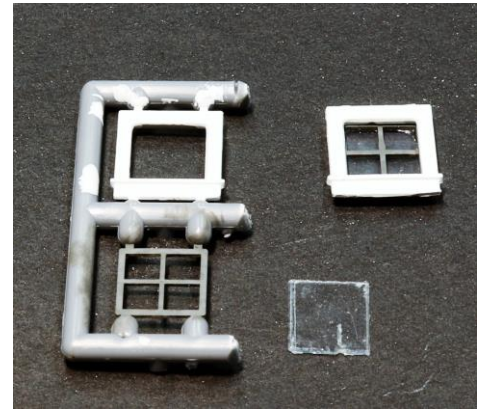

6. **Trim around door openings** – Using the 1/32”x1/16” wood strips, frame out around the 4 door openings. Use the picture and provided drawing as a reference for placement.

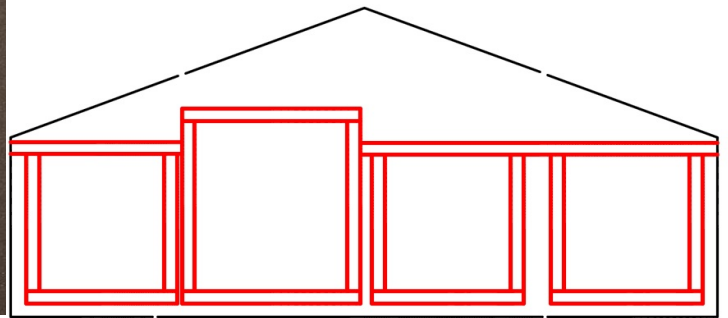

7. The motorcar shed has 4 doors that are different sizes. Be sure to keep them in the order they are on the laser board sheet. Paint them your desired color. Once dry, glue them onto the appropriate opening, right on top of the trim. If you want to be adventurous, you can cut the doors in half and model them in the open position. That way you can detail the interior.

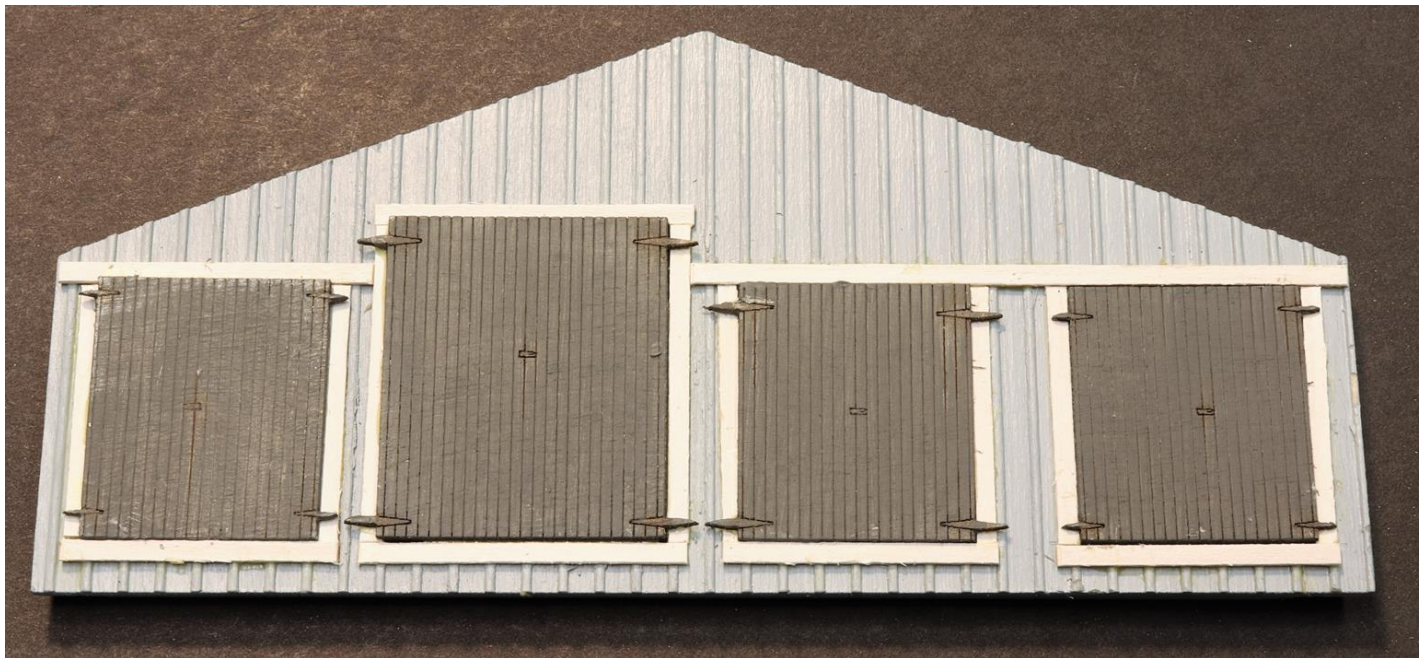

Mine Mount Models

Wall Assembly

8. To properly assemble the walls square, we highly recommend using mini squares and 1-2-3 blocks. Use the 1/16" wood strips provided in the kit to cut out the corner trim of the walls. Use the two long walls to measure the length of wood you need, attach the four pieces of trim to the two long walls (parts #1, 2). Do this by laying a wall with the clapboard pattern facing down. Apply glue to the trim pieces sparingly, and place on edge of walls. You can hold these in place with the 1-2-3 blocks or other types of sturdy bracing.

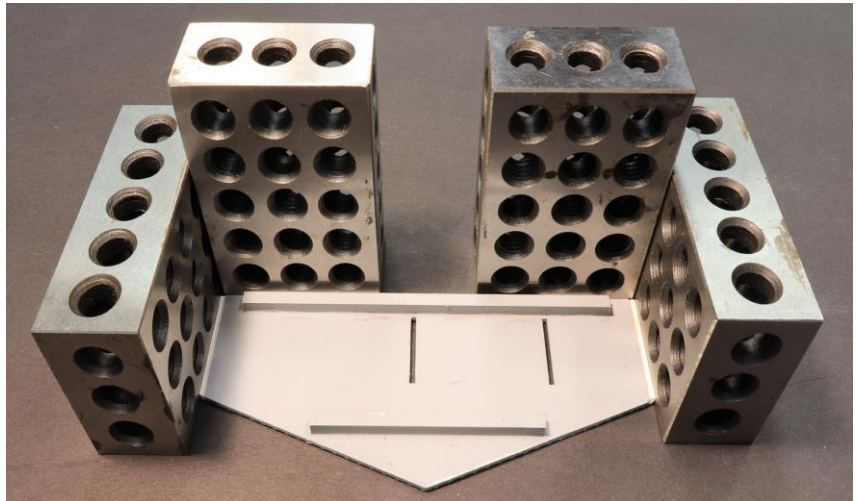

9. An important part in ensuring that the walls turn out square is to use two 1-2-3 blocks while gluing up the end gable wall (part #4). Be sure before gluing on the side wall, that your clapboard is facing the right way (see photo). You do not want to have the clapboard facing upside down. Having the 1-2-3 blocks against the long wall, glue the short gable walls to the 1/16" corner trim. This will create a 90-degree angle, ensuring your building will be square.

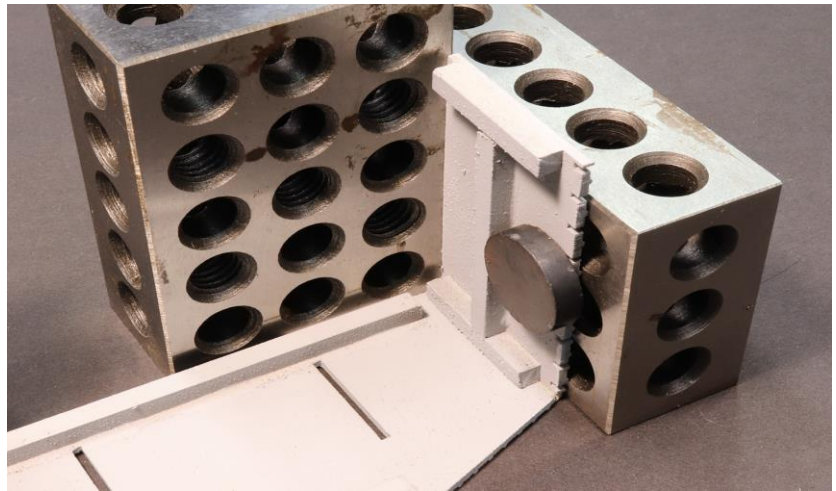

10. After the 3 walls are dry, the remaining front wall (part #3) can be glued to the opposite ends of the short walls. Again, use the square and blocks to keep everything aligned.

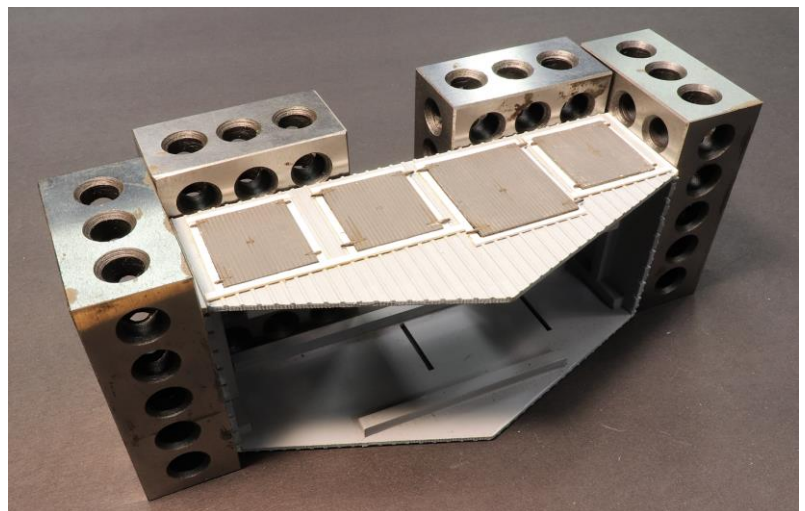

Mine Mount Models

11. You should have 3 small wall sections left (#5, 6, 7). These are for the shed bump out on the back of the building. You start by gluing on the 2 side walls (parts #5&6). Then add the back-shed wall (part #7) using the same techniques as the main building walls to keep them square.

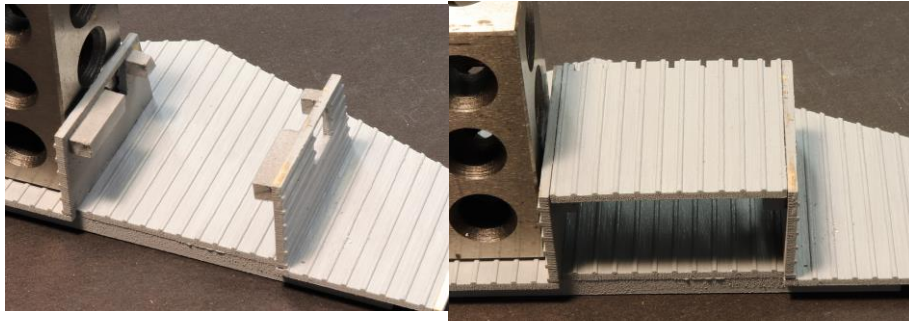

12. Take the 2 small windows and glue them into the openings of the back-shed walls.



Roof

13. Prior to gluing on the roof sheet, you need to add the rafter tails (parts #8) on both sides of the main building and (part #9) on the back-shed roof. We painted the rafters a dark gray before attaching to walls.

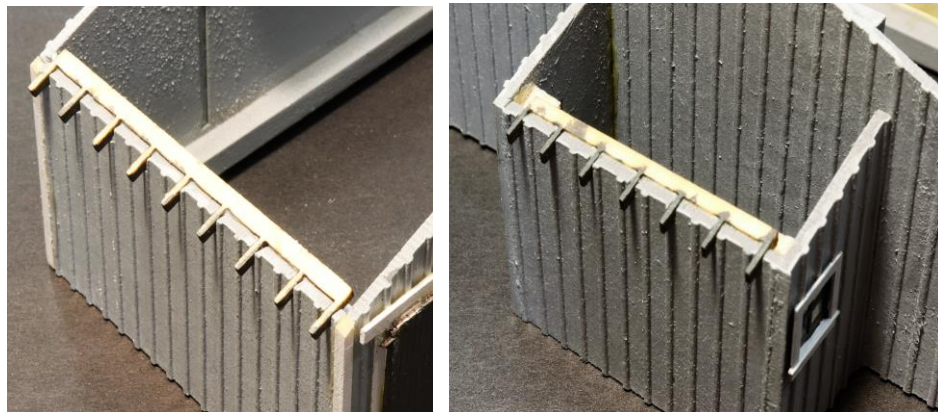

14. Once all the walls have been glued up square, and dried properly, it is time to move on to the roof material. Apply glue to the top edge of the main building walls and attach the large roof (part #10). We painted the roof a dark gray color just in case any of it would show through the edge of the rolled roofing material.



Mine Mount Models

15. Paint the rolled roofing stickers a dark gray color. We prefer multiple browns and grimy black washes. This has a self-adhesive backing and can be applied directly to the roof surface. Be sure to overlap slightly as you work your way up the roof. The nail holes should be on the lower side of the roof so that they are visible.



16. Apply the adhesive roofing by starting at the bottom edge on one side of the roof. Overlap each successive row by about 1/32". Work your way up to the peak of the roof. Repeat this process on the other side of the roof.

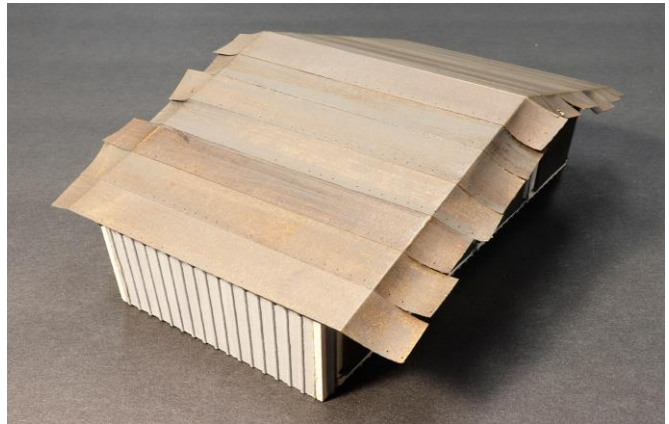

17. Once both sides are covered with the rolled roofing, it needs a cap strip on the peak. This is made by cutting a 1/4" wide strip from one of the roofing sticker sheets. Peel off the sticker and apply it to the top ridge.

18. When you are happy with the outcome of the roofing, you need to trim back the excess. Now is the time to treat your Exacto to a new blade. This will give you a nice clean-cut line along the roof edge.

19. Repeat the roofing steps to cover the back-shed roof as well.



20. Trim & Finishing Touches

21. The trim pieces along the bottom of the structure are completely optional. In our research we noticed that some of the C&O support buildings had trim, while others didn't. Prime and paint all the trim pieces (parts noted on parts list sheet). Let dry. (Hint: Hair Dryer again) Glue along the bottom edge of every wall. Some of these may need to be trimmed to length to fit properly.

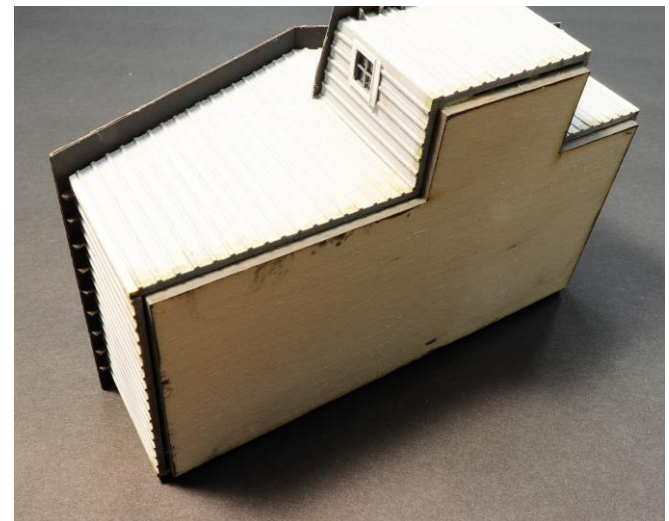

Mine Mount Models

22. Test fit the foundation (part #12) on the bottom of the structure. Remove the base and paint the edges a concrete color. Apply glue to the 1/8" basswood that you used to stiffen the walls in step 3. Attach the foundation into the bottom.
23. Signs for above the doors are provided on the parts list sheet. They read "GASOLINE Keep Fire and Lights Away" in red with white lettering, and "NO ACCIDENTS THIS YEAR" in black with white lettering. They can be cut out and hung directly on the door frame and siding. Or they can be glued to a thin piece of wood or styrene to create a plaque style of mounting.
24. We lightly weathered the shed to give it a well-used look. Adding rust streaks down from the hinges, dirtying up the bottom of the walls to simulate rain/mud splashing up, and a general overall dusting with weathering powders. This tones down the coloring and gives a homogeneous look to the structure.



At this point, your C&O Motorcar Shed is complete. It is ready to be placed in the yard scene of your layout, or part of a fantastic diorama. But don't let this stop you from adding more details, like crates, motorcars, tracks leading into the building, and scenery.



We want to thank you for choosing Mine Mount Models as your provider for finely detailed craftsman model kits for your hobby obsession.