



QUICK RELEASE FIRE EXTINGUISHER MOUNT

INSTALLATION GUIDE

ASSEMBLY CONTENTS :

1. REAR HINGE BLOCK (PRE ASSEMBLED)
2. MAIN MOUNT BLOCK (PRE ASSEMBLED)
3. TANK BLOCK
4. THUMB SCREW
5. DOWEL PIN (PRE ASSEMBLED)
6. QUICK RELEASE PIN
7. CLAMP ASSEMBLY
8. BAR ADAPTER/PROTECTIVE COVER

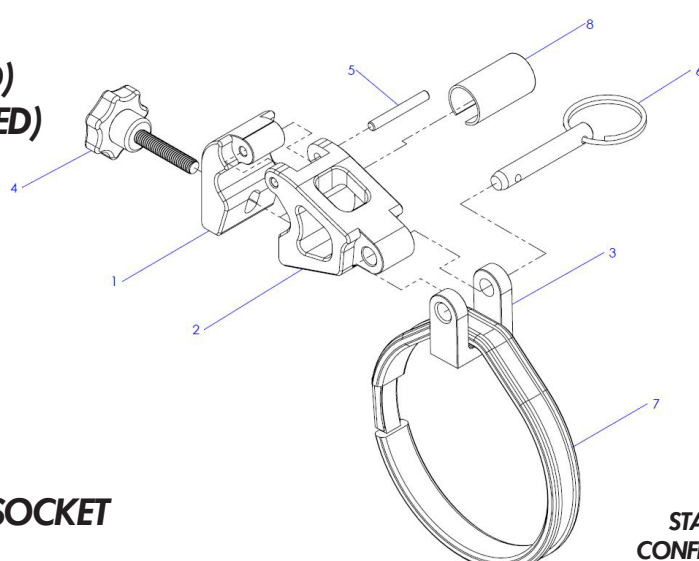
STANDARD
CONFIGURATION

TOOLS REQUIRED:

1. STRAIGHT SCREWDRIVER OR 5/16" SOCKET
2. SCISSORS OR CUTTING DEVICE

STEP 1:

-DEPENDING ON FIRE EXTINGUISHER TANK DIAMETER, PROTECTIVE CLAMP COVER MAY NEED TO BE TRIMMED FOR BETTER FIT. USE SCISSORS OR CUTTING DEVICE AND ADJUST AS NEEDED. CLAMP SIZE WILL FIT MOST 2.5LB -5LB TANK DIAMETERS.

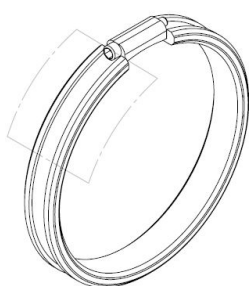

-ONCE CLAMP COVER HAS BEEN TRIMMED, ATTACH TANK BLOCK AND TIGHTEN DOWN TO CENTER OF TANK USING A STRAIGHT SCREWDRIVER OR 5/16" SOCKET (NOT INCLUDED).

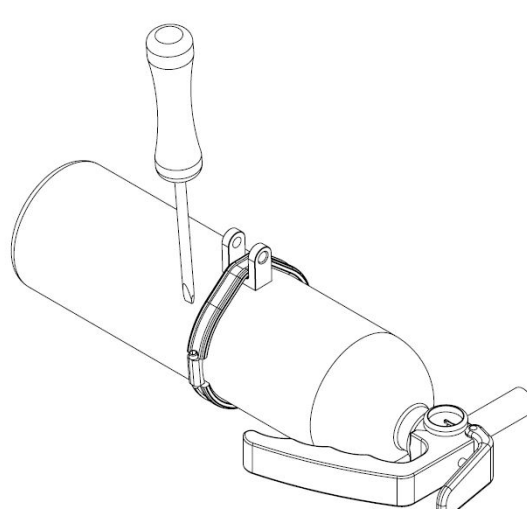
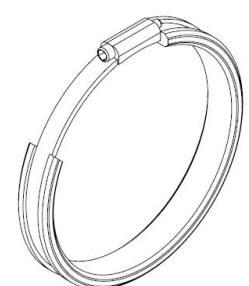

-FURTHER ADJUSTMENT MAY BE NEEDED WHEN INSTALLING INTO VEHICLE.

STEP 2:

-INSTALL THE PROTECTIVE BAR COVER / SIZING ADAPTER TO THE CAR'S SEAT ADJUSTMENT BAR, NEAR THE CENTER.

-WE RECOMMEND USING THE PROTECTIVE COVER IN ALL CASES, AND THE SIZING ADAPTER FOR THINNER DIAMETER ADJUSTMENT BARS. FOR VERY THIN ADJUSTMENT BARS, BOTH COVERS CAN BE USED.

STANDARD
PROTECTIVE COVER

SIZING ADAPTER

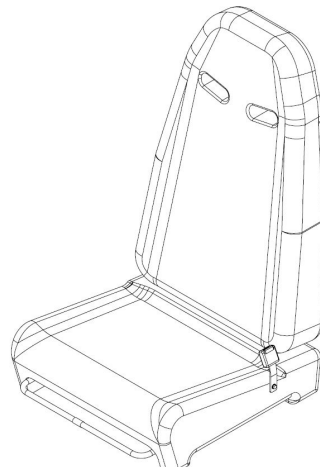

STEP 3:

-POSITION THE MOUNT ASSEMBLY OVER THE PROTECTIVE COVER/SIZING ADAPTER.

-ROTATE THE MOUNT ASSEMBLY FORWARD TO HELP WITH INSERTING THE THUMB SCREW. TIGHTEN GENTLY.

-ROTATE THE MOUNT ASSEMBLY BACK TO THE STANDARD CONFIGURATION.

-FURTHER ADJUSTMENT MAY BE NEEDED WHEN TANK ASSEMBLY IS INSTALLED.

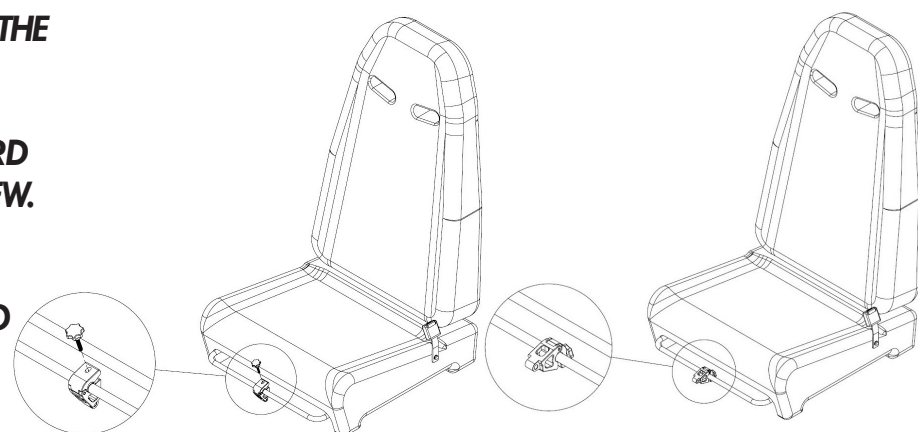

STEP 4:

-ALIGN TANK ASSEMBLY INTO MOUNT ASSEMBLY. INSERT PULL PIN TO SECURE BOTH ASSEMBLIES. IT IS RECOMMENDED TO HAVE PULL RING ON PIN FACING TOWARDS THE USER.

-ADJUST ASSEMBLIES SO THAT TANK IS SITTING ON VEHICLE FLOOR AND TIGHTEN DOWN THUMB SCREW.

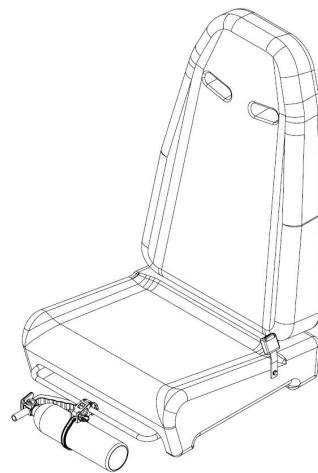

STEP 5:

-IN CASE OF EMERGENCY, PULL PIN TO RELEASE FIRE EXTINGUISHER.

-IT IS IMPORTANT TO PULL PIN IN HORIZONTAL MANNER TO RELEASE TANK WITH EASE.



MOUNTING CONFIGURATIONS:

-DEPENDING ON THE VEHICLE AND USER, THE MOUNT ASSEMBLY CAN BE POSITIONED IN A VARIETY OF WAYS.

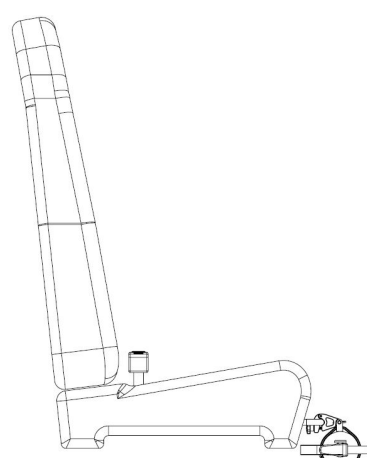
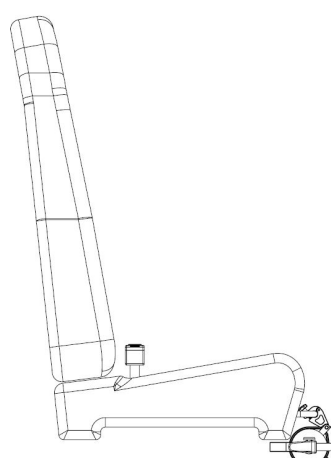
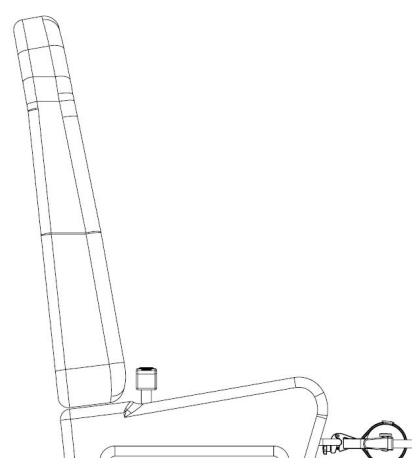
STANDARD
CONFIGURATIONEXTENDED DOWN
CONFIGURATIONFRONT EXTENDED
CONFIGURATION

- IMPORTANT -

- TANK ASSEMBLY MUST REST ON VEHICLE FLOOR. DO NOT LEAVE TANK ASSEMBLY UNSUPPORTED OR ABOVE VEHICLE FLOOR. DO NOT USE THIS PRODUCT FOR ANYTHING OTHER THAN INTENDED USE.

FOR AID IN EMERGENCY SITUATIONS. MOUNT ASSEMBLY DOES NOT GUARANTEE SAFETY OF THE OPERATOR OR OTHERS PRESENT WHILE IN USE. MOUNT ASSEMBLY DOES NOT GUARANTEE A DAMAGE FREE EMERGENCY. MIDD TOWN CO. AND MIDD TOWN CUSTOMS LLC. ARE NOT LIABLE FOR ANY DAMAGES THAT OCCUR IN AN EMERGENCY SITUATION.

FOR OFFROAD USE ONLY