

TIMBERLAKE[®]

WINTER 2018 PRODUCT LIBRARY





TABLE of CONTENTS

04 PORTFOLIO SELECT® SERIES

- 10 SIERRA VISTA®
- 12 NEW HAVEN®
- 14 WINDSOR™
- 16 RUSHMORE®
- 18 TUCSON®
- 20 CAPISTRANO®
- 22 COLEBROOK™
- 24 WYOMING®

26 PORTFOLIO® SERIES

- 32 LAUSANNE®
- 34 CUMBERLAND®
- 36 KINSDALE™
- 38 CLIFTON™
- 40 SONOMA®
- 42 SCOTTSDALE®
- 44 DOWNING™
- 46 BARNETT™
- 48 TAHOE®

50 VALUE BUILT® SERIES

- 51 ANDOVER®
- 51 FAIRFIELD

DISTINCTIVE CHARACTER

- 52 DECORATIVE HARDWARE
- 56 DECORATIVE GLASS DOORS
- 58 IMAGINATIVE KITCHEN ADDITIONS
- 60 IMAGINATIVE BATH & LAUNDRY ADDITIONS
- 62 IMAGINATIVE HOME ADDITIONS
- 64 PREMIUM FINISHES
- 66 WHAT TO EXPECT
- 67 CHOOSE YOUR MATERIAL
- 69 CABINETS BUILT-TO-ORDER
- 70 AN INSIDE LOOK AT TIMBERLAKE® FEATURES

PORTFOLIO SELECT® *Series*

The Portfolio Select® series is our top tier—with the style, quality and features found in expensive custom-built cabinetry.



New Haven® PAINTED STONE



Sierra Vista® PAINTED LINEN AND PAINTED STONE



Windsor™ MAPLE TRUFFLE AND PAINTED CASHMERE



Sierra Vista® PAINTED HARBOR



Sierra Vista® COLLECTION

To reach the high point of elegance, head to Sierra Vista®. This solid wood door style with mitered cuts at each corner is reminiscent of a fine picture frame. A classic and sophisticated design, with furniture quality mortise-and-tenon construction and extra-wide three-inch frames surrounding a raised center panel.



Sierra Vista® DOOR STYLES

Sierra Vista® doors are solid wood, full overlay, and designed with a raised-panel mitered style. Matching five-piece mitered drawer front. Available in cherry, maple, and painted finishes.

MAPLE



NATURAL HONEY COFFEE GLAZE* SPICE MOCHA GLAZE* COGNAC AUBURN GLAZE* TRUFFLE ESPRESSO

PAINTED**



LINEN* SILK* HAZELNUT GLAZE* CASHMERE* HARBOR* EMBER GLAZE* STONE*

CHERRY



AUTUMN SPICE JAVA SLATE

* Denotes premium finish

** Painted doors feature engineered wood center panels for a superior finish.

The glazes on our painted finishes are hand-applied, so no two doors will look exactly alike. And while the door front and edges are completely concealed by the base, some wood grain may show on the door back.

Decorative hardware is required and must be ordered separately.



New Haven® COLLECTION

A fresh, contemporary take on Mission style. With a choice of 15 shades, the sleek and simple lines make a bold statement in many décor styles.

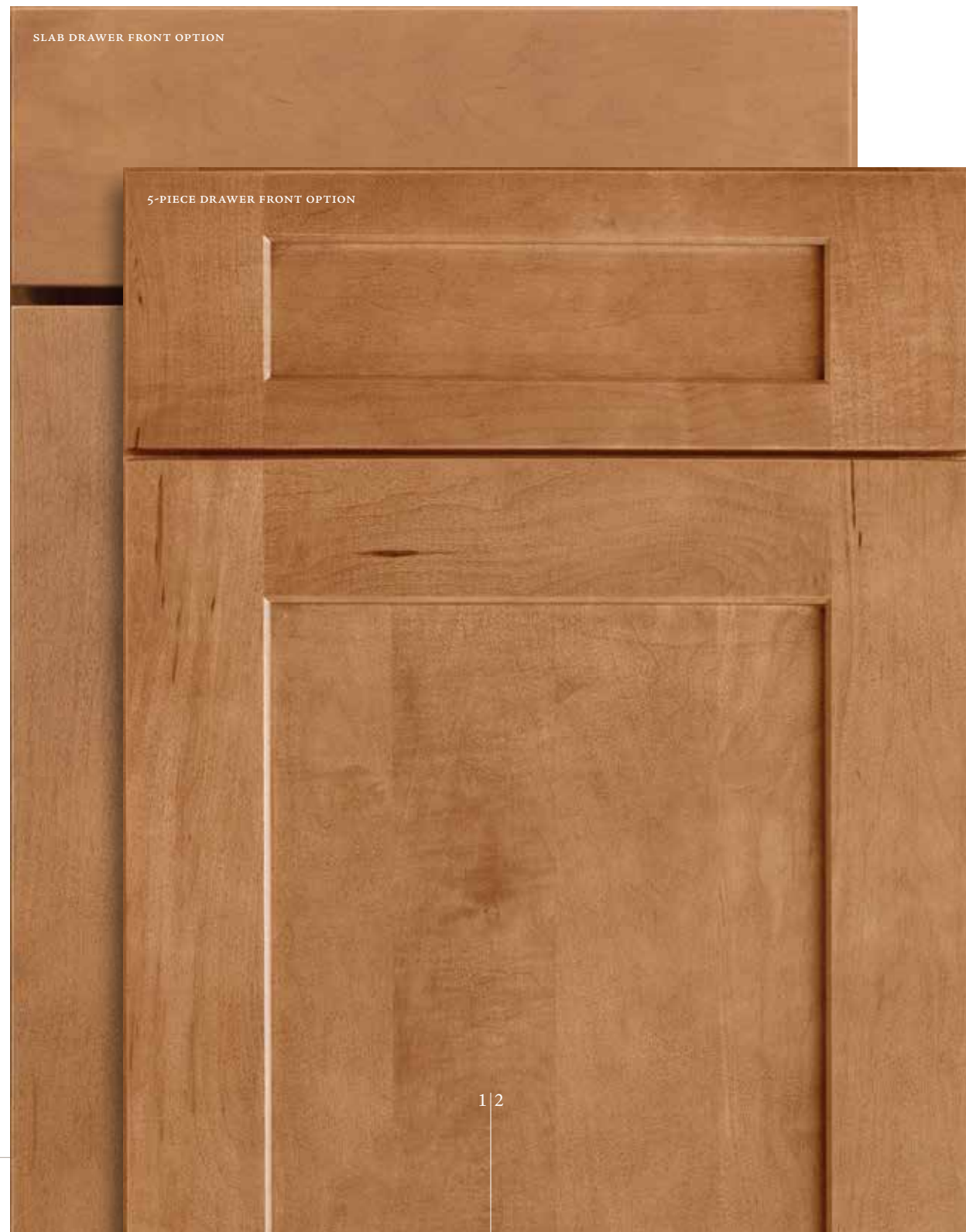

New Haven® DOOR STYLES

New Haven® doors are solid wood and full overlay in a recessed-panel style surrounded by three-inch framing on all sides. Choose either a slab or five-piece decorative drawer front. Available in cherry, maple, and painted finishes.

MAPLE



NATURAL HONEY SPICE COGNAC TRUFFLE ESPRESSO

PAINTED**



LINEN* SILK* CASHMERE* HARBOR* STONE*

CHERRY



AUTUMN SPICE JAVA SLATE

* Denotes premium finish
 ** Painted doors feature engineered wood center panels for a superior finish.

Decorative hardware is required and must be ordered separately.



Windsor™ COLLECTION

Windsor™ takes traditional styling to the next level. The solid raised center panel features an intricately pillowed profile that blends striking detail with elegant simplicity.



Windsor™ DOOR STYLES

Windsor™ doors are solid wood, full overlay, and available in either square or Roman arch. Choose between a five-piece or one-inch-thick decorative drawer front. Available in cherry, maple, oak, and painted finishes.

MAPLE Roman Arch & Square

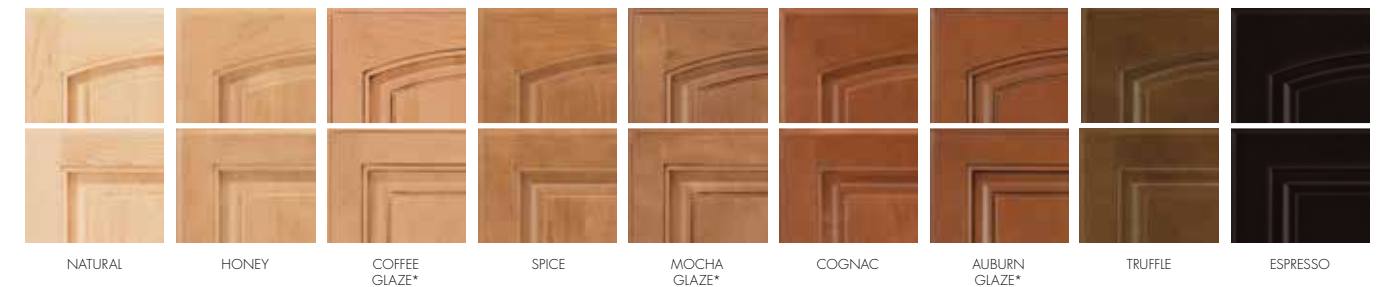

NATURAL HONEY COFFEE GLAZE* SPICE MOCHA GLAZE* COGNAC ALBURN GLAZE* TRUFFLE ESPRESSO

PAINTED** Roman Arch & Square



LINEN* SILK* HAZELNUT GLAZE* CASHMERE* HARBOR* EMBER GLAZE* STONE*

CHERRY Roman Arch & Square



AUTUMN SPICE JAVA SLATE HONEY TAWNY

OAK Roman Arch & Square



* Denotes premium finish
 ** Painted doors feature engineered wood center panels for a superior finish.

The glazes on our painted finishes are hand-applied, so no two doors will look exactly alike. And while the door front and edges are completely concealed by the base, some wood grain may show on the door back.

Decorative hardware is required and must be ordered separately.



Rushmore® COLLECTION

Fresh and modern with a traditional feel, the Rushmore® collection is a spectacular style with a solid wood raised center panel. The streamlined design works well with a range of decorating styles for every taste.



Rushmore® DOOR STYLES

Rushmore® doors are solid wood, full overlay, and feature a deluxe one-inch-thick decorative drawer front. Available in maple and painted finishes.

MAPLE



NATURAL HONEY COFFEE GLAZE* SPICE MOCHA GLAZE* COGNAC AUBURN GLAZE* TRUFFLE ESPRESSO

PAINTED**



LINEN* SILK* HAZELNUT GLAZE* CASHMERE* HARBOR* EMBER GLAZE* STONE*

* Denotes premium finish
 ** Painted doors feature engineered wood center panels for a superior finish.

The glazes on our painted finishes are hand-applied, so no two doors will look exactly alike. And while the door front and edges are completely concealed by the base, some wood grain may show on the door back.

Decorative hardware is required and must be ordered separately.



Tucson® COLLECTION

The distinctive beadboard center panel of solid wood resembles wainscoting, making Tucson® one of a kind. Simple, angled edges on the framing add a contemporary twist, making it a versatile and appealing choice for many décors.



Tucson® DOOR STYLES

Tucson® doors are solid wood, full overlay and available in maple and painted finishes.

MAPLE

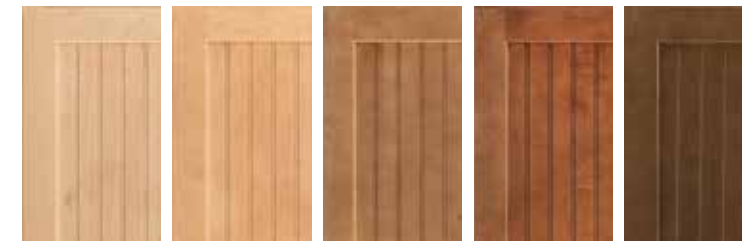

NATURAL

HONEY

SPICE

COGNAC

TRUFFLE

PAINTED



LINEN*

SILK*

CASHMERE*

HARBOR*

STONE*

* Denotes premium finish

Decorative hardware is required and must be ordered separately.



Capistrano® COLLECTION

A fresh twist on California Mission style, ideal for those in search of a simpler, cleaner line for their décor. The extra-wide framing and subtle door detailing makes this door style a real standout.

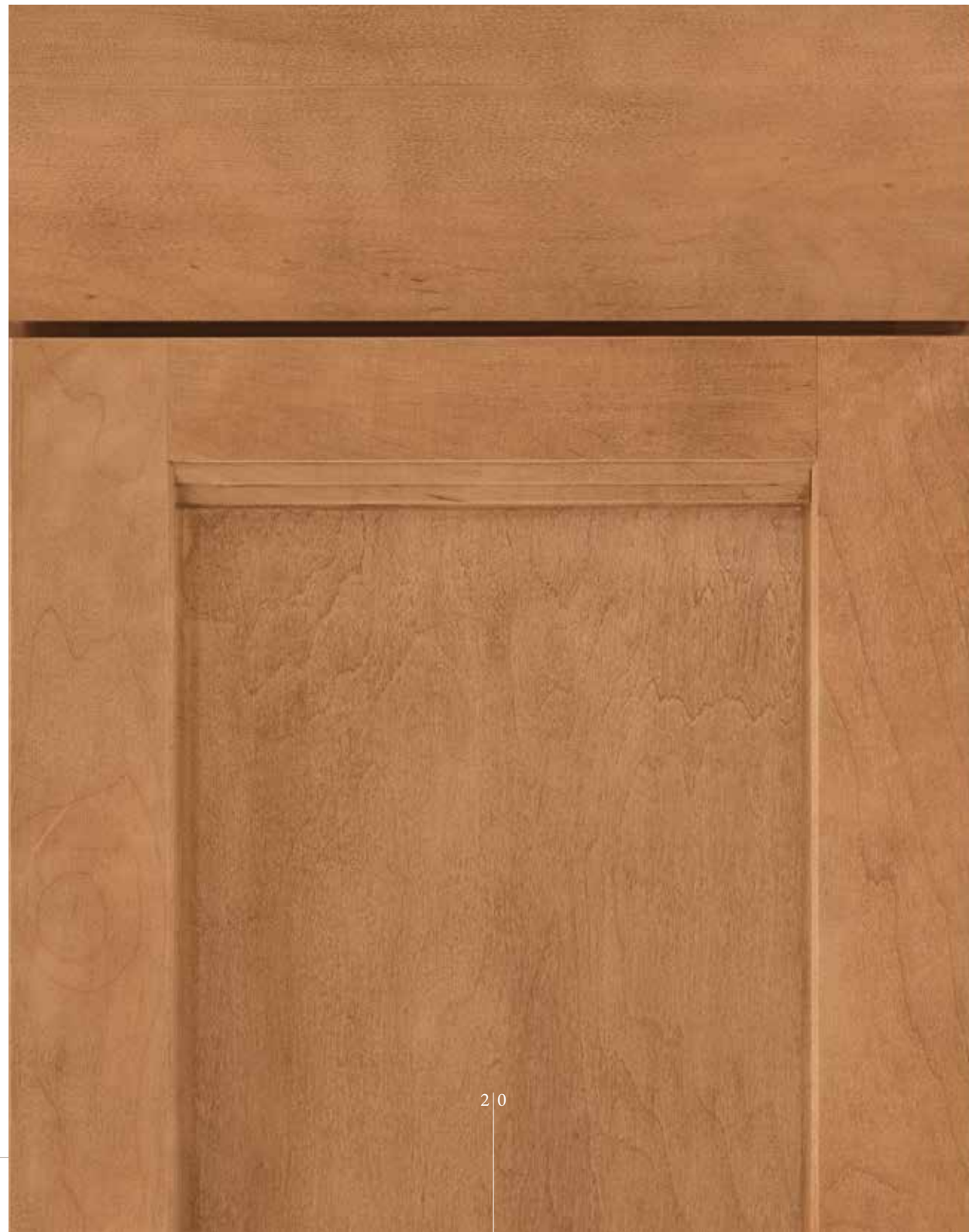

Capistrano® DOOR STYLES

Capistrano® doors are full overlay in a recessed-panel style with a unique cascading design detail on the inside of the top and bottom rails. Available in cherry, maple, and painted finishes.

MAPLE

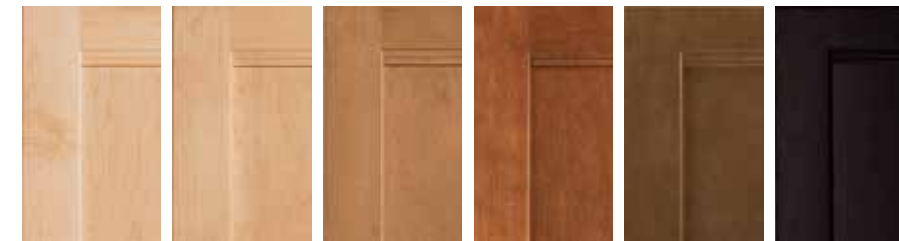

NATURAL HONEY SPICE COGNAC TRUFFLE ESPRESSO

PAINTED**

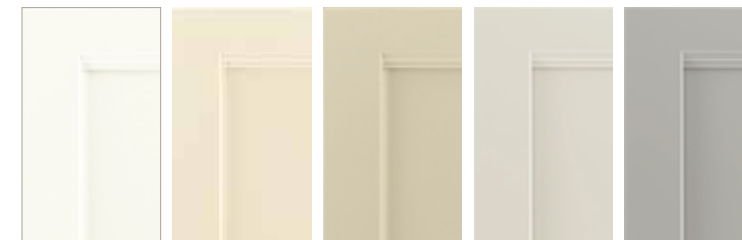

LINEN* SILK* CASHMERE* HARBOR* STONE*

CHERRY

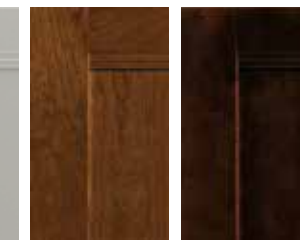

SPICE JAVA

* Denotes premium finish
** Painted doors feature engineered wood center panels for a superior finish.

Decorative hardware is required and must be ordered separately.



Colebrook™ COLLECTION

Colebrook reimagines traditional beauty with polished grace. The raised solid wood center panel and sophisticated detailing lend classic elegance a dash of fresh style. It's a striking silhouette for any décor.

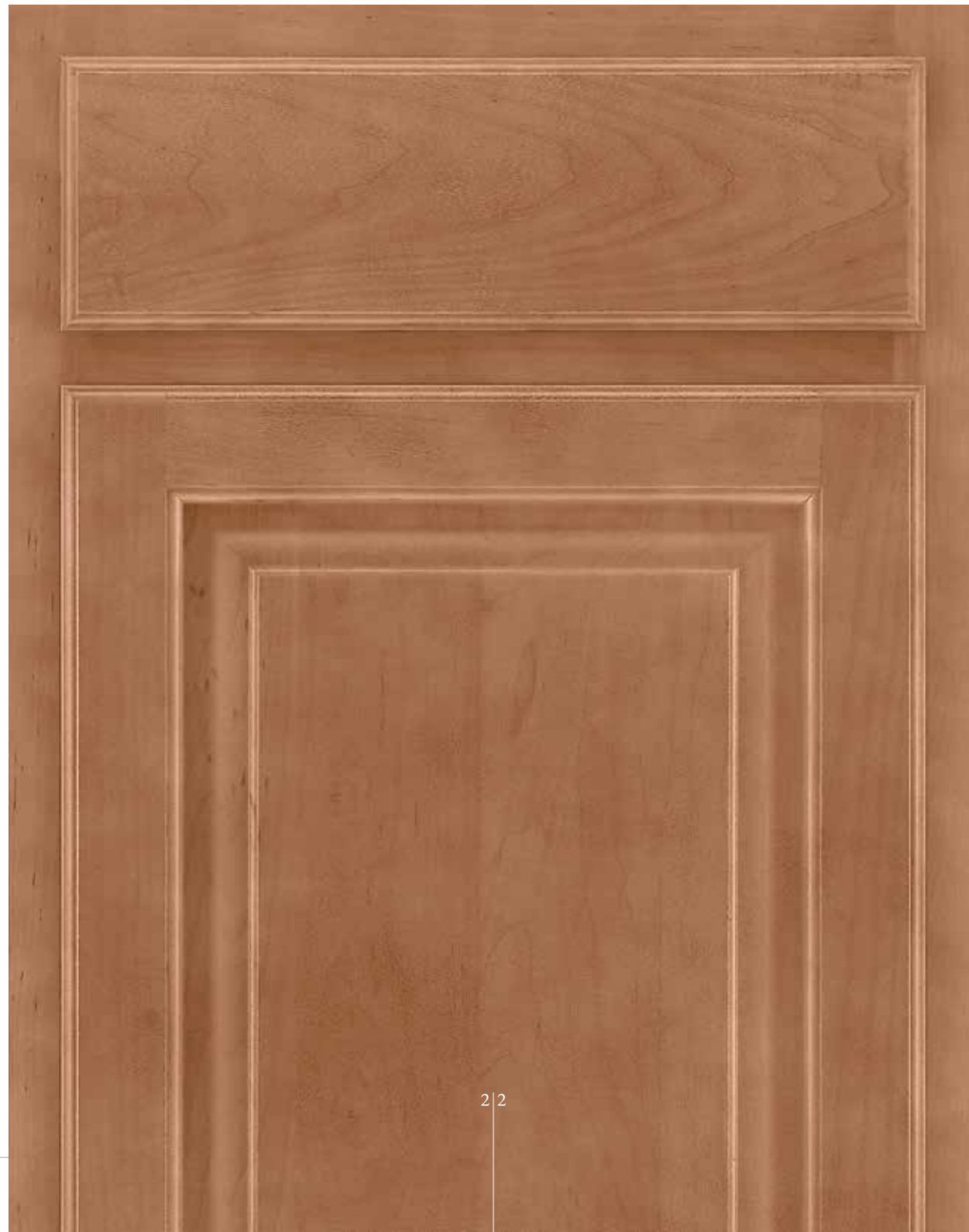

Colebrook™ DOOR STYLES

Colebrook™ doors are solid wood and standard overlay. Available in cherry, maple, oak, and painted in either square or Roman arch.

MAPLE Roman Arch & Square



PAINTED** Roman Arch & Square



CHERRY Roman Arch & Square



OAK Roman Arch & Square



* Denotes premium finish

** Painted doors feature engineered wood center panels for a superior finish.

The glazes on our painted finishes are hand-applied, so no two doors will look exactly alike. And while the door front and edges are completely concealed by the base, some wood grain may show on the door back.

Decorative hardware is recommended and must be ordered separately.



Wyoming® COLLECTION

The triple beading around the solid wood center panel of the Wyoming® style creates a cascade effect that is both sophisticated and beautiful. It is a traditional favorite with solid hardwood and a choice of square or Roman arch.



Wyoming® DOOR STYLES

Wyoming® doors are solid wood and standard overlay. Available in cherry, maple, oak, and painted in either square or Roman arch.

MAPLE Roman Arch & Square



PAINTED** Roman Arch & Square



CHERRY Roman Arch & Square



OAK Roman Arch & Square



* Denotes premium finish

** Painted doors feature engineered wood center panels for a superior finish.

The glazes on our painted finishes are hand-applied, so no two doors will look exactly alike. And while the door front and edges are completely concealed by the base, some wood grain may show on the door back.

Decorative hardware is recommended and must be ordered separately.



Lausanne® MAPLE TRUFFLE

PORTFOLIO® Series

The Timberlake® Portfolio® series is a finely-crafted homeowner favorite that boasts a range of style choices and upgrade options.





Clifton™ DURAFORM™ LINEN



Kinsdale™ MAPLE TRUFFLE



Cumberland® CHERRY JAVA



Lausanne® COLLECTION

The clean lines of the Lausanne® slab door offer a graceful, sophisticated look with a contemporary touch. A range of shades, from warm neutrals to furniture darks, adapts to many styles and moods.

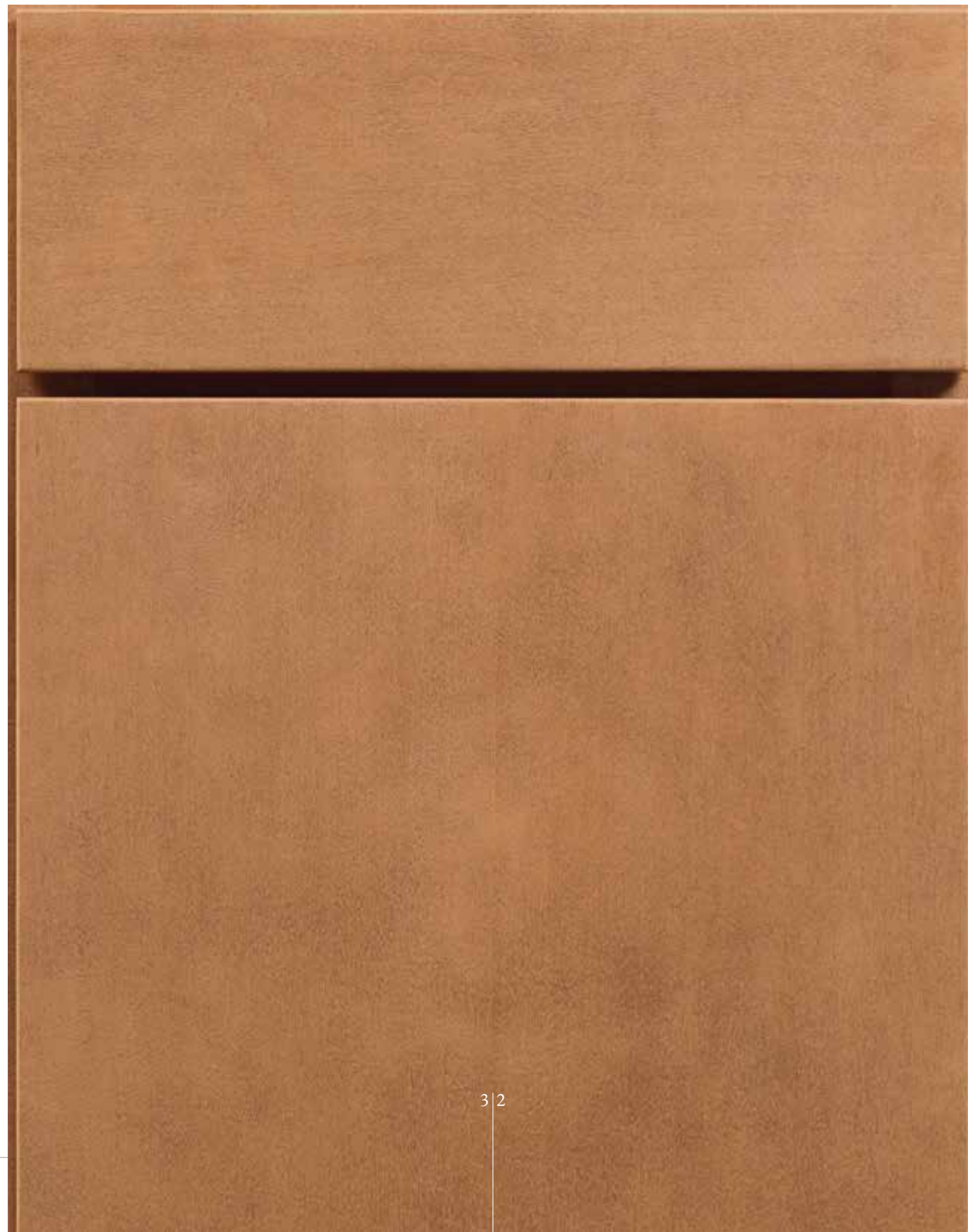

Lausanne® DOOR STYLES

Lausanne® doors are full overlay and veneer or Duraform™ in a contemporary slab style. Available in cherry, Duraform™, and maple finishes.

MAPLE



NATURAL

HONEY

SPICE

COGNAC

TRUFFLE

ESPRESSO

CHERRY



AUTUMN

SPICE

JAVA

SLATE

DURAFORM™

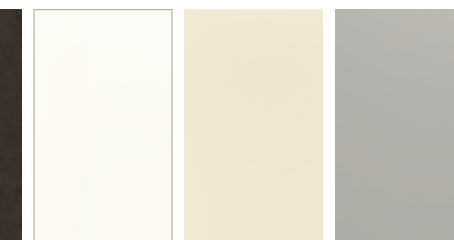

LINEN

SILK

STONE

Decorative hardware is required and must be ordered separately.



Cumberland® COLLECTION

Cumberland® is a distinctive & stylish collection that fits many decors. Veneer center panels keep this full overlay door style within the means of many home buyers.



Cumberland® DOOR STYLES

Cumberland® doors are full overlay and available in cherry, maple, and thermofoil finishes.

MAPLE



NATURAL

HONEY

COFFEE
GLAZE*

SPICE

MOCHA
GLAZE*

COGNAC

AUBURN
GLAZE*

TRUFFLE

ESPRESSO

CHERRY



AUTUMN

SPICE

JAVA

SLATE

WHITE

THERMOFOIL

* Denotes premium finish

Decorative hardware is required and must be ordered separately.



Kinsdale™ COLLECTION

As versatile as it is stylish, the Kinsdale™ collection features a recessed panel embellished with a beaded frame to create an ideal contrast.



Kinsdale™ DOOR STYLES

Kinsdale™ doors are mitered and full overlay in a recessed-panel style. Matching five-piece mitered drawer front. Available in cherry, maple, and painted finishes.

MAPLE



NATURAL HONEY COFFEE GLAZE* SPICE MOCHA GLAZE* COGNAC ALBURN GLAZE* TRUFFLE ESPRESSO

PAINTED**



LINEN* SILK* HAZELNUT GLAZE* CASHMERE* HARBOR* EMBER GLAZE* STONE*

CHERRY



AUTUMN SPICE JAVA SLATE

* Denotes premium finish
 ** Painted doors feature engineered wood center panels for a superior finish.

The glazes on our painted finishes are hand-applied, so no two doors will look exactly alike. And while the door front and edges are completely concealed by the base, some wood grain may show on the door back.

Decorative hardware is required and must be ordered separately.



Clifton™ COLLECTION

Beautifully at home in styles from transitional to traditional, the Clifton™ collection features a mitered pillow profile and beading that frames a recessed center panel in today's smart painted look.



Clifton™ DOOR STYLES

Clifton™ doors are full overlay and designed with a recessed-panel mitered style. Matching five-piece mitered drawer front. Available exclusively in Duraform™.

DURAFORM™

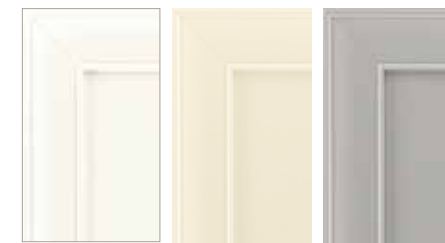

LINEN

SILK

STONE

Decorative hardware is required and must be ordered separately.



Sonoma® COLLECTION

The Sonoma® style is a sleek, contemporary interpretation of Shaker design with crisp edges and flat surfaces. These qualities make it a popular choice for those seeking a tasteful, straight-line design without excess decoration.

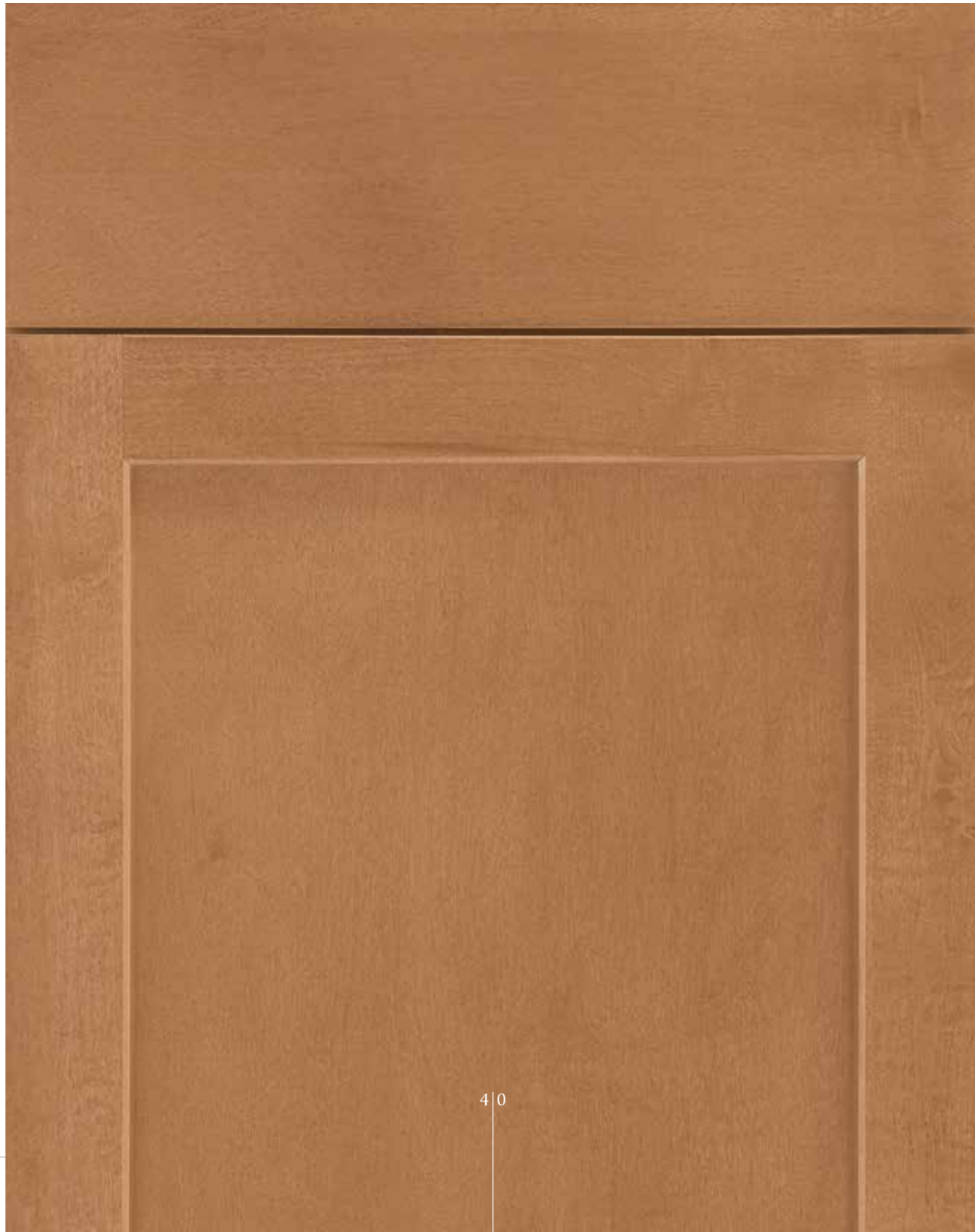

Sonoma® DOOR STYLES

Sonoma® doors are full overlay in a square Shaker style and available in cherry, maple, and painted finishes.

MAPLE



NATURAL HONEY SPICE COGNAC TRUFFLE ESPRESSO

PAINTED**



LINEN* SILK* CASHMERE* HARBOR* STONE*

CHERRY



AUTUMN SPICE JAVA SLATE

* Denotes premium finish
 ** Painted doors feature engineered wood center panels for a superior finish.

Decorative hardware is required and must be ordered separately.



Scottsdale® COLLECTION

Scottsdale® offers a lower-cost, yet attractive option. The triple-carved waterfall effect on the inside edge of the rails and stiles accentuates the raised center panel, producing a favorite for the traditionalist at heart.



Scottsdale® DOOR STYLES

Scottsdale® doors are standard overlay and available in cherry, maple, and oak finishes.

MAPLE

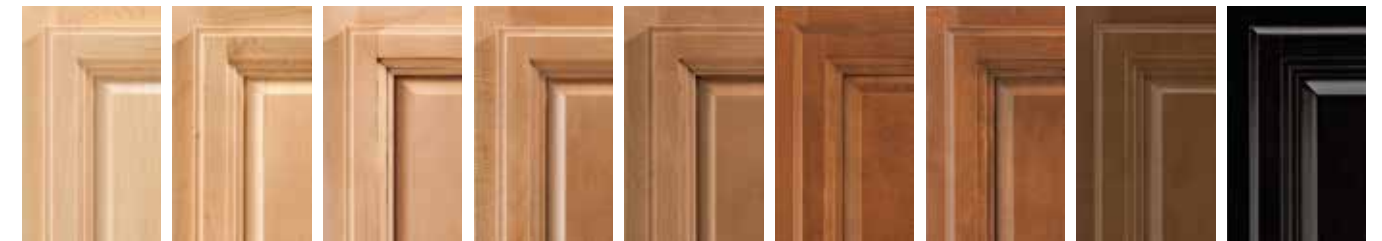

NATURAL HONEY COFFEE GLAZE* SPICE MOCHA GLAZE* COGNAC ALBURN GLAZE* TRUFFLE ESPRESSO

CHERRY

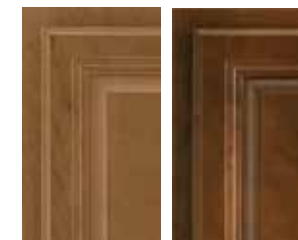

AUTUMN SPICE JAVA

OAK



SLATE HONEY TAWNY

* Denotes premium finish

Decorative hardware is recommended and must be ordered separately.



Downing™ COLLECTION

This traditional classic takes a modern mood with mitered corners and multi-tier detailing along the inside edge of the stiles and rails.



Downing™ DOOR STYLES

Downing™ doors are standard overlay in a recessed-panel mitered style. Matching five-piece mitered drawer front. Available exclusively in Duraform™.

DURAFORM™

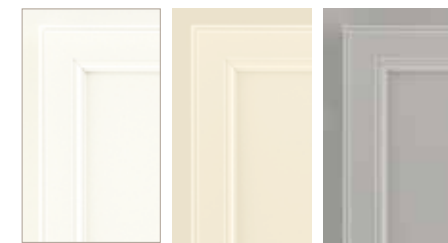

LINEN

SILK

STONE

Decorative hardware is recommended and must be ordered separately.



Barnett™ COLLECTION

The clean lines and simple beauty of this classic Shaker design are an ever-fresh style statement.



Barnett™ DOOR STYLES

Barnett™ doors are standard overlay in a Shaker design. Available exclusively in Duraform™.

DURAFORM™

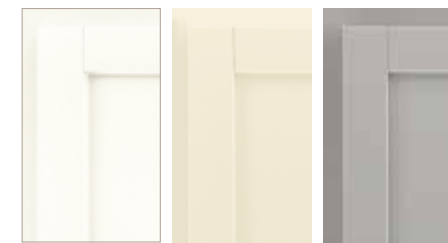

LINEN

SILK

STONE

Decorative hardware is recommended and must be ordered separately.



Tahoe® COLLECTION

This recessed center panel door features a triple-carved inside edge along the rails and stiles creating a harmonious waterfall effect. Tahoe® is a traditional style with unique characteristics.



Tahoe® DOOR STYLES

Tahoe® doors are standard overlay and available in cherry, maple, oak, and painted finishes.

MAPLE



PAINTED**



CHERRY



OAK



* Denotes premium finish

** Painted doors feature engineered wood center panels for a superior finish.

The glazes on our painted finishes are hand-applied, so no two doors will look exactly alike. And while the door front and edges are completely concealed by the base, some wood grain may show on the door back.

Decorative hardware is recommended and must be ordered separately.



Andover® NUTMEG



Value Built® SERIES

The Value Built® series is the perfect balance of craftsmanship, features, and affordability—it is an outstanding alternative when budgets are limited.

ANDOVER® Standard Overlay, Veneer Raised Panel



WHEAT SPICE NUTMEG HONEY TAWNY WHITE

FAIRFIELD Standard Overlay, Veneer Recessed Panel



WHEAT SPICE NUTMEG HONEY TAWNY

Decorative hardware is optional and must be ordered separately.



DECORATIVE *Hardware*

The right hardware can add the perfect finishing touch to any room. Are you a traditionalist? Modernist? Do you like a retro feel or lean toward the grand elegance of the Old World? No matter your style, Timberlake® has a wide selection of beautiful hardware choices to enhance your cabinetry. And many knobs have a complementary pull for easy coordination.



SATIN NICKEL

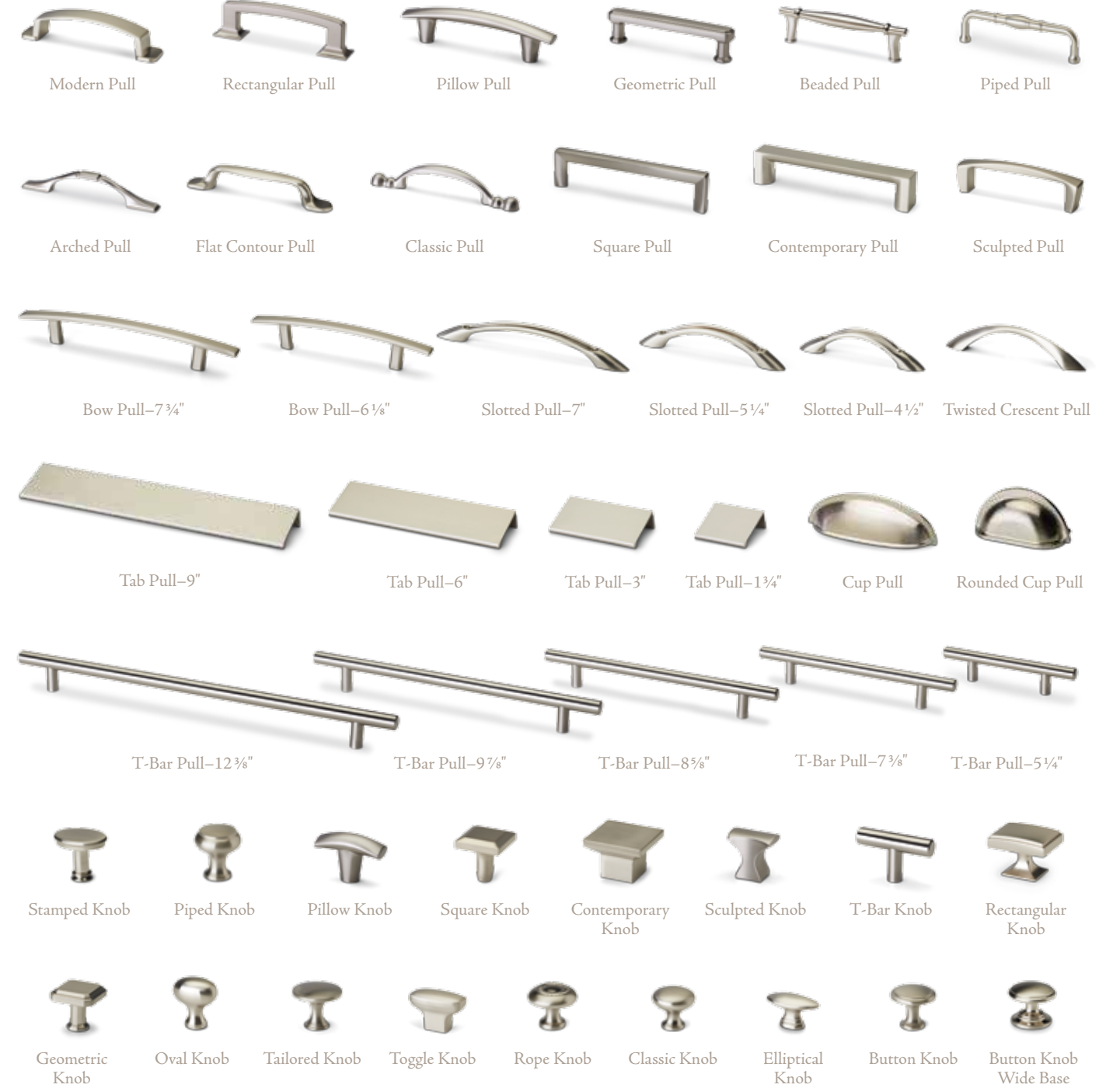

STAINLESS STEEL

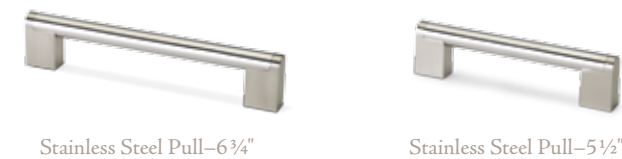

MODERN BRONZE



POLISHED CHROME



T-Bar Pull-12 3/8" T-Bar Pull-9 7/8" T-Bar Pull-8 5/8" T-Bar Pull-7 3/8" T-Bar Pull-5 1/4"



Square Pull Slotted Pull-5 1/4" Classic Pull T-Bar Knob Square Knob Elliptical Knob Classic Knob

POLISHED NICKEL



Beaded Pull Cathedral Pull Rectangular Pull Stamped Knob Domed Knob Rectangular Knob Twist Pull Twist Knob

FRENCH NICKEL

VERONA BRONZE



Rectangular Pull Sculpted Pull Beaded Pull Piped Pull Cup Pull Rounded Cup Pull



Contemporary Pull Twist Pull Barrel Pull-5 5/8" Barrel Pull-4 5/8" Ringed Arch Pull Arched Pull

WEATHERED NICKEL



Beaded Pull Flat Contour Pull Cup Pull Rounded Cup Pull Stamped Knob Rope Knob Classic Knob



Bow Pull-7 3/4" Pyramid Pull Reeded Pull-6 3/8" Reeded Pull-5" Classic Pull Cathedral Pull



T-Bar Pull-12 3/8" T-Bar Pull-9 7/8" T-Bar Pull-8 5/8" T-Bar Pull-7 3/8" T-Bar Pull-5 1/4"



Twist Knob Rectangular Knob Ringed Knob Beveled Knob Domed Knob Piped Knob Classic Knob

MATTE BLACK



Rectangular Pull Ringed Arch Pull Rectangular Knob Ringed Knob Classic Pull Classic Knob Button Knob

PATINA



Contemporary Knob Sculpted Knob Pyramid Knob T-Bar Knob Oval Knob Stamped Knob Reeded Knob

RUBBED BRONZE



Rustic Pull Rustic Knob Turned Pull Turned Knob Decorative Vine Pull Decorative Vine Knob

BRUSHED TIN

VINTAGE NICKEL

OILED BRONZE

WEATHERED VERONA BRONZE



Flat Contour Pull Modern Pull Rope Knob Tailored Knob Rectangular Pull Rectangular Knob



Decorative Glass DOORS

Add style to any kitchen with decorative glass doors. Feature any one of 18 different glass inserts available in assorted specialty door designs from open to aluminum frame.

SPECIALTY DOORS



Open Frame Door with Clear Glass



Mullion Frame Door with Clear Glass



Horizontal Frame Door with Clear Glass



Prairie Frame Door with Clear Glass



Brushed Aluminum Frame Door with Frosted Glass



Brushed Aluminum Frame Door with Frosted Ash Glass



Brushed Aluminum Frame Door with Woven Glass



Vintage Iron Frame Door with Frosted Glass



Vintage Iron Frame Door with Frosted Umber Glass



Vintage Iron Frame Door with Havana Glass

GLASS INSERTS



Afton Glass



Antiqued Afton Glass



Antiqued Fincastle Glass



Clear Glass



Derbyshire Glass



Fincastle Glass



Frosted Glass



Frosted Ash Glass



Frosted Umber Glass



Havana Glass

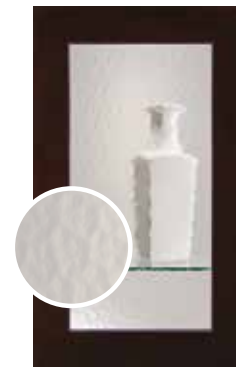

Impression Glass



Lucent Glass



Meredith Glass



Mirrored Glass



Radiance Glass



Ribbed Glass



Twilight Glass



Woven Glass



IMAGINATIVE *Kitchen* ADDITIONS

Imaginative additions help homeowners unclutter their counters and drawers. They get more work and storage space, instant access to kitchen tools, and a simply better experience.



Wood Tiered Cutlery Divider with Sliding Top Section



Spice Drawer Insert



Roll Out Tray Divider



Base Pot & Pan Organizer



Base Pantry Pull Out Cabinet with Utensil Storage



Base Cabinet with Two Factory Installed Wastebaskets



Two Drawer Base with Scalloped Deep Sliding Shelf and Peg Dish Organizer



IMAGINATIVE *Bath & Laundry* ADDITIONS

Creative ingenuity adds impressive design and pure functionality. All the homeowners' necessities are close at hand, but out of sight. And the look adds style to everyday living.



Vanity with Inverted Frame Option, Functional Drawer Below



Base Pantry Pull Out Cabinet



Single Floating Vanity



Laundry Storage



Laundry Storage



Laundry Storage with Floating Shelves



IMAGINATIVE *Home* ADDITIONS

Build in homeowner delight with additions that make a room work harder, turn a small space into a big advantage and create living spaces that organize and enhance today's lifestyles.



Storage Cube



Wet Bar



File Drawer Base Cabinet



Guest Suite Built-In Room Divider



Wine Cellar



Drop-Zone Lockers



Drop-Zone Storage



Built-In Dresser



Entry Drop-Zone



Premium FINISHES

Add luxuriously rich color to your cabinets with a premium finish. Choose a painted finish for a beautiful soft look. Or go with a glaze to accentuate the wood's natural personality.



PAINTED LINEN



PAINTED SILK



PAINTED HAZELNUT GLAZE



PAINTED CASHMERE



PAINTED HARBOR



PAINTED EMBER GLAZE



PAINTED STONE



MAPLE COFFEE GLAZE



MAPLE MOCHA GLAZE



MAPLE AUBURN GLAZE



UNIQUE RESULTS

Our glazes are hand-wiped onto each door and drawer, so the glaze settles naturally into corners and grooves, adding a layer of contrast. No two doors will be exactly alike, which is part of glaze's custom effect.



DISTINCT LOOK

Each collection profile is different, so every door and drawer to which glaze is applied has a distinct look. Each door – and kitchen – becomes one of a kind.

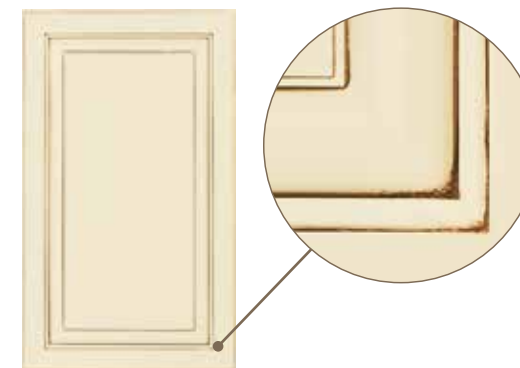

GLAZE OVER A LIGHT BASE COLOR CREATES THE GREATEST CONTRAST. AREAS WHERE THE GLAZE SETTLES WILL BE MORE NOTICEABLE.



GLAZE OVER A DARK BASE COLOR CREATES LESS CONTRAST. IT WILL ALSO DARKEN THE OVERALL FINISH.



IT'S A *fact* OF NATURE

No two pieces of wood are exactly alike — *even from the same tree.* These variations contribute to the beauty and distinction of fine cabinetry. Yet, it is important to understand what to expect.

NATURAL FACTORS

The following characteristics are natural and are not considered defects:

- » Naturally occurring color, grain and texture differences
- » Color deviations, even within the same section of wood
- » Differences between open- and closed-grain areas
- » Visible mineral streaks and worm tracking

Just as wood naturally expands and contracts, so do door joints. Periodically, you may see hairline cracks in the finish surface at the joints. These are normal and do not affect the integrity of the door.

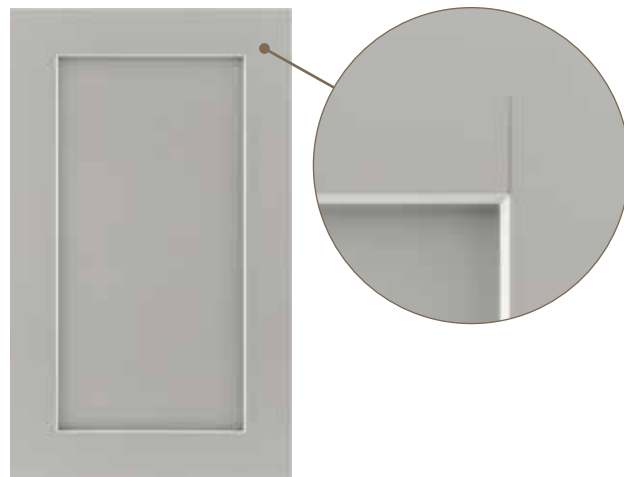

AS WOOD NATURALLY EXPANDS AND CONTRACTS, JOINT LINES MAY BECOME NOTICEABLE.

CARE & CLEANING

While our laminate, painting and wood finishing processes promote durability, care should be taken to preserve the original factory finish:

- » Wipe up spills immediately
- » Use mild soaps only
- » Be sure to read all cabinet care guidelines and cleaning product instructions carefully

ENVIRONMENTAL FACTORS

Cabinetry added at a later date may not match the original cabinets installed. This may be due to:

- » Exposure to sunlight, smoke and chemicals
- » Change in door samples or displays due to age (they may no longer be a true color representation)

Because of environmental factors, Timberlake is not responsible for texture differences or color and wood grain variations in wood or laminate materials used in your cabinets.

CHOOSE YOUR MATERIAL



CHERRY

Cherry is a closed-grain hardwood with uniform texture, known for its warmth and distinctive curly figures and pin knots. Its natural color ranges from pale yellow sapwood to deep reddish brown heartwood. From the time it is cut, cherry begins to darken. This gradual change gives the wood its warmth and charm. Cherry is particularly attractive when stained a deep, rich color.

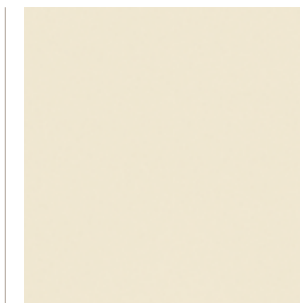

DURAFORM™

Duraform™ uses a highly-technological manufacturing process to bond foils and coatings to medium density fiberboard, high density fiberboard and similar materials to achieve a product with exceptional stability, consistency and durability.



HARDWOOD

Hardwood cabinetry has a dense structure and comes from a combination of deciduous trees such as maple, oak, birch, cherry, hickory, poplar, or ash. Natural colors range from light blonde to dark reddish brown tones. These hardwoods may contain mineral streaks, slight differences in graining, and color variations.



MAPLE

Maple is an extremely hard wood with a fine, smooth, even texture. Its color ranges from a light to cream-colored sapwood. Although it has a uniform straight grain, it may exhibit wavy, curly, bird's eye or burl graining. Maple is one of the most popular choices for cabinetry due to its durability and natural luster.

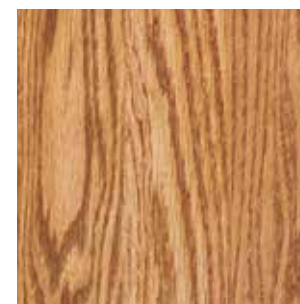

OAK

Oak is an open-grained hardwood with patterns ranging from straight grain to wide arcs. When stained, there is a noticeable difference in the color between the open- and closed-grain areas. Wood cut from the heartwood will range from pink to reddish brown. Because of the distinct grain, oak is a popular choice for cabinetry.



PAINTED

Painted finishes combine hardwoods and engineered materials to achieve a product with superior stability, consistency, coverage and durability. These finishes yield radiant painted cabinetry leaving natural wood grains less evident. Visible joint lines may appear due to the natural expansion and contraction of wood.

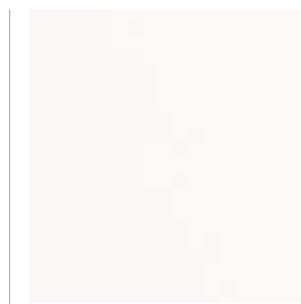

THERMOFOIL

Thermofoil is a process whereby a thick vinyl film is bonded permanently to a warp-resistant engineered wood core. Because the color is throughout the film, the surface is durable, easy to clean and especially resistant to chipping and cracking.





CABINETS BUILT-TO-ORDER

Since all Timberlake® cabinets are built-to-order, special construction needs are not a problem. These options do not add time or complexity. All options are shipped as part of your regular order in the standard turnaround time.

REDUCED DEPTH CABINET OPTION

Both wall and base cabinets are available with reduced depths in one-inch increments.

INCREASED DEPTH CABINET OPTION

Deeper cabinets often come in handy for designers. Our Increased Depth Option for wall cabinets allows you to select cabinets deeper than the standard 12" depth on cabinets up to 36" wide. The Increased Depth Option is available in one-inch increments from 13" to 24" deep on the following cabinets: Wall Cabinets, Peninsula Wall, Blind Wall, Blind Wall Peninsula, Straight Appliance Garage, and Bookshelves.

INVERTED FRAME CABINET OPTION

The Inverted Frame Option, available for most standard base cabinets, allows the drawer to go below. This option is also available for Base Pot & Pan Organizer and Factory Installed Wastebasket Cabinets.

MATCHING INTERIOR CABINET OPTION

Ideal for built-in cabinets, the matching interior upgrade provides an interior color that matches the exterior finish for a custom look.

VOID DOOR CABINET OPTION

The Void Door Option means cabinets will ship without doors, battens or hinges. Since stiles are pre-drilled for hinges, molding is used to provide a finished look. Choose from three moldings to be cut and field installed.

CUSHIONCLOSE® HINGE OPTION

The CushionClose® Hinge Option features a slow closing mechanism that helps reduce slams and noise, and is available on Portfolio Select® and Portfolio® series cabinets.

CUSHIONCLOSE® GLIDE OPTION

The CushionClose® no-slam, drawer closure system is available on Portfolio Select® and Portfolio® series cabinets on most drawers and a wide variety of accessories.

FURNITURE ENDS OPTION

The finished look of the Furniture Ends Option for cabinet sides is available on most Portfolio Select® and Portfolio® cabinets. The ¾" plywood side panels can be chosen for individual cabinets or the whole room.

ALL PLYWOOD CONSTRUCTION (APC) OPTION

The APC option is available for all Portfolio Select® and Portfolio®* door styles and features ½" plywood sides, floors and cabinet tops. The captured back, inset toe kick, corner blocks and shelves are also constructed with plywood. The plywood side panels are finished to match your chosen cabinet color with our multi-step BeautyGuard® finishing process.

PLYWOOD ENDS OPTION

This option adds extra strength. These ½" thick plywood panels are finished to match your chosen cabinet color.

DEEP DOVETAIL SLIDING SHELVES

Forget hunting for things in the back of the cabinet. These sturdy trays slide everything into view. Tray kits fit both standard base and utility cabinets.

*Dovetail Full-Access Drawer Option required with APC option on Portfolio® door styles.

AN INSIDE LOOK AT TIMBERLAKE® FEATURES

FURNITURE ENDS OPTION

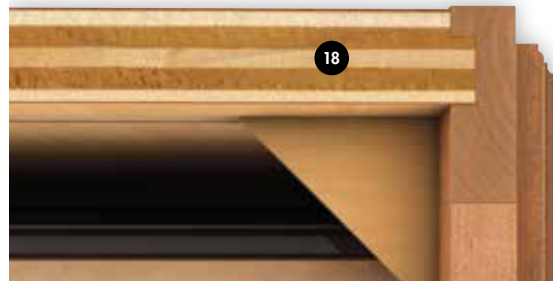

3/4" Furniture Ends Construction

Shown with All Plywood Construction Option. Also available with Standard Construction.

ALL PLYWOOD CONSTRUCTION

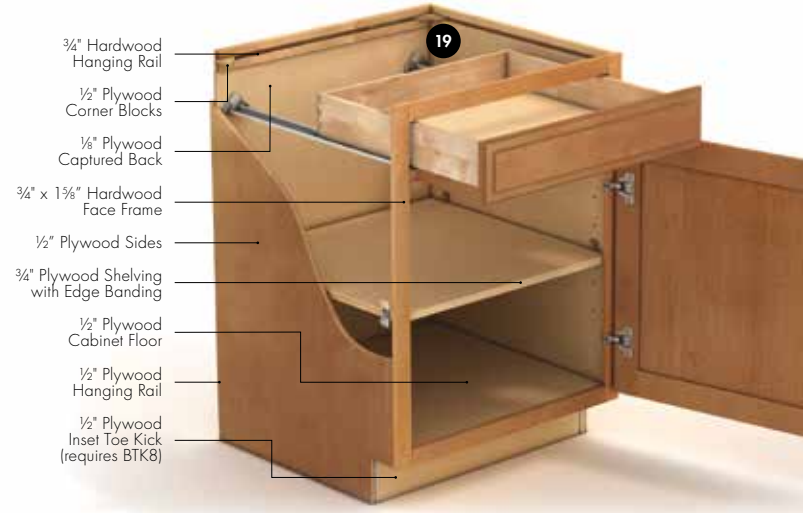

- 3/4" Hardwood Hanging Rail
- 1/2" Plywood Corner Blocks
- 1/8" Plywood Captured Back
- 3/4" x 1 1/8" Hardwood Face Frame
- 1/2" Plywood Sides
- 3/4" Plywood Shelving with Edge Banding
- 1/2" Plywood Cabinet Floor
- 1/2" Plywood Hanging Rail
- 1/2" Plywood Inset Toe Kick (requires BTK8)



Choose the perfect combination of features for your needs... and budget. Timberlake makes it simple. There are three series — each with different features and options — to help you satisfy every type of homebuyer: from entry level to move-up to luxury.

PORTFOLIO SELECT® FEATURES

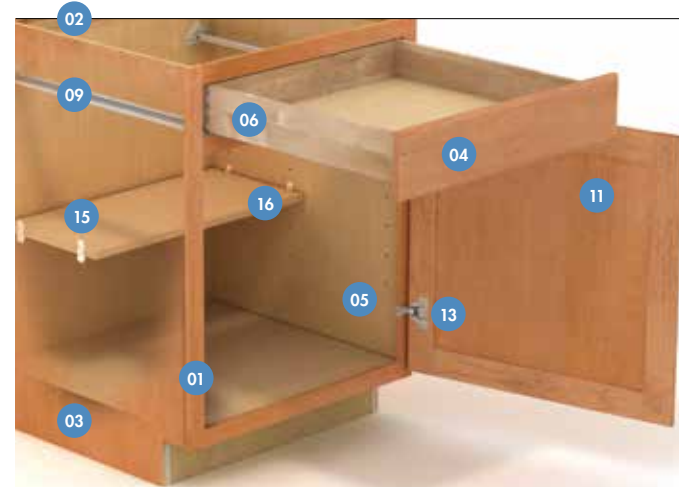

PORTFOLIO® FEATURES

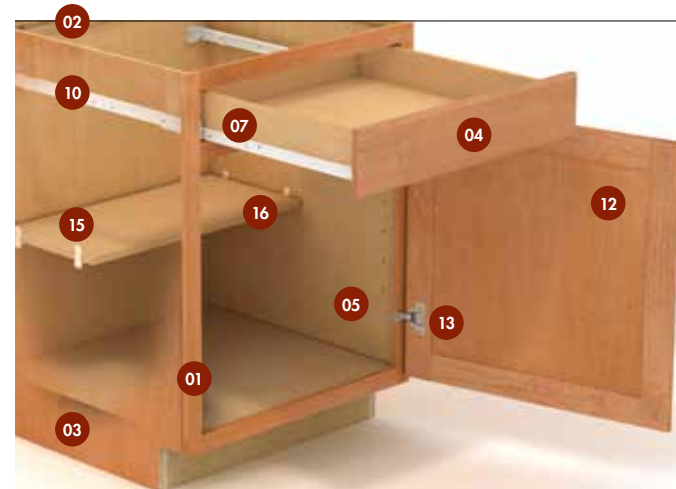

VALUE BUILT® FEATURES

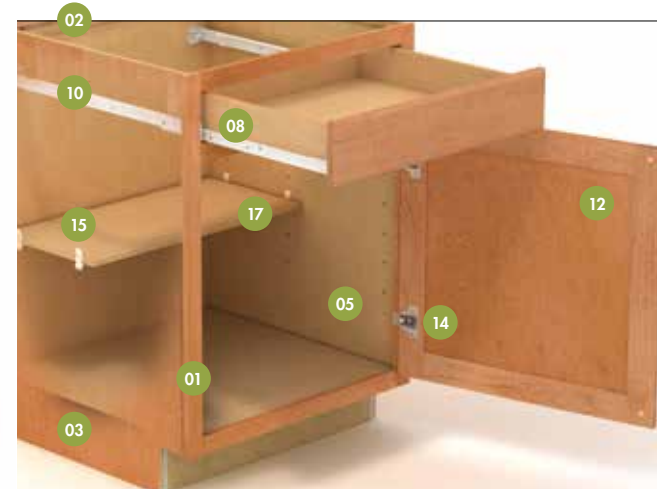

FEATURES BY CABINET SERIES

CABINET CONSTRUCTION

- 01 Solid Hardwood Face Frames
- 02 Captured Back Construction
- 03 1/2" Thick Engineered Wood Cabinet Sides

FINISH

- 04 Multi-Step BeautyGuard® Finish¹
- 05 TuffTech® Interior Finish²

¹ BeautyGuard® is a finishing system that brings out the richness, luster and natural graining, while offering the ultimate protection from fading, staining and scratching
² TuffTech® interior finish is a bonded acrylic that resists scratching, fading and moisture

DRAWERS

- 06 21" Deep, 5/8" Thick Premium Dovetail Hardwood Drawers with Plywood Bottom*
- 07 21" Deep Drawers, 1/2" Thick Engineered Wood*
- 08 18" Deep Drawers, 1/2" Thick Engineered Wood

DRAWER GLIDES

- 09 Full-Access Hidden Glides®*
- 10 Side-Mounted Drawer Glides
CushionClose® Glide Option

DOORS/HINGES

- 11 Solid Wood Doors**
- 12 Veneer Doors
- 12 Wrapped Doors
- 13 Adjustable Hidden Hinges®
- 14 Hidden Hinges®
CushionClose® Hinge Option

SHELVING

- 15 Adjustable Shelves
- 16 3/4" Thick Shelving
- 17 1/2" Thick Shelving

WARRANTY

- 5-Year Limited Warranty
- 2-Year Limited Warranty

OPTIONS

- 18 Furniture Ends
- 19 All Plywood Construction
Plywood Ends
Aluminum Frame Doors
Recessed Toe Kick
Reduced / Increased Depths
Decorative Glass Doors
Matching Interiors
Void Door
Cabinet Front Only
Inverted Frame

*Excluding Vanity and 21" Deep Desk Cabinetry

**Painted doors feature engineered wood center panels for a superior finish; Capistrano® has veneer recessed panels

	Portfolio SELECT	Portfolio	Value BUILT
01	●	●	●
02	●	●	●
03	●	●	●
04	●	●	●
05	●	●	●
06	●	OPTIONAL	●
07	●	●	●
08	●	●	●
09	●	OPTIONAL	●
10	OPTIONAL	OPTIONAL	●
11	●	●	●
12	●	●	●
13	●	●	●
14	●	OPTIONAL	●
15	●	●	●
16	●	●	●
17	●	●	●
5-Year Limited Warranty	●	●	●
2-Year Limited Warranty	●	●	●
18	●	●	●
19	●	●	●
Plywood Ends	●	●	●
Aluminum Frame Doors	●	●	●
Recessed Toe Kick	●	●	●
Reduced / Increased Depths	●	●	●
Decorative Glass Doors	●	●	●
Matching Interiors	●	●	●
Void Door	●	●	●
Cabinet Front Only	●	●	●
Inverted Frame	●	●	●



Lausanne® MAPLE TRUFFLE



TIMBERLAKE
CABINETS | BUILT BY
SERVICE

P.O. BOX 1980
WINCHESTER, VIRGINIA 22604
WWW.TIMBERLAKE.COM

© 2018 American Woodmark Corporation
01/18 TBL96819 17M

Photography is for illustration purposes only. Actual colors may vary slightly due to the printing process.
For actual color selections, please consult your Timberlake® distributor or builder.