

McGee's Modular Façade Retention System | South Molton

1. Design

We've designed a new modular façade retention system which is **lighter, stiffer and quicker to install** than a traditional latticed tower frame system.

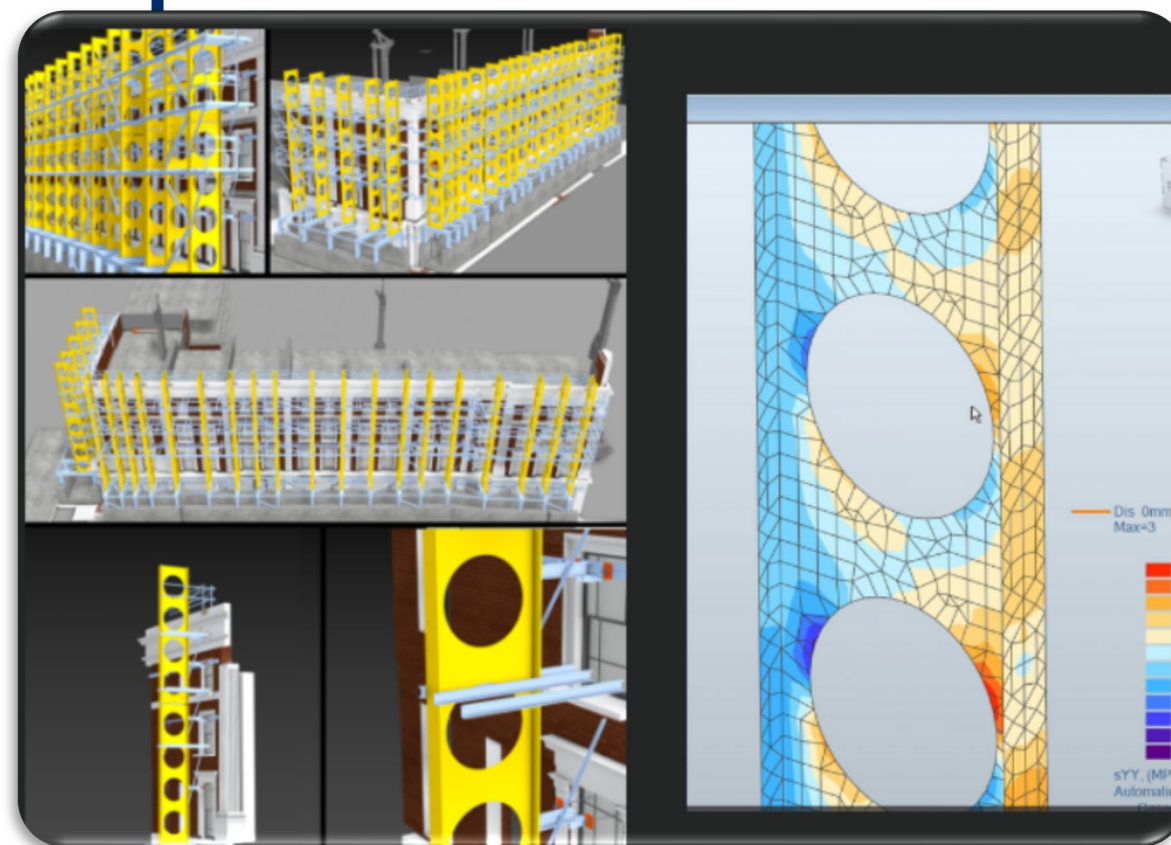
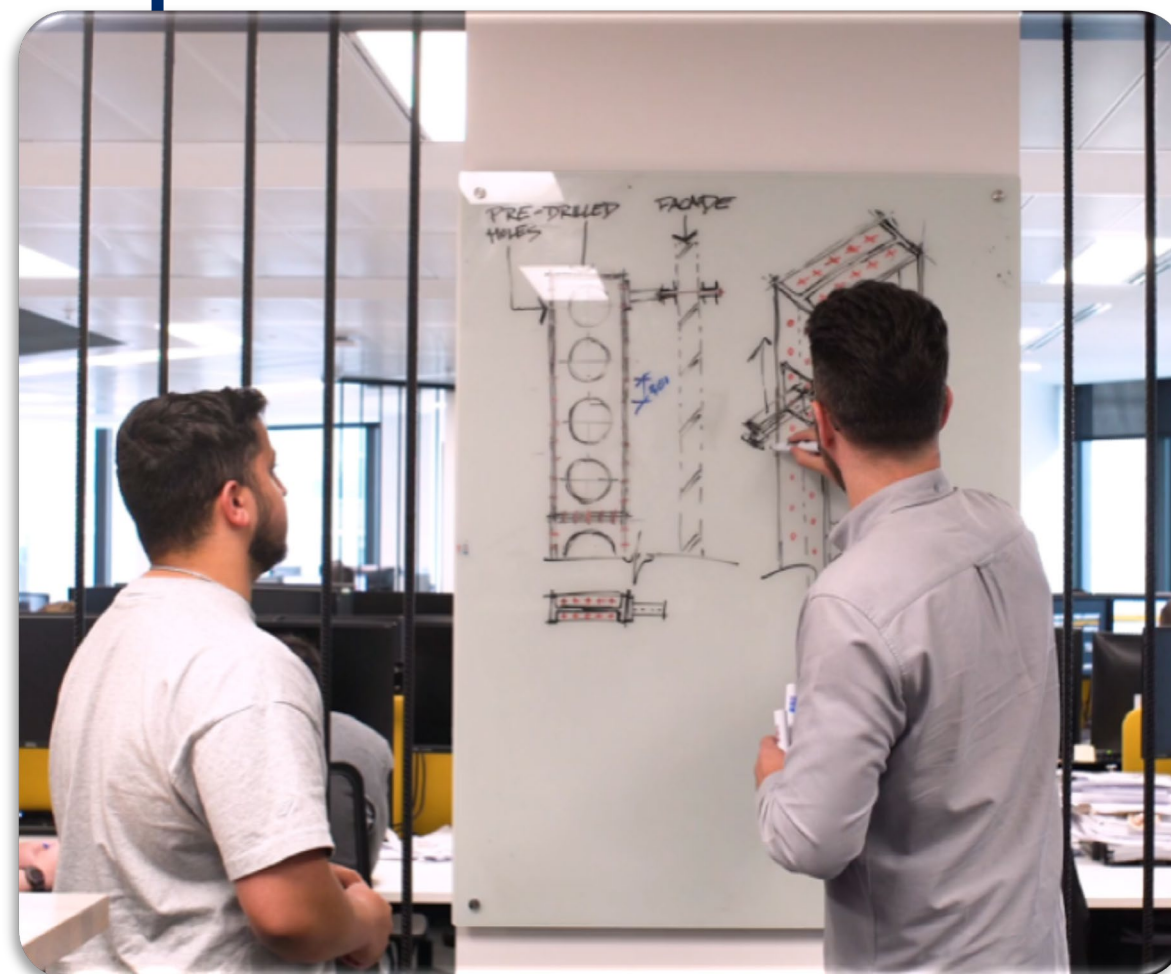

2. Source existing Steelwork

We sourced **existing steelwork** from EMR, shipped it to ASD Westok in Leeds for it to be **defabricated**.



3. Refabricate

Refabricated it to a **cellular ribbon cut Westok** section. Thus upgrading the stiffness of the parent section.



4. Install

We created a truly inspired façade retention system, which **avoided 62.7tCO2e** supporting Grosvenor's quest for 500kgCO2e/m2

