

HUSKER VALLEY CLUSTER PREMIUM LISTS

**FRIDAY BOXER, BOSTON TERRIER & SHETLAND SHEPDOG
SPECIALTIES ARE LIMITED TO 100 ENTRIES EACH SHOW**

**GERMAN WIREHAired POINTERS, BORZOIS & BOXERS ARE LIMITED TO 100
ENTRIES AT THE CONCURRENT SPECIALTY & ALL BREED SHOW THE DAY OF
THE CONCURRENT**

**OBEDIENCE IS LIMITED TO 5 HOURS ON SATURDAY & SUNDAY
RALLY IS LIMITED TO 40 ENTRIES SATURDAY & SUNDAY**

ENTRIES CLOSE WEDNESDAY NOON, SEPTEMBER 20, 2023 or when the limits have been reached, if reached prior to this date at Superintendent's Office. After which time entries cannot be accepted, canceled, altered or substituted except as provided for in Chapter 11, Section 6 of the Dog Show Rules.

Obedience & Rally entries are open to All-American Dogs listed in the AKC Canine Partners Program

FRIDAY, OCTOBER 6, 2023

**GERMAN WIREHAired POINTER CLUB OF AMERICA, INC.
SPECIALTY SHOWS - 2023009801**

Member of the American Kennel Club

National Specialty, Junior Showmanship, Veteran Sweepstakes & Sweepstakes,
AOH Sweepstakes, Futurity & Maturity

MISSOURI VALLEY BOXER CLUB - SPECIALTY SHOWS

Licensed by the American Kennel Club

1st Specialty Show & Sweepstakes - 2023033301 • 2nd Specialty Show - 2023033302
AKC NATIONAL OWNER HANDLED SERIES

GREATER OMAHA TERRIER ASSOCIATION - GROUP SHOW

Licensed by the American Kennel Club

Group Show & All Breed Obedience - 2023681901 • All Breed Rally - 2023681902

EASTERN NEBRASKA BOSTON TERRIER CLUB - SPECIALTY SHOWS

1st Specialty Show & Sweepstakes 2023677801

2nd Specialty Show & Junior Showmanship - 2023677802

MIDLANDS SHETLAND SHEPDOG CLUB, INC. - SPECIALTY SHOWS

Licensed by the American Kennel Club

1st Conformation Show - 2023086002 • 2nd Conformation Show - 2023086001

SATURDAY, OCTOBER 7, 2023

CORNHUSKER KENNEL CLUB OF LINCOLN, NEBRASKA, INC.

Member of the American Kennel Club

Conformation & Obedience - 2023033905 • Rally - 2023033908

4-6 Month Beginner Puppy - 2023033906 Open Show - 2023033918

CONCURRENT SPECIALTY SHOWS

GERMAN WIREHAired POINTER CLUB OF AMERICA, INC. REGIONAL - 2023009803

BORZOI CLUB OF GREATER OMAHA - 2023676001

MISSOURI VALLEY BOXER CLUB - 2023033303

Conformation & Obedience - 2023033907 • Rally - 2023033909 • Open Show - 2023033919

SUNDAY, OCTOBER 8, 2023

★ SATURDAY & SUNDAY - AKC NATIONAL OWNER HANDLED SERIES & FSS OPEN SHOWS ★

CONCURRENT SPECIALTY SHOW

Borzoi Club of Greater Omaha - 2023676002

SUPPORTED ENTRY - SATURDAY & SUNDAY

GERMAN WIREHAired POINTER CLUB OF AMERICA, INC.

★★ LANCASTER EVENT CENTER ★★

4100 N 84th Street • Lincoln, Nebraska 68507

THESE SHOWS WILL BE HELD INDOORS - UNBENCHED

★ CONFORMATION CLASSES IN PAVILION I ON CONCRETE ★ OBEDIENCE &
RALLY WILL BE MATTED ★

GROOMING ON CEMENT • AMPLE PARKING NEXT TO THE PAVILION

SHOW HOURS - 6:00 am to 6:00 pm

Member: Dog Show Superintendents Association



American
Kennel Club
Annually Licensed
Superintendents

John Goosen • Candy E James • Christopher L James
H T (Terry) James • Mary Beth James • Tim E James • Zach James
John McDonald • Sandi McDonald • Antony M Onofrio
Jack David Onofrio • Patricia Onofrio • Sue Onofrio • Tiffany R Fields Peterson
Glen Power • Luann Ramsey • Reggie Turner • Sharon Turner

PO Box 25764

Oklahoma City, Oklahoma 73125-0764

Phone: (405) 427-8181 • www.onofrio.com



**AMERICAN
KENNEL CLUB®**

CERTIFICATION

Permission has been granted by the American Kennel Club for the holding of this event under the American Kennel Club rules and regulations.

GINA M. DINARDO, Executive Secretary

ENTRY FEES • (including 50 cent AKC recording fee and \$3.00 AKC Event Service Fee)

When a dog is entered in more than one class, the highest priced class is considered the first entry.

Separate fee for each dog, each day, each show

GERMAN WIREHAired POINTER CLUB OF AMERICA, INC.**FRIDAY & SATURDAY SPECIALTIES**

First entry of each dog	\$30.00
Additional entry of same dog, unless otherwise specified	\$26.00
Best of Breed	\$35.00
Puppy & Bred-by-Exhibitor Classes	\$26.00
Sweepstakes & Veteran Sweepstakes, Amateur Owner-Handled Sweepstakes	\$26.00
Junior Showmanship Competition	\$15.00
Stud Dog & Brood Bitch	\$26.00
Futurity & Maturity	\$20.00

BORZOI CLUB OF GREATER OMAHA - SATURDAY & SUNDAY CONCURRENT SPECIALTIES

First entry of each dog	\$30.00
Additional entry of same dog, unless otherwise specified	\$24.00
Puppy & Bred-by-Exhibitor Classes	\$24.00
Stud Dog & Brood Bitch Classes	\$18.00
Sweepstakes & Veteran Sweepstakes	\$15.00

MISSOURI VALLEY BOXER CLUB - FRIDAY & SATURDAY SPECIALTIES

First entry of each dog	\$30.00
Additional entry of same dog, unless otherwise specified	\$18.00
Puppy & Veteran Classes	\$21.00
Sweepstakes (Friday First Show)	\$18.00

GREATER OMAHA TERRIER ASSOCIATION

First Conformation entry of each dog	\$30.00
Additional Conformation entry of same dog, unless otherwise specified	\$24.00
Puppy & Bred-by-Exhibitor Classes	\$24.00
Veteran Special Attraction (Spayed/Neutered allowed)	\$15.00
First Obedience entry of each dog	\$30.00
Additional Obedience entry of same dog	\$24.00

EASTERN NEBRASKA BOSTON TERRIER CLUB - FRIDAY SPECIALTIES

First entry of each dog	\$30.00
Additional entry of same dog, unless otherwise specified	\$24.00
Puppy Classes	\$21.00
Veterans	\$21.00
Sweepstakes - 1st Show	\$18.00
Junior Showmanship - 2nd Show	FREE

MIDLANDS SHETLAND SHEEPDOG CLUB, INC. SPECIALTY SHOWS

First entry of each dog	\$28.00
Additional entry of same dog	\$24.00

CORNHUSKER KENNEL CLUB OF LINCOLN, NEBRASKA, INC.

First entry of each dog	\$30.00
Additional entry of same dog, unless otherwise specified	\$24.00
Puppy & Bred-by-Exhibitor Classes	\$24.00
Junior Showmanship Competition ONLY	\$10.00
as an additional entry	\$5.00
4-6 Month Beginner Puppy (includes \$2.00 AKC recording fee) Saturday	\$20.00
Open Show Open Classes (including \$2.00 AKC recording fee)	\$30.00
Open Show Puppy & Bred-by-Exhibitor Classes (including \$2.00 AKC recording fee)	\$24.00

CORNHUSKER KENNEL CLUB OF LINCOLN, NEBRASKA, INC.**GREATER OMAHA TERRIER ASSOCIATION**

RALLY ENTRY FEES - (including AKC recording fee of \$3.50 1st entry & \$3.00 additional entry of same dog)

Separate fee for each dog, each day, each trial

First entry of each dog	\$30.00
Additional entry of same dog	\$24.00

NOTICE: PLEASE PUT BREED & NAME OF SHOW ON CHECK

SHOW PHOTOGRAPHER

Melia Photography

7613 S 72nd Ave, LaVista NE 68128

(402) 331-5071

Select & purchase Pictures on the website
meliaphotography.com

BOOTH RENTAL INFORMATION

Suzy Riedel

402-314-1716

pudlzone@aol.com

Interested in Ring Stewarding?

IF ANYONE WOULD LIKE TO VOLUNTEER TO RING STEWARD, EITHER OF THE 2 DAYS, WE WOULD VERY MUCH APPRECIATE YOUR HELP. LUNCH WILL BE PROVIDED FOR AT LEAST A HALF DAY OF STEWARDING.

PLEASE CONTACT SANDY MYERS BY SEPTEMBER 17, 2023. IF YOU ARE AVAILABLE TO HELP RING STEWARD.

EMAIL SANDY MYERS AT:

SMYERS563@GMAIL.COM OR PHONE # IS (402) 429-8804.

2 AKC COONHOUND BENCH SHOWS

Held on Saturday & Sunday, October 7 & 8, 2023.

Time & Ring to be announced. Day of Entries ONLY.

Questions: Contact Raven Klone oldsoulkennel@gmail.com



OFA Cardio Clinics

Saturday, October 7th 2023



Cornhusker KC show-Lancaster Event Center, Lincoln NE



Dr. Justin Thomason, DVM, DACVIM

Echocardiogram- \$275 per dog

Auscultation- \$60 per dog

For registration:

<https://forms.gle/BSmaZKwQL3soKjA58>

Please send any questions to bcgotreasurer@gmail.com

AKC NATIONAL OWNER-HANDLED SERIES

BOXER SPECIALTIES - FRIDAY

ALL BREED SHOWS - SATURDAY & SUNDAY

The AKC National Owner-Handled Series is a non-titling competition for dogs that are exhibited by their owners that are not professional handlers.



“DON’T FORGET TO CHECK THE OWNER-HANDLED BOX ON THE ENTRY FORM IF ENTERING THIS COMPETITION.”



All dogs that are owner-handled and are not exhibited in the National Owner-Handled Series by professional handlers* meet the requirements for this competition. Exhibitors must declare their dog is Owner-Handled eligible at the time of entry using the check box on the entry form. Eligible dogs will be identified by an asterisk in the steward’s book & the catalog. **Dogs must be handled throughout the breed level competition for the regular show by an eligible owner. Professional handlers, household members and current assistants to professional handlers may not exhibit the dog in any AKC National Owner-Handled Series competition during the entire show. A current assistant is defined by anyone employed by a professional handler on a full-time basis, or assisting a professional handler at the show or any show during the cluster/weekend, however current assistants that are eligible to compete in Junior Showmanship (meet age and amateur status requirements) may participate in NOHS.**

Owner-Handled Best of Breed will be selected from the dogs that are competing in the Best of Breed competition including Winners Dog, Winners Bitch and winners of the non-regular classes.

The breed will not be represented in the Owner-Handled Group if there is no eligible dog competing in the Best of Breed, or in Best of Winners competition.

**Professional handlers are defined as any person who belongs or has belonged to a professional handlers’ organization, distributed rate cards, or otherwise advertised or represented themselves as handling dogs for pay within the last five years.*

JUNIOR SHOWMANSHIP COMPETITION

NOVICE JUNIOR CLASS - For Boys and Girls at least 9 and under 12 years of age on the day of the show who at the time entries close, have not won three (3) first place awards★, with competition present, in a Novice Class at a licensed or member show.

NOVICE INTERMEDIATE CLASS - For Boys and Girls at least 12 and under 15 years of age on the day of the show who at the time entries close, have not won three (3) first place awards★, with competition present, in a Novice Class at a licensed or member show.

NOVICE SENIOR CLASS - For Boys and Girls at least 15 and under 18 years of age on the day of the show who at the time entries close, have not won three (3) first place awards★, with competition present, in a Novice Class at a licensed or member show.

OPEN JUNIOR CLASS - For Boys and Girls at least 9 and under 12 years of age on the day of the show who at the time entries close, have won three (3) first place awards★ in a Novice Class at a licensed or member show, with competition present in the Novice Class.

OPEN INTERMEDIATE CLASS - For Boys and Girls at least 12 and under 15 years of age on the day of the show who at the time entries close, have won three (3) first place awards★ in a Novice Class at a licensed or member show, with competition present in the Novice Class.

OPEN SENIOR CLASS - For Boys and Girls at least 15 and under 18 years of age on the day of the show who at the time entries close, have won three (3) first place awards★ in a Novice Class at a licensed or member show, with competition present in the Novice Class.

MASTER CLASS - For Boys and Girls at least 9 and under 18 years of age on the day of the show and who have won ten (10) Best Junior Handler awards with competition. The calendar for this class will be consistent with the eligibility dates for the AKC National Championship. All juniors meeting the criteria for this class are required to enter the Master Class and must change their entry the day of the show if entries have already closed. Once the eligibility time frame for that year has passed, all participants return to the Open Class to compete for the following year.

★ A first place in Novice without competition leading to a Best Junior award with competition counts as one win towards moving to Open.

NOTICE: Junior Handlers must include their AKC JUNIOR HANDLER NUMBER on each entry. To obtain junior identification number contact juniors@akc.org

BE SURE ALL INFORMATION for Junior Showmanship Classes is entered on front and back of entry form.

• RIBBON/ROSETTE PRIZES WILL BE AS FOLLOWS •

REGULAR CLASSES

First Prize	Blue
Second Prize	Red
Third Prize	Yellow
Fourth Prize	White
Winners	Purple
Reserve Winners	Purple and White
Best of Winners	Blue and White
Best of Breed	Purple and Gold
Best of Variety of Breed	Purple and Gold
Best of Opposite Sex to Best of Breed and to Best of Variety of Breed	Red and White
Select	Light Blue and White

OBEDIENCE CLASSES

Highest Scoring Dog in the Regular Obedience Classes	Blue and Gold
Highest Combined Score in Open B & Utility Obedience Classes	Blue & Green
Qualifying Score	Dark Green

RALLY CLASSES

Highest Scoring Triple Qualifying Score	Red & Blue
Highest Combined Score in Advanced B & Excellent B Rally Classes	Blue & Green
Qualifying Score	Dark Green

VARIETY GROUPS

First Prize	Blue
Second Prize	Red
Third Prize	Yellow
Fourth Prize	White
Best in Show	Red, White and Blue
Reserve Best in Show	Red, Silver and Blue

NON-REGULAR CLASSES

First Prize	Rose
Second Prize	Brown
Third Prize	Light Green
Fourth Prize	Gray

• CLASSIFICATION •

Regular Classes

Puppy, Dogs
6 months & under 9 months
9 months & under 12 months
Twelve to Eighteen Month, Dogs
*Novice, Dogs
**Amateur-Owner-Handler, Dogs
Bred-by-Exhibitor, Dogs
American-bred, Dogs
Open, Dogs
WINNERS, DOG

Puppy, Bitches
6 months & under 9 months
9 months & under 12 months
Twelve to Eighteen Month, Bitches
*Novice, Bitches
**Amateur-Owner-Handler, Bitches
Bred-by-Exhibitor, Bitches
American-bred, Bitches
Open, Bitches
WINNERS, BITCH

*Novice Classes are not offered at the Boxer Specialties on Friday & Saturday, Boston Terrier Specialties on Friday, Shetland Sheepdog Specialties on Friday & All Breed Shows

**Amateur-Owner-Handler Classes are not offered at the Boxer Specialties on Friday, Boxer Concurrent Specialty on Saturday, Boston Terrier Specialties on Friday, Borzoi Concurrent Specialties on Saturday & Sunday & Shetland Sheepdog Specialties on Friday

The above classification is provided for all breeds (and varieties). Additional divisions, i.e. (age, color or weight) are in the breed list and must be indicated on the entry.

OPEN CLASS DIVISIONS

DACHSHUNDS (ALL THREE VARIETIES): Miniature - 11 lbs & under & 12 mos old or over; Standard - Over 11 lbs & 11 lbs & under if less than 12 mos old

BOXERS: Brindle; Fawn

DOBERMAN PINSCHERS: Black; AOAC

GIANT SCHNAUZERS: Black; Pepper & Salt

GREAT DANES: Black; Blue; Brindle; Fawn; Harlequin; Mantle, Merle

BOSTON TERRIERS: Under 15 lbs; 15 lbs & over

CHINESE SHAR-PEI: Brushcoat; Horsecot

AUSTRALIAN SHEPHERDS: Blue Merle; Black; Red Merle; Red

COLLIES (ROUGH): Blue Merle; Sable & White; Tri-Color; White

SHETLAND SHEEPDOGS: Sable & White; AOAC

FOR GERMAN WIREHAired POINTER SPECIALTY ON FRIDAY & SATURDAY, BORZOI CONCURRENT SPECIALTIES ON SATURDAY & SUNDAY, BOXER SPECIALTIES FRIDAY & SATURDAY, BOSTON TERRIER SPECIALTIES ON FRIDAY & SHETLAND SHEEPDOG SPECIALTIES ON FRIDAY

NON-REGULAR (ADDITIONAL) CLASSES Involving Single Dog Entries

*VETERAN DOG CLASS - A Class for Dogs seven (7) years or older.

*VETERAN BITCH CLASS - A Class for Bitches seven (7) years or older.

*GERMAN WIREHAired POINTERS - Seven (7) years & under Ten (10) years; Ten (10) years & Older

*BOXERS - Six (6) years or older

FOR GERMAN WIREHAired POINTER SPECIALTY ON FRIDAY & SATURDAY FIELD DOG/BITCH - Open to German Wirehaired Pointers on Friday Only.

Open to any dog or bitch with an AKC Hunt Test or Field Trial Title, Field Dog/Bitch must be intact. Winner, if otherwise undefeated, are eligible for Best of Breed competition

NEUTERED DOGS & SPAYED BITCHES MAY COMPETE IN VETERAN CLASSES AT THESE SPECIALTIES

FOR GERMAN WIREHAired POINTER SPECIALTY & BORZOI CONCURRENT SPECIALTIES

NON-REGULAR (ADDITIONAL CLASSES) Involving Multiple Dog Entries

As the judge's decision in the Non-Regular Classes involving Multiple Dog Entries is based on the merits of more than one dog or bitch, no one of the dogs or bitches making up the entry judged first in these classes will be eligible to compete for Best of Breed by virtue of having won these classes.

STUD DOG CLASS - For Stud Dogs and two of their Get. It is not necessary that the Get be under the same ownership as that of the Stud Dog. The Stud Dog may be entered separately in one of the regular classes, or if a Champion of Record in Best of Breed Competition, but **MUST** be entered in the Stud Dog Class, the Get **MUST** be entered in one of the regular classes. The Stud Dog shall be considered as one entry and requires one entry fee, this being the regular fee plus the additional class fee if the Stud Dog is entered in another class. The Stud Dog must be shown in the ring with the Get. The class will be judged on the merits of the Get.

BROOD BITCH CLASS - Same as for the Stud Dog except substitute Brood Bitch for Stud Dog and Produce for Get.

FOR GREATER OMAHA TERRIER ASSOCIATION

VETERAN • SPECIAL ATTRACTION

BREED • GROUP

Competition is offered for dogs & bitches 7 years & older (combined sexes) from Best of Breed through Veteran Variety Group. Neutered dogs & spayed bitches are eligible to compete. Veteran Variety Group will be held.

Beginner Puppies (4-6 months of age) **AKC Sanctioned Beginner Puppy Competition!**

ALL BREED SHOW - SATURDAY

All BREED JUDGE: Laura Reeves

Section 1- Classifications

The Four-to-Six Month Puppy competition shall be for dogs that are four months of age and over but under six months on the day of the event.

Section 2 – Entry and Eligibility

Entry and eligibility requirements include:

- The Four-to-Six Month Puppy event may be offered at licensed or member dog shows at the option of the show giving club.
- Four-to-Six Month Puppy Competition must be listed in the premium list, entry form and judging schedule, if offered.
- AKC registration number or an AKC litter number will be required for all entries.
- A foreign born dog may enter this class if they are registered in the country of origin.
- All entrants are to be vaccinated (including rabies) in accordance with their veterinarian's protocol.
- Professional handlers, members of their household and current assistants to professional handlers may not personally exhibit dogs in the Four-to-Six Month (Beginner Puppy) Competition. Dogs that are owned or co-owned by the forenamed may compete in this competition but must be handled by a non-professional handler. Professional handlers are defined as any person who belongs or has belonged to a professional handlers' organization, distributed rate cards, or otherwise advertised or represented themselves as handling dogs for pay within the last five years.
- Minors (under 18) with amateur status who reside with professional handlers and current assistants to professional handlers that are eligible to compete in Junior Showmanship (meet age and amateur status requirements) may personally exhibit dogs in the Four-to-Six Month Beginner Puppy Competition.

Entries will close Wednesday Noon, September 20, 2023 at Superintendent's office.

SHOW VETERINARIANS

TOMORROW'S VETERINARY CARE

(ON CALL) • (402) 786-2600
14110 Kenilworth Ave, Waverly NE 68462

Friday - 8:00 am to 6:00 pm

Saturday - 9:00 am to 5:00 pm

Sunday - CLOSED

EMERGENCY VET

(ON CALL AFTER HOURS)
3700 S 9th St, Suite M Lincoln NE 68502
(402) 489-6800

DIRECTIONS TO TOMORROW'S VETERINARY CARE: Drive North (right) on 84th Street to Hwy 6 (Cornhusker Hwy). Turn East (right) and continue to Waverly. Turn North (left) at 141st street (at the light). Continue 2 blocks to the clinic on the Northeast corner

DIRECTIONS TO EMERGENCY VET SERVICE OF LINCOLN: Take 84th Street South to A Street (about 4 miles). Turn right (West) to 9th Street. Turn left (South) onto 9th Street & go 3 miles to Pioneer Blvd. Turn right & go 1 block, turn right, (North) and the emergency vet clinic is at the end of the strip mall.

JUDGES

Mrs Eva E Berg - 136 Longfield Pl, Moraga CA 94556

Mr Kenneth E Berg - 136 Longfield Pl, Moraga CA 94556

Mr James E Frederiksen - 2110 Bob Carnes Ln, Knoxville TN 37924

Mr Duff M Harris - 16583 Yucca Cir, Fountain Valley CA 92705

Mrs Robin A Hug* - PO Box 891, Conifer CO 80433

Mr Robert E Hutton* - 216 W Kenwood Dr, Louisville KY 40214

Mrs Laura Myles* - 21526 W Lost Lake Rd, Snohomish WA 98296

Ms Patricia A Nevins - 5155 Balmoral Ln S, Bloomington MN 55437

Mr James E Noe - 2110 Bob Carnes Ln, Knoxville TN 37924

Laura Reeves* - 7185 Redwood Hwy, Grants Pass OR 97527

** One or more breed assigned approved as provisional/permit by AKC*

VARIETY GROUP JUDGES

GREATER OMAHA TERRIER ASSN +ALLBREED O&R-FRIDAY

Mr Duff M Harris • Terrier Group

CORNHUSKER KC OF LINCOLN NE, INC. (1)-SATURDAY

Mr James E Noe • Sporting Group

Mrs Eva E Berg • Hound Group

Mr Robert E Hutton • Working Group

Mr Kenneth E Berg • Terrier Group

Mr Kenneth E Berg • Toy Group

Mr Robert E Hutton • Non-Sporting Group

Mrs Eva E Berg • Herding Group

Mr James E Frederiksen • Best In Show

OWNER-HANDLED VARIETY GROUPS (1)-SATURDAY

Mrs Laura Myles • Sporting Group

Mrs Robin A Hug • Hound Group

Mrs Robin A Hug • Working Group

Mr Robert E Hutton • Terrier Group

Mr James E Noe • Toy Group

Mr James E Noe • Non-Sporting Group

Mr James E Frederiksen • Herding Group

Laura Reeves • Best In Show

CORNHUSKER KC OF LINCOLN NE, INC. (2)-SUNDAY

- Mr Robert E Hutton* • Sporting Group
- Mr James E Frederiksen • Hound Group
- Mr James E Noe • Working Group
- Mr Robert E Hutton • Terrier Group
- Mr James E Frederiksen • Toy Group
- Mr Kenneth E Berg • Non-Sporting Group
- Mr James E Noe • Herding Group
- Mrs Eva E Berg • Best In Show

OWNER-HANDLED VARIETY GROUPS (2)-SUNDAY

- Laura Reeves • Sporting Group
- Laura Reeves • Hound Group
- Laura Reeves • Working Group
- Laura Reeves • Terrier Group
- Laura Reeves • Toy Group
- Mr Robert E Hutton • Non-Sporting Group
- Mrs Robin A Hug • Herding Group
- Mrs Laura Myles • Best In Show

JUDGING ASSIGNMENTS

SPORTING BREEDS	CORH1-(Sat)	CORH2-(Sun)
Barbet	J E Noe	R E Hutton*
Bracchi Italiani	J E Noe	R E Hutton*
Brittany	L Reeves	R E Hutton
Lagotti Romagnoli	L Reeves*	R E Hutton*
Nederlandse Kooikerhondjes	J E Noe	R E Hutton*
Pointers	J E Noe	R E Hutton
Pointers (German Shorthaired)	L Reeves	L Myles
Pointers (German Wirehaired)	E E Berg	R E Hutton*
Retrievers (Chesapeake Bay)	J E Noe	R E Hutton*
Retrievers (Curly-Coated)	J E Noe	R E Hutton*
Retrievers (Flat-Coated)	J E Noe	R E Hutton*
Retrievers (Golden)	L Reeves*	R E Hutton
Retrievers (Labrador)	R E Hutton*	J E Noe
Retrievers (Nova Scotia Duck Tolling)	L Reeves*	R E Hutton*
Setters (English)	L Reeves*	L Myles*
Setters (Gordon)	R E Hutton*	L Myles
Setters (Irish)	L Reeves*	R E Hutton*
Setters (Irish Red And White)	R E Hutton*	L Myles*
Spaniels (American Water)	J E Noe	R E Hutton*
Spaniels (Boykin)	J E Noe	R E Hutton*
Spaniels (Cumber)	L Reeves	R E Hutton*
Spaniels (Cocker) Black	L Reeves*	R E Hutton
Spaniels (Cocker) Ascob	L Reeves*	R E Hutton
Spaniels (Cocker) Parti-Color	L Reeves*	R E Hutton
Spaniels (English Cocker)	J E Noe	R E Hutton*
Spaniels (English Springer)	J E Noe	R E Hutton
Spaniels (Field)	L Reeves*	R E Hutton*
Spaniels (Irish Water)	L Reeves*	R E Hutton*
Spaniels (Sussex)	L Reeves	R E Hutton*
Spaniels (Welsh Springer)	J E Noe	R E Hutton*
Spinoni Italiani	R E Hutton*	L Myles*
Vizslas	L Reeves	R E Hutton
Weimaraners	L Reeves*	R E Hutton*
Wirehaired Pointing Griffons	J E Noe	R E Hutton*
Wirehaired Vizslas	J E Noe	R E Hutton*
HOUD BREEDS	CORH1-(Sat)	CORH2-(Sun)
Afghan Hounds	J E Frederiksen	E E Berg
American English Coonhounds	J E Frederiksen	E E Berg
American Foxhounds	J E Frederiksen	E E Berg
Azawakhs	J E Frederiksen	R A Hug*
Basenjis	J E Frederiksen	E E Berg
Basset Hounds	J E Frederiksen	E E Berg
Beagles (13 Inch)	J E Frederiksen	E E Berg
Beagles (15 Inch)	J E Frederiksen	E E Berg
Black & Tan Coonhounds	J E Frederiksen	R A Hug*
Bloodhounds	J E Frederiksen	E E Berg
Bluetick Coonhounds	J E Frederiksen	E E Berg
Borzoi	J E Frederiksen	E E Berg
Cirneci dell'Etna	J E Frederiksen	E E Berg
Dachshunds (Longhaired)	J E Frederiksen	R E Hutton

Dachshunds (Smooth)	J E Frederiksen	R E Hutton	
Dachshunds (Wirehaired)	J E Frederiksen	R E Hutton	
English Foxhounds	J E Frederiksen	E E Berg	
Grand Basset Griffon Vendeens	J E Frederiksen	R A Hug*	
Greyhounds	J E Frederiksen	R A Hug*	
Harriers	J E Frederiksen	E E Berg	
Ibizan Hounds	L Reeves	E E Berg	
Irish Wolfhounds	L Reeves	R A Hug*	
Norwegian Elkhounds	J E Frederiksen	E E Berg	
Otterhounds	J E Frederiksen	R A Hug*	
Petits Bassets Griffons Vendeens	J E Frederiksen	E E Berg	
Pharaoh Hounds	J E Frederiksen	R A Hug*	
Plott Hounds	J E Frederiksen	E E Berg	
Portuguese Podengo Pequenos	J E Frederiksen	R A Hug*	
Redbone Coonhounds	J E Frederiksen	E E Berg	
Rhodesian Ridgebacks	L Reeves	E E Berg	
Salukis	J E Frederiksen	E E Berg	
Scottish Deerhounds	J E Frederiksen	E E Berg	
Sloughis	J E Frederiksen	E E Berg	
Treeing Walker Coonhounds	J E Frederiksen	E E Berg	
Whippets	J E Frederiksen	E E Berg	
WORKING BREEDS	CORH1-(SAT)	CORH2-(SUN)	
Akitas	L Reeves	J E Noe	
Alaskan Malamutes	E E Berg	J E Noe	
Anatolian Shepherd Dogs	E E Berg	J E Noe	
Bernese Mountain Dogs	E E Berg	J E Noe	
Black Russian Terriers	E E Berg	J E Noe	
Boerboels	E E Berg	J E Noe	
Boxers	E E Berg	J E Noe	
Bullmastiffs	E E Berg	J E Noe	
Cane Corso	E E Berg	J E Noe	
Chinooks	E E Berg	J E Noe	
Doberman Pinschers	E E Berg	J E Noe	
Dogo Argentinos	E E Berg	J E Noe	
Dogues de Bordeaux	E E Berg	J E Noe	
German Pinschers	E E Berg	J E Noe	
Giant Schnauzers	E E Berg	J E Noe	
Great Danes	E E Berg	J E Noe	
Great Pyrenees	E E Berg	J E Noe	
Greater Swiss Mountain Dogs	E E Berg	J E Noe	
Komondorok	E E Berg	J E Noe	
Kuvaszok	E E Berg	J E Noe	
Leonbergers	E E Berg	J E Noe	
Mastiffs	E E Berg	J E Noe	
Neapolitan Mastiffs	E E Berg	J E Noe	
Newfoundlands	E E Berg	J E Noe	
Portuguese Water Dogs	E E Berg	J E Frederiksen	
Rottweilers	E E Berg	J E Noe	
Saint Bernards	L Reeves*	J E Frederiksen	
Samoyeds	E E Berg	J E Frederiksen	
Siberian Huskies	E E Berg	J E Frederiksen	
Standard Schnauzers	E E Berg	J E Frederiksen	
Tibetan Mastiffs	E E Berg	J E Frederiksen	
TERRIER BREEDS	GOTA1-(Fri)	CORH1-(SAT)	CORH2-(SUN)
Airedale Terriers	DM Harris	R E Hutton	KE Berg
American Hairless Terriers	DM Harris	R E Hutton	KE Berg
American Staffordshire Terriers	DM Harris	R E Hutton	KE Berg
Australian Terriers	DM Harris	R E Hutton	KE Berg
Bedlington Terriers	DM Harris	R E Hutton	KE Berg
Border Terriers	DM Harris	R E Hutton	KE Berg
Bull Terriers (Colored)	DM Harris	R E Hutton	KE Berg
Bull Terriers (White)	DM Harris	R E Hutton	KE Berg
Cairn Terriers	DM Harris	R E Hutton	KE Berg
Cesky Terriers	DM Harris	R E Hutton	KE Berg
Dandie Dinmont Terriers	DM Harris	R E Hutton	KE Berg
Fox Terriers (Smooth)	DM Harris	R E Hutton	KE Berg
Fox Terriers (Wire)	DM Harris	R E Hutton	KE Berg
Glen of Imaal Terriers	DM Harris	R E Hutton	KE Berg
Irish Terriers	DM Harris	R E Hutton	KE Berg
Kerry Blue Terriers	DM Harris	R E Hutton	KE Berg
Lakeland Terriers	DM Harris	R E Hutton	KE Berg
Manchester Terriers (Standard)	DM Harris	R E Hutton	L Reeves*
Miniature Bull Terriers	DM Harris	R E Hutton	KE Berg
Miniature Schnauzers	DM Harris	R E Hutton	KE Berg
Norfolk Terriers	DM Harris	R E Hutton	KE Berg
Norwich Terriers	DM Harris	R E Hutton	KE Berg
Parson Russell Terriers	DM Harris	R E Hutton	KE Berg

Rat Terriers	D M Harris	R E Hutton	K E Berg
Russell Terriers	D M Harris	R E Hutton	K E Berg
Scottish Terriers	D M Harris	R E Hutton	K E Berg
Sealyham Terriers	D M Harris	R E Hutton	K E Berg
Skye Terriers	D M Harris	R E Hutton	K E Berg
Soft Coated Wheaten Terriers	D M Harris	R E Hutton	K E Berg
Staffordshire Bull Terriers	D M Harris	R E Hutton	K E Berg
Welsh Terriers	D M Harris	R E Hutton	K E Berg
West Highland White Terriers	D M Harris	R E Hutton	K E Berg
TOY BREEDS		CORH1-(Sat)	CORH2-(Sun)
Affenpinschers		K E Berg	J E Frederiksen
Biewer Terriers		K E Berg	J E Frederiksen
Brussels Griffons		K E Berg	J E Frederiksen
Cavalier King Charles Spaniels		K E Berg	J E Frederiksen
Chihuahuas (Long Coat)		K E Berg	J E Frederiksen
Chihuahuas (Smooth Coat)		K E Berg	J E Frederiksen
Chinese Cresteds		K E Berg	J E Frederiksen
English Toy Spaniels (B & P C)		K E Berg	J E Frederiksen
English Toy Spaniels (K C & R)		K E Berg	J E Frederiksen
Havanese		K E Berg	J E Frederiksen
Italian Greyhounds		K E Berg	J E Frederiksen
Japanese Chin		K E Berg	J E Frederiksen
Maltese		K E Berg	J E Frederiksen
Manchester Terriers (Toy)		L Reeves*	J E Frederiksen
Miniature Pinschers		K E Berg	J E Frederiksen
Papillons		K E Berg	J E Frederiksen
Pekingese		K E Berg	J E Frederiksen
Pomeranians		K E Berg	J E Frederiksen
Poodles (Toy)		K E Berg	J E Noe
Pugs		L Reeves	K E Berg
Russian Toys		K E Berg	J E Frederiksen
Shih Tzu		K E Berg	J E Frederiksen
Silky Terriers		K E Berg	J E Frederiksen
Toy Fox Terriers		K E Berg	J E Frederiksen
Yorkshire Terriers		K E Berg	J E Frederiksen
NON-SPORTING BREEDS		CORH1-(Sat)	CORH2-(Sun)
American Eskimo Dogs		R E Hutton	K E Berg
Bichons Frises		R E Hutton	K E Berg
Boston Terriers		J E Frederiksen	K E Berg
Bulldogs		R E Hutton	K E Berg
Chinese Shar-Pei		R E Hutton	K E Berg
Chow Chows		R E Hutton	K E Berg
Coton de Tulear		R E Hutton	K E Berg
Dalmatians		R E Hutton	K E Berg
Finnish Spitz		R E Hutton	K E Berg
French Bulldogs		R E Hutton	K E Berg
Keeshonden		R E Hutton	K E Berg
Lhasa Apsos		R E Hutton	K E Berg
Lowchen		R E Hutton	K E Berg
Norwegian Lundehunds		R E Hutton	K E Berg
Poodles (Miniature)		R E Hutton	K E Berg
Poodles (Standard)		R E Hutton	K E Berg
Schipperkes		R E Hutton	K E Berg
Shiba Inu		R E Hutton	K E Berg
Tibetan Spaniels		R E Hutton	K E Berg
Tibetan Terriers		R E Hutton	K E Berg
Xoloitzcuintli		R E Hutton	K E Berg
HERDING BREEDS		CORH1-(Sat)	CORH2-(Sun)
Australian Cattle Dogs		J E Noe	R A Hug*
Australian Shepherds		J E Noe	J E Frederiksen
Bearded Collies		J E Noe	E E Berg
Beaucerons		J E Noe	E E Berg
Belgian Laekenois		J E Noe	E E Berg
Belgian Malinois		J E Noe	E E Berg
Belgian Sheepdogs		J E Noe	E E Berg
Belgian Tervuren		J E Noe	E E Berg
Bergamasco Sheepdogs		J E Noe	E E Berg
Berger Picards		J E Noe	R A Hug*
Border Collies		J E Noe	E E Berg
Bouvier des Flandres		J E Noe	R A Hug*
Briards		J E Noe	R A Hug*
Canaan Dogs		J E Noe	E E Berg
Cardigan Welsh Corgis		J E Noe	E E Berg
Collies (Rough)		J E Frederiksen	J E Noe
Collies (Smooth)		J E Frederiksen	J E Noe

Entlebucher Mountain Dogs	J E Noe	E E Berg
Finnish Lapphunds	J E Noe	E E Berg
German Shepherd Dogs	J E Noe	E E Berg
Icelandic Sheepdogs	J E Noe	E E Berg
Miniature American Shepherds	J E Noe	E E Berg
Mudik	J E Noe	E E Berg
Norwegian Buhunds	J E Noe	R A Hug*
Old English Sheepdogs	J E Noe	E E Berg
Pembroke Welsh Corgis	J E Noe	E E Berg
Polish Lowland Sheepdogs	J E Noe	E E Berg
Pulik	J E Noe	R A Hug*
Pumik	J E Noe	R A Hug*
Pyrenean Shepherds	J E Noe	E E Berg
Shetland Sheepdogs	J E Frederiksen	E E Berg
Spanish Water Dogs	J E Noe	E E Berg
Swedish Vallhunds	J E Noe	E E Berg

MISC CLASS	CORH1-(Sat)	CORH2-(Sun)
------------	-------------	-------------

Basset Fauve de Bretagne, Danish-Swedish Farm Dogs, Dutch Shepherds, Japanese Akitainu, Kai Kens, Lancashire Heelers, Norrbottenspets, Peruvian Inca Orchids, Portuguese Podengo, Russian Tsvetnaya Bolonka, Small Munsterlander & Teddy Roosevelt Terriers.

There will be Puppy (6 months & under 9 months and 9 months & under 12 months), Bred-By-Exhibitor and Open Classes for each of the Miscellaneous Breeds in each sex.

J E Noe K E Berg

SEE OPEN SHOW INFORMATION ON PAGE 15

OBEDIENCE CLASSES	GOTA1-(Fri)	CORH1-(Sat)	CORH2-(Sun)
Novice A Class	P A Nevins	P A Nevins	P A Nevins
Novice B Class	P A Nevins	P A Nevins	P A Nevins
Open A Class	P A Nevins	P A Nevins	P A Nevins
Open B Class	P A Nevins	P A Nevins	P A Nevins
Utility A Class	P A Nevins	P A Nevins	P A Nevins
Utility B Class	P A Nevins	P A Nevins	P A Nevins
UDX	NO CLASSES		
Preferred Novice Class	P A Nevins	P A Nevins	P A Nevins
Preferred Open Class	P A Nevins	P A Nevins	P A Nevins
Preferred Utility Class	P A Nevins	P A Nevins	P A Nevins
Preferred UDX	NO CLASSES		
Beginner Novice A Class	P A Nevins	P A Nevins	P A Nevins
Beginner Novice B Class	P A Nevins	P A Nevins	P A Nevins
Graduate Novice Class	P A Nevins	P A Nevins	P A Nevins
Graduate Open Class	P A Nevins	P A Nevins	P A Nevins
Versatility Class	P A Nevins	P A Nevins	P A Nevins
RALLY CLASSES	GOTA1-(Fri)	CORH1-(Sat)	CORH2-(Sun)
Rally Novice A	P A Nevins	P A Nevins	P A Nevins
Rally Novice B	P A Nevins	P A Nevins	P A Nevins
Rally Intermediate	P A Nevins	P A Nevins	P A Nevins
Rally Advanced A	P A Nevins	P A Nevins	P A Nevins
Rally Advanced B	P A Nevins	P A Nevins	P A Nevins
Rally Excellent A	P A Nevins	P A Nevins	P A Nevins
Rally Excellent B	P A Nevins	P A Nevins	P A Nevins
Rally Master	P A Nevins	P A Nevins	P A Nevins
Rally Choice	P A Nevins	P A Nevins	P A Nevins
RAE	NO CLASSES		
RACH	NO CLASSES		
JUNIOR SHOWMANSHIP		CORH1-(Sat)	CORH2-(Sun)

L Myles L Reeves

ATTENTION EXHIBITORS

The Show Site will be available to exhibitors at 6:00 am on Friday or when grooming set up is complete. **THERE WILL BE NO ACCESS TO THE BUILDING ON THURSDAY, NO EXCEPTIONS**

On Saturday & Sunday the Show Site will be available at 6:00 am. Dogs must be removed from the show site immediately following Best in Show judging on Sunday. The building will be locked at 11:00 pm Friday & Saturday nights.

Dogs may be left in the building overnight, but you **MUST** have your dogs name, your name and phone number on every crate that has a dog in it. A club member will be in the non-electrical parking with a key to the building in case of an emergency.

If your dog eliminates in the ring, you will be provided with the necessities to clean it up.

The Show Committee has the right to limit grooming equipment & stack crates if it becomes necessary.

It is recommended that proof of current rabies vaccination be in the possession of exhibitors or handlers for all dogs at these shows.

EXHIBITORS MUST PICK UP AFTER THEIR DOGS.

NO WASHING DOGS OR DOG BOWLS IN RESTROOMS. ABSOLUTELY NO DOGS ALLOWED IN RESTROOMS.

THERE IS NO ROPING OFF OF AREAS, ROPES WILL BE REMOVED. NO UNENTERED DOGS ALLOWED IN THE BUILDING.

Public exercise pens will be available.

NO EXERCISE PENS OR COCKER PENS INSIDE PAVILION 1.

It is recommended that dogs in crates not be left unattended.

The public address system will be used at the discretion of the show-giving clubs. Exhibitors are responsible for having their dogs at ringside for judging.

Exhibitors should be aware of recently reported attempts by animal rights groups to open crates and release dogs at dog shows. Dogs should not be left unattended at any time.

Every attempt will be made to keep the show site and all exhibitors' possessions secure; however, the show-giving club, their officials, members or agents are not responsible for any loss or damage to equipment or animals left in the auditorium at any time.

Loading & unloading will be restricted.

Exhibitors and handlers will be responsible for clean conditions around their grooming/cratering areas.

Crating and grooming allowed in designated areas only. NO ELECTRICAL ACCESS IN THE FREE GROOMING. IF YOU DO PLUG IN, YOU WILL BE CHARGED THE \$90.00 FEE THAT THE CLUB HAS TO PAY. IF YOU NEED ELECTRICITY FOR GROOMING, PLEASE GET RESERVED GROOMING.

Ringside Crating may be setup in Exhibitor aisle as space allows, 15 minutes prior to ring time & must be removed immediately upon completion of judging.

This is a NON-SMOKING FACILITY according to federal & state regulations. A FINE can be imposed if in violation. **THIS WILL BE MONITORED.**

The Cornhusker Kennel Club of Lincoln, Nebraska, Inc. & the Borzoi Club of Greater Omaha do not agree to arbitrate claims as set forth on the Official AKC entry form for these events.

The following breeds may be judged on the ground or on a ramp: Lagotti Romagnoli, Nova Scotia Duck Tolling Retrievers, American Water Spaniels, Boykin Spaniels, English Springer Spaniels, Field Spaniels, Welsh Springer Spaniels, Grand Basset Griffon Vendeens, Whippets, German Pinschers, Standard Schnauzers, American Staffordshire Terriers, Irish Terriers, Soft Coated Wheaten Terriers, Staffordshire Bull Terriers, Finnish Spitz, Entlebucher Mountain Dogs, Finnish Lapphunds, Icelandic Sheepdogs, Norwegian Buhunds, Polish Lowland Sheepdogs, Spanish Water Dogs and Norrbottenspets (Misc).

The following breed may be judged on the ground, a ramp, or on a table: Miniature Bull Terriers.

The following breed may be judged on a ramp or on a table: Mudi

The following breeds must be judged on a ramp through all levels of conformation competition: Clumber Spaniels, Sussex Spaniels, Basset Hounds, Cirneco dell'Etna, Kerry Blue Terriers, Bulldogs, Chinese Shar-Pei, Chow Chows and Keeshonden.

PUBLICATION RIGHTS: By entering this show, all owners, handlers, breeders and kennels agree that all rights to televise, videotape, photograph, advertise, promote and publicize or otherwise exploit this show, or the persons or animals participating in it or the results of the competition before, during or after the event, shall belong solely to The American Kennel Club and their respective assigns, including the use of the names, likenesses or biographical matter of all dogs, owners, handlers, breeders and kennels participating in the show and no such owner, handler, breeder or kennel shall allow any other party to make commercial use of any videotape or photograph of any person or animal participating in this competition.

NEW EXHIBITOR BRIEFING on Saturday. Check Judging Program for time & location.

A Recording Fee of 50 cents for each dog and an AKC Event Service Fee of \$3.00 will be required for each recordable single entry class at any Licensed or Member Club Show or Obedience Trial. (American Kennel Club Rule, Chapter 11, Section 2). An AKC Recording Fee of \$3.50 1st Entry & \$3.00 additional entry of same dog will be required for each entry in Rally. (American Kennel Club Rally Regulation, Chapter 1, Section 4) These Fees are paid to the American Kennel Club.

CANADIAN/FOREIGN EXHIBITORS MUST SUBMIT ENTRIES WITH CHECKS DRAWN ON U.S. ACCOUNTS OR WITH INTERNATIONAL MONEY ORDERS IN U.S. FUNDS.

Entries received prior to the published opening date and time of entries or received prior to the publishing of this premium list will be returned without processing.

A service/processing fee of \$7.00 will be charged to each duplicate entry.

Dogs need be present only for scheduled judging and will be released if not needed for further judging.

Dogs allowed in rings during judging only.

Dogs must be ready for judging. Neither the club nor its Superintendents will be responsible or obligated to furnish any service for notifying exhibitors or their agents of Breed or Class Judging. Judges need not wait for any dog holding up a class. **Owners or agents alone are responsible for the presence of their dogs in the judging rings.**

The Club reserves the right to substitute a prize of equal or greater value.

All trophies must be claimed the day of the show - None will be mailed.

All checks issued as prizes are the sole responsibility of the recipient. Lost, stolen and/or misplaced checks will not be replaced. Checks are valid for 90 days. The Superintendent is not able to checks nor will they be accepted toward entry fees.

RETURNED CHECKS/DECLINED CREDIT/DEBIT CARDS do not constitute a valid entry fee. Fees must be paid in guaranteed funds. Checks will not be accepted. The Superintendent will add a fee for completing the transaction and/or reprocessing the entries. Repeated occurrences from the same exhibitors may result in their being put on a **ONLY** basis.

Entry Fee will not be refunded in the event that a dog is absent, disqualified, excused by Veterinarian or judge or barred from competition by action of the Show Committee.

Exhibitors should follow their veterinarian's recommendation to assure their dogs are free of internal and external parasites, any communicable diseases and have appropriate vaccinations.

No entry fees will be refunded if the Show cannot open or be completed by reason of riots, civil disturbances, fire, extreme and/or dangerous weather conditions, an Act of God, public emergency, act of a public enemy, strikes or any other cause beyond the control of the Club or the Superintendent.

The show giving Club, the Show Superintendent, their agents, employees, etc, assume no responsibility for any loss, damage or injury sustained by exhibitors, handlers, or to any of their dogs or property and further assume no responsibility for injury to children.

No entry shall be made and no entry shall be accepted which specifies any condition as to its acceptance. Entries will not be accepted without fees, signatures or the "Agreement" on the reverse side of the Official AKC Entry Form.

Changes, additions or corrections to entry forms must be received in writing prior to close of entries. Those received by telephone are not acceptable.

Refunds of \$4.00 & less will not be issued due to the costs of processing.

An administrative fee of \$2.50 will be charged for all cancellations or changes made prior to closing of entries.

EXHIBITORS NOTE: Please notify Superintendent of any change of address.

Each Entry processed through Jack Onofrio Dog Shows Telephone Entry Service or Onofrio Online Entry will have a service fee included in the amount charged to the payment card provided. Each user of either service acknowledges they are authorized to charge fees to the card provided for payment and further acknowledges the transaction is made over the phone or internet. Chargebacks on cards are a violation of the agreement to pay all fees included in this premium list and can result in the club refusing future entries from the exhibitor, refusal of entries from the exhibitor by the superintendent until the debt has been paid and/or being placed on a only basis with the superintendent.

FAX/EMAIL ENTRIES AND PAPER ENTRIES WITH CREDIT CARD ARE NOT ACCEPTABLE METHODS FOR ENTRIES AND WILL NOT BE PROCESSED. Online Entries and Checks by Mail are not affected by this change. If mailing be sure to have the entry with check enclosed arrive prior to the closing date of the show. Please note all entries received via fax or email and/or paper entries with credit card information will be shredded/deleted immediately upon delivery without processing. With credit card security and identity theft concerns we are implementing this change to protect your information from potential abuse. Entry forms are occasionally viewed by others outside of the staff of the Superintendent. We will always be happy to accept entries with payment by check at any of our shows. Stop by and say hello.

Jack Onofrio Dog Shows Telephone Entry Service phone number (405) 427-0405 or toll free (888) 421-0405: This is for Telephone Entry Service ONLY. For Mastercard/Discover/Visa/American Express cardholders. A \$4.75 charge will be added to each entry for use of this service. Mon, Tues, Thurs & Fri 8:00 am to 4:30 pm; Wed 8:00 am to 12:00 noon.

Onofrio Online Entry at www.onofrio.com for entries made with Mastercard/Discover/Visa/American Express. A **nonrefundable** \$2.95 charge will be added to each entry for use of this service.

Special Delivery & Overnight Delivery Mail Address: 3401 NE 23rd St, Oklahoma City, Oklahoma 73121-2447 FOR SPECIAL & OVERNIGHT DELIVERY MAIL ONLY!

OPEN SHOWS

ALL MISCELLANEOUS & FSS BREEDS

SPONSORED BY THE CORNHUSKER KENNEL CLUB OF LINCOLN, NEBRASKA, INC.

SATURDAY, OCTOBER 7, 2023

SUNDAY, OCTOBER 8, 2023

An Open Show is an informal American Kennel Club sanctioned* conformation event where Championship points are not earned but rather Certificate of Merit (CM) points are awarded to this introductory AKC conformation suffix title. Judged by AKC judges.

Professional handlers are not permitted to exhibit in Open Shows. Professional handlers are defined as any person who belongs or has belonged to a professional handlers' organization, distributed rate cards, or otherwise advertised or represented themselves as handling dogs for pay within the last five years.

Entries Close September 20, 2023

Send entries to Jack Onofrio Dog Shows, L.L.C.

CLASSIFICATION

The following breed classes will be offered for both dogs & bitches at all Open Shows:

**4-6 Month Puppy Class • 6-9 Month Puppy Class
9-12 Month Puppy Class • Bred-by-Exhibitor Class • Open Class
Miscellaneous AND Foundations Stock Service (FSS) breeds
will be considered equivalent to a Group.**

JUDGES

Saturday - Laura Reeves

Sunday - Mrs Laura Myles

SATURDAY & SUNDAY PRIZES

The Cornhusker Kennel Club of Lincoln, Nebraska offers a Rosette for Best in Open Show & First, Second, Third & Fourth in Each Group.

SATURDAY

BEST IN OPEN SHOW

\$20.00 VENDOR COUPON

Offered by Tomorrow's Vet Care

SUNDAY

BEST IN OPEN SHOW

\$20.00 PETCO GIFT CARD

Offered by Tomorrow's Vet Care

HOTELS & MOTELS THAT WILL ACCEPT DOGS

SOME GROUP RATES ARE ONLY GOOD UNTIL THE FIRST OF SEPTEMBER. PLEASE ASK FOR THE HUSKER VALLEY CLUSTER OR DOG SHOW.

Use the phone numbers listed, online reservations does not have the same information.

★★★ MAKE HOTEL/MOTEL RESERVATIONS EARLY ★★★

America's Best Value Inn	(402) 464-5971
5600 Cornhusker Hwy, Lincoln NE 68507 • Flat \$25.00 pet fee for 1-4 nights	
America's Best Value Inn	(402) 475-3211
3001 NW 12th St, Lincoln NE 68521, 1-80, Exit #399 • Flat \$25.00 pet fee for 1-4 nights	
Candlewood Suites	(402) 420-0330
4100 Pioneer Woods Dr, Lincoln NE 68506 • Pet Fee \$25.00 for 1 night \$50 for 2-3 nights	
Comfort Inn Airport	(402) 474-1417
1010 S Bond St, Lincoln NE 68521 • Flat \$25.00 pet fee 1-3 nights • 2 dog limit	
Comfort Suites	(402) 325-8800
331 N Cotner Blvd, Lincoln NE 68505	
Flat \$20.00 pet fee for 1-4 nights 2 dog limit & 30lb dog limit	
Comfort Suites of Lincoln	(402) 476-8080
4231 Industrial Ave, Lincoln NE 68504 • Flat \$10.00 pet fee for 1-4 nights	
Microtel	(402) 476-2591
2505 Fairfield, Lincoln NE 68521 • No pet fee for the dog show	
StayBridge Suites	(402) 438-7829
2700 Fletcher Ave, Lincoln NE 68504 • Flat \$25.00 pet fee for 1-4 nights	
StayBridge Suites Lincoln Northeast	(402) 484-6000
1501 N 86th St, Lincoln NE 68504 • Flat \$25.00 pet fee for 1-4 nights	
Motel 6	(402) 438-4700
6501 N 28th, Lincoln NE 68504 • No Pet Fee For Dog Show 2 dog limit	
Americinn	(402) 435-1600
6555 N 27th, Lincoln NE 68504 • No Pet Fee For Dog Show	
Super 8	(402) 467-4488
2545 Cornhusker Hwy, Lincoln NE 68521 • Pet fee included in room rate	
Victorian Inn & Suites	(402) 464-4400
225 N 50th St, Lincoln NE 68504 • Flat \$20.00 pet fee for 1-4 nights • 2 dog limit	
Syracuse Inn & Suites	(402) 269-2700
130 N 30th St, Syracuse NE 68446 • \$15.00 per night pet fee	
Cobblestone Hotel & Suites	(402) 646-1004
2575 Progressive Rd, Seward NE 68434 • \$25.00 per night pet fee	
East Hill Motel	(402) 643-3679
131 Main St, Seward NE 68434 • \$10.00 per night pet fee	
Sunset Inn & Suites	(402) 475-3616
2920 NW 12th St, Lincoln NE 68521 • \$15.00 per night pet fee	
Luxury Inn & Suites	(402) 475-2200
2940 NW 12th St, Lincoln NE 68521 • \$15.00 per night pet fee	

PARKING - PLEASE NOTE!!!

Parking Lot A & B - Car/Van Parking Only - Single Stall Only

NO MOTOR HOME OR BOX TRUCK PARKING IN LOT A & B

Parking Lot C - Non-Electrical RV, Box Truck Parking & Overnight Parking Only (Fee Applied)

OVERNIGHT PARKING WITHOUT ELECTRICAL

\$15.00 per day • Non-Electrical RV & Camper Parking is in Parking Lot C

Fees collected by the Lancaster Event Center

Call (402) 441-1823 or pay at Good Time Grill

Or you can pay fees in the office before 5:00 pm the day of arrival.

Electrical Hook-up in Campground ONLY

OVERNIGHT PARKING WITH ELECTRICAL & WATER

(no sewer hookup) • Dump station on site

Electrical Parking is available at the Event Center Campground

Note - Significant distance from Pavilion 1

\$35.00 per day

MUST PAY FEES at the Event Center Office before 5:00 pm on the day of arrival.

Can reserve camping at www.lancastereventcenter.com

Upon payment, you will receive a certificate (to be displayed on camper)

ROUTES TO THE SHOW

DIRECTIONS TO LANCASTER EVENT CENTER - (84th & Havelock Avenue)

FROM THE SOUTH - (Highway 77) Take 77 north to Highway 2 east. Take Highway 2 east to 84th St. Take 84th St north (left) to Havelock Ave. The Lancaster Event Center is on the southeast corner of the intersection.

FROM THE NORTH - (Highway 77) Take I-80 east to the Waverly Exit & follow directions for east/west.

FROM THE EAST/WEST - Take I-80, Waverly exit. Take Highway 6 west to 84th St. Take 84th St South (left) to Havelock Ave.



THIS IS A NO SMOKING FACILITY

Specialty Shows
GERMAN WIREHAired POINTER CLUB OF AMERICA, INC.



Licensed by the American Kennel Club

FRIDAY, OCTOBER 6, 2023 National

SATURDAY, OCTOBER 7, 2023

The event is dedicated to the Patricia Laurans

OFFICERS

Liz Barrett-Dixon • President
Ray Calkins • Vice President
Rich Donohue • Treasurer
Stacy Risler • Secretary
3809 37th St, Elk Mound WI 54739

BOARD OF DIRECTORS

Mike Braddock • Eastern • L R Mars - Midwest • Rocky Gilleard - Western

SHOW COMMITTEE

Ms Betsy Reifschneider • Show Chairman
W10264 9th St, Camp Douglas WI 54618
Joan Payton • Jodi Quesnell • Garnett Persinger • Lori Sargent • Lisa Ramirez-George
Laura Myles • Futurity Chair
Judy Cheshire • Maturity Chair
Erin Yanish • Obedience & Rally Coordinator

COMMITTEES

Bonnie Crawford & Laura Steel • Meals & Hospitality
Lauren Fetner • Catalog Advertising
Kelton Hatton, Samantha Myles & Lisa Kreuser • Trophies
Sylvia Miller • Auction/Raffle
Lori Sargent • Basket Raffle

JUDGES

FRIDAY

Sweepstakes, Veteran Sweepstakes & AOH Sweepstakes

Sandra L Hoesel - Cascade, WI

Futurity & Maturity

Mandy Geary - Great Harwood Lanire, England

National Specialty, Regular & Non-Regular Classes & Junior Showmanship Competition

Laura Reeves - 7185 Redwood Hwy, Grants Pass, OR 97527

SATURDAY JUDGE

Regional Specialty, Regular & Non-Regular Classes & Junior Showmanship Competition,

Laura Myles - 21526 W Lost Lake Rd, Snohomish WA 98296

*The German Wirehaired Pointer Club of America, Inc. reserves the right to
substitute trophies equal to or greater than the value of the mentioned trophies/prizes.*

FRIDAY SWEEPSTAKES REQUIREMENTS & CLASSIFICATION

Sweepstakes is open to German Wirehaired Pointers that are 6 months of age and under 18 months of age on the day of the show. Dogs shown in Sweepstakes must also be entered in one of the regular classes at the regular entry fee and on the regular entry form. Indicate your Sweepstakes Class with the age division in the space provided for "Additional Class." Anyone in good standing with the AKC may handle an entry.

The following classes will be provided for both dogs and bitches.

Puppy, 6 Mos & Under 9 Mos • Puppy, 9 Mos & Under 12 Mos
Junior, 12 Mos & Under 15 Mos • Junior, 15 Mos & Under 18 Mos

DIVISION OF ENTRY MONEY AS PRIZES

35% of total entry fees will be retained by the Club for expenses. The remaining 65% will be divided as follows:

Best in Sweepstakes	20% of Sweepstakes Entries
Best of Opposite Sex to Best in Sweepstakes	10% of Sweepstakes Entries

The remaining 35% shall be further divided by class as follows:

First Place	40% of Sweepstakes Entries
Second Place	30% of Sweepstakes Entries
Third Place	20% of Sweepstakes Entries
Fourth Place	10% of Sweepstakes Entries

SWEEPSTAKES PRIZES

The following prizes are offered by the German Wirehaired Pointer Club of America, Inc. unless otherwise noted.

BEST IN SWEEPSTAKES - Woodbury Pewter

BEST OF OPPOSITE SEX TO BEST IN SWEEPSTAKES - GWP Figurine offered by Jacqueline Adams

FRIDAY VETERAN SWEEPSTAKES REQUIREMENTS & CLASSIFICATION

Veteran Sweepstakes is open to German Wirehaired Pointers that are over 7 years of age on the day of the show. Indicate your Veteran Sweepstakes Class with the age division in the space provided for "Additional Class." Anyone in good standing with the AKC may handle an entry. Altered dogs/bitches may be shown.

The following classes will be provided for both dogs and bitches.

Veteran, 7 Yrs & Under 10 Yrs • Veteran, 10 Yrs & Older

DIVISION OF ENTRY MONEY AS PRIZES in SWEEPSTAKES

35% of entry fees will be retained by the club for expenses. The remaining 65% will be divided as follows:

Best in Sweepstakes or Best Veteran Sweepstakes	20% of Veteran Sweepstakes Entries
Best of Opposite Sex to Best in Sweepstakes	10% of Veteran Sweepstakes Entries

The remaining 35% shall be further divided by class as follows:

First Place	40% of Sweepstakes Entries
Second Place	30% of Sweepstakes Entries
Third Place	20% of Sweepstakes Entries
Fourth Place	10% of Sweepstakes Entries

VETERAN SWEEPSTAKES PRIZES

The following prizes are offered by the German Wirehaired Pointer Club of America, Inc. unless otherwise noted.

BEST IN VETERAN SWEEPSTAKES - Woodbury Pewter

BEST OF OPPOSITE SEX TO BEST IN VETERAN SWEEPSTAKES - German Wirehaired Pointer Figurine offered By Jacqueline Adams

FRIDAY - AMATEUR OWNER HANDLERS SWEEPSTAKES

Dogs must be handled in the class by the registered owner of the dog & is limited to exhibitors who have not, at any point in time, been a professional dog handler or received compensation to show a dog, an AKC approved conformation judge, or employed as an assistant to a professional handler. All pertinent AKC rules apply to the offered classes, with the addition that dogs must meet the above eligibility requirements. No championship points are awarded in this non-regular competition. Winners of each class will compete for Best in AOH Sweepstakes

The following classes will be provided for both dogs and bitches.

Classes will be divided by sex.

6-9 mo Puppy • 9-12 mo Puppy

Adult • Champion

Division of Amateur Owner Handler Sweepstakes Prize Money

25% of Entry Fees will be retained by the Club for expenses. The remaining 75% will be divided as follows:

Best in Amateur Owner Handler Sweepstakes	25% of Sweepstakes Entries
Best of Opposite Sex to Best Amateur Owner-Handler Sweepstakes	25% of Sweepstakes Entries
Best Puppy in Amateur Owner-Handler Sweepstakes	25% of Sweepstakes Entries
Best of Opposite Sex to Best Puppy in Amateur Owner-Handler Sweepstakes	25% of Sweepstakes Entries

AMATEUR OWNER-HANDLER SWEEPSTAKES PRIZES

The following prizes are offered by the German Wirehaired Pointer Club of America, Inc. unless otherwise noted.

BEST IN AMATEUR OWNER-HANDLER SWEEPSTAKES – Woodbury Pewter

BEST OF OPPOSITE SEX TO BEST IN AMATEUR OWNER-HANDLER SWEEPSTAKES – Coaster Set

BEST PUPPY IN AMATEUR OWNER-HANDLER SWEEPSTAKES – GWP Figure offered by Jacqueline Adams

BEST OF OPPOSITE SEX TO BEST PUPPY IN AMATEUR OWNER HANDLER SWEEPSTAKES – GWP Figurine offered by Jacqueline Adams

FUTURITY & MATURITY

All dogs entered in the Futurity or Maturity must be owned & co-owned by a member of the German Wirehaired Pointer Club of America. All dogs must be entered in a regular class at the GWPCA National Specialty show. Dogs must be properly nominated & re-nominated. Entry fee is \$ 20.00 . Write in Additional Entry space on entry form.

FUTURITY CLASSES

CLASSES WILL BE DIVIDED BY SEX.

Junior Class	Whelped on or after December 1, 2022 through March 31, 2023
Intermediate Class	Whelped on or after August 1, 2022 through November 30, 2022
Senior Class	Whelped on or after April 1, 2022 through July 31, 2022

DIVISION OF FUTURITY PRIZE MONEY

Actual expenses will be deducted from the Futurity money. The remainder will be divided as follows:

Best in Futurity	12.5% of Futurity Entries
Best of Opposite Sex	12.5% of Futurity Entries
First Place	12.5% of Futurity Entries

Each winner's share will be further divided

60% to the Owner

40% to Breeder(s)/Nominator

FUTURITY PRIZES

The following prizes are offered by the German Wirehaired Pointer Club of America, Inc. unless otherwise noted.

BEST IN FUTURITY - Traveling Trophy

BEST IN FUTURITY - Rosette

BEST OF OPPOSITE SEX TO BEST IN FUTURITY - Rosette

MATURITY CLASSES

2023 Maturity eligible dogs are those from litters whelped between April 1, 2021 & March 31, 2022. Dogs must be owned & bred by GWPCA members. Dogs must be properly nominated & re-nominated. Entry fee is \$ 20.00 . Write in Additional Entry space on entry form.

Division of Maturity Prize Money

Actual expenses will be deducted from the Maturity money. The remainder will be divided as follows:

Best Dog - 40% • Best Bitch - 40% • Grand Maturity Winner - 20%

Each winner's share will be further divided

60% to the Owner

40% to Breeder(s)/Nominator

MATURITY PRIZES

The following prizes are offered by the German Wirehaired Pointer Club of America, Inc. unless otherwise noted.

BEST DOG IN MATURITY - Framed German Wirehaired Pointer Silhouette

BEST BITCH IN MATURITY - Framed German Wirehaired Pointer Silhouette

FIRST, SECOND, THIRD & FOURTH IN EACH CLASS- German Wirehaired Pointer Club of America, Inc. Medallion on Neck Ribbon

POINTS FOR RESERVE

German Wirehaired Pointer Club of America will award at its National Specialty a three point major to Reserve Winners Dog/Bitch if the Regular Class Dog/Bitch entry is twice the required number for a five point major in the division where the National Specialty is held (5-point major in District 13 is 6).

AWARDS OF MERIT

The Specialty judge may, at his or her discretion, award Judge's Awards of Merit to a maximum of 10% of the Best of Breed entry.

Along with Stud Dog and Brood Bitch, three additional events will be held after the Best Of Breed Competition. Only undefeated dogs and bitches are eligible for these competitions. If the first place first-place winner is not present, the second place winner may not compete.

BEST PUPPY COMPETITION

During the course of regular judging, the assigned judge will select a Best Puppy from the Puppy Class winners. This will be done after the Best of Breed Competition, unless the Best Puppy award is automatic. Example: An entry from the Puppy class is awarded Best of Winners or Best of Breed. Only dogs and bitches undefeated in a Puppy class are eligible for Best Puppy. NO ADDITIONAL FEE IS REQUIRED.

BRED-BY-EXHIBITOR CLASS

(Bred By Exhibitor Class Eligibility)

All dogs entered in the Bred-By-Exhibitor Class must be individually registered with AKC. For dogs that are at least six (6) months of age on the first day of the show, that are not champions of record. Dogs must be handled in the class by the registered owner of the dog. The Person handling the dog must be the person individually registered with AKC and are owned or co-owned by any of the breeders as of the date of closing entries for this show. The person handling the dog in the class must be both a breeder of record and an owner of record of this dog. In any subsequent classes for which dog from the Bred-by-Exhibitor Class becomes eligible, there are no restrictions as to who may handle it. NO ADDITIONAL FEE IS REQUIRED.

BEST VETERAN COMPETITION

During the course of regular judging, the assigned judge will select a Best Veteran from the Veteran Class winners. This will be done after the Best of Breed Competition, unless the Best Veteran award is automatic. Example: An entry from the Veteran class is awarded Best of Breed. Only dog and bitches undefeated in a Veteran class are eligible for Best Veteran competition. If the first-place winner is not present, the second place winner may not compete. NO ADDITIONAL FEE IS REQUIRED.

FRIDAY & SATURDAY BREED PRIZES

The German Wirehaired Pointer Club of America, Inc. will be offering Rosettes for Best of Breed, Best of Winners, Best of Opposite Sex to Best of Breed, Select Dog, Select Bitch, Winners Dog, Reserve Winners Dog, Winners Bitch, Reserve Winners Bitch, Awards of Merit, Best Puppy, Best Bred-by-Exhibitor, Best Veteran and First, Second, Third & Fourth in each class.

NATIONAL CONFORMATION - FRIDAY

The following trophies are offered by the German Wirehaired Pointer Club of America, Inc., unless otherwise noted.

BEST OF BREED - Woodbury Pewter and German Wirehaired Pointer Memorabilia offered by Laura Reeves

BEST OF WINNERS - Woodbury Pewter

BEST OF OPPOSITE SEX TO BEST OF BREED - Woodbury Pewter

SELECT DOG - Woodbury Pewter

SELECT BITCH - Woodbury Pewter

AWARD OF MERIT - Woodbury Pewter

WINNERS DOG - - Woodbury Pewter

WINNERS BITCH - Woodbury Pewter

RESERVE WINNERS DOG/BITCH - Woodbury Pewter

FIRST, SECOND, THIRD & FOURTH - Cooling Towel

JUNIOR SHOWMANSHIP COMPETITION PRIZES

BEST JUNIOR HANDLER – Woodbury Pewter offered by the German Wirehaired Pointer Club of America, Inc.

RESERVE BEST JUNIOR HANDLER – Woodbury Pewter offered by the German Wirehaired Pointer Club of America, Inc.

ALL JUNIOR HANDLER ENTRANTS - Goody Bag offered by the German Wirehaired Pointer Club of America, Inc.,

REGIONAL CONFORMATION - SATURDAY

The following trophies are offered by the German Wirehaired Pointer Club of America, Inc.

BEST OF BREED - Embroidered Chair

BEST OF OPPOSITE TO BEST OF BREED - Embroidered Chair

BEST OF WINNERS - Embroidered Chair

SELECT DOG/BITCH - Cutting Board

AWARD OF MERIT - Coaster Set

WINNERS DOG/BITCH – Kennel Blanket

RESERVE WINNERS DOG/BITCH – Event Item

JUNIOR SHOWMANSHIP COMPETITION PRIZES

The following trophies are offered by the German Wirehaired Pointer Club of America, Inc.

BEST JUNIOR HANDLER – Tote Bag

RESERVE BEST JUNIOR HANDLER – Kennel Bucket

FIRST IN EACH CLASS - Grooming Apron

The German Wirehaired Pointer Club of America, Inc. National Conformation Show weekend is dedicated to our club's longtime AKC Delegate Patricia W Laurans. Her leadership will be truly missed but never forgotten.

The German Wirehaired Pointer Club of America, Inc National Field Trial is dedicated to a truly compassionate and exuberant field trial judge and member of the German Wirehaired Pointer Club of America, Inc., Dr Ellis Hertz

Friday evening

2022 Annual Awards Ceremony

Saturday evening

Annual Membership Meeting

Meal Reservation Form and Information and Event

Merchandise can be found at GWPCA.com

At the end of the day we all take home the same dog. The BEST one. So, win with Grace, lose with Dignity. Dog shows should be fun for everyone.

Saturday the German Wirehaired Pointer Club of America, Inc. is hosting an Educational Event for all interested people.

**Learn Canine CPR and Choking Management
from a Pet Tech Certified Instructor**

Bethany Wiltshire - PTI #2542

(Member of German Wirehaired Pointer Club of America, Inc.)

YOU ARE YOUR DOG'S FIRST RESPONDER!

DO YOU KNOW WHAT TO DO IF A DOG COLLAPSES?

In one hour we will develop the motor memory to jump into action when seconds count. Learn evidence-based best practice for canine CPR in the Field. We will go through various scenarios to help you perform as needed in an emergency situation. We will also cover how to massage a dog who is choking and how to stabilize your dog for transport to your veterinarian.



Specialty Shows

LIMITED TO 100 ENTRIES EACH SHOW

See Page 48 for Saturday Concurrent Specialty Information



Licensed by the American Kennel Club

FRIDAY, OCTOBER 6, 2023

OFFICERS

Wade Hilker • President
Lee Mitchell • Vice President
Sandy Orr • Treasurer
Annmarie Andersen • Recording Secretary
Jay Kloecker • Corresponding Secretary
2700 W Raymond Rd, Raymond NE 68428

BOARD OF DIRECTORS

Ann Tomhave • Pamela Savoye

SHOW COMMITTEE

Sandy Orr • Show Chairman
7106 N 57th St, Omaha NE 68152-2301 • (402) 659-8484 • sorr@orkidboxers.com
Officers of the Club & Members of the Board of Directors

COMMITTEES

Gail Kloecker • Advertising
Ann Tomhave • Chief Ring Steward
Steve Orr • Hospitality
Lee Mitchell & Annmarie Andersen • Trophies

Missouri Valley Boxer Club will have four reserved grooming spaces close to the ring

1ST SHOW JUDGES

Sweepstakes

Karen Emerson - 21600 Harper Rd, Chanute KS 67200

Regular & Non-Regular Classes

Howard E Engel - 5961 CR I, Wiggins CO 80654

2ND SHOW JUDGE

Regular & Non-Regular Classes

Mrs Stephanie Hamblin Barnhill - 2508 Kensington Rd, Lawrence KS 66046

1ST SHOW SWEEPSTAKES REQUIREMENTS & CLASSIFICATION

Dogs shown in Sweepstakes must also be entered in one of the regular classes at the regular entry fee and on the regular entry form. Indicate your Sweepstakes Class with the age division in the space provided for "Additional Class." There are no AKC Championship points connected with the Sweepstakes.

The following classes will be provided for both dogs and bitches.

Puppy, 6 Mos & Under 9 Mos • Puppy, 9 Mos & Under 12 Mos • Junior, 12 Mos & Under 18 Mos

DIVISION OF ENTRY MONEY AS PRIZES

30% of total entry fees will be retained by the Club for expenses. The remaining 70% will be divided in each class as follows:

First - 35% • Second - 30% • Third - 20% • Fourth - 15%

SWEEPSTAKES PRIZES

The Missouri Valley Boxer Club offers a Rosette for Grand Sweepstakes Winner, Best Puppy in Sweepstakes & Best Junior in Sweepstakes.

The following prizes are offered by the Missouri Valley Boxer Club through the generosity of friends and club members.

GRAND SWEEPSTAKES WINNER - Basket of Toys and Treats (Value \$20.00)

BEST PUPPY IN SWEEPSTAKES - Basket of Toys and Treats (Value \$15.00)

BEST JUNIOR IN SWEEPSTAKES - Basket of Toys and Treats (Value \$15.00)

1ST SHOW BREED PRIZES

The Missouri Valley Boxer Club offers a Rosette for Best of Breed, Best of Winners, Best of Opposite Sex to Best of Breed, Select Dog, Select Bitch, Winners Dog, Reserve Winners Dog, Winners Bitch, Reserve Winners Bitch & Best of Breed Owner-Handled.

Unless otherwise indicated, the following prizes are offered by the Missouri Valley Boxer Club through the generosity of friends and club members.

BEST OF BREED – Travelers Club 18" Cool Carry Insulated Rolling Cooler

BEST OF WINNERS – Official ABC Plaque offered by the American Boxer Club

BEST OF OPPOSITE SEX TO BEST OF BREED – Travelers Club 18" Cool Carry Insulated Rolling Cooler

SELECT DOG – Large Insulated Reusable Grocery Bag

SELECT BITCH – Large Insulated Reusable Grocery Bag

WINNERS DOG – Large Insulated Reusable Grocery Bag

RESERVE WINNERS DOG – Large Insulated Reusable Grocery Bag

WINNERS BITCH – Large Insulated Reusable Grocery Bag

RESERVE WINNERS BITCH – Large Insulated Reusable Grocery Bag

FIRST IN EACH REGULAR CLASS – Insulated Lunch Bag

FIRST IN EACH VETERAN CLASS – \$10.00

THERE WILL BE COMPETITION FOR BEST PUPPY IN PUPPY CLASSES AT THE SECOND SHOW

2ND SHOW BREED PRIZES

The Missouri Valley Boxer Club offers a Rosette for Best of Breed, Best of Winners, Best of Opposite Sex to Best of Breed, Select Dog, Select Bitch, Winners Dog, Reserve Winners Dog, Winners Bitch, Reserve Winners Bitch, Best of Breed Owner-Handled & Best Puppy in Puppy Classes.

Unless otherwise indicated, the following prizes are offered by the Missouri Valley Boxer Club through the generosity of friends and club members.

BEST OF BREED – Hand Painted Boxer Statue offered by Lee Mitchell and Annmarie Andersen & Four 32 oz Etched Beer Mugs

BEST OF WINNERS – Official American Boxer Club Plaque offered by the American Boxer Club

BEST OF OPPOSITE SEX TO BEST OF BREED – Two 32 oz Etched Beer Mugs

SELECT DOG – Two Etched 15 oz Classic Pilsner Beer Glasses
SELECT BITCH – Two Etched 14 oz Porter Beer Glasses
BEST PUPPY IN PUPPY CLASSES – Etched Champagne Glass
WINNERS DOG – Two Etched 32 oz Wheat Beer Glasses
RESERVE WINNERS DOG – Two Etched 20 oz Craft Pub Beer Glasses
WINNERS BITCH – Two Etched 16 oz Belgian Ale Glasses
RESERVE WINNERS BITCH – Two Etched 20 oz English Pub Beer Glasses
FIRST IN EACH REGULAR – Painted Puppy Plates
FIRST IN EACH VETERAN CLASS – \$10.00

Group Show, All-Breed Obedience Trial & All-Breed Rally Trial



Licensed by the American Kennel Club

FRIDAY, OCTOBER 6, 2023

OFFICERS

Larry Voller • President
Ronald Weaks • Vice President
Teresa Columbo-Heavey • Treasurer
Pat Gordy • Secretary
582 South 126th St, Omaha NE 68154

BOARD OF DIRECTORS

Karen Voller • Ken Goesch • Jen Howell • Nancy Goesch • Bonnie Lawrence

SHOW COMMITTEE

Mateel Smith • Show Chairman
5016 Wright Way, Blair, NE 68008 xcell@cox.net
Larry Voller • Obedience & Rally Chairman
7610 S 130th St Omaha, NE 68138 • (402) 680-4431 • voller_contracting@cox.net

COMMITTEES

Karen Voller • Trophy
Larry Voller • Advertising
Pat Gordy • Publicity
Nancy Goesch • Chief Ring Steward

ATTENTION EXHIBITORS

The Greater Omaha Terrier Association offers a Medallion to anyone receiving a new Championship or new Obedience or Rally Title at this show. Please notify the trophy table!

VARIETY GROUP PRIZES FOR FIRST IN REGULAR GROUP

\$50.00

PLAQUE

Dog's name will be placed on the Memorial Plaque

ROSETTE

Offered by the Greater Omaha Terrier Association

FOR SECOND IN REGULAR GROUP

\$30.00

ROSETTE

Offered by the Greater Omaha Terrier Association

FOR THIRD IN REGULAR GROUP

\$20.00

ROSETTE

Offered by the Greater Omaha Terrier Association

FOR FOURTH IN REGULAR GROUP

\$10.00

ROSETTE

Offered by the Greater Omaha Terrier Association

FOR FIRST IN VETERAN GROUP

\$20.00

PLAQUE WITH FRAME

Offered by Pat Gordy in Memory of Tom Steyer

ROSETTE

Offered by the Greater Omaha Terrier Association

MEMORIALS ON DISPLAY

These Memorials will have the dog's name & owner's name and breed added. An additional Generic Award Plaque (not having the dog's name & owner's name) will be awarded along with a Ribbon for owner to keep.

FIRST IN GROUP - Memorial Plaque with Dog's Name offered by the Greater Omaha Terrier Association

ALL BREED OBEDIENCE TRIAL PRIZES

Qualifying score required for all prizes in Titling Classes.

A Dark Green Qualifying Ribbon will be given to each dog attaining a Qualifying Score.

PLEASE NOTE: Refund of entry fees (minus \$10.00 processing fee) for bitches entered in Obedience that come in season after closing date of this show may be obtained provided that a veterinarian's certificate and a request in writing is received by the Show Superintendent no later than 30 minutes prior to the start of judging.

Armbands for this Trial will be arranged in descending Jump Height Order.

Transfers will be allowed at this trial per AKC Regulations.

FOR HIGHEST SCORING DOG IN REGULAR CLASSES

\$25.00

ROSETTE

Offered by the Greater Omaha Terrier Association

FOR HIGHEST COMBINED SCORE IN OPEN B & UTILITY CLASSES

\$25.00

ROSETTE

Offered by the Greater Omaha Terrier Association

FOR HIGHEST SCORING DOG FROM THE TERRIER GROUP IN REGULAR CLASSES

PERPETUAL MEMORIAL PLAQUE WITH DOG'S NAME, BREED & SCORE
PLACED ON THE MEMORIAL PLAQUE

An additional Generic Award Plaque (not having the dog's name & owner's name) will be awarded along with a Ribbon for owner to keep.

\$25.00

ROSETTE

Offered by the Greater Omaha Terrier Association

**DOG FROM THE TERRIER GROUP WITH
HIGHEST COMBINED SCORE IN OPEN B & UTILITY CLASSES**

ROSETTE

Offered by the Greater Omaha Terrier Association

ALL BREED RALLY TRIAL PRIZES

Qualifying score required for all prizes.

A Dark Green Qualifying Ribbon will be given to each dog attaining a Qualifying Score.

PLEASE NOTE: Refund of entry fees (minus \$10.00 processing fee) for bitches entered in Rally that come in season after closing date of this show may be obtained provided that a veterinarian's certificate and a request in writing is received by the Show Superintendent no later than 30 minutes prior to the start of judging.

Transfers will be allowed at this trial per AKC Regulations.

Armbands for this Trial will be arranged in ascending Jump Height Order.

Ring Size: 40 ft X 50 ft

FOR HIGHEST SCORING TRIPLE QUALIFYING SCORE

\$25.00

ROSETTE

Offered by the Greater Omaha Terrier Association

**FOR HIGHEST COMBINED SCORE IN
ADVANCED B & EXCELLENT B CLASSES**

\$25.00

ROSETTE

Offered by the Greater Omaha Terrier Association

**DOG FROM THE TERRIER GROUP WITH HIGHEST COMBINED
SCORE IN ADVANCED B & EXCELLENT B CLASSES**

\$25.00

ROSETTE

Offered by the Greater Omaha Terrier Association

Specialty Shows
LIMITED TO 100 ENTRIES EACH

EASTERN NEBRASKA

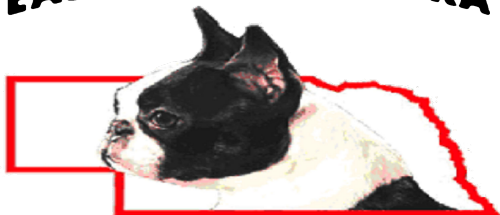

BOSTON TERRIER CLUB

Licensed by the American Kennel Club

FRIDAY, OCTOBER 6, 2023

OFFICERS

Martha Anderson • President
Beccy Smith • Vice President
Anna Stork • Treasurer
Shayne Fili • Secretary
9808 Military Road, Omaha, NE 68134

BOARD OF DIRECTORS

Cindy Zingg • Dean Zingg • Peggy O'Brien

SHOW COMMITTEE

Martha Anderson • Show Chairman
8812 S 230th Plaza Circle, Gretna NE 68028
Officers of the Club & Members of the Board of Directors

COMMITTEES

Beccy Smith • Trophy
Anna Stork • Advertising
Martha Anderson • Publicity
Dean Zingg • Chief Ring Steward

1st SHOW JUDGES

Sweepstakes

Tom Widick-Eckery - 3920 Mescal Cir, Lincoln NE 68516

Regular & Non-Regular Classes

Mrs Jane Boatman Blackerby - 9509 Hocker Dr, Merriam KS 66203

2nd SHOW JUDGE

Regular & Non-Regular Classes & Junior Showmanship

Mrs Eva Berg - 136 Longfield Pl, Moraga CA 94556

FIRST SHOW SWEEPSTAKES

Requirements & Classification

Dogs shown in Sweepstakes must also be entered in one of the regular classes at the regular entry fee and on the regular entry form. Indicate your Sweepstakes Class with the age division the space provided for "Additional Class".

The following classes will be provided for both dogs and bitches.

Puppy, 6 Mos & Under 9 Mos; Puppy, 9 Mos & Under 12 Mos; Junior, 12 Mos & under 18 Mos

DIVISION OF ENTRY MONEY AS PRIZES

35% of total entry fees will be retained by the Club for expenses. The remaining 65% will be divided as in each class as follows:

First 40%; Second 30%; Third, 20%, Fourth, 10%

SWEEPSTAKES PRIZES

The Eastern Nebraska Boston Terrier Club offers a Rosette for Best in Sweepstakes & Best of Opposite Sex to Best in Sweepstakes.

THERE WILL BE COMPETITION FOR BEST VETERAN

BREED PRIZES - BOTH SHOWS

The Eastern Nebraska Boston Terrier Club offers a Rosette for Best of Breed, Best of Opposite Sex to Best of Breed, Winners Dog, Winners Bitch & Best Veteran.

The following prizes are offered by the Eastern Nebraska Boston Terrier Club.

BEST OF BREED - \$50.00

BEST OF BREED - Dog Blanket with the Eastern Nebraska Boston Terrier Club Logo

BEST OF OPPOSITE SEX TO BEST OF BREED - \$25.00

WINNER'S DOG - \$20.00

WINNER'S BITCH - \$20.00

FIRST IN EACH VETERAN'S CLASS - \$15.00

AWARDS OF MERIT

The judge may, at their discretion, recall into the ring up to two dogs/bitches to receive a Rosette offered by the Eastern Nebraska Boston Terrier Club. These Rosettes are reserved for those quality animals the judge feels are worthy of final consideration for Best of Breed.

SECOND SHOW JUNIOR SHOWMANSHIP COMPETITION PRIZES

BEST JUNIOR HANDLER - Crate Mat offered by the Eastern Nebraska Boston Terrier Club

BEST JUNIOR HANDLER - Rosette offered by the Eastern Nebraska Boston Terrier Club

RESERVE BEST JUNIOR HANDLER - Crate Mat offered by the Eastern Nebraska Boston Terrier Club

RESERVE BEST JUNIOR HANDLER - Rosette offered by the Eastern Nebraska Boston Terrier Club

SPECIALTY SHOWS

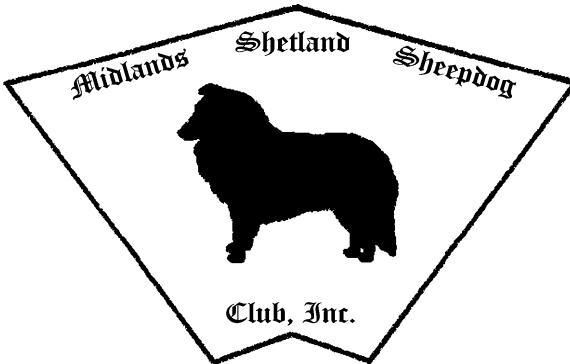

Licensed by the American Kennel Club

EACH SHOW IS LIMITED TO 100 ENTRIES

73rd & 74th Fall Specialty Shows

FRIDAY, OCTOBER 6, 2023

OFFICERS

Kathie Antrim • President
Carolyn Forman • Vice President
Joanne Swenson • Treasurer
Gretchen Fry • Secretary
12009 S 217th St, Gretna NE 68028

BOARD OF DIRECTORS

Stephen Prostert • Angela Curtis • Charlie McIntosh

SHOW COMMITTEE

Dianne Krantz • Show Chairperson
8614 Birch Dr, LaVista NE 68128 • (402) 639-8517 cell • dimarshelties@msn.com
Officers of the Club & Members of the Board of Directors

COMMITTEES

Gretchen Fry • Trophies
Carolyn Foreman • Hospitality
Joanne Swenson • Catalog Sales
Dianne Krantz • Premium List
Carolyn Foreman • Post Show Dinner
Charlie McIntosh • Raffle
Trudy Supella • Chief Ring Steward

1ST SHOW JUDGE

Regular & Non-Regular Classes

Mr Randall Sheets - 1612 Devon Dr, Colleyville, TX 76034

2ND SHOW JUDGE

Regular & Non-Regular Classes

Connie DuBois* - 3105 E Trapnell Rd, Plant City FL 33566

** One or more breed assigned approved as provisional/permit by AKC*

1ST & 2ND SHOW BREED PRIZES

The Midlands Shetland Sheepdog Club, Inc. offers a Rosette for Best of Breed, Best of Winners, Best of Opposite Sex to Best of Breed, Winners Dog, Reserve Winners Dog, Winners Bitch & Reserve Winners Bitch. American Shetland Sheepdog Association Medallion will be offered for Winners Dog & Winners Bitch.

*The Club reserves the right to substitute trophies of equal
or greater value if necessary.
Prize list for First Show Only.*

BEST OF BREED - Everest Sporty Gear Duffel Bag offered by Chuck and Pat Leyendecker
BEST OF WINNERS - Derby Dog Grooming Tote Pockets offered by Charlie and Kathy McIntosh
BEST OF OPPOSITE SEX - Everest Sporty Gear Duffel Bag offered by Kathie Antrim
WINNERS DOG - Dalix 12" Mini Gym Duffel Bag offered by Joanne Swenson
RESERVE WINNERS DOG - TOPDesign Canvas Tote Bag offered by Terri Richardson
WINNERS BITCH - Dalix 12" Mini Gym Duffel Bag offered by Ray and Betty Bloomquist
RESERVE WINNERS BITCH - TOPDesign Canvas Tote Bag offered by Stephen & Barb Prostert
FIRST PLACE IN EACH CLASS - LED Nightlight with Sheltie Silhouette offered by Gretchen Fry
(Spice O'Life Shelties)

Post Show Dinner at Lancaster Event Center

Midlands Shetland Sheepdog Club will be hosting a buffet dinner Friday Evening after the conclusion of the 2 Shetland Sheepdog Specialties.

Contact Carolyn Foreman

carolynforeman@cox.net

Sign up by September 30th.

Midlands Shetland Sheepdog Club Raffle

Held on Friday, October 6th.

Raffle Table will be near the Sheltie Ring!!

More than Sheltie items!

Come check it out.

All Breed Dog Shows, Obedience Trials & Rally Trials



Incorporated
Member of the American Kennel Club

SATURDAY, OCTOBER 7, 2023

SUNDAY, OCTOBER 8, 2023

OFFICERS

Sandy Myers • President
Jim Fedde • Vice President
Tom Widick-Eckery • Treasurer
Dawn Sybrant • Recording Secretary
Dian Quist • Corresponding Secretary
2145 S 52nd St, Lincoln NE 68506

BOARD OF DIRECTORS

Karin Ostmann • Marla Zoz

SHOW COMMITTEE

Marla Zoz • Show Chairman
4101 W A St, Lincoln NE 68522
Dian Quist • Obedience Chairman
Dian Quist • Rally Chairman

Officers of the Club & Members of the Board of Directors

COMMITTEES

Rick & Suzy Riedel • Hospitality
Sandy Myers • Chief Ring Steward
Suzy Riedel • Booth Rentals
(402) 314-1716
pudlzone@aol.com
Jim Fedde • Trophies
Rick & Suzy Riedel • Catalog Sales
Marla Zoz • Clean Up
Betsy Fedde • AKC Information Booth
Tom Widick-Eckery • Grooming

NOVICE CONFORMATION CLASSES ARE NOT OFFERED AT THESE SHOWS

ATTENTION EXHIBITORS

The Cornhusker Kennel Club of Lincoln, Nebraska, Inc. offers a New Title Rosette to any dog finishing an Obedience or Rally Title at this show.

The Cornhusker Kennel Club of Lincoln, Nebraska, Inc. reserves the right to substitute trophies of equal or greater value if necessary.

SATURDAY

BEST IN SHOW & VARIETY GROUP PRIZES

FOR BEST IN SHOW

\$50.00 VENDOR COUPON

Offered by Optimum Veterinary

ROSETTE

Offered by the Cornhusker Kennel Club of Lincoln, Nebraska, Inc.

FOR RESERVE BEST IN SHOW

\$25.00 VENDOR COUPON

Offered by Optimum Veterinary

ROSETTE

Offered by the Cornhusker Kennel Club of Lincoln, Nebraska, Inc.

FOR BEST OWNER-HANDLED IN SHOW

\$25.00 VENDOR COUPON

Offered by Russ & Tricia Stanczyk

ROSETTE

Offered by the Cornhusker Kennel Club of Lincoln, Nebraska, Inc.

FOR RESERVE BEST OWNER-HANDLED IN SHOW

\$20.00 VENDOR COUPON

Offered by Wachal Pet Health Center

ROSETTE

Offered by the Cornhusker Kennel Club of Lincoln, Nebraska, Inc.

FOR FIRST IN EACH REGULAR VARIETY GROUP

\$20.00 VENDOR COUPON

Offered by Hillcrest Animal Clinic, unless otherwise indicated

Hound Group - Offered by Tomorrow's Vet Care

Terrier Group - Offered by Marla Zoz

Toy Group - Offered by Karin Ostmann

Herding Group - Offered by Wachal Pet Health Center

FOR FIRST, SECOND, THIRD & FOURTH IN EACH REGULAR VARIETY GROUP

ROSETTE

Offered by the Cornhusker Kennel Club of Lincoln, Nebraska, Inc.

FOR FIRST IN EACH OWNER-HANDLED VARIETY GROUP

\$15.00 VENDOR COUPON

Sporting Group - Offered by Karin Ostmann

Hound Group - Offered by Betsy & Jim Fedde

Working Group - Offered by Karin Ostmann

Terrier Group - Offered by Sandy Myers

Toy Group - Offered by Tom Widick-Eckery & Greg Eckery-Widick

Non-Sporting Group - Offered by Sandy Myers

Herding Group - Offered by Tomorrow's Vet Care

FOR FIRST, SECOND, THIRD & FOURTH IN EACH OWNER-HANDLED VARIETY GROUP

ROSETTE

Offered by the Cornhusker Kennel Club of Lincoln, Nebraska, Inc.

BREED PRIZES SPORTING BREEDS

POINTERS

BEST OF BREED - \$15.00 Vendor Coupon offered by Sandy Myers

POINTERS (GERMAN WIREHAIRD)

**THE GERMAN WIREHAIRD POINTER CLUB OF AMERICA, INC. SUPPORTS THE
ENTRY OF ITS BREED AT THIS SHOW.**

The following prizes are offered by the German Wirehaired Pointer Club of America, Inc.

BEST OF BREED - Event Item (Minimum Value \$5.00)

BEST OF WINNERS - Event Item (Minimum Value \$5.00)

BEST OF OPPOSITE SEX TO BEST OF BREED - Event Item (Minimum Value \$5.00)

RETRIEVERS (LABRADOR)

BEST OF BREED - \$15.00 Vendor Coupon offered by Optimum Veterinary

SPINONI ITALIANI

BEST OF BREED - \$15.00 Vendor Coupon offered by Sandy Myers

HOUND BREEDS

BLACK & TAN COONHOUNDS

The following prizes are offered by Old Soul Kennel.

BEST OF BREED - \$15.00 Vendor Coupon

BEST OF WINNERS - \$12.00 Vendor Coupon

BEST OF OPPOSITE SEX TO BEST OF BREED - \$12.00 Vendor Coupon

WINNERS DOG - \$10.00 Vendor Coupon

WINNERS BITCH - \$10.00 Vendor Coupon

RHODESIAN RIDGEBACKS

BEST OF BREED - \$15.00 Vendor Coupon offered by Yankee Hill Veterinary Clinic

SALUKIS

BEST OF WINNERS - \$12.00 Vendor Coupon offered by Betsy & Jim Fedde

WHIPPETS

BEST OF WINNERS - \$12.00 Vendor Coupon offered by Betsy & Jim Fedde

WORKING BREEDS

BOXERS

BEST OF BREED - \$15.00 Vendor Coupon offered by Ann Tomhave, Wesan Boxers

GREAT DANES

BEST OF BREED - \$15.00 Vendor Coupon offered by Optimum Veterinary

GREAT PYRENEES

BEST OF BREED - \$15.00 Vendor Coupon offered by Optimum Veterinary

NEWFOUNDLANDS

BEST OF BREED - \$15.00 Vendor Coupon offered by Optimum Veterinary

PORTUGUESE WATER DOGS

The following prizes are offered by the Sandy Myers.

BEST OF BREED - \$15.00 Vendor Coupon

BEST OF WINNERS - \$12.00 Vendor Coupon

BEST OF OPPOSITE SEX TO BEST OF BREED - \$12.00 Vendor Coupon

ROTTWEILERS

The following prizes are offered by Dawn Sybrant.

BEST OF BREED - \$15.00 Vendor Coupon

BEST OF WINNERS - \$12.00 Vendor Coupon

BEST OF OPPOSITE SEX TO BREED - \$12.00 Vendor Coupon

WINNERS DOG - \$10.00 Vendor Coupon

WINNERS BITCH - \$10.00 Vendor Coupon

TERRIER BREEDS

BORDER TERRIERS

BEST OF BREED - \$15.00 Vendor Coupon offered by Yankee Hill Veterinary Clinic

MANCHESTER TERRIERS (STANDARD)

The following prizes are offered by Ambrick Manchester Terriers.

BEST OF VARIETY - \$15.00 Vendor Coupon

BEST OF OPPOSITE SEX TO BEST OF VARIETY - \$12.00 Vendor Coupon

TOY BREEDS

CHIHUAHUAS (LONG COAT)

BEST OF VARIETY - \$15.00 Vendor Coupon offered by Tom Widick-Eckery & Gregg Eckery-Widick

HAVANESE

BEST OF BREED - \$15.00 Vendor Coupon offered by Yankee Hill Veterinary Clinic

NON-SPORTING BREEDS

BOSTON TERRIERS

The following prizes are offered by the Eastern Nebraska Boston Terrier Club.

BEST OF BREED - \$15.00 Vendor Coupon

BEST OF WINNERS - \$12.00 Vendor Coupon

BEST OF OPPOSITE SEX TO BEST OF BREED - \$12.00 Vendor Coupon

WINNERS DOG - \$10.00 Vendor Coupon

WINNERS BITCH - \$10.00 Vendor Coupon

HERDING BREEDS

CARDIGAN WELSH CORGIS

BEST OF WINNERS - \$12.00 Vendor Coupon offered by Betsy & Jim Fedde

SHETLAND SHEEPDOGS

BEST OF BREED - \$15.00 Vendor Coupon offered by Fox Hollow Shelties in Memory of Romayne's Uptown Girl CGC TKA RI CD THD

JUNIOR SHOWMANSHIP COMPETITION PRIZES

BEST JUNIOR HANDLER - \$20.00 Vendor Coupon (not redeemable for cash) offered by Ehlers Animal Care

BEST JUNIOR HANDLER - Rosette offered by the Cornhusker Kennel Club of Lincoln, Nebraska, Inc.

RESERVE BEST JUNIOR HANDLER - \$10.00 Vendor Coupon (not redeemable for cash) offered by Antelope Creek Vet Center

RESERVE BEST JUNIOR HANDLER - Rosette offered by the Cornhusker Kennel Club of Lincoln, Nebraska, Inc.



The following prizes are offered by the Junior Achievement Challenge.

FIRST IN EACH CLASS - 1 Group of AKC Breed Standards (Junior's Choice)

OBEDIENCE TRIAL PRIZES

Qualifying Score required for all prizes in Titling Classes.

A Dark Green Qualifying Ribbon will be given to each dog attaining a Qualifying Score.

PLEASE NOTE: Refund of entry fees for bitches entered in Obedience that come in season after closing date of this show may be obtained provided that a veterinarian's certificate and a request in writing is received by the Show Superintendent no later than 30 minutes prior to the start of judging.

Transfers will be allowed at this trial per AKC Regulations.

Armbands for this Trial will be arranged in descending Jump Height Order.

FOR HIGHEST SCORING DOG IN REGULAR CLASSES

\$50.00 VENDOR COUPON

Offered by Kenl Inn

ROSETTE

Offered by the Cornhusker Kennel Club of Lincoln, Nebraska, Inc.

FOR HIGHEST COMBINED SCORE IN OPEN B & UTILITY CLASSES

\$25.00 VENDOR COUPON

Offered by Hillcrest Animal Clinic

ROSETTE

Offered by the Cornhusker Kennel Club of Lincoln, Nebraska, Inc.



JAC OBEDIENCE PRIZES

ALL JUNIOR HANDLERS (9 YRS & UNDER 18 YRS) AWARDED A QUALIFYING

SCORE - 1 Group of AKC Breed Standards (Junior's Choice) offered by the Junior Achievement Challenge

RALLY TRIAL PRIZES

Qualifying Score required for all prizes.

A Dark Green Qualifying Ribbon will be given to each dog attaining a Qualifying Score.

PLEASE NOTE: Refund of entry fees for bitches entered in Rally that come in season after closing date of this show may be obtained provided that a veterinarian's certificate and a request in writing is received by the Show Superintendent no later than 30 minutes prior to the start of judging.

Transfers will be allowed at this trial per AKC Regulations.

Armbands for this Trial will be arranged in ascending Jump Height Order.

Ring Size: 40 ft X 50 ft

FOR HIGHEST SCORING TRIPLE QUALIFYING SCORE

\$25.00 VENDOR COUPON

Offered by Kenl Inn

ROSETTE

Offered by the Cornhusker Kennel Club of Lincoln, Nebraska, Inc.

FOR HIGHEST COMBINED SCORE IN ADVANCED B & EXCELLENT B CLASSES

\$25.00 VENDOR COUPON

Offered by Kenl Inn

ROSETTE

Offered by the Cornhusker Kennel Club of Lincoln, Nebraska, Inc.

SUNDAY

BEST IN SHOW & VARIETY GROUP PRIZES

FOR BEST IN SHOW

\$50.00 PETCO GIFT CARD

Offered by Optimum Veterinary

ROSETTE

Offered by the Cornhusker Kennel Club of Lincoln, Nebraska, Inc.

FOR RESERVE BEST IN SHOW

\$25.00 PETCO GIFT CARD

Offered by Optimum Veterinary

ROSETTE

Offered by the Cornhusker Kennel Club of Lincoln, Nebraska, Inc.

FOR BEST OWNER-HANDLED IN SHOW

\$25.00 PETCO GIFT CARD

Offered by Russ & Tricia Stanczyk

ROSETTE

Offered by the Cornhusker Kennel Club of Lincoln, Nebraska, Inc.

FOR RESERVE BEST OWNER-HANDLED IN SHOW

\$20.00 PETCO GIFT CARD

Offered by Wachal Pet Health Center

ROSETTE

Offered by the Cornhusker Kennel Club of Lincoln, Nebraska, Inc.

FOR FIRST IN EACH REGULAR VARIETY GROUP

\$20.00 PETCO GIFT CARD

Offered by Hillcrest Animal Clinic, unless otherwise indicated

Hound Group - Offered by Tomorrow's Vet Care

Terrier Group - Offered by Marla Zoz

Toy Group - Offered by Karin Ostmann

FOR FIRST, SECOND, THIRD & FOURTH IN EACH REGULAR VARIETY GROUP

ROSETTE

Offered by the Cornhusker Kennel Club of Lincoln, Nebraska, Inc.

FOR FIRST IN EACH OWNER-HANDLED VARIETY GROUP

\$15.00 PETCO GIFT CARD

Sporting Group - Offered by Karin Ostman

Hound Group - Offered by Betsy & Jim Fedde

Working Group - Offered by Karin Ostman

Terrier Group - Offered by Sandy Myers

Toy Group - Offered by Tom Widick-Eckery & Gregg Eckery-Widick

Non-Sporting Group - Offered by Sandy Myers

Herding Group - Offered by Tomorrows Vet Care

FOR FIRST, SECOND, THIRD & FOURTH IN EACH OWNER-HANDLED VARIETY GROUP

ROSETTE

Offered by the Cornhusker Kennel Club of Lincoln, Nebraska, Inc.

BREED PRIZES

SPORTING BREEDS

POINTERS

BEST OF BREED - \$15.00 Petco Gift Card offered by Sandy Myers

POINTERS (GERMAN WIREHAIRD)

THE GERMAN WIREHAIRD POINTER CLUB OF AMERICA, INC. SUPPORTS THE ENTRY OF ITS BREED AT THIS SHOW.

The following prizes are offered by the German Wirehaired Pointer Club of America, Inc.

BEST OF BREED - Event Item (Minimum Value \$5.00)

BEST OF WINNERS - Event Item (Minimum Value \$5.00)

BEST OF OPPOSITE SEX TO BEST OF BREED - Event Item (Minimum Value \$5.00)

RETRIEVERS (LABRADOR)

BEST OF BREED - \$15.00 Petco Gift Card offered by Optimum Veterinary

SPINONI ITALIANI

BEST OF BREED - \$15.00 offered by Sandy Myers

HOUND BREEDS

BLACK & TAN COONHOUNDS

The following prizes are offered by Old Soul Kennel

BEST OF BREED - \$15.00 Petco Gift Card

BEST OF WINNERS - \$12.00 Petco Gift Card

BEST OF OPPOSITE SEX TO BEST OF BREED - \$12.00 Petco Gift Card

WINNERS DOG - \$10.00 Petco Gift Card

WINNERS BITCH - \$10.00 Petco Gift Card

RHODESIAN RIDGEBACKS

BEST OF BREED - \$15.00 Petco Gift Card offered by Richard Craven

SALUKIS

BEST OF WINNERS - \$12.00 Petco Gift Card offered by Betsy & Jim Fedde

WHIPPETS

BEST OF WINNERS - \$12.00 Petco Gift Card offered by Betsy & Jim Fedde

WORKING BREEDS

BOXERS

BEST OF BREED - \$15.00 Petco Gift Card offered by Ann Tomhave, Wesan Boxers

GREAT DANES

BEST OF BREED - \$15.00 Petco Gift Card offered by Optimum Veterinary

GREAT PYRENEES

BEST OF BREED - \$15.00 offered by Optimum Veterinary

NEWFOUNDLANDS

BEST OF BREED - \$15.00 Petco Gift Card offered by Optimum Veterinary

PORTUGUESE WATER DOGS

The following prizes are offered by Sandy Myers.

BEST OF BREED - \$15.00 Petco Gift Card

BEST OF WINNERS - \$12.00 Petco Gift Card

BEST OF OPPOSITE SEX TO BEST OF BREED - \$12.00 Petco Gift Card

ROTTWEILERS

The following prizes are offered by Dawn Sybrant.

BEST OF BREED - \$15.00 Petco Gift Card

BEST OF WINNERS - \$12.00 Petco Gift Card

BEST OF OPPOSITE SEX TO BREED - \$12.00 Petco Gift Card

WINNERS DOG - \$10.00 Petco Gift Card

WINNERS BITCH - \$10.00 Petco Gift Card

TERRIER BREEDS

BORDER TERRIERS

BEST OF BREED - \$15.00 Petco Gift Card offered by Richard Craven

MANCHESTER TERRIERS (STANDARD)

The following prizes are offered by Ambrick Manchester Terriers.

BEST OF VARIETY - \$15.00 Petco Gift Card

BEST OF OPPOSITE SEX TO BEST OF VARIETY - \$12.00 Petco Gift Card

TOY BREEDS

CHIHUAHUAS (LONG COAT)

BEST OF VARIETY - \$15.00 Petco Gift Card offered by Tom Widick-Eckery & Gregg Eckery-Widick

HAVANESE

BEST OF BREED - \$15.00 Petco Gift Card offered by Richard Craven

NON-SPORTING BREEDS

BOSTON TERRIERS

The following prizes are offered by Rex & Martha Anderson.

BEST OF BREED - \$15.00 Petco Gift Card

BEST OF WINNERS - \$12.00 Petco Gift Card

BEST OF OPPOSITE SEX TO BEST OF BREED - \$12.00 Petco Gift Card

WINNERS DOG - \$10.00 Petco Gift Card

WINNERS BITCH - \$10.00 Petco Gift Card

HERDING BREEDS

CARDIGAN WELSH CORGIS

BEST OF WINNERS - \$12.00 Petco Gift Card offered by Betsy & Jim Fedde

SHETLAND SHEEPDOGS

BEST OF BREED - \$15.00 Petco Gift Card offered by Trudy A Supalla, Foxhollow Shelties in Memory of Romayne's Uptown Girl CGC TKA RI CD THD

JUNIOR SHOWMANSHIP COMPETITION PRIZES

BEST JUNIOR HANDLER - \$20.00 Petco Gift Card (not redeemable for cash) offered by Ehlers Animal Care

BEST JUNIOR HANDLER - Rosette offered by the Cornhusker Kennel Club of Lincoln, Nebraska, Inc.

RESERVE BEST JUNIOR HANDLER - \$10.00 Petco Gift Card (not redeemable for cash) offered by the Antelope Creek Vet Center

RESERVE BEST JUNIOR HANDLER - Rosette offered by the Cornhusker Kennel Club of Lincoln, Nebraska, Inc.



The following prizes are offered by the Junior Achievement Challenge.

FIRST IN EACH CLASS - 1 Group of AKC Breed Standards (Junior's Choice)

OBEDIENCE TRIAL PRIZES

Qualifying Score required for all prizes in Titling Classes.

A Dark Green Qualifying Ribbon will be given to each dog attaining a Qualifying Score.

PLEASE NOTE: Refund of entry fees for bitches entered in Obedience that come in season after closing date of this show may be obtained provided that a veterinarian's certificate and a request in writing is received by the Show Superintendent no later than 30 minutes prior to the start of judging.

Transfers will be allowed at this trial per AKC Regulations.

Armbands for this Trial will be arranged in descending Jump Height Order.

FOR HIGHEST SCORING DOG IN REGULAR CLASSES

\$50.00 PETCO GIFT CARD

Offered by Kenl Inn

ROSETTE

Offered by the Cornhusker Kennel Club of Lincoln, Nebraska, Inc.

FOR HIGHEST COMBINED SCORE IN OPEN B & UTILITY CLASSES

\$25.00 PETCO GIFT CARD

Offered by Hillcrest Animal Clinic

ROSETTE

Offered by the Cornhusker Kennel Club of Lincoln, Nebraska, Inc.

JAC OBEDIENCE PRIZES



ALL JUNIOR HANDLERS (9 YRS & UNDER 18 YRS) AWARDED A
QUALIFYING

SCORE - 1 Group of AKC Breed Standards (Junior's Choice) offered by the Junior
Achievement Challenge

RALLY TRIAL PRIZES

Qualifying Score required for all prizes.

A Dark Green Qualifying Ribbon will be given to each dog attaining a Qualifying Score.

PLEASE NOTE: Refund of entry fees for bitches entered in Rally that come in season after closing date of this show may be obtained provided that a veterinarian's certificate and a request in writing is received by the Show Superintendent no later than 30 minutes prior to the start of judging.

Transfers will be allowed at this trial per AKC Regulations.

Armbands for this Trial will be arranged in ascending Jump Height Order.

Ring Size: 40 ft X 50 ft

FOR HIGHEST SCORING TRIPLE QUALIFYING SCORE

\$25.00 PETCO GIFT CARD

Offered by Kenl Inn

ROSETTE

Offered by the Cornhusker Kennel Club of Lincoln, Nebraska, Inc.

FOR HIGHEST COMBINED SCORE IN ADVANCED B & EXCELLENT B CLASSES

\$25.00 PETCO GIFT CARD

Offered by Hillcrest Animal Clinic

ROSETTE

Offered by the Cornhusker Kennel Club of Lincoln, Nebraska, Inc.

The Borzoi Club of Greater Omaha
Concurrent Specialty Shows
Allows exhibitors the opportunity to exhibit twice on one day.



THESE SHOWS ARE LIMITED TO 100 ENTRIES PER DAY

SATURDAY, OCTOBER 7, 2023

SUNDAY, OCTOBER 8, 2023

SHOW HOURS - 6:00 am to 6:00 pm

OFFICERS

Caryl Dumaine • President
Josie Haumont • Vice President
Kelley Frary • Treasurer
Kay Cassella • Secretary
4025 Rockenham Cir, Saint George KS 66535

MEMBER AT LARGE

Elizabeth Bucholz

SHOW COMMITTEE

Caryl Dumaine • Show Chairman
5615 Florence Blvd, Omaha NE 68110
Officers of the Club & Members of the Board of Directors

COMMITTEES

Kelly Frary • Trophy

SATURDAY JUDGES

Sweepstakes & Veteran Sweepstakes

Kim Horn Janek - 7707 W State Rd 32, Farmland IN 47340

Regular & Non-Regular Classes

Dr Anne Midgarden, DVM - 2014 Bay Rd, Wapakoneta, OH 45895-8206

SUNDAY JUDGES

Sweepstakes & Veteran Sweepstakes

Justine Spiers -11832 Smith Rd, Loma Rica CA 95901

Regular & Non-Regular Classes

Mrs Jane M Bishop - 711 Pennsylvania Ave, Bridgeport WV 26330

SWEEPSTAKES REQUIREMENTS & CLASSIFICATION

Dogs shown in Sweepstakes must also be entered in one of the regular classes at the regular entry fee and on the regular entry form. Indicate your Sweepstakes Class with the age division in the space provided for "Additional Class." No Professional Handlers may show in Sweepstakes, unless they own the dog.

The following classes will be provided for both dogs and bitches.

Puppy, 6 Mos & Under 9 Mos • Puppy, 9 Mos & Under 12 Mos
Junior, 12 Mos & Under 15 Mos Junior, 15 Mos & Under 18 Mos

DIVISION OF ENTRY MONEY AS PRIZES

35% of total entry fees will be retained by the Club for expenses. The remaining 65% will be divided as in each class as follows:

First - 40% • Second - 30% • Third - 20% • Fourth - 10%

SATURDAY and SUNDAY SWEEPSTAKES PRIZES

BEST IN SWEEPSTAKES - Resin Borzoi Art offered by Renee McCartin, Mielikki Borzoi

BEST OF OPPOSITE SEX TO BEST IN SWEEPSTAKES - Plushie Pet Toy offered by Jim and Debb Meyer, O'Pendragon Borzoi

FIRST IN EACH CLASS - Toy offered by Kay Cassella, Konza Borzoi

VETERAN SWEEPSTAKES REQUIREMENTS & CLASSIFICATION

Dogs shown in Veteran Sweepstakes need not be entered in one of the regular classes or at the regular entry fee. Indicate your Veteran Sweepstakes Class with the age division in the space provided.

The following classes will be provided for both dogs and bitches.

Veteran, 7 Yrs & Under 10 Yrs • Veteran, 10 Yrs & Older

DIVISION OF ENTRY MONEY AS PRIZES

35% of total entry fees will be retained by the Club for expenses. The remaining 65% will be divided as in each class as follows:

First - 40% • Second - 30% • Third - 20% • Fourth - 10%

SATURDAY and SUNDAY VETERAN SWEEPSTAKES PRIZES

BEST IN VETERAN SWEEPSTAKES - Fleece Blanket, offered by Mike and Josie Haumont, Deakon Borzoi

BEST OF OPPOSITE SEX TO BEST IN VETERAN SWEEPSTAKES - Fleece Blanket offered by Mike and Josie Haumont, Deakon Borzoi

<p>THERE WILL BE COMPETITION FOR BEST PUPPY IN PUPPY CLASSES, BEST BRED-BY-EXHIBITOR & BEST VETERAN</p>
--

SATURDAY BREED PRIZES

The Borzoi Club of Greater Omaha offers a Rosette for Best of Breed, Best of Winners, Best of Opposite Sex to Best of Breed, Select Dog, Select Bitch, Winners Dog, Reserve Winners Dog, Winners Bitch, Reserve Winners Bitch, Best Puppy in Puppy Classes, Best Bred-By-Exhibitor, Best Veteran, Stud Dog Class, 1st & Brood Bitch Class, 1st

BEST OF BREED - Gold Plated Russian Wolfhound Club of America Medallion offered by the Borzoi Club of America

BEST OF BREED - Grooming Bag with Spray Bottle offered by Borzoi Club of Greater Omaha

BEST OF WINNERS - Grooming Bag offered by Elizabeth Bucholz

BEST OF OPPOSITE SEX TO BEST OF BREED - Elevated Dog Bed offered by Pam Buffington, Horse & Hound Borzoi

BEST OF OPPOSITE SEX TO BEST OF BREED - Pewter Russian Wolfhound Club of America Medallion offered by the Borzoi Club of America

SELECT DOG - Embellished Spray Bottle offered by Borzoi Club of Greater Omaha

SELECT BITCH - Embellished Spray Bottle offered by Borzoi Club of Greater Omaha

WINNERS DOG - Embellished Spray Bottle offered by Josie and Mike Haumont, Drakon Borzoi

RESERVE WINNERS DOG - Embellished Spray Bottle offered by Kelley Frary, Luxor Borzoi

WINNERS BITCH - Embellished Spray Bottle offered by Elizabeth Bucholz

RESERVE WINNERS BITCH - Embellished Spray Bottle offered by Kelley Frary, Luxor Borzoi

AWARDS OF MERIT

At the discretion of the judge, up to 2 Awards of Merits may be selected from the Best of Breed Competition. These Rosettes offered by the Borzoi Club of Greater Omaha are reserved for those quality animals the judge feels are worthy of final consideration for Best of Breed.

SUNDAY BREED PRIZES

The Borzoi Club of Greater Omaha offers a Rosette for Best of Breed, Best of Winners, Best of Opposite Sex to Best of Breed, Select Dog, Select Bitch, Winners Dog, Reserve Winners Dog, Winners Bitch, Reserve Winners Bitch, Best Puppy in Puppy Classes, Best Bred-By-Exhibitor, Best Veteran, Stud Dog Class, 1st & Brood Bitch Class, 1st.

BEST OF BREED - Gold Plated Russian Wolfhound Club of America Medallion offered by the Borzoi Club of America

BEST OF WINNERS - Grooming Bag offered by Elizabeth Bucholz

BEST OF BREED - Grooming Bag with Spray Bottle offered by Borzoi Club of Greater Omaha

BEST OF OPPOSITE SEX TO BEST OF BREED - Pewter Russian Wolfhound Club of America Medallion offered by the Borzoi Club of America

BEST OF OPPOSITE SEX TO BEST OF BREED - Elevated Dog Bed offered by Pam Buffington, Horse and Hound Borzoi

SELECT DOG - Embellished Spray Bottle offered by Borzoi Club of Greater Omaha

SELECT BITCH - Embellished Spray Bottle offered by Borzoi Club of Greater Omaha

WINNERS DOG - Embellished Spray Bottle offered by Josie and Mike Haumont, Drakon Borzoi

RESERVE WINNERS DOG - Embellished Spray Bottle offered by Kelley Frary, Luxor Borzoi

WINNERS BITCH - Embellished Spray Bottle offered by Elizabeth Bucholz

RESERVE WINNERS BITCH - Embellished Spray Bottle offered by Kelley Frary, Luxor Borzoi

AWARDS OF MERIT

At the discretion of the judge, up to 2 Awards of Merits may be selected from the Best of Breed Competition. These Rosettes offered by the Borzoi Club of Greater Omaha are reserved for those quality animals the judge feels are worthy of final consideration for Best of Breed.

THE MISSOURI VALLEY BOXER CLUB

Concurrent Specialty Show

Allows Exhibitors the opportunity to exhibit twice in one day.



THIS SHOW IS LIMITED TO 100 ENTRIES

SATURDAY, OCTOBER 7, 2023

SHOW HOURS - 6:00 am to 6:00 pm

OFFICERS

- Wade Hilker • President
 - Lee Mitchell • Vice President
 - Sandy Orr • Treasurer
 - Annmarie Andersen • Recording Secretary
 - Jay Kloeckerr • Corresponding Secretary
- 2700 W Raymond Rd, Raymond NE 68428

BOARD OF DIRECTORS

Ann Tomhave • Pamela Savoye

SHOW COMMITTEE

Sandy Orr • Show Chairman
7106 N 57th St, Omaha NE 68152-2301 • (402) 659-8484 • sorr@orrkidboxers.com
Officers of the Club & Members of the Board of Directors

COMMITTEES

- Gail Kloecker • Advertising
- Ann Tomhave • Chief Ring Steward
- Steve Orr • Hospitality
- Lee Mitchell & Annmarie Andersen • Trophies

JUDGE

Regular & Non-Regular Classes

Ms Robin A Hug - PO Box 891, Conifer CO 80433

BREED PRIZES

The Missouri Valley Boxer Club offers a Rosette for Best of Breed, Best of Winners, Best of Opposite Sex to Best of Breed, Select Dog, Select Bitch, Winners Dog, Reserve Winners Dog, Winners Bitch & Reserve Winners Bitch.

Unless otherwise indicated, the following prizes are offered by the Missouri Valley Boxer Club through the generosity of friends and club members.

BEST OF BREED - \$30.00

BEST OF WINNERS - Official ABC Plaque offered by the American Boxer Club

BEST OF OPPOSITE SEX TO BEST OF BREED - \$25.00

SELECT DOG - \$15.00
SELECT BITCH - \$15.00
WINNERS DOG - \$15.00
RESERVE WINNERS DOG - \$12.00
WINNERS BITCH - \$15.00
RESERVE WINNERS BITCH - \$12.00
FIRST IN EACH REGULAR AND NON-REGULAR CLASS - \$10.00

BOXER HOSPITALITY

Boxer exhibitors and friends are invited to
attend our **hospitality on Saturday after the
show**. Location and details will be available at
the show. **FOOD, DRINKS,
RAFFLE, DOOR PRIZES, FUN!!!!**

CORNHUSKER KENNEL CLUB OF LINCOLN, NEBRASKA, INC.

Invites you to join us for our Obedience & Rally C-Match

The match will be from 5:00 pm - 7:00 pm

FRIDAY

Cost is **\$10.00** for 10 minutes of ring time

Sign up the day of Match before end of judging of all Obedience & Rally Or

Mail with payment to: Dian Quist, Obedience Chair 2145 S 52nd St, Lincoln NE 68506

Name:.....

Address:.....

City/State/Zip:.....

Email:.....

Obedience # entries:..... at **\$10.00**/entry = \$.....

Rally # entries:..... at **\$10.00**/entry = \$.....

I (we) certify and represent that the dog(s) entered is not a hazard to other persons or dogs.

Signature:.....

Husker Valley Cluster Reserved Grooming

\$40.00 for a 10' x 10' Space with Electricity

Payment: PayPal or Check

PayPal Address: cornhuskerkc@gmail.com

(Limit 2 grooming spaces per person)

Please mail or email the form!

The form is required to guarantee the reservation!

Name: _____

Address: _____

City: _____ State _____ Zip: _____

Telephone: _____

Email: _____

Breed: _____

Mail reservation form and payment to:

**Cornhusker Kennel Club % Tom Widick-Eckery
3920 Mescal Cir, Lincoln, NE 68516 wiredogs@aol.com**

Please send reservations early. All spaces will have access to shared electricity. People wanting spaces together **MUST** mail their requests together. No more than two 10 x 10 Feet spaces can be reserved by one person.

Limited free grooming space will be available.

NO ELECTRICAL ACCESS IN FREE GROOMING AREA. IF YOU PLUG IN WHILE IN THE FREE GROOMING AREA, YOU WILL BE CHARGED THE \$90.00 FEE THAT THE CLUB PAYS. If you need electricity, please reserve a grooming space. CKC reserves the right to monitor grooming to best utilize the space available.

NO EX-PENS MAY BE PLACED INSIDE THE BUILDING.

RESERVATION DEADLINE: September 20th, 2023

I, the undersigned, understand that this reservation will be accepted on a first-come, first-served basis and that I will accept the space I am assigned. I further understand access to a reserved grooming space is a privilege that can be withdrawn from those who do not follow the rules, regulations and instructions of the Husker Valley Cluster.

Signature: _____

HUSKER VALLEY CLUSTER RESERVED GROOMING LAYOUT

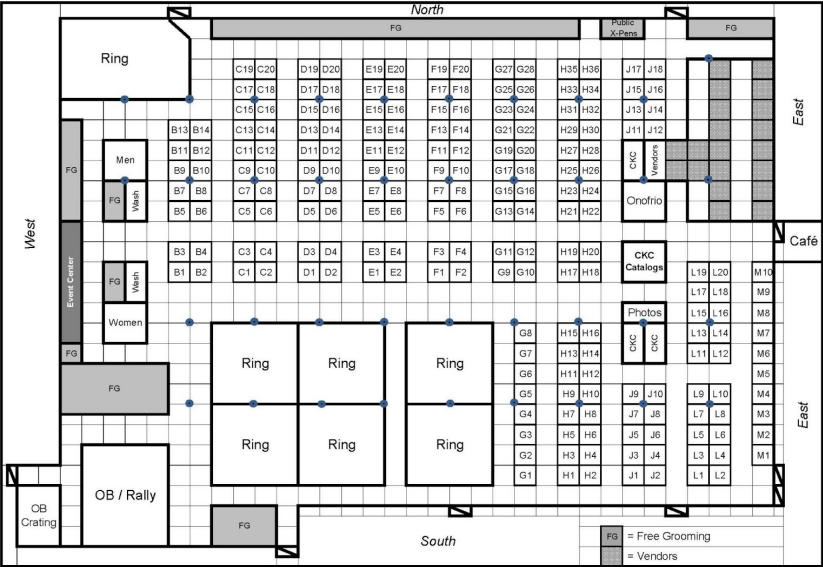



The Cornhusker Kennel Club is pleased to announce
Fast CAT will be offered at this year's cluster!

Does your dog like to chase bunnies?
Come try Fast CAT!

Dogs run one at a time chasing a lure in a timed 100-yard dash.

Each dog's time is converted to MPH to see how fast they've run!

Earn AKC Titles!

Your dog's MPH is converted into points based on a height handicap system.

150 points earns their first title! Two trials per day!

October 6-8, 2023
Lancaster Event Center, Lincoln, NE
Outdoors on grass

Course will be fenced with portable stock fencing.

Reversible, variable speed, continuous loop system.

For More Information Visit:
www.DogSportsAmerica.com/events

OFFICIAL AMERICAN KENNEL CLUB ENTRY FORM

BOTH SIDES OF ENTRY FORM MUST BE SUBMITTED • Appropriate Box(es) MUST BE CHECKED

Appropriate Box(es) MUST BE CHECKED**German Wirehaired Pointer Club of America, Inc.**☐ **FRIDAY, OCTOBER 6, 2023** • ☐ **SATURDAY, OCTOBER 7, 2023**

Lancaster Event Center • 4100 N 84th Street • Lincoln, Nebraska 68507

See page 3 for entry fees

ENTRIES CLOSE WEDNESDAY NOON, SEPTEMBER 20, 2023, or when the limits have been reached, if reached prior to this date at Show Secretary's/ Superintendent's Office. (See limits on page 1)

MAIL ENTRIES with Fees Payable to JACK ONOFRIO, PO Box 25764, Oklahoma City, Oklahoma 73125-0764.

NOTICE: PLEASE PUT BREED & NAME OF SHOW ON CHECKS. I ENCLOSE \$ _____ for entry fees.

IMPORTANT - Read Carefully instructions on reverse side before filling out. Numbers in the boxes indicate sections of the instructions relevant to the information relevant in that box (PLEASE PRINT).

BREED		VARIETY (1)		SEX	
DOG (2) (3) SHOW CLASS			CLASS (3) DIVISION Weight, Color, Etc.		
ADDITIONAL CLASSES		OBEEDIENCE CLASS (Jump Height)	RALLY CLASS (Jump Height)	JR. SHOWMANSHIP CLASS	
NAME OF (See Back) JUNIOR HANDLER (if any)				JR. HANDLER AKC #	
FULL NAME OF DOG					
<input type="checkbox"/> AKC® NO. <input type="checkbox"/> PAL NO. <input type="checkbox"/> FOREIGN REG. NO. & COUNTRY			Enter number here		
			DATE OF BIRTH		
			PLACE OF BIRTH (list country) Do not print the above in the catalog		

BREEDER**SIRE****DAM**

Exhibitor's Code _____

ACTUAL OWNER(S) [4] _____
(Please Print)

OWNER'S ADDRESS _____

CITY _____ STATE _____ ZIP + 4 _____

NAME OF OWNER'S AGENT (IF ANY) AT THIS SHOW

CODE # _____

I CERTIFY that I am the actual owner of the dog, or that I am the duly authorized agent of the actual owner whose name I have entered above. In consideration of the acceptance of this entry, I (we) agree to abide by the rules and regulations of the American Kennel Club in effect at the time of this event, and by any additional rules and regulations appearing in the premium list for this event, and further agree to be bound by the "Agreement" printed on the reverse side of this entry form. I (we) certify and represent that the dog entered is not a hazard to persons or other dogs. This entry is submitted for acceptance on the foregoing representation and Agreement. I (we) agree to conduct myself (ourselves) in accordance with all such Rules and Regulations (including all provisions applying to discipline) and to abide by any decisions made in accord with them.

☒ **SIGNATURE of owner or his agent**

duly authorized to make this entry _____

Telephone () _____

ARE YOU A NEW EXHIBITOR? Yes ☐ No ☐

Email address: _____

(An acknowledgement or receipt of entry may be sent to this email address)

CHECK THIS BOX TO RECEIVE A PRINTED JUDGING PROGRAM ☐

Emergency Contact: _____ Telephone () _____

AGREEMENT

I (we) agree that the club holding this event has the right to refuse this entry for cause which the club shall deem sufficient. In consideration of the acceptance of this entry and of the holding of this event and of the opportunity to have the dog judged and to win prizes, ribbons, or trophies, I (we) agree to hold the AKC, the event-giving club, their members, directors, governors, officers, agents, superintendents or event secretary and the owner and/or lessor of the premises and any provider of services that are necessary to hold this event and any employees or volunteers of the aforementioned parties, and any AKC approved judge, judging at this event, harmless from any claim for loss or injury which may be alleged to have been caused directly or indirectly to any person or thing by the act of this dog while in or about the event premises or grounds or near any entrance thereto, and I (we) personally assume all responsibility and liability for any such claim; and I (we) further agree to hold the aforementioned parties harmless from any claim for loss, injury or damage to this dog. Additionally, I (we) hereby assume the sole responsibility for and agree to indemnify, defend and save the aforementioned parties harmless from any and all loss and expense (including legal fees) by reason of the liability imposed by law upon any of the aforementioned parties for damage because of bodily injuries, including death at any time resulting therefrom, sustained by any person or persons, including myself (ourselves), or on account of damage to property, arising out of or in consequence of my (our) participation in this event, however such, injuries, death or property damage may be caused, and whether or not the same may have been caused or may be alleged to have been caused by the negligence of the aforementioned parties or any of their employees, agents, or any other persons. **I (WE) AGREE THAT ANY CAUSE OF ACTION, CONTROVERSY OR CLAIM ARISING OUT OF OR RELATED TO THE ENTRY, EXHIBITION OR ATTENDANCE AT THE EVENT BETWEEN THE AKC AND THE EVENT-GIVING CLUB (UNLESS OTHERWISE STATED IN ITS PREMIUM LIST) AND MYSELF (OURSELVES) OR AS TO THE CONSTRUCTION, INTERPRETATION AND EFFECT OF THIS AGREEMENT SHALL BE SETTLED BY ARBITRATION PURSUANT TO THE APPLICABLE RULES OF THE AMERICAN ARBITRATION ASSOCIATION. HOWEVER, PRIOR TO ARBITRATION ALL APPLICABLE AKC BYLAWS, RULES, REGULATIONS AND PROCEDURES MUST FIRST BE FOLLOWED AS SET FORTH IN THE AKC CHARTER AND BYLAWS, RULES, REGULATIONS, PUBLISHED POLICIES AND GUIDELINES.**

INSTRUCTIONS

- (Variety) if you are entering a dog of breed in which there are varieties for show purposes, please designate the particular variety you are entering i.e., Cocker Spaniel (solid color black, ASCOB, parti-color). Beagles (not exceeding 13 in. over 13 in. but not exceeding 15 in.). Dachshunds (longhaired, smooth, wirehaired), Bull Terriers (colored, white), Manchester Terriers (standard, toy), Chihuahuas (smooth coat, long coat), English Toy Spaniels (King Charles and Ruby, Blenheim and Prince Charles), Poodles (toy, miniature, standard), Collies (rough, smooth),
- The following categories of dogs may be entered and shown in Best of Breed competition; Dogs that are Champions of Record and dogs which, according to their owner's records, have completed the requirements for a championship, but whose championships are unconfirmed. The showing of unconfirmed Champions in Best of Breed competition is limited to a period of 90 days from the date of the show where the dog completed the requirements for a championship.
- (Event Class) Consult the classification in this premium list. If the event class in which you are entering your dog is divided, then, in addition to designating the class, specify the particular division of the class in which you are entering your dog, i.e., age division, color division, weight division.
- A dog must be entered in the name of the person who actually owned it at the time entries for an event closed. If a registered dog has been acquired by a new owner, it must be entered in the name of its new owner in any event for which entries closed after the date of acquisition, regardless of whether the new owner has received the registration certificate indicating that the dog is recorded in his name. State on entry form whether transfer application has been mailed to the AKC (For complete rules refer to Chapter 11, Section 3).
- Mixed Breed dogs entering classes for Agility, Obedience and Rally trials should mark Breed as AKC Canine Partners Listed Dog "All-American Dog/Mixed Breed." Sire and Dam information shall remain blank for mixed breed entrants.

If this entry is for Jr Showmanship, please enter the following information:

JUNIOR SHOWMANSHIP
AKC JR HANDLER NUMBER

JR.'S DATE OF BIRTH _____

The above number MUST be included. Should you not have your Junior Handler number, this may be obtained from the AMERICAN KENNEL CLUB. PHONE:(919) 233-9767.

By signing the entry form I (we) certify that the Junior Showman does not now, and will not at any time, act as an agent/handler for pay while continuing to compete in Junior Showmanship.

ADDRESS

City

State

OFFICIAL AMERICAN KENNEL CLUB ENTRY FORM

BOTH SIDES OF ENTRY FORM MUST BE SUBMITTED • Appropriate Box(es) MUST BE CHECKED

Specialties/Group Show - FRIDAY, OCTOBER 6, 2023

- ☐ Missouri Valley Boxer Club - 1st Specialty • ☐ Missouri Valley Boxer Club - 2nd Specialty
☐ GROUP SHOW - Greater Omaha Terrier Association
☐ Eastern Nebraska Boston Terrier Club - 1st Specialty • ☐ Eastern Nebraska Boston Terrier Club - 2nd Specialty
☐ Midlands Shetland Sheepdog Club, Inc. - 1st Specialty ☐ Midlands Shetland Sheepdog Club, Inc. - 2nd Specialty
Lancaster Event Center • 4100 N 84th Street • Lincoln, Nebraska 68507
See page 3 for entry fees

ENTRIES CLOSE WEDNESDAY NOON, SEPTEMBER 20, 2023, or when the limits have been reached, if reached prior to this date at Superintendent's Office. (See limits on page 1)

MAIL ENTRIES with Fees Payable to JACK ONOFRIO, PO Box 25764, Oklahoma City, Oklahoma 73125-0764.

NOTICE: PLEASE PUT BREED & NAME OF SHOW ON CHECKS. I ENCLOSE \$ _____ for entry fees.

IMPORTANT - Read Carefully instructions on reverse side before filling out. Numbers in the boxes indicate sections of the instructions relevant to the information needed in that box (PLEASE PRINT).

BREED		VARIETY (1)		SEX
DOG (2) (3) SHOW CLASS			CLASS (3) DIVISION Weight, Color, Etc.	
ADDITIONAL CLASSES	OBEDIENCE CLASS (Jump Height)	RALLY CLASS (Jump Height)	JR. SHOWMANSHIP CLASS	
NAME OF (See Back) JUNIOR HANDLER (if any)			JR. HANDLER AKC #	
FULL NAME OF DOG				
Enter number here		DATE OF BIRTH		
<input type="checkbox"/> AKC® NO. <input type="checkbox"/> PAL NO. <input type="checkbox"/> FOREIGN REG. NO. & COUNTRY		PLACE OF BIRTH (list country) Do not print the above in the catalog		

BREEDER**SIRE****DAM**

Exhibitor's Code _____

ACTUAL OWNER(S) [4] _____
(Please Print)

OWNER'S ADDRESS _____

CITY _____ STATE _____ ZIP + 4 _____

NAME OF OWNER'S AGENT (IF ANY) AT THIS SHOW _____ CODE # _____

I CERTIFY that I am the actual owner of the dog, or that I am the duly authorized agent of the actual owner whose name I have entered above. In consideration of the acceptance of this entry, I (we) agree to abide by the rules and regulations of the American Kennel Club in effect at the time of this event, and by any additional rules and regulations appearing in the premium list for this event, and further agree to be bound by the "Agreement" printed on the reverse side of this entry form. I (we) certify and represent that the dog entered is not a hazard to persons or other dogs. This entry is submitted for acceptance on the foregoing representation and Agreement. I (we) agree to conduct myself (ourselves) in accordance with all such Rules and Regulations (including all provisions applying to discipline) and to abide by any decisions made in accord with them.

☒ **SIGNATURE of owner or his agent**
duly authorized to make this entry _____ Telephone () _____

ARE YOU A NEW EXHIBITOR? Yes ☐ No ☐OWNER-HANDLED ELIGIBLE? Yes ☐ No ☐

Email address: _____

(An acknowledgement or receipt of entry may be sent to this email address)

CHECK THIS BOX TO RECEIVE A PRINTED JUDGING PROGRAM ☐

Emergency Contact: _____ Telephone () _____

AGREEMENT

I (we) agree that the club holding this event has the right to refuse this entry for cause which the club shall deem sufficient. In consideration of the acceptance of this entry and of the holding of this event and of the opportunity to have the dog judged and to win prizes, ribbons, or trophies, I (we) agree to hold the AKC, the event-giving club, their members, directors, governors, officers, agents, superintendents or event secretary and the owner and/or lessor of the premises and any provider of services that are necessary to hold this event and any employees or volunteers of the aforementioned parties, and any AKC approved judge, judging at this event, harmless from any claim for loss or injury which may be alleged to have been caused directly or indirectly to any person or thing by the act of this dog while in or about the event premises or grounds or near any entrance thereto, and I (we) personally assume all responsibility and liability for any such claim; and I (we) further agree to hold the aforementioned parties harmless from any claim for loss, injury or damage to this dog. Additionally, I (we) hereby assume the sole responsibility for and agree to indemnify, defend and save the aforementioned parties harmless from any and all loss and expense (including legal fees) by reason of the liability imposed by law upon any of the aforementioned parties for damage because of bodily injuries, including death at any time resulting therefrom, sustained by any person or persons, including myself (ourselves), or on account of damage to property, arising out of or in consequence of my (our) participation in this event, however such, injuries, death or property damage may be caused, and whether or not the same may have been caused or may be alleged to have been caused by the negligence of the aforementioned parties or any of their employees, agents, or any other persons. **I (WE) AGREE THAT ANY CAUSE OF ACTION, CONTROVERSY OR CLAIM ARISING OUT OF OR RELATED TO THE ENTRY, EXHIBITION OR ATTENDANCE AT THE EVENT BETWEEN THE AKC AND THE EVENT-GIVING CLUB (UNLESS OTHERWISE STATED IN ITS PREMIUM LIST) AND MYSELF (OURSELVES) OR AS TO THE CONSTRUCTION, INTERPRETATION AND EFFECT OF THIS AGREEMENT SHALL BE SETTLED BY ARBITRATION PURSUANT TO THE APPLICABLE RULES OF THE AMERICAN ARBITRATION ASSOCIATION. HOWEVER, PRIOR TO ARBITRATION ALL APPLICABLE AKC BYLAWS, RULES, REGULATIONS AND PROCEDURES MUST FIRST BE FOLLOWED AS SET FORTH IN THE AKC CHARTER AND BYLAWS, RULES, REGULATIONS, PUBLISHED POLICIES AND GUIDELINES.**

INSTRUCTIONS

- (Variety) if you are entering a dog of breed in which there are varieties for show purposes, please designate the particular variety you are entering i.e., Cocker Spaniel (solid color black, ASCOB, parti-color). Beagles (not exceeding 13 in. over 13 in. but not exceeding 15 in.). Dachshunds (longhaired, smooth, wirehaired), Bull Terriers (colored, white), Manchester Terriers (standard, toy), Chihuahuas (smooth coat, long coat), English Toy Spaniels (King Charles and Ruby, Blenheim and Prince Charles), Poodles (toy, miniature, standard), Collies (rough, smooth),
- The following categories of dogs may be entered and shown in Best of Breed competition; Dogs that are Champions of Record and dogs which, according to their owner's records, have completed the requirements for a championship, but whose championships are unconfirmed. The showing of unconfirmed Champions in Best of Breed competition is limited to a period of 90 days from the date of the show where the dog completed the requirements for a championship.
- (Event Class) Consult the classification in this premium list. If the event class in which you are entering your dog is divided, then, in addition to designating the class, specify the particular division of the class in which you are entering your dog, i.e., age division, color division, weight division.
- A dog must be entered in the name of the person who actually owned it at the time entries for an event closed. If a registered dog has been acquired by a new owner, it must be entered in the name of its new owner in any event for which entries closed after the date of acquisition, regardless of whether the new owner has received the registration certificate indicating that the dog is recorded in his name. State on entry form whether transfer application has been mailed to the AKC (For complete rules refer to Chapter 11, Section 3).
- Mixed Breed dogs entering classes for Agility, Obedience and Rally trials should mark Breed as AKC Canine Partners Listed Dog "All-American Dog/Mixed Breed." Sire and Dam information shall remain blank for mixed breed entrants.

If this entry is for Jr Showmanship, please enter the following information:

JUNIOR SHOWMANSHIP
AKC JR HANDLER NUMBER

JR.'S DATE OF BIRTH _____

The above number MUST be included. Should you not have your Junior Handler number, this may be obtained from the AMERICAN KENNEL CLUB. PHONE:(919) 233-9767.

By signing the entry form I (we) certify that the Junior Showman does not now, and will not at any time, act as an agent/handler for pay while continuing to compete in Junior Showmanship.

ADDRESS _____

City _____

State _____

ZIP _____

OFFICIAL AMERICAN KENNEL CLUB ENTRY FORM

BOTH SIDES OF ENTRY FORM MUST BE SUBMITTED • Appropriate Box(es) MUST BE CHECKED

Appropriate Box(es) MUST BE CHECKED
All Breed Dog Shows, Obedience & Rally Trials
Cornhusker Kennel Club of Lincoln, Nebraska, Inc.☐ SATURDAY, OCTOBER 7, 2023 • ☐ 4-6 Month Beginner Puppy Competition☐ SUNDAY, OCTOBER 8, 2023

Lancaster Event Center • 4100 N 84th Street • Lincoln, Nebraska 68507

See page 3 for entry fees

ENTRIES CLOSE WEDNESDAY NOON, September 20, 2023, or when the limit has been reached, if reached prior to this date at Superintendent's Office. (See limit on page 1)

MAIL ENTRIES with Fees Payable to JACK ONOFRIO, PO Box 25764, Oklahoma City, Oklahoma 73125-0764.

NOTICE: PLEASE PUT BREED & NAME OF SHOW ON CHECKS. I ENCLOSE \$_____ for entry fees.**IMPORTANT - Read Carefully instructions on reverse side before filling out. Numbers in the boxes indicate sections of the instructions relevant to the information needed in that box (PLEASE PRINT).**

BREED		VARIETY (1)		SEX
DOG (2) (3) SHOW CLASS			CLASS (3) DIVISION Weight, Color, Etc.	
ADDITIONAL CLASSES	OBEDIENCE CLASS (Jump Height)	RALLY CLASS (Jump Height)	JR. SHOWMANSHIP CLASS	
NAME OF (See Back) JUNIOR HANDLER (if any)			JR. HANDLER AKC #	
FULL NAME OF DOG				
<input type="checkbox"/> AKC® NO.		Enter number here	DATE OF BIRTH	
<input type="checkbox"/> PAL NO.			PLACE OF BIRTH (list country)	
<input type="checkbox"/> FOREIGN REG. NO. & COUNTRY			Do not print the above in the catalog	

BREEDER**SIRE****DAM****Exhibitor's Code** _____**ACTUAL OWNER(S) [4]** _____
(Please Print)**OWNER'S ADDRESS** _____**CITY** _____ **STATE** _____ **ZIP + 4** _____**NAME OF OWNER'S AGENT (IF ANY) AT THIS SHOW** _____ **CODE #** _____

I CERTIFY that I am the actual owner of the dog, or that I am the duly authorized agent of the actual owner whose name I have entered above. In consideration of the acceptance of this entry, I (we) agree to abide by the rules and regulations of the American Kennel Club in effect at the time of this event, and by any additional rules and regulations appearing in the premium list for this event, and further agree to be bound by the "Agreement" printed on the reverse side of this entry form. I (we) certify and represent that the dog entered is not a hazard to persons or other dogs. This entry is submitted for acceptance on the foregoing representation and Agreement. I (we) agree to conduct myself (ourselves) in accordance with all such Rules and Regulations (including all provisions applying to discipline) and to abide by any decisions made in accord with them.

☒ **SIGNATURE of owner or his agent**

duly authorized to make this entry _____ Telephone () _____

ARE YOU A NEW EXHIBITOR? Yes ☐ No ☐ **OWNER-HANDLED ELIGIBLE?** Yes ☐ No ☐**Email address:** _____

(An acknowledgement or receipt of entry may be sent to this email address)

CHECK THIS BOX TO RECEIVE A PRINTED JUDGING PROGRAM ☐**Emergency Contact:** _____ **Telephone ()** _____

AGREEMENT

I (we) agree that the club holding this event has the right to refuse this entry for cause which the club shall deem sufficient. In consideration of the acceptance of this entry and of the holding of this event and of the opportunity to have the dog judged and to win prizes, ribbons, or trophies, I (we) agree to hold the AKC, the event-giving club, their members, directors, governors, officers, agents, superintendents or event secretary and the owner and/or lessor of the premises and any provider of services that are necessary to hold this event and any employees or volunteers of the aforementioned parties, and any AKC approved judge, judging at this event, harmless from any claim for loss or injury which may be alleged to have been caused directly or indirectly to any person or thing by the act of this dog while in or about the event premises or grounds or near any entrance thereto, and I (we) personally assume all responsibility and liability for any such claim; and I (we) further agree to hold the aforementioned parties harmless from any claim for loss, injury or damage to this dog. Additionally, I (we) hereby assume the sole responsibility for and agree to indemnify, defend and save the aforementioned parties harmless from any and all loss and expense (including legal fees) by reason of the liability imposed by law upon any of the aforementioned parties for damage because of bodily injuries, including death at any time resulting therefrom, sustained by any person or persons, including myself (ourselves), or on account of damage to property, arising out of or in consequence of my (our) participation in this event, however such, injuries, death or property damage may be caused, and whether or not the same may have been caused or may be alleged to have been caused by the negligence of the aforementioned parties or any of their employees, agents, or any other persons. **I (WE) AGREE THAT ANY CAUSE OF ACTION, CONTROVERSY OR CLAIM ARISING OUT OF OR RELATED TO THE ENTRY, EXHIBITION OR ATTENDANCE AT THE EVENT BETWEEN THE AKC AND THE EVENT-GIVING CLUB (UNLESS OTHERWISE STATED IN ITS PREMIUM LIST) AND MYSELF (OURSELVES) OR AS TO THE CONSTRUCTION, INTERPRETATION AND EFFECT OF THIS AGREEMENT SHALL BE SETTLED BY ARBITRATION PURSUANT TO THE APPLICABLE RULES OF THE AMERICAN ARBITRATION ASSOCIATION. HOWEVER, PRIOR TO ARBITRATION ALL APPLICABLE AKC BYLAWS, RULES, REGULATIONS AND PROCEDURES MUST FIRST BE FOLLOWED AS SET FORTH IN THE AKC CHARTER AND BYLAWS, RULES, REGULATIONS, PUBLISHED POLICIES AND GUIDELINES.**

INSTRUCTIONS

- (Variety) if you are entering a dog of breed in which there are varieties for show purposes, please designate the particular variety you are entering i.e., Cocker Spaniel (solid color black, ASCOB, parti-color). Beagles (not exceeding 13 in. over 13 in. but not exceeding 15 in.). Dachshunds (longhaired, smooth, wirehaired), Bull Terriers (colored, white), Manchester Terriers (standard, toy), Chihuahuas (smooth coat, long coat), English Toy Spaniels (King Charles and Ruby, Blenheim and Prince Charles), Poodles (toy, miniature, standard), Collies (rough, smooth),
- The following categories of dogs may be entered and shown in Best of Breed competition; Dogs that are Champions of Record and dogs which, according to their owner's records, have completed the requirements for a championship, but whose championships are unconfirmed. The showing of unconfirmed Champions in Best of Breed competition is limited to a period of 90 days from the date of the show where the dog completed the requirements for a championship.
- (Event Class) Consult the classification in this premium list. If the event class in which you are entering your dog is divided, then, in addition to designating the class, specify the particular division of the class in which you are entering your dog, i.e., age division, color division, weight division.
- A dog must be entered in the name of the person who actually owned it at the time entries for an event closed. If a registered dog has been acquired by a new owner, it must be entered in the name of its new owner in any event for which entries closed after the date of acquirement, regardless of whether the new owner has received the registration certificate indicating that the dog is recorded in his name. State on entry form whether transfer application has been mailed to the AKC (For complete rules refer to Chapter 11, Section 3).
- Mixed Breed dogs entering classes for Agility, Obedience and Rally trials should mark Breed as AKC Canine Partners Listed Dog "All-American Dog/Mixed Breed." Sire and Dam information shall remain blank for mixed breed entrants.

If this entry is for Jr Showmanship, please enter the following information:

JUNIOR SHOWMANSHIP

JR.'S DATE OF BIRTH _____

AKC JR HANDLER NUMBER _____

The above number **MUST** be included. Should you not have your Junior Handler number, this may be obtained from the AMERICAN KENNEL CLUB. PHONE:(919) 233-9767.

By signing the entry form I (we) certify that the Junior Showman does not now, and will not at any time, act as an agent/handler for pay while continuing to compete in Junior Showmanship.

ADDRESS

City _____

State _____

ZIP _____

OFFICIAL AMERICAN KENNEL CLUB ENTRY FORM

BOTH SIDES OF ENTRY FORM MUST BE SUBMITTED • Appropriate Box(es) MUST BE CHECKED

Appropriate Box(es) MUST BE CHECKED
All Breed Dog Shows, Obedience & Rally Trials
Cornhusker Kennel Club of Lincoln, Nebraska, Inc.☐ SATURDAY, OCTOBER 7, 2023 • ☐ 4-6 Month Beginner Puppy Competition☐ SUNDAY, OCTOBER 8, 2023

Lancaster Event Center • 4100 N 84th Street • Lincoln, Nebraska 68507

See page 3 for entry fees

ENTRIES CLOSE WEDNESDAY NOON, September 20, 2023, or when the limit has been reached, if reached prior to this date at Superintendent's Office. (See limit on page 1)

MAIL ENTRIES with Fees Payable to JACK ONOFRIO, PO Box 25764, Oklahoma City, Oklahoma 73125-0764.

NOTICE: PLEASE PUT BREED & NAME OF SHOW ON CHECKS. I ENCLOSE \$_____ for entry fees.**IMPORTANT - Read Carefully instructions on reverse side before filling out. Numbers in the boxes indicate sections of the instructions relevant to the information needed in that box (PLEASE PRINT).**

BREED		VARIETY (1)	SEX
DOG (2) (3) SHOW CLASS		CLASS (3) DIVISION Weight, Color, Etc.	
ADDITIONAL CLASSES	OBEEDIENCE CLASS (Jump Height)	RALLY CLASS (Jump Height)	JR. SHOWMANSHIP CLASS
NAME OF (See Back) JUNIOR HANDLER (if any)			JR. HANDLER AKC #
FULL NAME OF DOG			
<input type="checkbox"/> AKC® NO. <input type="checkbox"/> PAL NO. <input type="checkbox"/> FOREIGN REG. NO. & COUNTRY		Enter number here DATE OF BIRTH PLACE OF BIRTH (list country) Do not print the above in the catalog	

BREEDER**SIRE****DAM****Exhibitor's Code** _ _ _ _ _**ACTUAL OWNER(S) [4]** _____
(Please Print)**OWNER'S ADDRESS** _____**CITY** _____ **STATE** _____ **ZIP + 4** _____**NAME OF OWNER'S AGENT (IF ANY) AT THIS SHOW** _____ **CODE #** _____

I CERTIFY that I am the actual owner of the dog, or that I am the duly authorized agent of the actual owner whose name I have entered above. In consideration of the acceptance of this entry, I (we) agree to abide by the rules and regulations of the American Kennel Club in effect at the time of this event, and by any additional rules and regulations appearing in the premium list for this event, and further agree to be bound by the "Agreement" printed on the reverse side of this entry form. I (we) certify and represent that the dog entered is not a hazard to persons or other dogs. This entry is submitted for acceptance on the foregoing representation and Agreement. I (we) agree to conduct myself (ourselves) in accordance with all such Rules and Regulations (including all provisions applying to discipline) and to abide by any decisions made in accord with them.

☒ **SIGNATURE of owner or his agent**

duly authorized to make this entry _____ Telephone () _____

ARE YOU A NEW EXHIBITOR? Yes ☐ No ☐ **OWNER-HANDLED ELIGIBLE?** Yes ☐ No ☐**Email address:** _____

(An acknowledgement or receipt of entry may be sent to this email address)

CHECK THIS BOX TO RECEIVE A PRINTED JUDGING PROGRAM ☐**Emergency Contact:** _____ **Telephone ()** _____

AGREEMENT

I (we) agree that the club holding this event has the right to refuse this entry for cause which the club shall deem sufficient. In consideration of the acceptance of this entry and of the holding of this event and of the opportunity to have the dog judged and to win prizes, ribbons, or trophies, I (we) agree to hold the AKC, the event-giving club, their members, directors, governors, officers, agents, superintendents or event secretary and the owner and/or lessor of the premises and any provider of services that are necessary to hold this event and any employees or volunteers of the aforementioned parties, and any AKC approved judge, judging at this event, harmless from any claim for loss or injury which may be alleged to have been caused directly or indirectly to any person or thing by the act of this dog while in or about the event premises or grounds or near any entrance thereto, and I (we) personally assume all responsibility and liability for any such claim; and I (we) further agree to hold the aforementioned parties harmless from any claim for loss, injury or damage to this dog. Additionally, I (we) hereby assume the sole responsibility for and agree to indemnify, defend and save the aforementioned parties harmless from any and all loss and expense (including legal fees) by reason of the liability imposed by law upon any of the aforementioned parties for damage because of bodily injuries, including death at any time resulting therefrom, sustained by any person or persons, including myself (ourselves), or on account of damage to property, arising out of or in consequence of my (our) participation in this event, however such, injuries, death or property damage may be caused, and whether or not the same may have been caused or may be alleged to have been caused by the negligence of the aforementioned parties or any of their employees, agents, or any other persons. **I (WE) AGREE THAT ANY CAUSE OF ACTION, CONTROVERSY OR CLAIM ARISING OUT OF OR RELATED TO THE ENTRY, EXHIBITION OR ATTENDANCE AT THE EVENT BETWEEN THE AKC AND THE EVENT-GIVING CLUB (UNLESS OTHERWISE STATED IN ITS PREMIUM LIST) AND MYSELF (OURSELVES) OR AS TO THE CONSTRUCTION, INTERPRETATION AND EFFECT OF THIS AGREEMENT SHALL BE SETTLED BY ARBITRATION PURSUANT TO THE APPLICABLE RULES OF THE AMERICAN ARBITRATION ASSOCIATION. HOWEVER, PRIOR TO ARBITRATION ALL APPLICABLE AKC BYLAWS, RULES, REGULATIONS AND PROCEDURES MUST FIRST BE FOLLOWED AS SET FORTH IN THE AKC CHARTER AND BYLAWS, RULES, REGULATIONS, PUBLISHED POLICIES AND GUIDELINES.**

INSTRUCTIONS

- (Variety) if you are entering a dog of breed in which there are varieties for show purposes, please designate the particular variety you are entering i.e., Cocker Spaniel (solid color black, ASCOB, parti-color). Beagles (not exceeding 13 in. over 13 in. but not exceeding 15 in.). Dachshunds (longhaired, smooth, wirehaired), Bull Terriers (colored, white), Manchester Terriers (standard, toy), Chihuahuas (smooth coat, long coat), English Toy Spaniels (King Charles and Ruby, Blenheim and Prince Charles), Poodles (toy, miniature, standard), Collies (rough, smooth),
- The following categories of dogs may be entered and shown in Best of Breed competition; Dogs that are Champions of Record and dogs which, according to their owner's records, have completed the requirements for a championship, but whose championships are unconfirmed. The showing of unconfirmed Champions in Best of Breed competition is limited to a period of 90 days from the date of the show where the dog completed the requirements for a championship.
- (Event Class) Consult the classification in this premium list. If the event class in which you are entering your dog is divided, then, in addition to designating the class, specify the particular division of the class in which you are entering your dog, i.e., age division, color division, weight division.
- A dog must be entered in the name of the person who actually owned it at the time entries for an event closed. If a registered dog has been acquired by a new owner, it must be entered in the name of its new owner in any event for which entries closed after the date of acquirement, regardless of whether the new owner has received the registration certificate indicating that the dog is recorded in his name. State on entry form whether transfer application has been mailed to the AKC (For complete rules refer to Chapter 11, Section 3).
- Mixed Breed dogs entering classes for Agility, Obedience and Rally trials should mark Breed as AKC Canine Partners Listed Dog "All-American Dog/Mixed Breed." Sire and Dam information shall remain blank for mixed breed entrants.

If this entry is for Jr Showmanship, please enter the following information:

JUNIOR SHOWMANSHIP

JR.'S DATE OF BIRTH _____

AKC JR HANDLER NUMBER _____

The above number **MUST** be included. Should you not have your Junior Handler number, this may be obtained from the AMERICAN KENNEL CLUB. PHONE:(919) 233-9767.

By signing the entry form I (we) certify that the Junior Showman does not now, and will not at any time, act as an agent/handler for pay while continuing to compete in Junior Showmanship.

ADDRESS

City _____

State _____

ZIP _____

OFFICIAL AMERICAN KENNEL CLUB ENTRY FORM

BOTH SIDES OF ENTRY FORM MUST BE SUBMITTED • Appropriate Box(es) MUST BE CHECKED

Appropriate Box(es) MUST BE CHECKED**OPEN SHOWS**

SPONSORED BY CORNHUSKER KENNEL CLUB OF LINCOLN, NEBRASKA, INC.

☐ SATURDAY, OCTOBER 7, 2023 • ☐ SUNDAY, OCTOBER 8, 2023

Lancaster Event Center • 4100 N 84th Street • Lincoln, Nebraska 68507

See page 3 for entry fees

ENTRIES CLOSE WEDNESDAY NOON, September 20, 2023, at Superintendent's Office.

MAIL ENTRIES with Fees Payable to JACK ONOFRIO, PO Box 25764, Oklahoma City, Oklahoma 73125-0764.

NOTICE: PLEASE PUT BREED & NAME OF SHOW ON CHECKS. I ENCLOSE \$_____ for entry fees.**IMPORTANT - Read Carefully instructions on reverse side before filling out. Numbers in the boxes indicate sections of the instructions relevant to the information needed in that box (PLEASE PRINT).**

BREED		VARIETY (1)		SEX
DOG (2) (3) SHOW CLASS			CLASS (3) DIVISION Weight, Color, Etc.	
ADDITIONAL CLASSES	OBEDIENCE CLASS (Jump Height)	RALLY CLASS (Jump Height)	JR. SHOWMANSHIP CLASS	
NAME OF (See Back) JUNIOR HANDLER (if any)			JR. HANDLER AKC #	
FULL NAME OF DOG				
<input type="checkbox"/> AKC® NO.		Enter number here	DATE OF BIRTH	
<input type="checkbox"/> PAL NO.			PLACE OF BIRTH (list country)	
<input type="checkbox"/> FOREIGN REG. NO. & COUNTRY			Do not print the above in the catalog	

BREEDER**SIRE****DAM**

Exhibitor's Code _____

ACTUAL OWNER(S) [4] _____
(Please Print)**OWNER'S ADDRESS** _____**CITY** _____ **STATE** _____ **ZIP + 4** _____**NAME OF OWNER'S AGENT (IF ANY) AT THIS SHOW** _____ **CODE #** _____

I CERTIFY that I am the actual owner of the dog, or that I am the duly authorized agent of the actual owner whose name I have entered above. In consideration of the acceptance of this entry, I (we) agree to abide by the rules and regulations of the American Kennel Club in effect at the time of this event, and by any additional rules and regulations appearing in the premium list for this event, and further agree to be bound by the "Agreement" printed on the reverse side of this entry form. I (we) certify and represent that the dog entered is not a hazard to persons or other dogs. This entry is submitted for acceptance on the foregoing representation and Agreement. I (we) agree to conduct myself (ourselves) in accordance with all such Rules and Regulations (including all provisions applying to discipline) and to abide by any decisions made in accord with them.

■ SIGNATURE of owner or his agent

duly authorized to make this entry _____

Telephone () _____**ARE YOU A NEW EXHIBITOR? Yes ☐ No ☐****Email address:** _____

(An acknowledgement or receipt of entry may be sent to this email address)

CHECK THIS BOX TO RECEIVE A PRINTED JUDGING PROGRAM ☐**Emergency Contact:** _____ **Telephone ()** _____

AGREEMENT

I (we) agree that the club holding this event has the right to refuse this entry for cause which the club shall deem sufficient. In consideration of the acceptance of this entry and of the holding of this event and of the opportunity to have the dog judged and to win prizes, ribbons, or trophies, I (we) agree to hold the AKC, the event-giving club, their members, directors, governors, officers, agents, superintendents or event secretary and the owner and/or lessor of the premises and any provider of services that are necessary to hold this event and any employees or volunteers of the aforementioned parties, and any AKC approved judge, judging at this event, harmless from any claim for loss or injury which may be alleged to have been caused directly or indirectly to any person or thing by the act of this dog while in or about the event premises or grounds or near any entrance thereto, and I (we) personally assume all responsibility and liability for any such claim; and I (we) further agree to hold the aforementioned parties harmless from any claim for loss, injury or damage to this dog. Additionally, I (we) hereby assume the sole responsibility for and agree to indemnify, defend and save the aforementioned parties harmless from any and all loss and expense (including legal fees) by reason of the liability imposed by law upon any of the aforementioned parties for damage because of bodily injuries, including death at any time resulting therefrom, sustained by any person or persons, including myself (ourselves), or on account of damage to property, arising out of or in consequence of my (our) participation in this event, however such, injuries, death or property damage may be caused, and whether or not the same may have been caused or may be alleged to have been caused by the negligence of the aforementioned parties or any of their employees, agents, or any other persons. **I (WE) AGREE THAT ANY CAUSE OF ACTION, CONTROVERSY OR CLAIM ARISING OUT OF OR RELATED TO THE ENTRY, EXHIBITION OR ATTENDANCE AT THE EVENT BETWEEN THE AKC AND THE EVENT-GIVING CLUB (UNLESS OTHERWISE STATED IN ITS PREMIUM LIST) AND MYSELF (OURSELVES) OR AS TO THE CONSTRUCTION, INTERPRETATION AND EFFECT OF THIS AGREEMENT SHALL BE SETTLED BY ARBITRATION PURSUANT TO THE APPLICABLE RULES OF THE AMERICAN ARBITRATION ASSOCIATION. HOWEVER, PRIOR TO ARBITRATION ALL APPLICABLE AKC BYLAWS, RULES, REGULATIONS AND PROCEDURES MUST FIRST BE FOLLOWED AS SET FORTH IN THE AKC CHARTER AND BYLAWS, RULES, REGULATIONS, PUBLISHED POLICIES AND GUIDELINES.**

INSTRUCTIONS

1. (Variety) if you are entering a dog of breed in which there are varieties for show purposes, please designate the particular variety you are entering i.e., Cocker Spaniel (solid color black, ASCOB, parti-color). Beagles (not exceeding 13 in. over 13 in. but not exceeding 15 in.). Dachshunds (longhaired, smooth, wirehaired), Bull Terriers (colored, white), Manchester Terriers (standard, toy), Chihuahuas (smooth coat, long coat), English Toy Spaniels (King Charles and Ruby, Blenheim and Prince Charles), Poodles (toy, miniature, standard), Collies (rough, smooth),
2. The following categories of dogs may be entered and shown in Best of Breed competition; Dogs that are Champions of Record and dogs which, according to their owner's records, have completed the requirements for a championship, but whose championships are unconfirmed. The showing of unconfirmed Champions in Best of Breed competition is limited to a period of 90 days from the date of the show where the dog completed the requirements for a championship.
3. (Event Class) Consult the classification in this premium list. If the event class in which you are entering your dog is divided, then, in addition to designating the class, specify the particular division of the class in which you are entering your dog, i.e., age division, color division, weight division.
4. A dog must be entered in the name of the person who actually owned it at the time entries for an event closed. If a registered dog has been acquired by a new owner, it must be entered in the name of its new owner in any event for which entries closed after the date of acquirement, regardless of whether the new owner has received the registration certificate indicating that the dog is recorded in his name. State on entry form whether transfer application has been mailed to the AKC (For complete rules refer to Chapter 11, Section 3).
5. Mixed Breed dogs entering classes for Agility, Obedience and Rally trials should mark Breed as AKC Canine Partners Listed Dog "All-American Dog/Mixed Breed." Sire and Dam information shall remain blank for mixed breed entrants.

If this entry is for Jr Showmanship, please enter the following information:

JUNIOR SHOWMANSHIP
AKC JR HANDLER NUMBER

JR.'S DATE OF BIRTH _____

The above number **MUST** be included. Should you not have your Junior Handler number, this may be obtained from the AMERICAN KENNEL CLUB. PHONE:(919) 233-9767.

By signing the entry form I (we) certify that the Junior Showman does not now, and will not at any time, act as an agent/handler for pay while continuing to compete in Junior Showmanship.

ADDRESS

City

State

ZIP

OFFICIAL AMERICAN KENNEL CLUB ENTRY FORM

BOTH SIDES OF ENTRY FORM MUST BE SUBMITTED • Appropriate Box(es) MUST BE CHECKED

Appropriate Box(es) MUST BE CHECKED**CONCURRENT SPECIALTIES**

MISSOURI VALLEY BOXER CLUB

☐ SATURDAY, OCTOBER 7, 2023

BORZOI CLUB OF GREATER OMAHA

☐ SATURDAY, OCTOBER 7, 2023☐ SUNDAY, OCTOBER 8, 2023

Lancaster Event Center • 4100 N 84th Street • Lincoln, Nebraska 68507

See page 3 for entry fees

ENTRIES CLOSE WEDNESDAY NOON, September 20, 2023, or when the limit has been reached, if reached prior to this date at Superintendent's Office. (See limit on page 1)

MAIL ENTRIES with Fees Payable to JACK ONOFRIO, PO Box 25764, Oklahoma City, Oklahoma 73125-0764.

NOTICE: PLEASE PUT BREED & NAME OF SHOW ON CHECKS. I ENCLOSE \$_____ for entry fees.**IMPORTANT - Read Carefully instructions on reverse side before filling out. Numbers in the boxes****indicate sections of the instructions relevant to the information needed in that box (PLEASE PRINT).**

BREED		VARIETY (1)		SEX
DOG (2) (3) SHOW CLASS			CLASS (3) DIVISION Weight, Color, Etc.	
ADDITIONAL CLASSES	OBDIENCE CLASS (Jump Height)	RALLY CLASS (Jump Height)	JR. SHOWMANSHIP CLASS	
NAME OF (See Back) JUNIOR HANDLER (if any)			JR. HANDLER AKC #	
FULL NAME OF DOG				
<input type="checkbox"/> AKC® NO. <input type="checkbox"/> PAL NO. <input type="checkbox"/> FOREIGN REG. NO. & COUNTRY		Enter number here	DATE OF BIRTH	
			PLACE OF BIRTH (list country)	
			Do not print the above in the catalog	

BREEDER**SIRE****DAM**

Exhibitor's Code _____

ACTUAL OWNER(S) [4] _____ (Please Print)**OWNER'S ADDRESS** _____**CITY** _____ **STATE** _____ **ZIP + 4** _____**NAME OF OWNER'S AGENT (IF ANY) AT THIS SHOW** _____ **CODE #** _____

I CERTIFY that I am the actual owner of the dog, or that I am the duly authorized agent of the actual owner whose name I have entered above. In consideration of the acceptance of this entry, I (we) agree to abide by the rules and regulations of the American Kennel Club in effect at the time of this event, and by any additional rules and regulations appearing in the premium list for this event, and further agree to be bound by the "Agreement" printed on the reverse side of this entry form. I (we) certify and represent that the dog entered is not a hazard to persons or other dogs. This entry is submitted for acceptance on the foregoing representation and Agreement. I (we) agree to conduct myself (ourselves) in accordance with all such Rules and Regulations (including all provisions applying to discipline) and to abide by any decisions made in accord with them.

☒ **SIGNATURE of owner or his agent**

duly authorized to make this entry _____ Telephone () _____

ARE YOU A NEW EXHIBITOR? Yes ☐ No ☐**Email address:** _____

(An acknowledgement or receipt of entry may be sent to this email address)

CHECK THIS BOX TO RECEIVE A PRINTED JUDGING PROGRAM ☐**Emergency Contact:** _____ Telephone () _____

AGREEMENT

I (we) agree that the club holding this event has the right to refuse this entry for cause which the club shall deem sufficient. In consideration of the acceptance of this entry and of the holding of this event and of the opportunity to have the dog judged and to win prizes, ribbons, or trophies, I (we) agree to hold the AKC, the event-giving club, their members, directors, governors, officers, agents, superintendents or event secretary and the owner and/or lessor of the premises and any provider of services that are necessary to hold this event and any employees or volunteers of the aforementioned parties, and any AKC approved judge, judging at this event, harmless from any claim for loss or injury which may be alleged to have been caused directly or indirectly to any person or thing by the act of this dog while in or about the event premises or grounds or near any entrance thereto, and I (we) personally assume all responsibility and liability for any such claim; and I (we) further agree to hold the aforementioned parties harmless from any claim for loss, injury or damage to this dog. Additionally, I (we) hereby assume the sole responsibility for and agree to indemnify, defend and save the aforementioned parties harmless from any and all loss and expense (including legal fees) by reason of the liability imposed by law upon any of the aforementioned parties for damage because of bodily injuries, including death at any time resulting therefrom, sustained by any person or persons, including myself (ourselves), or on account of damage to property, arising out of or in consequence of my (our) participation in this event, however such, injuries, death or property damage may be caused, and whether or not the same may have been caused or may be alleged to have been caused by the negligence of the aforementioned parties or any of their employees, agents, or any other persons. **I (WE) AGREE THAT ANY CAUSE OF ACTION, CONTROVERSY OR CLAIM ARISING OUT OF OR RELATED TO THE ENTRY, EXHIBITION OR ATTENDANCE AT THE EVENT BETWEEN THE AKC AND THE EVENT-GIVING CLUB (UNLESS OTHERWISE STATED IN ITS PREMIUM LIST) AND MYSELF (OURSELVES) OR AS TO THE CONSTRUCTION, INTERPRETATION AND EFFECT OF THIS AGREEMENT SHALL BE SETTLED BY ARBITRATION PURSUANT TO THE APPLICABLE RULES OF THE AMERICAN ARBITRATION ASSOCIATION. HOWEVER, PRIOR TO ARBITRATION ALL APPLICABLE AKC BYLAWS, RULES, REGULATIONS AND PROCEDURES MUST FIRST BE FOLLOWED AS SET FORTH IN THE AKC CHARTER AND BYLAWS, RULES, REGULATIONS, PUBLISHED POLICIES AND GUIDELINES.**

INSTRUCTIONS

1. (Variety) if you are entering a dog of breed in which there are varieties for show purposes, please designate the particular variety you are entering i.e., Cocker Spaniel (solid color black, ASCOB, parti-color). Beagles (not exceeding 13 in. over 13 in. but not exceeding 15 in.). Dachshunds (longhaired, smooth, wirehaired), Bull Terriers (colored, white), Manchester Terriers (standard, toy), Chihuahuas (smooth coat, long coat), English Toy Spaniels (King Charles and Ruby, Blenheim and Prince Charles), Poodles (toy, miniature, standard), Collies (rough, smooth),
2. The following categories of dogs may be entered and shown in Best of Breed competition; Dogs that are Champions of Record and dogs which, according to their owner's records, have completed the requirements for a championship, but whose championships are unconfirmed. The showing of unconfirmed Champions in Best of Breed competition is limited to a period of 90 days from the date of the show where the dog completed the requirements for a championship.
3. (Event Class) Consult the classification in this premium list. If the event class in which you are entering your dog is divided, then, in addition to designating the class, specify the particular division of the class in which you are entering your dog, i.e., age division, color division, weight division.
4. A dog must be entered in the name of the person who actually owned it at the time entries for an event closed. If a registered dog has been acquired by a new owner, it must be entered in the name of its new owner in any event for which entries closed after the date of acquirement, regardless of whether the new owner has received the registration certificate indicating that the dog is recorded in his name. State on entry form whether transfer application has been mailed to the AKC (For complete rules refer to Chapter 11, Section 3).
5. Mixed Breed dogs entering classes for Agility, Obedience and Rally trials should mark Breed as AKC Canine Partners Listed Dog "All-American Dog/Mixed Breed." Sire and Dam information shall remain blank for mixed breed entrants.

If this entry is for Jr Showmanship, please enter the following information:

JUNIOR SHOWMANSHIP
AKC JR HANDLER NUMBER

JR.'S DATE OF BIRTH _____

The above number **MUST** be included. Should you not have your Junior Handler number, this may be obtained from the AMERICAN KENNEL CLUB. PHONE:(919) 233-9767.

By signing the entry form I (we) certify that the Junior Showman does not now, and will not at any time, act as an agent/handler for pay while continuing to compete in Junior Showmanship.

ADDRESS

City

State

ZIP