

AEROVED

AEROVED COMPUTER MOUNT INSTALLATION GUIDE:

(Installation process is the same for the Garmin and Wahoo compatible mounts)

STEP 1

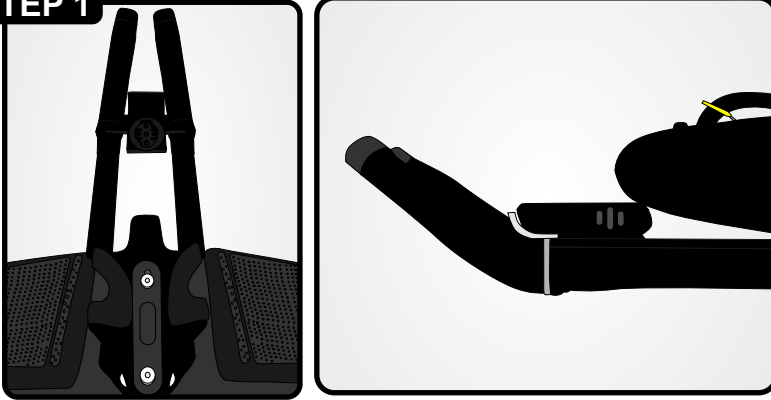

Using clockwise rotation, install your computer on the AEROVED mount.

Please note the computer cannot be installed by turning it counterclockwise. It may be very tight at first. Install your computer onto the AEROVED mount. Place both units on the aero extensions. Get in aero position on your bike to make sure you have a clear view of the computer screen. Mark the location on both extensions. Next, apply 3 to 4 layers of electrical tape around extensions at the marked locations. This will assure that your computer mount stays snug.

STEP 2

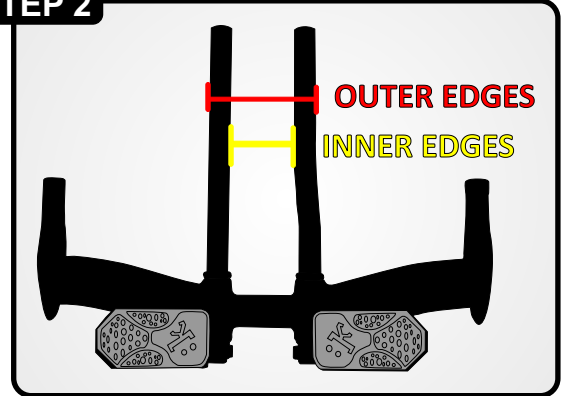

Measure the distance between inner and outer edges of your aero extensions.

STEP 3

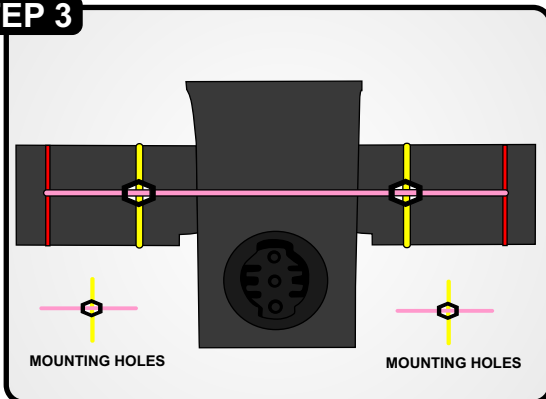

Use the measurements from [Step 1](#) to mark the locations of the inner and outer edges on the mount. Measure the width of the wings and mark the center location where the mounting holes are. Using a 6mm drill bit, drill two mounting holes at this marked location.

STEP 4

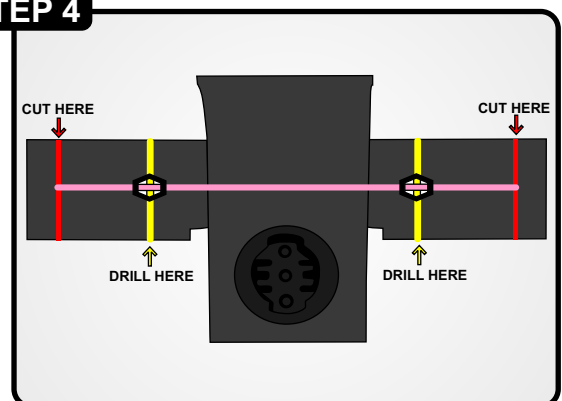

Cut the extra materials off of the wings using a tool such as a hacksaw. Before you make the cuts, make sure the distance between the two outer lines on the mount match the distance between the outer edges of your aero extension from [Step 2](#).

STEP 5

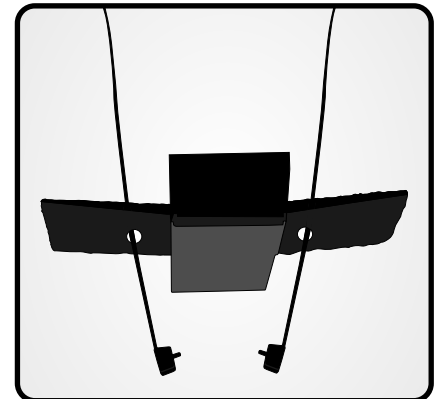
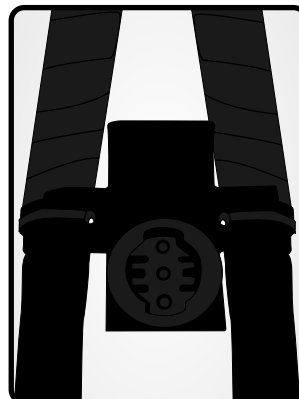
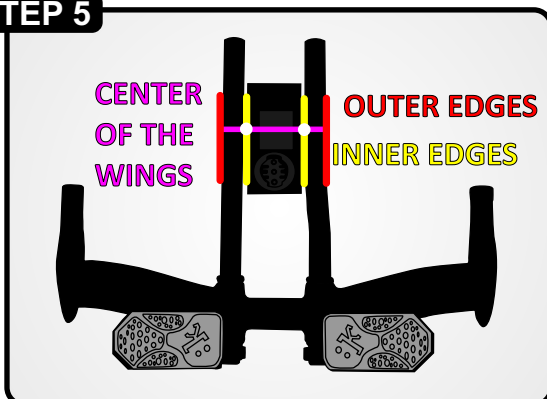

Using counterclockwise rotation, remove your computer from the AEROVED mount. Place the mount on top of the taped areas on the extensions and install the 2 straps from the bottom of the mount. Make sure that the head of each strap is facing away from the extension bar that it's being mounted on ([See image ABOVE](#)).