

AEROVED

AEROVED BOTTLE MOUNT INSTALLATION GUIDE:

(Installation process is the same for the STEALTH X AND STEALTH XT bottle mount)

STEP 1

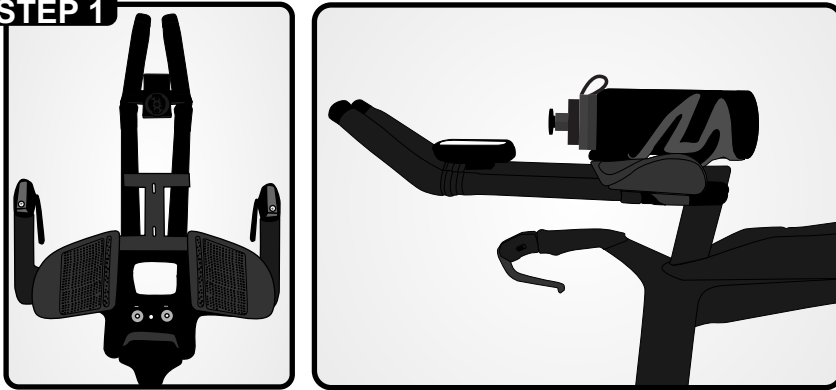

Place the bottle mount on the aero extensions and mark the desired location on both extensions. Next, apply 3 to 4 layers of electrical tape around extensions at the marked locations. This will assure that your bottle mount stays snug.

STEP 2

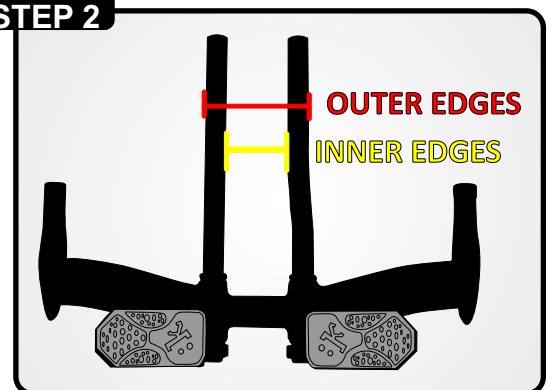

Measure the distance between inner and outer edges of your aero extensions.

STEP 3

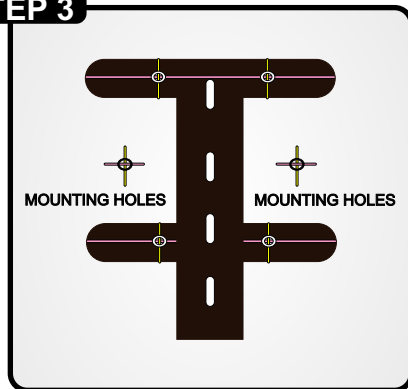

Use the measurements from [Step 2](#) to mark the locations of the inner and outer edges on the mount. Measure the width of the wings and mark the center location where the mounting holes are. Using a 6mm drill bit, drill four holes at this marked location.

STEP 4

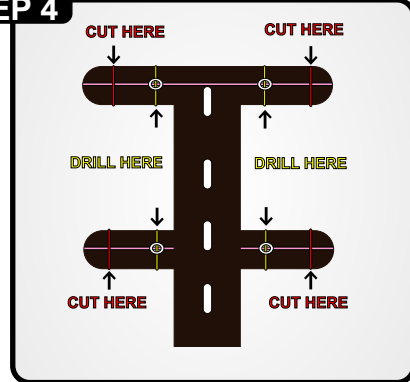

Cut the extra materials off of the wings using a tool such as a hacksaw. Before you make the cuts, make sure the distance between the two outer lines on the mount match the distance between the outer edges of your aero extensions from [Step 2](#).

STEP 5

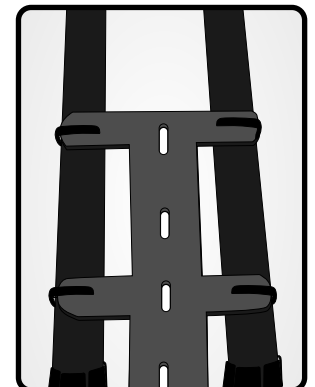
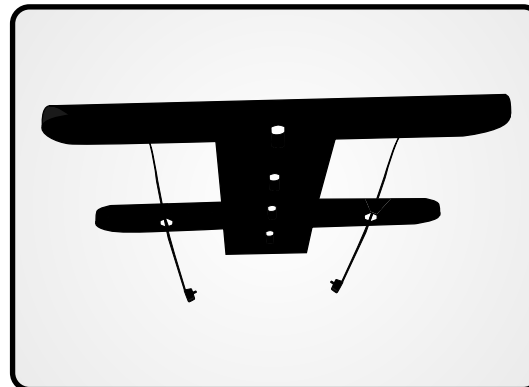
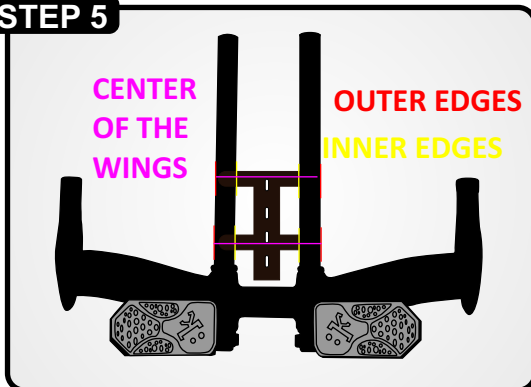

Place the bottle mount on top of the taped areas on the extensions and install the 4 straps from the bottom of the mount. Make sure that the head of each strap is facing away from the extension bar that it's being mounted on ([See image ABOVE](#)).