

## ON GOING PROJECTS



Hemadurga's Landmark  
@Krishi Nagar, Miyapur



Hemadurga's Padmavati  
@Krishi Nagar, Miyapur



9 Independent Row Houses  
@Muthangi

Builders & Developers



**SRI HEMADURGA  
CONSTRUCTIONS**

Cell No: +91 91212 26424, +91 91212 26425  
+91 91212 26426, +91 91212 26427  
+91 91212 26428, +91 91212 26429

Site address

Hemadurga's  
**Paradise**

Shanti Nagar, Deepthi Sree Nagar,  
Miyapur, Hyderabad.

Location for  
Google Scan



Site address

Hemadurga's  
**Prime**

J P Nagar, Miyapur, Hyderabad.

Location for  
Google Scan



Note : This brochure is only conceptual presentation of the project and not a legal offering. The promoters reserve the right to make changes in the elevation, plans and specification as deemed fit.

designed by Barma Ad Systems +91 98664 01362 +91 8897384503 15/07/23

Projects by 

**SRI HEMADURGA  
CONSTRUCTIONS**

Fulfilling Your Dreams

Hemadurga's  
**Paradise**

Hemadurga's  
**Prime**

2 & 3 BHK Luxury Apartments @Shanti Nagar & J P Nagar

"The **NEST** of your  
**DREAMS**"





Hemadurga's  
**Paradise**

## Typical Floor Plan

Flat No.	1	2
Area in sft.	1600 Sft	1200 Sft
Facing	East	West



### Highlights

- Project Approved by GHMC
- As Per Vaastu
- Premium quality construction
- Spacious Car parking & Drive Area
- Excellent cross ventilation
- Uncompromising common area
- Close to NH - 9 & Miyapur Metro Terminal





## Typical Floor Plan

Flat No. 1  
 Area in sft. 1500 Sft  
 Facing East

Hemadurga's  
**Prime**



## Car Parking Plan

# Hemadurga's Paradise

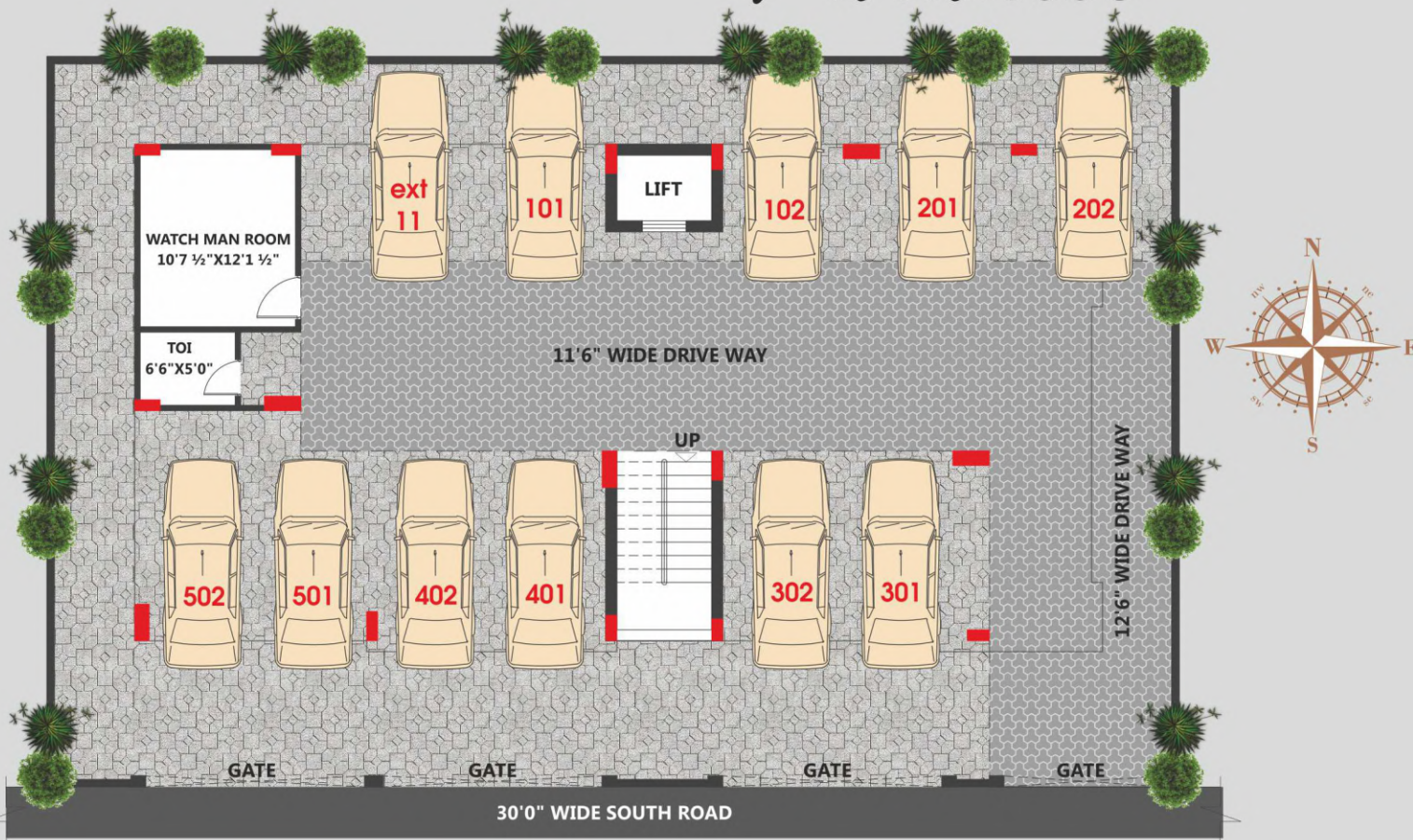

## Car Parking Plan

# Hemadurga's Prime

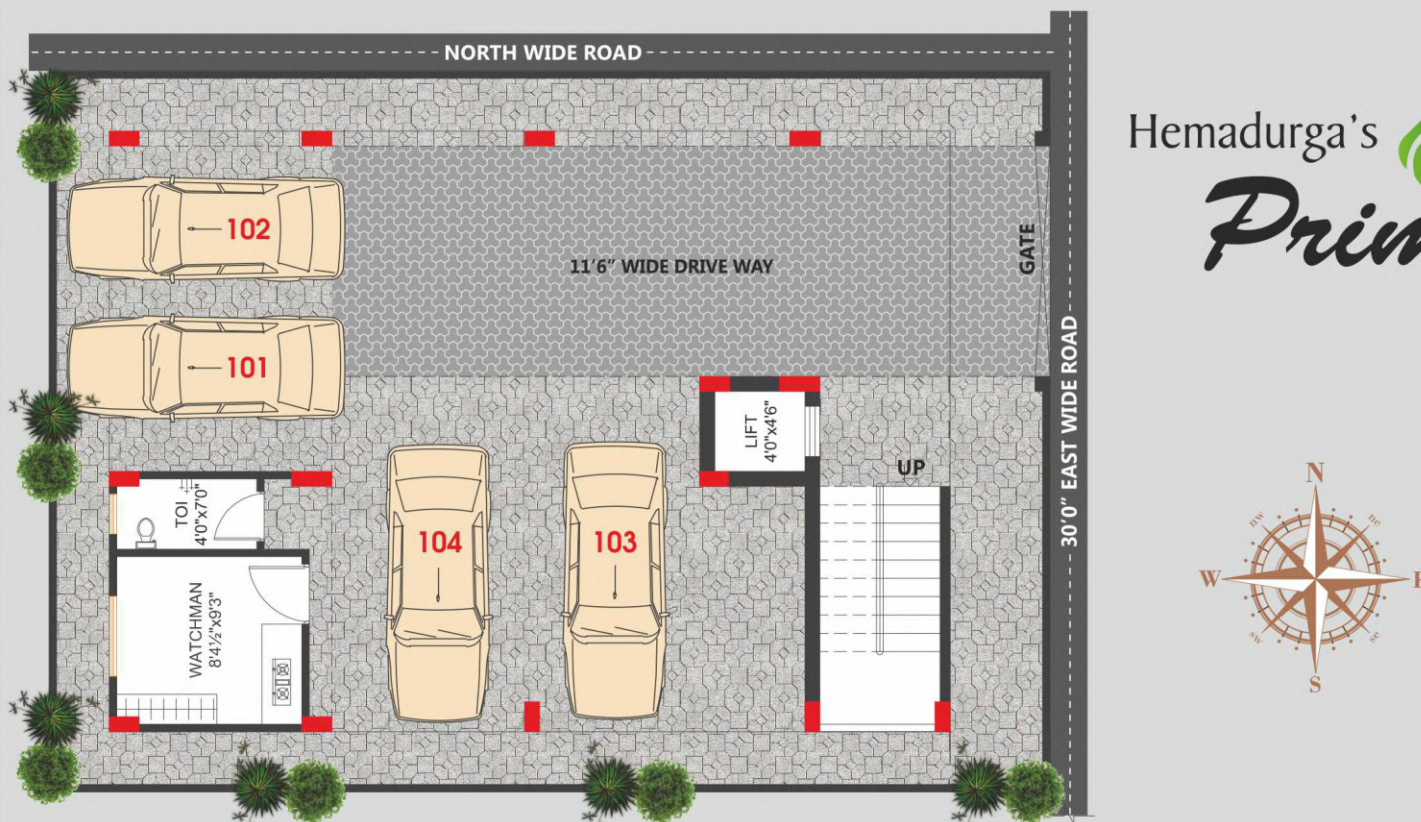

**STRUCTURE**  
RCC Framed structure.



**KITCHEN**  
Z black Granite or Khammam black Granite topped Cooking platform with steel sink, with dadoing of wall tiles upto 2 feet height.



**PLUMBING**  
CPVC fittings - Astral or Ashirvad or Sudhakar or Prince  
PVC fittings - Astral or Ashirvad or Sudhakar or Prince  
Bath room sanitary - Cera or Hindware or Parryware or Plumber or Bathsense Taps.



**SUPER STRUCTURE**  
Red Burnt Brick walls in C.M



**PLASTERING**  
Two coats of Plastering with sponge finishing both internal and external walls.



**TOILETS**  
Ceramic wall tiles with cladding upto door height and anti skid ceramic tiles for flooring

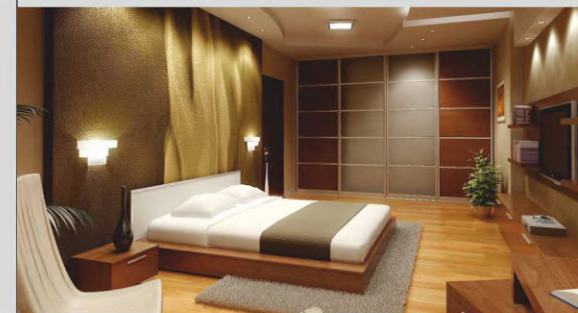

## SPECIFICATIONS



**DOORS**  
Main Door : Teak wood frame and Teak wood shutter / Veneer Hardwood shutter with melamine polish with good quality of hardware.  
Other Doors : Frame - Teak Wood Frames, Shutters - Standard make flush doors or moulded doors along with necessary Hardware.



**PAINTING**  
Internal walls and ceiling with wall Putty finish and emulsion paints (Asian / Equivalent)  
External walls with exterior paints, Internal door frames with two coats of enamel paint finishing.



**WATER**  
Separate storage tanks for manjeera, bore well ground and overhead.



**WINDOWS**  
UPVC windows with safety grills and mosquito mesh



**ELECTRICAL**  
Concealed Sudhakar PVC pipes and copper wiring with necessary points for lights, fans, refrigerator, Tv, Telephone, PC and AC points in bedrooms and Hall, one geyser point in each bath room  
Switches - Legrand or Havells or Anchor roma  
Wiring - Polycab or Equivalent



**LIFT**  
Lift of 6 passengers capacity of standard make



**FLOORING**  
Cera or Johnson or Equivalent Vitrified Tiles 3'X3'. Granite Flooring for Independent House.



**STAIRCASE**  
SS Railing



**NOTE**  
Registration, GST are applicable as per govt norms.

**BALCONY'S**  
SS Grills or Ms Grills