

The SSLA



# LLAMA JOURNAL

The Official Journal of the Southern States Llama Association

April 2018



## TABLE OF CONTENTS

SSLA Board Members and Information	3
President’s Message	4
SSLA 2017 Board of Directors Meeting, March 16, 2018	4
SSLA 2018 Board of Directors Meeting, March 16, 2018	6
SSLA Spring Pack Trials 2018 Announcement	7
Florida State Fair Llama Show Highlights	8
SSLA Hillbilly Show Results	9
St. Patrick’s Day Parade Atlanta Photos	11
Remember This?...Click, Treat & Train	12
SSLA Annual Conference 2018 Highlights	13
Georgia Llama Club Photos	15
Calendar of Upcoming Llama Events	16
Advertising Information	17
Obstacle Trailer Advertising Information	19

*Cover: Llama hike at  
Rambling Bald  
State Park, NC*

**Deadline for the next issue is July 15, 2018**

*Send articles, photos (digital format preferred) to:*

Charlene Braun, Online Journal Editor, [turtlrn@earthlink.net](mailto:turtlrn@earthlink.net)

## SSLA BOARD MEMBERS AND INFORMATION

### Board of Directors

Kim Kyst, *President*  
[Kim@kyst.org](mailto:Kim@kyst.org)

Cathie Kindler, *Vice President*  
[llamajudge@gmail.com](mailto:llamajudge@gmail.com)

Kathy Devaul, *Treasurer*  
[Kdevaul@bellsouth.net](mailto:Kdevaul@bellsouth.net)

Lauri Jones, *Secretary*  
[Laurijones@windstream.net](mailto:Laurijones@windstream.net)

Mary Rose Collins, *Director*  
[mrc604@tampabay.rr.com](mailto:mrc604@tampabay.rr.com)

Greg Hall, *Director*  
[SimplicitylamaFarm@yahoo.com](mailto:SimplicitylamaFarm@yahoo.com)

Lynn Wright, *Director*  
[walkingwright@msn.com](mailto:walkingwright@msn.com)

### Committee Chairs & Contacts

(If the committee chair is a board member, that person is also the Board Liaison)

#### Committees

#### Annual Meeting Conference—

**By-law Amendment**—Tom Wilson  
*Board Liaison: Kim Kyst*

**Carting**—Greg Hall

**Election**—To be appointed by President

**Fiber**—Tracy Weaver  
*Board Liaison: Lauri Jones*

**Online Journal**—Charlene Braun  
[turtlrn@earthlink.net](mailto:turtlrn@earthlink.net)  
*Board Liaison: Mary Rose Collins*

**Library**—Lauren Wright

**Llama Trekking & Packing**—  
 Tom Rothering  
*Board Liaison: Cathie Kindler*

**Membership**—Mary Rose Collins  
[clambert5@tampabay.rr.com](mailto:clambert5@tampabay.rr.com)  
*Board Liaison:*

**Show**—Kathy Devaul

**Website**—Vicki Sundberg  
*Board Liaison: Greg Hall*

**Youth & Youth Ambassador Awards**—  
 Cathie Kindler  
*Board Liaison: Kim Kyst*

**Youth Scholarship**—Tom Rothering  
*Board Liaison: Kim Kyst*

**Ambassador Awards**—Greg Hall  
**Trekking Awards**—Vicki Sundberg  
**Sweepstakes Awards**—Lynn/Lauren Wright  
*Board Liaison: Lynn Wright*

**Rescue**—Deborah Logan  
[logan99.mail@gmail.com](mailto:logan99.mail@gmail.com)

**Sweepstakes**—Vicki Sundberg  
*Board Liaison: Lynn Wright*

### Journal Mission Statement

THE LLAMA JOURNAL, published by the Southern States Llama Association (SSLA) is distributed quarterly to the members of SSLA. The purpose of the Journal is to provide:

- Information and articles of interest
- A forum for members to express their opinions on llamas and related matters
- Board of Directors meeting minutes, Treasurer's report and other information pertinent to the function of SSLA.

**Notice:** The information contained in this Journal is not intended to be a substitute for qualified professional advice. Our readers are encouraged to consult with their own vets, accountants or attorneys for questions concerning their animals or business operations. SSLA or the editor is not responsible for any losses resulting from a reader's failure to heed this caution. Opinions expressed or implied are hereby the editor's choice and are not the opinions of the SSLA Board of Directors or SSLA as a group.

### SSLA Mission Statement

OUR MISSION as members of the Southern States Llama Association is to be a strong organization of llama and alpaca owners who have joined together for the purpose of education, fun, and fellowship while promoting the health and welfare of llamas and the llama industry.

### SSLA Online—keep in touch with your llama organization

**Website:** [www.ssla.org](http://www.ssla.org)

**Facebook** page: Listed as "SSLA-Southern States Llama Association"

**SSLA-Members Yahoo Group:** Request membership from [ssla-members-owner@yahoogroups.com](mailto:ssla-members-owner@yahoogroups.com)

Group members can post messages to [SSLA-Members@yahoogroups.com](mailto:SSLA-Members@yahoogroups.com)

# PRESIDENT'S MESSAGE

I am honored to assume the role as SSLA President. I look forward to a productive and successful year, and I invite each of you to participate and, most importantly, become actively involved in our organization. For our current members and prospective members, I want to assure you that the intention of this board of directors is to grow the SSLA membership and its value to the membership. Our board is focused on structuring programs to create social opportunities, shows, pack trails, fiber programs, educational programs, marketing opportunities for farms and services, and much more.

Excitement and enthusiasm were some of the feelings I brought home from the March Annual SSLA Conference. The attending members enjoyed networking, team building, expanding their knowledge, celebrating their accomplishments and creating memories and new friendships. A special thank you to Mountain Lodge and Conference Center. Scott and his staff have gone above and beyond to create and provide an exceptional place to host our annual conference for many years. Thank you to the SSLA Conference Committee for structuring a fabulous opportunity for our membership.

Our keynote speaker, Dr. Lauren Griffeth from UGA, shared knowledge on today's society and created challenges for those attending to work together to build on ideas and programs to

restructure our SSLA membership. Dr. Marie Ferrer from UGA discussed challenges with difficult breedings in camelids and gave insights on possible solutions.

The raffle and the silent and live auctions were all successful fundraisers for SSLA and the SSLA Youth Scholarship funds. Thank you to everyone for making the contributions to make these successful and to those who participated in each area of the fundraising efforts.

While the enthusiasm is fresh, and the energy is still flowing, I would like to challenge our members to build on the ideas created at conference and share with those who weren't able to attend. Let's get our organization moving into the future and our numbers growing! So many companies are currently marketing their products with our llamas and alpacas, let's ride their success and make it our success! Business cards, marketing events, visibility, website, social media, community awareness, and youth board are all areas I feel could benefit our organization. I know this can't all happen overnight, but I know the more folks that are involved the more we can accomplish! Become involved! Volunteer! There's a place for everyone within our membership to utilize their talents to benefit the organization as a whole.

*Kim Kyst*  
2018 SSLA President

## SSLA 2017 BOARD OF DIRECTORS MEETING MARCH 16, 2018 FLAT ROCK, NC

Meeting called to order 7:05 pm.

**Attendance:**

- Mary Rose Collins, President
- Tom Rothering, Vice President
- Kathy Devaul, Treasurer
- Greg Hall, Director
- Cathie Kindler, Director
- Kim Kyst, Director
- Lynn Wright, Director

Absent: Tracy Weaver, Secretary

Resigned: Karen Pihera, Director

**Topic: Board Vacancy**

Due to Karen Pihera resigning from the Board, we have two options since it was already voted on to approve reduction from 9 to 7 board positions:

1. Special appointment from the at-large membership.
2. Do not fill the position therefore reducing the number to the 7 which does follow the bylaws.

Motion made by Cathie Kindler to leave at 7 not fill the position, motion seconded, passed unanimously.

*Continued on page 5*

*SSLA 2017 Board of Directors Meeting, March 16, 2018, continued*

### **Topic: Treasurer's Report**

Discussion: Kathy Devaul

Profit and Loss Report Submitted and reviewed by Board. Some history and accounting became difficult after the unexpected loss of the previous Treasurer. PayPal gave us 3 pages of transactions. But not broken out 'correctly'? The losses that 'showed up' may not have been in the correct categories. 90-100 transactions, needed to 'finish' to get the taxes done. Put the 'unknown' transactions into Membership, may not have been accurate? And some of these transactions may have been in 2016. Had auction in March, but didn't Transfer to scholarship was in October. Same issue with Regional shows to main account, so there is a 'profit' that will show up in 2016 vs 2017 vs 2018. \$3,000+ for wrapping trailer, almost \$4,000. So those amounts wash when added back to show, but because of 'problems' with accounting the balance is correct it is just an issue of what categories the monies came in from.

Last year we were at a similar account balance. The pattern seems to be showing the same. Sometimes Up/Down, but consistent. We may need to have fund raisers. We are not growing, but we aren't really losing either. Outstanding are Board Insurance, Sweepstakes bills, outstanding expenses for Conference, but it 'seems' that we are breaking even. Having Vicki doing website is saving us money. We need to grow membership to make the proportions go down per member.

### **Old Business**

#### **Topic: Elections**

Action: The election was done again by Simply Voting. The system was easy to use and accurate in reporting. Vicki Sundberg was the Inspector of Elections. 29 farms voted out of a potential 36. Greg Hall, Kathy Devaul, and Lauri Jones were elected to the Board. Vicki Sundberg will present and introduce the Board and Officers at the Annual Meeting.

### **Topic: Website**

Action: Webmaster resigned in January, Vicki Sundberg, who is the Website Chairperson, picked it up very well. Using GoDaddy, the 'cross over' went very well. We are looking to have a private/members only section, but not up yet. Vicki will present website information at the Annual Meeting.

### **Topic: Show**

Kathy Devaul reported the show year has done well leaving a comfortable balance in the show account as well as being able to give back the General Fund. Kathy will report at the Annual Meeting.

### **Topic: Scholarship**

Tom Rothering reports that we will add Lauren Wright for signature. Keeping account where it is and need sign off by Board Members to approve. Leave in Washington, GA (small bank). Janessa Hall, Hunter Williams, Candice Snow are current, no one in 2018, and then Bailey Jones and several others in 2019. We have criteria, and those are being kept up-to-date. Tom Rothering will present at the Annual Meeting.

### **Topic: Membership**

Cheryl Lambert reports we are down again this year. There is a total of 55 farms, 46 renewals, 4 new members, 5 lifetime members. Last year at this time we had 70 members and ended the year with 77. In 2016 total membership was 87.

Meeting Motioned by Kathy Devaul Seconded by Tom Rothering be adjourned at 7:40 pm.

# SSLA 2018 BOARD OF DIRECTORS MEETING

## MARCH 16, 2018

### FLAT ROCK, NC

Meeting called to order at 7:50 pm.

#### Attendance:

Mary Rose Collins  
Kathy Devaul  
Lynn Wright  
Kim Kyst  
Greg Hall  
Cathie Kindler  
Lauri Jones

#### Topic: Election of Officers

- Mary Rose Collins nominated Kim Kyst for President. Kathy Devaul seconded. Approved by unanimous vote.
- Mary Rose Collins nominated Cathie Kindler for Vice President, seconded by Kim Kyst. Approved by unanimous vote.
- Mary Rose Collins nominated Kathy Devaul for Treasurer, seconded by Lauri Jones. Approved by unanimous vote.
- Mary Rose Collins nominated Lauri Jones for Secretary, seconded by Cathie Kindler. Approved by unanimous vote.

**Old Business** — None

#### New Business

##### Topic: PR Release

We should have PR (photo) releases on all forms, so they can be on websites and social media, etc. Will come up with verbiage that will be on the membership form.

##### Topic: Membership

May have a new membership chairperson.

##### Topic: Treasurer's Report

Still have issue with Treasury accounts but not everyone can 'see' all the account info. Mary Rose and Kathy came up with a way to 'see' all account info, (or pay \$39 per month extra to allow second user). May keep this process up.

#### Topic: Goals

We may need to set goals based on Dr. Griffith's presentation, and we as Board will have to agree to goals, etc.

Journal may become online only. There was a vote by membership to do two hard copy and two online Journals per year in 2017, and we did not have sufficient advertising to justify Print copies of Journal. Print and shipping is very expensive.

#### Topic: Committees

##### Annual Meeting Conference—

**By-law Amendment**—Tom Wilson, *Board Liaison: Kim Kyst*

**Carting**—Greg Hall

**Election**—To be appointed by President

**Fiber**—Tracy Weaver, *Board Liaison: Lauri Jones*

**Online Journal**—Charlene Braun [turtlrn@earthlink.net](mailto:turtlrn@earthlink.net)  
*Board Liaison: Mary Rose Collins*

**Library**—Lauren Wright

**Llama Trekking & Packing**—Tom Rothering, *Board Liaison: Cathie Kindler*

**Membership**—Mary Rose Collins [clambert5@tampabay.rr.com](mailto:clambert5@tampabay.rr.com)  
*Board Liaison:*

**Show**—Kathy Devaul

**Website**—Vicki Sundberg, *Board Liaison: Greg Hall*

**Youth & Youth Ambassador Awards**—Cathie Kindler,  
*Board Liaison: Kim Kyst*

**Youth Scholarship**—Tom Rothering, *Board Liaison: Kim Kyst*

**Ambassador Awards**—Greg Hall

**Trekking Awards**—Vicki Sundberg

**Sweepstakes Awards**—Lynn/Lauren Wright, *Board Liaison: Lynn Wright*

**Rescue**—Deborah Logan [logan99.mail@gmail.com](mailto:logan99.mail@gmail.com)

**Sweepstakes**—Vicki Sundberg, *Board Liaison: Lynn Wright*

Motion made by Mary Rose Collins to adjourn, motion seconded by Greg Hall, meeting adjourned at 8:48 pm.

## SSLA Spring Pack Trials

DuPont Recreational Forest  
Cedar Mountain, North Carolina  
April 27 -29, 2018

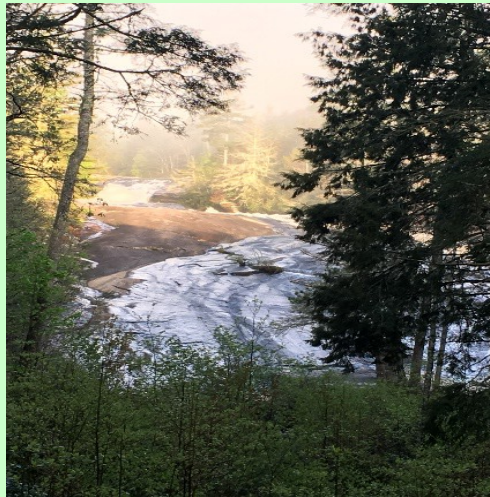

This is a two-day event with a Potluck Dinner Saturday night

Both Advanced and Basic Course Pack Trials Saturday and Sunday morning

This is a PLTA Certified Event

It is also a beautiful location just to come to and fun hike over the weekend.

Primitive campsites are available with access to bathroom and showers

Stall and pasture space available for the animals

Contact Mary Rose Collins for details [mrc604@tampabay.rr.com](mailto:mrc604@tampabay.rr.com)

Details can also be found on the SSLA website [www.ssla.org](http://www.ssla.org)

FLORIDA STATE FAIR LLAMA SHOW  
FEBRUARY 16-18, 2018

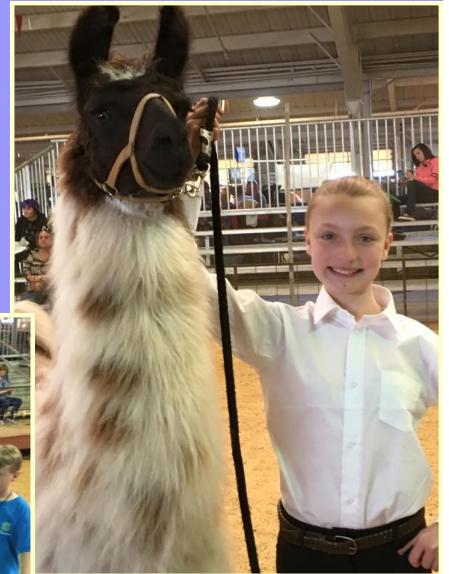



**SSLA HILLBILLY SHOW  
MARCH 2-4, 2018**

**ALSA Red / ILR Red**

**ALSA Blue / ILR Blue**

<b>Driving Performance</b>	<b>Grand:</b> BB Trev - Vicki Sundberg <b>Reserve:</b> Mooch Cook - Vicki Sundberg	<b>Grand:</b> BB Trev - Vicki Sundberg <b>Reserve:</b> Mooch Cook - Vicki Sundberg
<b>Master Performance</b>	<b>Grand:</b> Timberwinds Chevy Chase - Lauren Wright <b>Reserve:</b> Tux's Spotted Snowflake - Mary Rose Collins	<b>Grand:</b> Timberwinds Chevy Chase - Lauren Wright <b>Reserve:</b> Oak Rest's Winter Rose - Mary Rose Collins
<b>Alpaca Master Performance</b>	<b>Grand:</b> Mr. Wilbur - Lauren Wright	<b>Grand:</b> Mr. Wilbur - Lauren Wright
<b>Advanced Performance</b>	<b>Grand:</b> Sapaveco's Rock Starr - Lauren Wright <b>Reserve:</b> Moose Hill's Speckletush - Mary Rose Collins	<b>Grand:</b> Moose Hill's Speckletush - Mary Rose Collins <b>Reserve:</b> Sapaveco's Rock Starr - Lauren Wright
<b>Alpaca Advanced Performance</b>	<b>Grand:</b> Lofty Pine Friendly Thomas - Lauren Wright	<b>Grand:</b> Lofty Pine Friendly Thomas - Lauren Wright
<b>Senior Youth Performance</b>	<b>Grand:</b> Riseland's Prevoe "Leo" - Bailey Jones <b>Reserve:</b> Slick Nifty - Andie Ellett	<b>Grand:</b> Riseland's Prevoe "Leo" - Bailey Jones <b>Reserve ALSA:</b> S.O. Rocketman - Savannah Morgan <b>Reserve ILR:</b> Slick Nifty - Andie Ellett
<b>Intermediate Youth Performance</b>	<b>Grand ALSA:</b> Oak Rest's Bentley - Ben McCloughan <b>Grand ILR:</b> Oak Rests Gold Rush - Maggie Jordan <b>Reserve ALSA:</b> Oak Rests Gold Rush - Maggie Jordan <b>Reserve ILR:</b> Oak Rest's Bentley - Ben McCloughan	<b>Grand ALSA:</b> Oak Rest's Bentley - Ben McCloughan <b>Grand ILR:</b> S.O. Rocketman - Savannah Morgan <b>Reserve ALSA:</b> Oak Rests Gold Rush - Maggie Jordan <b>Reserve ILR:</b> Oak Rest's Bentley - Ben McCloughan
<b>Junior Youth Performance</b>	<b>Grand ALSA:</b> Camps Serendipity - Dylan Shaver <b>Grand ILR:</b> Carolinas Charlotte - Kylie Morgan <b>Reserve ALSA:</b> Carolinas Charlotte - Kylie Morgan <b>Reserve ILR:</b> Camps Serendipity - Dylan Shaver	<b>Grand:</b> Camps Serendipity - Dylan Shaver <b>Reserve:</b> Carolinas Charlotte - Kylie Morgan
<b>Novice Performance</b>	<b>Grand:</b> Tevye's Taken by Toccoa - Bailey Jones <b>Reserve:</b> Chelian's Outrageous Onyx - Andie Ellett	<b>Grand:</b> Tevye's Taken by Toccoa - Bailey Jones <b>Reserve:</b> Chelian's Outrageous Onyx - Andie Ellett
<b>Alpaca Novice Performance</b>	<b>Grand:</b> Maximus II - Debbie Andrews <b>Reserve:</b> Brook Creek Gus - Lauren Wright	<b>Grand:</b> Maximus II - Debbie Andrews <b>Reserve:</b> Prince Wednesday - Lauren Wright
<b>Alpaca Non Breeder</b>	<b>Grand:</b> Maximus II - Debbie Andrews <b>Reserve:</b> Prince Wednesday - Lauren Wright	<b>Grand:</b> Prince Wednesday - Lauren Wright <b>Reserve:</b> Maximus II - Debbie Andrews
<b>Non Breeder</b>	<b>Grand:</b> Riseland's Prevoe "Leo" - Bailey Jones <b>Reserve:</b> Tevye's Taken by Toccoa - Bailey Jones	<b>Grand:</b> Riseland's Prevoe "Leo" - Bailey Jones <b>Reserve:</b> Tevye's Taken by Toccoa - Bailey Jones
<b>Fleece Non Breeder</b>	<b>Grand:</b> ALCL Snoopy - Debbie Andrews <b>Reserve:</b> Furor De La Noche - Kitty Tuck-Hampel	<b>Grand:</b> Furor De La Noche - Kitty Tuck-Hampel <b>Reserve:</b> ALCL Snoopy - Debbie Andrews

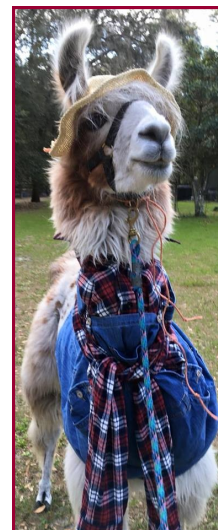

**SSLA HILLBILLY SHOW  
MARCH 2-4, 2018**

**ALSA Red / ILR Red**

**ALSA Blue / ILR Blue**

<b>Suri Wool Female</b>	<b>Grand:</b> Alalama's Poca Mocha - Nancy Miller-Borg <b>Reserve:</b> CVL Super Nova - McKayla Snow	<b>Grand:</b> AlaLlama's Poca Mocha - Nancy Miller-Borg <b>Reserve:</b> Peloquins Hally Ween Spookie Ap! - Dorthe Peloquin
<b>Light Wool Female</b>	<b>Grand:</b> Overman's Black Sapphire - Debbie Andrews	<b>Grand:</b> Overman's Black Sapphire - Debbie Andrews
<b>Medium Wool Female</b>	<b>Grand:</b> ALCL Anna - Savannah Morgan <b>Reserve:</b> ALCL Dominique - Debbie Andrews	<b>Grand:</b> ALCL Dominique - Debbie Andrews <b>Reserve:</b> ALCL Anna - Savannah Morgan
<b>Heavy Wool Female</b>	<b>Grand:</b> Carolinas Charlotte - Kylie Morgan <b>Reserve:</b> MSF Moondance - Debbie Andrews	<b>Grand:</b> MSF Moondance - Debbie Andrews <b>Reserve:</b> Carolinas Charlotte - Kylie Morgan
<b>Suri Wool Male</b>	<b>Grand:</b> NWLF's Stormchaser - KittyTuck-Hampel <b>Reserve:</b> KRS V Mater of Dance - Stacy Mashburn	<b>Grand:</b> NWLF's Stormchaser - KittyTuck-Hampel <b>Reserve:</b> KRS V Mater of Dance - Stacy Mashburn
<b>Light Wool Male</b>	<b>Grand:</b> RCF Browning - Bailey Jones <b>Reserve:</b> ALCL After Midnight - Alex Williams	<b>Grand:</b> AFK Liar's Mark - Kitty Tuck-Hampel <b>Reserve:</b> NWLF's Flash Gordon - Lauren Wright
<b>Medium Wool Male</b>	<b>Grand:</b> ALCL Before Midnight - Debbie Andrews <b>Reserve:</b> WCF James Bond - Elizabeth Ingram	<b>Grand:</b> ALCL Before Midnight - Debbie Andrews <b>Reserve:</b> CWL Black By Design - Bailey Jones
<b>Heavy Wool Male</b>	<b>Grand:</b> Spapveco's Rock Starr - Lauren Wright <b>Reserve:</b> Oak Rest's Cinco De Mayo - Kathy Wilbanks	<b>Grand:</b> Spapveco's Rock Starr - Lauren Wright <b>Reserve:</b> Detroit's Star Walker - Dorthe Peloquin



# ST. PATRICK'S DAY PARADE ATLANTA

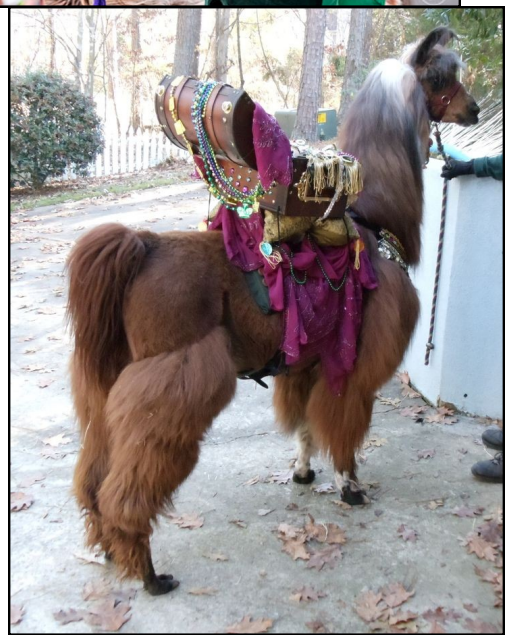

## REMEMBER . . . .

*This article is from the SSLA Llama Journal Summer 2001*

### **Click, Treat & Train and Enjoy the Results!**

*By De Ila Meyer*

The more I work with my llamas, the more I thank for something every trainer I ever met.

I thank Marty McGee for catch-rope haltering and the no-pressure handling techniques, especially for legs. I thank John Mallon for the idea of rewarding llamas by my absence. But most of all, I thank Jim and Amy Logan for the Click & Reward™ technique that makes my llamas eager to be trained.

Click & Reward™ is the Logans' term for an operant training technique that uses only positive reinforcement. This technique was first conceived in the 1940's by behaviorist B.F. Skinner and has been used since that time by many types of animal trainers, including those training dolphins and other marine mammals. We think training a llama can be challenging, but how do you train an animal that can just swim away from you? Believe me, this technique works with dolphins, and it works equally well with not only llamas, but all of the animals that are trained to “act” in movies and on television. This is a powerful technique, but basically very simple.

Click, Treat & Train uses a clicker as a signal to the animal that he has done something right. It is an exact time marker, so that the animal has no doubt regarding what is being rewarded. The click is always followed by a reward. A bit of the llama's regular ration is a good treat. The challenge from the trainer's perspective is to become accurate enough with the clicker so that he is rewarding the behavior that he wants, and not the behavior that precedes or follows the correct behavior. A split second can make the difference. Practice is essential for good results.

I first used clicker training with a llama that wanted to jump the fence and run away anytime his owner entered any size enclosure with him. Within a few sessions over the course of two or three weeks, he was standing in the stall for haltering. The results were most astounding to me.

The 4-H'ers in the Carolina Cria Club sponsored by Saluda Farms have been using clicker training to train their llamas. We have seen impressive results with haltering by young 9 and 10 year old 4-H'ers. One of our older members was given the challenge of working with a llama notorious for kicking. Over the course of now too very long, the llama was tolerating touching and grooming of back legs.

I like to work with some of our more difficult llamas in order to eliminate undesirable behaviors, such as spitting or kicking. With Click, Treat & Train, the best way to eliminate undesirable behaviors is to teach an incompatible behavior, so they can't do both the desired behavior and spit or kick at the same time. It is really wonderful to see this kind of progress.

It is amazing how the sound of the clicker becomes a positive communication to the llamas. Recently two of our llamas who had been away from “home” for about six months returned for breeding. The new owner obviously had a fine relationship with the llamas and frequently hand-fed them, but he did not consistently clicker train. Although he would feed when he was getting behavior he wanted, he didn't include the clicker. Observing some difficulty in haltering, I used the clicker to halter the younger one, and it was as if a light switch had been turned on. It was obvious that this was a sound that she remembered and enjoyed. I am, using the brief opportunity of having her back “home” to work on her training. It is far from an instant solution, but it is certainly a positive way to improve the haltering scenario.

This is the fun part of the interaction with the llamas. They enjoy the training, and that makes it fun and rewarding for all of us.

# SSLA ANNUAL CONFERENCE HIGHLIGHTS MARCH 16-18, 2018

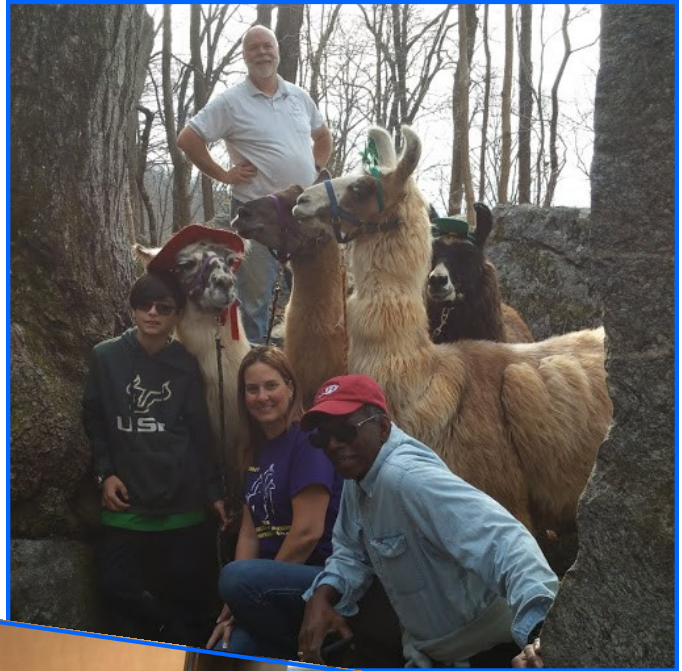

# SSLA ANNUAL CONFERENCE HIGHLIGHTS MARCH 16-18, 2018

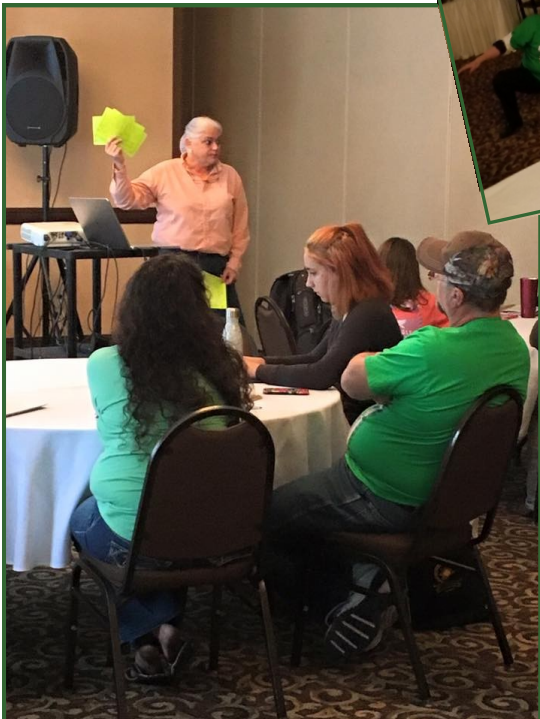

Llama Club near Apple Valley, GA  
Proper pack fitting and Easter Egg hunt

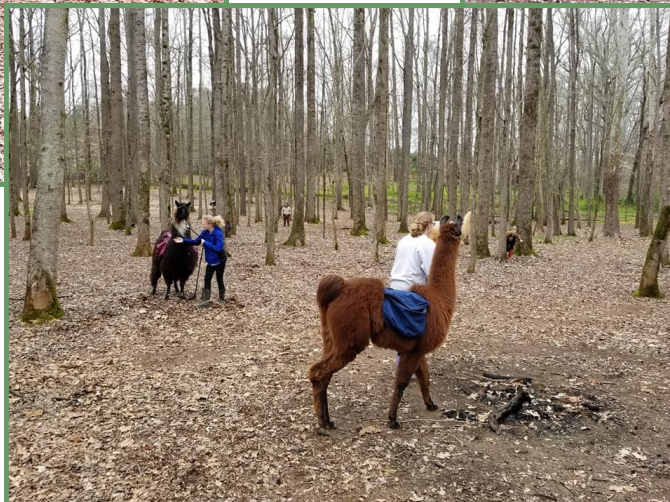

## CALENDAR OF UPCOMING LLAMA EVENTS

Date	What	Where	Contact
Apr 14, 2018	Mellow Yellow Llama Show		Cathie Kindler <a href="mailto:llamajudge@gmail.com">llamajudge@gmail.com</a>
Apr 20-22, 2018	Smoky Mountain Fiber Arts Festival	Townsend, TN	<a href="http://townsendartisanguild.net/fiber-arts.html">townsendartisanguild.net/fiber-arts.html</a>
Apr 27-29, 2018	SSLA Spring Pack Llama Trial	Dupont Forest, NC	Mary Rose Collins <a href="mailto:MRC604@tampabay.rr.com">MRC604@tampabay.rr.com</a>
May 26-27, 2018	Northeast Tennessee Llama Show	White Pines, TN	Kathy Devaul <a href="mailto:kdevaul@bellsouth.net">kdevaul@bellsouth.net</a> Cathie Kindler <a href="mailto:llamajudge@gmail.com">llamajudge@gmail.com</a> Cheryl Lambert, <a href="mailto:Clambert5@tampabay.rr.com">Clambert5@tampabay.rr.com</a>



Jackson County 4H Love of Llamas participating in a fundraiser with Regional District Project Achievement for 4H of Georgia



## ADVERTISING INFORMATION

Advertising content may be emailed as clean  
as a high-resolution (300 dpi or better) electronic file to:

**Charlene Braun**, Online SSLA Journal Editor at [turtlrun@earthlink.net](mailto:turtlrun@earthlink.net), 352-243-0383

Or **Lisa Pool**, Printed SSLA Journal Editor at [designsbylisap@gmail.com](mailto:designsbylisap@gmail.com), 478-825-3239

*Please verify via phone or email to ensure your ad has been received. You must pay for it prior to publication.*

Ad sizes				
Full Page 7 ¼ x 9 ½"	Half Page 3 ½ x XX	Quarter page 7 ¼ x 2 1/2		Business Cards
		Quarter Page 3 ½ x 4 ¼		

**Display Advertising:**  
All advertising must be camera-ready. Advertisers are encouraged to submit ads in electronic format. All electronic ads must be 300 dpi and in MS Word, Publisher, pdf, tif, or jpg format.

Ad Types and Sizes	Members Only Cost	Non-Member Cost	How Many	Amount
Cover ads (contact Able publishing at <a href="mailto:steph.pride@ableprintingcompany.com">steph.pride@ableprintingcompany.com</a> )	\$185	\$200		
Full page black & white (7 ¼" wide x 9 ½" high)	\$90	\$105		
Half page (7 ¼" wide x 4 5/8" high or 3 ½" wide x 9 ½" high)	\$45	\$60		
Quarter Page (7 ¼" wide x 2 3/8" or 3 ½" wide x 4 5/8" high)	\$25	\$35		
Business Card (3 ½" x 2")	\$5	\$10		
Classified Ad (See Instructions below. 35 words or less, each word over 35 words is \$0.10 extra)	\$5	\$10		
Name, Farm and Website listing only (free with purchase of business card ad)	\$5	\$10		

### Display Ads

**CLASSIFIED ADS...** The first 35 words are a flat \$5. Each additional word after 35 is \$0.10 (10 cents) each. Each separate ad is \$5.00 for the first 35 words. When counting words remember:

- the entire farm name is one word
- an animal's proper name is one word
- the phone number is one word
- punctuation does not constitute a word
- the price is one word

### NOTE TO ADVERTISERS

Ad invoices are sent via email. All ads must be paid in advance. Please send payment made out to SSLA to:

Kathy Devaul  
217 Donald Rd  
Leesburg, GA 31763

## FREE BUSINESS CARD ADS!

Want one?

Just submit an article or  
photo series to the Journal.

## Southern States Llama Association (SSLA) Obstacle Trailer Advertising Form

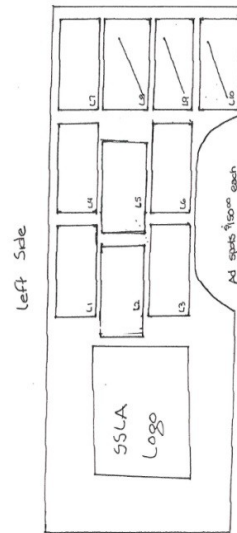
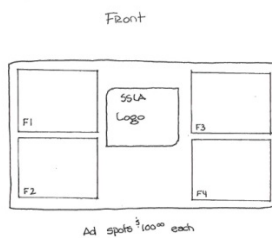
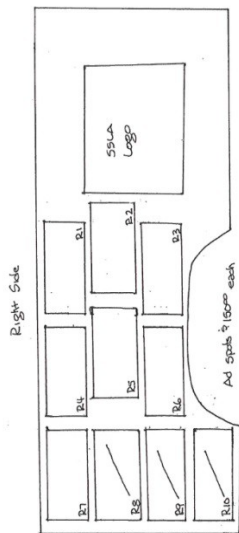
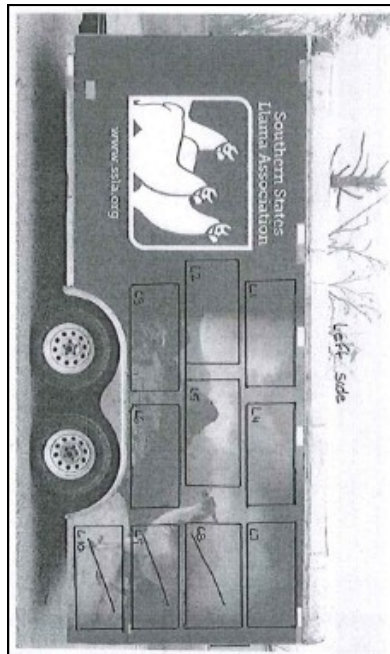

SSLA is offering this MOBILE opportunity for visibility within the Southeast Region of the United States. Great limited space available opportunity to hit the roads, show rings, interstate, back roads, mountains and rest areas within the SSLA show area! SSLA is opening up the opportunity for marketing on the obstacle trailer! Limited space available. Artwork assistance available.

The profile photo of the trailer gives you a visual image of the opportunities available. The company that created the wrap artwork for the obstacle trailer is assisting with artwork design and installation.

*Continued on next page*

---

## Southern States Llama Association (SSLA) Obstacle Trailer Advertising Form

Advertisement is for a full year based on advertising contract. Ads for the side panels for \$150 per space. Ads for the front panel is \$100 per space. Payments must be received prior to space being reserved.

Name: \_\_\_\_\_

Address: \_\_\_\_\_

Phone Number: \_\_\_\_\_

Email: \_\_\_\_\_

Space selection: \_\_\_\_\_

Please complete this form and return to Kathy Devaul.  
[kdevaul@bellsouth.net](mailto:kdevaul@bellsouth.net) or mail 217 Donald Road, Leesburg, GA 31763.