

The SSLA



LLAMA JOURNAL

The Official Journal of the Southern States Llama Association

July 2019



TABLE OF CONTENTS

SSLA Board Members and Information	3
President’s Message	4
SundMist Pastures	5
Jackson County Love of Llamas Attend NETLS	6
Highlights from Northeast Tennessee Llama Show	8
Llama Rendezvous at the Beach	10
Reservation Form—Llama Rendezvous at the Beach	12
From 2001: Llama Care for Warm Weather	13
Calendar of Upcoming Llama Events	15
Obstacle Trailer Advertising Information	16

Cover: Class from NETLS

Deadline for the next issue is October 15, 2019

Send articles, photos (digital format) to:

Charlene Braun, Online Journal Editor, turtlrun@earthlink.net

SSLA BOARD MEMBERS AND INFORMATION

Board of Directors

Kim Kyst, *President*
Kim@kyst.org

Tom Rothering, *Vice President*
TWRothering@aol.com

Kathy Devaul, *Treasurer*
Kdevaul@bellsouth.net

Lauri Jones, *Secretary*
Laurijones@windstream.net

Greg Hall, *Director*
SimplicitylamaFarm@yahoo.com

Andie Frederick, *Director*
Davidandie@msn.com

Vicki Sundberg, *Director*
homesweethome_3@yahoo.com

Committee Chairs & Contacts

(If the committee chair is a board member, that person is also the Board Liaison)

Committees

Annual Meeting Conference—

By-law Amendment—Tom Wilson
Board Liaison: Kim Kyst

Carting—Greg Hall

Election—Kim Kyst

Fiber—Tracy Weaver
Board Liaison: Lauri Jones

Online Journal—Charlene Braun
turtlrn@earthlink.net
Board Liaison: Andie Frederick

Library—Lauren Wright

Llama Trekking & Packing—
 Tom Rothering

Membership—Lauri Jones

Show—Kathy Devaul

Website—Vicki Sundberg

Youth & Youth Ambassador Awards—
 Cathie Kindler
Board Liaison: Kim Kyst

Youth Scholarship— Tom Rothering

Ambassador Awards—Greg Hall

Trekking Awards —Vicki Sundberg

Sweepstakes Awards—Lynn/Lauren
 Wright

Rescue—Deborah Logan
logan99.mail@gmail.com

Sweepstakes Program/Points — Vicki
 Sundberg

Journal Mission Statement

THE LLAMA JOURNAL, published by the Southern States Llama Association (SSLA) is distributed quarterly to the members of SSLA. The purpose of the Journal is to provide:

- Information and articles of interest
- A forum for members to express their opinions on llamas and related matters
- Board of Directors meeting minutes, Treasurer's report and other information pertinent to the function of SSLA.

Notice: The information contained in this Journal is not intended to be a substitute for qualified professional advice. Our readers are encouraged to consult with their own vets, accountants or attorneys for questions concerning their animals or business operations. SSLA or the editor is not responsible for any losses resulting from a reader's failure to heed this caution. Opinions expressed or implied are hereby the editor's choice and are not the opinions of the SSLA Board of Directors or SSLA as a group.

SSLA Mission Statement

OUR MISSION as members of the Southern States Llama Association is to be a strong organization of llama and alpaca owners who have joined together for the purpose of education, fun, and fellowship while promoting the health and welfare of llamas and the llama industry.

SSLA Online—keep in touch with your llama organization

Website: www.ssla.org

Facebook page: Listed as "SSLA-Southern States Llama Association"

SSLA-Members Yahoo Group:
 Request membership from ssla-members-owner@yahoogroups.com

Group members can post messages to SSLA-Members@yahoogroups.com

PRESIDENT'S MESSAGE



Summer is here and so is the heat and humidity. I hope everyone has taken the time to prepare their animals and farms to assist your llamas with survival during the summer elements. Remember not only does the heat play a huge factor, but so do parasites and predators. Shearing, ongoing health checks, pasture cleanup, proper shelter, access to fresh cool drinking water, wading pool or water access, limiting standing and stagnate water, running fans, and access to electrolytes can help all aide in your herds health during this time. My herd loves the daily visit and water games. Maybe you can find time incorporate wetting a few bellies and view a few mud baths into your summer activities! It's funny the animals do love it, but I do believe the youth and parents possibly enjoy it more. They are who make Chelian Farm and the Jackson County 4-H Love of Llamas amazing place! Our herd is spoiled completely rotten! Yes, we even have some animals that require hand feeding, not because of health concerns.....just because they are rotten to their cores!

SSLA needs volunteers!!! By volunteering, it will allow you to become more connected with SSLA. It will allow you to help steer the direction of SSLA and its programs and events. By growing the number of volunteers within our organization, it will help create and structure a bigger, brighter and stronger organization. Without volunteers the organization will not thrive. We suffer at events, on committees and filling spots vacated on the Board of Directors each year. As the SSLA President, I am reaching out for volunteers and assistance. Please consider becoming a vital dependable part of our organization. Please contact me to discuss, Kim Kyst kim@kyst.org.

The SSLA Board: Kim Kyst-President, Tom Rothering-Vice President, Kathy Devaul-Treasurer, Lauri Jones-Secretary, Greg Hall, Andie Fredericks, and Vicki Sundberg. Please feel free to contact any of the board about opportunities and concerns within our organization.

The SSLA Committees and Chairs: By-Laws: Tom Wilson, Carting: Greg Hall, Elections: Kim Kyst, Fiber: Tracy Weaver, Online Journal: Charlene Braun, Library: Lauren Wright, Llama Trekking & Packing: Tom Rothering, Membership: Lauri Jones, Show: Kathy Devaul, Website: Vicki Sundberg, Youth & Youth Ambassador Awards: Cathie Kandler, Youth Scholarship: Tom Rothering, Ambassador Awards: Greg Hall, Trekking Awards: Vicki Sundberg, Sweepstakes Program/Points: Vicki Sundberg, Sweepstakes Awards: Lynn and Lauren Wright, and Rescue: Deborah Logan.

Our next edition of the **SSLA Journal** deadline is October 15, 2019. It will be published on October 20, 2019. Please

remember to submit articles and photos. The Journal is a useful avenue for veterinarians to submit articles that the entire membership will find useful and educational. Please reach out to your veterinarian to see if they have experienced concerns within our industry that they would like to share. Remember this is a great place to do feature stories on events and activities. Please remember to submit articles, photos, and advertisements to Charlene Braun turtlrn@earthlink.net

Agritourism has become a popular part of our region's economic generators. Several of our members are taking advantage of offering day trips, educational programs, hikes, yoga, and such to help offset farm expenses. If this is an avenue you are considering for your farm, please reach out to those who have become successful within SSLA's membership. There are also several governmental, non-governmental, and university organizations dedicated to assisting in the development and marketing of agritourism. Llamas are extremely popular now, so it would be a great time to ride their success and get involved in agritourism to educate the community about our wonderful animals.

SAVE THE DATE! The **2020 SSLA Educational Conference and Awards Banquet** date has been set. The event will once again be at the UGA Livestock Arena in Athens, GA on March 13-15, 2020. Please contact me to give me idea of programs you feel would beneficial to the membership and veterinarians.

Our next SSLA event is the **Heart of Dixie Llama and Alpaca Show** in Ringgold, GA. A special thank you to Stacey Mashburn and the Willow Tree Farm for hosting this event; they do an amazing job creating a beautiful facility for our show. Hopefully you are making plans to attend! Show information can be found on the SSLA website. If you need further assistance, please contact Kathy Devaul at kdevaul@bellsouth.net

For a full list of other activities and events, please go to the SSLA website at www.ssla.org. If you have information you would like to post or update on the website, please contact webmaster, Vicki Sundberg homesweethome_3@yahoo.com

Thank you to each of you for your support! I look forward to hearing from you soon! Be safe in your travels!

Kim Kyst
 SSLA President
kim@kyst.org
 678-481-3759

More fun event pictures from SundMist Pastures.

Fund Raising Event: We were asked to help raise some funds for a lady who suffered a stroke while pregnant with her second child. Not only did she lose the baby but also her eyesight. We offered a Picture for Karen for a donation. The money went towards surgery to hopefully regain eyesight.



Llamas and South Brunswick High School: For the second year we have joyfully shared the llamas with the Special Needs class. This year, we borrowed the idea of Llama Yoga from others with rave reviews.



THE JACKSON COUNTY 4H LOVE OF LLAMAS ATTEND NETLS

The Love of Llamas show team traveled to the beautiful Tennessee mountains to compete in the Southern States Llama Association's (SSLA) Northeast Tennessee Llama Show in White Pine, TN. The show, which was held Memorial Day weekend, is a Double ALSA (Alpaca Llama Show Association) point, Double ILR-SD (International Llama Registry-Show Division) point, and Quad SSLA point show, which means the youth are competing simultaneously in two shows and are earning double points toward the show placings.

The show superintendents were Cathie Kindler of Ellijay, GA and Kathy Devaul of Leesburg, GA. The two show judges were Cynthia Ernst (Green Judge), from Michigan, and Mike Haumschild (Orange Judge), from Ohio.

The show includes several performance classes which include Pack, Obstacle, and Public Relations. The 4H Love of Llamas youth work with both llamas and alpacas. The youth and their animals work as a team



to maneuver obstacles that they may encounter in a real-life situation, such as walking over fallen limbs or over a bridge. Both youth and animals train together and build a strong bond. The animals trust the youth to lead and show the skills that they have learned together.

Showmanship class offers the youth a chance to share their knowledge and handling techniques of the llama or alpaca before the judges. The judges ask the youth questions about their specific animals or about specific traits of llamas or alpacas. Halter class gives the youth a chance to show the llama or alpaca based on conformation, or how physically correct the animal is and how well they move, as well as fiber quality.

Lily Howell had the opportunity to show two llamas in the Tennessee show, Moose Hill's Hondo and Chama Llama Ding Dong. Lily said she "enjoyed showing Chama and Hondo in my first major show and doing so well during Halter Class." This was the third show for Olivia Ascenzo and alpaca Senor Fuzzybutt. Olivia said what she loved most about the show is that "I get to spend so much time with Fuzzy and I get to see so many beautiful llamas and alpacas." Racheal Gilley attended with Moose Hills She-mar, and Megan Gilley with GVL Silver Salute.

THE JACKSON COUNTY 4H LOVE OF LLAMAS ATTEND NETLS

The 4-H youth placed as follows:

Junior Youth Class:

Olivia Ascenzo and Senor Fuzzybutt in Junior Youth Pack: 4th and 5th, Junior Youth Obstacle: 2nd, Junior Youth Public Relations: 4th and 5th, Junior Youth Performance: Reserve, Junior Youth Showmanship: 4th, Alpaca Non-Breeder: 5th

Racheal Gilley and Moose Hill's Shemar in Junior Youth Pack: 3rd, Junior Youth Obstacle: 3rd, Junior Youth Public Relations: 2nd, Junior Youth Showmanship: 3rd.

Intermediate Youth Class:

Lily Howell and Chama Llama Ding Dong in Intermediate Youth Pack: 2nd, Intermediate Youth Obstacle, Intermediate Youth Public Relations: 3rd and 4th, Intermediate Youth Showmanship: 3rd, Yearling Suri Wool Male: 1st Grand and Reserve

Lily Howell and Moose Hill's Hondo Juvenile Silky Male: 1st and Grand

Senior Youth Class:

Megan Gilley and GVL Silver Salute in Senior Youth Pack: 2nd, Senior Youth Obstacle: 3rd, Senior Youth Public Relations: 2nd, Senior Youth Performance: Reserve, Senior Youth Showmanship: 2nd, Adult Non-Breeder: 3rd and 5th

~Heather Ascenzo



2019 NORTHEAST TENNESSEE LLAMA SHOW



2019 NORTHEAST TENNESSEE LLAMA SHOW



LLAMA RENDEZVOUS AT THE BEACH

The revival of the Llama Rendezvous at the Beach (2006 - 2013) on **September 27 - 29, 2019** will launch a *new camping venue* while retaining the previous unique experience with your llama – the beach, the dunes, the sun, historic sites and a ferry ride. Carolina Beach State Park has approved having llamas at eight (8) campsites. Llamas are limited to a maximum of **two per campsite** and **MUST** be secured at all times (corralled, tethered, inside a trailer, or on a lead). This very limited *experimental* first year will test this concept of actually camping near the beach. Lessons learned will dictate future events.

What we do:

1. Introduce your llama to the Atlantic Ocean.
2. Do the beach thing – the sun and the water. At the 2009 Rendezvous we created **Llamas' Games at the Beach**.
3. Practice packing – let the llamas carry your picnic and drinks to the beach.
4. Hike a two-mile salt **marsh forest trail** leading to the ocean. Bring your binoculars to watch the marsh and ocean birds and animals. Find the location of the “home” of the Fort Fisher Hermit who spent 17 years under the stars and scrub oaks of Fort Fisher.
5. Take your llamas on a **ferry ride** from/to Ft Fisher State Park to Southport.
6. Wander with your llama through **Brunswick Town**, a colonial ghost town located beside the Cape Fear River. Brunswick Town was the first settlement in the Cape Fear region. A major pre-Revolutionary port on North Carolina’s Cape Fear River, Brunswick was razed by British troops in 1776 and was never rebuilt. During the Civil War, Fort Anderson was constructed atop the old village site, and served as part of the Cape Fear River defenses below Wilmington before the fall of the Confederacy. Today, it is one of North Carolina’s state historic sites and a working archaeological site.
7. Cart drive your llamas (we have two carts to share). If you don’t have a carting llama, you have the opportunity to drive one of ours.
8. Visit the historic **Civil War Fort Fisher** and museum.
9. Six miles of trails wind through a variety of distinct habitats at Carolina Beach State Park. Relatively flat and easy to walk, the trails offer an opportunity to observe the diversity of plant and animal life in the park. Bikes are not allowed on the park trails.
10. Fish from the river bank, or the wheelchair accessible fishing deck. Flounder, spot, sheepshead and speckled trout are waiting. A North Carolina Coastal Recreational Fishing License is required to fish in the park.
11. Eat **FRESH** seafood. The park is close (almost walking distance) to abundant restaurants.
12. Be prepared to do **Public Relations** -- we draw attention -- if you can imagine that. You never know what we'll end up getting into. Over the years, we've coincidentally been involved in two different weddings, a photo shoot and definitely the newspaper.

Got an idea? We can try that, too!

continued on next page

LLAMA RENDEZVOUS AT THE BEACH

THE DETAILS

CAMP SITES.

- Only eight (8) tent/trailer campsites have been approved for llamas. Reservations, along with full payment, is strictly limited by filling out the attached registration form and mailed to:
Vicki Sundberg
5550 Mills Trail SE
Bolivia, NC 28422
- Maximum capacity per site is six (6) people, two (2) tents, two (2) llamas. RVs (motorhome, tagalong, fifth wheels) are limited by size. Details are on the registration form. NOTE the length limitations apply to the length of your vehicle/trailer.
- An adult 18 years of age or older must occupy the site.
- No electrical hook-ups at these sites. Generators and unnecessary noises are not allowed between 11:00 PM and 7:00 AM.
- Two water spigots are located for these eight sites.
- A bathhouse is available for camper's use.
- All vehicles must be registered and display a green vehicle pass. No more than two (2) vehicles are allowed per site. Vehicles/trailers that don't fit in the camp site must park them at the marina or visitor center parking lot.
- Parking is prohibited along road shoulders, in the woods and on unoccupied campsites.
- Llamas are not allowed to forage. These delicate sandy sites have very limited growth for grazing.
- While not on a lead, llamas must be securely corralled, tethered, or in a trailer. Bring your own corral panels - none available locally. Bring your own hay and feed. Park rangers expressed concern about the llamas causing damage to their campsites. They were assured that when we left, they would not be able to detect the presence of llamas and minimal impact of humans. **(Please)**
- Raccoons and other wildlife are present. They may carry or transmit rabies. Rabies may be contracted through touching rabid wildlife or items they may have chewed upon.
- More "fun" facts: Venomous snakes are common to this region. Deer live in the park. Poison ivy, poison oak, and poison sumac are abundant in the park. Ticks and chiggers are also found in the park. Take precautions before arriving and bring appropriate insecticide for you and your llamas.
- Carolina Beach State Park is located on the Cape Fear River side of Pleasure Island. Swimming or wading in adjacent park waters is prohibited due to dangerous currents and sharp drop offs.
- Please don't transport firewood into our state parks because you could unknowingly spread dangerous insects and diseases—such as the emerald ash borer—which can harm the forest. Buy firewood locally at the marina, or buy heat-treated firewood.
- The front gate is closed and locked at posted closing times (7 PM - 7 AM) for your protection. There will be no exiting or entering the gate between these times and the combination will NOT be given out. If you leave the park and do not return before closing time, you will not be able to re-enter. If you have an emergency, see camp host. Please notify camp hosts for emergencies only.

Web Site: <https://www.ncparks.gov/carolina-beach-state-park>

Vicki Sundberg & Dave Smith, SundMist Pastures
(910) 253-5612
homesweethome_3@yahoo.com

Reservation Form for 2019 Llama Rendezvous at the Beach

Fill out a separate form for each site you are going to use for your party.

So that you have realistic expectations, the following are the options. Most likely either your vehicle or trailer will need to be parked in the park office parking lot due to the limits. Circle preferred site, if any.

- | | |
|---|--|
| <u>Two pull throughs:</u> | 64 Driveway length 45', Max vehicle length 40' |
| 67 Driveway length 76', Max vehicle length 40' | 65 Driveway length 53', Max vehicle length 45' |
| 69 <u>Drive way length 69', Max for the site:</u> | 66 Driveway length 40', Max vehicle length 30' |
| Name (18yr old or greater for the site): | 68 Driveway length 48', Max vehicle length 48' |
| Name (18yr old or greater for the site): | |
| <u>Six Back ins:</u> Name (18yr old or greater for the site): | |
| 62 Driveway length 48', Max vehicle length 48' | |
| 63 Driveway length 57', Max vehicle length 40' | |

Your request for a specific site will be noted, however, to best accommodate the most people, specific site assignments will be made once all eight people make reservations.

Name (18yr old or greater for the site):	Phone(s):
_____	_____
Address:	Email(s):
_____	_____
_____	_____
_____	_____

Vehicle Length: _____ ft Trailer Length _____ ft Total: _____ ft

Is the vehicle or trailer an RV? Yes No Describe your trailer: _____

What are your plans for sleeping (in tent, in car/truck, in RV, etc)?

What are your plans for securing your llamas overnight?

Can you back your combined rig into a lane or will you require a pull through lane?

\$80.00

Cost covers two nights (Friday and Saturday) at camp site, transaction fees, use fees, and special permit fees for Carolina Beach State Park and Ft Fisher State Park. This does not cover ferry toll, entrance fees, food, etc.

Make check out to: Vicki Sundberg

Mail to: Vicki Sundberg
5550 Mills Trail SE
Bolivia, NC 28422

From 2001 JOURNAL:

LLAMA CARE FOR WARM WEATHER

Lillian Beck
KENT ROCK MEADOWS

The change in the seasons requires different types of care for your llamas. The heat in the South as well as in the North can suddenly change to a very warm or hot and humid temperature. Llamas can tolerate gradual changes over a period of days, but an abrupt one can greatly affect them. If you have a llama that is ill, has worms, or is pregnant, that additional high temperature can result in them getting heat exhaustion.

It is never too early to plan for the oppressive humidity and heat of the summer. Some of the ways you can prevent your animals from developing heat stress is just proper maintenance and care. Keep up a deworming program, which you and your veterinarian have decided on. Make sure you keep your llamas' vaccinations up to date. Do a daily observation of your animals to make sure they are well. Over a period of time you will begin to know and understand your animals for signs of wellness and illness. This will avoid some problem becoming worse over a period of time. Make sure they always have fresh clean water, and also a clean cool place to lie down. Put out minerals and salt blocks. Plan a shearing program for all of your llamas and stick with it. Also provide them with fans which will circulate a lot of air. Install sprinklers in your fields.

Your program for avoiding heat-related problems in your animals can actually begin with the construction of your barn. Plan for the best wind circulation you can capture. Allow nature to help you out in this building process. Walk around the area where you plan to build and see which way the wind normally blows. Construct your barn doors so that the wind will blow through the building. Have all buildings versus short low ceilings. The higher the roof and walls the better air flow you will receive. As I said, let nature talk to you in your construction. If you wanted to stay cool, would you get out in the hot field and lie down, or into some woods, which are cooler? Save your fields for grass and hay, and construct some of your llama shelters in the woods.

We built four of our building in the woods, and one out in the open field. From the middle of April to the end of September the building in the field is useless except in

the early morning. It is like a bake oven. But in the fall and winter it is well-loved by the llamas. We are not getting our maximum usage out of that building. Remember, if you build your barns out in a hot area they will go there because they have nowhere else to go for protection and shelter from the sun. Something to them is better than nothing, but why not make their home as pleasant and cool as possible? Our barns in the woods are always 10 to 15 degrees cooler than the other barn.

As we built we became smarter; the last barn for the females is very tall, the wind blows through both doors. It is constructed with walls that only go up six feet and is open to the floor. This allows the hot air to escape out the top and the wind to blow in. We use fans that sit on shelves in openings we constructed in the walls, and this has been very successful. All the fans in the barns have been put on timers. As the summer progresses, we can select the time for them to go on and off, which is a wonderful time save. There are no fans on the floors and therefore, it has prevented groups of llamas from bunching up on one or two fans and forming a crowd. This again allows better air circulation in the barn.

The floor has pea gravel thrown on it, which we hose down so the llamas are lying on a cooler floor. The gravel provides another added benefit of helping to keep their nails trimmed down.

I have talked with some people who have put sprinkler hoses close to the floor and place them on timers. This is wonderful way to get llamas' bellies cooled. Llamas get matted down with the weight of water if it is on their backs, turning their wool into a wet felt which traps their body heat.

A good sprinkler in the fields that rotates is nice because it not only will water your grass, but cools the legs and underbelly of the animal. Some will even learn to drink out of these sprinklers. I try to teach all our llamas to drink out of a hose, too. Almost all of our animals look forward to being hosed. Be sure to do this on their legs and under their bellies and leg pits, and under the tail.

continued on next page

LLAMA CARE FOR WARM WEATHER *continued*

Another popular item is a baby pool. We have stopped using this since they became dirty too fast and the llamas began fighting over who was going to lie down in the pool, or they broke the pool with their toenails. But honestly, there is nothing funnier than seeing six or seven llamas standing in a baby pool!

To help complete their comfort nothing can substitute for shearing. This is really essential in the South. You can shear with scissors or electric shears. The shearing of your llamas really is the only way to assure that they will not suffer from the heat.

Llamas develop heat exhaustion over a period of time. The effects of heat plus humidity add up and then their body overheats. That is when your animal can die from heat exhaustion. Signs of heat exhaustion can be very subtle and a llama can be in the early stages without your being aware of it. Signs are a staggering gate, inability to get up, redness to the skin, mouth breathing, and sometimes drooling. The male's scrotums will swell and enlarge. Young crias also have a difficult time in the heat. They must be watched carefully. It is best to give them a barrel cut, and keep them in a cool area if possible.

Early prevention is always the best cure for heat stress, but if you find one of your animals in this situation the treatment must be fast. If your animal isn't sheared, get all the body wool off as quickly as possible. Hose the llama down for at least 20 minutes or more. It takes this long for the core body temperature to start cooling. A small cria can be picked up and put directly into a tank of cool water. Try to see if you can get oral fluids into the llama. See if you can get them to drink out of the hose. You may need medical help if the llama does not respond to the above care. Call our veterinarian; IV fluids and other supportive care may be required.

If you are aware of the daily temperature and relative humidity. It will give you an idea of the day your llamas will have to face weather-wise. Add the temperature and humidity and if the total is under 120—not too bad, but a total of 120 or higher—that is a Red Alert day. Hose your llamas down and watch them all. With planning, and shearing of your llamas, you will be able to keep them fairly comfortable. Even on those Red Alert days they will do well if you spend the extra time up front to prepare them for the hot summer days.



CALENDAR OF UPCOMING LLAMA EVENTS

Date	What	Where	Contact
Aug 31 - Sep 1, 2019	Heart of Dixie Llama Show		Cathie Kindler llamajudge@gmail.com
Sep 4-5, 2019	John Mallon- Gentle Training Llamas and Alpacas	Seymour, TN	Susan Sterling MiscStock@yahoo.com
Sep 6-8, 2019	NC Mountain State Fair Llama/ Alpaca Show	CANCELLED	
Sep 20-22, 2019	Llama Fleece Judging Clinic	Four Ladies and Me Llama Farm Michael and Patricia West East Bend, NC	Mary Jo Miller and Fran Soukup fran@srllamas.com
Sep 27 - 29, 2019	Llama Rendezvous at the Beach	Carolina Beach State Park, NC	Vicki Sundberg homesweethome_3@yahoo.com
Oct 5, 2019	The Great Llama Race Fundraiser for Casa de Sara	Knoxville, TN	Deb Logan logan99.mail@gmail.com
Oct 11-13, 2019	GA National Fair Lama Show	Perry, GA	Kathy Devaul Kdevaul@bellsouth.net
Oct 11-13, 2019	ALSA SE Regional Championships	Perry, GA	Cheryl Lambert clambert5@tampabay.rr.com
Oct 25-27, 2019	Southeast Animal Fiber Fair	Fletcher, NC	https://www.saffsite.org/
Dec 7, 2019	Children's Healthcare of Atlanta Christmas Parade	Atlanta, GA	Tracy Munroe witsendfarm@comcast.net

Southern States Llama Association (SSLA) Obstacle Trailer Advertising



Southern States Llama Association (SSLA) Obstacle Trailer Advertising Form

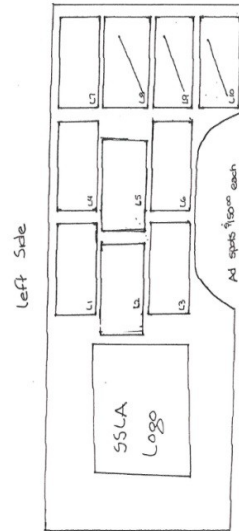
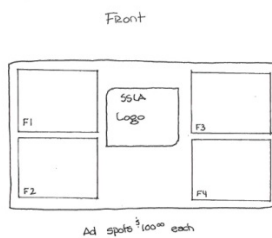
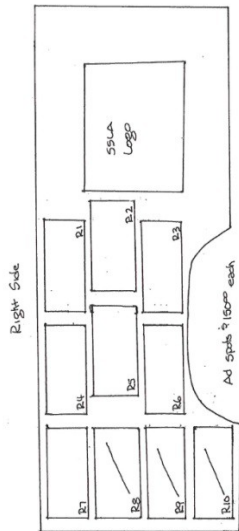
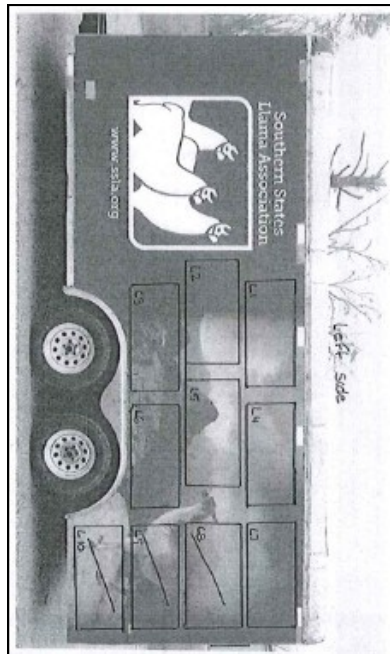

SSLA is offering this MOBILE opportunity for visibility within the Southeast Region of the United States. Great limited space available opportunity to hit the roads, show rings, interstate, back roads, mountains and rest areas within the SSLA show area! SSLA is opening up the opportunity for marketing on the obstacle trailer! Limited space available. Artwork assistance available.

The profile photo of the trailer gives you a visual image of the opportunities available. The company that created the wrap artwork for the obstacle trailer is assisting with artwork design and installation.

Continued on next page

**Southern States Llama Association (SSLA)
Obstacle Trailer Advertising Form**

Advertisement is for a full year based on advertising contract. Ads for the side panels for \$150 per space. Ads for the front panel is \$100 per space. Payments must be received prior to space being reserved.

Name: _____

Address: _____

Phone Number: _____

Email: _____

Space selection: _____

Please complete this form and return to Kathy Devaul.
kdevaul@bellsouth.net or mail 217 Donald Road, Leesburg, GA 31763.