

The SSLA



LLAMA JOURNAL

The Official Journal of the Southern States Llama Association

July 2017



TABLE OF CONTENTS

Advertising Information	3
Obstacle Trailer Advertising Information	4
SSLA Board Members and Information	6
President’s Message	7
SSLA 2017 Board of Directors Meeting, March 17, 2017	7
SSLA 2017 Annual Membership Meeting, March 18, 2017	8
SSLA 2017 Board of Directors Emergency Conference Call, March 23, 2017	10
SSLA 2017 Board of Directors Meeting, May 27, 2017	10
The Winter Classic	12
SSLA 2017 Conference Photo Highlights	14
Letter to SSLA Members and Board	16
SSLA Spring Pack Trial Photos	17
Jackson County 4-H Love of Llamas Year in Review	18
2017 NE Tennessee Llama Show	20
Calendar of Upcoming Llama Events	21

*Cover: Bridal Veil Falls,
DuPont National Forest, NC*

Deadline for the next issue is October 15, 2017

Send articles, photos and ads (digital format preferred) to:

Lisa Pool, Journal Editor at designsbylisap@gmail.com
or
 Charlene Braun, Online Journal Editor, turtlrun@earthlink.net

All ads must be prepaid. Send payment to:
 Kathy Devaul, SSLA Treasurer, 217 Donald Road, Leesburg, GA 31763

Stay cool this summer!



ADVERTISING INFORMATION

Advertising content may be emailed as clean
as a high-resolution (300 dpi or better) electronic file to:

Charlene Braun, Online SSLA Journal Editor at turtlrun@earthlink.net, 352-243-0383

Or **Lisa Pool**, Printed SSLA Journal Editor at designsbylisap@gmail.com, 478-825-3239

Please verify via phone or email to ensure your ad has been received. You must pay for it prior to publication.

Ad sizes				
Full Page 7 ¼ x 9 ½"	Half Page 3 ½ x XX	Quarter page 7 ¼ x 2 1/2		Business Cards
		Quarter Page 3 ½ x 4 ¼		

Display Advertising:
All advertising must be camera-ready. Advertisers are encouraged to submit ads in electronic format. All electronic ads must be 300 dpi and in MS Word, Publisher, pdf, tif, or jpg format.

Ad Types and Sizes	Members Only Cost	Non-Member Cost	How Many	Amount
Cover ads (contact Able publishing at steph.pride@ableprintingcompany.com)	\$185	\$200		
Full page black & white (7 ¼" wide x 9 ½" high)	\$90	\$105		
Half page (7 ¼" wide x 4 5/8" high or 3 ½" wide x 9 ½" high)	\$45	\$60		
Quarter Page (7 ¼" wide x 2 3/8" or 3 ½" wide x 4 5/8" high)	\$25	\$35		
Business Card (3 ½" x 2")	\$5	\$10		
Classified Ad (See Instructions below. 35 words or less, each word over 35 words is \$0.10 extra)	\$5	\$10		
Name, Farm and Website listing only (free with purchase of business card ad)	\$5	\$10		

Display Ads

CLASSIFIED ADS... The first 35 words are a flat \$5. Each additional word after 35 is \$0.10 (10 cents) each. Each separate ad is \$5.00 for the first 35 words. When counting words remember:

- the entire farm name is one word
- an animal's proper name is one word
- the phone number is one word
- punctuation does not constitute a word
- the price is one word

NOTE TO ADVERTISERS

Ad invoices are sent via email. All ads must be paid in advance. Please send payment made out to SSLA to:

Kathy Devaul
217 Donald Rd
Leesburg, GA 31763

FREE BUSINESS CARD ADS!

Want one?

Just submit an article or
photo series to the Journal.

Southern States Llama Association (SSLA) Obstacle Trailer Advertising Form

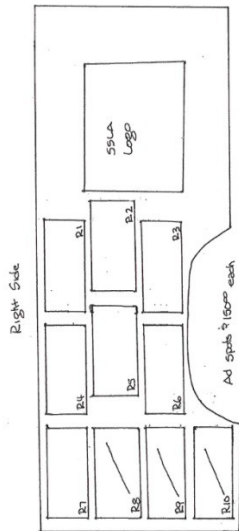
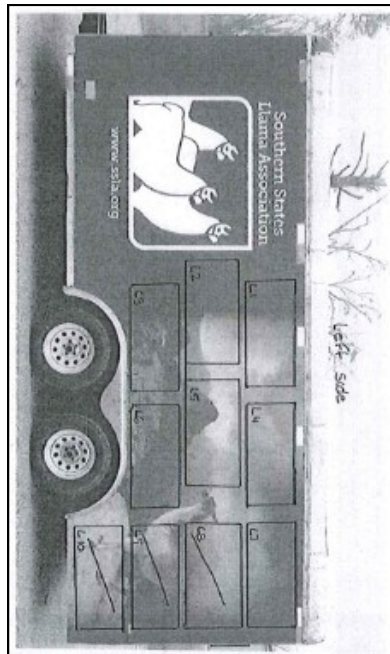

SSLA is offering this MOBILE opportunity for visibility within the Southeast Region of the United States. Great limited space available opportunity to hit the roads, show rings, interstate, back roads, mountains and rest areas within the SSLA show area! SSLA is opening up the opportunity for marketing on the obstacle trailer! Limited space available. Artwork assistance available.

The profile photo of the trailer gives you a visual image of the opportunities available. The company that created the wrap artwork for the obstacle trailer is assisting with artwork design and installation.

Continued on next page

**Southern States Llama Association (SSLA)
Obstacle Trailer Advertising Form**

Advertisement is for a full year based on advertising contract. Ads for the side panels for \$150 per space. Ads for the front panel is \$100 per space. Payments must be received prior to space being reserved.

Name: _____

Address: _____

Phone Number: _____

Email: _____

Space selection: _____

Please complete this form and return to Kathy Devaul.
kdevaul@bellsouth.net or mail 217 Donald Road, Leesburg, GA 31763.

SSLA BOARD MEMBERS AND INFORMATION

Board of Directors

Mary Rose Collins, *President*
mrc604@tampabay.rr.com

Tom Rothering, *Vice President*
twrothering@aol.com

Kathy Devaul, *Treasurer*
kdevaul@bellsouth.net

Tracy Weaver, *Secretary*
lotsallamas@earthlink.net

Karen Pihera, *Director*
kpihera@aol.com

Lynn Wright, *Director*
walkingwright@msn.com

Kim Kyst, *Director*
Kim@kyst.org

Greg Hall, *Director*
SimplicitylamaFarm@yahoo.com

SSLA Mission Statement

OUR MISSION as members of the Southern States Llama Association is to be a strong organization of llama and alpaca owners who have joined together for the purpose of education, fun, and fellowship while promoting the health and welfare of llamas and the llama industry.

Committee Chairs & Contacts

(If the committee chair is a board member, that person is also the Board Liaison)

Committees

Annual Meeting Conference—
 Mary Rose Collins

By-law Amendment—Tom Wilson

Carting—Greg Hall

Election—To be determined

Fiber—Tracy Weaver

Online Journal—Charlene Braun
turtlrun@earthlink.net

Printed Journal—Lisa Pool
designsbylisap@gmail.com
Board Liaison: Mary Rose Collins

Library—To be determined

Llama Trekking & Packing—
 Tom Rothering

Membership—Cheryl Lambert
clambert5@tampabay.rr.com
Board Liaison: Karen Pihera

Show—Kathy Devaul

Website—Vicki Sundberg
Board Liaison: To be determined

Youth & Youth Ambassador Awards—
 Cathie Kindler
Board Liaison: Kim Kyst

Youth Scholarship—Tom Rothering

Ambassador Awards—Greg Hall
Trekking Awards—Vicki Sundberg
Sweepstakes Awards—Lynn/Lauren Wright
Board Liaison: Lynn Wright

Rescue—Deborah Logan
logan99.mail@gmail.com

Sweepstakes—Vicki Sundberg
Board Liaison: Lynn Wright

Journal Mission Statement

THE LLAMA JOURNAL, published by the Southern States Llama Association (SSLA) is distributed quarterly to the members of SSLA. The purpose of the Journal is to provide:

- Information and articles of interest
- A forum for members to express their opinions on llamas and related matters
- Board of Directors meeting minutes, Treasurer's report and other information pertinent to the function of SSLA.

Notice: The information contained in this Journal is not intended to be a substitute for qualified professional advice. Our readers are encouraged to consult with their own vets, accountants or attorneys for questions concerning their animals or business operations. SSLA or the editor is not responsible for any losses resulting from a reader's failure to heed this caution. Opinions expressed or implied are hereby the editor's choice and are not the opinions of the SSLA Board of Directors or SSLA as a group.

SSLA Online—keep in touch with your llama organization

Website: www.ssla.org

Facebook page: Listed as "SSLA-Southern States Llama Association"

SSLA-Members Yahoo Group: Request membership from ssla-members-owner@yahoogroups.com

Group members can post messages to SSLA-Members@yahoogroups.com



PRESIDENT'S MESSAGE

Hello SSLA Members,
 I hope this finds you all well and enjoying life.
 Well, it has been a busy Spring and start to Summer. We had a wonderful Conference and Annual Meeting in March. Thank you to Karen Pihera for bringing back so many original members and speakers to share our history.
 The SSLA Spring Pack Trials and Certifiers Course was held in April. The weather was gorgeous and DuPont Recreational Forest once again did not disappoint. PLTA President Lisa Wolf conducted a Pack Trial Certifiers Course allowing six of our members to complete the course. This will be excellent for future events. The rest of us enjoyed the trails with multiple hikes and Pack Trial Advanced or Basic completed by all!! Thank you to Laura and Rick Steere for bringing their 4H Group. We had a blast with them.
 Next was on to the Northeast Tennessee Llama Show. The turnout was very good and a super group of exhibitors.

Thank you to Kathy Devaul and Cathy Kindler for keeping this show going, and your obstacle courses were supreme. The weather became the story of the weekend with Saturday night wind and rain rocking trailers, turning trash cans into projectiles and lifting metal roofing off the barn. Thankfully, all the animals and exhibitors weathered the storm. Just another show story.

Coming up, once again in March 2018 we will be returning to the Mountain Lodge in Flat Rock, North Carolina for our Annual Meeting and Conference. Mary Rose Collins will be Chairing with the assistance of Kim Kyst. We need your help looking for a speaker for Saturday afternoon. Please contact either one of us if you have any suggestions.

SSLA needs your help; join a committee, help at an event, participate!

Mary Rose Collins
 2017 SSLA President



SSLA 2017 BOARD OF DIRECTORS MEETING MARCH 17, 2017 FLAT ROCK, NC

MEETING CALLED TO ORDER at 8:03 p.m.

Attendance:

- Cathie Kindler, Past President
- Mary Rose Collins, President
- Tom Rothering, Vice President
- Hank Balch, Treasurer
- Kathy Devaul, Secretary
- Lynn Wright, Director
- Greg Hall, Director
- Tracy Weaver, Director
- Karen Pihera, Director

Topic: Treasurer's Report

Discussion: Hank passed out a detailed Profit and loss for the year 2016. We had a loss of \$2,227.05. Available cash as of 3/16/2017 \$21,510.71.

Action: Approved.

OLD BUSINESS

Topic: Elections

Discussion: Mary Rose Collins

Action: Report for Vicki Sundburg, Inspector of Elections from the Elections Committee additional members Lauri Jones and Vickie Balch.

Simply Voting was the company we used for voting for the 2017 SSLA Board. This was the same company we used last year and they are very helpful with helping set the process up and run it. Again this year we had a good turnout for voting. 75% of the members voted. We would highly recommend using Simply Voting next year as it makes it much easier to set up this way and the voter turnout is better than mailing everything out.

Continued on page 8

SSLA March 17, 2017 Board of Directors Meeting, continued

Topic: Membership

Discussion: Mary Rose Collins

Action: A report was read from Cheryl Lambert, Membership Chairperson. There were a total of six emails that went out starting the last week of November until the middle of February with the last call for the directories to have all membership in by the 23rd. Since we have added three additional members totaling 57 farms.

Topic: Discover Llamas

Discussion: Tom Wilson

Action: They are out and being distributed to members. They will be distributed from Tom Wilson in NC, Laurie Jones in GA, and Mary Rose Collins in FL. Good Job Tom.

Topic: Procedure Manual

Discussion: Mary Rose Collins

Action: Getting all the information into one format so that it can be sent out to others who can update sections they are familiar with.

NEW BUSINESS

Topic: Obstacle Trailer Advertising

Discussion: Kathy Devaul

Action: It was decided that SSLA would charge for the space on the trailer. Advertisers would pay the cost of the ad and the installation. However, it would have to be done with Matrix, the company that wrapped the trailer. Kathy Devaul, Tom Rothering and Cathie Kindler would come up with sizes and costs of the spaces and would present to members at general meeting.

Topic: Sweepstakes Issue

Discussion: Mary Rose Collins

There was a disagreement as to whether an exhibitor was on the farm membership and should receive the sweepstakes award.

Action: Board agreed he should.

Topic: Winter Classic

Discussion: Mary Rose Collins

Hunter Snow Williams had requested that her show the Winter Classic be made a SSLA Sweepstakes show.

Action: Board agreed that it should.

Motion to Adjourn : Hank Balch, seconded Greg Hall, and Meeting Adjourned.

SSLA 2017 ANNUAL MEMBERSHIP MEETING MARCH 18, 2017 FLAT ROCK, NC

MEETING CALLED TO ORDER at 3:36 p.m.

Welcome to the members attending and Thank you to the 2016 outgoing BOD. Thank you gifts were given to Tom Wilson and Lauren Wright for their service on the BOD.

Topic: Introduction of the 2017 BOD and Officers

Discussion: Vicki Sundberg

Vicki Sundberg introduced the BOD Officers: President-Mary Rose Collins, Vice President-Tom Rothering, Treasurer-Hank Balch, Secretary-Kathy Devaul, returning members Greg Hall, Tracy Weaver, Karen Pihera, and new members Cathie Kindler, and Lynn Wright.

Topic: Treasurer's Report

Discussion: Hank Balch

Hank Balch passed out a detailed profit and loss statement for the year 2016. There was a loss of \$2,227.05. Available cash on hand as of 3/16/2017 is \$21,510.71.

-Brief discussion concerning membership being down, obstacle trailer. As well as numbers being down at the shows has caused this year's loss.

Continued on page 9

SSLA March 18, 2017 Annual Membership Meeting, continued

Topic: By-law Change

Discussion: Mary Rose Collins

The bylaw change regarding the number of BOD was passed.

-Brief discussion as to the reasoning behind this due to membership numbers being down.

Topic: Membership Chairperson Report

Discussion: Cheryl Lambert

A report was read from Cheryl Lambert, Membership Chairperson. There were a total of six emails that went out starting the last week of November until the middle of February with the last call for the directories to have all membership in by the 23rd. Since, we have added three additional members totaling 57 farms.

Topic: Scholarship Chairperson Report

Discussion: Tom Rothering

Tom Rothering reported that the scholarship fund was doing well. There are 3 recipients this year with Hunter Snow Williams the newest.

-Karen Pihera asked about increasing the number of recipients, Tom voiced concerns about over-committing our resources and not being able to carry more for the whole for years.

Topic: Show Chairperson Report

Discussion: Kathy Devaul

Kathy Devaul reported that Jerry and Carolyn Ayers had retired from the Northeast Tennessee Llama Show and that Cathie Kindler and she would be the new superintendents and that it would become another SSLA double sweepstakes show. The Heart of Dixie Llama Show has also become an SSLA double sweepstakes show and would again be held at Mashburn's farm in Ringgold, GA.

-Vicki Sundberg gave a brief description of how Sweepstakes Points are allotted for SSLA sponsored show versus shows included in the sweepstakes.

-Hunter Snow Williams' show, the Winter Classic, will become the newest show to become an SSLA sweepstakes show. She did a great job with the show last year.

Topic: Obstacle Trailer Status

Discussion: Kathy Devaul

The trail has been repaired and wrapped. The wrapping company surprised us with the llama picture. We were only expecting the logos.

-Very positive comments from the membership concerning the look of the trailer.

Topic: Obstacle Trailer Ads

Discussion: Cathie Kindler, Tom Rothering, and Kathy Devaul

Cathie Kindler explained that we were selling ad spots. There are 7 spots on each side 4'x2' each and 4 spots on the front that 2'x2' each. The ads will be the responsibility of the advertisers and will be handled by Matrix, the company that wrapped the trailer. Ad spots are sold for one year at the cost of \$150.00 for the side spots and \$100.00 for the front spots.

Additional information and explanation to follow in an email to the membership.

Topic: Llama Journal

Discussion: Mary Rose Collins

-Hard copy. There were a few rough spots but they are being worked though. The journal editor needs members to send articles and pictures.

-Online copy. Doing well.

Membership recommended farms being highlighted, with interviews conducted for articles, to reduce cost only print Grand and Reserve Show results.

Topic: Discover Llamas

Discussion: Tom Wilson

The new issue is out and being distributed to members present. There will be 3 distribution sites. Contact the person nearest to you. Tom Wilson-NC, Laurie Jones-GA, or Mary Rose Collins-FL.

Floor open to members.

Susan Sterling and Mary Rose Collins thanked people who have and are helping them in the llama community and specifically SSLA.

Meeting Adjourned at 4:52 pm.

SSLA 2017 BOARD OF DIRECTORS EMERGENCY CONFERENCE CALL MARCH 23, 2017

MEETING CALLED TO ORDER at 8:35 p.m.

Attendance:

- Mary Rose Collins, President
- Tom Rothering, Vice President
- Kathy Devaul, Secretary
- Karen Pihera, Director
- Tracy Weaver, Director
- Lynn Wright, Director
- Greg Hall, Director
- Kim Kyst, Director

Absent: Cathie Kindler, Past President

Purpose: Filling vacancy on the Board of Directors and re-establishing Officer Positions.

Mary Rose Collins informed the Board, as of Section 6.7. Vacancies. Any vacancy occurring in any Directorship shall be filled by the nominee from the previous election with the next largest number of votes who will serve the remainder of the original term.

This would be Kim Kyst and she has accepted the position.

Kathy Devaul has volunteered to be the Treasurer, motion to accept Kathy Devaul as Treasurer, Board unanimously voted yes.

Tracy Weaver has volunteered to be the Secretary, motion to accept Tracy Weaver as Secretary, Board unanimously voted yes.

Discussion:

Karen Pihera requested to speak to the Board concerning PLTA conducting a Pack Trial Certifiers Course at the SSLA Spring Pack Trial at Dupont Recreational Forest, NC on April 28-30, 2017. Board requested Karen present more detailed and complete information before the Board was able to make a decision.

Karen tasked to put all details in an email to all Board Members in order for a decision to be properly vetted.

Motion to Adjourn by Karen Pihera, Seconded by Tom Rothering

Meeting Adjourned 9:05 pm.

SSLA 2017 BOARD OF DIRECTORS MEETING MAY 27, 2017 WHITE PINE, TN

MEETING CALLED TO ORDER at 8:02 p.m.

Attendance:

- Mary Rose Collins, President
- Kathy Devaul, Treasurer
- Greg Hall, Director
- Kim Kyst, Director
- Cathie Kindler, Past President

Conference Call: Tom Rothering, Vice President

- Tracy Weaver, Secretary
- Lynn Wright, Director
- Charlene Braun, Online Journal Editor

Absent: Karen Pihera, Director

Topic: Treasurer's Report

Discussion: Kathy Devaul

Kathy Devaul reported on the Conference income and expenses, including the raffle, live auction incomes, the Hank Balch memorial fund and the tax refund.

Kathy also discussed the trophy expenses for SSLA shows. This embarked a discussion concerning covering those costs, with an emphasis on the shipping costs. It was stated that Lisa Poole is the creator of the trophies and has done a wonderful job of personalizing the trophies for each of the SSLA sponsored shows.

The motion was made by Greg Hall to continue with the present trophy provider for an additional show year. Tom Rothering seconded the motion. Roll call for voting, motion approved, unanimously.

SSLA May 27, 2017 Board of Directors Meeting, continued

Mary Rose stated that the minutes from the past conference meeting were previously accepted by the board.

UNFINISHED BUSINESS

Topic: Discover Llamas Magazine

Information to board, the cost for the publication exceeded \$7000. SSLA did not break even on the literature, possibly due to shipping costs. A closer inspection of the details for the publication will be looked into to discover how to proceed with the magazine. Magazine is published once every 2 years.

Drop off points for the Discover Llama magazine are with Tom Wilson, Laurie Jones, and Mary Rose Collins. Contact these folks for your publications.

Topic: Llama Journal

After discussion concerning journal costs: online versus hard copy, printing/shipping cost and securing ads from advertisers, it was decided by Board to table this discussion until figures can be determined for hard copy costs of magazine. Online publication is due out in July and will be coordinated by Charlene Braun. Articles should be submitted to her prior to July.

Topic: Procedure Manual

Has been revised and Mary Rose has someone that is reviewing copy for accuracy and formalities. She is in hope that it will be typed up and finalized next month.

Topic: Obstacle Trailer Advertising

Kathy Devaul is the keeper of the "Map of Trailer" – defined: it is the spots/sizes on the trailer for advertising (Left, Right and Front sides) and costs of those spots.

A. What is needed? A form to send out to members (electronic or mail out) with pertinent information from advertiser; example: Name, address, type of artwork, deadlines for advertising, etc.

B. Steps for processing the information:

1. Kim Kyst will create a form for the advertiser.
2. Kim and Kathy will send the created form to board for approval.
3. After approval from Board, the form is sent to Charlene (prior to July 10) for publishing in the Llama Journal.

4. Member fills in pertinent information on trailer form (picking spot) and sends check and form to Kathy Devaul.
5. Kathy then sends member artwork information to a company to allow them to work up ad and pricing for the artwork. (That will be billed directly to member.)
6. Trailer is then taken to have artwork advertising installed.

NEW BUSINESS

Topic: Committees, Liaisons and Chairs

The by-laws states: "the President shall fill by appointment with concurrence of the Board, the following positions plus any other Committee Chairpersons that are deemed necessary: Llama Journal Editor, Membership Chairperson, LLSA Conference Chairperson, and Librarian. A Board member shall serve as liaison to each appointed committee, except the Elections committee."

Mary Rose would like to streamline the committees/liaisons and chairs. After discussion from the Board, she volunteered to write up and submit a recommendation letter concerning the above for Board to review and vote.

Topic: SSLA Conference 2018

Discussion and voting on: Where, when, who and how for 2018 annual conference.

- A. Continue the conference at the Mountain Lodge, Flat Rock, NC — Roll call vote - approved, unanimously.
- B. Date — weekend of March 16-18, 2018 Roll call vote - approved, unanimously.

Kim Kyst and Mary Rose Collins will assist in organizing details of conference.

Topic: Voted by Board previously

It was established that all Board members are required to attend, participate or assist in one SSLA-sponsored show per year during their tenure as SSLA Board members. After some discussion, a letter of clarification will be written and notice will be sent to Board members stating their responsibilities to the Board. It will be signed by member and returned in a determined time frame.

Exceeding our conference time, a motion was made by Cathie Kindler to adjourn the meeting and seconded by Kathy Devaul. Motion carried and the meeting adjourned at 9:03pm.

THE WINTER CLASSIC

By Superintendent Hunter Williams

Hello everyone! The first annual Winter Classic Llama and Alpaca Show was a success.

It was held at Chicopee Woods Agricultural Center in Gainesville, GA. The show was the second weekend in December and our judges were Tor Sorenson and Robin Sturgeon. It was a double ALSA show for Performance, Halter, and Youth. We also offered Alpaca

Performance. Many special awards were given out, such as our Premier Exhibitor Award (a llama pendant from Images of the Heart and Soul, won by Dorthe Peolquin of Peloquin's Perch); two llama sun catchers for Overall Performance Champion (one was awarded to Dorthe Peloquin and the other to Mary Rose Collins); gift baskets for our High Point Youth award (one was awarded to Elizabeth Ingram and the other to Bailey Jones); and we had 4 Best of Show awards. Each judge got to give out a male and a female Best of Show. These were awarded to ALCL Live Action, MCC Amahl's Baymax, Overman's Black Sapphire, and MCC Amahl's Gypsy Heat Wave.

We had exhibitors for MANY states including, Georgia, Florida, Ohio, Illinois, and North Carolina. Our schedule is a little different from most shows. We run Showmanship and Halter on Saturday starting with

females. We run all the females (suri, light, medium, heavy) and then all the males. That seemed to work out great last year and we will be doing so again this year.

We have lots of new and exciting things happening this year for the Winter Classic. We are an SSLA-sponsored show and we will be giving out points for SSLA sweepstakes as well as SSLA trophies and plates. LFA will also be sponsoring us this year so we will be adding a futurity show that will pay premiums for First Place, Second Place, Third Place, Grand and Reserve Champion. Versatility Champion will also be an award that will be added this year.

Once again, it will be held the second weekend in December (9th and 10th) at Chicopee Woods Agricultural Center in Gainesville, GA. We will also be a dual ALSA show again this year with Cynthia Ernst and Mary Jo Miller as our judges.

Our ALSA show will be adding Alpaca Halter classes this year. We will also have new awards. We will have ribbons to Third Place in all our classes, banners will be given for our Halter Show, and sashes will be given for Performance and LFA as well as for our new class this year, Overall Showmanship.

A huge thank you to everyone that came last year and made our first show so much fun and a success, as well as a huge thank you to our sponsors. They truly made our show happen. Please make plans to attend The Winter Classic this year. It will be a show not to miss!



Continued on next page

THE WINTER CLASSIC



2017 SSLA CONFERENCE HIGHLIGHTS 30 YEAR ANNIVERSARY

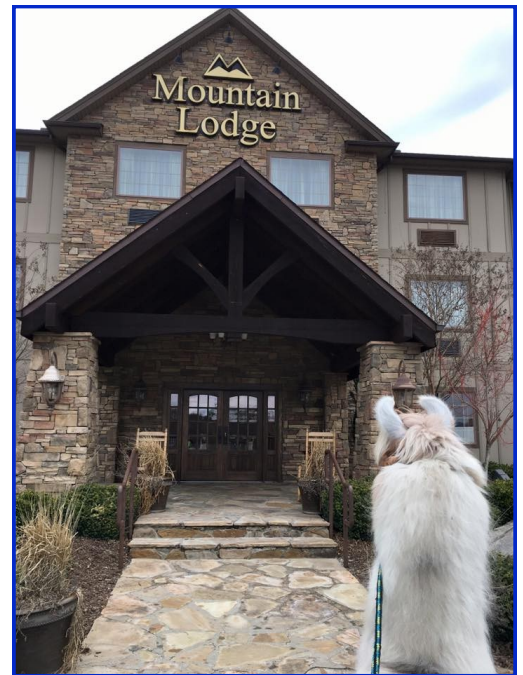

2017 SSLA CONFERENCE HIGHLIGHTS 30 YEAR ANNIVERSARY



Dear SSLA Members and Board of Directors,

First I want to thank you all for all your support over the years. I am honored and humbled to announce that I am the 2017 SSLA scholarship recipient. SSLA and the llama community have been my family now for 8 years (that's crazy to believe it has been 8 years). They have molded me into the person I am proud to say I am today. When I got into llamas I was a shy 5th grader who did not like to speak up in class or challenge people's opinions. Through this wonderful community I have become a person that is outspoken and willing to be that person that challenges the way things have been to change them for the better. This scholarship will help me continue to peruse avenues that will not only further me in my education but also as a person. Learning helps us stay young and continue to grow so I try to learn as much as I can. I could not do this without all the support I have had throughout the years. My greatest supporters have always been my family; they have always stood by my every dream and helped me to pursue it.

Currently I have graduated Athens Technical College with an Associates of Applied Science in Criminal Justice Technology. I will graduate from Georgia Cyber Academy in June with my High School Diploma with honors and a business excellence pathway. I am a member of National Honors Society at my high and a member of Alpha Beta Gamma and Phi Theta Kappa at my college. I plan to go back to Athens Technical College to pursue an associate's degree in Computer Specialist Technologies. I have also been so fortunate as to receive the 2017 Alpaca Llama Show Association Scholarship and the 2017 Georgia Motor Trucking Rich Perkins Memorial Scholarship.

Once again thank you for this honor.

Sincerely,

Hunter Nycolle Williams

2017 SSLA SPRING PACK TRIAL DUPONT FOREST, NC

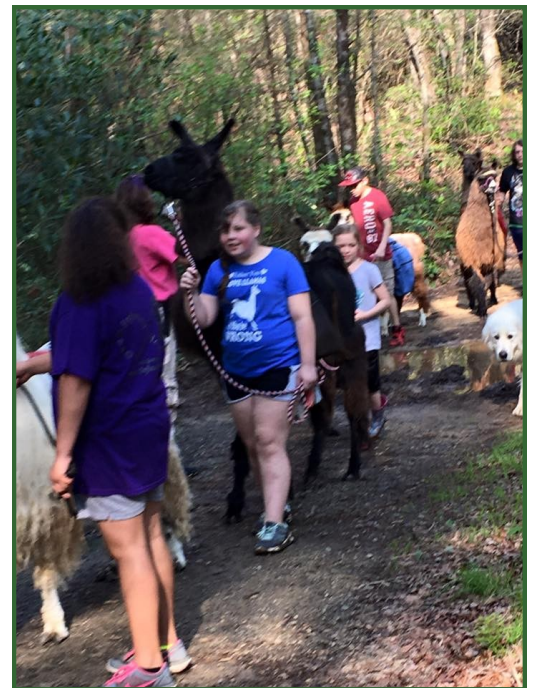
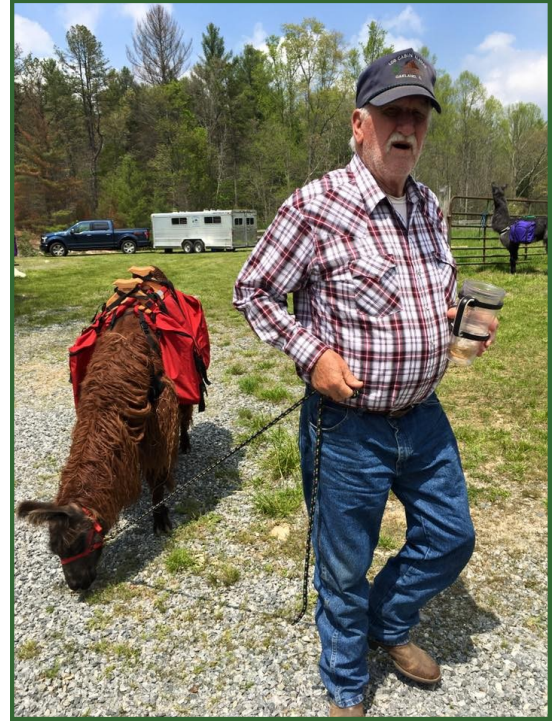

Jackson County 4-H Love of Llamas Year in Review

Submitted by Jackie Ellett

The 4-H motto, “To make the best better”, focuses on the idea of youth reaching their highest potential through the engagement of challenging activities and giving back to their community. The Jackson County 4-H Love of Llamas club takes this motto to heart. Through weekly meetings the youth collaborate and implement many activities that help them develop their independence and leadership skills and increase their awareness of the positive impact they can have on their community through service.

This year we had three new club members who hit the barn running, so to say. Lilly Howell, Isabelle and Ava Olliff all became actively engaged in both the educational studies and hands-on work necessary to understand and work with large exotic animals. Each girl had obstacles to overcome and learned the value of hard work, patience, and fortitude. Learning to groom, feed, and care for llamas may be fun, but it is also a lot of work and takes a deep level of commitment. With the help of senior members Cody Avery, Andie Ellett, and Elizabeth Ingram the younger members became much more sure of themselves and participated in many community events. Here is a review of some of their accomplishments.

An open house in June welcomed youth ages 9 – 18 to visit the farm and learn about llamas and the 4-H program. August was the beginning of show season and several youth participated. Shows included the NC Mountain State Fair Llama Show in Fletcher, NC; GA National Fair in Perry, GA; Winter Classic at Chicopee Woods in Gainesville, GA; and the Hillbilly Llama Show in Perry, GA.

Community activities included Holiday Parades; visiting home bound patients, the annual Jefferson Easter Egg Hunt where llamas become long eared “ramas”! Participation at an elementary school where students could get

a photo with a llama in red pajama during Read Across America Day raised more than \$700 for Relay for Life. Larger all-day events included the Girl Scout Animal Day which the youth developed, organized, and implemented for a full-day badge earning event for over 75 Girl Scouts ages 5 – 18 was a huge success. The Blue Ridge Scenic Railway event was tied in with the fall train rides to Farmer Brown’s Pumpkin Patch where the youth meet the public with llamas in costumes as engineers, train crew and in fall attire, and llama learning took place.

Another highlight was the 2017 SSLA Conference and Annual Membership Meeting at the Mountain Lodge in Flat Rock, NC where several youth were honored. Cody Avery received the SSLA Grand Champion Year End Award for Special Youth in both Showmanship and Performance; Kate Dutton received the SSLA Reserve Champion Year End Award for Junior Youth in both Showmanship and Performance; Andie Ellett received the SSLA Grand Champion Year End Award for Intermediate Youth in Showmanship and the SSLA Reserve Champion for Intermediate Youth in Performance; Lilly Howell received the SSLA Third Place Year End Award in Showmanship and the SSLA Participation as Youth Ambassador; and Elizabeth Ingram received the SSLA Third Placement Senior Youth in Performance and the SSLA Fourth Placement Senior Youth in Showmanship.

Continued on page 20

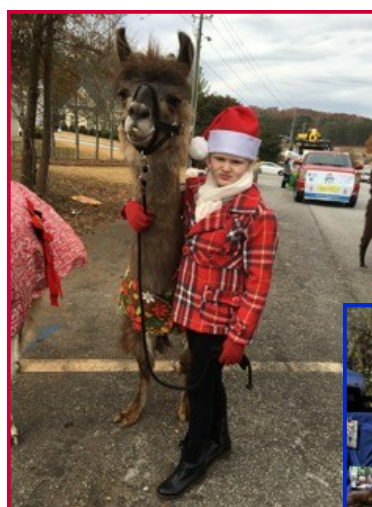

Jackson County 4-H Love of Llamas Year in Review *continued*

“Making the best better” is about achieving through hard work and commitment; it’s about learning independence and being proud of invested accomplishments. As we come to the end of the school year and regular club meetings the youth have a lot to reflect upon and a few events to be excited about. Looking ahead June is already booked with four library visits where the llamas will appear in red pajamas in memory of Anna Dewdney, the author of the Llama, Llama, Red Pajama books.

In preparation for another successful year we have looked ahead to plan our Annual Open House Recruitment Day. The Jackson County 4-H Love of Llamas club will be hosting the Open House on Sunday, August 13, 2017 at 3 pm. Please contact Kim Kyst at kim@kyst.org for details about the Open House and reserve a spot in the program. Space is limited.

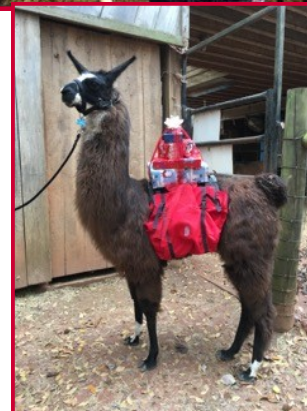
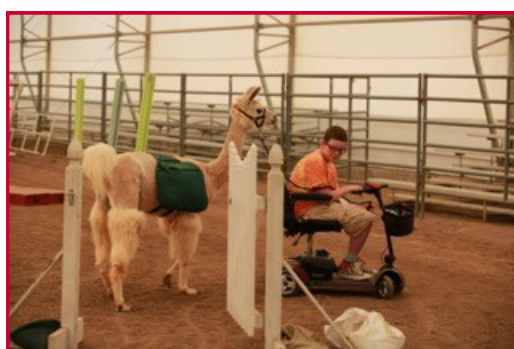

**2017 NE TENNESSEE LLAMA SHOW
WHITE PINE, TN**

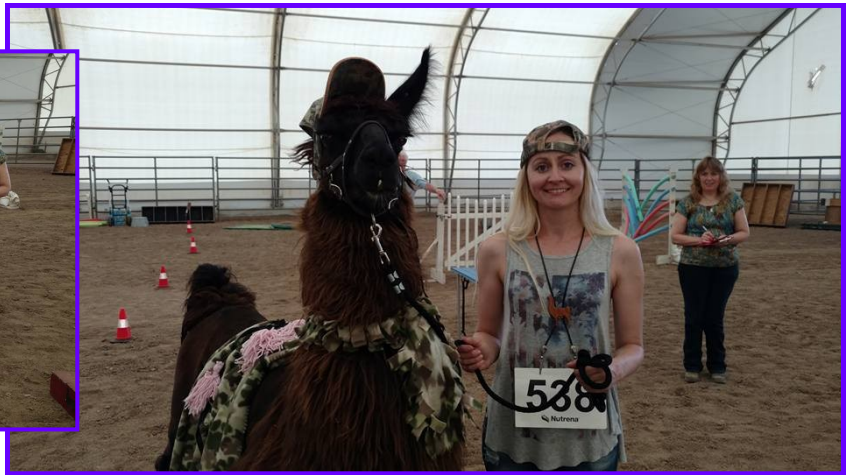

CALENDAR OF UPCOMING LLAMA EVENTS

Date	What	Where	Contact
Sept 2-3, 2017	Heart of Dixie Llama Show	Ringgold, GA	Kathy Devaul kdevaul@bellsouth.net Cheryl Lambert, Clambert5@tampabay.rr.com
Sept 9-10, 2017	NC Mountain State Fair Llama Show	Fletcher, NC	<u>Lauri Jones</u> Laurijones1@windstream.net
Sept 23-24, 2017	White Lightning Show & Pack Trial	Ellijay, GA @ Pihera Property	Cathie Kindler llamajudge@gmail.com
Oct 7, 2017	The Great Llama Race Fund-raiser for Casa de Sara	World's Fair Park in downtown Knoxville, TN	Deb Logan Logan99.mail@gmail.com Tracy Munroe witsendfarm@comcast.net thegreatllamarace.com
Oct 13-15, 2017	GA National Fair Llama Show	Perry, GA	Kathy Devaul kdevaul@bellsouth.net
Oct 13-15, 2017	ALSA SE Regional Championships	Perry, GA	Cheryl Lambert, Clambert5@tampabay.rr.com
Nov 2017	SSLA Fall Pack Llama Trial	Furnace Creek Farm Cumberland Furnace, TN	Tori and Michael Howk Tmh2399@yahoo.com
Dec 2, 2017	Children's Healthcare of Atlanta Christmas Parade	Atlanta, GA	Tracy Munroe witsendfarm@comcast.net
Dec 9 & 10, 2017	Winter Classic Llama Show	Gainesville, GA	Hunter Snow huntershopesandreams@gmail.com

Mobile Llama Shearing
 Most Southeastern States
Don Holliston
 706-896-5005
 email: llamafarm@windstream.net

