

The SSLA



LLAMA JOURNAL

The Official Journal of the Southern States Llama Association

October 2017



TABLE OF CONTENTS

SSLA Board Members and Information	3
President’s Message	4
SSLA 2017 Board of Directors Meeting, September 2, 2017	4
2017 Winter Classic Announcement	6
Heart of Dixie Llama Show Results	7
Florida State Fair Youth Champion Program	8
Virginia 4-H Group Photos	10
Llama Love	11
Mr. Peanut, the Pack Llama	13
SSLA Annual Conference 2018 Announcement	14
Calendar of Upcoming Llama Events	15
Advertising Information	16
Obstacle Trailer Advertising Information	17

*Cover: Lauren Wright and Yeti
Heart of Dixie Llama Show
Advanced Alpaca Public Relations*



Deadline for the next issue is January 15, 2018

Send articles, photos and ads (digital format preferred) to:

Lisa Pool, Journal Editor at designsbylisap@gmail.com
or
Charlene Braun, Online Journal Editor, turtlrn@earthlink.net

All ads must be prepaid. Send payment to:
Kathy Devaul, SSLA Treasurer, 217 Donald Road, Leesburg, GA 31763

SSLA BOARD MEMBERS AND INFORMATION

Board of Directors

Mary Rose Collins, *President*
mrc604@tampabay.rr.com

Tom Rothering, *Vice President*
twrothering@aol.com

Kathy Devaul, *Treasurer*
kdevaul@bellsouth.net

Tracy Weaver, *Secretary*
lotsallamas@earthlink.net

Karen Pihera, *Director*
kpihera@aol.com

Lynn Wright, *Director*
walkingwright@msn.com

Kim Kyst, *Director*
Kim@kyst.org

Greg Hall, *Director*
SimplicityLlamaFarm@yahoo.com

Committee Chairs & Contacts

(If the committee chair is a board member, that person is also the Board Liaison)

Committees

Annual Meeting Conference—
 Mary Rose Collins

By-law Amendment—Tom Wilson
Board Liaison: Mary Rose Collins

Carting—Greg Hall

Election—To be determined

Fiber—Tracy Weaver

Online Journal—Charlene Braun
turtlrun@earthlink.net

Printed Journal—Lisa Pool
designsbylisap@gmail.com
Board Liaison: Mary Rose Collins

Library—Lauren Wright

Llama Trekking & Packing—
 Tom Rothering

Membership—Cheryl Lambert
clambert5@tampabay.rr.com
Board Liaison: Karen Pihera

Pack—Tom Rothering

Show—Kathy Devaul

Website—Vicki Sundberg
Board Liaison: To be determined

Youth & Youth Ambassador Awards—
 Cathie Kindler
Board Liaison: Kim Kyst

Youth Scholarship—Tom Rothering

Ambassador Awards—Greg Hall
Trekking Awards—Vicki Sundberg
Sweepstakes Awards—Lynn/Lauren Wright
Board Liaison: Lynn Wright

Rescue—Deborah Logan
logan99.mail@gmail.com

Sweepstakes—Vicki Sundberg
Board Liaison: Lynn Wright

Journal Mission Statement

THE LLAMA JOURNAL, published by the Southern States Llama Association (SSLA) is distributed quarterly to the members of SSLA. The purpose of the Journal is to provide:

- Information and articles of interest
- A forum for members to express their opinions on llamas and related matters
- Board of Directors meeting minutes, Treasurer's report and other information pertinent to the function of SSLA.

Notice: The information contained in this Journal is not intended to be a substitute for qualified professional advice. Our readers are encouraged to consult with their own vets, accountants or attorneys for questions concerning their animals or business operations. SSLA or the editor is not responsible for any losses resulting from a reader's failure to heed this caution. Opinions expressed or implied are hereby the editor's choice and are not the opinions of the SSLA Board of Directors or SSLA as a group.

SSLA Mission Statement

OUR MISSION as members of the Southern States Llama Association is to be a strong organization of llama and alpaca owners who have joined together for the purpose of education, fun, and fellowship while promoting the health and welfare of llamas and the llama industry.

SSLA Online—keep in touch with your llama organization

Website: www.ssla.org

Facebook page: Listed as "SSLA-Southern States Llama Association"

SSLA-Members Yahoo Group: Request membership from ssla-members-owner@yahoo.com

Group members can post messages to SSLA-Members@yahoo.com

PRESIDENT'S MESSAGE

As you can see the Llama Journal is once again the online version. We originally thought we would be doing a hardcopy twice a year but it has become increasing difficult to get sponsors and articles for the hardcopy, which is very expensive to print. So the Board agreed to once again do the online version. Charlene, our online Editor, graciously agreed to produce this online version. Thank you to those who have contributed to let folks know what is going on in our Llama Community.

The Show Committee has done an outstanding job with the HODLS, Georgia National and the ALSA SE Regional. The Winter Classic in December is now an SSLA Sweepstakes Show. Stay tuned for more details and for information from Show Superintendent Hunter Williams.

Planning for the Annual Meeting and Conference is underway. Once again it will be at The Mountain Lodge in Flat Rock, North Carolina. We are trying to include all your areas of interest such as Fiber, Hiking, Show information and Camelid Medical issues. If you have sugges-

tions please reach out to the committees and share your ideas.

Lauren Wright has agreed to be the Library Chairperson. All items have been transferred to DVD and are a great source of information, especially if you have a Youth Group who is searching for knowledge and information.

Scholarship Chairperson Tom Rothering has added Lauren Wright and Alex Rodman to the committee to better service the organization and our recipient's needs.

I hope you all have weathered the storms of this summer and wish you all a Happy Halloween and wonderful Thanksgiving, for we have so much to be thankful for in this Community of Llama.

Mary Rose Collins
2017 SSLA President

SSLA 2017 BOARD OF DIRECTORS MEETING SEPTEMBER 2, 2017 RINGGOLD, GA

The board of directors meeting was called to order by President, Mary Rose Collins, at 7:03pm.

Location: Heart Of Dixie Llama Show, at Kings Ransom Stables, Willow Tree Farm, Ringgold GA

Attendance at site:

- Mary Rose Collins, President
- Kathy Devaul, Treasurer
- Tracy Weaver, Secretary
- Cathie Kindler, Director
- Kim Kyst, Director
- Karen Pihera, Director

Attendance via conference call:

- Greg Hall, Director
- Tom Rothering, Vice President
- Lynn Wright, Director

Topic: Treasurer's Report

Discussion: Kathy briefly reviewed the summary of the treasurer's report balance, income and expenses and then gave those attending a printout of the report.

Action: A motion was made by Cathie Kindler to accept the report, a second by Kim Kyst. Roll call for voting, motion approved, unanimously.

Topic: Minutes

The minutes from the May 27, 2017 meeting were reviewed and the following agenda items were referenced for action from this board meeting:

Mary Rose presented each board member the revised 2017 SSLA policy and procedure manual. Those on conference call will receive manuals by couriers. A review of the updated SSLA committees and added Lauren Wright to the Library committee.

Continued on page 8

SSLA September 2, 2017 Board of Directors Meeting, continued

Topic: Monies to be moved from the General Account to Scholarship Account

Discussion: Cathie Kindle

Action: A motion was made by Cathie Kindleer stating, "The monies from the SSLA Conference Live Auction of \$7615 will be moved from the General Account to the Scholarship Account." Second by Kathy Devaul. Discussion, and voting by roll call, motion approved without dissent. Tom Rothering (Scholarship Committee Chair) will deposit check into that account. Tom will also continue to research for a second signature for the account.

Topic: SSLA Sweepstakes Points for sponsored shows

Discussion: Cathie Kindler

Action: Cathie explained the sweepstakes point system and the shows qualifying for the points. After some discussion from board members, Mary Rose appointed the following persons (Lynn Wright, Vickie Sundberg, Belinda Snow and Lauren Wright) to develop some recommendations regarding shows that qualify, calendar year and the impact on the exhibitors with regards to point distribution of shows.

Topic: Annual Conference Update

Discussion: Mary Rose Collins

Action: Mary Rose discussed a summary of the conference planning, mentioning the tentative agenda for the weekend. Kim Kyst is exploring motivational speakers for the conference and seeking those that will connect and inspire the diversity of the SSLA membership. Touch base with Kim with any contacts or suggestions of speakers.

Topic: Llama Journal

Discussion: Mary Rose Collins

Action: Journal was to be published in hard copy form for the October issue, but as there has not been enough sponsors and material for publishing, Mary Rose would like to contact Charlene Braun to publish an online Journal for the October issue, if Board is in favor of the change for this issue. Roll call voting, all are in favor of an online Journal for October. Material for Journal news would be in the show area, youth, fiber, and medical interests. If you have story ideas, please begin gathering information. If Charlene agrees, she will be the send-to person.

Topic: Discover Llamas

Action: Tom Rothering would like to explore the idea of the Discover Llama magazine as a digital version on the website. Mary Rose will reach out to Tom Wilson, Vickie Sundberg and the web master to check out the possibility of the idea.

Topic: BOD Member Responsibilities

Discussion: Mary Rose Collins

We would like to review the policy and requirements for the officer and board positions of the SSLA, especially the requirement of attending/volunteering/participation in two SSLA shows per year. Mary Rose would like to set up some guidelines for the requirements and then set up a conference call to discuss only this area of BOD member responsibilities. Further action/discussion on this topic.

Topic: Obstacle Trailer Advertising

Discussion: The question was asked if the performance trailer has had sponsor ads established. No ads yet displayed on the trailer. Kim Kyst has volunteered to use original PDF and make a poster to display at GA National Show to attract sponsor ads for the trailer.

2017 WINTER CLASSIC LLAMA AND ALPACA SHOW

It is about that time everyone! As our fall show season ends that means the only winter show is right around the corner. The 2017 Winter Classic Llama and Alpaca show is back again this year at Chicopee Woods Agricultural Center in Gainesville, GA. It will be December 9 and 10 and will be better than ever!

We will be dual ALSA sanctioned again this year as well as a double-pointed SSLA Sweepstakes Show and an LFA futurity show AND a dual ALSA fleece show. Our judges are Mary Jo Miller and Cynthia Ernst.

We have lots of new classes this year as well, including alpaca performance (Masters, Advanced, and Novice Alpaca Performance), alpaca halter, walking fleece, overall showmanship, versatility, and futurity classes. Back this year will be the best of show classes, premier exhibitor, and high point youth awards. Our futurity classes will have premiums paid to third, second, first, reserve champion, and grand champion winners.

Our tentative schedule will be: walking fleece starting Friday night and wrapping up Saturday morning, followed by showmanship and halter. If time allows we will begin performance and Sunday will be whatever performance we have left to complete.

As always, please check the ALSA, SSLA, or Winter Classic websites for all our information. We look forward to seeing everyone there!

**HEART OF DIXIE LLAMA SHOW
SEPTEMBER 1, 2, & 3, 2017**

ALSA Red / ILR Red

ALSA Blue / ILR Blue

Master Performance	Grand: Timberwinds Chevy Chase - Lauren Wright Reserve: Tux's Spotted Snowflake - Mary Rose Collins	Grand: Timberwinds Chevy Chase - Lauren Wright Reserve: ALCL BlackJack - Debbie Andrews
Advanced Performance	Grand: Moose Hill's Speckletush - Mary Rose Collins Reserve: HF Edition's Nicholas - Dorthe Peloquin	Grand: Moose Hill's Speckletush - Mary Rose Collins Reserve: HF Edition's Nicholas - Dorthe Peloquin
Novice Performance	Grand: Luke at Me - Lauren Wright Reserve: Tevye's Taken by Toccoa - Bailey Jones	Grand: Luke at Me - Lauren Wright Reserve: Tevye's Taken by Toccoa - Bailey Jones
ALSA Non Breeder	Grand: ALCL Live Action - Debbie Andrews Reserve: Riseland's Prevoe "Leo" - Bailey Jones	Grand: ALCL Live Action - Debbie Andrews Reserve: ALCL Hungry Jack - Hunter Williams
Suri Wool Female	Grand: Peloquins Hally Ween Spookie Ap! - Dorthe Peloquin Reserve: KR's Indigo Night Starr - Stacy Mashburn	Grand: Peloquins Hally Ween Spookie Ap! - Dorthe Peloquin Reserve: Peloquin's Gorgeous Oreo Ap! - Dorthe Peloquin
Suri Wool Male	Grand: KRS V Master of Dance - Stacy Mashburn Reserve: Iniago Merlot - Michael West	Grand: Iniago Merlot - Michael West Reserve: KRS V Master of Dance - Stacy Mashburn
Light Wool Female	Grand: Overman's Black Sapphire - Debbie Andrews Reserve: DDH's Lazer Design - Hunter Williams	Grand: Overman's Black Sapphire - Debbie Andrews Reserve: 4L&M Miss Chief - Michael West
Light Wool Male	Grand: RCF Browning - Bailey Jones Reserve: NWLF's Flash Gordon - Lauren Wright	Grand: NWLF's Flash Gordon - Lauren Wright Reserve: RCF Browning - Bailey Jones
Medium Wool Female	Grand: Moose Hill's Speckletush - Mary Rose Collins Reserve: ALCL Dominique - Debbie Andrews	Grand: AlaLlama's Poca Mocha - Nancy Miller-Borg Reserve: Moose Hill's Speckletush - Mary Rose Collins
Medium Wool Male	Grand: Moose Hill's Midnight Ryder - Mary Rose Collins Reserve: HF Edition's Nicholas - Dorthe Peloquin	Grand: HF Edition's Nicholas - Dorthe Peloquin Reserve: 4L&M Ice Breaker - Michael West
Heavy Wool Female	Grand: MSF Moondance - Debbie Andrews Reserve: Souley Mae - Michael West	Grand: MSF Moondance - Debbie Andrews Reserve: Souley Mae - Michael West
Heavy Wool Male	Grand: Sapaveco's Rock Starr - Lauren Wright Reserve: 4L&M Greydor - Michael West	Grand: Sapaveco's Rock Starr - Lauren Wright Reserve: 4L&M Greydor - Michael West



FLORIDA STATE FAIR YOUTH CHAMPION PROGRAM

By Tracy Weaver, Superintendent

I would like to introduce you to the **Florida State Fair Youth Champion Program** located in Tampa, Florida!

Just simply a great way for Florida youth, ages 8-18, with a desire to exhibit livestock and learn more about a specific species of an animal. An impressive program to be involved in with a yearly rotation of various topics, including: health, re-production, nutrition, marketing & products of animals. It keeps the information challenging to the youth each year.

Each year, the Youth Program begins in September when Florida youth are invited to attend a seminar to educate them in the various aspects of the program. A choreographed day moves the first time exhibitors, as well as the experienced youth, through a variety of topics to prepare each potential exhibitor to do the best job in preparing themselves and their animal for the FSF Youth Livestock Show held each February.

The Champion Program promotes the positive aspects of showing livestock with the appropriate halter classes and showmanship opportunities for the exhibitors to earning ribbons and premiums for their efforts. The Champion Program includes other activities for the participants during their 3 to 4 days at the fairgrounds. The youth earn points by participating in the activities which, in turn, earns them money for participating and doing their best in those events.

Those events include:

- maintaining and turning in an animal record book,
- a poster on the topic of that particular year,

- attend the 'ask me' booth at the fair, to inform the public about the animal that is presented,
- 'hands-on' skill-a-thon stations to assess knowledge on particular levels of achievement,
- a knowledge evaluation over preparation of the animal record book and
- participation at the annual workshop in held each September prior to the Fair.

The FSF Youth Llama/Alpaca Committee also offers other workshops throughout the year to encourage youth to participate with their animals to increase showing skills or their fiber interests.

Each animal program is operated through the Florida State Fair Agriculture Livestock Staff and those folks are very devoted to the Youth Program. The specific species maintain committee chairs and members that work tirelessly to ensure that the workshops, seminars, and livestock shows are adequately staffed and operate smoothly. As I believe in all

Florida State Fair Youth Llama/Alpaca Seminar 2017



Florida State Fair Youth Champion Program *continued*

shows, there are many volunteers, sponsors, parents, leaders, and unknown heroes that contribute to the Youth Program faithfully throughout the year for these programs.

Our FSF Youth Llama/Alpaca Committee members are a dedicated group of adults that continue to strive for the best from the youth. We continue to educate the youth to train and groom their camelids for each new show season with new preparations as needed.

This year, as the committee was waiting for our llama/alpaca group to make their way to our part of the September workshop, two of our past exhibitors (now graduated) arrived and presented

to us a small token of their appreciation. They thanked us for all we do as committee members of the Youth Llama/Alpaca FSF Show. The effort to take a large part of their day to come to the fairgrounds and thank us personally was a great way to begin a new show season at the Florida State Fairgrounds. Thank you Tyler and Tori and other llama exhibitors for the many years of exhibiting llamas at the Florida State Fair!

We appreciate all the patronage, sponsors and support of the Florida Youth Llama/Alpaca shows!



Practicing knot tying—restraints for llamas



Sarah reviewing animal medicine labels. Topic: Health



Youth working on body parts poster



September 2017

“Great fall day in Virginia to be playing with llamas!”

~Laura Steere
Infinity Acres Ranch



LLAMA LOVE

By Susanna Ziesmer, llama training student

If I were asked to pick one highlight from this past year, it would be helping to train llamas.

How did I get interested in llamas? We passed a llama farm, Peloquin’s Perch, on our way to almost everywhere and I began to like watching the llamas. So we called the farm to see if we could stop by and meet the llamas. Now I enjoy helping the llamas every week with the owner, Dorthé Peloquin.

You’re probably thinking that llamas spit and wouldn’t be very fun to work with. No, llamas don’t spit very often despite what people say. Only the male llamas spit and for territorial reasons. So when I work with llamas, I don’t get spit on.

What kind of tricks do the llamas do? Several times a year, the llamas go to competitions. They

do their tricks in front of the judges and are given awards depending on their performance. Some tricks that the llamas do are bridges, complicated bridges, teeter-totters, stepping through tires, loading and unloading into a trailer, self-loading into a trailer, going under covered “caravans,” walking through pool noodles, and even things as simple as looking into a mirror. When being judged for their physical form, they have to show their teeth and hooves to the judges. A straight back gets more points than an arched back. There are a lot of different awards the llamas can earn and a lot of tricks to perform.

Some of the baby llamas, called crias, I work with are Spotacular and Smokey. Spotacular is a very curious boy and always manages to chew on my shirt! He is very talented for being about 8 months old and has a quality physical form. Smokey is

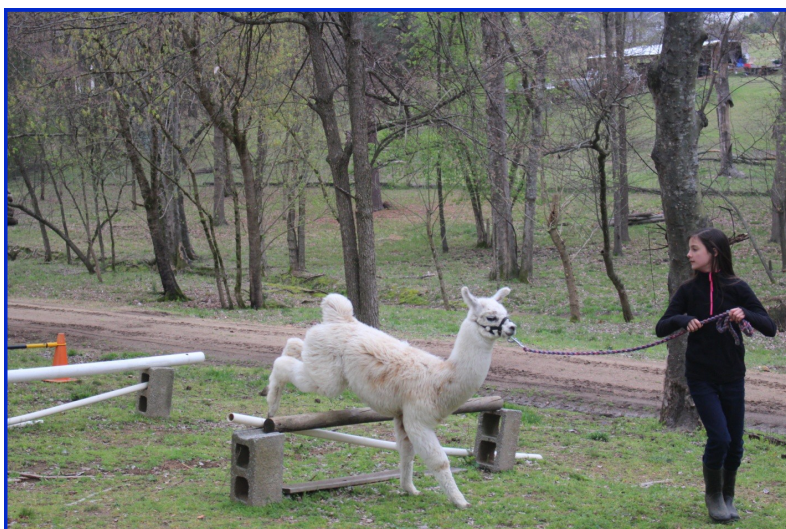

Llama Love *continued*

only a few weeks old and is doing complicated bridges and self-loading, which are advanced moves. I was privileged with seeing his birth, and then halter-training him; getting him used to the halter. He's very sweet and pals with Spotacular. Watching them grow in not only size, but skills, is enjoyable.

One day, I came for my training session and met a new baby llama. Sadly, he had a wry face which means his upper jaw was twisted. Because of this deformity, it was hard for him to eat and he wasn't expected to live very long. The next week, he had managed to eat, and we began to hope he would survive. If he did, he was going to be a therapy llama named Phantom, from Phantom of the Opera due to his "masked" face. Even though he was able to eat, it didn't provide enough nutrition and he



passed away after two weeks. But now there is a new llama named Pearl E. White and she's a stubborn llama!

I love working with llamas and enjoy their fun personalities.

*Submitted by Dorte Peloquin
Peloquin's Perch*



Susanna with Spunkie and Choco Latte!



Susanna, Dorte and Spunkie

MR. PEANUT, THE PACK LLAMA

Mr. Peanut and I go back a long way together. He was the first llama I purchased in 1997. So we sort of figured out llama packing as a team. Our team was built on trust and it has continued for 19 years. Mr. Peanut will turn 20, September 26, 2016. He has packed commercially for 17 years and **is still going**. He is one of those llamas who fits anywhere in the pack string. However, since he is older he prefers to bring up the rear where he can set his own pace.

I attribute his longevity in the packing industry to never overloading his panniers. You will notice in the photo his pasterns are not broken down and he still maintains a straight back for the most part. He has never been a llama to “over indulge in the groceries” and he has maintained a steady weight. His

short wool and athleticism are also qualities found in the ideal pack llama. A will and desire to pack is also one of Mr. Peanut’s attributes. Once he even climbed into the stock trailer before I was ready to go!

He has been used as a demo in several Llama Packing 101 classes in the southeast. Mr. Peanut has been an excellent role model for our younger llamas in training for our pack string.

Mr. Peanut still utilizes his original Mt. Sopris saddle and panniers I purchased in 1999. This packing system has become the “gold standard” for San Juan Mountains Llamas. I have tried other systems but Mt. Sopris has certainly proven its worth over time.

*Laura Higgins, MD
San Juan Mountains Llama Treks
Cortez, Colorado*



**Southern States Llama
Association
Annual Meeting and Conference
March 16-18, 2018**



**The Mountain Lodge
Flat Rock, NC**

**Annual Meeting
Break-out Group Sessions
Memorial Hank Hike
Fiber Room with Activities
Keynote Speaker
Awards Dinner
Auction and Raffle**

Come join the start of the Next Thirty Years

CALENDAR OF UPCOMING LLAMA EVENTS

Date	What	Where	Contact
Sept 2-3, 2017	Heart of Dixie Llama Show	Ringgold, GA	Kathy Devaul kdevaul@bellsouth.net Cheryl Lambert, Clambert5@tampabay.rr.com
Sept 9-10, 2017	NC Mountain State Fair Llama Show	Fletcher, NC	<u>Lauri Jones</u> Laurijones1@windstream.net
Sept 23-24, 2017	White Lightning Show & Pack Trial	CANCELLED	
Oct 7, 2017	The Great Llama Race Fund-raiser for Casa de Sara	CANCELLED	
Oct 13-15, 2017	GA National Fair Llama Show	Perry, GA	Kathy Devaul kdevaul@bellsouth.net
Oct 13-15, 2017	ALSA SE Regional Championships	Perry, GA	Cheryl Lambert, Clambert5@tampabay.rr.com
Nov 4-6, 2017	North American Llama & Alpaca Show	Louisville, KY	Harvey Pool hpool57@yahoo.com
Nov 2017	SSLA Fall Pack Llama Trial	Furnace Creek Farm Cumberland Furnace, TN	Tori and Michael Howk Tmh2399@yahoo.com
Dec 2, 2017	Children's Healthcare of Atlanta Christmas Parade	Atlanta, GA	Tracy Munroe witsendfarm@comcast.net
Dec 9 & 10, 2017	Winter Classic Llama Show	Gainesville, GA	Hunter Snow huntershopesandreams@gmail.com

Mobile Llama Shearing
 Most Southeastern States
Don Holliston
 706-896-5005
 email: llamafarm@windstream.net



ADVERTISING INFORMATION

Advertising content may be emailed as clean
as a high-resolution (300 dpi or better) electronic file to:

Charlene Braun, Online SSLA Journal Editor at turtlrun@earthlink.net, 352-243-0383

Or **Lisa Pool**, Printed SSLA Journal Editor at designsbylisap@gmail.com, 478-825-3239

Please verify via phone or email to ensure your ad has been received. You must pay for it prior to publication.

Ad sizes				
Full Page 7 ¼ x 9 ½"	Half Page 3 ½ x XX	Quarter page 7 ¼ x 2 1/2		Business Cards
		Quarter Page 3 ½ x 4 ¼		

Display Advertising:
All advertising must be camera-ready. Advertisers are encouraged to submit ads in electronic format. All electronic ads must be 300 dpi and in MS Word, Publisher, pdf, tif, or jpg format.

Ad Types and Sizes	Members Only Cost	Non-Member Cost	How Many	Amount
Cover ads (contact Able publishing at steph.pride@ableprintingcompany.com)	\$185	\$200		
Full page black & white (7 ¼" wide x 9 ½" high)	\$90	\$105		
Half page (7 ¼" wide x 4 5/8" high or 3 ½" wide x 9 ½" high)	\$45	\$60		
Quarter Page (7 ¼" wide x 2 3/8" or 3 ½" wide x 4 5/8" high)	\$25	\$35		
Business Card (3 ½" x 2")	\$5	\$10		
Classified Ad (See Instructions below. 35 words or less, each word over 35 words is \$0.10 extra)	\$5	\$10		
Name, Farm and Website listing only (free with purchase of business card ad)	\$5	\$10		

Display Ads

CLASSIFIED ADS... The first 35 words are a flat \$5. Each additional word after 35 is \$0.10 (10 cents) each. Each separate ad is \$5.00 for the first 35 words. When counting words remember:

- the entire farm name is one word
- an animal's proper name is one word
- the phone number is one word
- punctuation does not constitute a word
- the price is one word

NOTE TO ADVERTISERS

Ad invoices are sent via email. All ads must be paid in advance. Please send payment made out to SSLA to:

Kathy Devaul
217 Donald Rd
Leesburg, GA 31763

FREE BUSINESS CARD ADS!

Want one?

Just submit an article or
photo series to the Journal.

Southern States Llama Association (SSLA) Obstacle Trailer Advertising Form

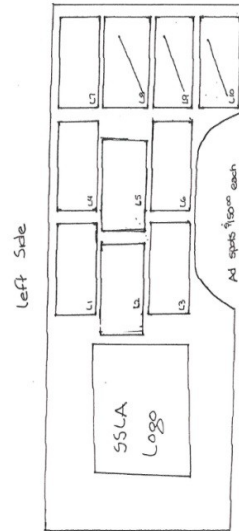
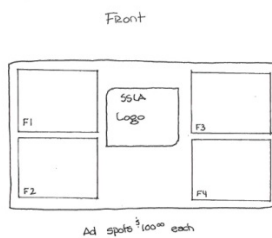
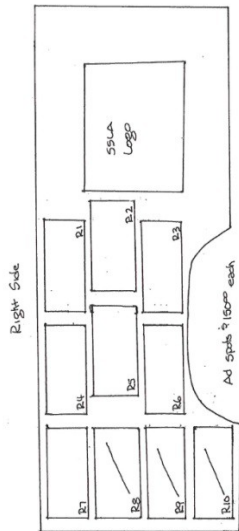
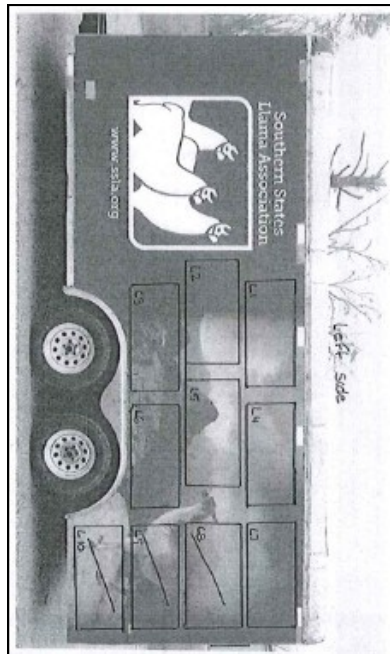

SSLA is offering this MOBILE opportunity for visibility within the Southeast Region of the United States. Great limited space available opportunity to hit the roads, show rings, interstate, back roads, mountains and rest areas within the SSLA show area! SSLA is opening up the opportunity for marketing on the obstacle trailer! Limited space available. Artwork assistance available.

The profile photo of the trailer gives you a visual image of the opportunities available. The company that created the wrap artwork for the obstacle trailer is assisting with artwork design and installation.

Continued on next page

**Southern States Llama Association (SSLA)
Obstacle Trailer Advertising Form**

Advertisement is for a full year based on advertising contract. Ads for the side panels for \$150 per space. Ads for the front panel is \$100 per space. Payments must be received prior to space being reserved.

Name: _____

Address: _____

Phone Number: _____

Email: _____

Space selection: _____

Please complete this form and return to Kathy Devaul.
kdevaul@bellsouth.net or mail 217 Donald Road, Leesburg, GA 31763.