

The SSLA



LLAMA JOURNAL

The Official Journal of the Southern States Llama Association

October 2018

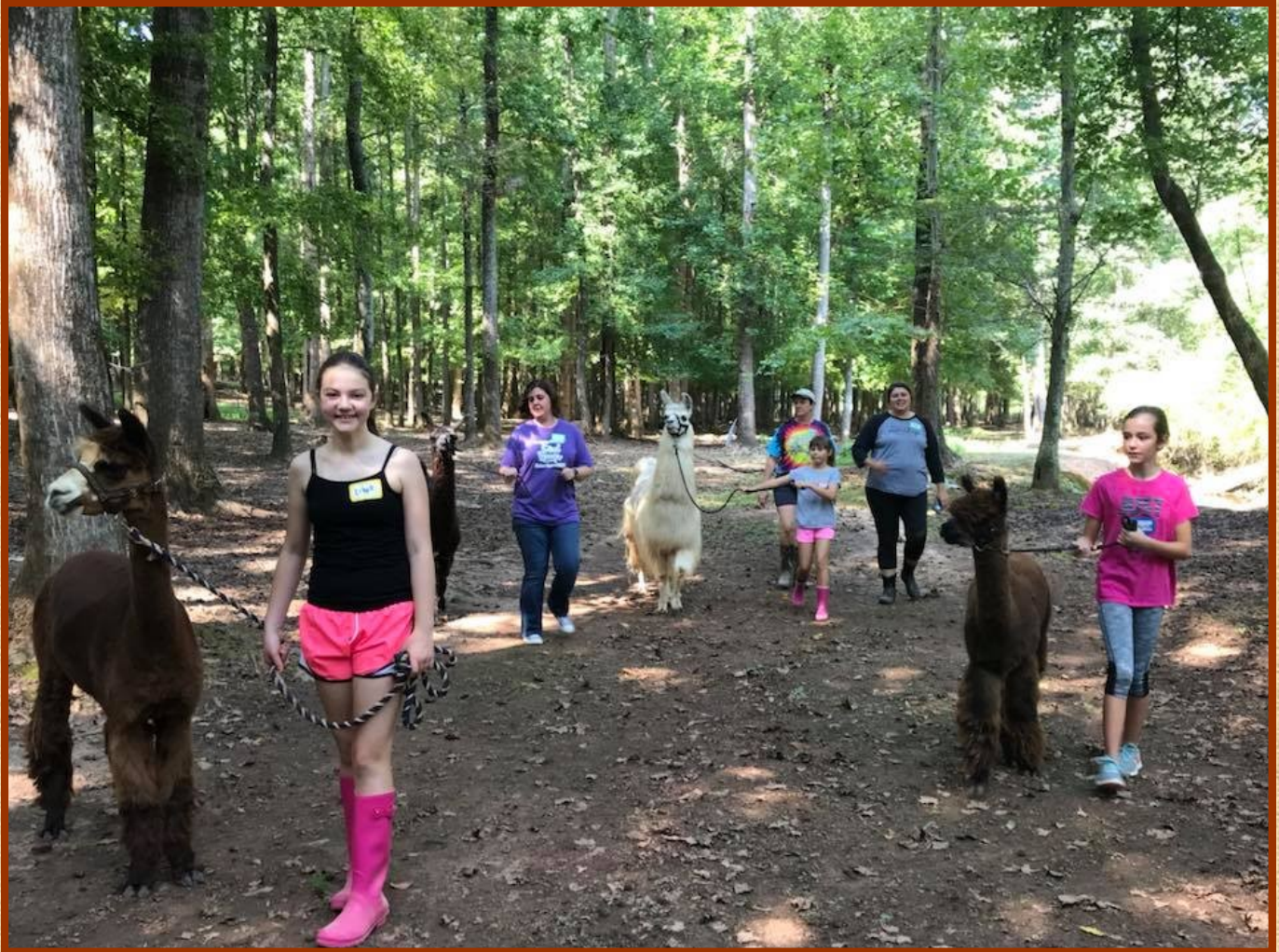

TABLE OF CONTENTS

SSLA Board Members and Information	3
President’s Message	4
SSLA 2018 Board Meeting, August 31, 2018	5
The Great Llama Race 2018 — Behind the Scene	6
Save the Date — SSLA Conference	7
Llamaste Yoga	8
What Is Jackson County 4-H Love of Llamas Youth Group?	9
ALSA SE Regional Championship Llama Show Results	11
Georgia National ALSA Llama Show Results	13
Calendar of Upcoming Llama Events	14
Advertising Information	15
Obstacle Trailer Advertising Information	17

Cover: Getting ready for the Great Llama Race with Llama/Alpaca 4-H Club of Infinity Acres Ranch



It’s that time of year again — SSLA membership dues are due by December 31, 2018

Deadline for the next issue is January 15, 2019

Send articles, photos (digital format preferred) to:

Charlene Braun, Online Journal Editor, turtlrn@earthlink.net

SSLA BOARD MEMBERS AND INFORMATION

Board of Directors

Kim Kyst, *President*
Kim@kyst.org

Cathie Kindler, *Vice President*
llamajudge@gmail.com

Kathy Devaul, *Treasurer*
Kdevaul@bellsouth.net

Lauri Jones, *Secretary*
Laurijones@windstream.net

Mary Rose Collins, *Director*
mrc604@tampabay.rr.com

Greg Hall, *Director*
SimplicitylamaFarm@yahoo.com

Lynn Wright, *Director*
walkingwright@msn.com

Committee Chairs & Contacts

(If the committee chair is a board member, that person is also the Board Liaison)

Committees

Annual Meeting Conference—

By-law Amendment—Tom Wilson
Board Liaison: Kim Kyst

Carting—Greg Hall

Election—To be appointed by President

Fiber—Tracy Weaver
Board Liaison: Lauri Jones

Online Journal—Charlene Braun
turtlrn@earthlink.net
Board Liaison: Mary Rose Collins

Library—Lauren Wright

Llama Trekking & Packing—
 Tom Rothering
Board Liaison: Cathie Kindler

Membership—Cheryl Lambert
clambert5@tampabay.rr.com
Board Liaison: Mary Rose Collins

Show—Kathy Devaul

Website—Vicki Sundberg
Board Liaison: Greg Hall

Youth & Youth Ambassador Awards—
 Cathie Kindler
Board Liaison: Kim Kyst

Youth Scholarship—Tom Rothering
Board Liaison: Kim Kyst

Ambassador Awards—Greg Hall
Trekking Awards—Vicki Sundberg
Sweepstakes Awards—Lynn/Lauren Wright
Board Liaison: Lynn Wright

Rescue—Deborah Logan
logan99.mail@gmail.com

Sweepstakes—Vicki Sundberg
Board Liaison: Lynn Wright

Journal Mission Statement

THE LLAMA JOURNAL, published by the Southern States Llama Association (SSLA) is distributed quarterly to the members of SSLA. The purpose of the Journal is to provide:

- Information and articles of interest
- A forum for members to express their opinions on llamas and related matters
- Board of Directors meeting minutes, Treasurer's report and other information pertinent to the function of SSLA.

Notice: The information contained in this Journal is not intended to be a substitute for qualified professional advice. Our readers are encouraged to consult with their own vets, accountants or attorneys for questions concerning their animals or business operations. SSLA or the editor is not responsible for any losses resulting from a reader's failure to heed this caution. Opinions expressed or implied are hereby the editor's choice and are not the opinions of the SSLA Board of Directors or SSLA as a group.

SSLA Mission Statement

OUR MISSION as members of the Southern States Llama Association is to be a strong organization of llama and alpaca owners who have joined together for the purpose of education, fun, and fellowship while promoting the health and welfare of llamas and the llama industry.

SSLA Online—keep in touch with your llama organization

Website: www.ssla.org

Facebook page: Listed as "SSLA-Southern States Llama Association"

SSLA-Members Yahoo Group: Request membership from ssla-members-owner@yahoogroups.com

Group members can post messages to SSLA-Members@yahoogroups.com

PRESIDENT'S MESSAGE



★ Dear Membership,

★ There is lots of great and amazing things happening with our membership and industry. Everyone's business and industry are using camelids to market and promote their services and products. It's an exciting time.

★ I would like to request that those within our membership utilize their creative abilities and skills to create a stronger and more valued SSLA organization. If you currently aren't serving within SSLA, please consider stepping up and helping. If you will contact me directly about where you would like to better serve SSLA and its BOD and committees, I will assist with getting your ideas and talents implemented within our organization.

★ This hurricane season hasn't been a compassionate one to our members. Flooding and storm damage has created great suffering on several within our membership. Please keep those suffering from damages and loss in your thoughts and prayers.

★ This has been an exciting year for the Jackson County Georgia 4-H Love of Llamas club. The club has seen amazing growth this year. Our membership grew with ten new members. They have been a very eager group of parents and youth looking to become active in all areas of the program. With the growth came a few growing pains. The club has been working with the same core group of llamas for many years. Due to the youth membership expansion this year, the herd expanded with nine new animals. With a combination of purchased animals from Bill and Susan Johns, loaner animals from Cathie Kindler, and donated yearlings from Beth Daniels, we have been able to open the door for new opportunities and a more advanced training program. I would personally like to say thank you to each of you for making the program successful and supporting our efforts.

It's that time of year to begin renewing memberships and looking into the bright new year of 2019! I would like to suggest SSLA create a committee to assist the Membership Committee with the creation of a membership drive and promotion program. We need to reach out to the public and attract those seeking information about camelids. If you have ideas and programs that you would like to organize and lead to grow membership, please let me know. I would like to submit your ideas to the SSLA Board of Directors for approval to move forward.

The 2019 Annual Conference is currently being planned and organized. The conference will be held in Athens, Georgia on March 15-17, 2019. The University of Georgia veterinarians, UGA Small Ruminants Club and SSLA members have been diligently working to create a fun and educational opportunity for not only the SSLA membership, but all camelid owners and veterinarians. The conference will allow networking time, veterinarian continued educational classes, Llamaste Yoga, camelid health classes, fiber classes, and show and training programs to improve handling skills and knowledge.

Our election committee is seeking those interested in becoming more active in the future of SSLA to step up to and serve on the Board of Director of SSLA. Please watch for emails and information about the upcoming nominations and elections.

Be safe out there,
Kim Kyst
SSLA 2018 President



SSLA BOARD OF DIRECTORS MEETING

AUGUST 31, 2018

RINGGOLD, GA

Meeting called to order 7:12 pm.

Attendance:

Kim Kyst, President
 Cathie Kindler, Vice President
 Kathy Devaul, Treasurer
 Lauri Jones, Secretary
 Greg Hall (phone), Director
 Mary Rose Collins, Director
 Lynn Wright (phone), Director

Minutes from last meeting were approved and posted on the website.

Old Business:

Business cards and banner were approved and are printed. Who is responsible for banners? Secretary holds one banner and business cards, show team (Kathy Devaul) holds one banner, and pack trial organizer (Mary Rose Collins) holds one. All directors in agreeance.

Topic: Treasurer's Report

Treasurer makes a motion to transfer live auction funds of \$1825 and funds donated by conference speaker \$500 be transferred from general funds to youth fund – Mary Rose seconded motion and all board members are in agreeance.

Topic: Journal

Each committee chair must make sure they are aware of the deadline dates so that any information from the committees makes it into the Journal. Delay the October deadline so that there is time to get Regional Show information into the Journal.

Topic: Website

Brought in Vicki Sundberg to cover – covered items that are being added to the website and things that have already been completed. Members should send pictures to be added to the website (pictures showing their love for llamas). Directors have a contact page so members can email them and what specifically they can answer. History information has been added. Members only link is being added as well. By entering your email, it will send you email for login access. Must log out when done. Members only page contains the library, Discover Llamas

form to contact Tom Wilson. Considering a way for a Discover Llama magazine to be sent out when someone request for a mailing fee because it is too large to put on the website. The Journals can be added to the website. Board minutes are only on the members page. SSLA specific documents like insurance info, bylaws, GA registration, etc. The harassment policy will be listed in both public and members only pages. Hot Line resources have been added like carting, fiber, poisonous plants, etc. Veterinarians list needs to be updated by possible help from members. Need to get photo release on the website. Add featured farm link on the public page. On the security side we must ensure that we add or delete membership timely. Advertising link has been added. How will advertising be worked out with Journal and website?.

Topic: Sweepstakes Awards

Review what changes need to be made to the sweepstakes guidelines. Vicki Sundberg departed meeting. Lynn will send back out information about updates for sweepstakes.

Topic: Membership

Reworking membership form and need to have form reviewed before end of October. Work on ways to encourage membership potentially through breeding farms to help boost membership.

Topic: Library

Lauren almost finished sorting and documenting items in the library.

Topic: Conference

Moving forward with conference to be held at UGA. This is how we perceive that the conference would roll out: Friday night – pot luck dinner with tour/networking; Saturday – 3 breakout sessions / fiber / performance or judging i.e. / camelid care and have vendor area in stalls; reserved and deposit has been put down in order to hold the facility; groups from UGA assisting with getting things set up and additional areas for trekking.

Kathy Devaul motion to adjourn, Mary Rose second.

Meeting ended at 8:30 pm

The Great Llama Race 2018





**Southern States
Llama Association**

SSLA 2019 Annual Conference & Awards Banquet

Save the Date!

Open to all camelid owners and veterinarians
(CE credits available)

Friday, March 15 -17, 2019

UGA Instructional Arena, Athens, Georgia

Schedule:

FRIDAY, March 15, 2019

Noon – 5 pm: Arrive and check-in

5-6:30 pm Pot Luck Dinner (Everyone bring a dish to share)

7-9 pm Tour of UGA Vet Hospital

SATURDAY, March 16, 2019

7 am Llama Yoga with Claire Hess

8-9 am Breakfast

Breakout sessions:

There will be a fiber, show, and health option during all breakout sessions.

Speakers and programs will be announced soon.

9-10:15 am Breakout Session

10:30- noon Breakout Session

Noon – 1 pm Lunch

1 pm – 2:15 pm Breakout Session

2:30 – 4 pm Breakout Session

4 pm – 5 pm Membership Meeting

7 pm Banquet Dinner/Dancing

SUNDAY, March 17, 2019

7 am Llama Yoga with Claire Hess

8 – 9 am Breakfast

9 – 11 am Llama Trek

SPONSORSHIPS AVAILABLE!

Vendor Market Place, A great opportunity
and space to promote and sell your
camelid items and supplies.

SSLA Mission Statement

Our mission as members of SSLA is to be a strong organization of llama and alpaca owners who have joined together for the purpose of education, fun, and fellowship while promoting the health and welfare of camelids and the camelid industry.

www.ssla.org

Llamaste Yoga



Jackson County 4-H Love of Llamas Welcomes New Members and Parents

This year at the annual Open House Recruitment Day on August 5th, Jackson County 4-H Love of Llamas welcomed 30 parents and youth to visit Chelian Farms in Jefferson, Georgia to learn more about the Love of Llamas 4-H youth program and llamas as exotic livestock. By the end of the week the Jackson County 4-H Love of Llamas club welcomed ten new members with their families along with four returning members.

Our youth became actively engaged in both the educational studies and hands-on work necessary to understand and work with large exotic animals. Each member has begun the engaging learning process of how to groom, feed, and care for llamas. Though fun, our new members are learning that it also takes a lot of work and a deep level of commitment to create a bond with the llamas. With the help of returning members Andie Ellett, Lily Howell, and Isabelle and Ava Olliff, the new members are becoming much more sure of themselves around the farm and animals.



Jackson County 4-H Love of Llamas Welcomes New Members and Parents *continued*

This growing and thriving program also welcomed new animals to the farm. Thank you to Susan Johns for Echo, Zaccheo, and Salute; Cathie Kindler for Fuzzy, Shamar, and Rafael; and Beth Daniels for Chama, Turbo, and Flash. All nine of these new boys have quickly bonded with the youth and blended well with the herd.

Be on the lookout for an article that shares the accomplishments of our enthusiastic Jackson County 4-H 2018-19 Love of Llamas club members! Exciting events are in our future!



**ALSA SOUTHEASTERN REGIONAL CHAMPIONSHIP LLAMA SHOW
OCTOBER 13 - 14, 2018**

Master Performance	Grand: Timberwinds Chevy Chase - Lauren Wright Reserve: NWLF's Flash Gordon - Lauren Wright
Alpaca Master Performance	Grand: Mr. Wilbur - Lauren Wright
Advanced Performance	Grand: Luke at Me - Lauren Wright Reserve: PPR Briarglen - Tom Rothering
Alpaca Advanced Performance	Grand: Lofty Pine Friendly Thomas - Lauren Wright Reserve: Prince Wednesday - Lauren Wright
Senior Youth Performance	Grand: Riseland's Prevoe "Leo" - Bailey Jones
Intermediate Youth Performance	Grand: Oak Rest's Bently - Ben McCloughan Reserve: Pongo the Magnificent - Isabelle Olliff
Novice Performance	Grand: STAMF Mr. Sandman - Elizabeth Ingram Reserve: CWL The Joker - Elizabeth Ingram
Alpaca Novice Performance	Grand: Maximus II - Deb Andrews Reserve: Brook Creek Gus - Lauren Wright
Non Breeder	Grand: Furor de le Noche - Kitty Tuck Hampel Reserve: Moose Hill's Midnight Ryder - Deb Andrews
Alpaca Non Breeder	Grand: Maximus II - Deb Andrews Reserve: Prince Wednesday - Lauren Wright
Suri Wool Female	Grand: RCF Piping Hot - Harvey Pool Reserve: RCF Blackberry Wine - Harvey Pool
Light Wool Female	Grand: Overman's Black Sapphire - Deb Andrews Reserve: PPR Xanadue - Cliff Zimmerman
Medium Wool Female	Grand: Eleveses Aroon - Eric Vlaencia Reserve: Moose Hills Speckle Tush - Mary Rose Collins
Heavy Wool Female	Grand: MSF Moondance - Deb Andrews Reserve: KRS Avalon Starr - Stacy Mashburn
Suri Wool Male	Grand: KRS V Mater of Dance - Stacy Mashburn Reserve: KRS RCF Jakarta - Harvey Pool
Light Wool Male	Grand: Murali's Ichiban - Harvey Pool Reserve: NWLF's Flash Gordon - Lauren Wright
Medium Wool Male	Grand: MSF Fame and Fortune - Justin Pelletier Reserve: RCF Browning - Bailey Jones
Heavy Wool Male	Grand: Sapaveco's Rock Starr - Lauren Wright Reserve: Oak Rest's Cinco Demayo - Kathy Wilbanks



Moose Hill's Midnight Ryder was Grand Champion under the green judge and Reserve Champion under the orange judge and Reserve Champion in the ALSA Regional Show!

**GEORGIA NATIONAL ALSA LLAMA SHOW
OCTOBER 13 - 14, 2018**

Orange

Green

Driving Performance	Grand: Good Ol' Smiley - Greg Hall	Grand: Good Ol' Smiley - Greg Hall
Master Performance	Grand: Timberwinds Chevy Chase - Lauren Wright Reserve: Oak Rest Winter Rose - Mary Rose Collins	Grand: Timberwinds Chevy Chase - Lauren Wright Reserve: NWLF's Flash Gordon - Lauren Wright
Alpaca Master Performance	Grand: Mr. Wilbur - Lauren Wright	Grand: Mr. Wilbur - Lauren Wright
Advanced Performance	Grand: Luke at Me - Lauren Wright Reserve: PPR Briarglen - Tom Rothering	Grand: Luke at Me - Lauren Wright Reserve: PPR Briarglen - Tom Rothering
Alpaca Advanced Performance	Grand: Lofty Pine Friendly Thomas - Lauren Wright Reserve: Prince Wednesday - Lauren Wright	Grand: Lofty Pine Friendly Thomas - Lauren Wright Reserve: Prince Wednesday - Lauren Wright
Senior Youth Performance	Grand: Riseland's Prevoe "Leo" - Bailey Jones Reserve: Slick Nifty - Andie Ellett	Grand: Riseland's Prevoe "Leo" - Bailey Jones Reserve: Slick Nifty - Andie Ellett
Intermediate Youth Performance	Grand: PPR Voyager - Malory Williams Reserve: Pongo the Magnificent - Isabelle Olliff	Grand: Pongo the Magnificent - Isabelle Olliff Reserve: PPR Voyager - Malory Williams
Junior Youth Performance	Grand: Machu Man - Dylan Shaver Reserve: Chelians's Rainy Mega Million - Lily Howell	Grand: Machu Man - Dylan Shaver Reserve: PPR Kopper Kat - Holly Werkheiser
Novice Performance	Grand: STAMF Mr. Sandman - Elizabeth Ingram Reserve: MCC Amahl's Armani - Lauren Wright	Grand: STAMF Mr. Sandman - Elizabeth Ingram Reserve: MCC Amahl's Armani - Lauren Wright
Alpaca Novice Performance	Grand: Brook Creek Gus - Lauren Wright Reserve: Maximus II - Deb Andrews	Grand: Maximus II - Deb Andrews Reserve: Brook Creek Gus - Lauren Wright
Non Breeder	Grand: Riseland's Prevoe - Bailey Jones Reserve: Moose Hill's Midnight Ryder - Ulin Andrews	Grand: Moose Hill's Midnight Ryder - Ulin Andrews Reserve: Riseland's Prevoe - Bailey Jones
Alpaca Non Breeder	Grand: Maximus II - Deb Andrews Reserve: Prince Wednesday - Lauren Wright	Grand: Prince Wednesday - Lauren Wright Reserve: Maximus II - Deb Andrews
Suri Wool Female	Grand: RCF Piping Hot - Harvey Pool Reserve: RCF Blackberry Wine - Harvey Pool	Grand: RCF Piping Hot - Harvey Pool Reserve: RCF Blackberry Wine - Harvey Pool
Light Wool Female	Grand: Overman's Black Sapphire - Deb Andrews Reserve: PPR Xanadue - Cliff Zimmerman	Grand: Overman's Black Sapphire - Deb Andrews Reserve: PPR Xanadue - Cliff Zimmerman
Medium Wool Female	Grand: ALCL Dominique - Deb Andrews Reserve: Elevenses Aroon - Eric Vlaencia s	Grand: ALCL Dominique - Deb Andrews Reserve: Elevenses Aroon - Eric Vlaencia
Heavy Wool Female	Grand: MSF Moondance - Deb Andrews Reserve: KRS Avalon Starr - Stacy Mashburn	Grand: MSF Moondance - Deb Andrews Reserve: KRS Avalon Starr - Stacy Mashburn
Suri Wool Male	Grand: KRS V Mater of Dance - Stacy Mashburn Reserve: KRS RCF Jakarta - Harvey Pool	Grand: KRS RCF Jakarta - Harvey Pool Reserve: KRS V Mater of Dance - Stacy Mashburn
Light Wool Male	Grand: Murali's Ichiban - Harvey Pool Reserve: NWLF's Flash Gordon - Lauren Wright	Grand: Murali's Ichiban - Harvey Pool Reserve: NWLF's Flash Gordon - Lauren Wright
Medium Wool Male	Grand ALSA: RCF Browning - Bailey Jones Reserve ILR: SRLL Meraxes - Harvey Pool	Grand: RCF Browning - Bailey Jones Reserve: MSF Fame and Fortune - Justin Pelletier
Heavy Wool Male	Grand: Sapaveco's Rock Starr - Lauren Wright Reserve: RCF Allstar - Harvey Pool	Grand: Sapaveco's Rock Starr - Lauren Wright Reserve: RCF Allstar - Harvey Pool

CALENDAR OF UPCOMING LLAMA EVENTS

Date	What	Where	Contact
Dec 1, 2018	Children's Healthcare of Atlanta Christmas Parade	Atlanta, GA	Tracy Munroe witsendfarm@comcast.net

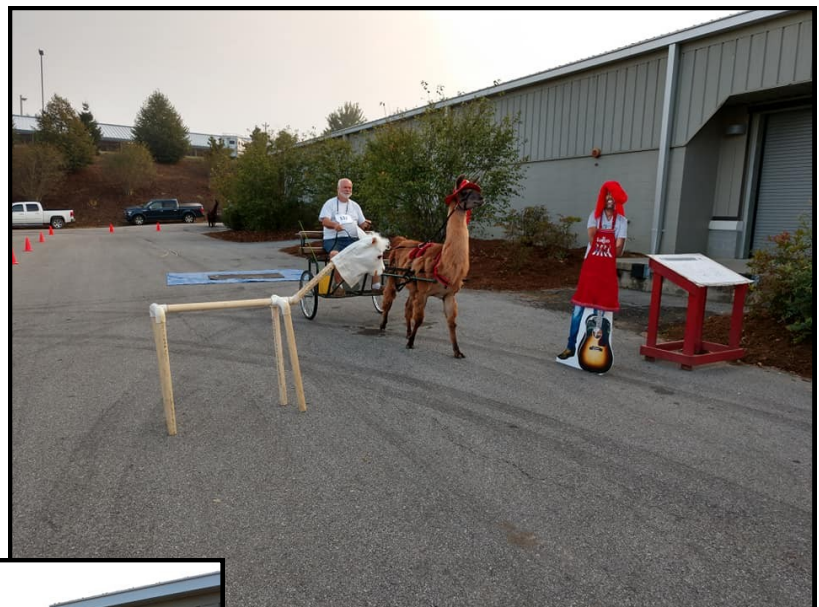

ADVERTISING INFORMATION

Advertising content may be emailed as clean
as a high-resolution (300 dpi or better) electronic file to:

Charlene Braun, Online SSLA Journal Editor at turtlrun@earthlink.net, 352-243-0383

Please verify via phone or email to ensure your ad has been received. You must pay for it prior to publication.

Ad sizes				
Full Page 7 ¼ x 9 ½"	Half Page 3 ½ x XX	Quarter page 7 ¼ x 2 1/2		Business Cards
		Quarter Page 3 ½ x 4 ¼		

Display Advertising:
All advertising must be camera-ready. Advertisers are encouraged to submit ads in electronic format. All electronic ads must be 300 dpi and in MS Word, Publisher, pdf, tif, or jpg format.

Ad Types and Sizes	Members Only Cost	Non-Member Cost	How Many	Amount
Cover ads (contact Able publishing at steph.pride@ableprintingcompany.com)	\$185	\$200		
Full page black & white (7 ¼" wide x 9 ½" high)	\$90	\$105		
Half page (7 ¼" wide x 4 5/8" high or 3 ½" wide x 9 ½" high)	\$45	\$60		
Quarter Page (7 ¼" wide x 2 3/8" or 3 ½" wide x 4 5/8" high)	\$25	\$35		
Business Card (3 ½" x 2")	\$5	\$10		
Classified Ad (See Instructions below. 35 words or less, each word over 35 words is \$0.10 extra)	\$5	\$10		
Name, Farm and Website listing only (free with purchase of business card ad)	\$5	\$10		

Display Ads

CLASSIFIED ADS... The first 35 words are a flat \$5. Each additional word after 35 is \$0.10 (10 cents) each. Each separate ad is \$5.00 for the first 35 words. When counting words remember:

- the entire farm name is one word
- an animal's proper name is one word
- the phone number is one word
- punctuation does not constitute a word
- the price is one word

NOTE TO ADVERTISERS

Ad invoices are sent via email. All ads must be paid in advance. Please send payment made out to SSLA to:

Kathy Devaul
217 Donald Rd
Leesburg, GA 31763

FREE BUSINESS CARD ADS!

Want one?

Just submit an article or
photo series to the Journal.

Southern States Llama Association (SSLA) Obstacle Trailer Advertising Form

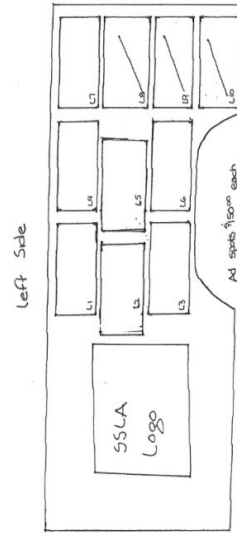
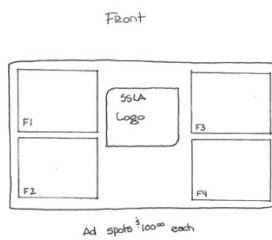
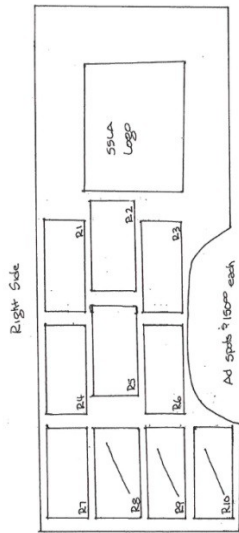
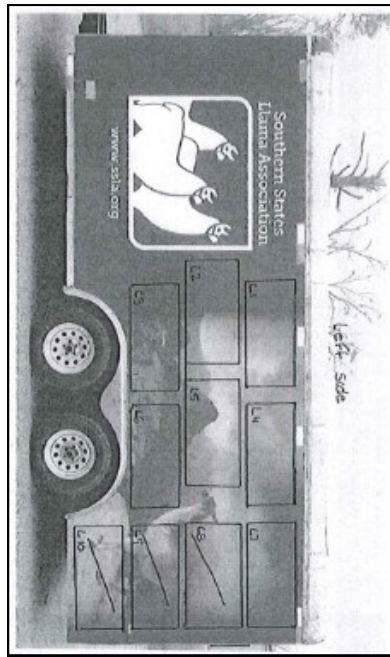

SSLA is offering this MOBILE opportunity for visibility within the Southeast Region of the United States. Great limited space available opportunity to hit the roads, show rings, interstate, back roads, mountains and rest areas within the SSLA show area! SSLA is opening up the opportunity for marketing on the obstacle trailer! Limited space available. Artwork assistance available.

The profile photo of the trailer gives you a visual image of the opportunities available. The company that created the wrap artwork for the obstacle trailer is assisting with artwork design and installation.

Continued on next page

**Southern States Llama Association (SSLA)
Obstacle Trailer Advertising Form**

Advertisement is for a full year based on advertising contract. Ads for the side panels for \$150 per space. Ads for the front panel is \$100 per space. Payments must be received prior to space being reserved.

Name: _____

Address: _____

Phone Number: _____

Email: _____

Space selection: _____

Please complete this form and return to Kathy Devaul.
kdevaul@bellsouth.net or mail 217 Donald Road, Leesburg, GA 31763.