

JUNE 2024



**FAMILY AND FELLOWS  
FOUNDATION**

# **Project Proposal**

**The Knowledge Center  
(Bashir Asi Campus)**

**PRESENTED TO:**

To Whom it may Concern

# Table of Contents

Who We Are	03
Mission and Vision	04
Our Projects	05
Proposed Timeline	06
Budget Proposal	08
Financial Projection	09
Future Content	10
Contact Information	11

# Who We Are

## We are

A dedicated organization committed to uplifting lives and building stronger communities. **Founded in 2016** and inspired by the legacy of our esteemed **founder, Mr. Muhammad Bashir Asi**, we strive to continue his mission of providing a helping hand to those in need. Our core initiatives focus on ensuring access to **Education**, **Healthcare** and **Food Security** fostering unity, compassion and fellowship across Pakistan



*Spend something (in charity) of what We have bestowed on you.*  
(Al-Quran)

## BOARD OF DIRECTORS



**Dr Amir Bashir**  
Chairman BOD



**Dr Aqeela Rashid**  
Member BOD



**Engr Yasir Bashir**  
Member BOD



**Engr Asim Bashir**  
President

# Mission and Vision



## MISSION

Our mission is to **uplift lives** and strengthen communities by providing comprehensive support in education, healthcare, food security, and emergency relief. Through **strategic partnerships**, **transparent operations**, and a **commitment to integrity**, we aim to foster self-reliance and long-term positive change.



## VISION

Our vision is to create a world where every individual has the opportunity to lead a **life of dignity**, empowered by access to education, healthcare, and essential resources. Together, we uplift lives and build stronger communities, creating a **legacy of compassion** and service through our **welfare initiatives**.



# Our Projects

100%

## Local School Support Project

Metric: Stationery and Winter Dresses for more than 200 Students based on need

100%

## Bashir Asi Scholarship for Excellence

Metric: Scholarships for more than 30 Students based on need and merit

100%

## Learning Essentials Initiative

Metric: Provide Learning Essentials to more than 100 Students

10%

## The Knowledge Center

Metric: Construction of State of the Art Knowledge Center for more than 200 students

## The Knowledge Center

- 1st of its kind **Educational Initiative** in Tehsil Pind Dadan Khan, currently in the planning stage, aimed at providing comprehensive educational services to more than **200 Students**
- The project will offer **Scholarship to 50 %** of its **Students**, ensuring accessible learning opportunities for all. **Selection** of students for scholarship will be **Based on Entrance Exam** and financial status
- The Knowledge Center will provide a range of supplementary educational services like **Computer Skills**, **Career Counselling** and **Educational Workshops**

# Proposed Timeline

The Knowledge Center **Construction** will span **18 Months**, starting with a nine-month fundraising and planning phase. Initial funding efforts will be followed by obtaining necessary permits and award of contract. The next six months will focus on construction, from site preparation to building completion. Concurrently, staff recruitment and training will begin in the final months of construction. The project will culminate with **Opening** and **Full Operationalization** within the final three months, welcoming the first batch of students and offering educational services to the community by **Oct 2025**.





# Proposed Structure

- **Classrooms**

- 3 classrooms will be available.

- **Multi-Purpose Hall/Computer Lab**

- 1 multi-purpose hall/computer lab will be used for:
  - Computer literacy
  - Freelancing courses
  - Career Counseling / Seminars

- **Grade Levels**

- Classes for grade 9 to 12 will be offered.

- **Operational Shifts**

- Morning Shift
  - Computer courses will be conducted in the morning.
- Evening Shift
  - 2 hours shift for Matric (Grades 9-10)
  - 2 hours shift for Intermediate (Grades 11-12)

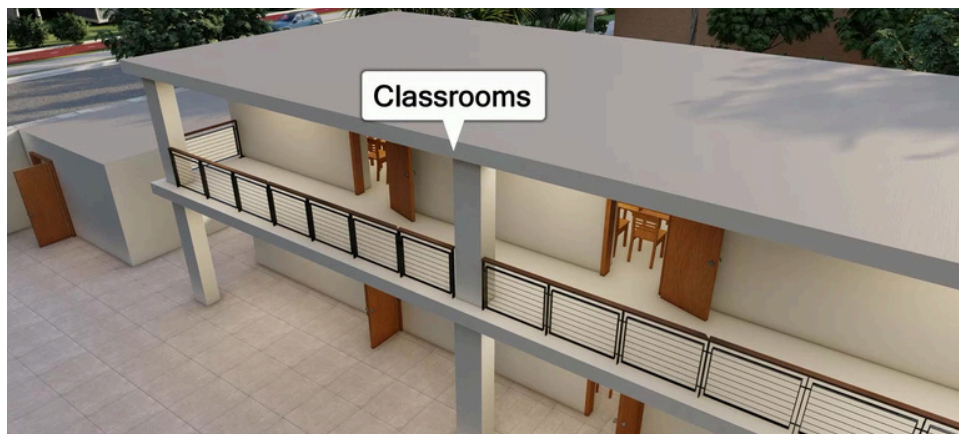

# Proposed Budget

Category	Estimated Cost (PKR)
<b>Fundraising and Planning</b>	
Fundraising Campaign	50000
Site Selection and Permits	25000
Architectural Plans	100000
<b>Construction</b>	
Site Preparation	1500000
Grey Structure	7300000
Interior Work	1200000
Equipment and Furnishings	2300000
<b>Staff Recruitment &amp; Training</b>	
Recruitment Costs	50000
Training Programs	75000
<b>Operationalization</b>	
Final Inspections	25000
Opening Ceremoney	100000
Contingency Fund	1275000
<b>Total Estimated Cost</b>	<b>13,000,000 or say 13 Mil</b>
<b>Approximate Covered Area</b>	<b>4000 sft</b>



# Financial Projections

Aspect	FY25	FY26	FY 27
Number of Students	100	150	200+
Annual Revenue	3600000	4800000	9600000
Annual Expenses	3200000	4500000	9000000
Scholarships	25	40	100

## FINANCIAL TARGETS FY25

Students - PKR 25,00,000  
 Donations - 600,000  
 Partnerships - 500,000

## FUTURE PLANS FOR GROWTH

Increase in Number of Students - 1500000  
 Additional Courses and Seminars- 500,000

## ADDITIONAL SOURCES OF REVENUE

Donations  
 Long Term Investments



**For inquiries,**



 [familyandfellowsfoundation.org](https://familyandfellowsfoundation.org)

 [Info@familyandfellowsfoundation.org](mailto:Info@familyandfellowsfoundation.org)

 +923365838068 +923345728814