

Contact details :
www.coxmartindesign.co.uk

Or 07889 564050

Led by Caroline Martin, an **Architect & Interior designer** with over 25 years professional experience, Cox Martin Design have experience of working on **Commercial Interior fit-out** projects in a variety of sectors including **Workplace, Health Care, Hospitality & Education** . Combining our in-house Architectural and Interior design skills, we're able to efficiently reconfigure and refurbish existing interior spaces to meet our clients brief and budget, helping them to get more out of their existing buildings.

Past winner of 'Best Office building' in the 'Interior Specialist Annual awards '

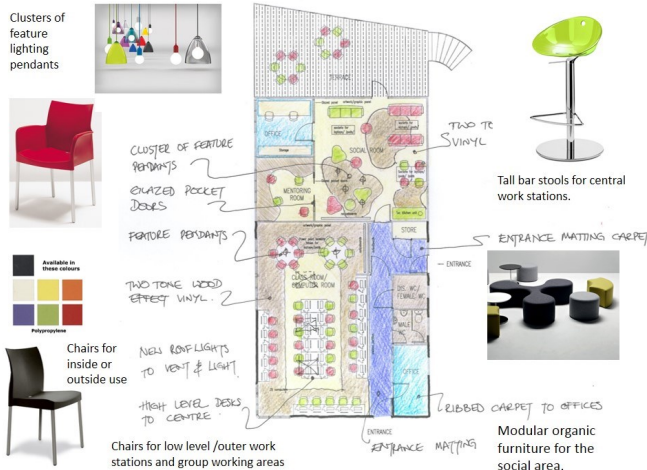
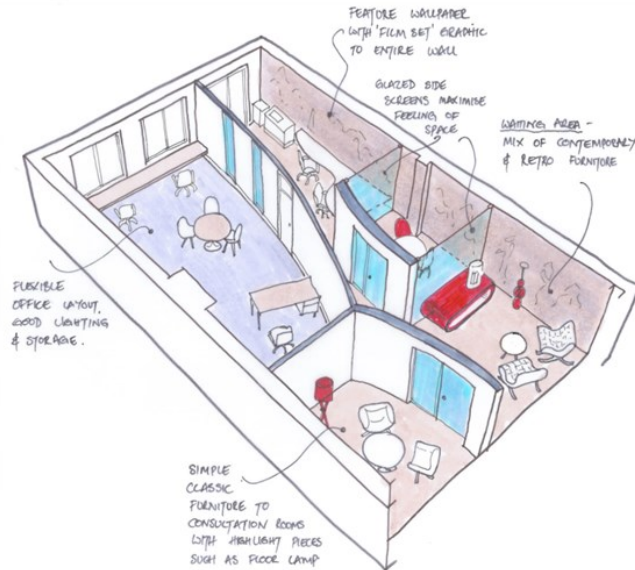

2023 - Elderly Care— Concept , detail design & specification to create areas for Hair & Beauty, Team base, meeting room & servery within an existing Care Home. To be implemented in 2024.

2021- Elderly Care—Design , specification & completion on site of the refurbishment of an existing Victorian orangery that had fallen into disrepair. The restored space was designed to be initially used as a Covid visitor's pod. but is now used as a general communal area for the residents of the care home.

2021— Assisted Living— Concept design for the conversion of an existing Victorian house into 3 self-contained apartments (with staff accommodation) for adults with a learning Disability.

2020— LD Care —feasibility & space planning to convert an existing mental health unit into a 10 bedded residential community for people with Autism and a learning disability ,with 3 self contained apartments, communal and therapeutic areas along with shared outdoor space.

2019 - Mental health PICU —Feasibility & space planning to convert an existing healthcare building to a 12 bed mental health PICU with communal and therapeutic spaces.

2017— Workplace— design and planning for the conversion of an agricultural barn to create 4 x 2 person offices, reception facilities and an open plan video presentation suite.

2015 - Workplace/Community— Concept design & space planning to create co-working & meeting rooms for a charity in London.

2015 - Workplace— Concept design, space planning and interior design for open plan offices for 40 people with meeting rooms and breakout spaces.

Interior Fit-Out CV— Caroline Martin



Whilst with Househam Henderson Architects:

2014– Hotel –extension & refurbishment (including repositioning to 4*+) of a 82 bed **Grade 1 listed** hotel in Bath. Concept design to completion on site, both Architectural and Interior design services (in association with HH Interiors) included bespoke artwork, wall-papers, furniture, fixtures & fittings.

2013 Mental Health—Conversion & fit-out of a large house into a 5 bed ‘step down unit’ Reigate. Planning to completion on site. All Architecture & Interiors design services.

2011– Office -Fit-out to provide refurbished Entrance, reception meeting, breakout & function space in the City Of London. Concept design to completion on site. included bespoke cabinetry and carpets.

2010 - Mental health— Conversion of an existing building to create a specialist **secure mental health** unit for the **deaf**, with 9 ensuite bedrooms and all the associated public areas, OT & therapy rooms. – concept design to completion on site-all Architectural and Interior Design services

2009– Education— Concept design and layouts to extend and refurbish a FE Students Union in Hampshire.

2009–Education— Student canteen— fitout/refurbishment including all new servery, fixtures fittings & furniture. Concept design to completion on site.

2008–Education— Staff Dining room at Southampton University . Fitout/refurbishment including all new servery, fixtures fittings & furniture. Concept design to completion on site.

2008 - Workplace—Interior Fit-out For Letts Educational to provide offices, reception & sales space, café/informal meeting space. Both Architectural and Interior design services.

2007 - Winchester & Basingstoke PCT - Refurbishment works to Operating Theatre staff areas. Concept design to completion on

Interiors fit-out CV– Caroline Martin

