

Closed
Sold
Available

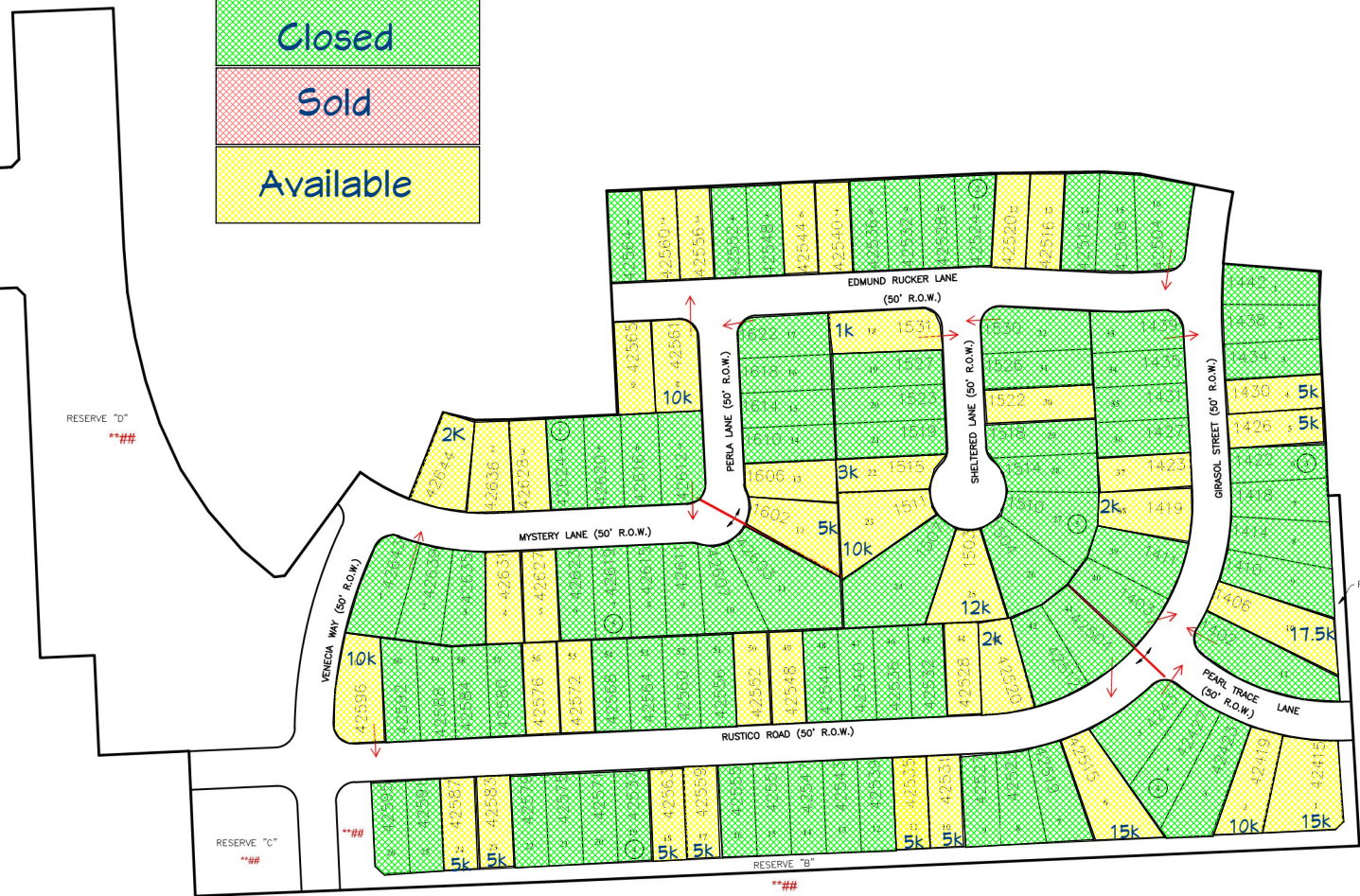
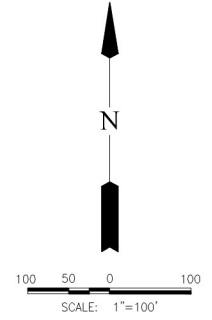

*** These reserves will be addressed as utilities are needed at specific locations.

Approved: TD
 Submit this address plat to the engineer's office for review within 30 days of the date below.
09/18/2023 11:28
MCECD - 911
MAGNOLIA, 77354

**ADDRESS MAP OF
 ESCONDIDO
 SECTION 5**

A SUBDIVISION OF 29.234 ACRES OF LAND SITUATED IN THE J. PIERPONT SURVEY, ABSTRACT 426, MONTGOMERY COUNTY, TEXAS.

123 LOTS 4 RESERVES (6.081 ACRES) 5 BLOCKS
 MARCH 27, 2023 JOB NO. 2139-3105P.310

OWNERS:
MAGNOLIA ESCONDIDO, LLC.
 A TEXAS LIMITED LIABILITY COMPANY
J. ALAN KENT, GENERAL MANAGER
 6046 FM 2920, SUITE 512, SPRING, TEXAS 77379

SURVEYOR:
LJA Surveying, Inc.
 3600 W. Sam Houston Parkway S. Phone 713.953.5200
 Suite 175 Fax 713.953.5026
 Houston, Texas 77042 T.B.P.E.L.S. Firm No. 10194382

ENGINEER:
LJA Engineering, Inc.
 3600 W. Sam Houston Parkway S. Phone 713.953.5200
 Suite 600 Fax 713.953.5026
 Houston, Texas 77042 FRN - F-1386

Date/Time : Mon, 27 Mar 2023 4:11 PM
 Path/Name : N:\Program\Working\426\1\Map\PEARL\Escondido Section 5.dwg
 CAD: ALEXIS.S
 MUAJ: CHECK: SUR: