



Existing 07:00am



Proposed 07:00am

March 21st (GMT)



Existing 08:00am



Proposed 08:00am

Sources: Point2Surveyors
 Scan data (received 13/08/18)
 Woodlands and Masters.rcp
 Site Photos (received 20/08/18)
 GRID ARCHITECTS
 Proposed Info (received 10/08/21)

Key:	<ul style="list-style-type: none"> Grey shadows are those caused by buildings which are not on the site under development. Green shadows are those caused specifically by the existing buildings on the site. Blue shadows are those caused specifically by the proposed development.
------	--

Project: Woodlands and Masters House, London

Title: Transient Overshadowing

Scheme Confirmed: -

Date: -

Drawn By: EVJ

Scale: NTS

Date: AUG 21

Dwg No: P1870/MAR01/01

Rel: 30





Existing 09:00am



Proposed 09:00am

March 21st (GMT)

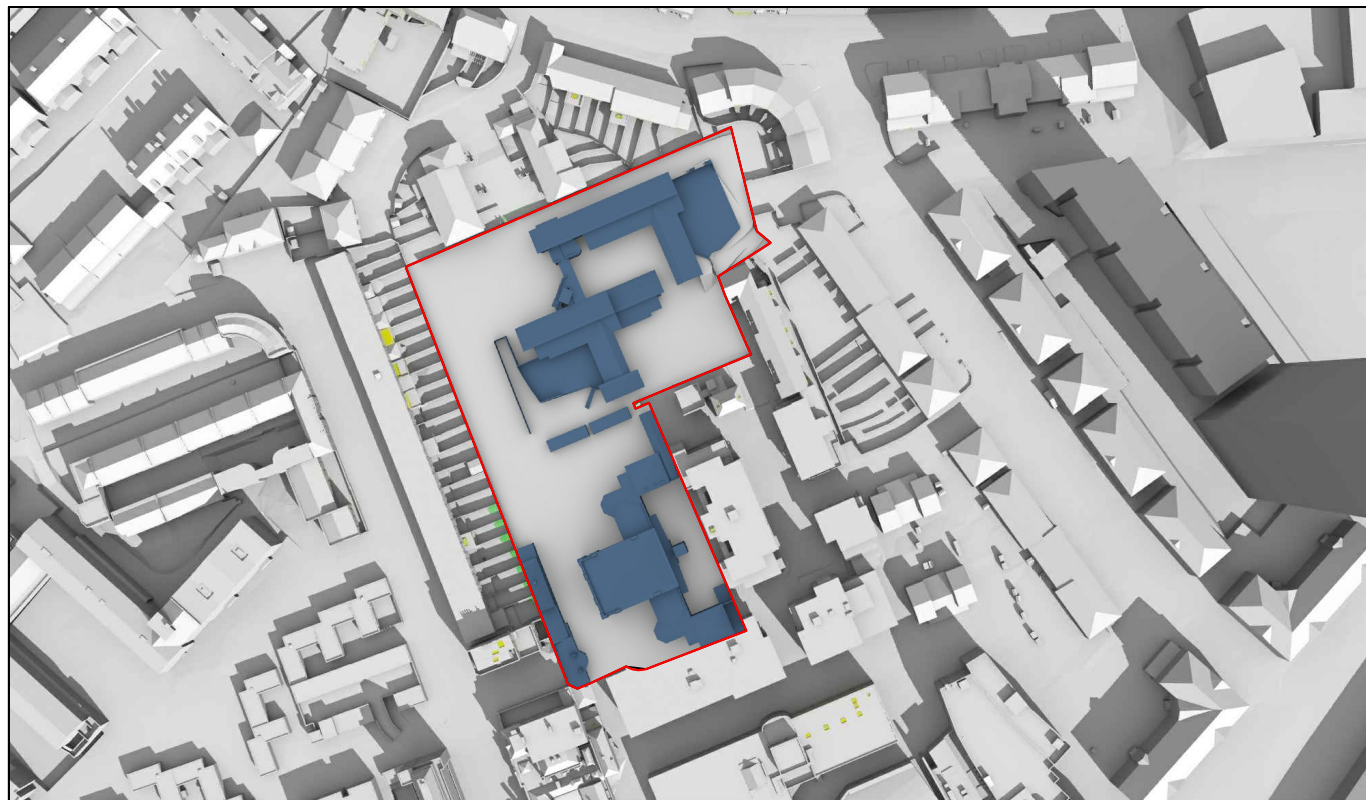

Existing 10:00am



Proposed 10:00am

Sources: Point2Surveyors
 Scan data (received 13/08/18)
 Woodlands and Masters.rcp
 Site Photos (received 20/08/18)
 GRID ARCHITECTS
 Proposed Info (received 10/08/21)

Key:

- Grey shadows are those caused by buildings which are not on the site under development.
- Green shadows are those caused specifically by the existing buildings on the site.
- Blue shadows are those caused specifically by the proposed development.

Project: Woodlands and Masters House, London

Title: Transient Overshadowing

Scheme Confirmed:

Date:

Drawn By:
EVJ

Scale:
NTS

Date:
AUG 21

Dwg No:
P1870/MAR01/02

Rel:
30



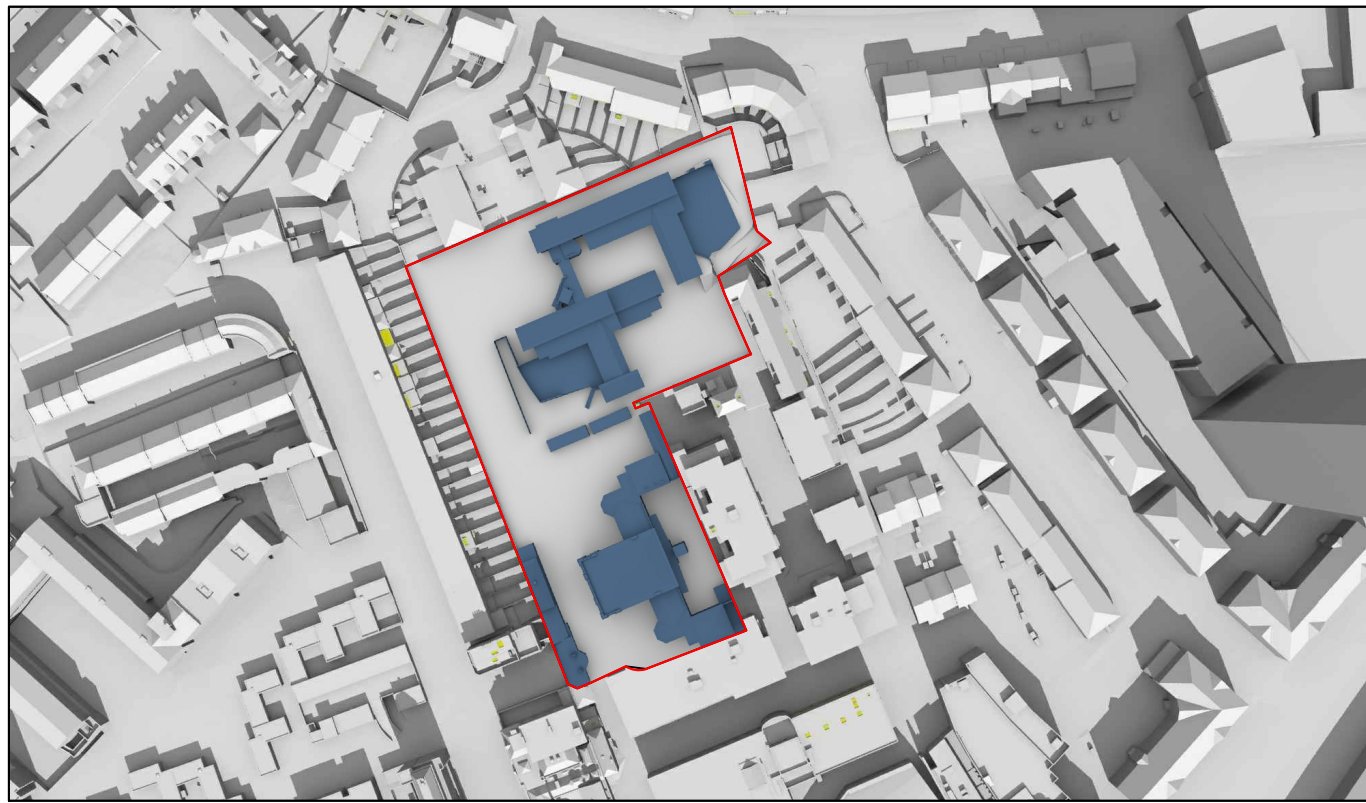

Existing 11:00am



Proposed 11:00am

March 21st (GMT)

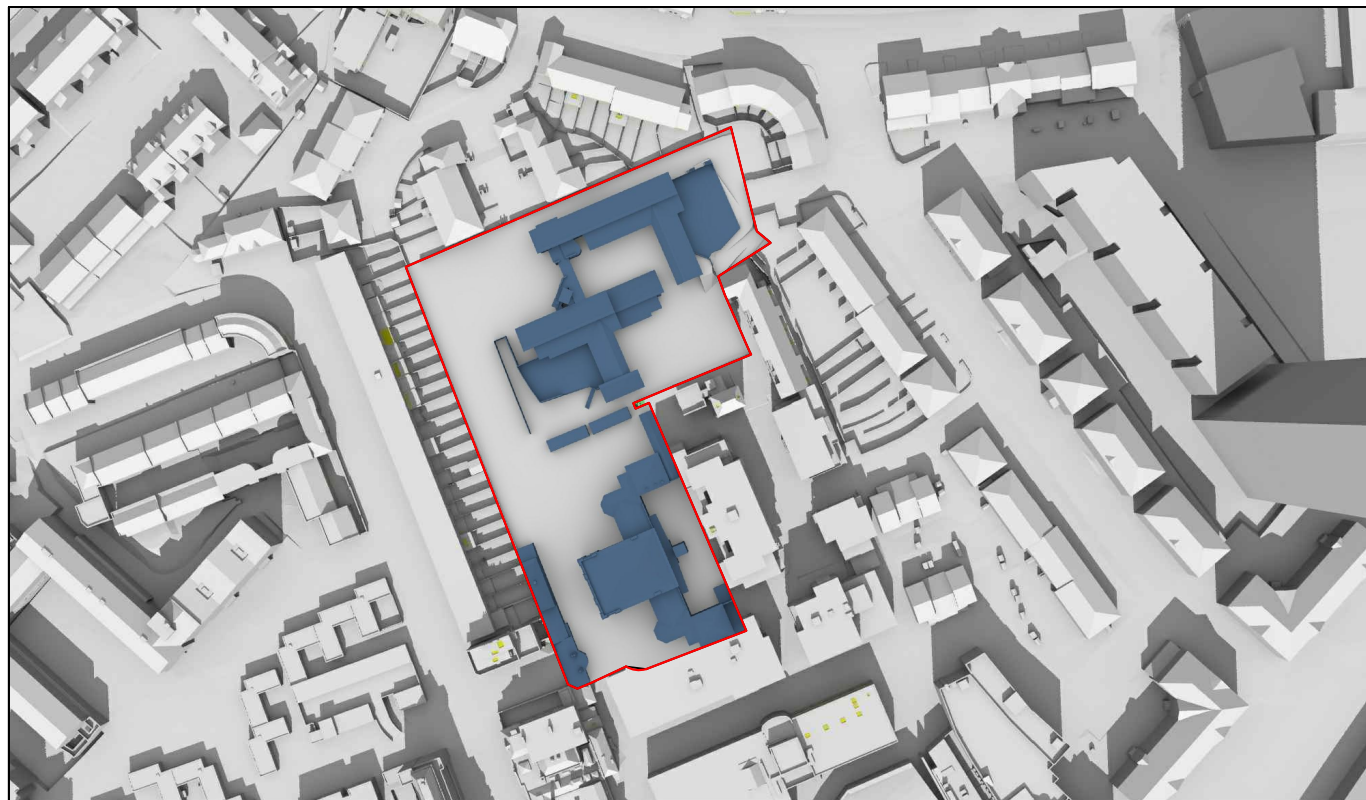

Existing 12:00pm

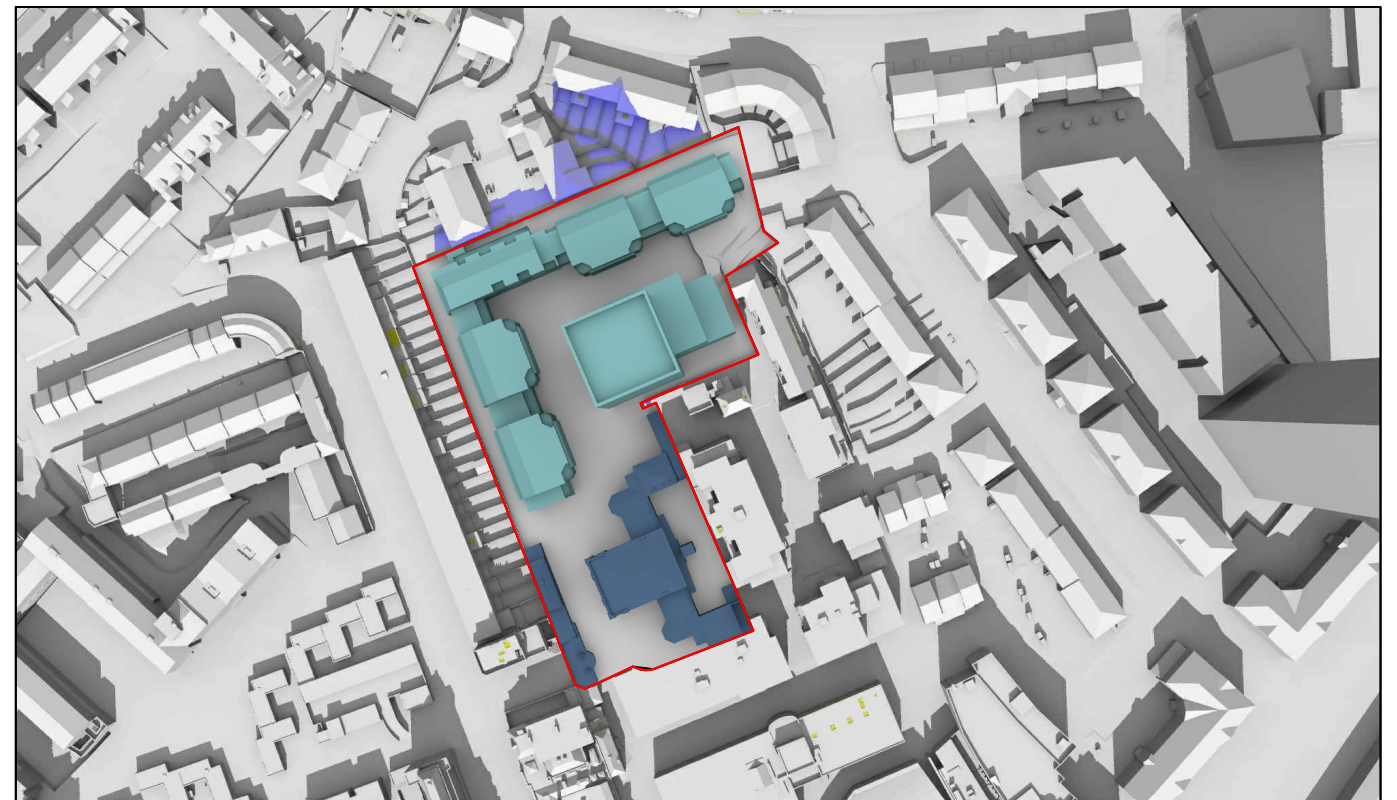

Proposed 12:00pm

Sources: Point2Surveyors
 Scan data (received 13/08/18)
 Woodlands and Masters.rcp
 Site Photos (received 20/08/18)
 GRID ARCHITECTS
 Proposed Info (received 10/08/21)

Key:

- Grey shadows are those caused by buildings which are not on the site under development.
- Green shadows are those caused specifically by the existing buildings on the site.
- Blue shadows are those caused specifically by the proposed development.

Project: Woodlands and Masters House, London

Title: Transient Overshadowing

Scheme Confirmed: -

Date: -

Drawn By: EVJ

Scale: NTS

Date: AUG 21

Dwg No: P1870/MAR01/03

Rel: 30



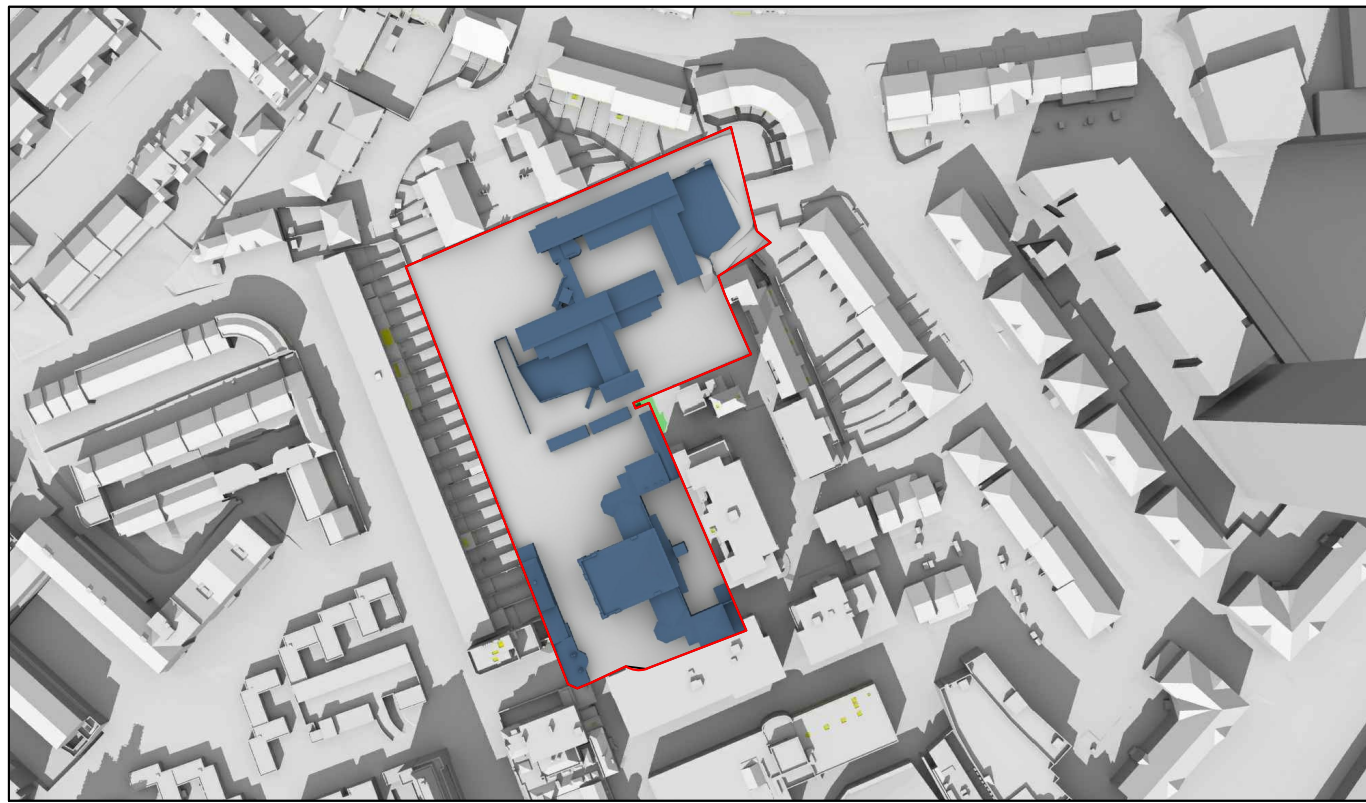

Existing 01:00pm

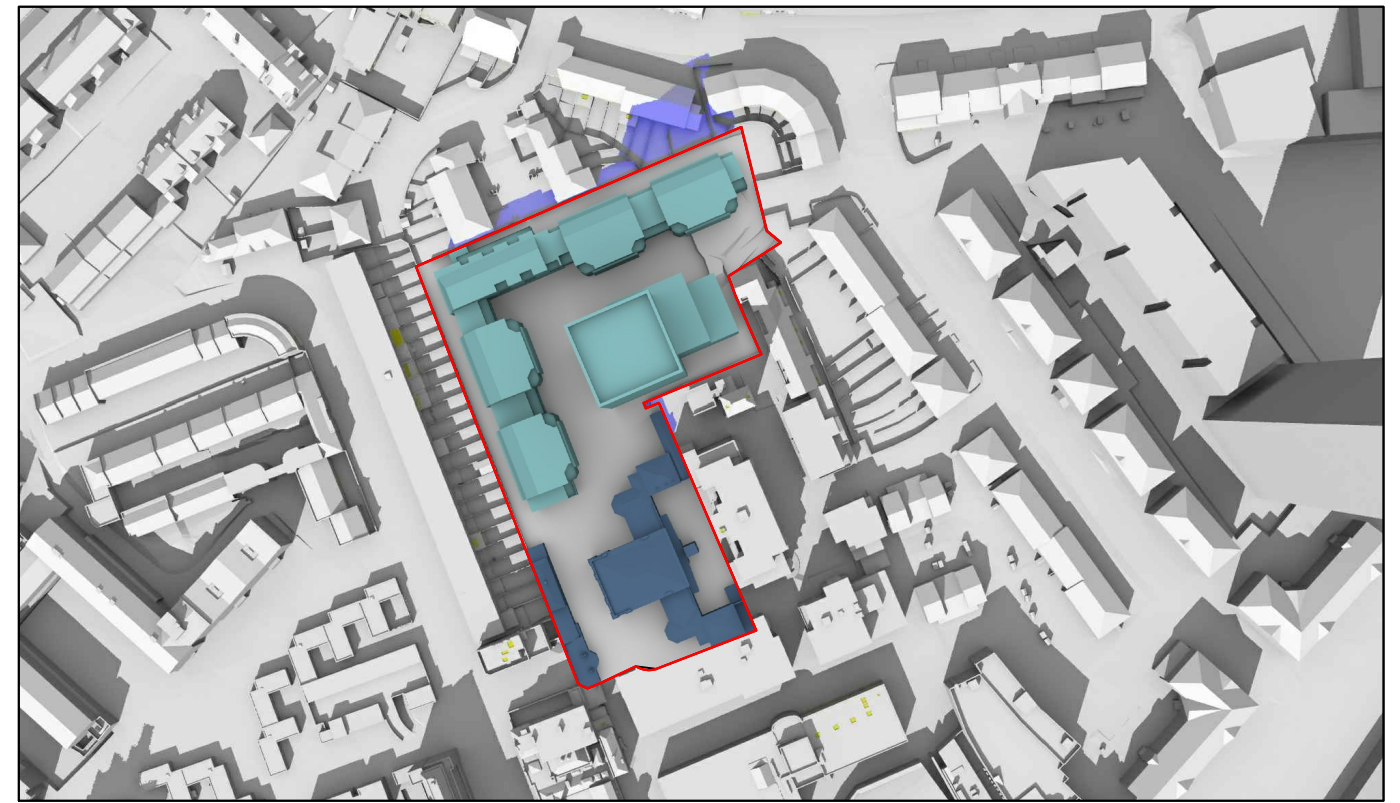

Proposed 01:00pm

March 21st (GMT)

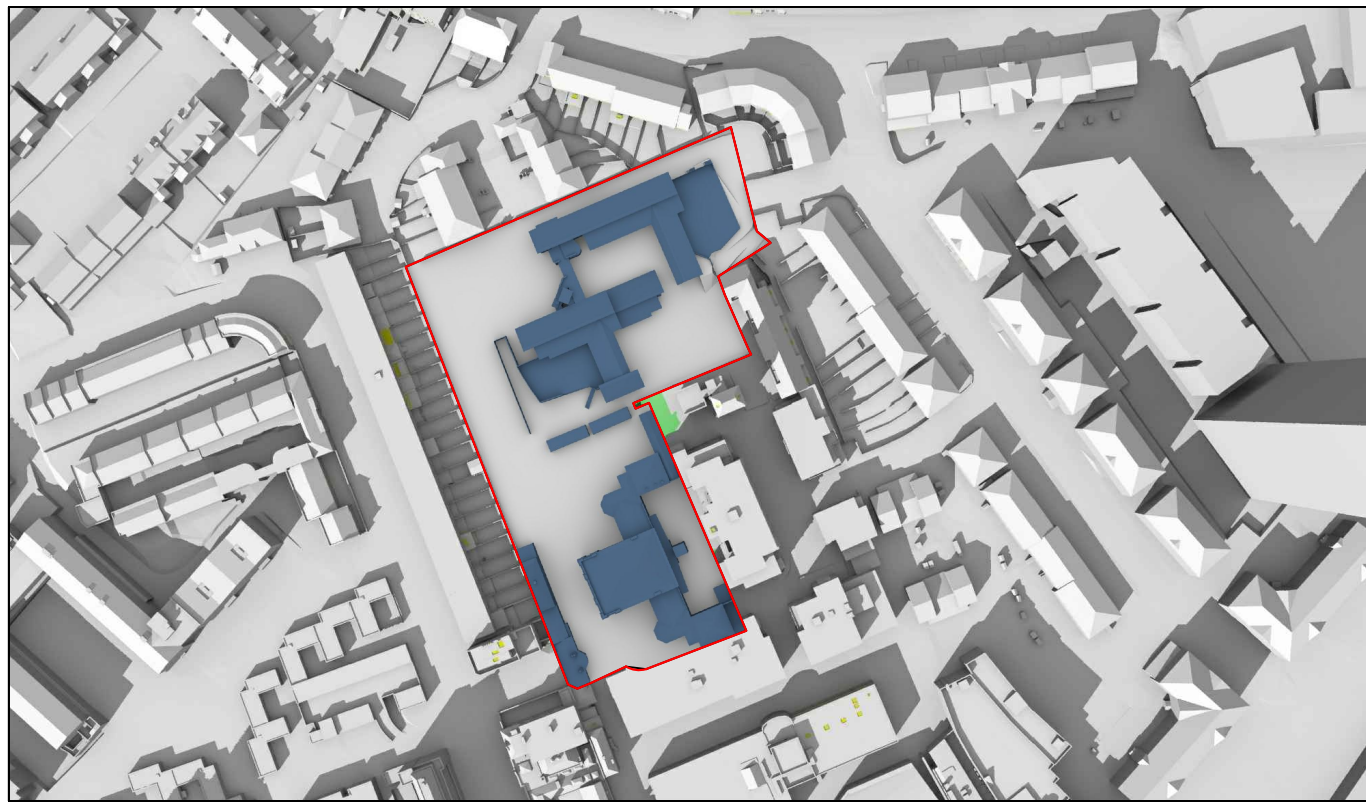

Existing 02:00pm

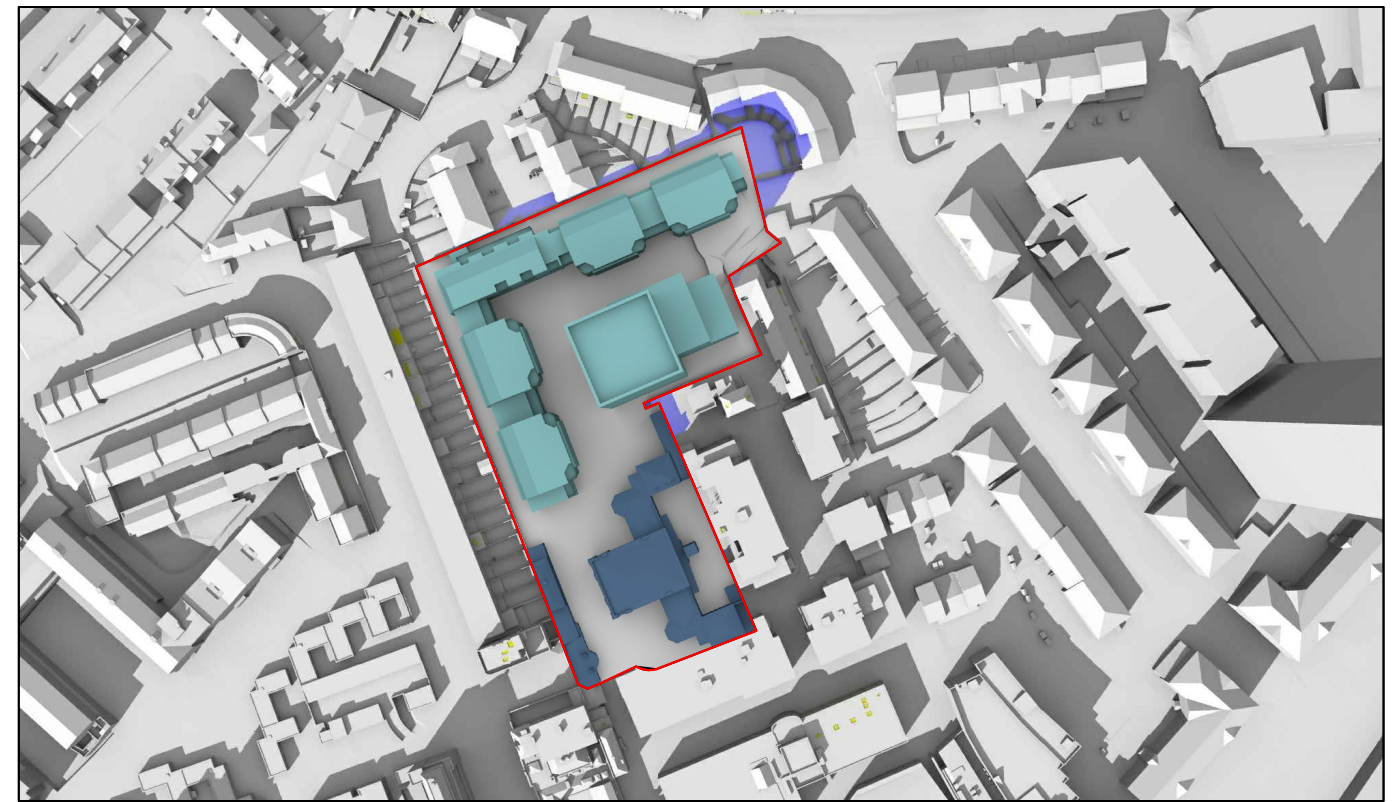

Proposed 02:00pm

Sources: Point2Surveyors
 Scan data (received 13/08/18)
 Woodlands and Masters.rcp
 Site Photos (received 20/08/18)
 GRID ARCHITECTS
 Proposed Info (received 10/08/21)

Key:	<ul style="list-style-type: none"> Grey shadows are those caused by buildings which are not on the site under development. Green shadows are those caused specifically by the existing buildings on the site. Blue shadows are those caused specifically by the proposed development.
------	--

Project: Woodlands and Masters House, London

Title: Transient Overshadowing

Scheme Confirmed: -

Date: -

Drawn By: EVJ

Scale: NTS

Date: AUG 21

Dwg No: P1870/MAR01/04

Rel: 30



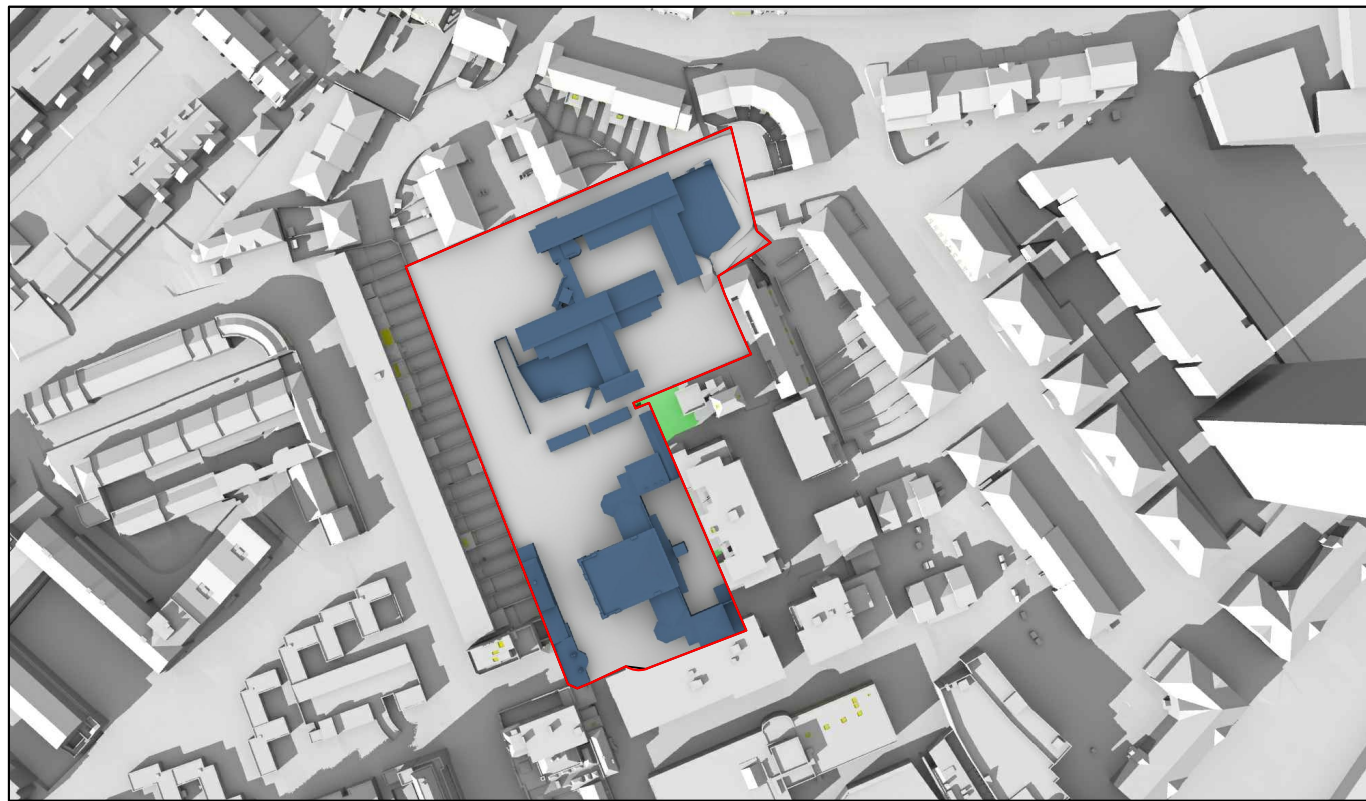

Existing 03:00pm

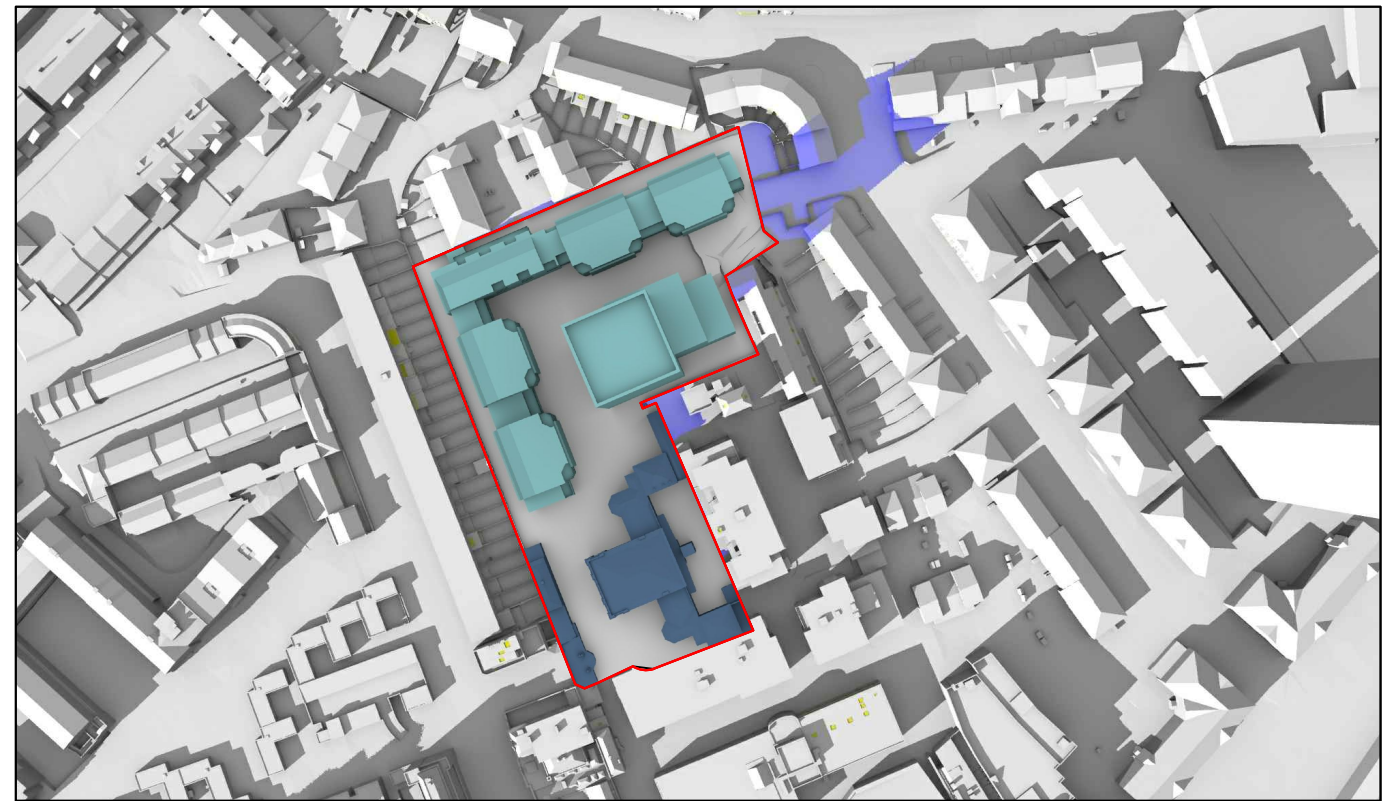

Proposed 03:00pm

March 21st (GMT)



Existing 04:00pm

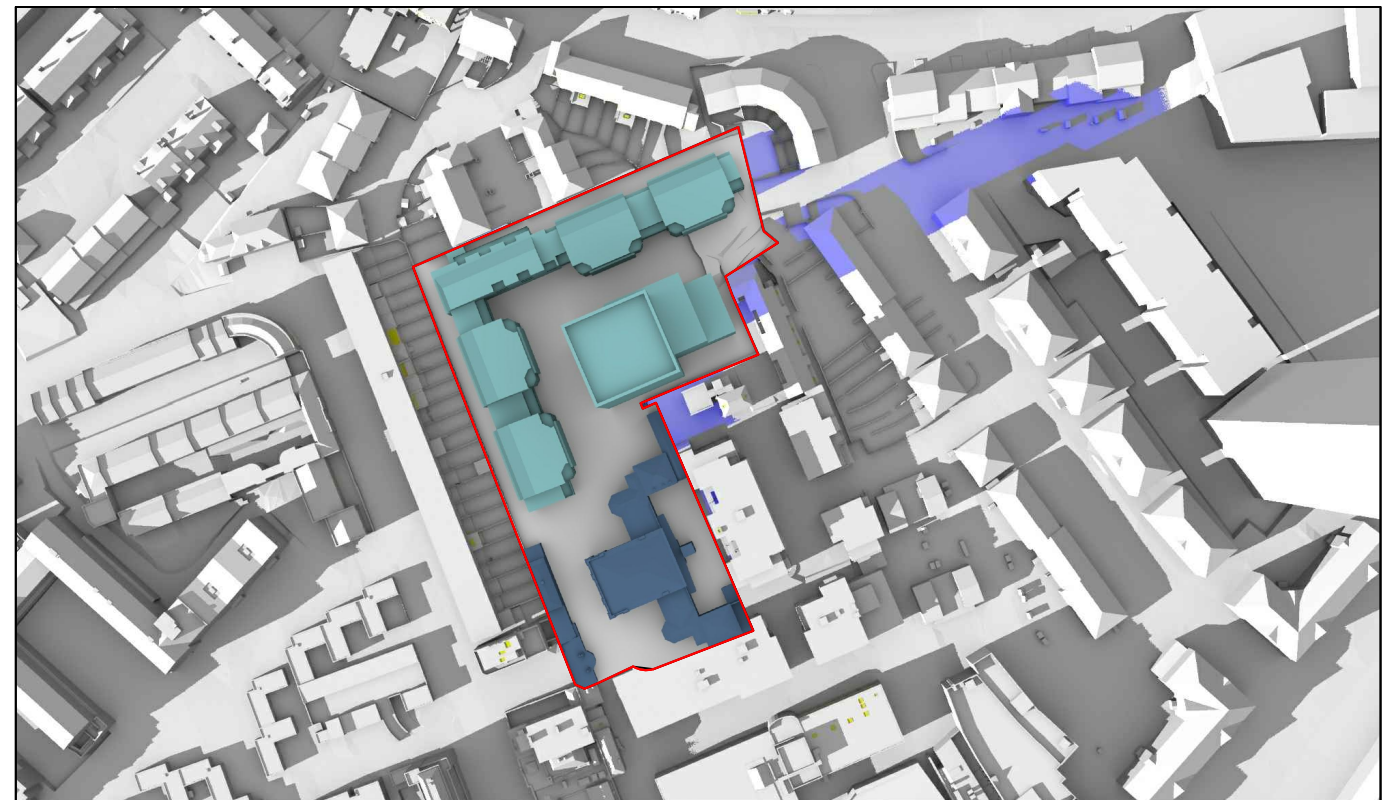

Proposed 04:00pm

Sources: Point2Surveyors
Scan data (received 13/08/18)
Woodlands and Masters.rcp

Site Photos (received 20/08/18)

GRID ARCHITECTS
Proposed Info (received 10/08/21)

Key:	<ul style="list-style-type: none"> Grey shadows are those caused by buildings which are not on the site under development. Green shadows are those caused specifically by the existing buildings on the site. Blue shadows are those caused specifically by the proposed development.
------	--

Project: Woodlands and Masters House, London

Title: Transient Overshadowing

Scheme Confirmed: -

Date: -

Drawn By: EVJ

Scale: NTS

Date: AUG 21

Dwg No: P1870/MAR01/05

Rel: 30



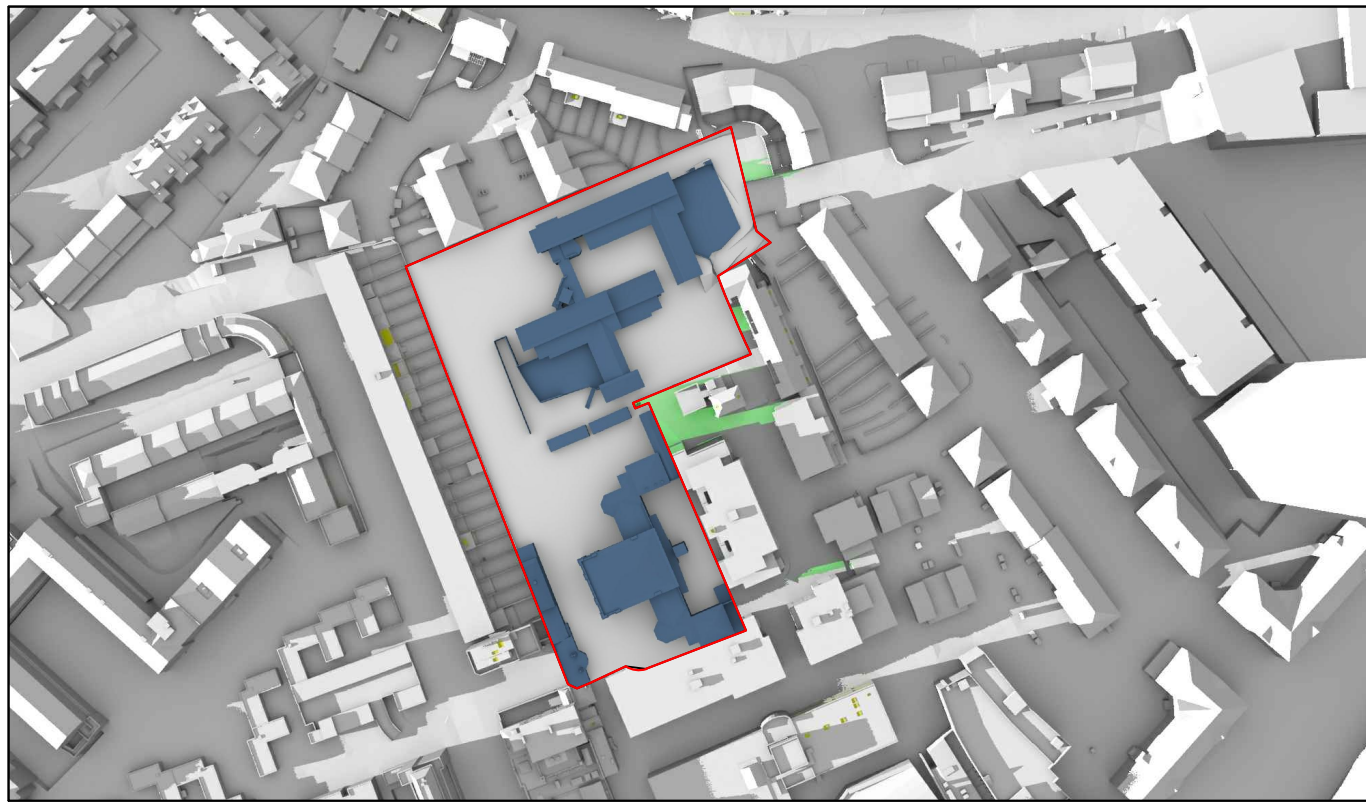

Existing 05:00pm



Proposed 05:00pm

March 21st (GMT)



Existing 06:00pm

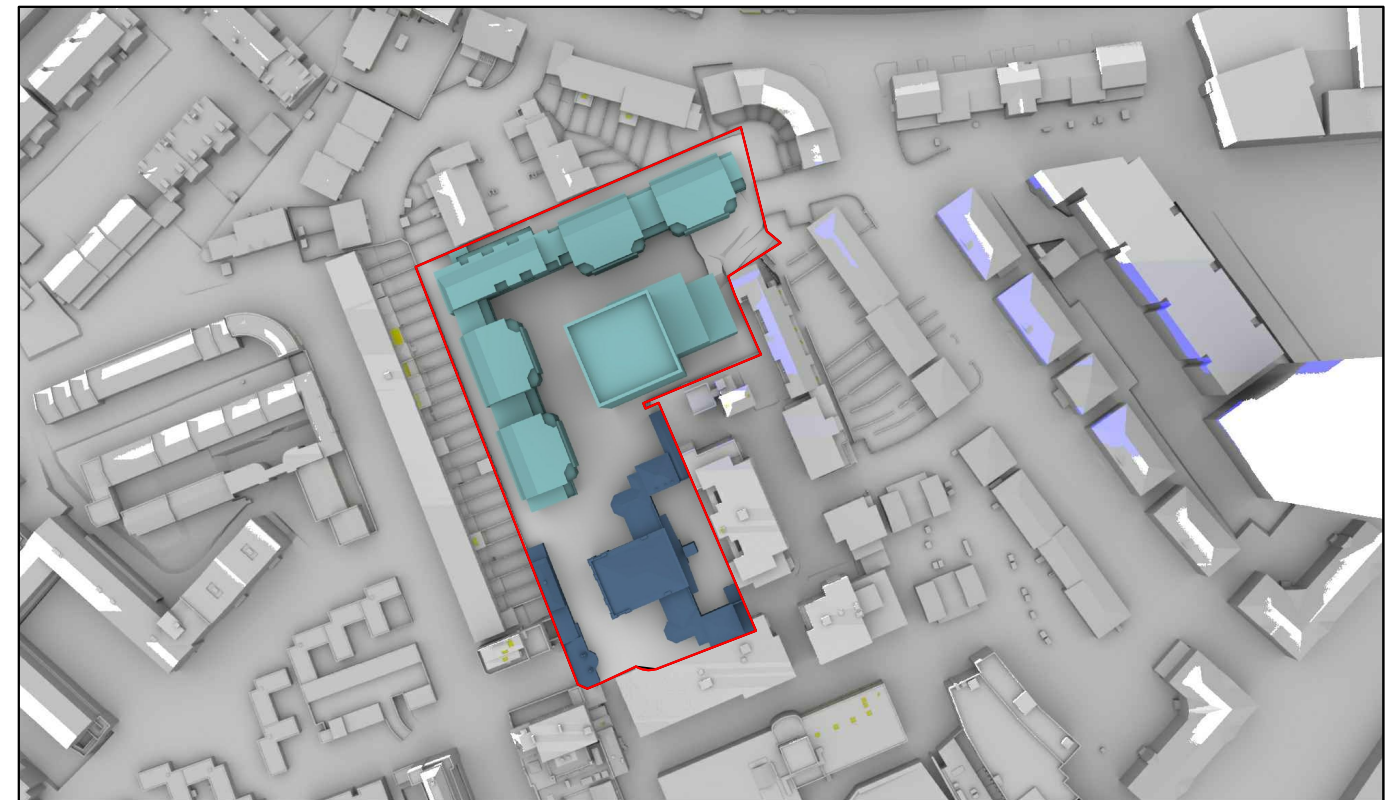

Proposed 06:00pm

Sources: Point2Surveyors
 Scan data (received 13/08/18)
 Woodlands and Masters.rcp
 Site Photos (received 20/08/18)
 GRID ARCHITECTS
 Proposed Info (received 10/08/21)

Key:	<ul style="list-style-type: none"> Grey shadows are those caused by buildings which are not on the site under development. Green shadows are those caused specifically by the existing buildings on the site. Blue shadows are those caused specifically by the proposed development.
------	--

Project:	Woodlands and Masters House, London
----------	-------------------------------------

Title:	Transient Overshadowing
--------	-------------------------

Scheme Confirmed:	-
-------------------	---

Date:	-
-------	---

Drawn By:	EVJ
-----------	-----

Scale:	NTS
--------	-----

Date:	AUG 21
-------	--------

Dwg No:	P1870/MAR01/06
---------	-----------------------

Rel:	30
------	-----------

