



Existing 06:00am



Proposed 06:00am

June 21st (BST)



Existing 07:00am



Proposed 07:00am

Sources: Point2Surveyors
 Scan data (received 13/08/18)
 Woodlands and Masters.rcp
 Site Photos (received 20/08/18)
 GRID ARCHITECTS
 Proposed Info (received 10/08/21)

Key:

- Grey shadows are those caused by buildings which are not on the site under development.
- Green shadows are those caused specifically by the existing buildings on the site.
- Blue shadows are those caused specifically by the proposed development.

Project: Woodlands and Masters House, London

Title: Transient Overshadowing

Scheme Confirmed:

Date:

Drawn By:
EVJ

Scale:
NTS

Date:
AUG 21

Dwg No:
P1870/JUN01/01

Rel:
30



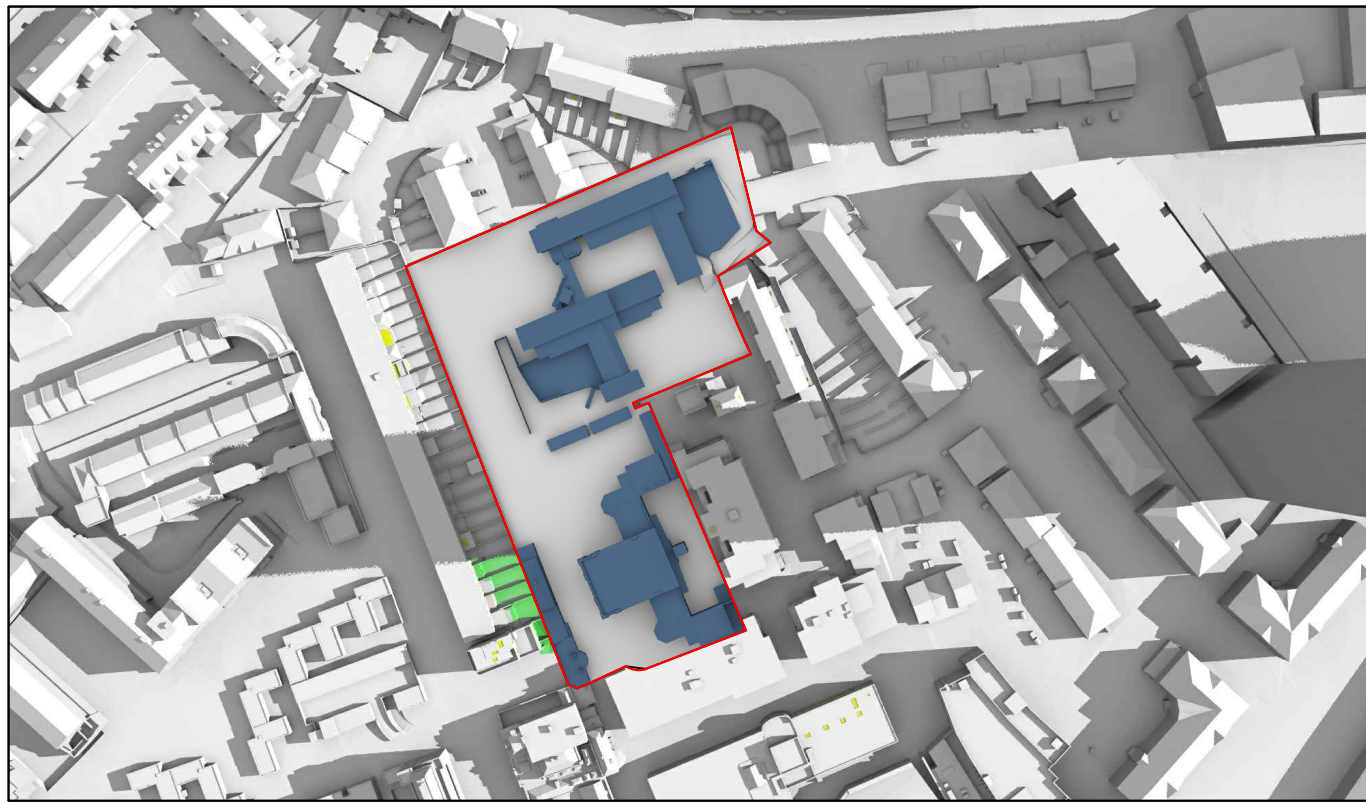

Existing 08:00am



Proposed 08:00am

June 21st (BST)



Existing 09:00am



Proposed 09:00am

Sources: Point2Surveyors
Scan data (received 13/08/18)
Woodlands and Masters.rcp

Site Photos (received 20/08/18)

GRID ARCHITECTS
Proposed Info (received 10/08/21)

Key:

- Grey shadows are those caused by buildings which are not on the site under development.
- Green shadows are those caused specifically by the existing buildings on the site.
- Blue shadows are those caused specifically by the proposed development.

Project: Woodlands and Masters House, London

Title: Transient Overshadowing

Scheme Confirmed:

Date:

Drawn By:
EVJ

Scale:
NTS

Date:
AUG 21

Dwg No:
P1870/JUN01/02

Rel:
30





Existing 10:00am



Proposed 10:00am

June 21st (BST)



Existing 11:00am



Proposed 11:00am

Sources: Point2Surveyors
Scan data (received 13/08/18)
Woodlands and Masters.rcp

Site Photos (received 20/08/18)

GRID ARCHITECTS
Proposed Info (received 10/08/21)

Key:

- Grey shadows are those caused by buildings which are not on the site under development.
- Green shadows are those caused specifically by the existing buildings on the site.
- Blue shadows are those caused specifically by the proposed development.

Project: Woodlands and Masters House, London

Title: Transient Overshadowing

Scheme Confirmed:

Date:

Drawn By:
EVJ

Scale:
NTS

Date:
AUG 21

Dwg No:
P1870/JUN01/03

Rel:
30





Existing 12:00pm



Proposed 12:00pm

June 21st (BST)



Existing 01:00pm



Proposed 01:00pm

Sources: Point2Surveyors
 Scan data (received 13/08/18)
 Woodlands and Masters.rcp
 Site Photos (received 20/08/18)
 GRID ARCHITECTS
 Proposed Info (received 10/08/21)

Key:

- Grey shadows are those caused by buildings which are not on the site under development.
- Green shadows are those caused specifically by the existing buildings on the site.
- Blue shadows are those caused specifically by the proposed development.

Project: Woodlands and Masters House, London

Title: Transient Overshadowing

Scheme Confirmed:

Date:

Drawn By:
EVJ

Scale:
NTS

Date:
AUG 21

Dwg No:
P1870/JUN01/04

Rel:
30





Existing 02:00pm

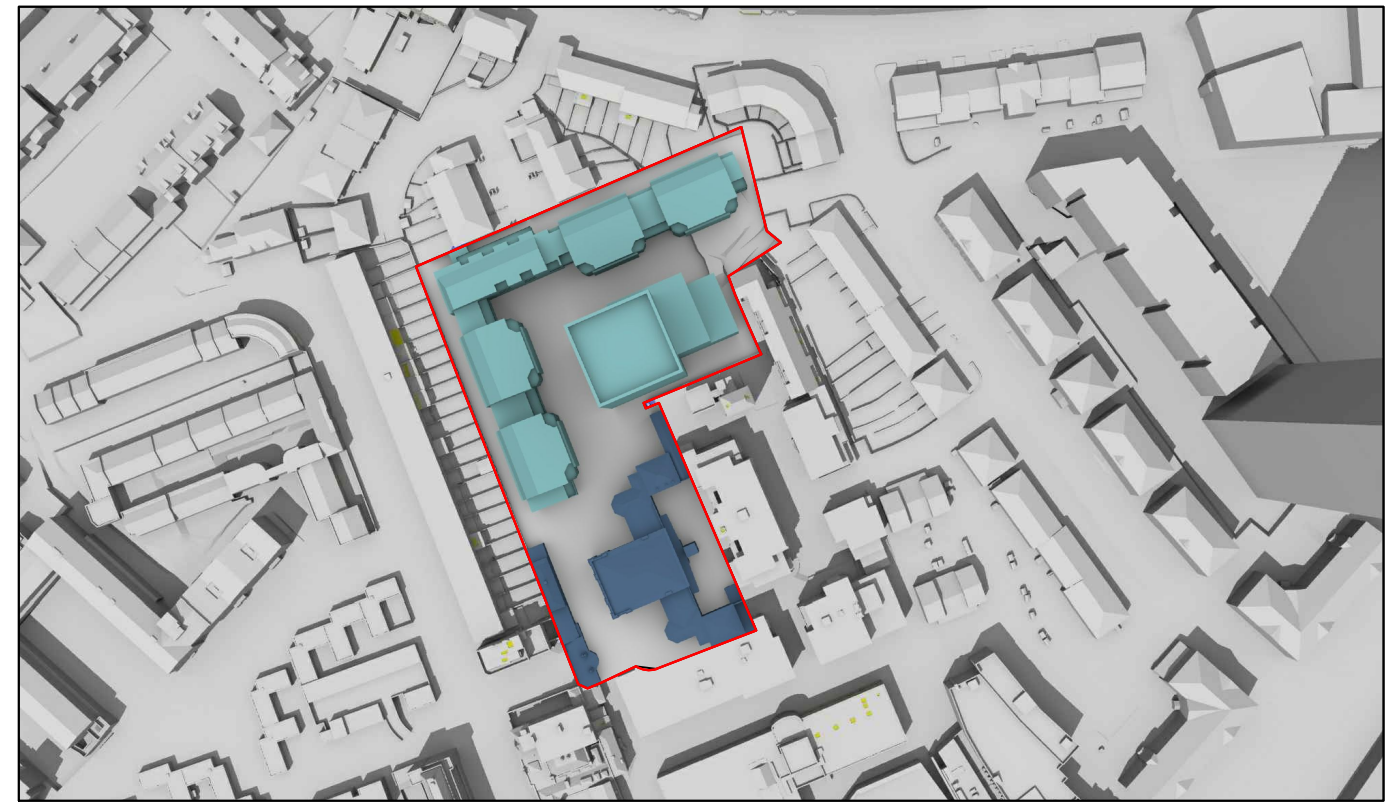

Proposed 02:00pm

June 21st (BST)



Existing 03:00pm

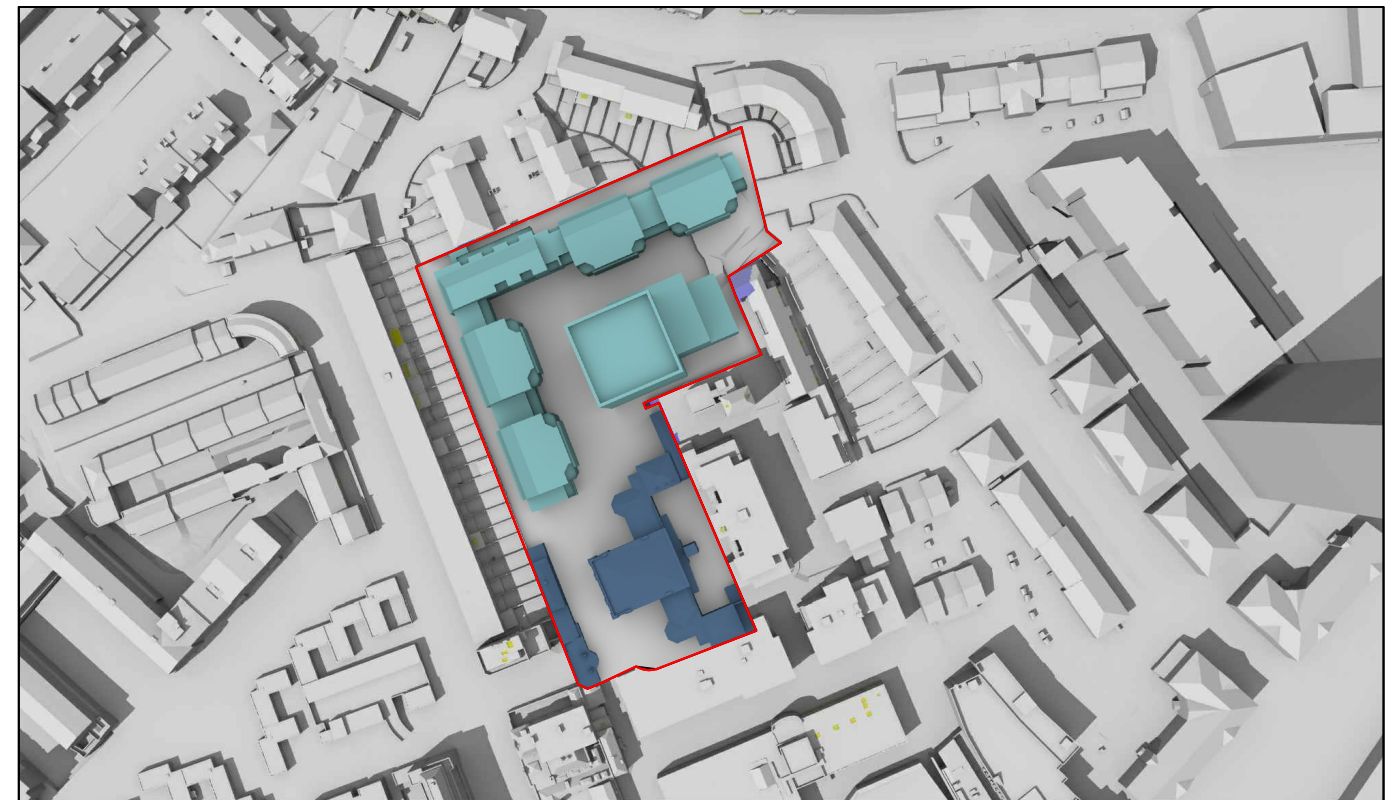

Proposed 03:00pm

Sources: Point2Surveyors
 Scan data (received 13/08/18)
 Woodlands and Masters.rcp
 Site Photos (received 20/08/18)
 GRID ARCHITECTS
 Proposed Info (received 10/08/21)

Key:

- Grey shadows are those caused by buildings which are not on the site under development.
- Green shadows are those caused specifically by the existing buildings on the site.
- Blue shadows are those caused specifically by the proposed development.

Project: Woodlands and Masters House, London

Title: Transient Overshadowing

Scheme Confirmed:

Date:

Drawn By:
EVJ

Scale:
NTS

Date:
AUG 21

Dwg No:
P1870/JUN01/05

Rel:
30





Existing 04:00pm



Proposed 04:00pm

June 21st (BST)



Existing 05:00pm



Proposed 05:00pm

Sources: Point2Surveyors
Scan data (received 13/08/18)
Woodlands and Masters.rcp

Site Photos (received 20/08/18)

GRID ARCHITECTS
Proposed Info (received 10/08/21)

Key:

- Grey shadows are those caused by buildings which are not on the site under development.
- Green shadows are those caused specifically by the existing buildings on the site.
- Blue shadows are those caused specifically by the proposed development.

Project: Woodlands and Masters House, London

Title: Transient Overshadowing

Scheme Confirmed:

Date:

Drawn By:
EVJ

Scale:
NTS

Date:
AUG 21

Dwg No:
P1870/JUN01/06

Rel:
30





Existing 06:00pm

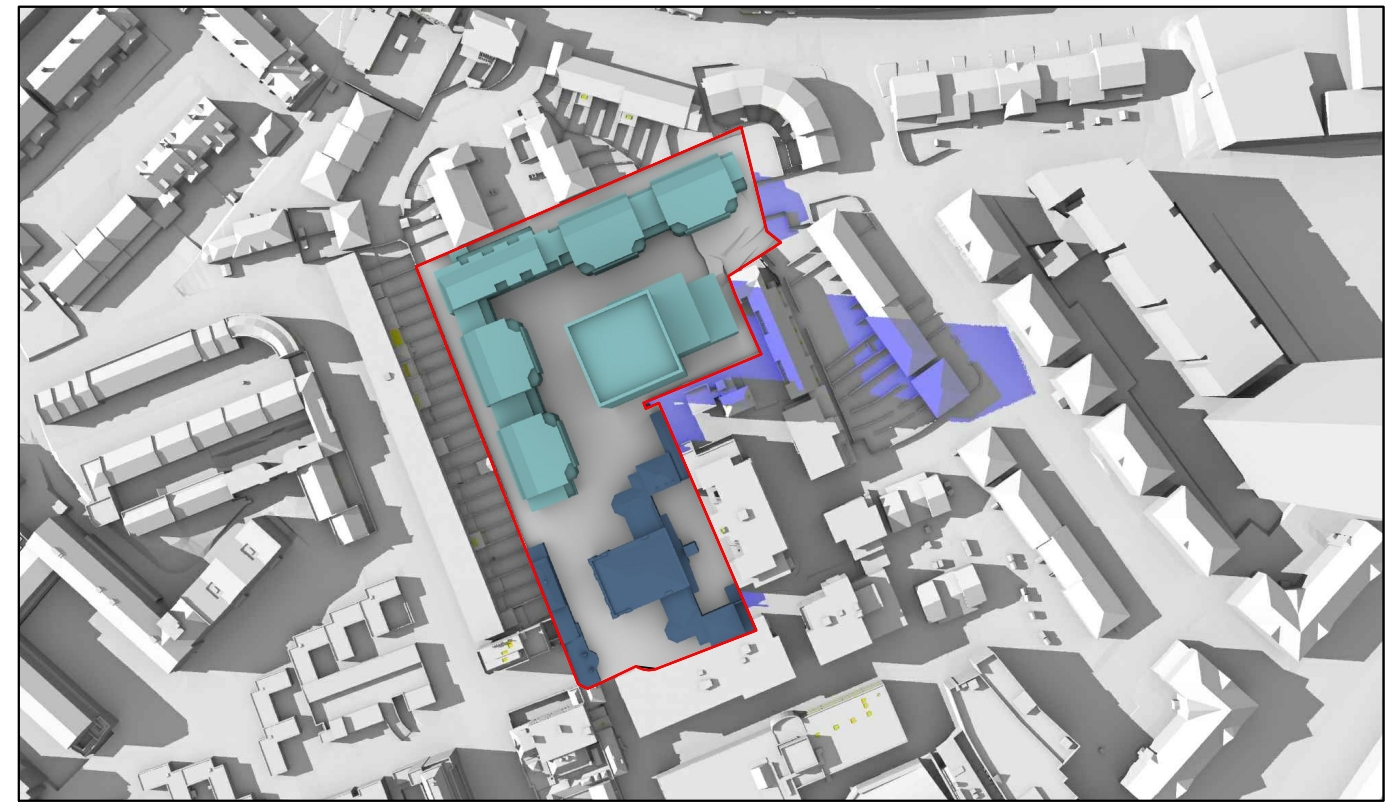

Proposed 06:00pm

June 21st (BST)



Existing 07:00pm



Proposed 07:00pm

Sources: Point2Surveyors
 Scan data (received 13/08/18)
 Woodlands and Masters.rcp
 Site Photos (received 20/08/18)
 GRID ARCHITECTS
 Proposed Info (received 10/08/21)

Key:

- Grey shadows are those caused by buildings which are not on the site under development.
- Green shadows are those caused specifically by the existing buildings on the site.
- Blue shadows are those caused specifically by the proposed development.

Project: Woodlands and Masters House, London

Title: Transient Overshadowing

Scheme Confirmed: -

Date: -

Drawn By: EVJ

Scale: NTS

Date: AUG 21

Dwg No: P1870/JUN01/07

Rel: 30





Existing 08:00pm



Proposed 08:00pm

June 21st (BST)

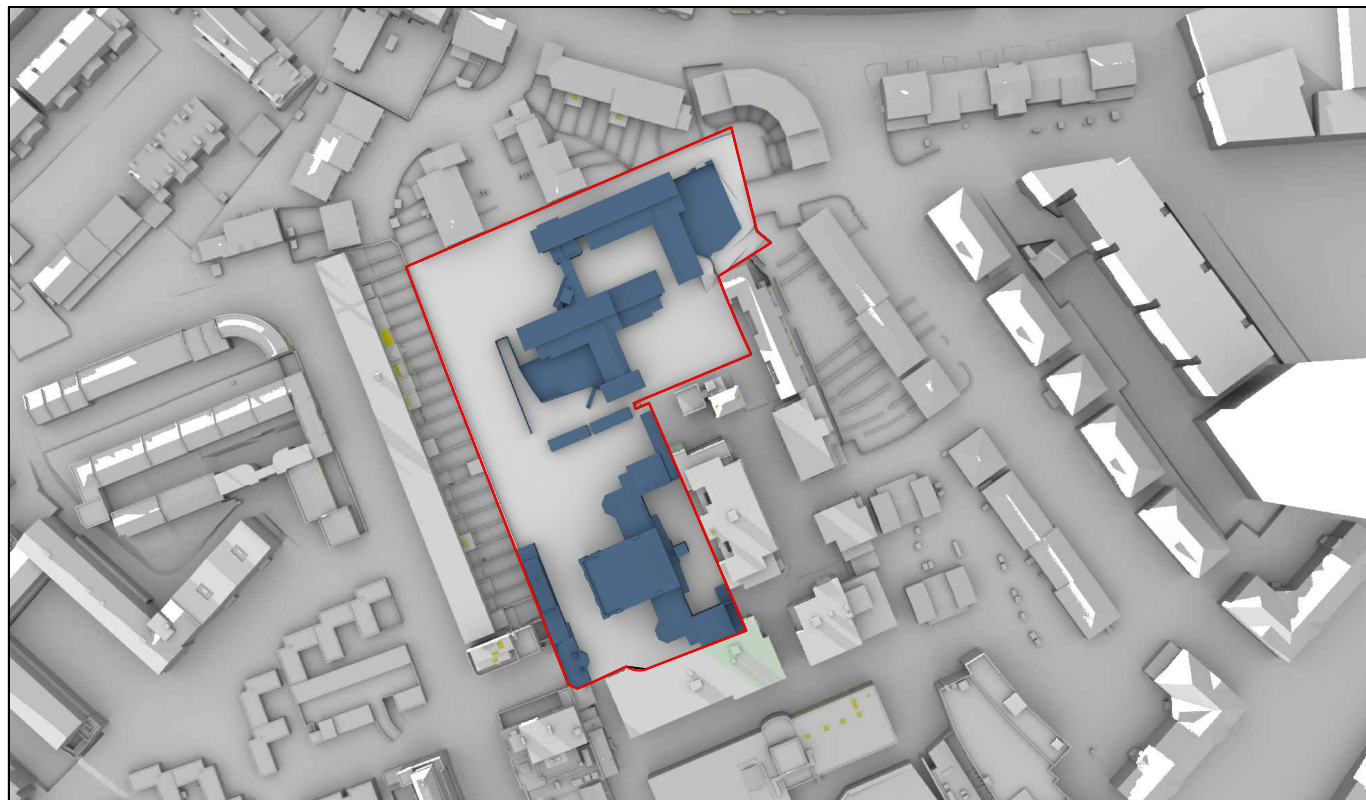

Existing 09:00pm

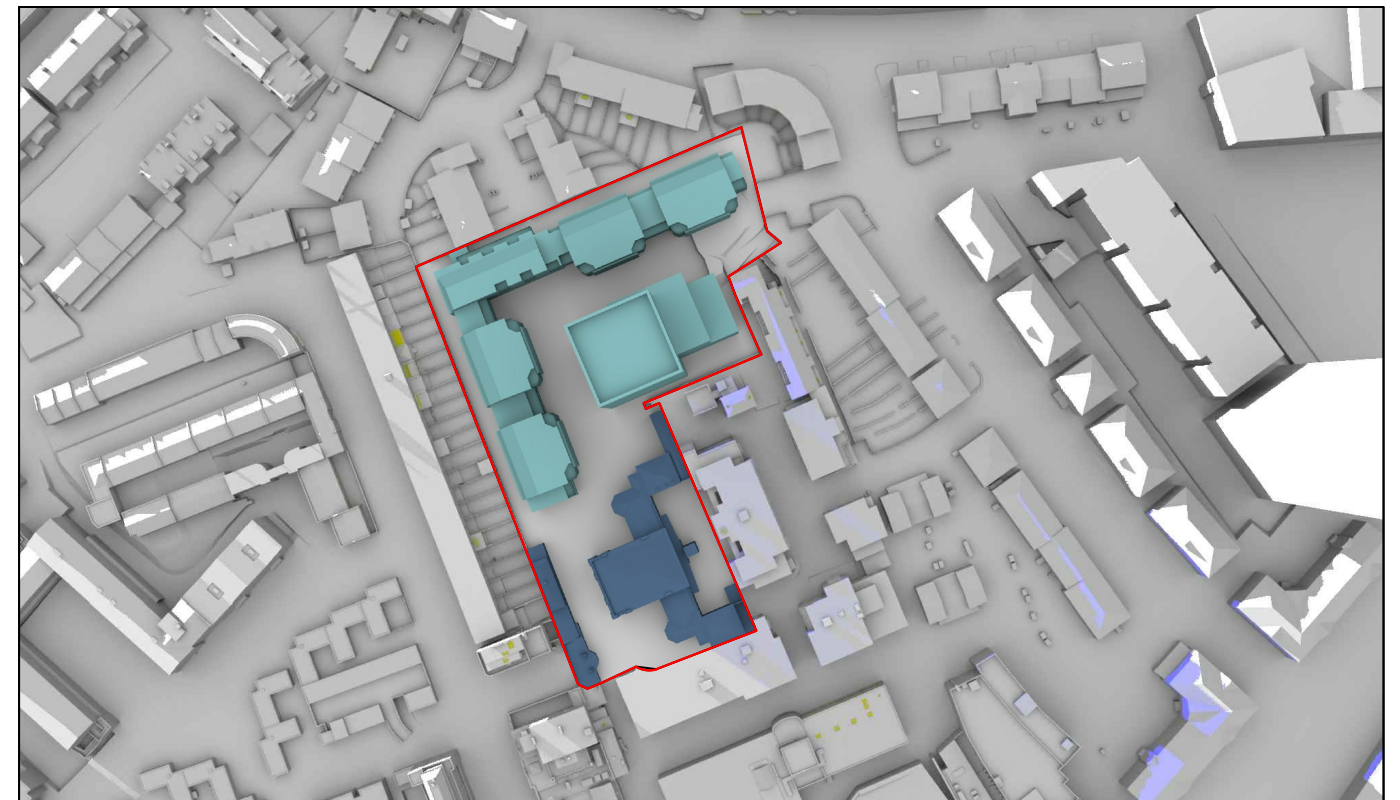

Proposed 09:00pm

Sources: Point2Surveyors
 Scan data (received 13/08/18)
 Woodlands and Masters.rcp
 Site Photos (received 20/08/18)
 GRID ARCHITECTS
 Proposed Info (received 05/08/21)

Key:

- Grey shadows are those caused by buildings which are not on the site under development.
- Green shadows are those caused specifically by the existing buildings on the site.
- Blue shadows are those caused specifically by the proposed development.

Project: Woodlands and Masters House, London

Title: Transient Overshadowing

Scheme Confirmed: -

Date: -

Drawn By: EVJ

Scale: NTS

Date: AUG 21

Dwg No: P1870/JUN01/08

Rel: 29

