

Appendix 3 – BRE Compliant Envelope A3 size
September 2020

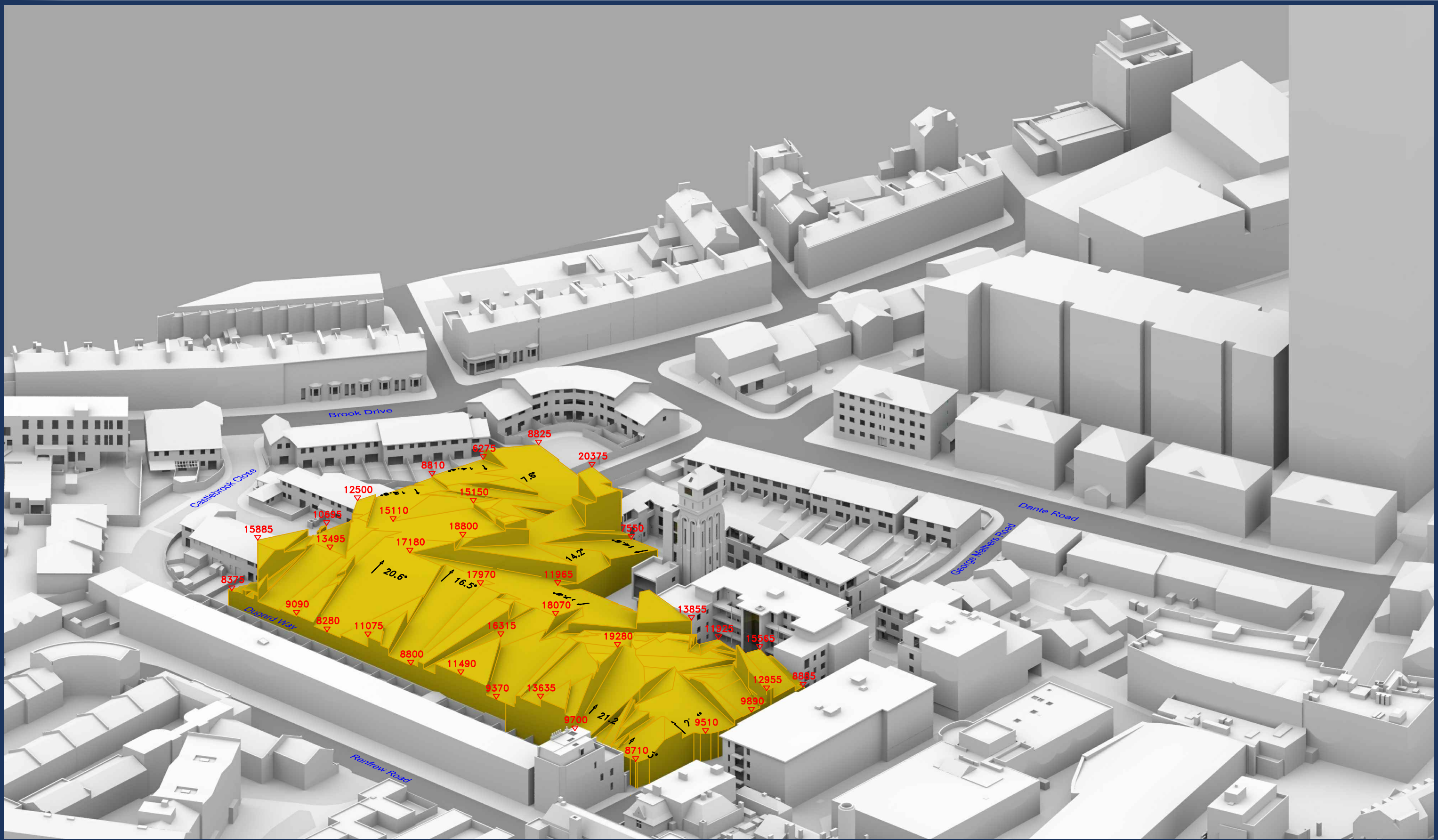

Sources: Point2Surveyors
 Scan data (received 13/08/18)
 Woodlands and Masters.rcp

Site Photos (received 20/08/18)

Rolfe Judd
 Proposed Info (received 25/03/19)
 190325-6057-Massing.skp
 Proposed Info (received 08/03/19)
 6057 - Options Appraisal - Option 01A.skp
 Proposed Info (received 28/11/18)
 6057-Geo Located Massing.dwg

Key:

- Existing Buildings
- Proposed Scheme
- Daylight +Sunlight Envelope

Project: Woodlands and Masters House, London

Title: 3D View
 Daylight & Sunlight Envelope

Scheme Confirmed:
 -

Date:
 -

Drawn By:
 BZW

Scale:
 NTS @ A3

Date:
 SEP 20

Dwg No:
P1870/35

Rel:
20





Sources: Point2Surveyors
 Scan data (received 13/08/18)
 Woodlands and Masters.rcp

Site Photos (received 20/08/18)

Rolfe Judd
 Proposed Info (received 25/03/19)
 190325-6057-Massing.skp
 Proposed Info (received 08/03/19)
 6057 - Options Appraisal - Option 01A.skp
 Proposed Info (received 28/11/18)
 6057-Geo Located Massing.dwg

Key:

- Existing Buildings
- Proposed Scheme
- Daylight +Sunlight Envelope

All Heights in mm AOD

Scheme Confirmed:	Date:
-	-

Project: Woodlands and Masters House, London

Drawn By:	Scale:	Date:
BZW	NTS @ A3	SEP 20

Title: 3D View
 Daylight & Sunlight Envelope

Dwg No:	Rel:
P1870/36	20

