

Lands of Reuben Benthall

John Sharp, 27-Jul-2024

From Source 718a, we know that Reuben Benthall inherited a lot of land ($940 - 100 + 205 = 1045$ acres inherited) from his brother John Benthall in about 1766. We can search on Ancestry.com to see what Land Patents were issued to Reuben Benthall to see how they match up with John and Reuben's wills. From [Ancestry.com](https://www.ancestry.com), we see that there are 4 Land Patents issued to 1 or more Reuben Benthalls (I am considering the possibility that there were more than one, but we will see). First we will look at the 16 May 1772 record in Ancestry.com, which consists of 14 pages. The first page is just a picture of the front page of the Patent (figure to the right). We can see that it is Patent No. 024, for 280 acres in Carteret County for Reuben Benthall. It is dated 16 May 1772, and the land location description is "N. E. side of North River."

The second page of the Patent is on the following page, and is the charge by Josiah Martin to have the land Patent surveyed for Reuben Benthall (see top figure on next page). Josiah Martin was a British Army officer, who was the last British governor of North Carolina.

As we look at the directions to the Surveyor-General, we can see the Surveyor-General was directed to admeasure and layout a plantation for Reuben Benthall of 400 hundred acres in Carteret County on the east side of the North River joining the Lines of said Benthall and Deep Creek. It is dated May 16, 1772.

024
No. _____
County Carteret
Name Benthall, Reuben
Acres 280
Grant No. _____
Issued _____
Warrant No. _____ Entry No. 373
Entered 16 May 1772
Book No. _____ Page No. _____
Location N. E. side of North River
Remarks: _____

There are some questions here. The first page of the Patent (figure to the right) says 280 acres and the directions to the Surveyor-General says 400 acres. I am not sure who is correct, but I will depend on what the Surveyor says in the later parts of the Patent.

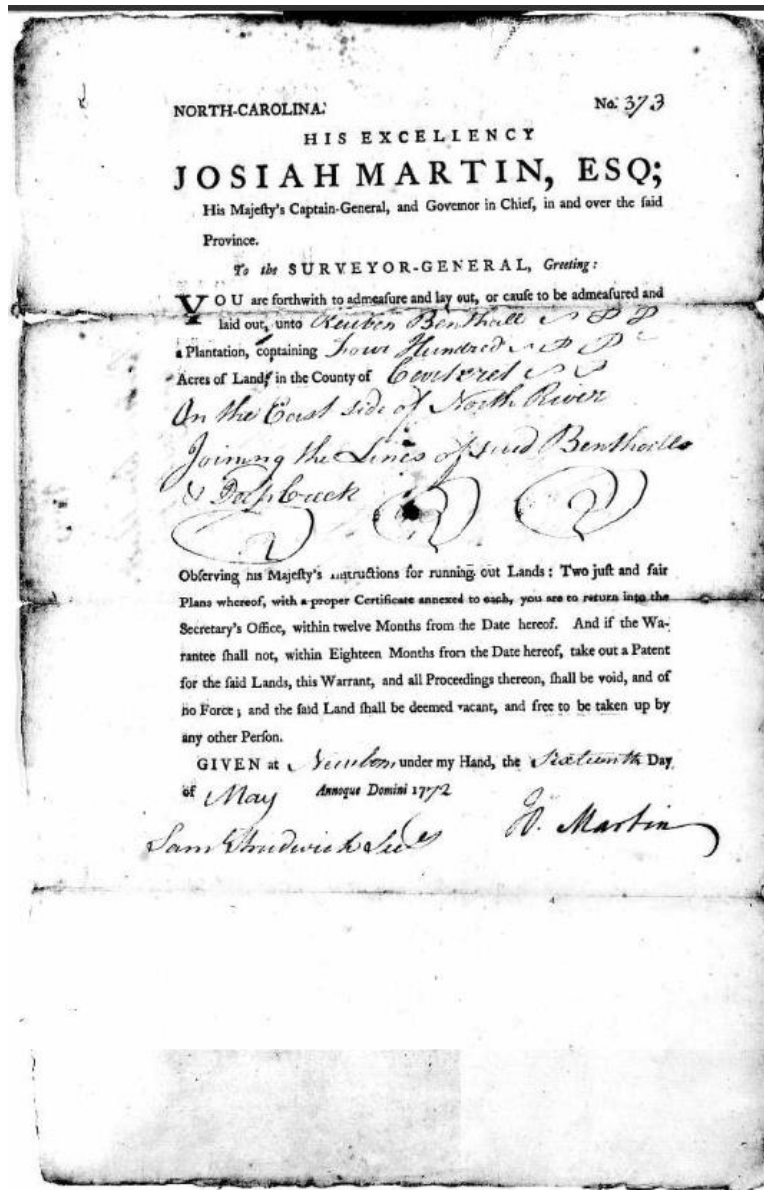

The third page is just the back side of the second page. It just has a few lines of writing on it:

"No. 373 [John Note: this is the Entry number of the Land Patent]
Reuben Benthall
400 Cartret [John Note: he meant "Carteret"]
To John Shepard Senr
W^m Palmer

Aug 8th 1772

Return'd to [July?] Court

1774

W^m Palmer

[DLG?]

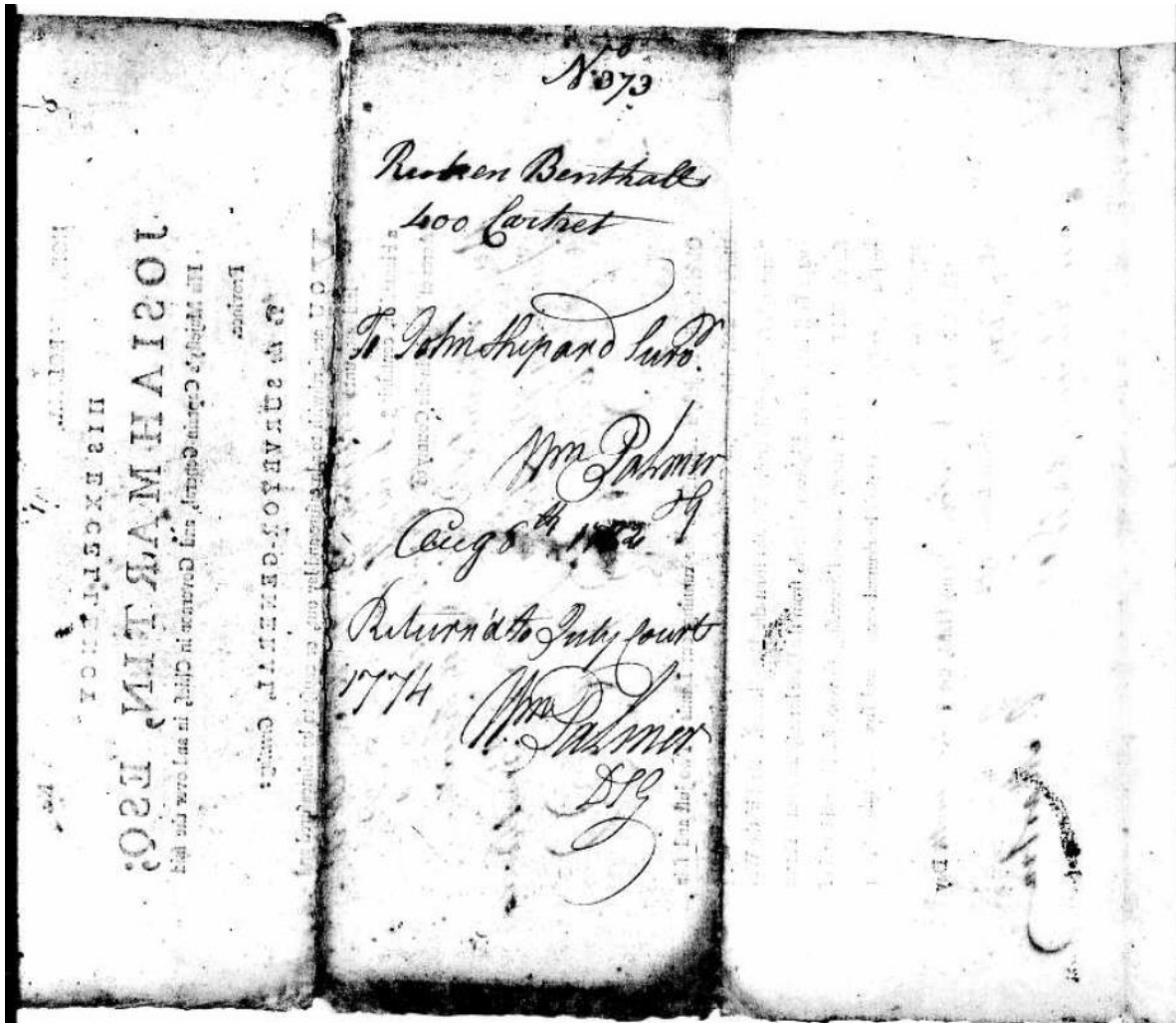

The 4th page is the Surveyor's drawing and description of the survey (see the next page). Here, we see that the Land Patent is for 280 acres according to the Surveyor, not the 400 acres that was in the directions to the Surveyor-General. The description of the survey is:

"Surveyed for Reuben Benthall Two Hundred and Eighty Acres of Land in the County of Carteret on the N^o. E^a. side of N^o. River, Beginning at the mouth of Deep Creek on the River side. Thence turning up s^d ["said"] Deep Creek 266 Poles opposite Joshua Simpson's Corner, thence along his Line S^o. 44 E^a. 136 Poles to a Pine in said Simpsons line [to?] Abel

Lester's Corner, thence along his line $S^{\circ}. 46 W^{\circ}. 100 P^{\circ}$ [poles] to his Co^r a cedar stake in a Marsh thence along his other line $S^{\circ}. 44 E^{\circ}. 184 Poles$ to s^d ["said"] Benthall's & Joshua Simpson's line of their old Land, thence down their old line $S^{\circ}. 75 W^{\circ}. 134 P^{\circ}$ ["poles"] to the River then up with the Various Courses of the River to the first Station. P^r John Shepard, Sen^r

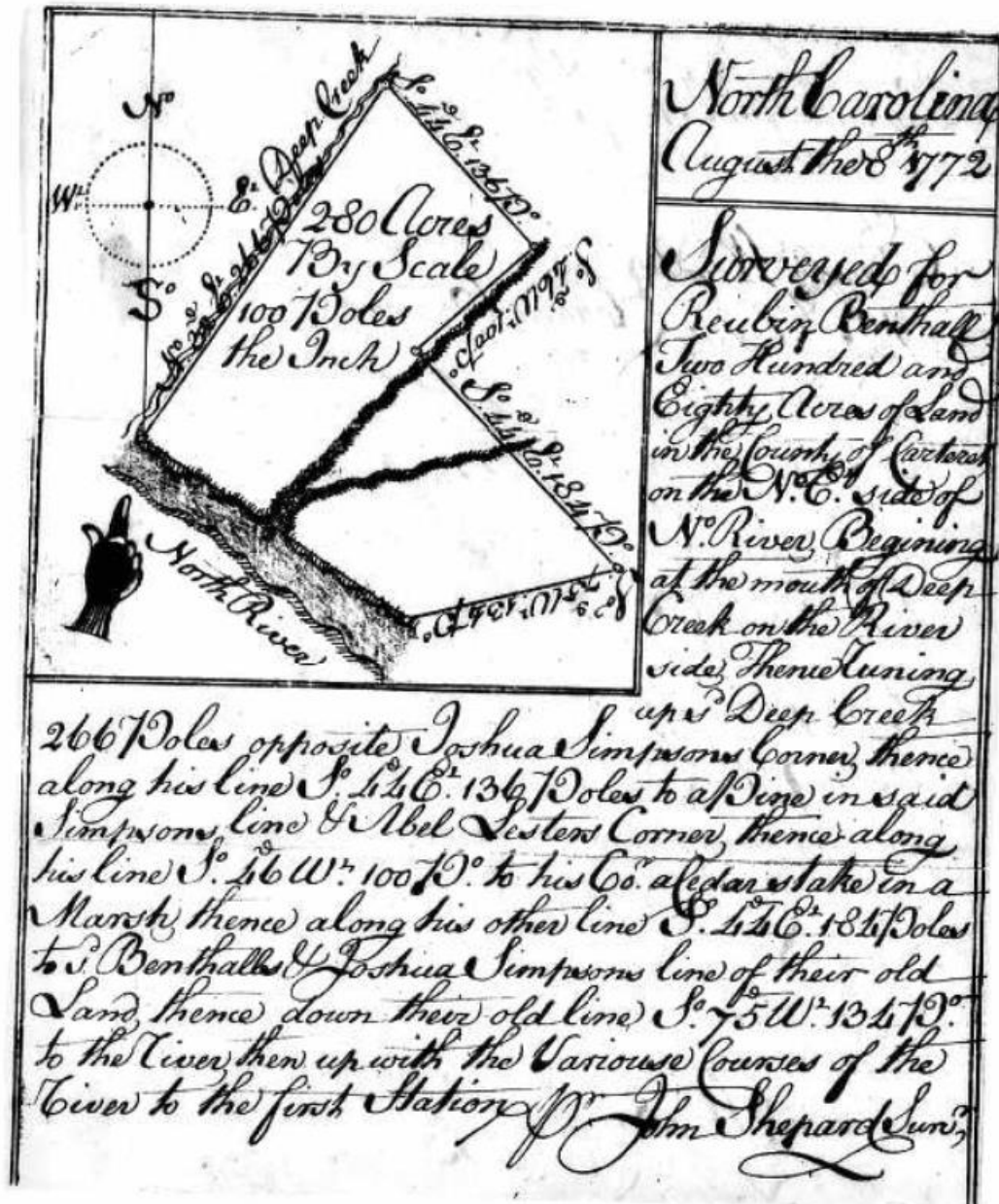

The next page in the Patent is the back side of the Surveyor's drawing and description. It is just the names of the two people who managed the chains during the survey: Enoch Ward and Abel Lester.

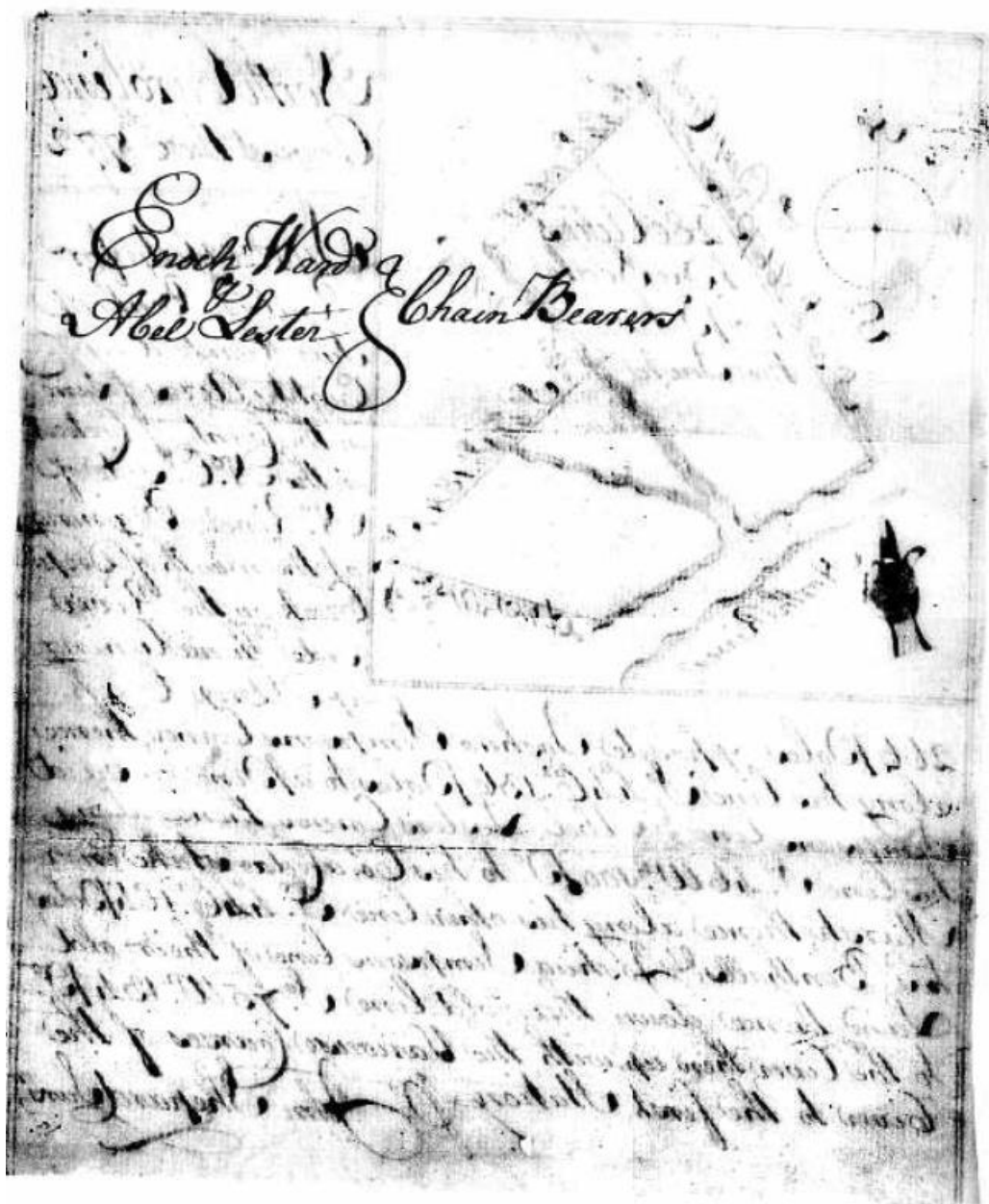

Then there are two more pages that are duplicates of the previous two pages, followed by a description of the survey from the two Chain Bearers – Enoch Ward and Able Lester. It is pretty much word-for-word the description of the Survey in John Shepard's description. I won't repeat it here.

August the 8th 1772 Surveyed for Reubin Benthall
 Eastern on the East side of North River Between his
 own and Joshua Simpson Land & Deep Creek, Begin-
 ing at the mouth of Deep Creek on the River side
 Turning up Deep Creek N. 32 E. 220 Poles
 near Joshua Simpons Land, thence down along by
 his Land S. 35 E. 272 Poles to his own Line thence
 along his own ^{and Joshua Simpson's} line S. 75 W. 160 Poles to N. River thence
 up with the various Courses of the River to the
 first Station
 Crook Ward & Abel Lester & B^y

The next page is a continuation of the Chain Bearer's description of the survey.

We began at Reubin Benthalls ^{upper} Corner ^{a quarter of a mile from} N. 33 W.
 272 Poles to Deep Creek about half a mile from the River

I don't have any idea where this Plantation is located. I can find the North River, but I can't find a Deep Creek. I found a Deep Creek town in NC, but it's a long way from the North River. Here's the North River on Google Maps.

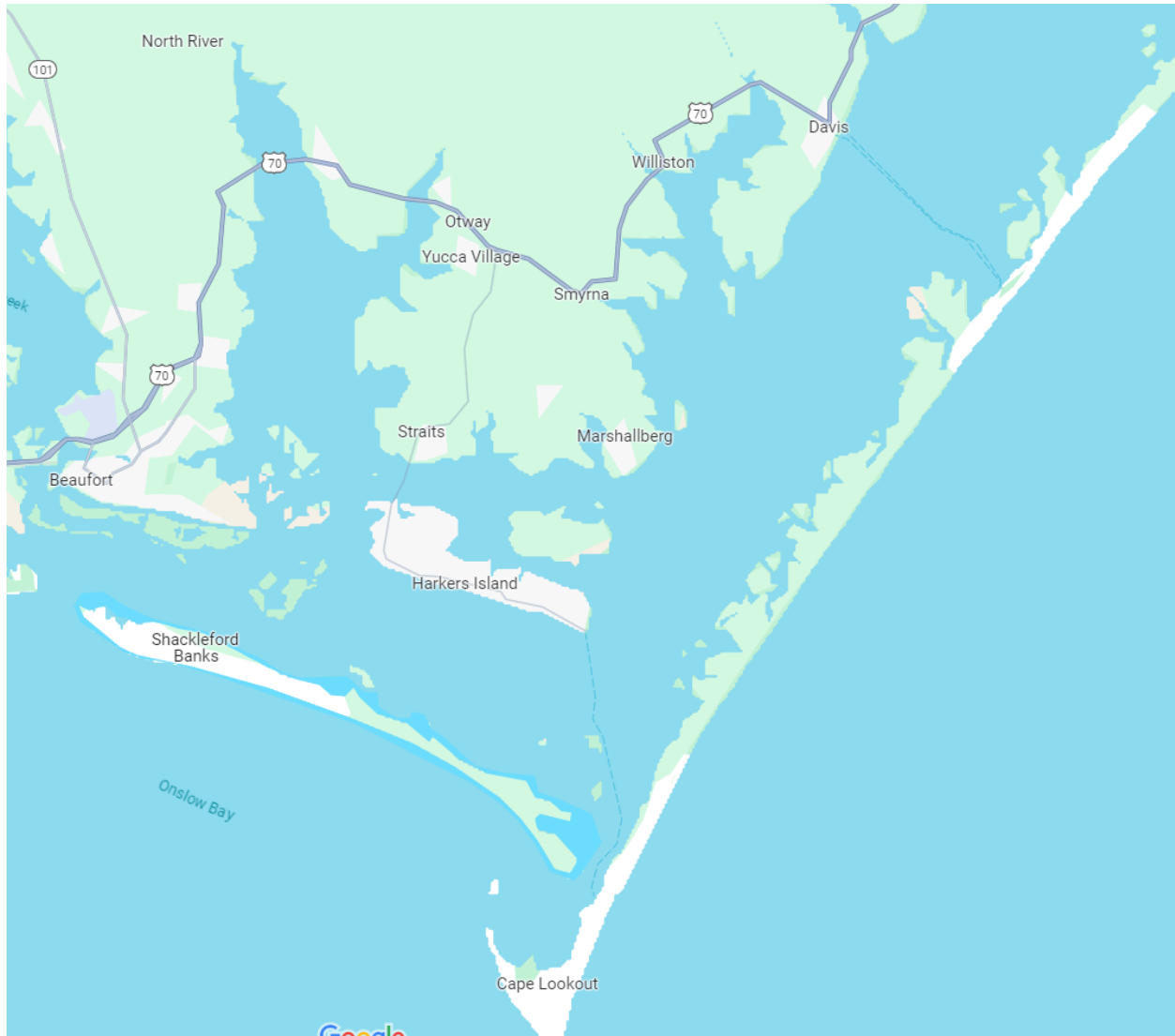

If we zoom in on the north part of North River, we see:

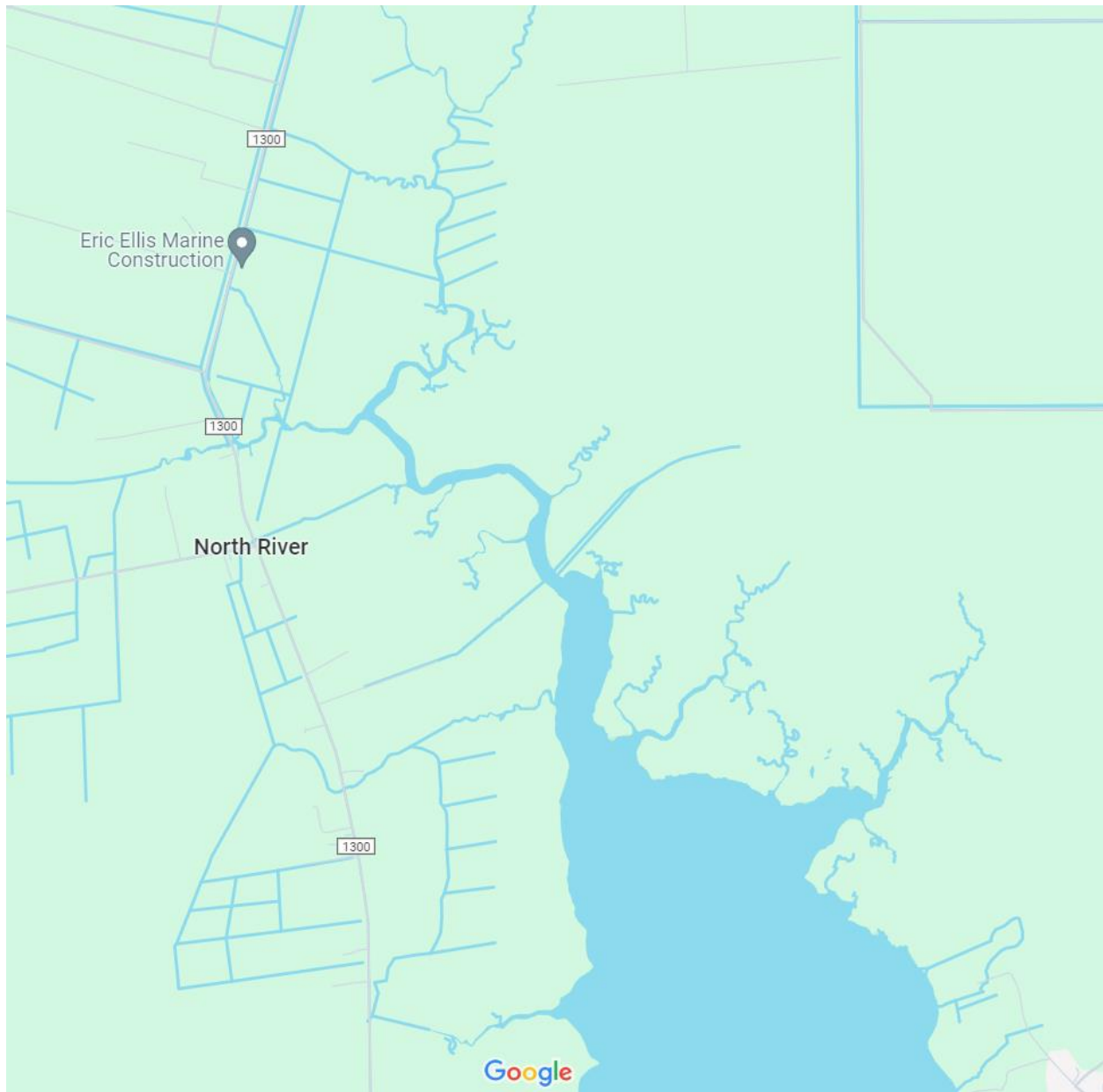

None of these little creeks flowing into the North River have names in Google Maps. So I can't go any further on where this Land Patent is without further information.

Now for the second Land Patent, Number 650, granted on March 3rd, 1779 for 300 acres described as "Calld Littleworth Lying on the fork of Newport River".

The second page of the Patent shows the directions to the Surveyor of Carteret County. (See the figure directly below). It directs the Surveyor to survey 300 acres for Reuben Benthall and the tract is described as "joining his own

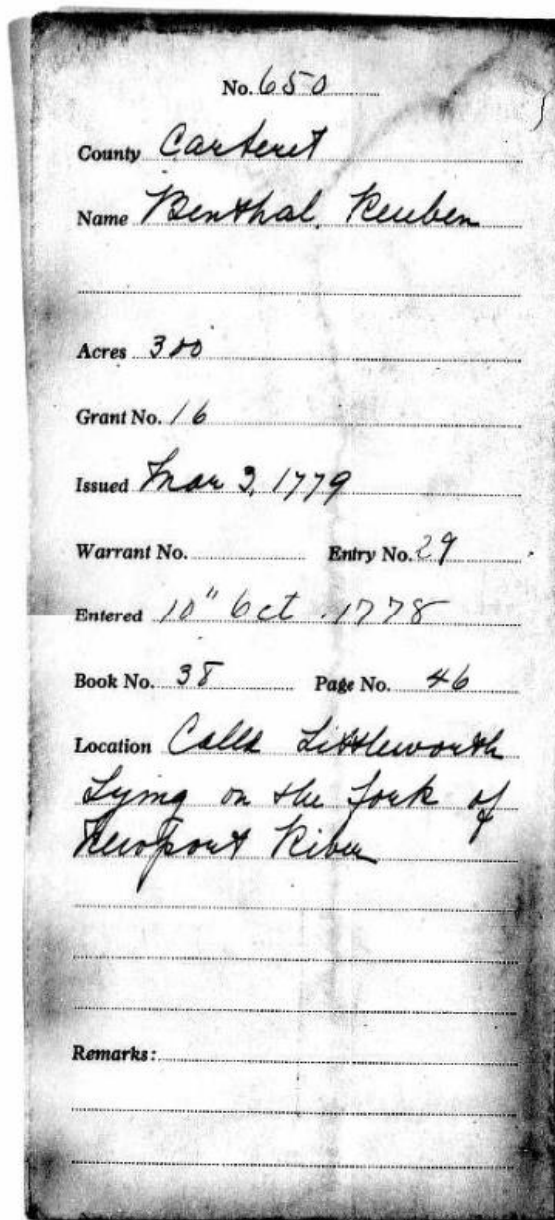
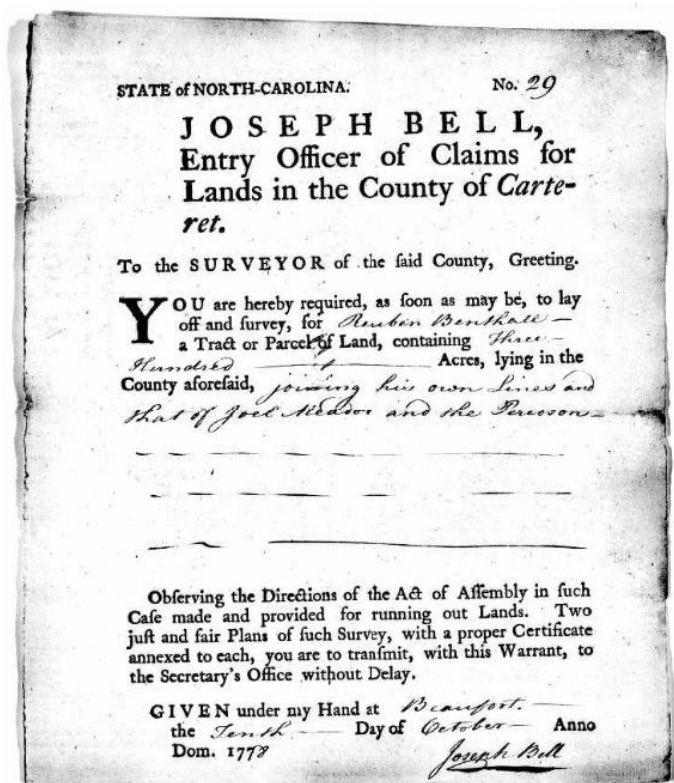

Lines and that of Joel Meador and the Percoson [?]" We will have to see if we can learn where this area is. The Meadors may be also known as the Meadows or Meddows that I see in a lot of documentation with the Benthalls. As Mark Twain said "It's a damn poor mind that can only think of one way to spell a word."

The next page is just the back side of the directions to the County Surveyor (see figure below). It has some writing "N^o. 29, Reuben Benthall, 300 Acres, October 10th, 1778".

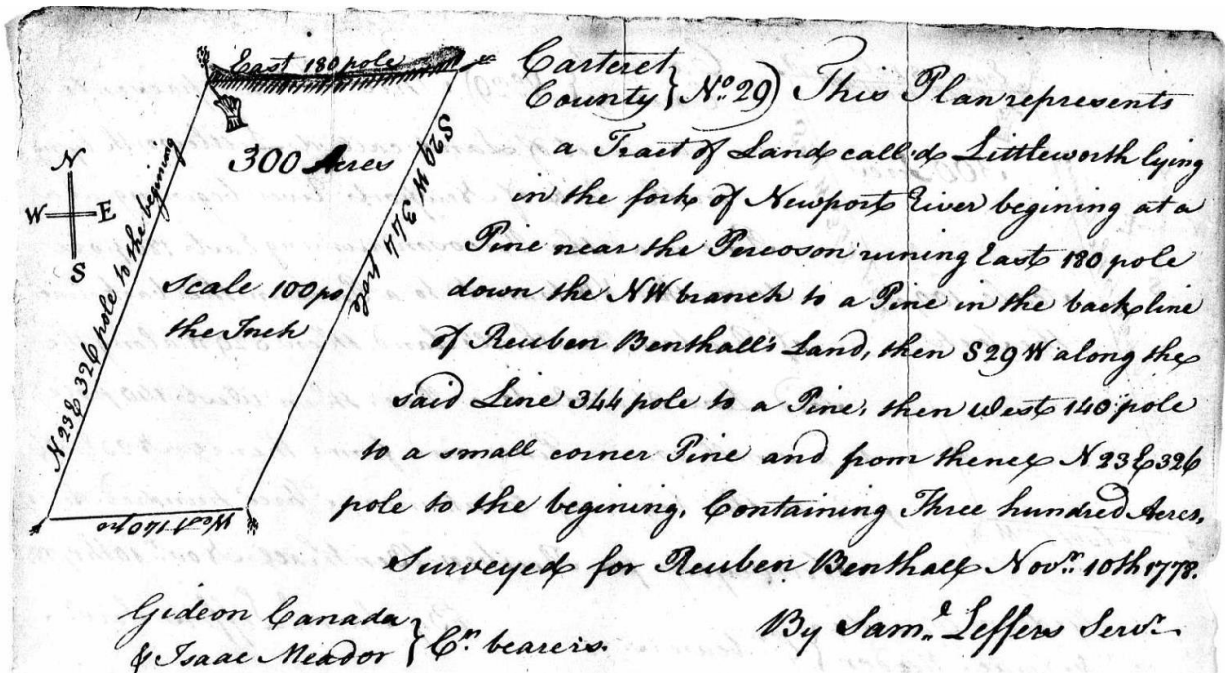
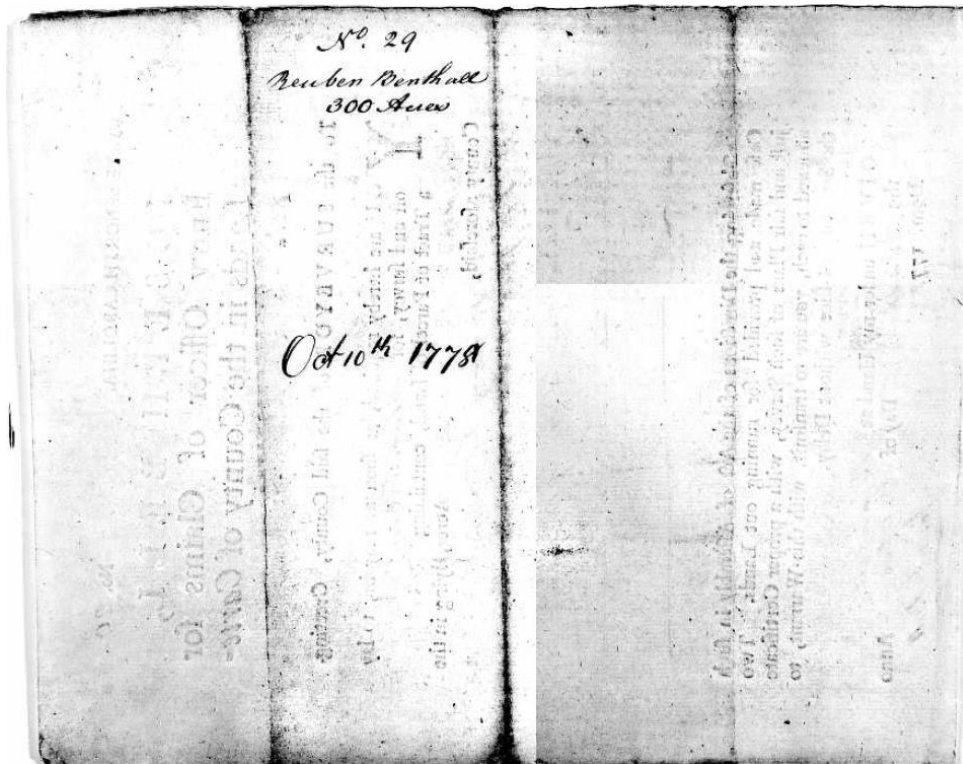

The next page (see figure directly above) is the surveyor's drawing and description of the land surveyed. The description is "Carteret County No. 29. This Plan represents a Tract of Land call'd Littleworth lying in the fork of Newport River beginning at a Pine near the Percoson running East 180 poles down the NW branch to a Pine in the back line of Reuben Benthall's Land, then @ 29

W along the said Line 344 pole to a Pine, then west 140 pole to a small corner Pine and from thence N 23 & 326 pole to the beginning, Containing Three Hundred Acres, Surveyed for Reuben Benthall, Nov. 10th 1778 by Sam^l Leffers Surv^r. Gideon Canada & Isaac Meador. Chⁿ Bearers”.

The word “percuson” is an old word and I think it means something like the head of a river. I found a document in the [USGW Archives](#) about the border between Halifax and Edgecombe counties which states:

“November Court -1853 – Report from Surveyors of Halifax & Edgecombe

Counties

In pursuance of directions from the respective Courts of Halifax and Edgecombe Counties empowering us the undersigned commissioners viz Lemuel L. SAVAGE & Samuel HYMAN on the part of Halifax County & Lewis E. PENDER & Redding S. PETWAY on the part of Edgecombe to run and mark the dividing line that separates the two Counties have proceeded to execute the said commission in the following manner – beginning at a large pine the corner of Martin County at or near the head of the Indian Branch and on the south side of the head or percuson thereof. Then down the meanders of said branch to Deep Creek, then up the various courses of said creek to the mouth of Marsh Swamp south eighty eight degrees west eight hundred pole to a sycamore on Fishing Creek below BIGGS old mill site.

Given under our hands & seals this the 24th day of September A.D. 1853

Lemuel L. SAVAGE

Samuel HYMAN

R. S. PETWAY

L. E. PENDER

November Court 1853

Rept returned & confirmed.

R. B. PIERCE Special Justice”

This is why I think “percuson” means something like the head of a river.

Now for the 3rd Land Patent in the Ancestry.com list of Reuben Benthall Land Patents (see figure below on the left). Patent number 636 was issued on the same date (March 3, 1779) in

Carteret County, North Carolina. It's for 141 acres (according to the first page of the Patent – we will see what the surveyor says later in the Survey drawing and description). The description of the land is "Call'd Joels Folly lying on the [North West?] Branch of Newport River." The Instructions to the Surveyor are in the figure on the right below.

No. 636

County Carteret

Name Benthall, Reuben

Acres 141

Grant No. 2

Issued Mar 3, 1779

Warrant No. _____ Entry No. 30

Entered 10th Oct 1778

Book No. 35 Page No. 32

Location Call'd Joels Folly
lying on the North
West Branch of Newport
River

Remarks: _____

STATE of NORTH-CAROLINA. No. 30

JOSEPH BELL,
Entry Officer of Claims for
Lands in the County of Carteret.

To the SURVEYOR of the said County, Greeting.

YOU are hereby required, as soon as may be, to lay off and survey, for Reuben Benthall – a Tract or Parcel of Land, containing One – Hundred & fifty Acres, lying in the County aforesaid, on the northwest Branch of Newport River joining his own and John Blairs lines.

Observing the Directions of the Act of Assembly in such Case made and provided for running out Lands. Two just and fair Plans of such Survey, with a proper Certificate annexed to each, you are to transmit, with this Warrant, to the Secretary's Office without Delay.

GIVEN under my Hand at Newport the Tenth Day of October Anno Dom. 1778. Joseph Bell

In the instructions to the Surveyor, you can see that they were issued on October 10, 1778 and the land description is "One hundred & fifty" acres lying on the "northwest branch of Newport River joining his own and John Blairs lines." The next page of the patent is just the back side of the Surveyor instructions which has the following writing on it "No. 30, Reuben Benthall, 141 Acres, Oct. 10th 1778". So a few discrepancies on the

actual acreage being surveyed, but it's not a huge deal.

The fourth page is the Surveyor drawing and description (see figure below – next page). The Surveyor description is "County Carteret No. 30. This Plan represents a Tract of Land call'd Joels

Folly lying on the NW branch of Newport River beginning by the Swamp side at a White Oak Reuben Benthall's corner running along his Line S 44 & 66 pole to the corner, then E^a. 103 pole to John Blairs Line, then along said Line North 120 Pole to a dead Pine, then W^e. 210 pole to a Red Oak near the Swamp, then South 92 pole to said Benthall's Line, then along said Line S 80 & 48 pole to his corner and thence across the Swamp 35 pole to the beginning. Containing One Hundred and forty one Acres. Surveyed for Reuben Benthall Nov. 12th 1778 by Sam^l Leffers, Surv^r. Gideon Canada & Isaac Meador. Chⁿ Bearers."

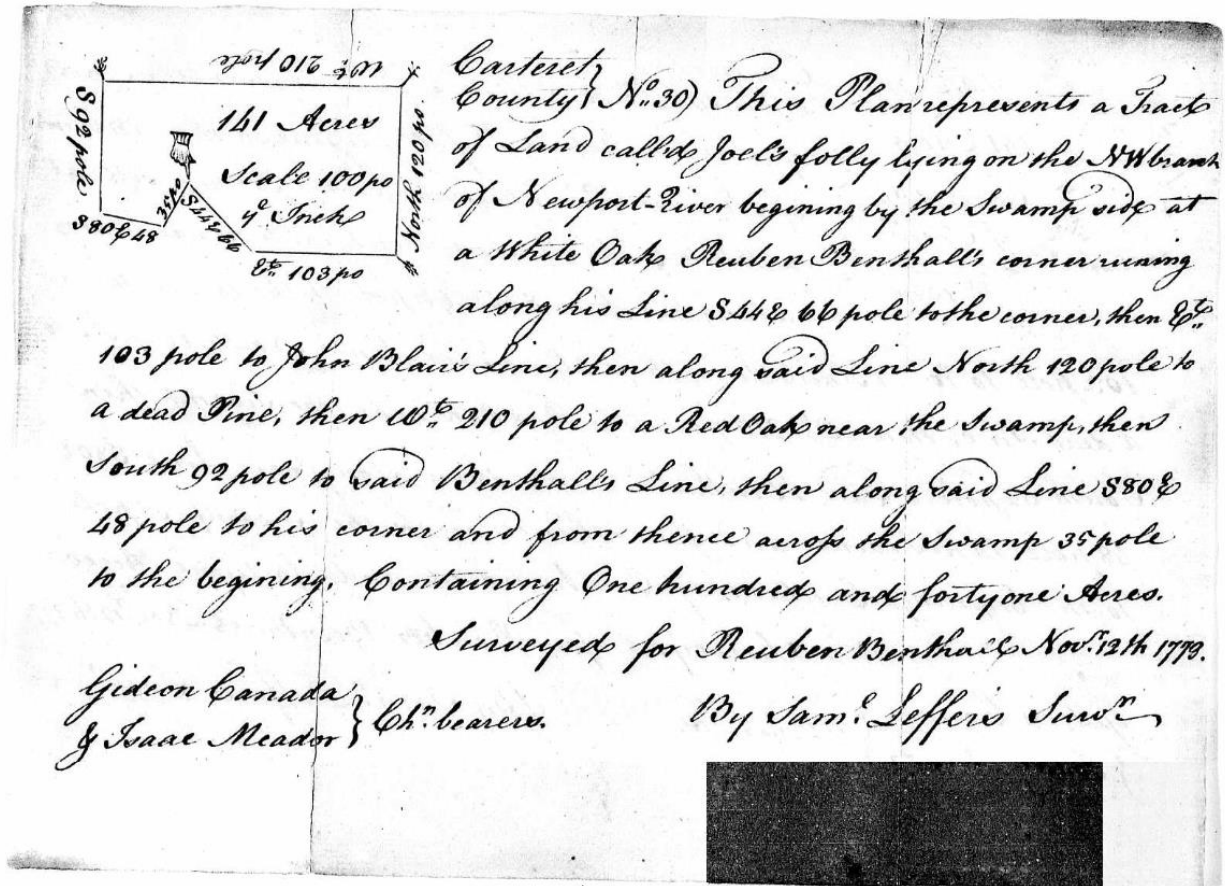

I don't yet see how this tract of land fits with the other tracts of land that Reuben owns. We'll continue with the last Patent.

The Fourth Patent listed on Ancestry.com is No. 668, issued for 500 acres in Carteret County, North Carolina on October 10th, 1780 (See figure on the left directly below). The land description is "in the fork of Newport River."

It's amazing to think of all this surveying and land acquisition going on in the middle of the Revolutionary War! Even though battles are being fought all over the place AND Reuben Benthall being a former soldier in the War, after his part he just came home and started acquiring land and setting up Plantations!

One of the things that isn't surprising is that the Survey organization is running out of the forms giving directions to the Surveyor. So the figure below are the instructions that were given to the Surveyor for this 4th tract of land.

These instructions are:

State of North Carolina No. 133

Joseph Bell Entry Officer of Claims for Land in the County of Carteret

To the Survior [Surveyor] of the said County Greeting.

You are hereby required as soon as may be to lay off and survey for Reuben Benthall a Tract or parcel of Land Containing Five hundred acres in the fork of of Newport River on the S. W. prong [bording?] on the river and being the surplus Land within the bounds of his own Patent which was granted to John Benthall Sen'.

Observing the Directions of the [Act?] of Assembly in such Cases made and Provided for running out Lands. [Two?] Just and fair Plans of such survey, with a proper Certificate [annexed?] to each you are to transmit with this Warrant to the secretarys Office without delay.

Given under my hand at Beaufort the

No. 668

County *Carteret*

Name *Reuben Benthall*

Acres *500*

Grant No. *34*

Issued *Oct 10 1780*

Warrant No. _____ Entry No. *133*

Entered *3 April 1780*

Book No. *52* Page No. *202*

Location *in the fork of Newport river*

Remarks: _____

Third day of April anno Dom 1780

Joseph Bell

State of North Carolina
Joseph Bell County Officer of Claims for Lands in the
County of Carter.
N^o 133
To the surveyor of the said County Genting
You are hereby required as soon as may be to lay off
and survey for Reuben Benthall a tract or parcel of
Land containing Five hundred Acres in the fork of of
Newport River on the S. W. prong binding on the river
and being the surplus Land within the bounds of his
own Patent which was granted to John Benthall Sr.
Observing the Directions of the Act of Assembly in such
Cases made and Provided for running out Lands. To
Just and fair Plans of such survey, with a proper
Certificate annexed to each you are to transmit with
this Warrant to the Secretary's Office without delay.
Given under my hand at Newfort the
Third day of April anno Dom 1780
Joseph Bell

The next page is just the back of this page, with the words " Reub. Benthall, No. 133, April 3, 1780" written on it. The last page is the Surveyor drawing and description. This drawing looks a lot like a surveyor drawing for John Benthall that I put in the analysis of John's will and what his lands looked like. You can see in the drawing that a piece of the paper has been lost – in the upper middle of the page. Presumably, this would show the river continuing to the left to meet up with the survey lines.

The survey description is:

Carteret County No. 113

Surveyed for Reuben Benthall five hundred acres of Land in the fork of Newport River being the Surplus land found and Contained within the Natural Bounds [and their home?] Land of his own Patent which was granted to John Benthall dec^d, beginning at a small post Oak on the North side of the S. W. branch, thence running North Three degrees East Eighty poles Then North Twenty-Nine degrees East Three hundred and Twenty four poles to the swamp of the N^o.W^t. Branch to a large Pine Thence North Eighty degrees West Three hundred and twenty poles to a small pine Thence South Twenty nine degrees West Seven hundred and Twenty Poles to a gum at the S. W. Run Thence down the Various Courses of the same to the beginning.

Survey October 8th 1782

By W^m W^s Taylor, Survey^r

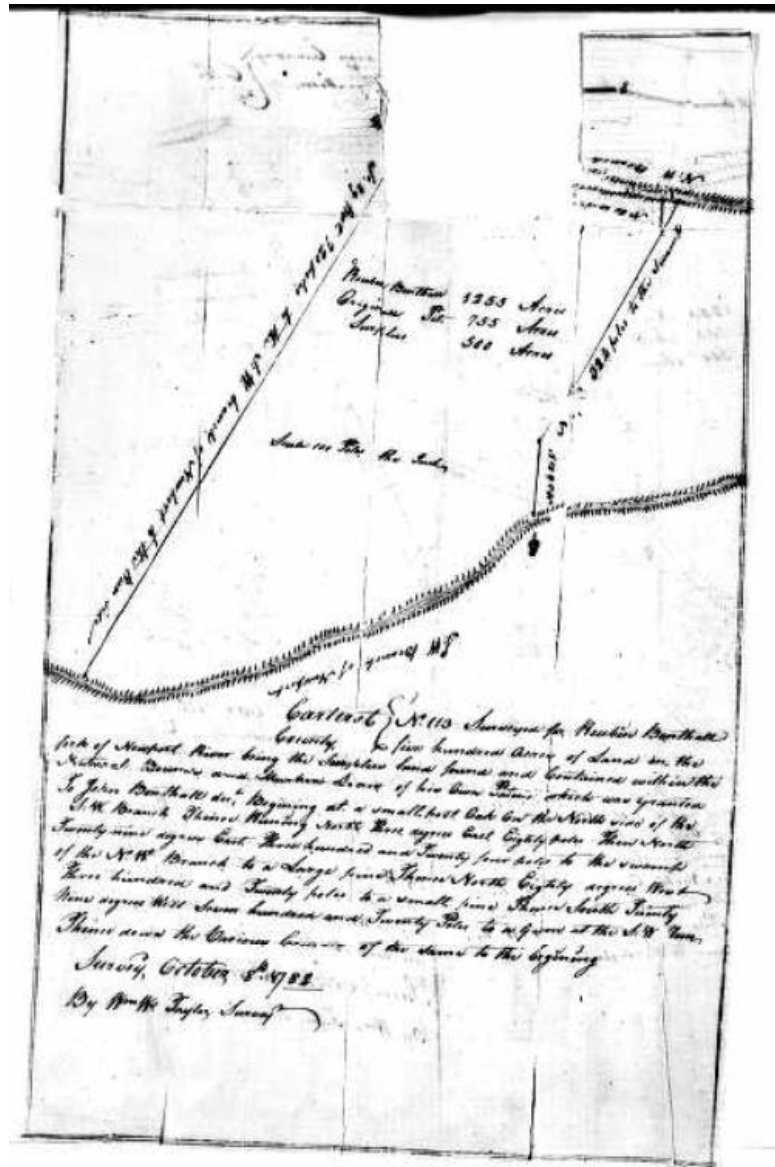

In the middle of the drawing, there are the words:

Reuben Benthall	1255 Acres
Original Pat	755 Acres
Surplus	500 Acres

The final page of the Patent is the back side of the drawing and description, and some of it is missing. I think that it is just the names of the chain bearers and should say:

Gideon Canaday

Isaac Meador

C B'

An interesting thought about this 1255 acres is that Reuben received quite a bit of land from his brother John when he died: (1) a 640-acre parcel, (2) a 400-acre parcel of which he had to give 100 acres to John Meddows, and (3) a 205-acre parcel that John was living on at the time of the writing of his will. So that is $640 + 400 - 100 + 205 = 1145$ acres received in John's will.

Where were these Plantations? As near as I can figure, they are in the fork where the Southwest Prong and the Northwest Prong of the Newport river come together to form the Newport River in Carteret County, NC:

