

Introducing the PUTTING ALLEY® Putting Stroke Isolator

How It Works

Because the Putting Alley is a controlled, precision practice device, a golfer can make confident directional swing changes based on active feedback from previous putt results.

If the ball falls off the alley it means you are not making a straight, square, on-line stroke. See the graphic at right (for a right handed golfer). Through repetition and adjustment, you will eventually work the ball up the alley. The higher it goes, the better the putt, and after practice, you will regularly make the full length putt.

Adjustments are made either by feel, or through instruction, which can shorten the process to develop a capable putting stroke.

Every golfer of any level of putting competence can improve his or her stroke just by using the Putting Alley on a regular basis. It's used by PGA, Champions and LPGA touring pros, PGA teaching professionals, and even executives at major club manufacturers. The golf blogs have rated it an average of 92/100. And 83% of golfers who bought a Putting Alley still use it after 4 years.

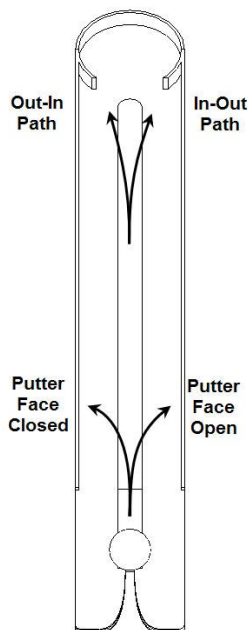

Easy to Use

Just drop a ball and putt.

Simply drop a ball in front of the Putting Alley and use your putter to push the ball through the slot and onto the front of "the alley"



.....then putt.

Make Sure It's Level



the alley is level for a perfectly straight putt.

Double-Sided, High-Strength Plastic.

Made from high strength plastic with an integrated putting alley on each side of the device. Flip the device to practice on either the wide or narrow alley.

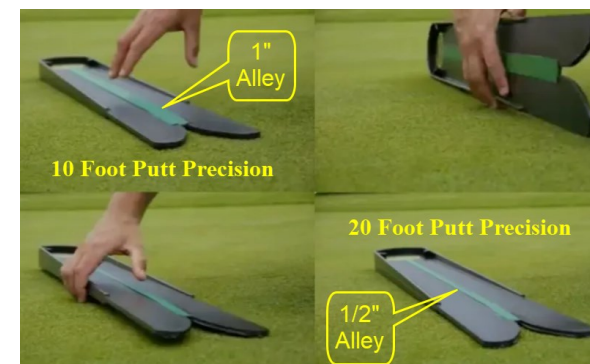

What The Golf Bloggers Say

The Putting Alley is an easy training aid to love: simple to use, durable, effective, inexpensive, and portable. —My Golf Spy

The Putting Alley not only improves your stroke but also your concentration. Hence, setting up little games such as seeing how many in a row you can make will really improve your mental focus. —The Hacker's Paradise

You can actually practice longer putts with just a small training aide. Moreover, rolling putts over and over again gives you great confidence when you have to face those 2 foot putts during your weekend skins game. —Three Guys Golf

I have always been a good putter, but if I continue practicing with this over the winter, I think I will be positively deadly. —Golfblogger.com

WHAT IT IS, AND WHAT IT DOES

The Putting Alley® is a short putt practice device, 35 inches long, that uses a raised precise putting surface, 27 inches long, as the putting “alley” to isolate and fix directional errors of a putting stroke (clubface angle, swing path, impact point).

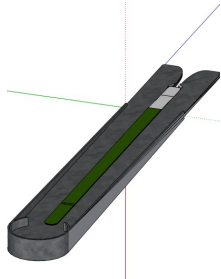

Putting on a narrow raised alley forces the stroke into a precise hitting position at impact. The putt never changes, but a golfer will naturally adjust the stroke by seeing where the ball falls off the alley. Even 5 minutes of use will improve the stroke.



The Putting Alley succeeds as the perfect device to isolate putting stroke errors, because it eliminates turf variance. Putting

greens, carpets, and putting mats all have some level of variability which provide inconsistent feedback, making it difficult to understand and fix stroke mechanics.

With consistent feedback and regular use a golfer will build a swing that narrows the angle the ball leaves the putter, resulting in more hole outs. Ultimately, a golfer can build a stroke that is six times more precise than necessary to make a 3 foot putt, and enough to make a straight, level 20 foot putt.

To make it as easy as possible to use, the Putting Alley has a unique front loading slot to place the ball in the exact same position each time **without bending over**. The Putting Alley comes with two different width alleys, which allow golfers of all handicaps to practice levels of precision to meet their needs.

PATENTED PUTT PRACTICE PRECISION

Practicing on a putting green simply tends to level out all golfers’ abilities. When you receive confusing feedback from the green, you compensate for it in your stroke. The human brain is too intelligent to continue missing putt after putt in the same way. But as you move from one spot on the putting green to another, the feedback changes, and thus your own compensations change, too. That is why you never seem to develop a consistent stroke.

– Dave Pelz (Legendary Putting Guru)

Practice does not make perfect, perfect practice makes perfect.

—Vince Lombardi (NFL Coaching Legend)

The Putting Alley provides a consistent, perfect-practice condition to isolate true stroke errors so a golfer can quickly learn better stroke mechanics.



Size: 35 in x 4.75 in

Weight: 2.1 lbs.

Angle of Incline: 0.5 degrees (approx)

The Putting Alley® is covered by the following patents: 9,028,336; 9,498,695; 9,616,312

Putting Alley® is a registered US trademark.



sales@puttingalley.com

www.puttingalley.com

PAT-2019-3

INTRODUCING

The Original Putting Alley® Putting Stroke Isolator



**The short putt practice
device with big putt results.**

www.puttingalley.com