



ENABLES DETECTION OF HIV
EARLIER AT THE POINT OF CARE

DETERMINE™ HIV-1/2 Ag/Ab COMBO

The first and only FDA-cleared rapid point-of-care test that simultaneously and separately detects HIV-1/2 antibodies and free HIV-1 p24 antigen on a single test strip.

Identifying HIV infection early, during the most infectious stage, offers significant benefits, particularly in high-risk populations such as men who have sex with men and injecting drug users.

- Rapid detection also helps to get patients into effective care and treatment earlier.
- Individuals who are unaware of their infection are 3.5 times more likely to transmit the virus to someone else.¹
- By detecting HIV earlier, further transmission can be prevented during this highly infectious stage.



DETERMINE HIV-1/2 Ag/Ab COMBO

THE FIRST POINT-OF-CARE HIV-1/2 Ag/Ab TEST

Determine™ HIV-1/2 Ag/Ab Combo has the ability to detect HIV earlier than conventional antibody-only tests.² This enables healthcare providers to diagnose HIV infection earlier, allowing individuals to seek medical care sooner.

- CLIA waived for fingerstick whole blood
- Minimal training required
- Tests in three easy steps
- Results in just 20 minutes
- Test using whole blood, serum or plasma
- Proven 99.9% overall clinical sensitivity for all sample types

TEST IN THREE EASY STEPS**

1 Prepare Test

Bend along the perforation, then tear one strip from the right and remove cover.

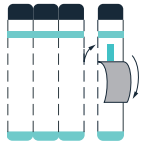

2 Add Sample

Fingerstick Whole Blood

Apply 50 µL of sample by touching the tip of the capillary tube to the sample pad. Wait 1 minute, then add chase buffer.

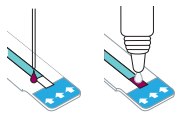

Venous Whole Blood

Apply 50 µL of sample by touching the tip of the precision pipette to the sample pad. Wait 1 minute, then add chase buffer.

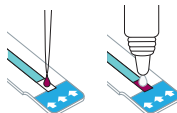

Serum or Plasma

Apply 50 µL of sample by touching the tip of the precision pipette to the sample pad.

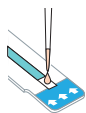

3 Read Results

Read the results for both the free HIV-1 p24 antigen (Ag) and HIV-1/2 antibodies (Ab) in just 20 minutes.

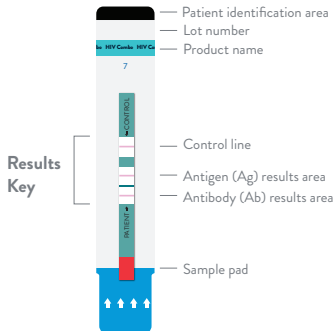
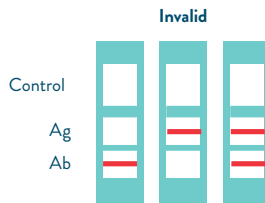
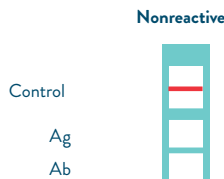
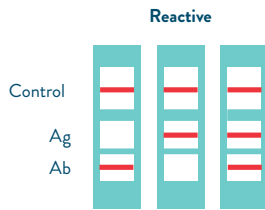

Please refer to the package insert for complete instructions.

Product Clinical Performance

Information Type	Overall Clinical Sensitivity	Overall Clinical Specificity
Fingerstick Whole Blood	99.9%	99.8%
Venous Whole Blood	99.9%	99.7%
Serum	99.9%	99.6%
Plasma	99.9%	99.7%

Product Information

Information Type	Product Detail
Method	Lateral flow
Time to Results	20 minutes
Storage Conditions	2°C–30°C (36°F–86°F)
Test Shelf Life	24 months*
External Controls Shelf Life	24 months*

Ordering Information

Product	Order Number
Determine™ HIV-1/2 Ag/Ab Combo (25 tests)	7D2648
External Controls	7D2628

**FOR MORE INFORMATION,
CONTACT YOUR LOCAL ABBOTT
REPRESENTATIVE, OR VISIT
GLOBALPOINTOF CARE.ABBOTT**

*From date of manufacture.

**Refer to product insert for complete instructions for use.

1. Marks G, Crepaz N, Janssen R. Estimating sexual transmission of HIV from persons aware and unaware that they are infected with the virus in the USA. *AIDS*. 2006;20(10):1447-1450. doi:10.1097/01.aids.0000233579.79714.8d

2. Masciotra S, Luo W, Youngpairoj AS, et al. Performance of the Alere Determine™ HIV-1/2 Ag/Ab Combo Rapid Test with specimens from HIV-1 seroconverters from the US and HIV-2 infected individuals from Ivory Coast. *Journal of Clinical Virology*. 2013;58(suppl 1):e54-e58. doi:10.1016/j.jcv.2013.07.002

© 2025 Abbott. All rights reserved. All trademarks referenced are trademarks of either the Abbott group of companies or their respective owners. Any photos displayed are for illustrative purposes only. RDx-24000596-05 10/25

