

Cool Core Pressure Sensor

P/N: RES-PS-2000

Specifications

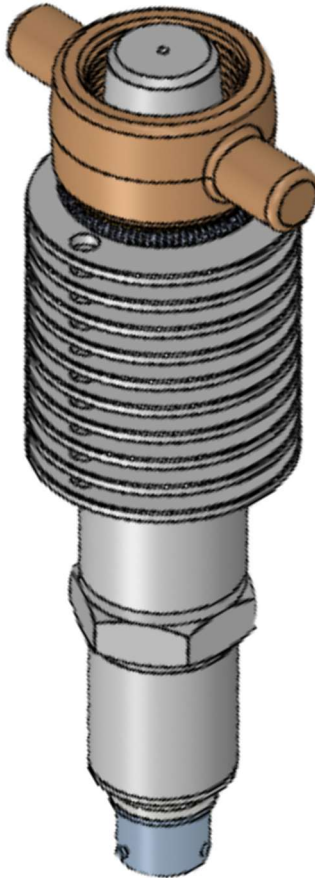

Image for reference only

Application	Portable Measurement
Power Input	9 – 28 Vdc
Size	6 x 2.75 inch
Weight	1 lb
Pressure Range	0 -2000 Psi
Output Signal	4 – 20 mA
Response Time	< 1ms
Accuracy	≤ ± 0.25 % FS
Material	Stainless Steel 316L
Electrical Connector	MIL C26482, 10-6
Operating Temperature	-40°F to 450°F (-40°C to 232°C) **
Pressure Connector	1 1/16"-10 Whitworth
Hazardous Area Rating	SEV 09 ATEX 0108 X EEx 1G ia IIC T3 - T6 FM/FM-C, Class 1, Div. 1 approved IEC/Ex SEV 10.003
Certifications & Approvals	FM 3028239 FM3028239C IEC Ex SEV 10.0003

** Ask us for more information



Part Number

Stock Product	RES-PS-2000
Build to Order	RES-PS-XXXX*

*X Options: 2000, 3000, 5000 Max Pressure Psi

2024, Resonance Systems. All rights reserved.

The contents of this publication are presented for informational purposes only, and while diligent efforts have been made to ensure their accuracy, they should not be considered as warranties or guarantees, express or implied, regarding the products or services described herein or their use or applicability. All sales are governed by our terms and conditions, which are available on request. We reserve the right to modify or improve the designs or specifications of our products at any time without notice.

Resonance Systems
8609 Kingston Pike
Ste 201
Knoxville, TN 37923 USA
+1-865-248-2453