



**Panda<sup>®</sup>**  
**Kitchen and Bath**

---

2020

---

## ABOUT US

In 1998, the Huang family purchased their first home in the U.S. and decided to visit one of the local remodeling companies to purchase a new Kitchen. After finding that their remodeling plans were out of reach, they decided to use their decades of experience in the construction industry to find a way to make the buying of a new Kitchen more affordable. By teaming up with the manufacturer directly, they found a way to save on project costs by up to 70% and, therefore, the family found a way to pass on those savings to the local consumer. After two years of preparation **Panda Kitchen and Bath Expo Center** was born.

Between 2002 and 2004, our aggressive prices and great savings paid off with our customers which led to our rapid growth into new territories with over 100,000 square feet of inventory. By 2006, Panda Kitchen and Bath had opened multiple distribution centers throughout the US growing to over 500,000 square feet of inventory. We also began our expansion into the Caribbean.

Today, Panda Kitchen & Bath operates multiple manufacturing plants in China, Malaysia, and now Yangon Myanmar along with over 1 million square feet of warehousing space throughout the US. We also have over 2,000 employees and support staff spread out over two continents. As worldwide leaders in the Ready-To-Assemble (RTA) category, we also offer delivery options to our US, Caribbean, and North/South American customers.

Even with our rapid growth, it's important to understand that our success hasn't only come from our sales and distribution centers. It also came from our many years of charitable and partnership opportunities. Some examples are the Ronald McDonald House, Harvest Bible Chapel, St Jude Hospital, SOBE Wine & Food Festival, the Florida Panthers, and our 3 time NBA Champions, the Miami Heat, just to name a few.

In conclusion, our philosophy is quite simple. By owning and operating multiple manufacturing plants we are able to better manage COST and QUALITY and, in turn, pass on those benefits to all of our customers. This means that our customers truly are saving by buying "Factory Direct".





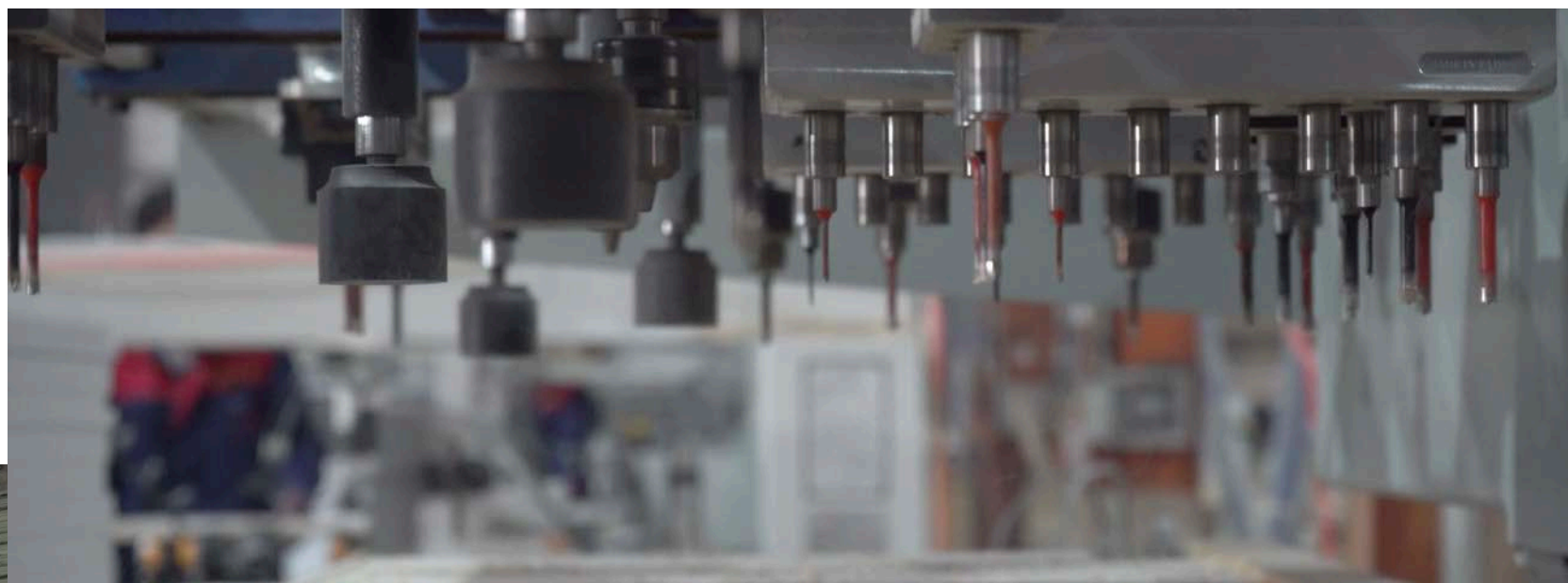





**SINGLE SHAKER**  
CHOCOLATE C7080

Chocolate Shaker pays tribute to basic styling with clean lines and square corners lending itself to nearly any décor.



**SINGLE SHAKER**  
WHITE C7070

Shaker White shows how simple clean lines can show an attractive modern look.







## **SINGLE SHAKER**

GREY C7072

Shaker Grey stands between the popular white and classic chocolate shakers. This offers the ultimate in flexibility and modern styling.





**BRISTOL**  
COFFEE C4521

Bristol Coffee has Bold shapes, raised paneling, deep color tones and has always been known for elegance.







**CATHY**  
HONEY C2052

Cathy Honey Maple with natural wood color tones and beautiful cathedral arches has always been a classic.



## CABINET OUTSTANDING FEATURES

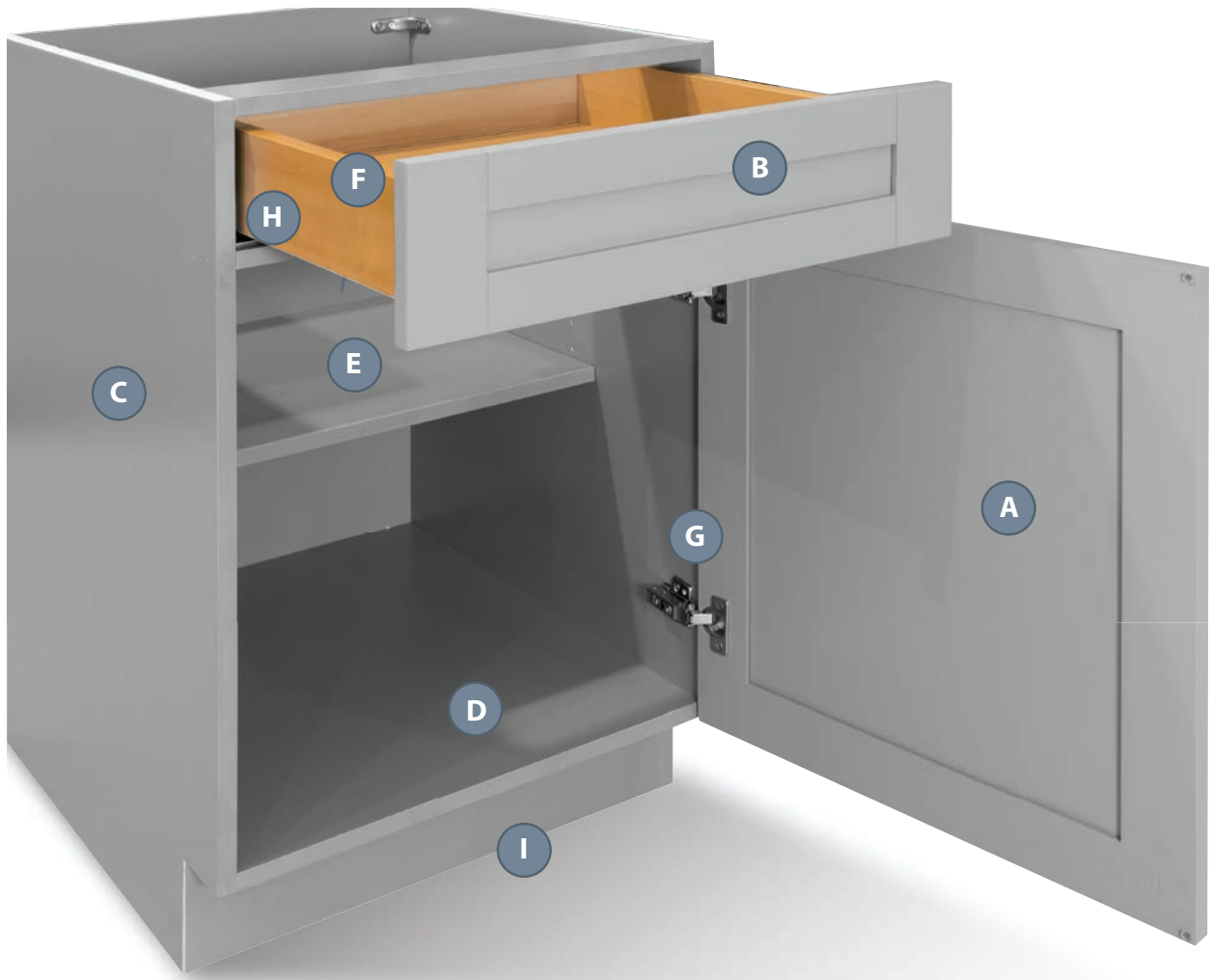

**A** Door – ¾" solid wood

**B** Drawer Face – ¾" solid wood

**C** Cabinet side panel – Panel made of 11 layers ¾" thickness plywood

**D** Cabinet bottom & top panel – Panel made of 11 layers ¾" thickness plywood

**E** Shelves – Adjustable shelves ¾" thickness made of 11 layers plywood

**F** Drawer box - ¾" thick solid wood with dovetail construction.

**G** Hinges – 105 degree stainless steel Soft-close hinges

**H** Rails - 20" full extension under-mount soft-close rails

**I** Toe kick – Made of ¾" thick of plywood

**J** Cabinet back panel – ¾" panel with ¾" frame.

\*Above description varies depending on cabinet's style

## BASE CABINETS

### Base Cabinets

#### 1-Door 1-Drawer Cabinet

- B09 – 09W x 34.5H x 24D
- B12 – 12W x 34.5H x 24D
- B15 – 15W x 34.5H x 24D
- B18 – 18W x 34.5H x 24D
- B21 – 21W x 34.5H x 24D



### Base Cabinets

#### 2-Door 1-Drawer Cabinet

- B24 – 24W x 34.5H x 24D
- B27 – 27W x 34.5H x 24D
- B30 – 30W x 34.5H x 24D
- B33 – 33W x 34.5H x 24D
- B36 – 36W x 34.5H x 24D



### Drawer Base Cabinets

#### 3-Drawer Cabinet

- DB12 – 12W x 34.5H x 24D
- DB15 – 15W x 34.5H x 24D
- DB18 – 18W x 34.5H x 24D
- DB21 – 21W x 34.5H x 24D



### Drawer Base Cabinets

#### 3-Drawer Cabinet

- DB24 – 24W x 34.5H x 24D
- DB27 – 27W x 34.5H x 24D
- DB30 – 30W x 34.5H x 24D
- DB36 – 36W x 34.5H x 24D



### Sink Base Cabinets

#### 2-Door 1-Drawer Face Cabinet

- SB24 – 24W x 34.5H x 24D
- SB27 – 27W x 34.5H x 24D
- SB30 – 30W x 34.5H x 24D
- SB33 – 33W x 34.5H x 24D
- SB36 – 36W x 34.5H x 24D
- SB42 – 42W x 34.5H x 24D



### Drawer Base Cabinets

#### 5-Drawer Cabinet

- DB06 – 06W x 34.5H x 24D

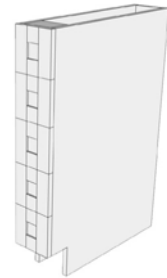

### NOTE

Shaker and Cathy Style doors measure approx. 5 13/16" in height for Drawers and 23 15/16" in height for Doors.

Bristol Coffee Style doors measure approx. 7 3/8" in height for Drawers and 22 5/16" in height for Doors.

Toe kicks(TK) are approximately 4 1/2" high.



## WALL CABINETS

### Wall Cabinets (W)

#### 1-Door Cabinet

- W0930 – 09W x 30H x 12D
- W1230 – 12W x 30H x 12D
- W1530 – 15W x 30H x 12D
- W1830 – 18W x 30H x 12D
- W2130 – 21W x 30H x 12D

NOTE: We also carry stock in 36" and 42" high wall cabinets



### Wall Cabinets (W)

#### 2-Door Cabinet

- W2430 – 24W x 30H x 12D
- W2730 – 27W x 30H x 12D
- W3030 – 30W x 30H x 12D
- W3330 – 33W x 30H x 12D
- W3630 – 36W x 30H x 12D

NOTE: We also carry stock in 36" and 42" high wall cabinets

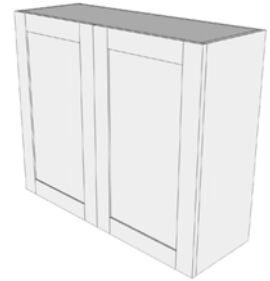

### Over the Range Cabinets (W)

#### 2-Door Cabinet

- W3014 – 30W x 14H x 12D
- W3020 – 30W x 20H x 12D
- W3026 – 30W x 26H x 12D

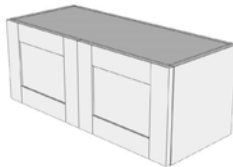

### Over the Fridge Cabinets (W)

#### 2-Door Cabinet

- W3612 – 36W x 12H x 12D
- W3618 – 36W x 18H x 12D
- W3624 – 36W x 24H x 12D

NOTE: We also carry stock in 24" deep fridge cabinets

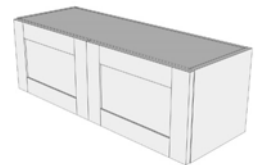

### Wall Cabinets w/ Glass (W)

#### 1-Door Cabinet

- W1230G – 24W x 30H x 12D
- W1530G – 30W x 30H x 12D
- W1830G – 36W x 30H x 12D

NOTE: We also carry stock in 36" and 42" high wall cabinets



### Wall Cabinets w/ Glass (W)

#### 2-Door Cabinet

- W2430G – 24W x 30H x 12D
- W3030G – 30W x 30H x 12D
- W3630G – 36W x 30H x 12D

NOTE: We also carry stock in 36" and 42" high wall cabinets



### Wall Wine Rack (WWR)

- WWR3018 – 30W x 18H x 12D
- WWR3618 – 36W x 18H x 12D

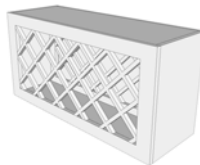

### Wall Open End Shelf (WOES)

- WOES0630 – 06W x 30H x 12D
- WOES0636 – 06W x 36H x 12D
- WOES0642 – 06W x 42H x 12D
- WOES1230 – 12W x 30H x 12D
- WOES1236 – 12W x 36H x 12D
- WOES1242 – 12W x 42H x 12D

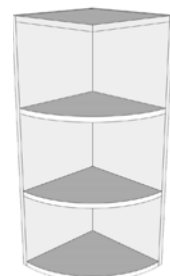

#### NOTE:

Shaker, Cathy, and Bristol Style wall doors measure approximately 29 15/16" in height (30 wall), 35 15/16" in height (36 wall), and 41 15/16" in height (42 wall).

## TALL AND CORNER CABINETS

### Base Lazy Suzan (BLS)

2-Door Cabinet

- BLS33 – 33W x 34.5H x 24D
- BLS36 – 36W x 34.5H x 24D

NOTE: Lazy Suzan metal inserts not included, available upon request

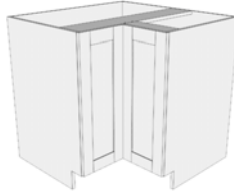

### Base Diagonal Corner (BDC)

1-Door Cabinet

- BDC36 – 36W x 34.5H x 24D

NOTE: Does not include a shelf

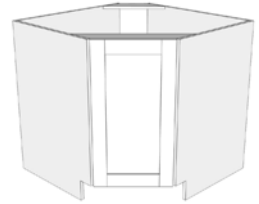

### Base Blind Corner (BBC)

1-Door 1-Drawer Cabinet

- BBC39 – 39W x 34.5H x 24D
- BBC42 – 42W x 34.5H x 24D
- BBC45 – 45W x 34.5H x 24D
- BBC48 – 48W x 34.5H x 24D

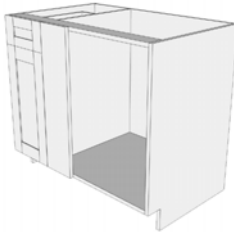

### Wall Diagonal Corner (WDC)

1-Door Cabinet

- WDC2430 – 24W x 30H x 12D
- WDC2436 – 24W x 36H x 12D
- WDC2442 – 24W x 42H x 12D
- WDC243615 – 24W x 36H x 15D
- WDC244215 – 24W x 42H x 15D

NOTE: Glass door options also available on some sizes.

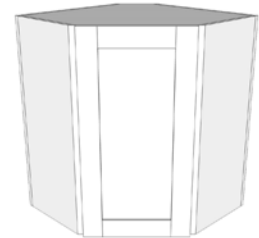

### Pantry Cabinet (PC)

1-Top Door 1-Bottom Door Pantry

- PC1884 – 18W x 84H x 24D

NOTE: We also carry stock in 90" and 96" high pantry cabinets.



### Pantry Cabinet (PC)

2-Top Door 2-Bottom Door Pantry

- PC2484 – 24W x 84H x 24D
- PC3084 – 30W x 84H x 24D
- PC3684 – 36W x 84H x 24D

NOTE: We also carry stock in 90" and 96" high pantry cabinets.



### Double Oven Cabinet (DOC)

2-Door 1-Drawer Cabinet

- DOC3084 – 30W x 84H x 24D
- DOC3090 – 30W x 90H x 24D
- DOC3096 – 30W x 96H x 24D





## VANITY CABINETS

### Vanity Sink Base (VSB)

2-Top Door 1-Bottom Drawer

- VSB24 – 24W x 32.5H x 21D
- VSB30 – 30W x 32.5H x 21D
- VSB36 – 36W x 32.5H x 21D

NOTE: The Bottom drawer is a working drawer.

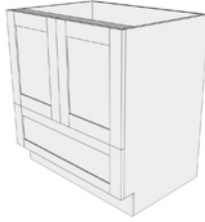

### Vanity Drawer Base (VDB)

3-Drawer Cabinet

- VDB12 – 12W x 32.5H x 21D



### Vanity Side Drawer (VSD)

5-Drawer Cabinet

- VSD30 – 30W x 32.5H x 21D
- VSD36 – 36W x 32.5H x 21D
- VSD42 – 42W x 32.5H x 21D

NOTE: The top side drawer is non-working face drawer only. This cabinet is designed for a center sink setup.



## TRIMS AND MOLDINGS

TBM 8

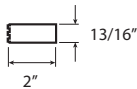

CTM 8

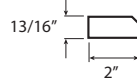

RWF6

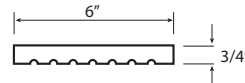

RWF3

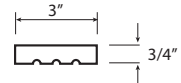

CCM8

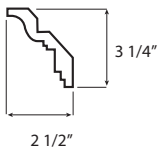

ACM8

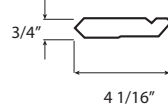

WF6

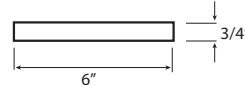

WF3

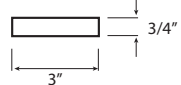

QR8



IVI 8

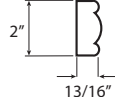

TK8

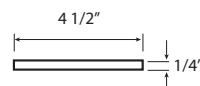

OGM8

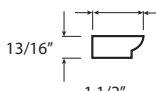



GUY FIERI AT SOBE CLOSING PARTY



AARON SANCHEZ

daKitchen.com



GIADA DE LAURENTIIS



RACHAEL RAY