

Full Text Search: YAY!

Presenter: Deanne Benbrook
GenealogyKC 2024

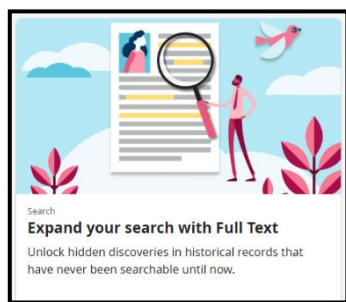

FamilySearch launched a new feature this year for their image only collection (non-indexed) of records entitled Full Text Search. So exciting!!

This handout will contain information as of June 2024. Please note that, as with any new technology, there is a learning curve. Adjustments and improvements will be made, and more records will be added over time to improve the feature. Keep checking for new additions! The class will include up to date information.

What is it??

With handwriting recognition and Optical Character Recognition (OCR) software, FamilySearch can convert an image of text into a machine-readable text format giving you the ability to search the full text of these records before they are even indexed.

At the time of this handout, over 100 million searchable records are available in Full-Text Search, including US Land and Probate Records, Mexico Notary Records, Australia Land and Probate Records, New Zealand Land and Probate Records, and US Plantation Records.

A few points to remember:

1. This is a Beta feature, so things are still being evaluated and considered as pre-release.
2. AI does its best to decipher written language but, just like us, will make mistakes.

How to access Full-Text Search:

1. Sign into your FamilySearch account.
2. On your home page, scroll down and locate "FamilySearch Labs".
3. Click on "View Experiments".
4. On the "Expand your search with Full Text" card, click "Try It".
5. A video on the page helps you learn to use this experience.

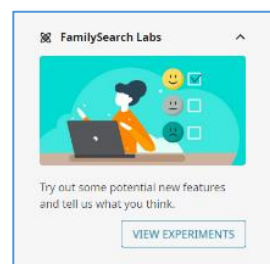

Search tips:

1. To reduce the number of search results, use the filters in the upper left under the Results number.
2. **Find an exact word, spelling, or phrase**
Use quotation marks. Example: "Henry Jones"
3. **Include a specific word or phrase**
Use the + symbol. Example: +Judith
4. **Exclude a specific word or phrase**
Use the - symbol. Example: -John
5. **Find different spellings**
Use the ? symbol. Example: Jens?n will return Jensen and Jenson
6. **Find different forms of a root word**
Use the * symbol if unsure of exact characters or letters. Example: Car* will match car, cars, carriage, carpenter, etc.

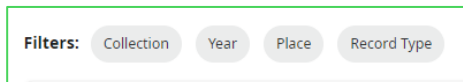

Begin searching:

Click on “More Options” to search specifically by Ancestor name.

Start your search

Enter a keyword to begin.

Limited data is currently available. You are browsing US Land and Probate Records, Mexico Notary Records, Australia Land and Probate Records, New Zealand Land and Probate Records, and US Plantation Records.

Keywords

Tip: Use quotation marks to search for an exact phrase "Jane Lee"

SEARCH

MORE OPTIONS

Start your search

Enter a keyword to begin.

Limited data is currently available. You are browsing US Land and Probate Records, Mexico Notary Records, Australia Land and Probate Records, New Zealand Land and Probate Records, and US Plantation Records.

Keywords

Tip: Use quotation marks to search for an exact phrase "Jane Lee"

Add Ancestor Information

Name

SEARCH

FEWER OPTIONS

To search for enslaved persons, it can be helpful to search for:

1. “Enslaver’s name” + Enslaved first name
2. Enslaved first name + location + Deed

EXAMPLE: ALVIN JAMES PETTIT B. 1881, D.1939

Keyword: “First and last name” produced 56 results in 7 states.

Ancestor Information only: “First and last name” produced 67 results in 8 states.

Using both together gave the same results Ancestor Information.

Let’s look at this record (page 1 only of 2):

*Remember It is always good to check pages before and after a record to make sure you are seeing the full record or any other pertinent information.

Some Relationships & Facts

1. Two minor daughters of Anna B. Pettit and Alvin Pettit now Grimsbys. (Eva & Winnie AKA Mary).
2. Winnie now known as Mary.
3. Anna’s parent’s names are John B. and Josephine Burger, he is deceased by this time.
4. Alvin is married to Ida.

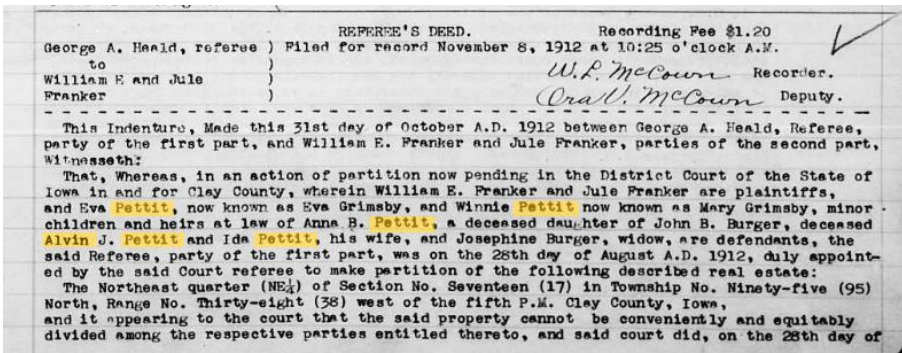

As you find records, take time to understand what the record is. Glean information by reading through the record and notating relationships and facts. Do any questions arise? Is there supporting evidence of relationships, dates, and locations?

Saving the record:

1. Select Attach to Tree.
2. Describe the record.
3. Add notes if desired to help clarify the who, what, where, etc.
4. View image group metadata by clicking Show. This metadata will not be included in the source. Copy any important data into the Notes field.
5. Select a person to attach this source to. Choose from the list of people you recently viewed in Family Tree, or search for a specific person using his or her Person ID.

6. Attach the source to other members of this person's family by selecting them from the list provided below. This is optional but can be very helpful for future research.
7. A list of selected people to attach the record will appear.
8. Reason to attach source is an option.
9. Attach to tree.
10. A pop up will appear allowing you to view source. This will open a window where you can edit, review, add, and make changes.

What is a Source Box on FamilySearch:

Your source box lets you reuse sources instead of retyping them each time you need to use them. For more information, click the Help button on the FamilySearch home page and type in Source Box in the search area. Helpful information will be provided.



View icons:

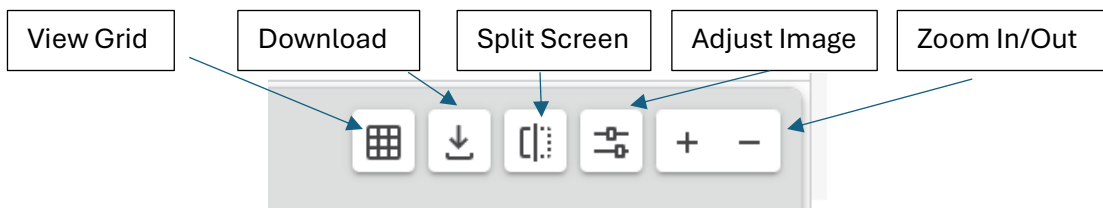

To download an image:

1. Click the download icon. It may immediately save as a jpg on your system.

OR

2. To customize your download option, click on the download icon below the Full Transcript area.
3. Select options and save. It will be saved as a PDF.

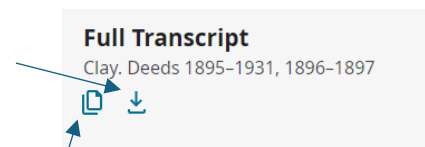

Copies the transcription of Full Text to the clipboard.

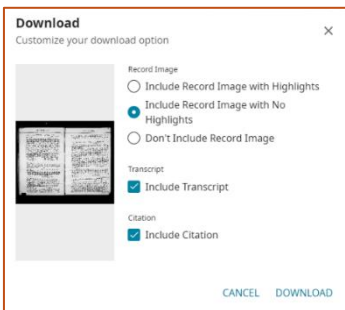

Expand your research by clicking Group Data. Select "Creator" to see all images from that Creator. You may find something in that collection as you browse through images.

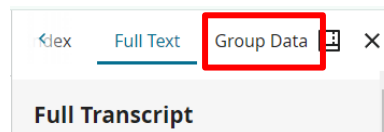

REMEMBER TO CHECK BACK OFTEN TO SEE WHAT NEW IMAGES ARE INCLUDED IN FULL TEXT SEARCH!

"Labs is where FamilySearch can share new and potential site features with users before they are released generally. It gives users a chance to see what is being worked on and to provide feedback. All of the products and features on the Labs website are experimental. The products and features are not guaranteed to be available or may not function correctly." - FamilySearch

Bonus Helpful Information on current available records:

Land and probate records are valuable resources for genealogists, providing a wealth of information that can help in constructing detailed family histories. Here are the key values of each type of record:

Land Records:

1. **Ownership and Residence:** Show where ancestors lived and owned property, establishing geographic locations tied to family history.
2. **Family Connections:** Land transactions often involve family members, offering clues about familial relationships and networks.
3. **Economic Status:** Details about the size and value of the property provide insights into an ancestor's economic situation and social standing.
4. **Migration Patterns:** Changes in land ownership can reveal the movement and migration patterns of families over time.
5. **Additional Documentation:** Related documents such as maps, surveys, and deeds can provide further context and information.

Probate Records:

1. **Inheritance Information:** Detail the distribution of an ancestor's estate, showing what was left to heirs and other beneficiaries.
2. **Family Relationships:** Probate records often list family members, helping to confirm relationships and show new ones.
3. **Personal Details:** Wills and estate inventories can reveal personal possessions, interests, and the lifestyle of the deceased.
4. **Economic and Social Status:** The value and type of property listed in probate records can indicate the deceased's economic status and social standing.
5. **Legal Documentation:** Includes wills, estate inventories, and other legal documents that can provide additional personal and familial information.

Together, land and probate records are essential tools for genealogists, offering comprehensive insights into family histories, economic conditions, and social relationships over generations.

For more information:

Go to Research Wiki and type in:

1. U.S. Land Records Class Handout
2. United States Probate Records
3. United States Deeds
4. Type location and genealogy. On the page, look at the right-side box menu and select record type for more information.