



**Commercial grade
Steam Cleaner
Model: TORNADO T8**

Instruction Manual



Pictures are for reference only; the final product may differ.

Thank you for choosing IMASS TORNADO T8 Stame Cleaner. Which is designed to provide powerful and efficient cleaning for variety surfaces. TORNADO T8 ensures thorough and hygienic cleanliness while minimizing effort free of hassle with AquaSteam technology.

Please read this instruction manual carefully before it is used to ensure optimal performance and safety. After reading, we recommend keeping this manual for future reference. Should you need another copy, the instruction manual is also available online at www.imass.com.au.

Contents index

Important Safety instructions ----- page 03

Diagram and packing list ----- page 05

Product Overview ----- page 07

Interface instructions

How to use

Product assembly & disassembly

Technical parameters

Maintenance ----- page 11

Troubleshooting and solutions

Statistical table of harmful substances

After-sale service and Warranty ----- page 14

Important safety instructions

Before using this product, please read all contents of this manual carefully and install the machine according to the steps of this manual. Keep this manual properly. If you transfer the product to a third party, please attach this manual together with the machine.

Instruction manual could be download from our website www.imass.com.au Any operation inconsistent with the instructions in the manual may lead to product damage or serious personal injury.

- 1. Fill up water tank first before connecting to power socket.**
- 2. Confirm Depression Valve (see page 8) is tightened by turning it clockwise.**
3. Power supply voltage must be consistent with the machine rated voltage.
4. When cleaning, maintenance, storage or when the machine is not in use, plug must be unplugged properly. Power cord pulling is forbidden.
5. Do not immerse the machine in water or other liquid, do not approach the heating source like heaters, fire or exposure to the sun.
6. Do not use the cleaning machine if the machine falls or a collision happens with obvious damage, abnormal operation, water leaking, power cord or power plug is damaged, etc. In these cases, pls ask assistance from your local dealer or a qualified technician.
7. Do not keep the machine running while the water tank is short of water. Top up water tank in time. Alarm “beeps” will remind you to top up water.

8. Do not point steam flow at human, animals and electrical products/ components/parts, such as home appliance PCB.
9. People with physical disabilities, sensory or mental problems, or lack of knowledge and experience may use this product only when they have obtained supervision/guidance of the safe use of this product and are aware of the hazards involved. This product is not a toy, do not let children play with the cleaning machine to avoid accidents which may cause severe injury.
10. When connected to the power supply, the appliance should not be left unattended.
11. There is a marked position on hose indicates steam jet outlet. Which should be paid attention when use. **DO NOT touch outlet while machine is working.**
12. **TORNADO T8 produces hot water and steam above 100°C. Any chemical solutions such as rust remover, aromatic agent, alcohol and detergent filling into water tank filling are FORBIDDEN during working. Please beware such additives may cause damage to the machine which does NOT comply with the warranty policy.**
13. Although decompress valve designed with safety lock. **DO NOT attempt to open decompression valve during machine in operation or before machine completely cooled down.** Doing so may lead to potential serious injuries caused by hot steam or damage to the equipment.

Diagram and packing list

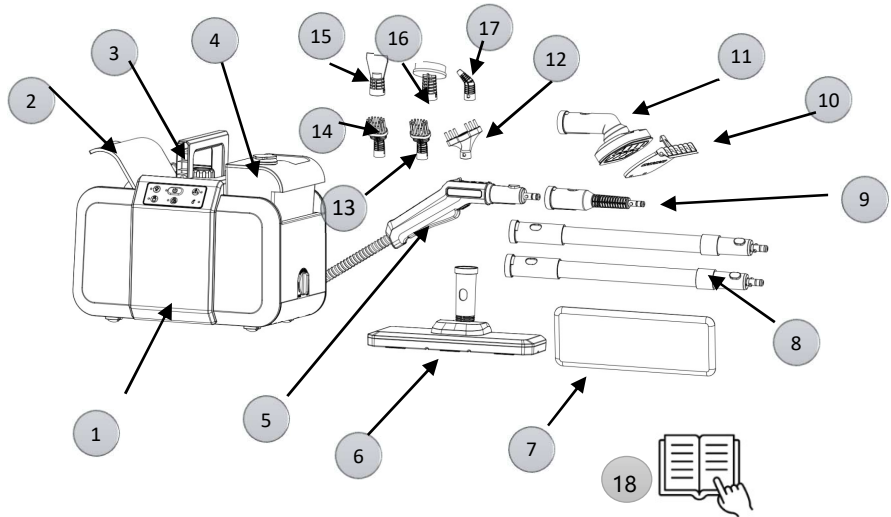

- | | | |
|--------------------|---------------------|--------------------------|
| 1 Main body | 2 Storage cabin Lid | 3 Carry handle |
| 4 Water tank | 5 Hose handle | 6 Mop board |
| 7 Mop head | 8 Extended tubes | 9 Brush nozzle connector |
| 10 Classes scraper | 11 Flat board | 12 Crevice nozzle |
| 13 Bristle brush | 14 Steel brush | 15 Shoal |
| 16 Polisher | 17 Curve jet nozzle | 18 Manual instruction |

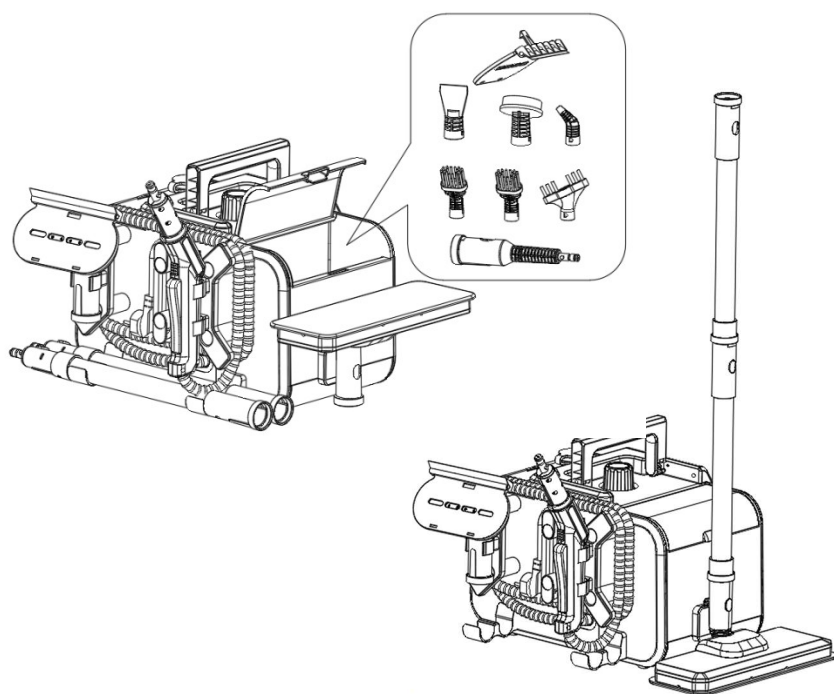
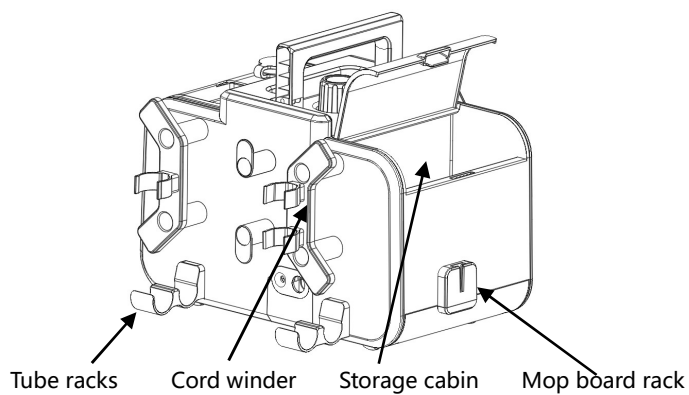

Product overview

Product assembly & disassembly

Extended tubes

Align tubes guideline with slot, push till heard "click". Push down the locker button and pull it out gently to disassemble.

Nozzle connector, mop board

Align nozzle connector's slot with extend tube's guideline, insert completely till heard "click". Push down the lock button and gently pull it out to disassemble.

Classes scraper

Align two pins with slot on the board. Push the class scraper to lock with the main board. Push release locker to disassemble the scraper.

Assorted nozzles

Align nozzle's guide slot with nozzle connector, insert complete then turn it clockwise to lock it firmly. anticlockwise it to disassemble.

Mop head

Hook-and-Loop fastener joint. Align mop head to mop board to sticks on. Gently tears off for mop head cleaning.

Interface instructions

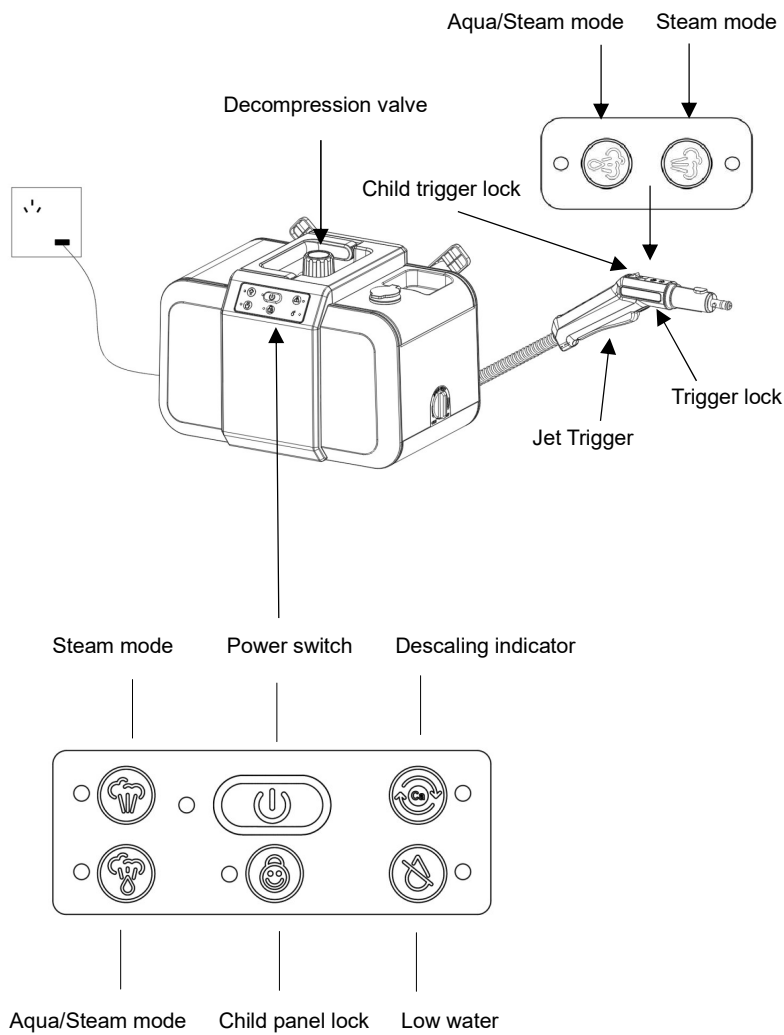

How to use

1. Lift water tank, fill up the water tank with clean water. Plug in the water inlet and sit back to the machine. Directly water top up without lifting tank is allowed, if by this way, a funnel utensil is recommended. **Water tank should be filled before power is connected. Do not exceed the highest water level mark.**

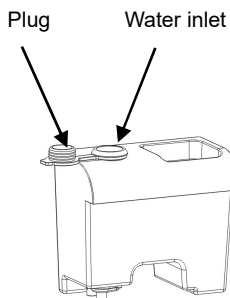
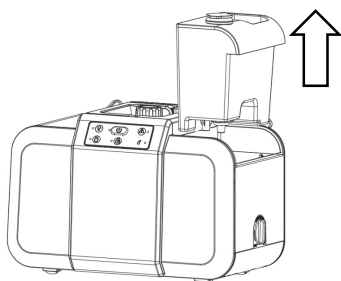

2. Connect the power plug to power socket and press switch button to switch on the machine, indicating light turns solid red.
3. **Confirm Depression Valve (see page 8) is tightened by turning it clockwise.**
4. Choose working mode, steam mode or AquaSteam mode. Preheating takes 2-3 minutes, indicating light will keep blinking during preheating.
5. When indicating light turns solid, machine is ready to use. Press Jet Trigger to jet steam, release trigger to stop. Child lock and trigger lock to be used when needed.
6. "Beeps" reminder will be activated when water tank is empty, indicating light  will be solid on too. **Top up water in time.** Water topping up could be done without machine operation interruption.

Technical parameters

Product name:	IMASS Steam Cleaner
Product model:	TORNADO T8
Rated voltage	220-240V~ 50Hz
Rated power:	2200W
Water tank capacity	2300 ml
Boiler capacity	1000 ml
Net weight:	8.20 kgs
Main product dimensions:	L426mm*W364mm*H257mm
Noise level:	70 dba
Hot water capacity:	125-155 g/min.
Steam Pressure	4.5 - 5.5 bar
Relief pressure:	5.5-7.5 bar
Steam capacity:	45-65 g/min
Steam temperature:	120-140°C
Length of power cord	5 meters

Product upgrade and parameters modification will be updated without prior notice.

Maintenance

General maintenance

Unplug power, wait till machine cools down. Use damp soft cloth gently wipe machine.

Water tank filter cleaning

Disassemble water tank filter and clean up filter when needed

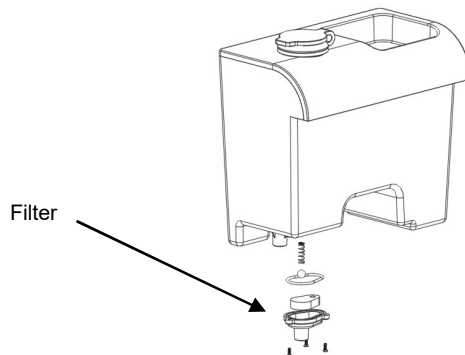

Boiler descaling and magnesium rod replacement

Regular descaling and mag rod replacement will maximum the products life span. Make sure machine is completely cooled down to go ahead flowing steps. Although decompress valve designed with safety lock. **DO NOT attempt to open decompression valve during machine in operation or before machine completely cooled down.** Doing so may lead to potential serious injuries caused by hot steam and/or damage to the equipment.

1. When countdown reaches 100 hours, descaling indicating  start to slow blink accompanied with "Beeps". Please descaler boiler and replace magnesium rod. Magesium rod life span may differ depending on lock water quality. Mag rod replacement may be needed even working hours are shorter than 100 hours. Regular mag rod consumption checking up is recommended.

2. Anticlockwise turns to unscrew the Decompression Valve.

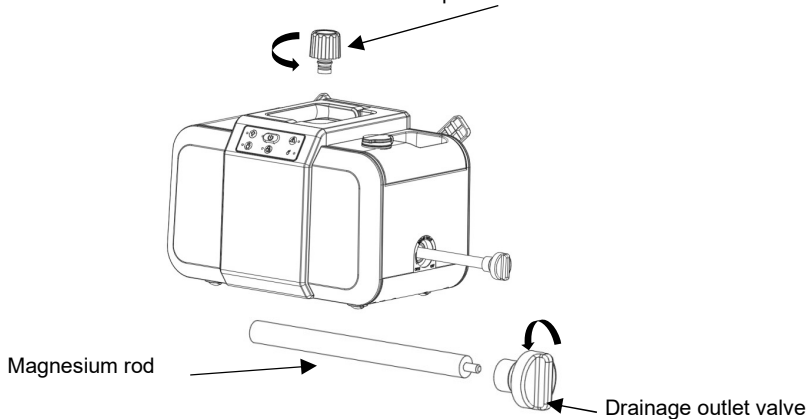

3. Follow descaling agent instructions to fill up descaling agent into boiler, leave it for 30-60 minutes. Unscrew drain outlet valve, empty boiler.
4. Fill up clean water into boiler, unscrew drain outlet valve to empty boiler again. Do such boiler rinse 1-2 times.
5. Replace magnesium rod.
6. Assemble drainage outlet and decompression valve firmly.
7. Long press descaling button for 5 seconds to reset.

Trouble shooting and solution guide

Issues	Solutions
No power	<ol style="list-style-type: none">1. Make sure power plug is plugged in socket firmly2. Try another power socket3. Check the power cord, if cord broken seek for electric technician
No steam	<ol style="list-style-type: none">1. Make sure water tank is filled with water.2. Press to choose Steam mode or AquaSteam mode first, wait 2-3 minutes for preheating till indicating be solid on. Then try again.
Steam triggers not working	<ol style="list-style-type: none">1. Make sure child lock is released.
Panel buttons no reaction	<ol style="list-style-type: none">1. Make sure child lock is released.
Decompression valve can't be opened	<ol style="list-style-type: none">1. Decompression valve can only be opened when machine is completely cooled down. Wait patiently and try again later

After-sale service Warranty

- 1.Product is under two years warranty from the purchase date.
- 2.Please keep your invoice/receipt as purchase evidence for warranty claim.
- 3.It is essential to follow the instructions provided for optimal troubleshooting support.
The manual offers a comprehensive troubleshooting guide for resolving common issues. Should these steps prove ineffective, additional assistance can be sought from authorized service centers or local retailers.
- 4.Damages resulting from misuse, accident, improper maintenance, or exposure to potentially harmful conditions are excluded from warranty.
- 5.Consumer items/parts, if any, are not under warranty coverage.

Warranty Card

Customer name	
Phone number	
Address	
Product model	
Serial number	
Purchase date	
Retailor	

Service record

Date of lodgment	Description	Service Date



[www.imass.com..au](http://www.imass.com.au)