

Description

In-line hydraulic check valve with orifice
Straight thread connector
SAE -10 male O-ring boss to JIC -6 male 37° flare

Features

Steel construction components
Springless check disc
Different orifices or blocked orifice available

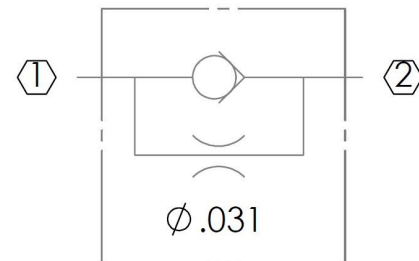

Specifications

Maximum Operating Pressure: 3000 psi
Nominal Flow Capacity: 6 gpm
Operating Temperature: -40 °F to 210 °F
Fluids: Mineral-based hydraulic fluids