



AIR CURTAIN

COMMERCIAL / INDUSTRIAL SERIES

■ APPLICATIONS

SHUT-OUT FUNCTION

- This air curtain performs as an invisible door and best for doorway with frequent customers/staff traffic, e.g. restaurants, shopping malls, shops, warehouses, etc.
- Heating/cooling retention efficiency of 70-90% helps lower air-conditioning cost
- Blocking out unpleasant elements like dust, fumes, odors and insects, best for fruit stores, grocery stores, butcher shops, etc.

ZONING FUNCTION

- Perfect for separating air conditioning zone and non-air-conditioning zone; smoking area and non-smoking area
- Ideal for application in bowling alleys, lounges, lobbies and rest areas

CIRCULATION FUNCTION

- Facilitate air circulation in spacious areas
- Ideal for application in halls and lobbies



PRODUCT



Enclosed Louver(L2)

Punch Hole Louver (L1)

FM08, FM10 and FM12-series

DESCRIPTION



ADJUSTABLE AIR DEFLECTION VENTS

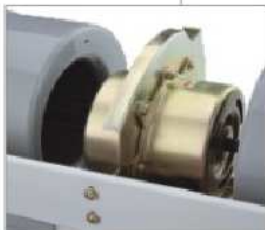

MOTORS
 • high performance
 • built-in thermal cut-out protection



PUSH BUTTON SWITCH
 • 2-speed or 3-speed control



SIROCCO FAN
 • high air velocity
 • quiet operation



REMOTE CONTROL
 • Remote control & light touch switch



AIR CURTAIN

SPECIFICATIONS

Model	Size(Length) mm	Volt/Hz	Speed Regulation	Input Power W	Current A	Speed R.P.M	Air Velocity m/s	Sound Level dB(A)
FM0809 FM0809RC	900	220/50	HI	80	0.32	1280	9	42
LO			60	0.27	1120	7	39	
FM0812 FM0812RC	1200	220/50	HI	85	0.34	1280	9	43
LO			65	0.28	1120	7	41	
FM1009 FM1009RC	900	220/50	HI	90	0.37	1380	10	46
LO			70	0.28	1250	8.5	42	
FM1012 FM1012RC	1200	220/50	HI	110	0.45	1380	10	46
LO			90	0.36	1250	8.5	42	
FM1209 FM1209RC	900	220/50	HI	242	1.065	2150	18	55
LO			211	0.99	1850	15	50	
FM1210 FM1210RC	1000	220/50	HI	242	1.065	2150	18	55
LO			211	0.99	1850	15	50	
FM1212 FM1212RC	1200	220/50	HI	300	1.33	2150	18	56
LO			274	1.27	1850	15	51	
FM1215 FM1215RC	1500	220/50	HI	392	1.73	2150	18	56
LO			348	1.63	1850	15	51	
FM1209A FM1209ARC	900	220/50	HI	242	1.065	2150	18	55
ME			211	0.99	1850	15	50	
LO			195	0.95	1650	11	47	
FM1210A FM1210ARC	1000	220/50	HI	242	1.065	2150	18	55
ME			211	0.99	1850	15	50	
LO			195	0.95	1650	11	47	
FM1212A FM1212ARC	1200	220/50	HI	300	1.33	2150	18	56
ME			274	1.27	1850	15	51	
LO			261	1.24	1650	11	48	
FM1215A FM1215ARC	1500	220/50	HI	392	1.73	2150	18	56
ME			348	1.63	1850	15	51	
LO			326	1.58	1650	11	48	

DIMENSIONS(mm)

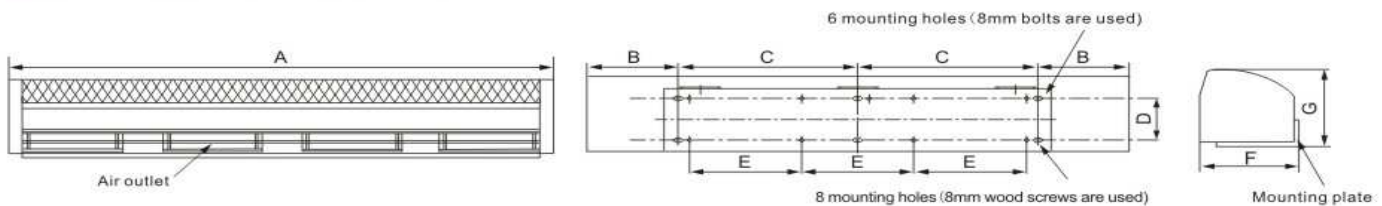

FM08, FM10 and FM12-series

Model	A	B	C	D	E	F	G
FM0809 / FM0809RC FM1009 / FM1009RC FM1209 / FM1209RC FM1209A / FM1209ARC	900	51.5	400	113	250	222	212
FM1210 / FM1210RC FM1210A / FM1210ARC	1000	101.5	400	113	250	222	212
FM0812 / FM0812RC FM1012 / FM1012RC FM1212 / FM1212RC FM1212A / FM1212ARC	1200	201.5	400	113	250	222	212
FM1215 / FM1215RC FM1215A / FM1215ARC	1500	351.5	400	113	250	222	212

PRODUCT



FM15-series



FM19-series



FM16-series



RM19-series

DESCRIPTION

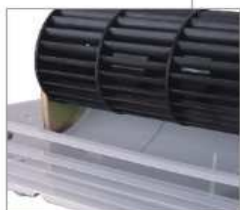

ADJUSTABLE AIR DEFLECTION VENTS



MOTORS
 • high performance
 • built-in thermal cut-out protection



PUSH BUTTON SWITCH
 • 2-speed or 3-speed control



SIROCCO FAN
 • high air velocity
 • quiet operation



REMOTE CONTROL
 • remote control & light touch switch



SPECIFICATIONS

Model	Size/(Length) mm	Volt/Hz	Speed Regulation	Input Power W	Current A	Outlet Air Velocity m/s	Speed R.P.M	Air Volume (m ³ /n)	Sound Level dB(A)
FM1506 / FM1506RC	600	220/50	HI	150	0.87	13	1230	1480	53
FM1606 / FM1606RC			LO	115	0.53	10	990	1260	50
FM1509 / FM1509RC	900	220/50	HI	200	0.91	13.5	1089	2400	54
FM1609 / FM1609RC			LO	170	0.78	10.5	943	2040	51
FM1512 / FM1512RC	1200	220/50	HI	335	1.53	14	1100	3380	57
FM1612 / FM1612RC			LO	295	1.34	11	976	2870	53
FM1515 / FM1515RC	1500	220/50	HI	360	1.64	14	1080	4620	60
FM1615 / FM1615RC			LO	330	1.51	11	956	3930	56
FM1909 / FM1909RC	900	200/60	HI	140	0.64	12	1500	1240	65
			ME	125	0.56	10	1300	1130	62
			LO	115	0.54	8	1100	1000	59
			HI	158	0.73	12	1500	1470	65
FM1910 / FM1910RC	1000	200/60	ME	140	0.64	10	1300	1300	62
			LO	135	0.6	8	1100	1100	59
			HI	160	0.75	12	1500	1730	65
			ME	145	0.66	10	1300	1540	62
FM1912 / FM1912RC	1200	200/60	LO	138	0.61	8	1100	1370	59
			HI	248	1.13	12	1500	2250	65
FM1915 / FM1915RC	1500	200/60	ME	240	1.09	10	1300	1940	62
			LO	230	1.05	8	1100	1640	59
			HI	6200	9	7.6	1600	930	61
			ME	6200	9	6.8	1500	860	59
RM1909 / RM1909RC	900	380/60	LO	6100	9	6.3	1400	800	57
			HI	7200	10	7.5	1600	1050	62
RM1910 / RM1910RC	1000	380/60	ME	7200	10	7	1500	990	60
			LO	7200	10	6.4	1400	960	57
			HI	7400	11	7.7	1600	1300	63
			ME	7400	11	7.2	1500	1200	61
RM1912 / RM1912RC	1200	380/60	LO	7400	11	6.7	1400	1110	59
			HI	9200	13	7.6	1600	1690	63
RM1915 / RM1915RC	1500	380/60	ME	9200	13	7.4	1500	1560	61
			LO	9200	13	6.7	1400	1480	59



DIMENSIONS (mm)

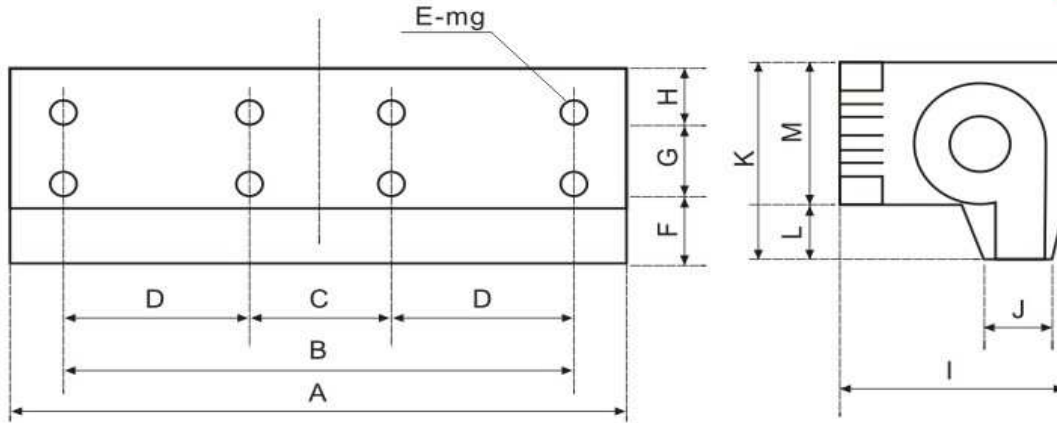

FM15-series
FM16-series

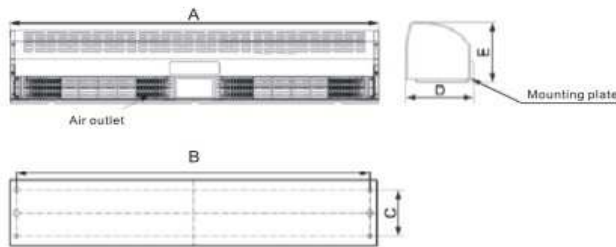

RM19-series

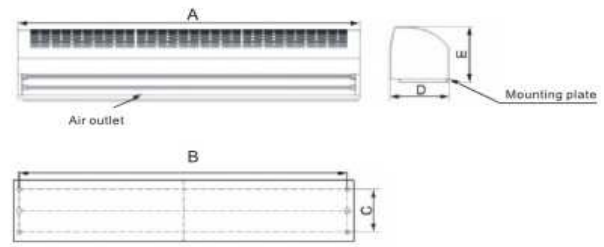

FM19-series

Model	A	B	C	D	E	F	G	H	I	J	K	L	M
FM1506 / FM1506RC FM1606 / FM1606RC	600	500	—	250	6	80	100	35	266	104	265	45	220
FM1509 / FM1509RC FM1609 / FM1609RC	900	800	160	320	8	80	150	35	266	104	265	45	220
FM1512 / FM1512RC FM1612 / FM1612RC	1200	1000	220	440	8	80	150	35	266	104	265	45	220
FM1515 / FM1515RC FM1615 / FM1615RC	1500	1400	220	590	8	80	150	35	266	104	265	45	220
FM1909 / FM1909RC RM1909 / RM1909RC	900	868	120	219	199	—	—	—	—	—	—	—	—
FM1910 / FM1910RC RM1910 / RM1910RC	1000	968	120	219	199	—	—	—	—	—	—	—	—
FM1912 / FM1912RC RM1912 / RM1912RC	1200	1168	120	219	199	—	—	—	—	—	—	—	—
FM1915 / FM1915RC RM1915 / RM1915RC	1500	1468	120	219	199	—	—	—	—	—	—	—	—



ACC01 Series air curtain performs as an invisible door and best for doorway with frequent customers/staff traffic. e.g. restaurants, shopping malls, shops, warehouses, etc.

- As an invisible door for shut-out function, zoning function and circulation function.
- Rust proof air curtains with quality ABS casing and well sealing terminal box and enclosed motor
- Simple and aesthetic silhouette casing perfectly match with modern interior design
- Durable & reliable motor with high performance enclosed motor & ball bearing
- Well balanced plastic centrifugal fan wheel for quiet and stable operation
- Wide size range : 900mm, 1200mm, 1500mm
- Optional remote control or push button switch
- Optional filter net at air inlet
- Quick-fit installation feature with installation wall plate.

SPECIFICATION

Model Number	Dimension (mm)	Voltage	Input Power (W)	Sound Level (dB(A))	Air Velocity (m/s)
ACC01-1009F1S	900 x 230 x 214	220V~50Hz	High: 89 Low: 72	High: 45 Low: 42	High: 10 Low: 8.6
ACC01-1009F1RC	900 x 230 x 214	220V~50Hz	High: 89 Low: 72	High: 45 Low: 42	High: 10 Low: 8.6
ACC01-1012F1S	1200 x 230 x 214	220V~50Hz	High: 106 Low: 86	High: 46 Low: 43	High: 10 Low: 8.6
ACC01-1012F1RC	1200 x 230 x 214	220V~50Hz	High: 106 Low: 86	High: 46 Low: 43	High: 10 Low: 8.6
ACC01-1015F1S	1500 x 230 x 214	220V~50Hz	High: 142 Low: 118	High: 46 Low: 43	High: 10 Low: 8.6
ACC01-1015F1RC	1500 x 230 x 214	220V~50Hz	High: 142 Low: 118	High: 46 Low: 43	High: 10 Low: 8.6
ACC01-1409F1S	900 x 230 x 214	220V~50Hz	High: 200 Low: 164	High: 55 Low: 53	High: 14 Low: 12.5
ACC01-1409F1RC	900 x 230 x 214	220V~50Hz	High: 200 Low: 164	High: 55 Low: 53	High: 14 Low: 12.5
ACC01-1412F1S	1200 x 230 x 214	220V~50Hz	High: 250 Low: 190	High: 57 Low: 54	High: 14 Low: 12.5
ACC01-1412F1RC	1200 x 230 x 214	220V~50Hz	High: 250 Low: 190	High: 57 Low: 54	High: 14 Low: 12.5



DESCRIPTION

FM12 Series is a centrifugal air curtain designed for different application requirement, including entrance shopping malls, restaurants, convenience stores, super markets, warehouses, department stores, lobbies, etc.

- As an invisible door for shut-out function, zoning function and circulation function.
- Wide size range: 3ft/900mm, 3.3ft/1000mm, 4ft/1200mm, 5ft/1500mm for specific models
- Optional push button or remote control switch (RC)
- Optional 2-speed or 3-speed
- Various louver design for selection
- Quiet operation

SPECIFICATION

Model No.	Dimension (mm)	Voltage	Input Power (W)	Sound Level (dB(A))	Speed (R.P.M)	Air Volume (m³/h)
FM1209	900 x 222 x 212	220V~50Hz	High: 242 Low: 211	High: 55 Low: 50	High: 2150 Low: 1850	High: 1400 Low: 1230
FM1209RC	900 x 222 x 212	220V~50Hz	High: 242 Low: 211	High: 55 Low: 50	High: 2150 Low: 1850	High: 1400 Low: 1230
FM1210	1000 x 222 x 212	220V~50Hz	High: 242 Low: 211	High: 55 Low: 50	High: 2150 Low: 1850	High: 1400 Low: 1230
FM1210RC	1000 x 222 x 212	220V~50Hz	High: 242 Low: 211	High: 55 Low: 50	High: 2150 Low: 1850	High: 1400 Low: 1230
FM1212	1200 x 222 x 212	220V~50Hz	High: 300 Low: 274	High: 56 Low: 51	High: 2150 Low: 1850	High: 1850 Low: 1600
FM1212RC	1200 x 222 x 212	220V~50Hz	High: 300 Low: 274	High: 56 Low: 51	High: 2150 Low: 1850	High: 1850 Low: 1600
FM1215	1500 x 222 x 212	220V~50Hz	High: 392 Low: 384	High: 56 Low: 51	High: 2150 Low: 1850	High: 2350 Low: 2050
FM1215RC	1500 x 222 x 212	220V~50Hz	High: 392 Low: 384	High: 56 Low: 51	High: 2150 Low: 1850	High: 2350 Low: 2050



DESCRIPTION

FM2509 - Air Circuator for spaces and precise temperature control

- Ideal for places such as pedestrian subway, underpass, tunnel, etc.
- Ductless system saves the cost of ducts installation.
- Easy installation by means of simple mounting to suspension bolts from the ceiling.

SPECIFICATION

Model No.	Dimension (mm)	Voltage	Input Power (W)	Sound Level (dB(A))	Air Volume (m ³ /h)
FM2509	900 x 225 x 235	220V~50Hz	78	<50	1050



DESCRIPTION

FM31, 32, 33 Series perform as an invisible door and best for doorway with frequent customers/staff traffic, e.g. restaurants, shopping malls, shops, warehouses, etc.

- Blocking out unpleasant elements like dust, fumes, odors and insects, best for fruit stores, grocery stores, butcher shops, bakery, etc.
- Heating/cooling retention efficiency of 70-90% helps lower air-conditioning cost
- Perfect for separating air conditioning zone and non-air-conditioning zone; smoking area and non-smoking area
- Ideal for application in bowling alleys, lounges, lobbies and rest areas butcher shops, etc.
- Facilitate air circulation in spacious areas

SPECIFICATION

Model No.	Dimension (mm)	Voltage	Input Power (W)	Sound Level (dB(A))	Air Volume (m³/min)
FM3109	900 x 212 x 230	220V~50Hz	325	44	17
FM3112	1200 x 212 x 230	220V~50Hz	420	45	22
FM3115	1500 x 212 x 230	220V~50Hz	535	48	28
FM3209	900 x 212 x 230	220V~50Hz	400	46	21
FM3212	1200 x 212 x 230	220V~50Hz	540	47	28
FM3215	1500 x 212 x 230	220V~50Hz	670	50	35
FM3309	900 x 212 x 230	220V~50Hz	450	52	25
FM3312	1200 x 212 x 230	220V~50Hz	600	54	34
FM3315	1500 x 212 x 230	220V~50Hz	750	55	42



AIR VELOCITY / DISTRIBUTION CHART (m/s)

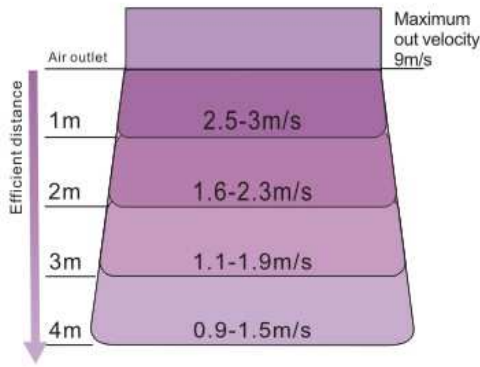

FM08-series

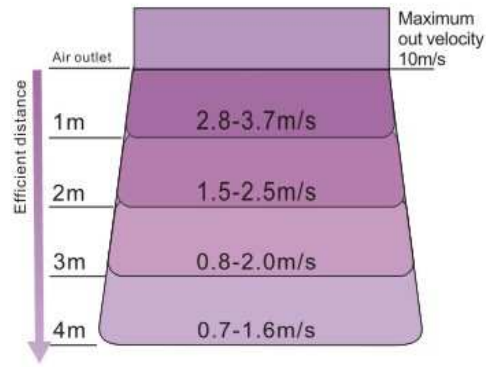

FM10-series

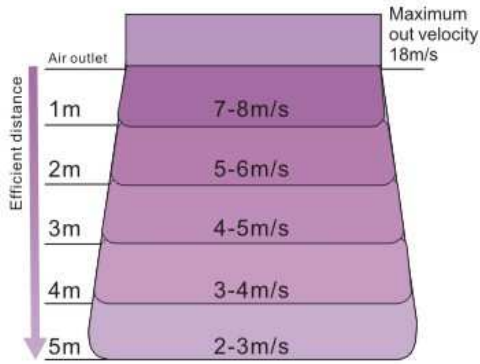

FM12-series

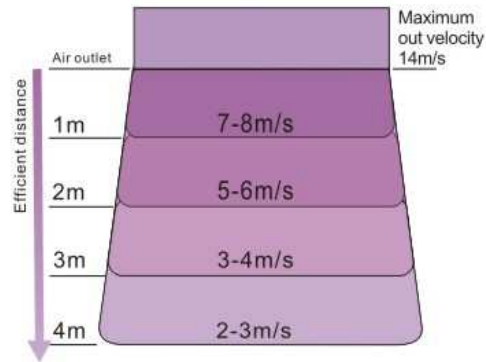

FM15 and 16-series

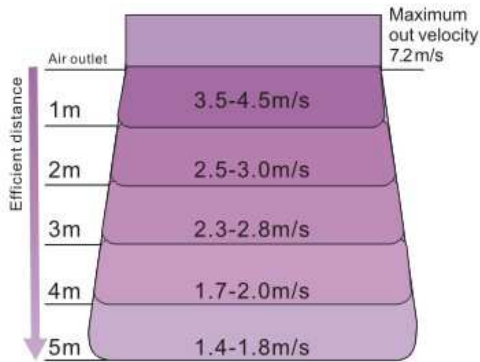

RM19-series

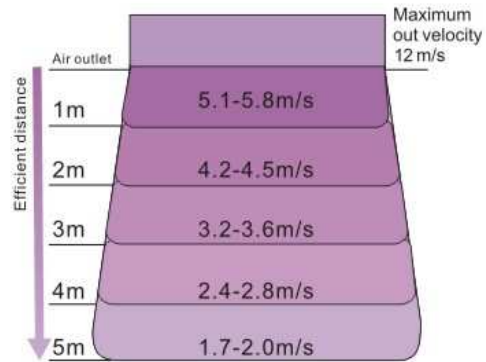

FM19-series



Main Office :

WOLFrost International LLP

India & Far East

for more information VISIT

www.wolfmep.com

Regional Sales & After Sales Service Contact :

WOLF International - SAIF ZONE

Middle East & North Africa

Contact :

info@wolfmep.com