

ALUMINUM PRODUCTS



ECCO™ is proud to be a member of:



SMACNA
Sheet Metal and Air
Conditioning Contractors'
National Association
www.smacna.org



HRAI
Heating, Refrigeration and
Air Conditioning
Institute of Canada
www.hrai.ca



HARDI
Heating, Air-conditioning
& Refrigeration
Distributors International
www.hardinet.org



ADI
Air
Distribution
Institute
www.steelduct.org



AD
Affiliated Distributors™
www.adhq.com



CME
Canadian
Manufacturers &
Exporters
www.cme-mec.ca



SPIDA
Spiral Duct
Manufacturers
Association
www.spida.org



INDEX

45° SADDLE WYES	C1-5
90° ELBOWS	C1-3
90° TEE STUBS — LESS SADDLE.....	C1-6
CHIMNEY LINERS	
2-PLY	C1-7
2-PLY — CARTON	C1-7
CAP ASSEMBLY	C1-9
CAP ASSEMBLY — 5" EXTENSION.....	C1-8
EXTENSIONS — 2-PLY — WITH COUPLER.....	C1-9
KITS.....	C1-8
CHINA CAPS.....	C1-6
DRYER VENT HOODS	C1-6
ECCO-FLEX DUCTING — 1-PLY	C1-6
FLEX COUPLERS	C1-7
FLEX VENT SPACERS	C1-7
INCREASERS — SPUN	C1-4
PIPE — SNAP LOCK.....	C1-3
PLUGS/TEE CAPS — SPUN.....	C1-5
REDUCERS — SPUN.....	C1-4
TEE REDUCERS.....	C1-3
TEE REDUCERS WITH TABS.....	C1-4
VENT TEES.....	C1-4
WYE BRANCHES	C1-5

LEGEND

NOTE: The boxed columns throughout the tables are intended to provide a quick determination of ordering dimensions.

ABBREVIATIONS: CTN/QTY = Carton Quantity
WT/100 = Weight per 100 Pieces
WT/100 FT = Weight per 100 Feet
PCS/BNDL = Pieces per Bundle
LGTH/CTN = Length per Bundle

PIPE — SNAP LOCK

ITEM #	SIZE (")	THICKNESS	A (")	B (")	GA	PCS/BNDL	WT/100 FT
301200	3 × 24	.016	3	24	26	50/Ctn	20
301300	4 × 24	.016	4	24	26	50/Ctn	26
301252	3 × 36	.020	3	36	24	30	27
301351	4 × 36	.020	4	36	24	30	34
301254	3 × 60	.020	3	60	24	25	27
301352	4 × 36	.025	4	36	22	30	43
301452	5 × 36	.025	5	36	22	30	40
301462	6 × 36	.025	6	36	22	30	50
301472	7 × 36	.025	7	36	22	30	56
301482	8 × 36	.025	8	36	22	30	63
301483	9 × 36	.025	9	36	22	30	70
301484	10 × 36	.025	10	36	22	30	75
301498	12 × 36	.025	12	36	22	30	89
301500	14 × 36	.025	14	36	20	30	104
301354	4 × 60	.025	4	60	22	50	43
301485	5 × 60	.025	5	60	22	50	40
301486	6 × 60	.025	6	60	22	50	50
301487	7 × 60	.025	7	60	22	50	56
301488	8 × 60	.025	8	60	22	50	63

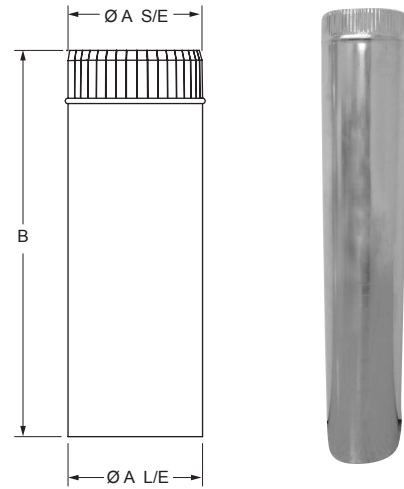

90° ELBOWS

ITEM #	SIZE	THICKNESS	GA	A (")	B (")	C (")	CTN/QTY	WT/100
302002	3" × 90°	.020	24	3	2-11/16	2-11/16	20	20
302102	4" × 90°	.025	22	4	2-7/8	2-3/8	20	37
302202	5" × 90°	.025	22	5	2-5/8	2-1/8	20	35
302302	6" × 90°	.025	22	6	2-11/16	2-11/16	20	65
302402	7" × 90°	.025	22	7	2-7/8	2-3/4	12/Bndl	59
302502	8" × 90°	.025	22	8	3	3-1/4	12/Bndl	75
302702	10" × 90°	.025	22	10	3-1/8	3-1/8	4/Bndl	102
302802	12" × 90°	.025	22	12	3-1/2	4-1/8	4/Bndl	150
302902	14" × 90°	.025	20	13-15/16	3-3/4	4-1/2	4/Bndl	168

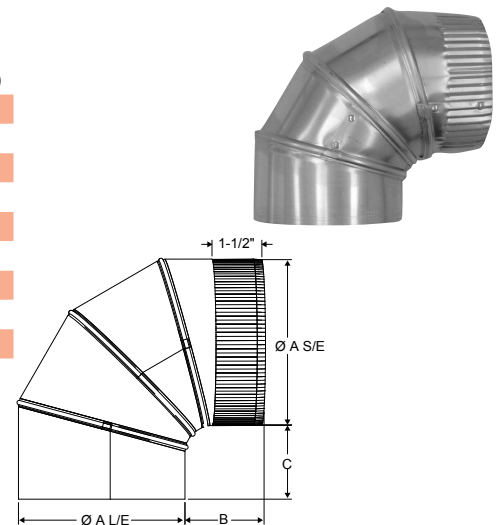

TEE REDUCERS

ITEM #	SIZE (")	A (")	CTN/QTY	WT/100
309304	4	4	50	6
309305	5	5	50	10
309306	6	6	50	11
309307	7	7	50	17
309308	8	8	50	18

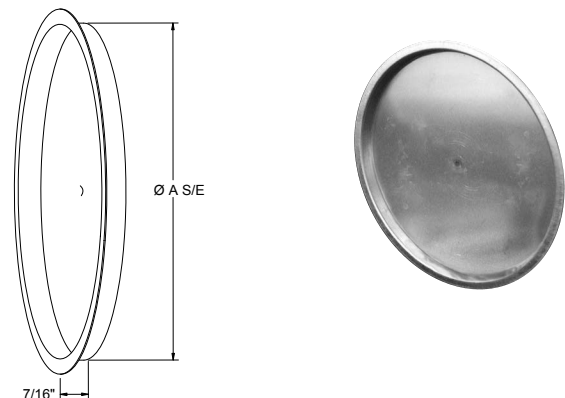

- E.&O.E. - Subject to Change Without Notice - May Not Be Available At All Locations -

TEE REDUCERS WITH TABS

ITEM #	SIZE (")	A (")	B (")	CTN/QTY	WT/100
309404	4-3	4	3	50	10
309405	5-4	5	4	50	6
309406	6-4	6	4	50	9

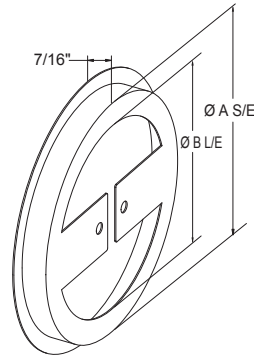

REDUCERS — SPUN

ITEM #	SIZE (")	A (")	B (")	CTN/QTY	WT/100
132800	4-3	4	3	20	18
132700	5-4	5	4	20	23
132650	6-4	6	4	20	33
132600	6-5	6	5	20	30
132500	7-4	7	4	10	40
132400	7-5	7	5	10	50
132300	7-6	7	6	10	40
132200	8-6	8	6	10	60
132100	8-7	8	7	10	53

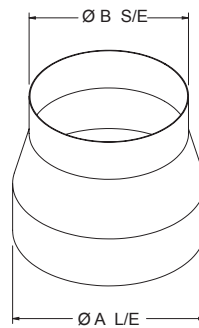

INCREASERS — SPUN

ITEM #	SIZE (")	A (")	B (")	CTN/QTY	WT/100
304543	3-4	3	4	20	14
304553	3-5	3	5	20	19
304554	4-5	4	5	20	19
304564	4-6	4	6	20	26
304574	4-7	4	7	10	33
304565	5-6	5	6	20	24
304575	5-7	5	7	10	33
304576	6-7	6	7	10	36
304586	6-8	6	8	10	32
304587	7-8	7	8	10	30

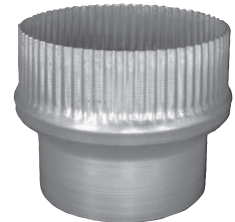
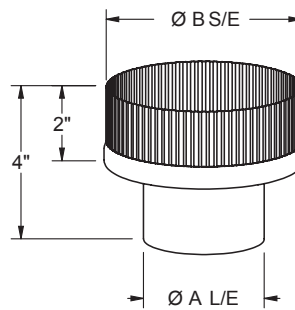

VENT TEES

ITEM #	SIZE (")	A (")	B (")	C (")	CTN/QTY	WT/100
304403	3 x 3 x 3	3	3	3	20	46
304404	4 x 4 x 4	4	4	4	20	50
304405	5 x 5 x 5	5	5	5	20	62
304406	6 x 6 x 6	6	6	6	20	72

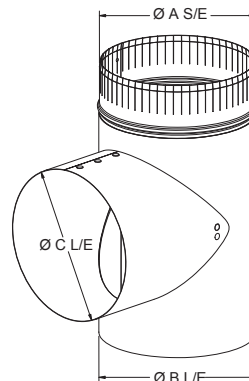

-E.&O.E. - Subject to Change Without Notice - May Not Be Available At All Locations -

WYE BRANCHES

ITEM #	SIZE (")	A (")	B (")	C (")	CTN/QTY	WT/100
304424	4 x 4 x 4	4	4	4	20	38
304436	5 x 4 x 3	5	4	3	20	38
304437	5 x 4 x 4	5	4	4	20	42
304425	5 x 5 x 5	5	5	5	20	48
304438	6 x 4 x 3	6	4	3	20	48
304440	6 x 5 x 3	6	5	3	20	42
304441	6 x 5 x 4	6	5	4	20	48
304426	6 x 6 x 6	6	6	6	10	64
304442	7 x 5 x 3	7	5	3	10	50
304444	7 x 6 x 3	7	6	3	10	52
304445	7 x 6 x 4	7	6	4	10	54
304427	7 x 7 x 7	7	7	7	10	78

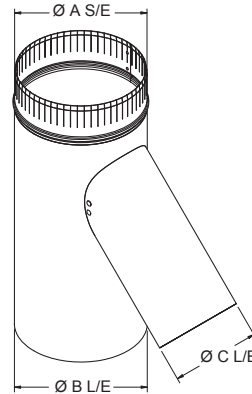

45° SADDLE WYES

ITEM #	SIZE	A (")	CTN/QTY	WT/100
304103	3" x 45°	3	20	25
304104	4" x 45°	4	20	30
304105	5" x 45°	5	10	58
304106	6" x 45°	6	10	58

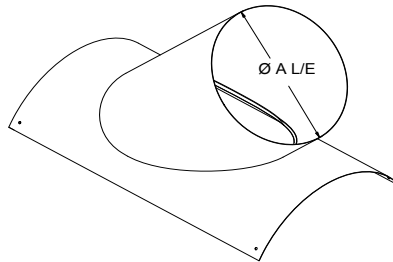

PLUGS/TEE CAPS — SPUN

ITEM #	SIZE (")	A (")	CTN/QTY	WT/100
350903	3	3	20	10
350904	4	4	20	10
350905	5	5	20	15
350906	6	6	20	20
350907	7	7	20	26
350908	8	8	20	32
350909	9	9	20	35
350910	10	10	20	40
350912	12	12	10	64
350914	14	14	10	70
350916	16	16	10	106
350918	18	18	10	105
350920	20	20	*	133
350922	22	22	*	156
350924	24	24	*	179

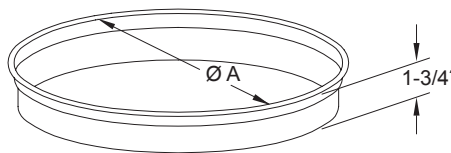

*Product shipped individually.

NOTES: Large end to fit over spiral pipe, + 1/8" (Cap)
 Small end to fit in spiral pipe, - 1/8" (Plug)
 Other sizes available upon request.

DRYER VENT HOODS

ITEM #	SIZE (")	A (")	B (")	C (")	CTN/QTY	WT/100
310100	3	3	6-3/4	6-5/16	20	48
310200	4	4	6-3/4	6-5/16	20	59
310300	5	5	8-5/8	7-11/16	20	60

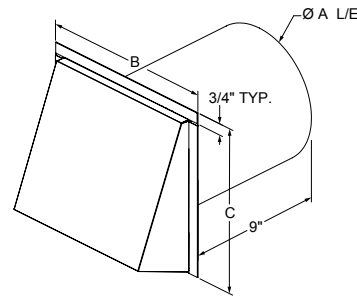

90° TEE STUBS — LESS SADDLE

ITEM #	SIZE (")	A (")	B (")	CTN/QTY	WT/100
304204	4	4	9-1/4	20	8
304205	5	5	9-3/4	20	10
304206	6	6	10	20	14

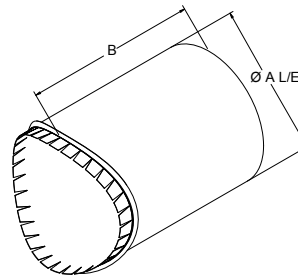

CHINA CAPS

ITEM #	SIZE (")	A (")	B (")	C (")	CTN/QTY	WT/100
304004	4	4	7-3/4	6	20	48
304005	5	5	9	6	20	55
304006	6	6	10-1/4	6	20	69
304007	7	7	12-1/4	6	10	80
304008	8	8	12-1/4	6	10	100

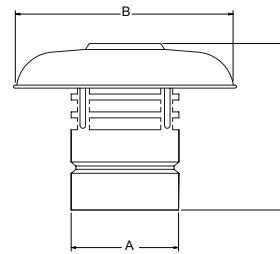

ECCO-FLEX DUCTING — 1-PLY

ITEM #	SIZE (")	A (")	B (")	CTN/QTY	WT/100 FT
300703	3	3	120	350	13
300704	4	4	120	200	16
300705	5	5	120	130	21
300706	6	6	120	90	24
300707	7	7	120	60	32
300708	8	8	120	50	34
300709	9	9	120	*	36
300710	10	10	120	*	39
300712	12	12	120	*	46
300714	14	13-15/16	120	*	52
300716	16	15-15/16	120	*	64
300718	18	17-7/8	120	*	72
300720	20	19-7/8	120	*	78
300722	22	21-7/8	120	*	86
300724	24	23-7/8	120	*	94
300744	4	4	240		16

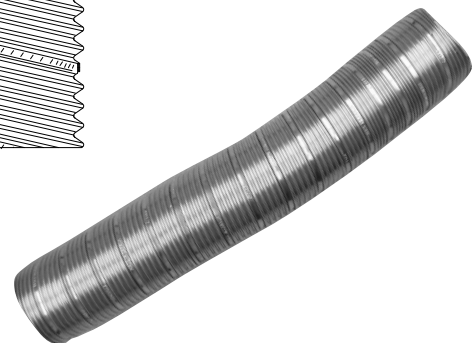
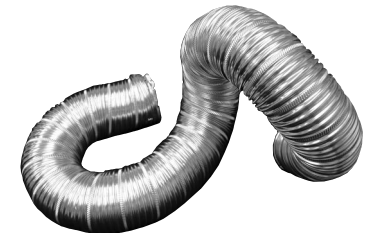
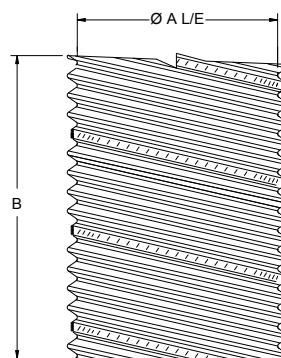

*Product shipped individually.

NOTE: For shipping purposes and to prevent damage 3" to 8" sizes are compressed to a 4 ft. length and 9" to 24" are compressed to a 5 ft. length.

— E.&O.E. — Subject to Change Without Notice — May Not Be Available At All Locations —

FLEX COUPLERS

ITEM #	SIZE	A (")	CTN/QTY	WT/100
300963	3	3	10	11
300964	4	4	10	15
300965	5	5	10	20
300966	6	6	10	24
300967	7	7	10	27
300968	8	8	10	31

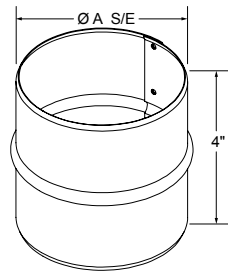

CHIMNEY LINERS — 2-PLY

ITEM #	SIZE	A (")	B (')	CTN/QTY	WT/100 FT
300907	7" x 25'	7	25	*	52
300908	8" x 25'	8	25	*	60
300937	7" x 35'	7	35	*	52
300938	8" x 35'	8	35	*	60
300953	3" x 50'	3	50	*	20
300954	4" x 50'	4	50	*	28
300955	5" x 50'	5	50	*	36
300956	6" x 50'	6	50	*	44
300957	7" x 50'	7	50	*	52
300958	8" x 50'	8	50	*	60

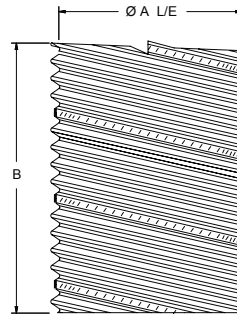

*Product shipped individually.

CHIMNEY LINERS — 2-PLY — CARTON

ITEM #	SIZE	A (")	B (')	CTN/QTY	WT/100 FT
300990	3" x 25'	3	25	1	530
300991	4" x 25'	4	25	1	730
300992	5" x 25'	5	25	1	930
300993	6" x 25'	6	25	1	1130
300996	3" x 35'	3	35	1	730
300997	4" x 35'	4	35	1	1010
300998	5" x 35'	5	35	1	1290
300999	6" x 35'	6	35	1	1570

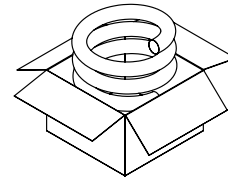
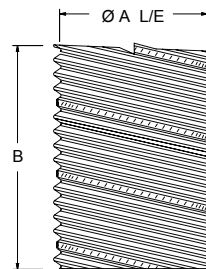

FLEX VENT SPACERS

ITEM #	DESCRIPTION	CTN/QTY	WT/100
670050	4" – 7" Aluminum Wire	240	1
670053	5" – 8" Aluminum Wire	200	1
670055	1" Stainless Steel Spring	300	4

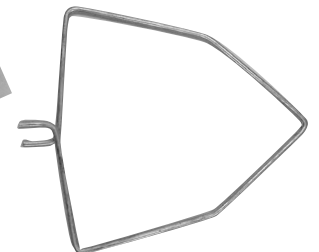
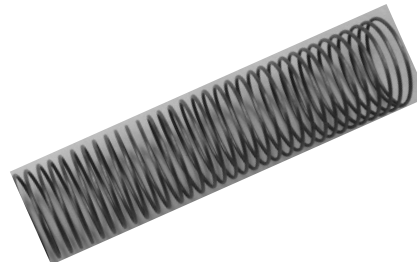

– E.&O.E. – Subject to Change Without Notice – May Not Be Available At All Locations –

CHIMNEY LINER KITS

ITEM #	SIZE	CTN/QTY	WT/100
301043	3" x 25'	1	1100
301044	4" x 25'	1	1350
301045	5" x 25'	1	1575
301046	6" x 25'	1	1750
301053	3" x 35'	1	1500
301054	4" x 35'	1	1850
301055	5" x 35'	1	2175
301056	6" x 35'	1	2525
301057	7" x 35'	1	2875
301058	8" x 35'	1	3225



Rain Cap

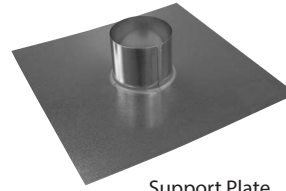

Support Plate



Mortar Sleeve



2-Ply Chimney Liner

Chimney Liner Kit includes:

1 – Rain Cap

1 – Support Plate

1 – Mortar Sleeve

1 – 2-Ply Chimney Liner

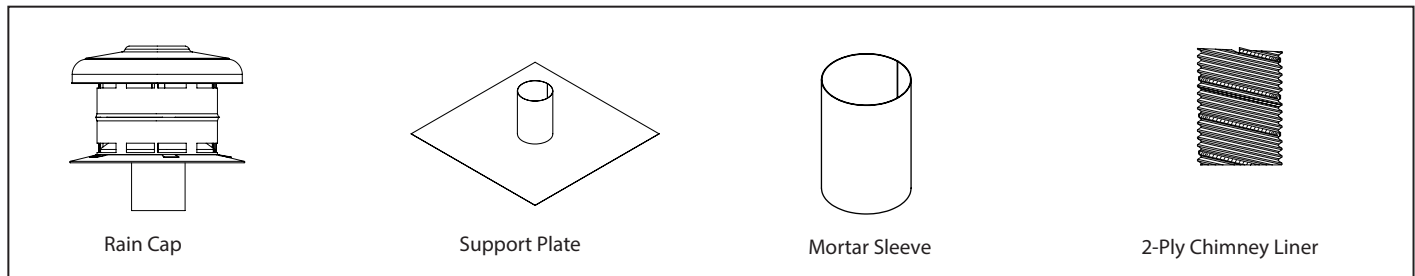

CHIMNEY LINER CAP ASSEMBLY — 5" EXTENSION

ITEM #	SIZE (")	A (")	CTN/QTY	WT/100
301023	3	3	*	400
301024	4	4	*	400
301025	5	5	*	400
301026	6	6	*	500
301027	7	7	*	500
301028	8	8	*	500

*Product shipped individually.

NOTE: Base – Galvanized / Cap – Aluminum

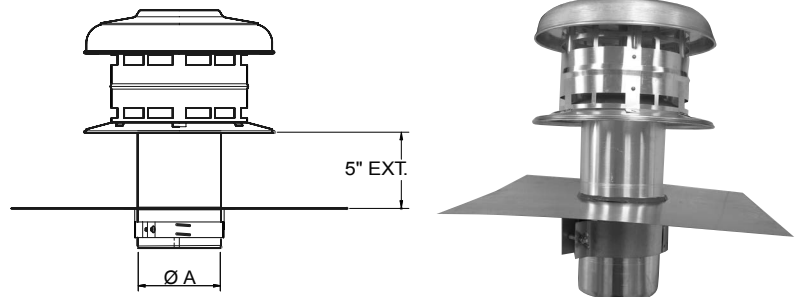

CHIMNEY LINER CAP ASSEMBLY

ITEM #	SIZE (")	A (")	B (")	C (")	D (")	CTN/QTY	WT/100
301003	3	3	8	6-1/8	4	*	285
301004	4	4	9-3/8	6-1/8	4	*	309
301005	5	5	10-3/4	7	4-1/2	*	323
301006	6	6	12-3/8	7	4-1/2	*	345
301007	7	7	14	7-3/4	5	*	368
301008	8	8	15-5/8	7-3/4	5	*	392

*Product shipped individually.

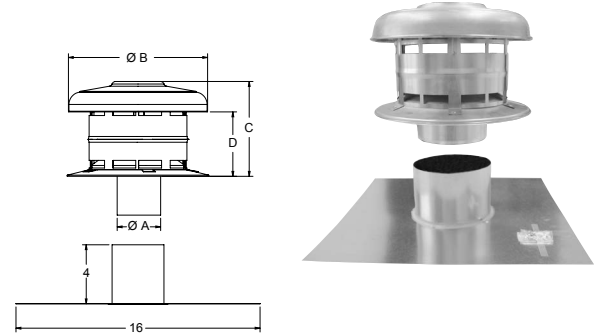

CHIMNEY LINER EXTENSIONS — 2-PLY — WITH COUPLER

ITEM #	SIZE	A (")	PCS/CTN	WT/100
301063	3" x 10'	3	35	220
301064	4" x 10'	4	20	295
301065	5" x 10'	5	13	375
301066	6" x 10'	6	9	440

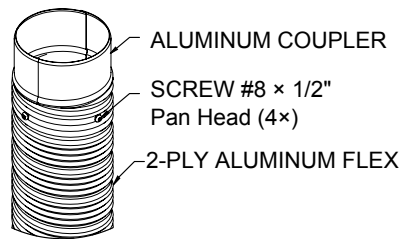
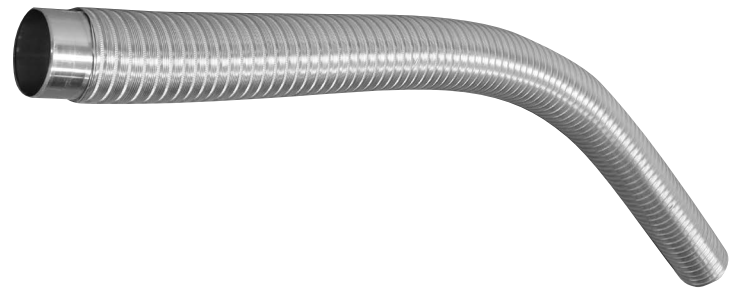

DETAIL VIEW

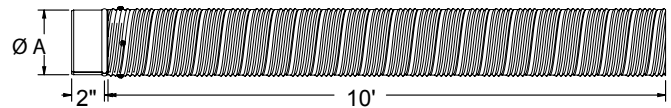

- E.&O.E. - Subject to Change Without Notice - May Not Be Available At All Locations -



www.eccomfg.com

Langley Distribution

19860 Fraser Highway
Langley, British Columbia
Canada V3A 4C9

Phone: 604-530-4151
Toll Free: 1-877-955-4805
Fax: 604-533-9335

Calgary Distribution

21 – 11150 38th Street, S.E.
Calgary, Alberta
Canada T2C 2Z6

Phone: 403-720-0895
Toll Free: 1-877-955-4815
Fax: 403-720-0897

Kent Distribution

20001 87th Ave. S, Bldg E
Kent, Washington
USA 98031

Phone: 253-872-3721
Toll Free: 1-800-207-6859
Fax: 253-872-3724