

28 Katz Way Somerton

New modern warehouses and offices for sale



New boutique warehouses and office spaces for sale

TC Commercial is pleased to offer for sale, 28 Katz Way, 19 brand new, architecturally designed warehouses and offices for your consideration.

The development is within the North Park estate, a premier business park.

On offer in Melbourne's North, approximately 18 kilometres from the CBD.

There are 19 brand new quality warehouse/office units designed by award winning JDZ Building Design (www.jdzbuildingdesign.net). Individual warehouse sizes ranging from 135m² to 217m².

All warehouses are available to be purchased off the plan.

The development is about to commence construction and working towards a completion date circa March 2018.

Key benefits of the offering:

- Priced from only \$297,000 plus GST
- Located in one of Melbourne's fastest growing industrial precincts
- Surrounded by first class fully landscaped public open space amenities
- Strategically positioned close to major arterials and Airports
- Brand new offering – be the first to own one of these quality industrial Warehouses
- Architecturally designed and superior build with all new road infrastructure
- Building areas from 135m² to 217m²
- 8 metre overall height to office/warehouses
- Full tilt slab construction
- Loading bays to warehouses
- Automated roller shutter door
- 3 phase power
- Disabled toilets, kitchenette and shower
- Allocated on-site car parking spaces
- Secure premises with automated gates
- All warehouses have mezzanines/offices



**COMMERCIAL &
RESIDENTIAL**
REAL ESTATE
Property Development & Sales

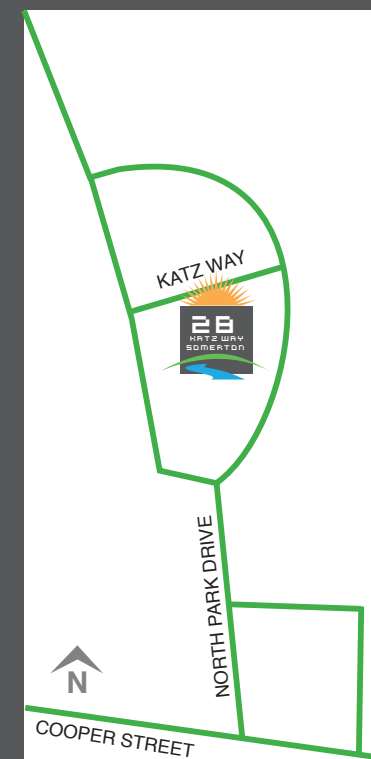

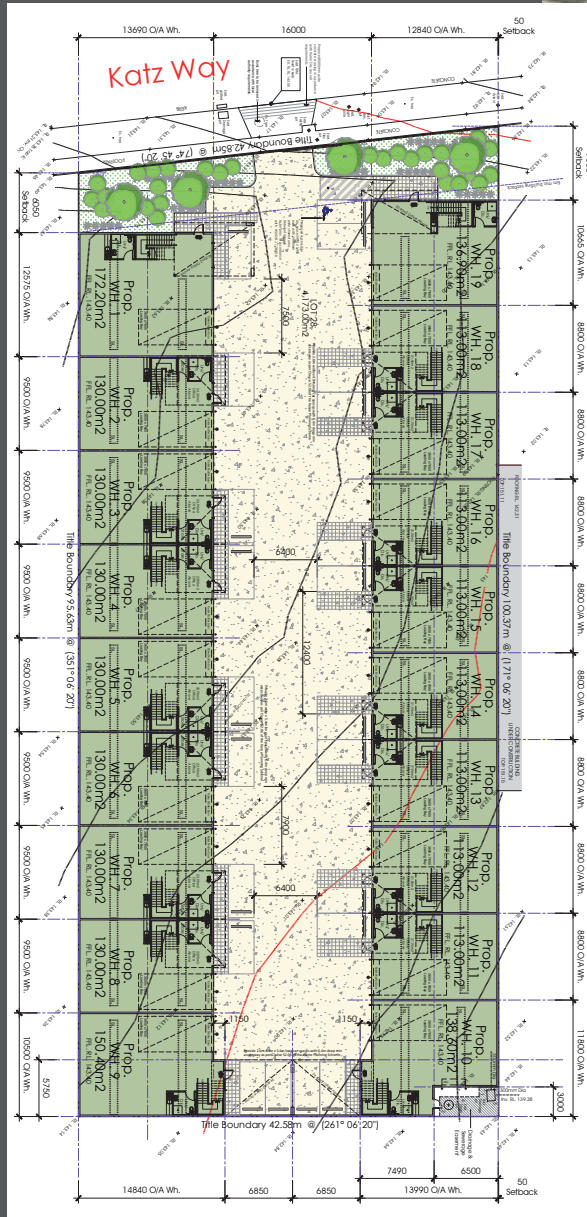

This document has been prepared by TC Commercial for advertising and general pictorial information only. Any interested party should undertake their own enquires as to the accuracy of the information.