

**FOR LEASE - RETAIL SPACE**  
**3611-3615 WASHINGTON STREET**

**JAMAICA PLAIN, MA**  
**02130**



# METROMARK

## Highlights

- Display windows offering strong street presence
- Located within a 283-unit residential community (450+ residents onsite)
- Adjacent to public transit (2-minute walk to Forest Hills Station)
- Onsite parking + street parking directly in front
- High foot traffic and built-in customer base

## About The Property

Prime 1,200 SF retail space available in the heart of Jamaica Plain at MetroMark — a vibrant, transit-oriented development with 283 residential units and over 450 residents onsite. The location offers exceptional visibility, high foot traffic and is ideal for retail or service-based businesses.

Featuring a flexible open floor plan, large display windows, and a clean, modern aesthetic, the space is ideal for a wide range of retail or service-based businesses. From boutique retail to specialty fitness or wellness concepts, the possibilities are endless.

## Contact Information

Patrick Leahy  
(617) 797-2241  
pat@overtimere.com



**OVERTIME**  
**REAL ESTATE**

# FOR LEASE - RETAIL SPACE

3611-3615 WASHINGTON STREET

JAMAICA PLAIN, MA

02130

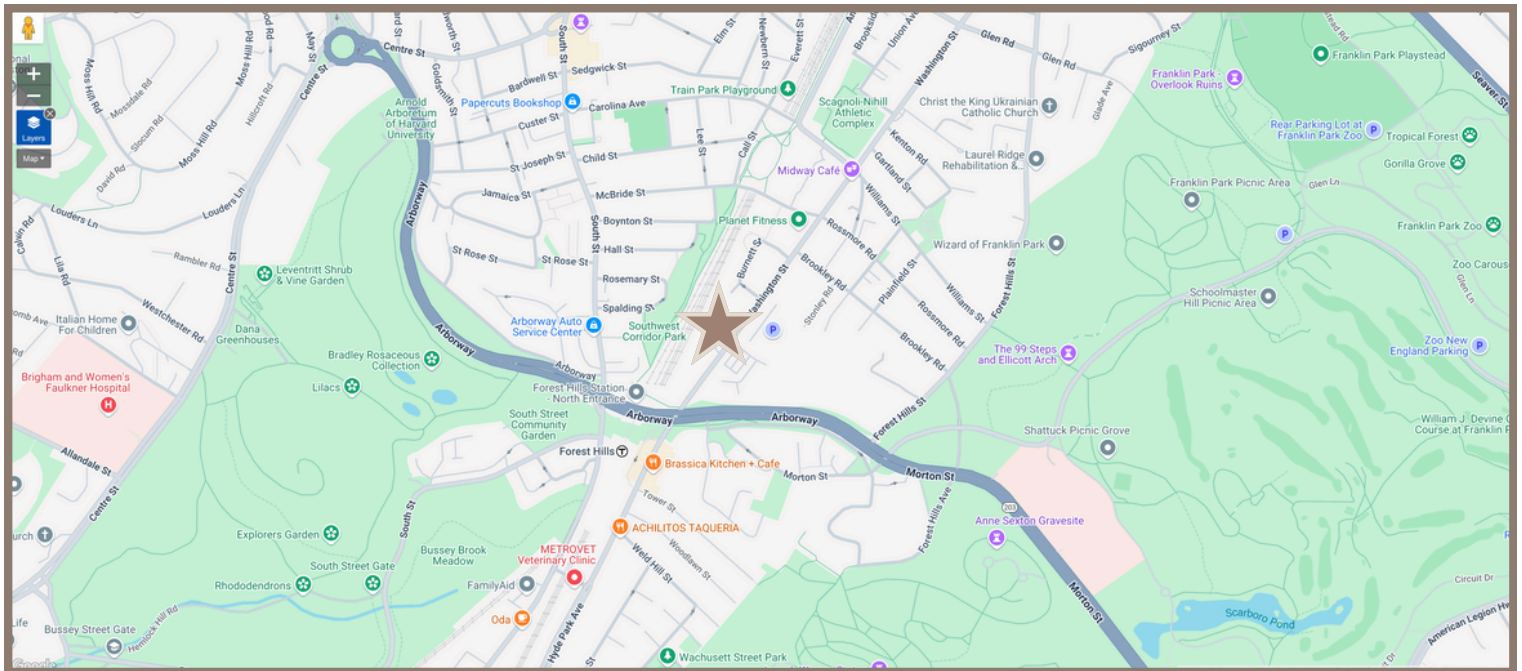
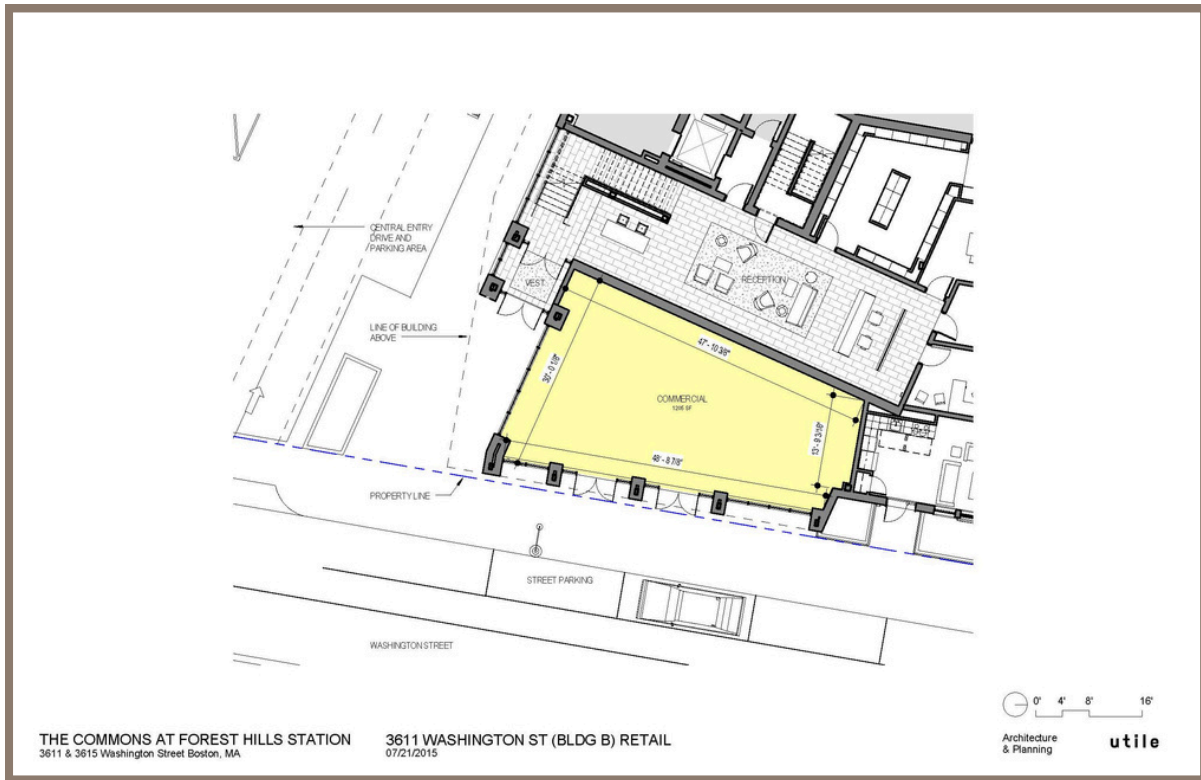

3615 WASHINGTON STREET | JAMAICA PLAIN, MA 02130

## Contact Information

Patrick Leahy  
(617) 797-2241  
pat@overtimere.com



OVERTIME  
REAL ESTATE