

Borrower or Owner CLIENT: Bethany Jones

Property Address 3546 Victoria Riverside Road

City Patterson County St. Mary Parish State LA Zip Code 70392

Lender or Client Bethany Ortego

# HOUSE INFORMATION AND MEASUREMENT SKETCH

## (HIMS) REPORT

CLIENT NAME: Bethany Ortego

DATE: August 31, 2021

PROPERTY ADDRESS: 3546 Victoria Riverside Road, Patterson, LA 70392

### HOUSE/PROPERTY DATA:

NET LIVING AREA: 2,394 sq. ft.

ROOM COUNT: 3 Bedrooms/2.5 Baths, plus Dining or Office

AIR CONDITIONING: Central Air and Heat

ADDITIONAL FEATURES: Waterfront location/view, dock over the water, front covered porch, rear covered screen patio, windows providing panoramic views, two car garage plus climate control storage room, fireplace, recreation building overlooking the river.

SITE AREA: 100'F X 364.86'S, .88 Acres, 38,333 sq. ft.

**SKETCH ADDENDUM**

Borrower or Owner **CLIENT: Bethany Jones**  
 Property Address **3546 Victoria Riverside Road**  
 City **Patterson** County **St. Mary Parish** State **LA** Zip Code **70392**  
 Client **Bethany Ortego**

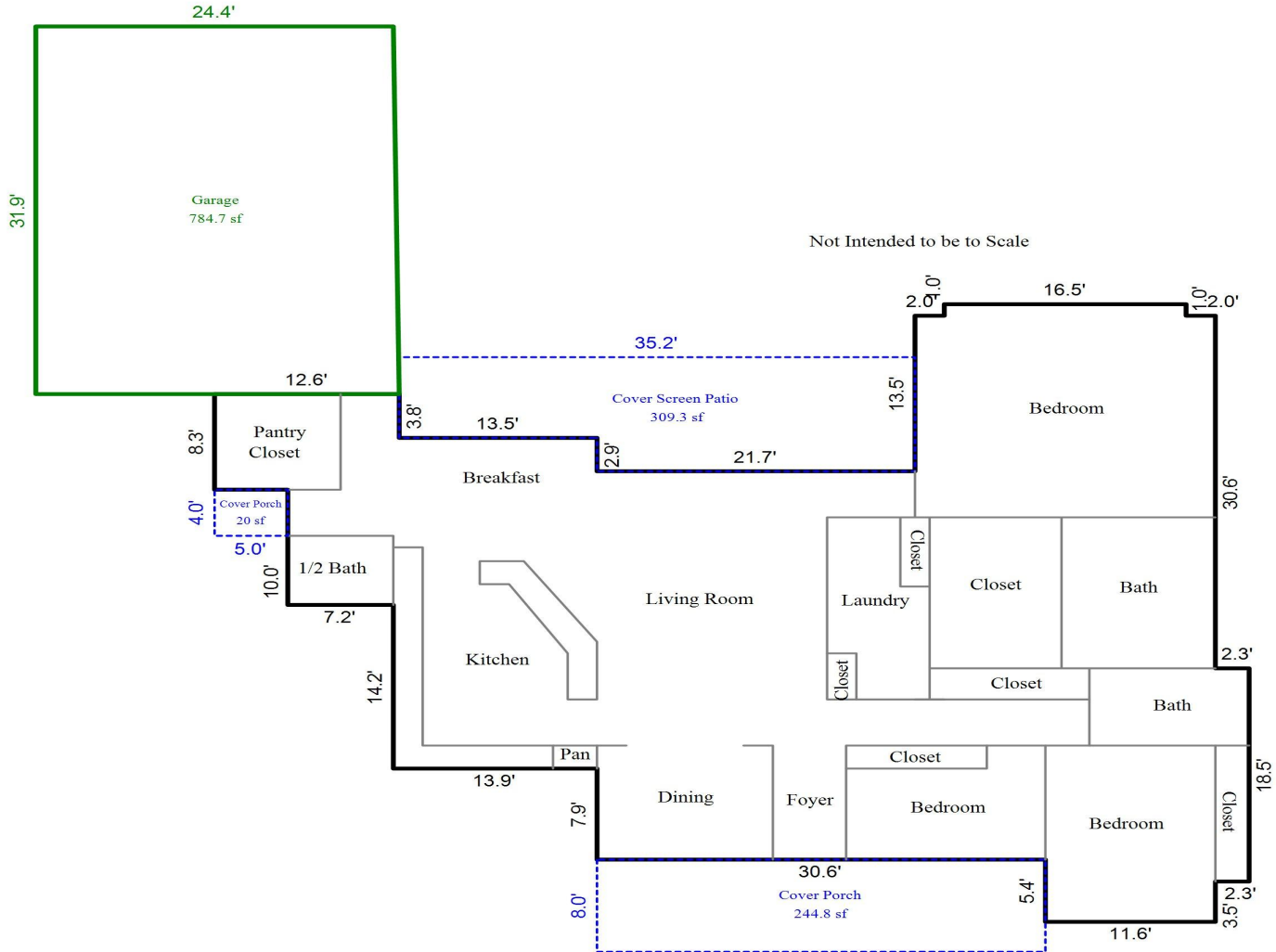

Sketch by Apex Sketch

AREA CALCULATIONS SUMMARY						AREA CALCULATIONS BREAKDOWN				
Code	Description	Factor	Net Size	Perimeter	Net Totals	Name	Base x	Height x	Width =	Area
GLA1	First Floor	1.0	2394.3	261.8	2394.3	First Floor		18.5 x	2.3 =	42.5
GAR	Garage	1.0	784.7	113.0	784.7			16.5 x	1.0 =	16.5
P/P	Cover Porch	1.0	244.8	77.2				42.2 x	33.7 =	1422.1
	Cover Screen Pat	1.0	309.3	90.2				20.5 x	5.4 =	62.6
	Cover Porch	1.0	20.0	18.0	574.1			20.5 x	13.5 =	276.8
								12.6 x	8.3 =	104.6
								10.0 x	7.6 =	76.0
								14.5 x	13.5 =	195.8
								14.2 x	13.9 =	197.4
	Net LIVABLE	cnt	1	(rounded)	2,394	9 total items			(rounded)	2,394

**PHOTOGRAPH ADDENDUM**

Borrower or Owner **CLIENT: Bethany Jones**

Property Address **3546 Victoria Riverside Road**

City **Patterson** County **St. Mary Parish** State **LA** Zip Code **70392**

Client **Bethany Ortego**

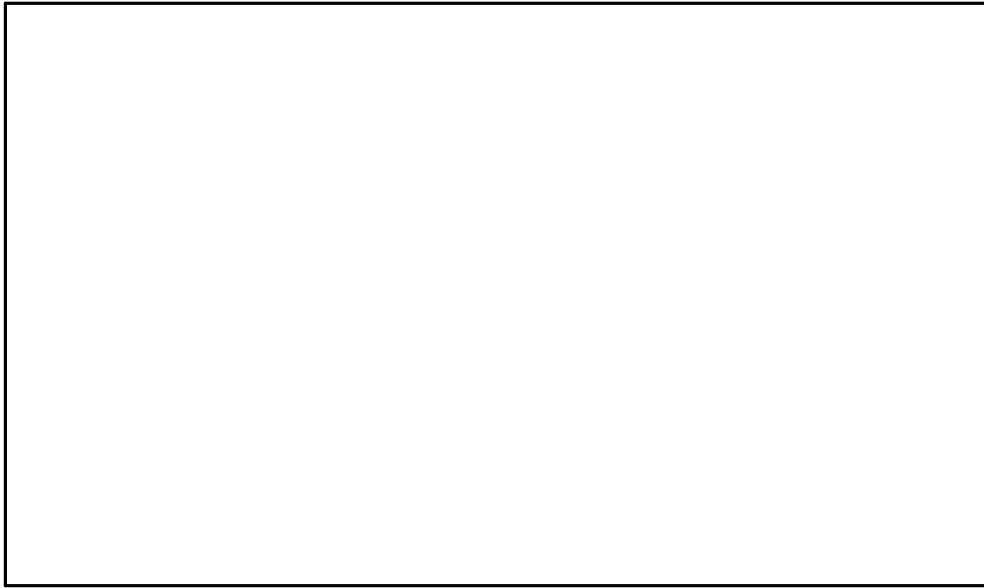

**FRONT VIEW OF  
SUBJECT PROPERTY**

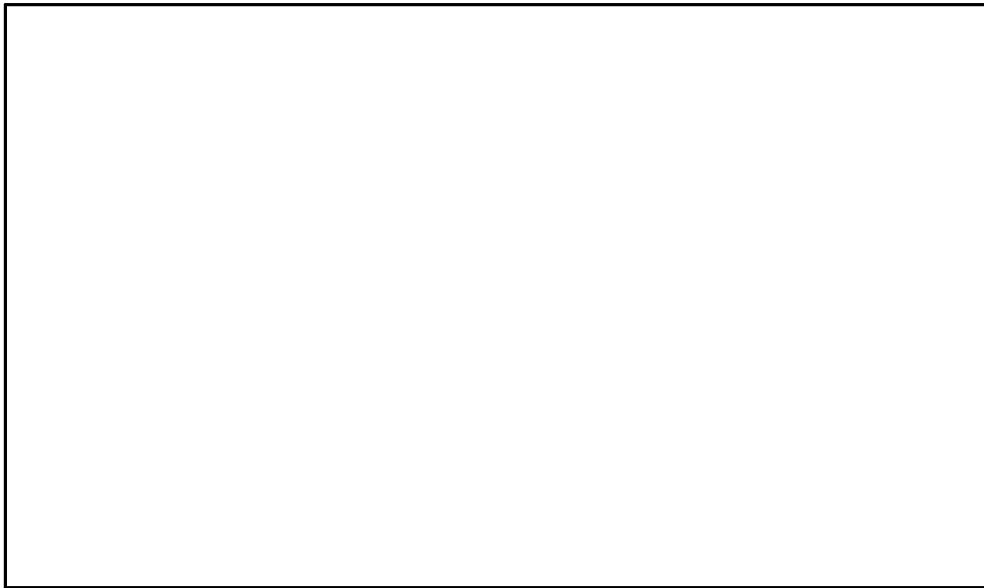

**REAR VIEW OF  
SUBJECT PROPERTY**

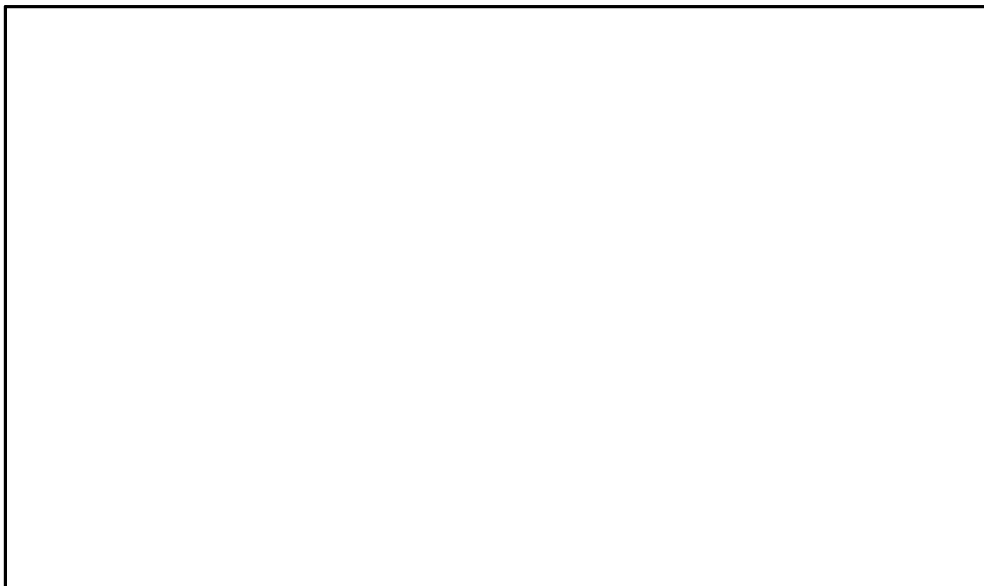

**STREET SCENE OF  
SUBJECT PROPERTY**

St. Mary Parish Appraisals  
P. O. Box 1305  
Patterson, LA 70392  
985-759-1292

<b>INVOICE</b>	11/10/2021 DATE	HIMS FILE NUMBER	CASE NUMBER
----------------	--------------------	---------------------	-------------

Client: Bethany Ortego

Item	Total
------	-------

HIMS REPORT FEE FOR SERVICES RENDERED	\$ 100.00
---------------------------------------	-----------

3546 Victoria Riverside Road  
Patterson, LA 70392

***PAID CHECK NO. 1234, VENMO, CREDIT CARD, PAY PAL OR CASH***	-100.00
--	---------

\*\*\*\*\**THANK YOU FOR YOUR BUSINESS*\*\*\*\*\*

\*\*\*\*\**HAVE A GREAT DAY*\*\*\*\*\*

<b>Total:</b>	\$	--00--
---------------	----	--------

---

Thank you

---