

PRODUCT CODE: CGT11
 PUBLICATION DATE: May 2021 v1.00

Heavy Duty Cavity Wall Tie

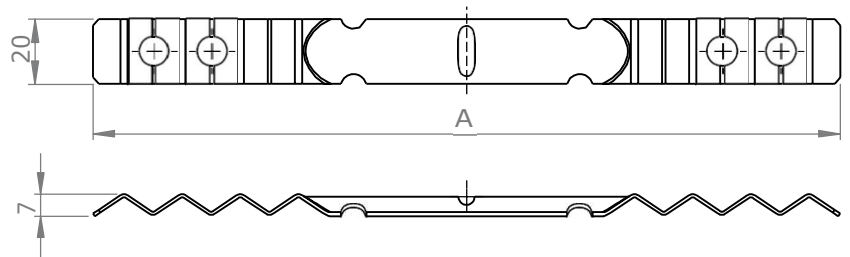
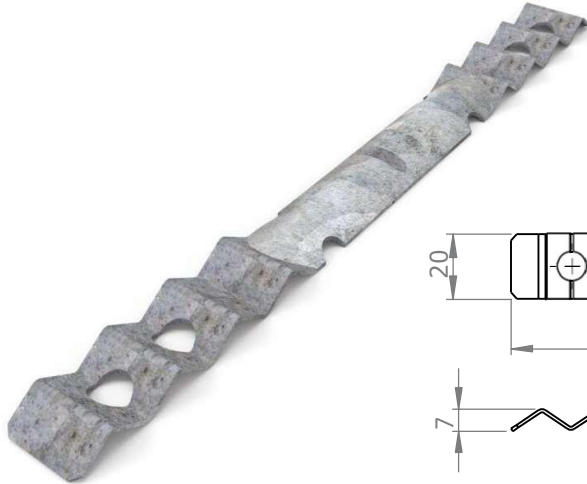

Datasheet

DESCRIPTION

Heavy duty cavity wall tie

FEATURES

- Clay brick / clay brick or clay brick / block work
- Maximum cavity 120mm
- Universal applications
- Australian design & tested as/nzs 2699.2:2020

SIZES

Standard Sizes : 200mm, 230mm, 270mm, 310mm and 350mm

CORROSION CHARACTERISTICS

Hot dipped galvanising (R3)
 Stainless steel 316L (R4)
 Conforms to corrosion resistance set by AS/NZS 2699.2:2020 / AS 3700.

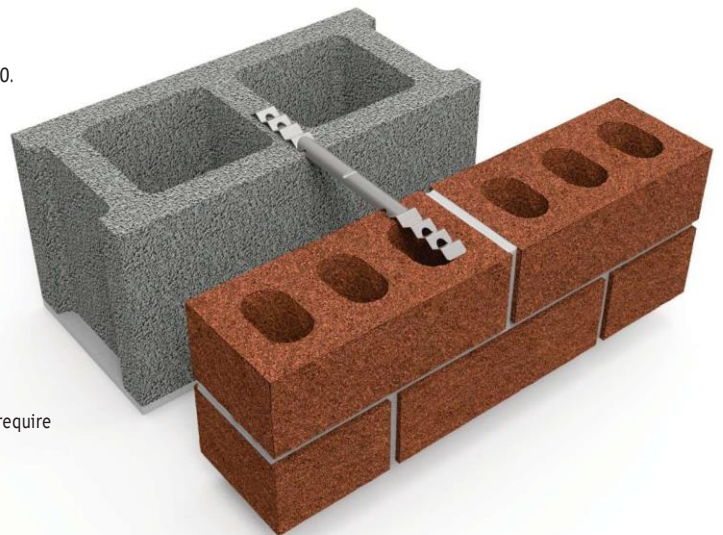

ORDERING INFORMATION

When ordering please supply use with the part number and quantity you require

CGT11-200-R4

PRODUCT CODE

LENGTH

MATERIAL

- | | |
|-----|------------------------------|
| A | Specify |
| 200 | R3 for Hot dipped galvanised |
| 230 | R4 for Stainless steel 316L |
| 270 | |
| 310 | |
| 350 | |



FOR SALES ENQUIRIES, PLEASE CONTACT ROGERS CS (QLD) OR SALES@ROGERSCS.COM.AU

UNIT 2, 19 HOOK STREET, CAPALABA QLD 4157 | T: 07 3823 2316 | HTTPS://ROGERSCS.COM.AU